



LUMEGEN LEDDOCK1000051001 LED Square Dock Light Instruction Manual

[Home](#) » [LUMEGEN](#) » LUMEGEN LEDDOCK1000051001 LED Square Dock Light Instruction Manual 



[LED SQUARE DOCK LIGHT] INSTRUCTION MANUAL

LEDDOCK1000051001 – LG-LDSH-20-50K

LEDDOCK1000051002 – LG-LDSH-30-50K

LEDDOCK1000051003 – LG-LDSH-50-50K

Contents

- [1 LEDDOCK1000051001 LED Square Dock Light](#)
- [2 IMPORTANT SAFETY & NOTES WARNING](#)
- [3 INSTALLATION INSTRUCTIONS](#)
- [4 TROUBLESHOOTING](#)
- [5 5-Year Limited Warranty](#)
- [6 Documents / Resources](#)
 - [6.1 References](#)
- [7 Related Posts](#)

LEDDOCK1000051001 LED Square Dock Light

Project:

Date of Purchase:

IMPORTANT: Read all instructions prior to installation! Keep instructions for future reference!

**Included Parts List:**

- (1) LED Round Dock Light Head
- (1) Instruction Sheet

Optional Accessories

- A40in. Adjustable Bracket Arm Kit – Single Arm
- 24in. Adjustable Bracket Arm Kit – Single Arm
- A40in. Adjustable Bracket Arm Kit – Double Arm
- A0in. Adjustable Bracket Arm Kit – Double Arm -Built- In Power Receptacle+1ft Dock Light Extension Cable
- 60in. Adjustable Bracket Arm Kit – Double Arm
- 8ft Dock Light Extension Cable

IMPORTANT SAFETY & NOTES WARNING

- Before installing, servicing, or performing routine maintenance upon this equipment, follow these general precautions.
- To reduce the risk of death, personal injury or property damage from fire, electric shock, falling parts, cuts/abrasions, and other hazards read all warnings and instructions included with and on the fixture box and all fixture labels.
- Product should be installed by a certified electrician in accordance with applicable national, state, and local building and electrical codes.
- Failure to properly support the fixture may result in damage or injury, for which the manufacturer does not assume responsibility.
- To prevent wiring damage or abrasion, do not expose wiring to edges of sheet metal or other sharp objects.
- Do not make or alter any open holes in an enclosure of wiring or electrical components during installation.

WARNING

- Turn off electrical power at fuse or circuit breaker box before wiring fixture to the power supply!
- Turn off the power when you perform any maintenance.
- Verify that supply voltage is correct by comparing it with the luminaire label information.
- All wiring connections should be capped with UL approved wire connectors.

CAUTION

- Avoid direct eye exposure to the light source while it is on
- Account for small parts and destroy packing material, as these may pose hazardous to children.
- Risk of burn! Disconnect power and allow fixture to cool before handling.

Recommended Tool List (Not included):

- Phillips Screw driver
- Hammer
- Electrical Meter

Electrical Specifications

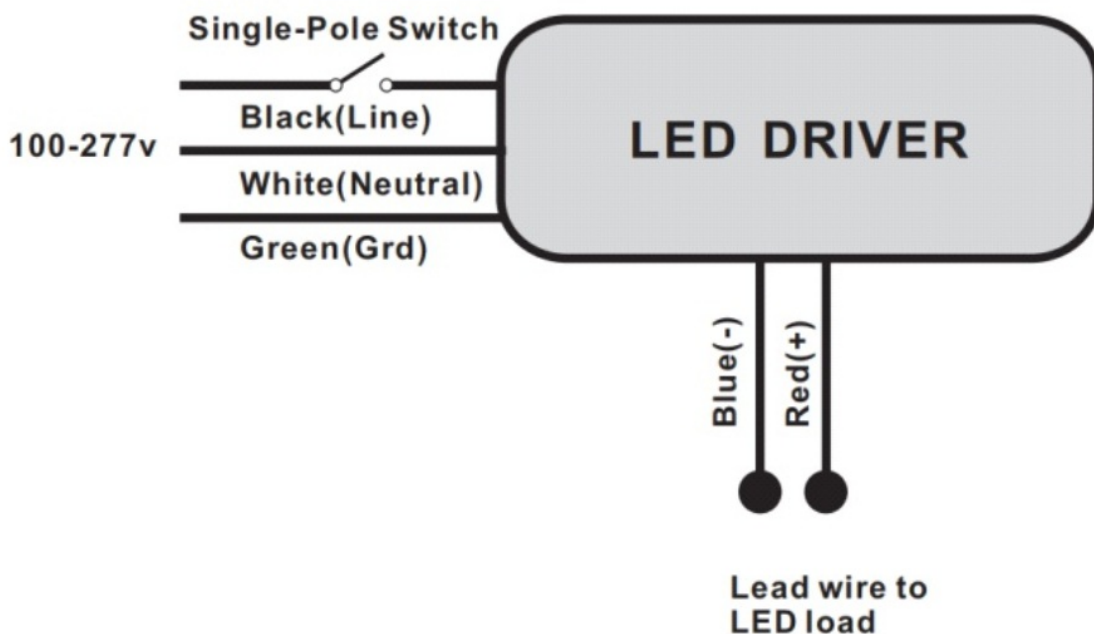

Electrical Specification

Power	Input Voltage	Frequency	Luminous Efficacy	Color Temperature	Opera Temperature	IP Rating
20W	100-277VAC	50/60Hz	140lm/W	5000K	-40°F ~ +113°F	IP65
30W	100-277VAC	50/60Hz	140lm/W	5000K	-40°F ~ +113°F	IP65
50W	100-277VAC	50/60Hz	140lm/W	5000K	-40°F ~ +113°F	IP65

*IP65 rating requires connection to weather protected outlet.

INSTALLATION INSTRUCTIONS

WARNING: Turn off power supply from main circuit breaker first!
Install a Rent Swing Brackets ("Wall Mounting")

1. 40in. Adjustable Bracket Arm Kit – Single Arm LEDDOCK1000051007 (need to be purchased separately)

Step 1. Drill holes in the wall according to the size of the wall mount;

Step 2. Fix the bracket with screws on the wall;

Step 3. Securely attach light to arm. Connect power cord to light.

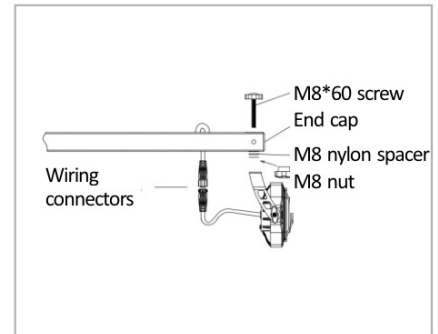
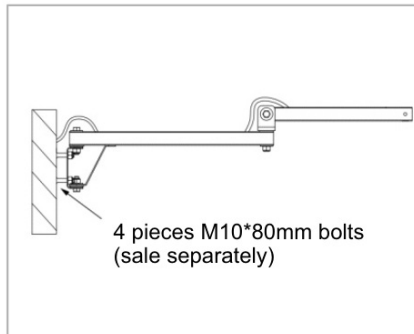
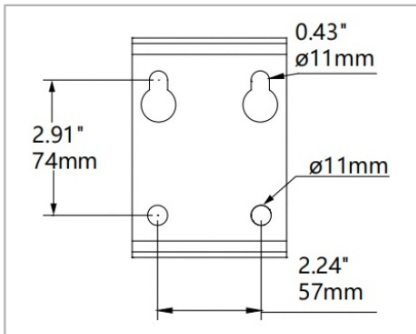

2. 24in. Adjustable Bracket Arm Kit – Single Arm LEDDOCK1000051008 (need to be purchased separately)

Step 1. Drill holes in the wall according to the size of the wall mounting plate;

Step 2. Fix the bracket with screws on the wall;

Step 3. Securely attach light to arm. Connect power cord to light.

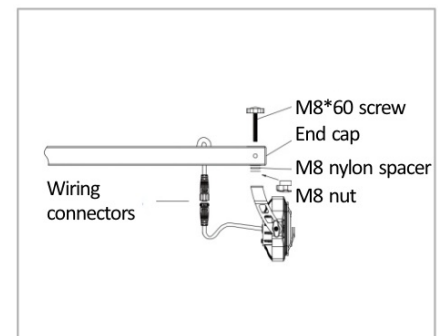
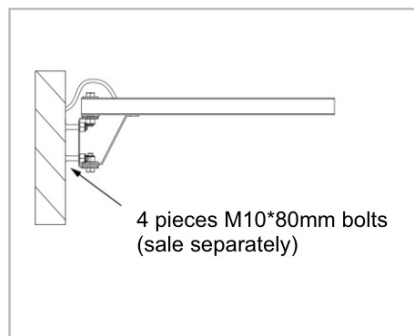
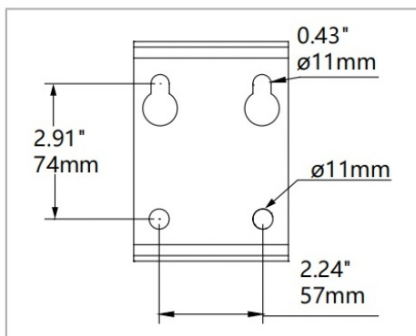

3. 40in. Adjustable Bracket Arm Kit – Double Arm LEDDOCK1000051009 (need to be purchased separately)

Step 1. Drill holes in the wall according to the size of the wall mounting plate;

Step 2. Fix the bracket with screws on the wall;

Step 3. Securely attach light to arm. Connect power cord to light.

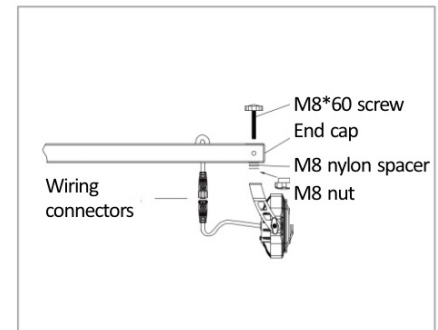
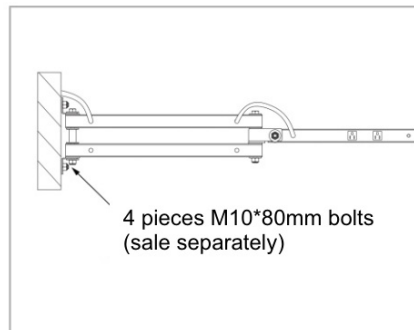
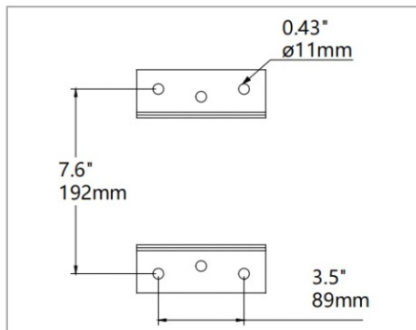

4. 40in. Adjustable Bracket Arm Kit – Double Arm – Built-in Power Receptacle LEDDOCK1000051010 (need to be purchased separately)

Step 1. Drill holes in the wall according to the size of the wall mounting plate;

Step 2. Fix the bracket with screws on the wall;

Step 3. Connect 1ft extension cable with a 120v US plug to light head.

Step 4. Securely attach light to arm. Connect power cord to light.

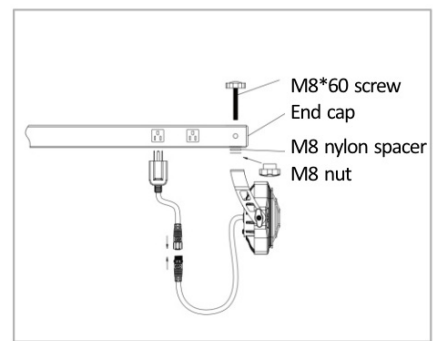
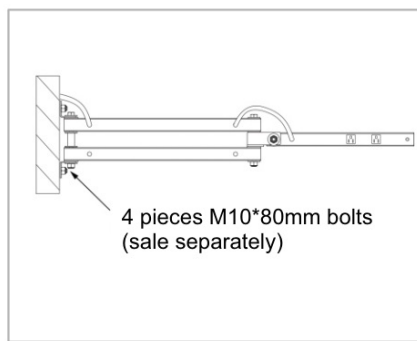
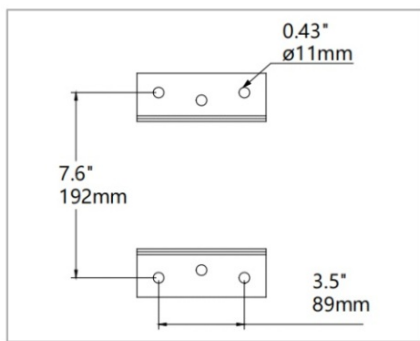

5. 60in. Adjustable Bracket Arm Kit – Double Arm LEODOCK1000051011 (need to be purchased separately)

Step 1. Drill holes in the solid objects according to the size of the mounting bracket;

Step 2. Connect 8ft extension cable with a 120v US plug.

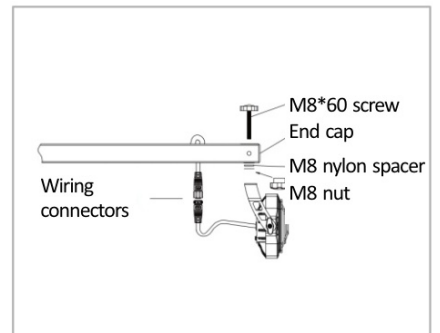
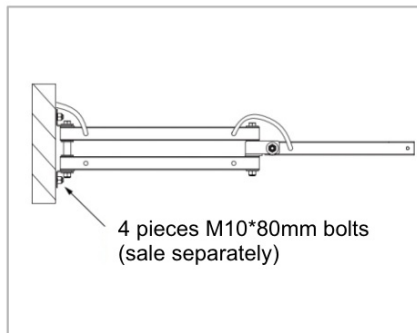
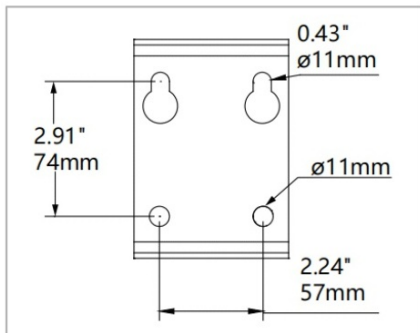

6. 8ft Dock Light Extension Cable LEDDOCK1000051012 (need to be purchased separately)

Step 1. Drill holes in the solid objects according to the size of the mounting bracket;

Step 2. Connect 8ft extension cable with a 120v US plug.

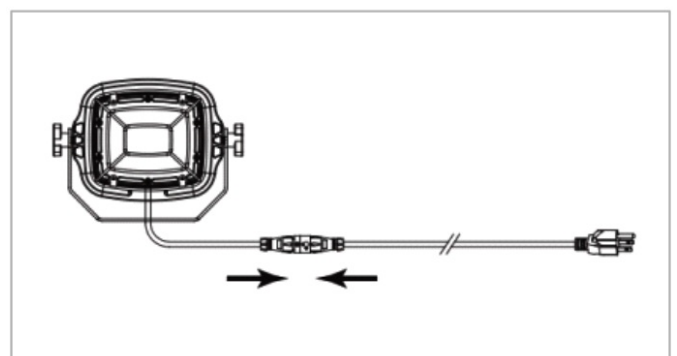
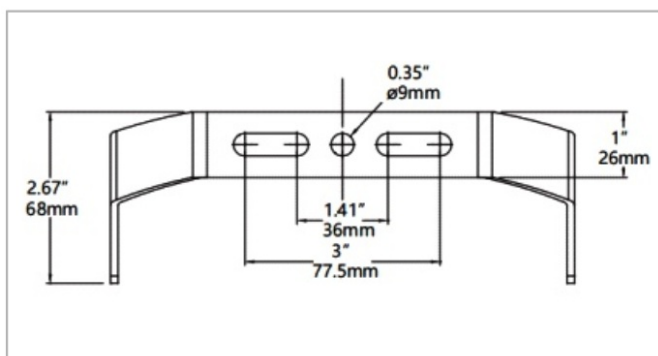

TROUBLESHOOTING

Having trouble? Before contacting the manufacturer, please review below troubleshooting check list:

- Verify your power source is on.
- Check electrical connections for secure connections.

5-Year Limited Warranty

LumeGen (Seller) carries a limited warranty on all of it's LED products for manufacturing defects and product failures. The warranty period for commercial products is 5 years from the date of purchase (based on 12 hours per day, 7 days per week of normal commercial use). If LumeGen LED products fail to operate within the warranty period listed above when used as directed, contact LumeGen Customer Service Department to initiate the return process and explain your warranty claim. Failure to follow the procedure as provided by the Customer Service Department will void this warranty.

What you Do: We ask that you call our Customer Service Department at [800-998-6977](tel:800-998-6977) to obtain an RMA number

and explain the warranty issue. It is the customer's responsibility to pay for the return shipping of the defective product (s) back to the Seller. If the product(s) is found to be defective, the Seller will pay for the shipping costs of the replacement product (s) back to the customer. The returned product (s) must include the RMA # clearly marked on the outside of the packaging, and must include a copy of the original proof of purchase (invoice or sales order). **What we Do:** Once we receive the product (s) in question, we will verify the defective claim on the product. If we determine that the defect was not caused by negligence, improper installation, electrical surges, alteration, abuse, unauthorized repair, or disassembly, we will send you a replacement LumeGen Product (s). If an identical replacement is not available for any reason, LumeGen reserves the right, at its sole discretion, to replace the defective product (s) with a different product (s) of equal value that most closely matches the specifications of the original product. Replacement of the defect product (s) is LumeGen's sole warranty obligation, and case or credit refunds will not be offered.

This Limited Warranty is subject to the following conditions:

- Seller is not responsible for incidental and consequential damages that may occur during the return of the product to the seller.
- This warranty is extended only to the original purchaser of the product from Seller. This warranty does not cover any thirdparty products or devices used in conjunction with the product purchased.
- Seller will not be responsible for any type of removal or re-installation costs, including labor and/or equipment charges or expenses, and will not be responsible for shipping costs or expenses to return the product(s) back to the Seller.
- This warranty covers products purchased in, and used within, the United States or Canada. No agent, distributor, or dealer is authorized to change, modify, or extend the terms of this Limited Warranty on behalf of LumeGen.
- For warranty or other questions, please call [800-988-6977](tel:800-988-6977) or email customerservice@onlinestores.com.

LumeGen | 1000 Westinghouse Drive STE 1, New Stanton PA 15672 | [800-988-6977](tel:800-988-6977) | Lightup.com
Specifications and dimensions subject to change without notice.

Documents / Resources

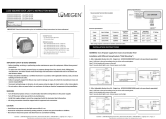
	LUMEGEN LEDDOCK1000051001 LED Square Dock Light [pdf] Instruction Manual LEDDOCK1000051001, LEDDOCK1000051002, LEDDOCK1000051003, LEDDOCK1000051001 LED Square Dock Light, LEDDOCK1000051001, LED Square Dock Light, Square Dock Light, Dock Light, Light
---	--

References

- [Light Up | Premier Commercial LED Lighting Solutions](#)
- [User Manual](#)

Manuals+. Privacy Policy

This website is an independent publication and is neither affiliated with nor endorsed by any of the trademark owners. The "Bluetooth®" word mark and logos are registered trademarks owned by Bluetooth SIG, Inc. The "Wi-Fi®" word mark and logos are registered trademarks owned by the Wi-Fi Alliance. Any use of these marks on this website does not imply any affiliation with or endorsement.