

Lumberg 
passion for connections
2542 03 Modular Plug



Lumberg 2542 03 Modular Plug Instruction Manual

[Home](#) » [Lumberg](#) » Lumberg 2542 03 Modular Plug Instruction Manual 

Contents

- [1 Lumberg 2542 03 Modular Plug](#)
- [2 Specifications](#)
- [3 Product accessories](#)
- [4 Step 1: Prepare the Network Cable](#)
- [5 Step 2: Cable Preparation](#)
- [6 Step 3: Wiring Cap Installation](#)
- [7 Step 4: Final Assembly](#)
- [8 FAQs](#)
- [9 Documents / Resources](#)
 - [9.1 References](#)
- [10 Related Posts](#)

Lumberg 
passion for connections

Lumberg 2542 03 Modular Plug



Specifications

- Part 1: 5.5-8.5mm
- Network Cable Length: 1.2 inches
- Manufacturer: Lumberg
- Website: www.lumberg.com
- Expiration Date: 08/2024

Product accessories

JACK PIN DESIGNATIONS		TIA/EIA T568A	TIA/EIA T568B
	1	White/Green	white/Orange
	2	Green	Orange
	3	white/Orange	White/Green
	4	Blue	Blue
	5	white/Blue	white/Blue
	6	Orange	Green
	7	White/Brown	White/Brown
	8	Brown	Brown

1. Insert the network cable into the nut from the end

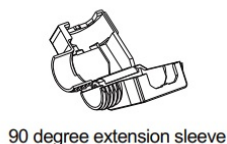
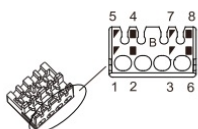
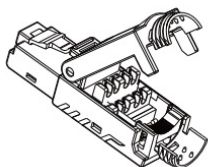

90 degree extension sleeve



Part 1: 5.5-8.5mm



Copper foil paper

2. Peel off the cover of the 1.2 inch network cable

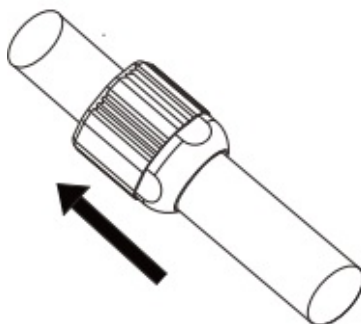

3. Fold back braid and drain wire



4. Wrap a layer of copper foil

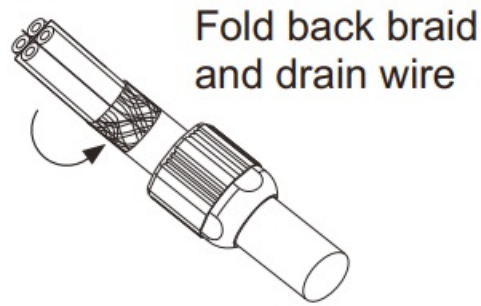

5. Fan out all four twisted pairs, following the color coding label and allocate each conductor into proper slots on wiring cap. Trim the ends of conductors.

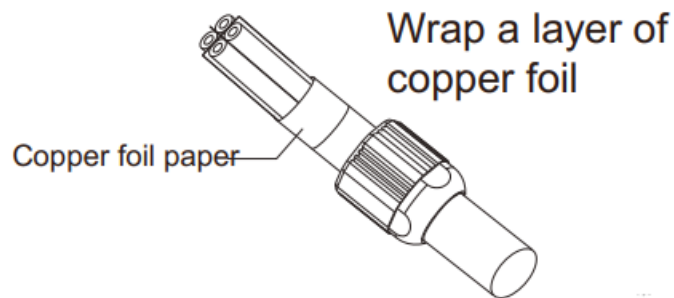

6. Tear Off excess stickers along the dotted line. Place Wiring cap on plug. Place the Wiring cap onto plug, use plier to clamp Wiring cap until it completely snaps-in to effect the connection.

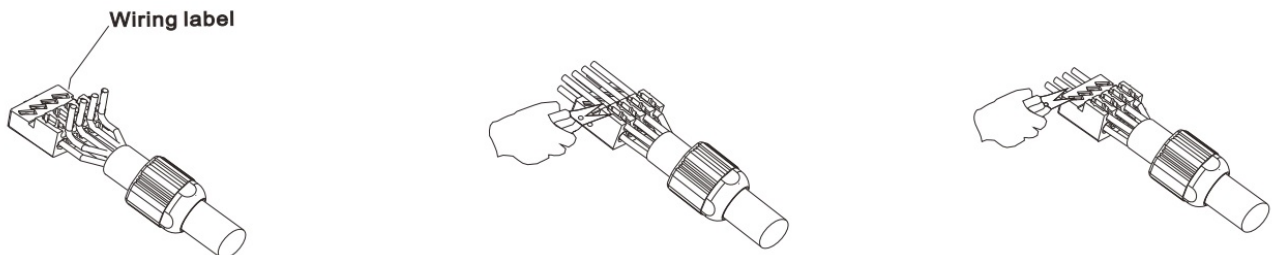

7. Close the plug cover, make sure the power cord makes proper contact With the ground dip on the plug, and tighten the nut.

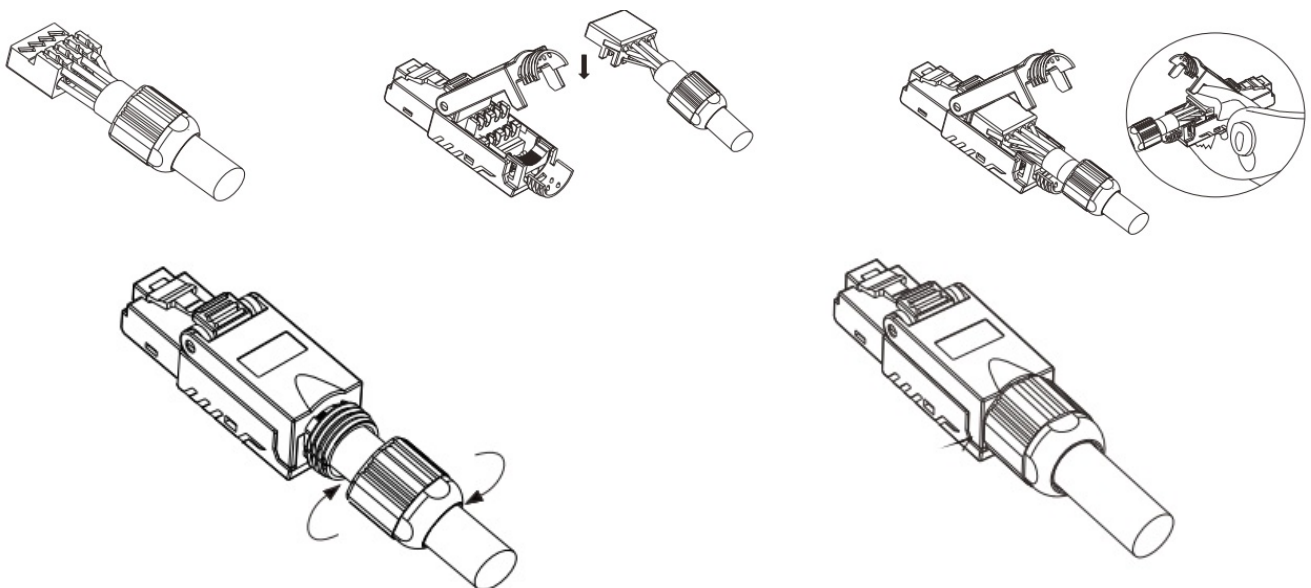

8. Close the plug cover, make sure the power cord makes proper contact With the ground clip on the plug, then close 90 degree extending sleeve and tighten the nut.

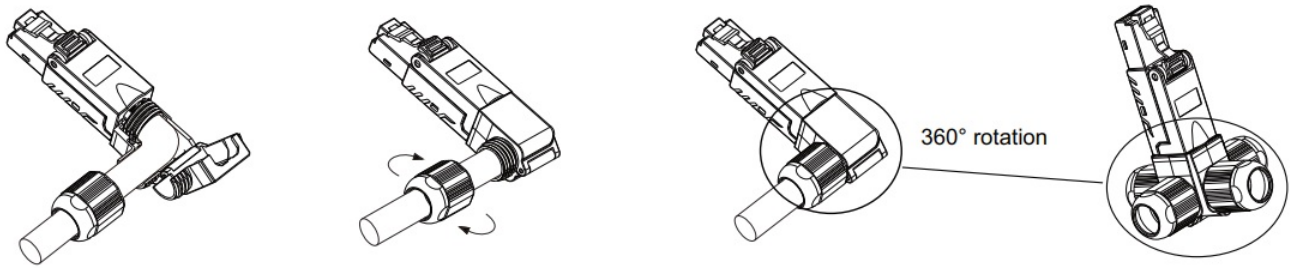

Step 1: Prepare the Network Cable

1. Insert the network cable into the nut from the end.
2. Peel off the cover of the 1.2 inch network cable.

Step 2: Cable Preparation

1. Fold back braid and drain wire.
2. Wrap a layer of copper foil around the cable.

Step 3: Wiring Cap Installation

1. Fan out all four twisted pairs following the color coding label.
2. Allocate each conductor into proper slots on the wiring cap.
3. Trim the ends of conductors.
4. Tear off excess stickers along the dotted line.
5. Place the wiring cap onto the plug.
6. Use pliers to clamp the wiring cap until it completely snaps in to effect the connection.

Step 4: Final Assembly

1. Close the plug cover.
2. Ensure the power cord makes proper contact with the ground clip on the plug.
3. If using the 90-degree extension sleeve, close it and tighten the nut.

FAQs

Q: How do I ensure a secure connection when assembling the plug?

A: Use pliers to firmly clamp the wiring cap until it completely snaps in, ensuring a secure connection.

Q: What is the purpose of the copper foil paper in the cable preparation process?

A: The copper foil paper helps shield the cable from electromagnetic interference, ensuring better signal quality.

Q: Do I need to follow a specific color coding when allocating conductors on the wiring cap?

A: Yes, follow the color coding label provided to ensure correct allocation of conductors for proper functionality.

Documents / Resources

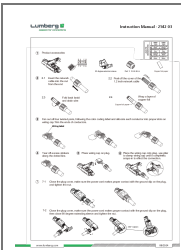

[Lumberg 2542 03 Modular Plug](#) [pdf] Instruction Manual
2542 03, 2542 03 Modular Plug, 2542 03, Modular Plug

References

- [User Manual](#)

Manuals+, Privacy Policy

This website is an independent publication and is neither affiliated with nor endorsed by any of the trademark owners. The "Bluetooth®" word mark and logos are registered trademarks owned by Bluetooth SIG, Inc. The "Wi-Fi®" word mark and logos are registered trademarks owned by the Wi-Fi Alliance. Any use of these marks on this website does not imply any affiliation with or endorsement.