



LUMASCAPE LS9010 Complete Linear Solution Instruction Manual

[Home](#) » [LUMASCAPE](#) » LUMASCAPE LS9010 Complete Linear Solution Instruction Manual 

Contents

- [1 LUMASCAPE LS9010 Complete Linear Solution](#)
- [2 INSTRUCTION](#)
- [3 Tools Required](#)
- [4 Included Components](#)
- [5 Assembly Instructions](#)
- [6 Wiring Designations](#)
- [7 Dimensions](#)
- [8 Luminaire Rotation](#)
- [9 Mounting](#)
- [10 SPECIFICATION](#)
- [11 Documents / Resources](#)
- [12 Related Posts](#)



LUMASCAPE LS9010 Complete Linear Solution



Please read and follow all safety instructions carefully. Failure to do so will void the warranty.

WARNING

Product Warranty is void if the product is not installed as per installation instructions and in compliance with all local and provincial codes.

INSTRUCTION

- Ensure installation complies with local electrical rules and regulations.
- All electrical work must be performed by a licensed electrician.
- Class III product SELV (symbol 3).
- All luminaires may become hot. Use discretion on where the luminaire is mounted. Take care when setting the luminaire as it may become hot.
- Luminaire should only be used complete with a protective shield. If the protective shield is cracked, immediately stop using the luminaire. Isolate the light source, keep it dry and immediately contact Lumascape for the replacement of the protective shield (symbol 10).
- If the external flexible cable or cord of this luminaire is damaged, it shall be exclusively replaced by Lumascape or their service agent in order to avoid a hazard.
- The light source contained in this luminaire shall only be replaced by Lumascape or its service agent.
- Do not stare at the operating light source. The luminaire should be positioned so that prolonged staring into the luminaire at a distance closer than 9.8' (3 m) is not expected (symbol 13).
- To reduce the risk of strangulation the flexible wiring connected to this luminaire shall be effectively fixed to the wall if the wiring is within arm's reach.
- Ensure mains input power is surge protected.
- Never make or break connections while the circuit is energized.
- Do not make modifications or alter the product.
- Keep luminaire clean and free of debris.
- Only clean with warm water.
- Do not use chemicals or abrasives to clean the luminaire as this may void the product warranty.
- Connections are to be kept clean and dry at all times.

- Suitable for use indoors or outdoors.

Tools Required

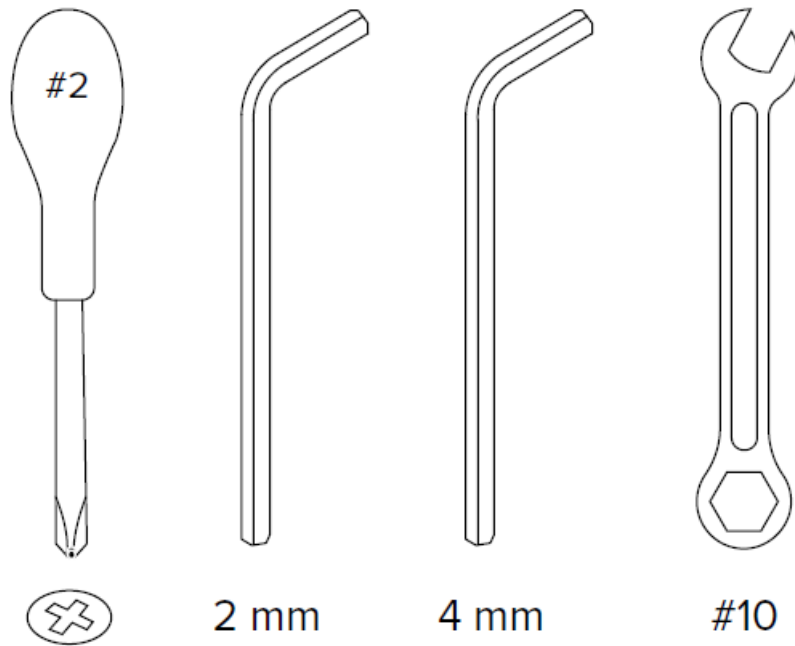

Included Components

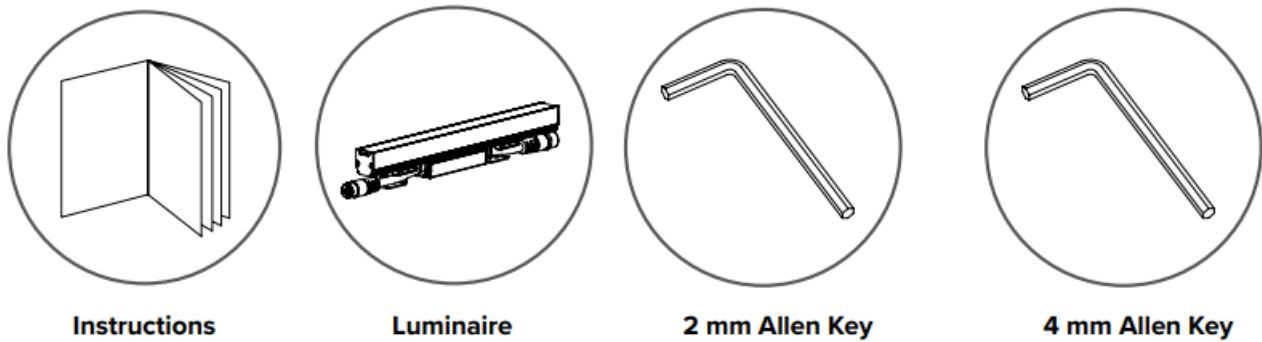

CAUTION Risk of Electric Shock

- Do Not Use Power Tools on Screws
- Keep Electronics Free From Dirt and Moisture
- Keep Away from Flammable Materials
- Do Not Hose or Pressure Clean
- Do Not Use Silicone On the Outside Surface
- Do Not Cut Cable to the Luminaire

Assembly Instructions

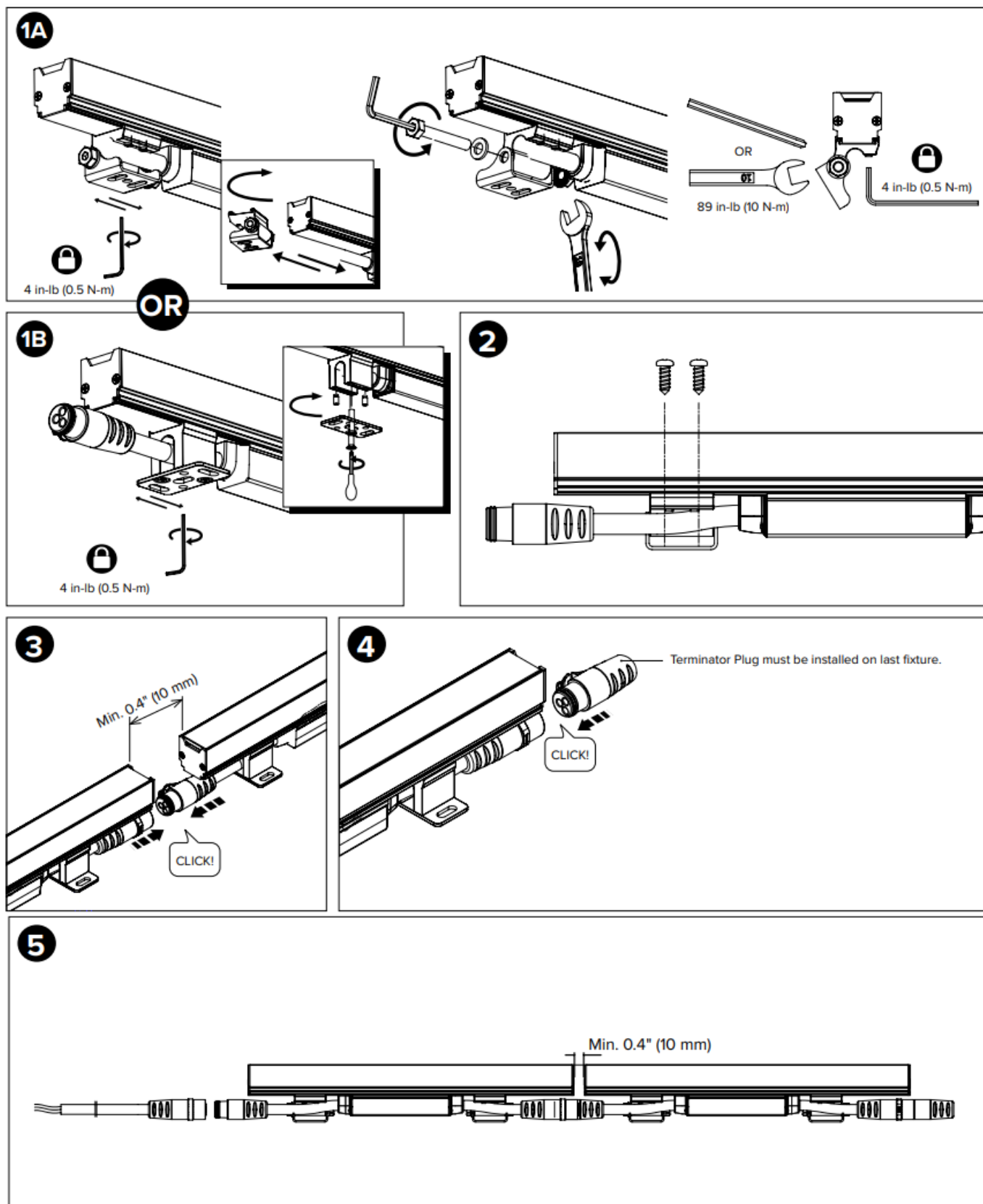

Wiring Designations

Designation/Color

- + DC Red
- – DC Black
- Data Orange

Do not Hi-Pot test

Dimensions

Body Type S: Without Integral Micro-Louvre

1 ft – 12.4" (314 mm)
2 ft – 24.1" (613 mm)
3 ft – 35.9" (912 mm)
4 ft – 47.7" (1,211 mm)
5 ft – 59.4" (1,510 mm)

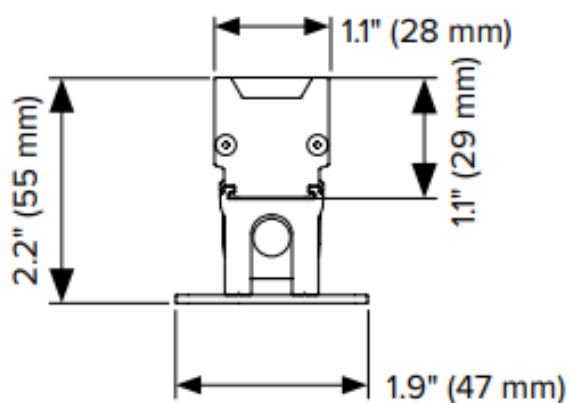

Fixed Bracket

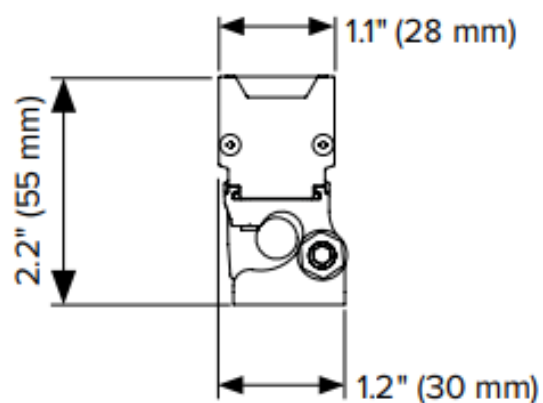

Adjustable Bracket

Body Type L: With Integral Micro-Louvre

1 ft – 12.4" (314 mm)
2 ft – 24.1" (613 mm)
3 ft – 35.9" (912 mm)
4 ft – 47.7" (1,211 mm)
5 ft – 59.4" (1,510 mm)

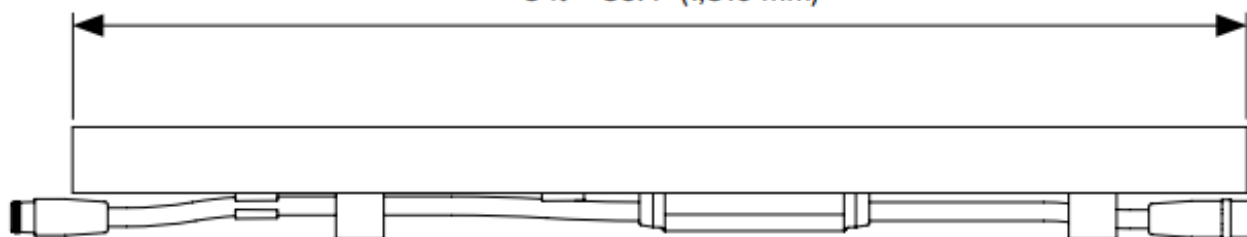

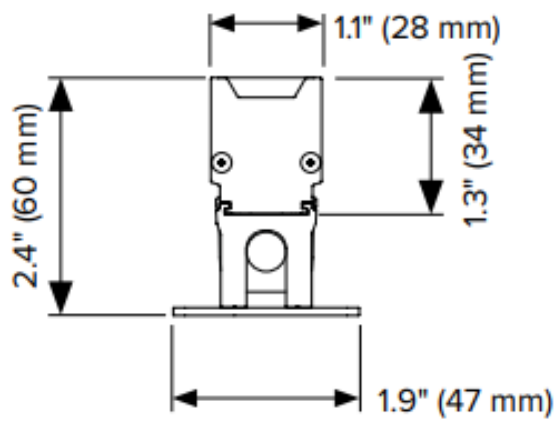

Fixed Bracket

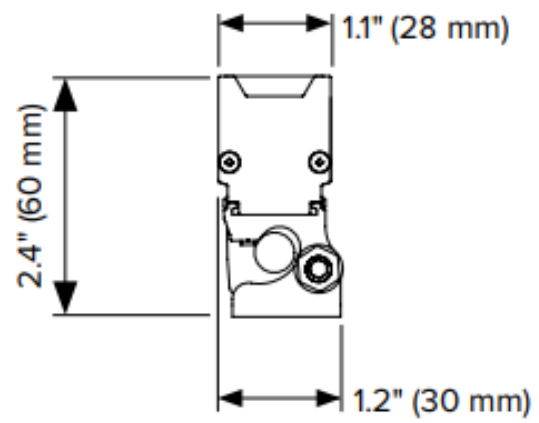

Adjustable Bracket

Luminaire Rotation

Adjustable Bracket

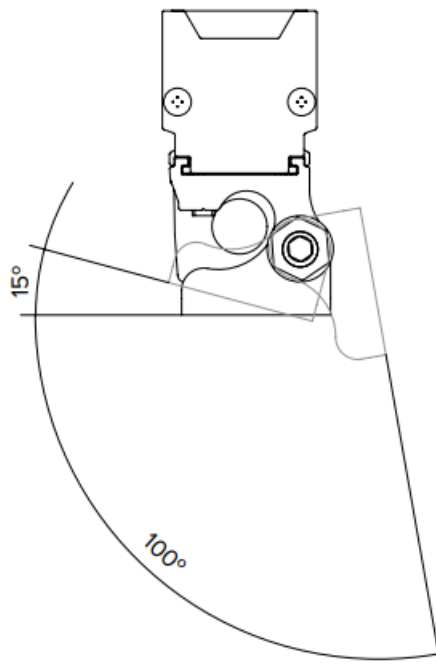

**Adjustable Bracket Installed
In Alternate Orientation**

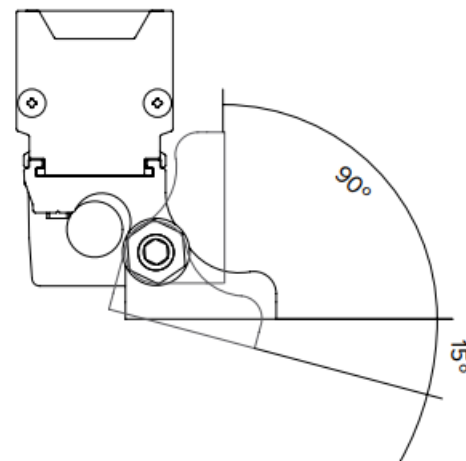

Mounting

Fixed Bracket

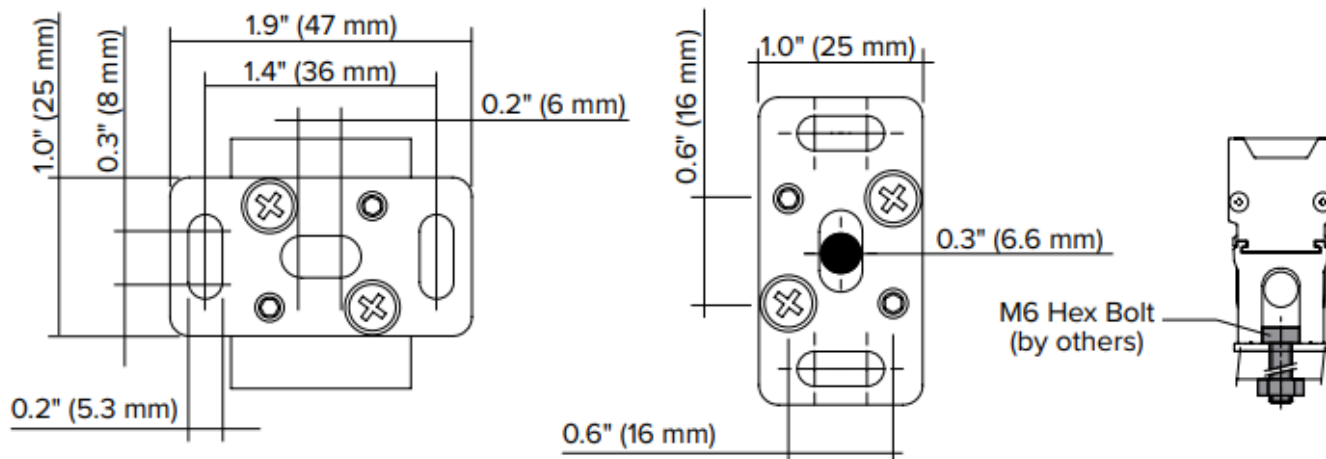

Adjustable Bracket

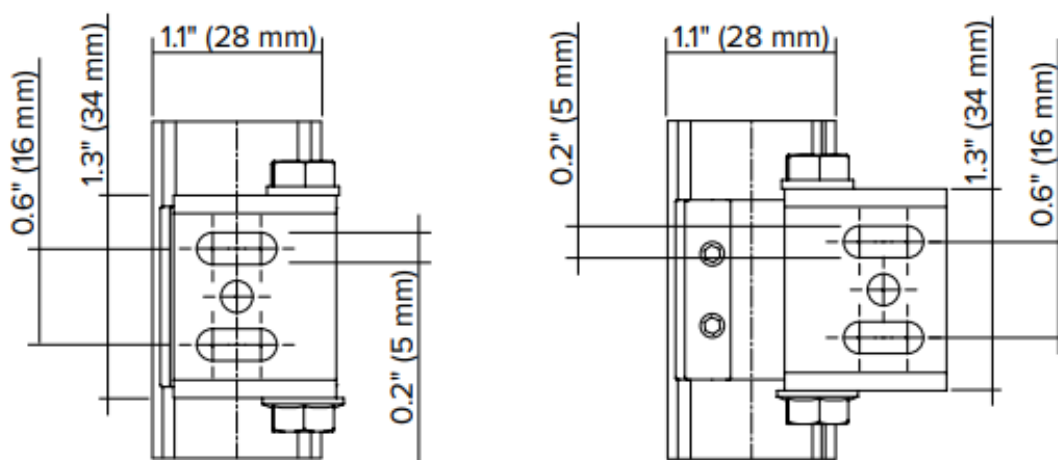

SPECIFICATION

- MODEL LS9010 GEN 2
- PART NUMBER LS9010 – xxD xxx 63 x x x xx xx xx xxx
- INSTALLATION TYPE LINEAR GRAZER
- IP RATING IP66/67 (Passes IP68 Test)
- SUPPLY VOLTAGE 30-48 Vdc
- INSTRUCTIONS COVER PowerSync™, Non-Dimmable
- DIMENSIONS (LxWxH) 47.5" x 1.7" x 2.4" (1,206 x 42 x 60 mm) for 4 ft section
- WEIGHT 3.5 lbs (1.6 kg) for 4 ft section
- MAX. PROJECTED AREA 0.5 ft² (0.4 m²) for 4 ft section

Find more product resources at lumascape.com.

Documents / Resources

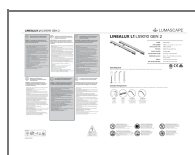

[LUMASCAPE LS9010 Complete Linear Solution](#) [pdf] Instruction Manual
LS9010, Complete Linear Solution, Linear Solution, Complete Solution, Solution

