

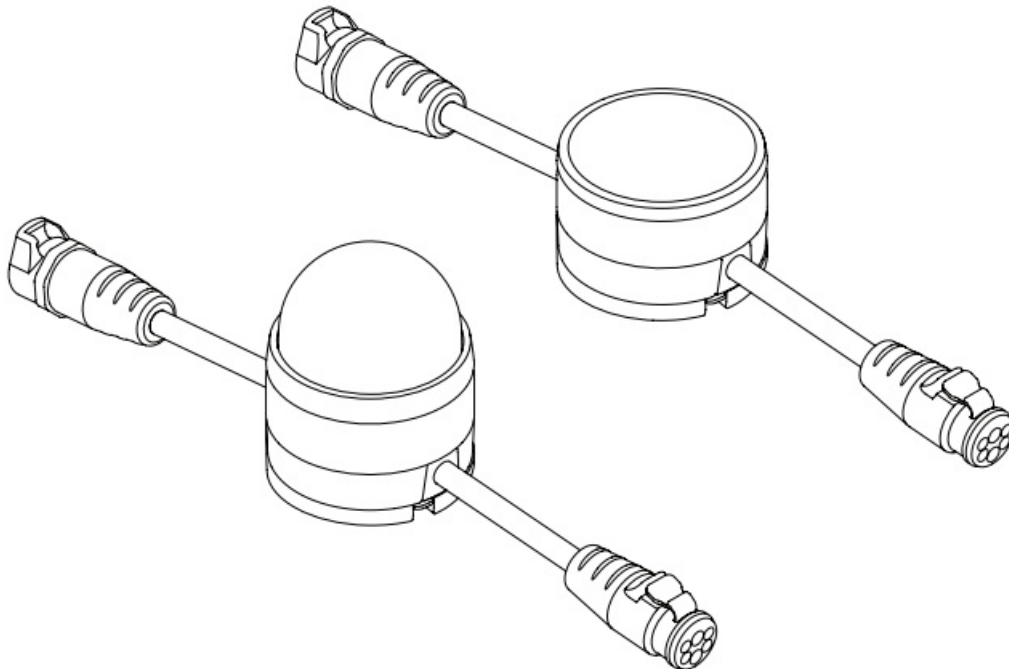

LUMASCAPE FAISCA F3 LS9230 Instruction Manual

[Home](#) » [LUMASCAPE](#) » LUMASCAPE FAISCA F3 LS9230 Instruction Manual 



Contents

- [1 FAISCA F3 LS9230](#)
- [2 Tools Required](#)
- [3 Included Components](#)
- [4 Assembly Instructions](#)
- [5 Wiring Designations](#)
- [6 Mounting](#)
- [7 Dimensions](#)
- [8 Documents / Resources](#)
- [9 Related Posts](#)

FAISCA F3 LS9230

MODEL	LS9230
PART NUMBER	LS9230 – xD xxx x xx xx xxx x xx xx xx xx
INSTALLATION TYPE	MARKER PIXEL
IP RATING	IP66/67 (Passes IP68 Test)
SUPPLY VOLTAGE	30-48 Vdc ~
INSTRUCTIONS COVER	PowerSync™, Non-Dimmable
DIMENSIONS (LxWxH)	Refer to included drawings
WEIGHT	1.1 lbs (0.5 kg) per node Cable not included



Tools Required

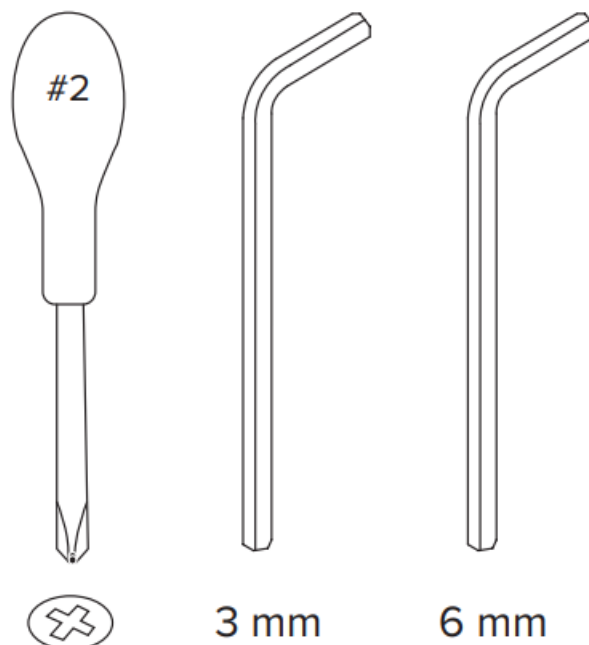

Included Components

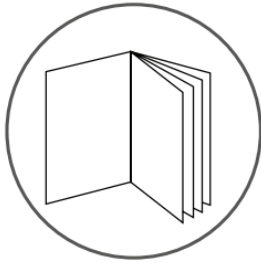

Instructions

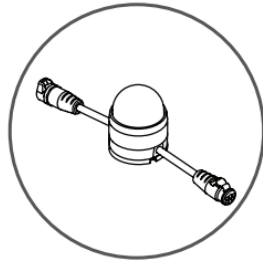



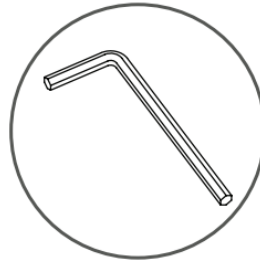

Luminaire

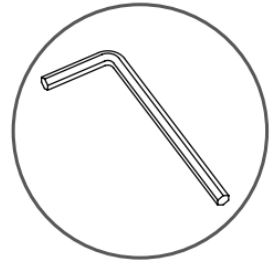

3 mm Allen Key



6 mm Allen Key

	Do Not Lift or Carry By the Cord
	Do Not Use Power Tools on Screws
	Keep Electronics Free From Dirt and Moisture
	Keep Away from Flammable Materials
	Do Not Hose or Pressure Clean
	Do Not Use Silicone On Outside Surface
	Do Not Cut Cable to the Luminaire



CAUTION Risk of Electric Shock

Please read and follow all safety instructions carefully.
Failure to do so will void warranty.

WARNING – Product Warranty is void if product is not installed as per installation instructions and in compliance with all local and provincial codes.

- › Ensure installation complies with local electrical rules and regulations.
- › All electrical work must be performed by a licensed electrician.
- › Class III product SELV (symbol 3).
- › For LED Options 2,700K, 3,000K, Red, Green, Blue, RGBA, RGBW, Tunable White: This product contains a light source of energy efficiency class G.
- › For LED Options 3,500K, 4,000K, 5,000K: This product contains a light source of energy efficiency class F.
- › All luminaires may become hot. Use discretion on where the luminaire is mounted. Take care when setting luminaire as it may become hot.
- › Luminaire should only be used complete with protective shield. If protective shield is cracked, immediately stop using luminaire. Isolate light source, keep it dry and immediately contact Lumascape for replacement of protective shield (symbol 10).
- › If the external flexible cable or cord of this luminaire is damaged, it shall be exclusively replaced by Lumascape or their service agent in order to avoid a hazard.
- › The light source contained in this luminaire shall only be replaced by Lumascape or their service agent.
- › To reduce the risk of strangulation the flexible wiring connected to this luminaire shall be effectively fixed to the wall if the wiring is within arm's reach.
- › Ensure mains input power is surge protected.
- › Never make or break connections while the circuit is energized.
- › Do not make modifications or alter the product.
- › Keep luminaire clean and free of debris.
- › Only clean with warm water.
- › Do not use chemicals or abrasives to clean luminaire as this may void the product warranty.
- › Connections are to be kept clean and dry at all times.
- › Suitable for use indoors or outdoors.

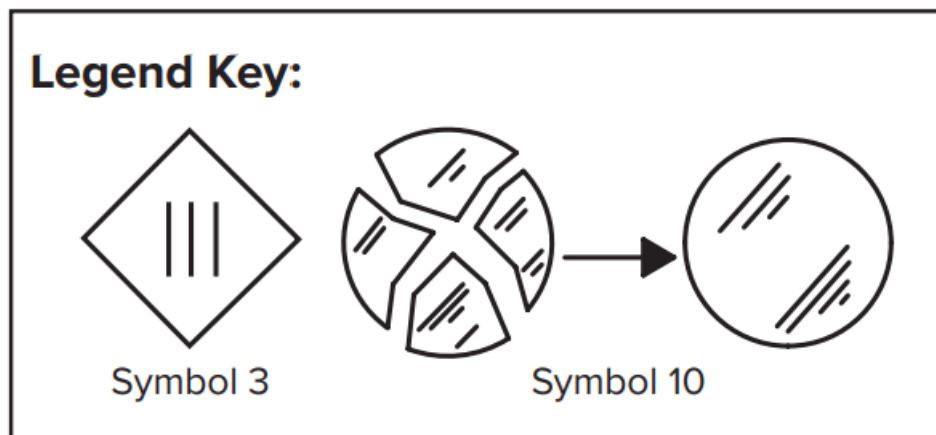

Assembly Instructions

ADJUSTABLE

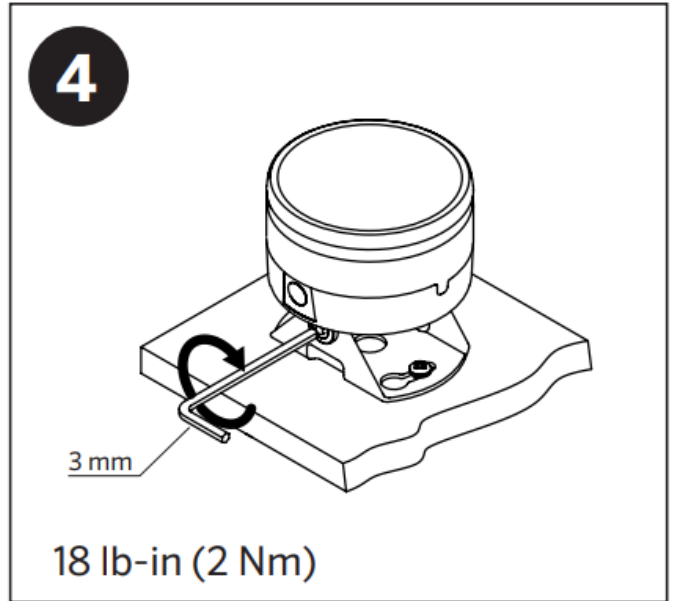
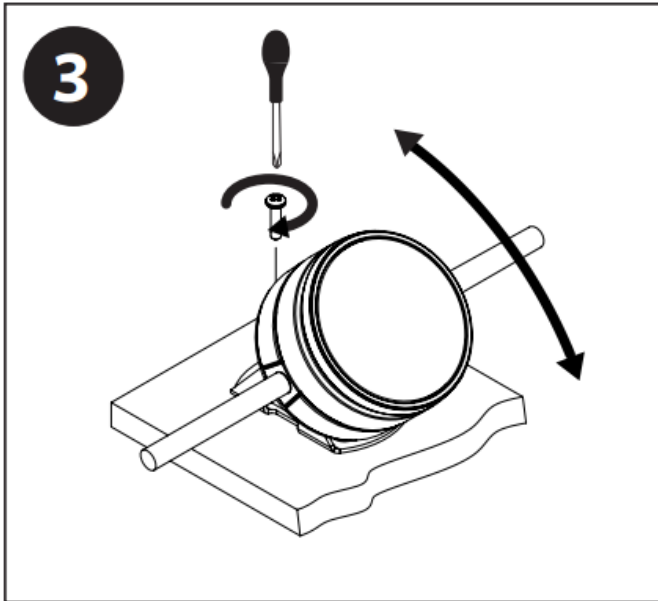
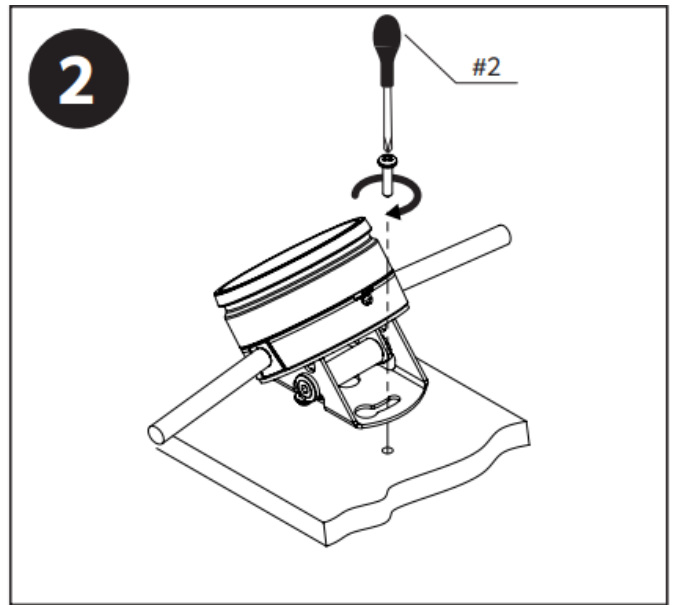
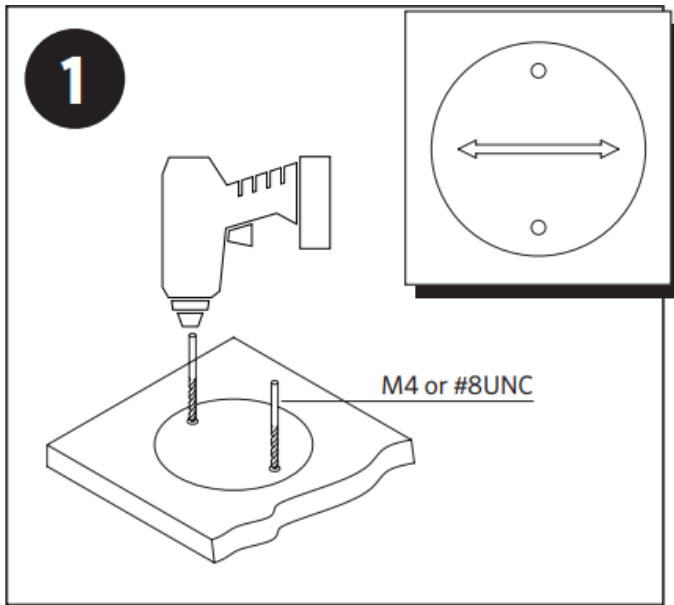

CATENARY

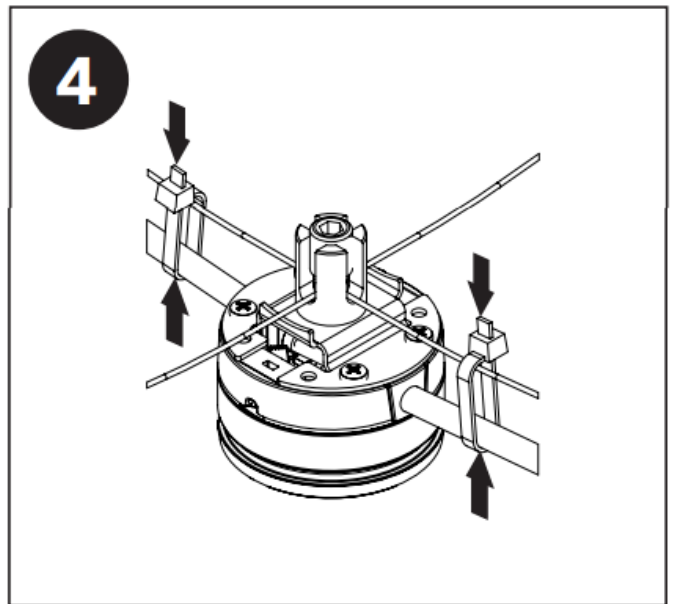
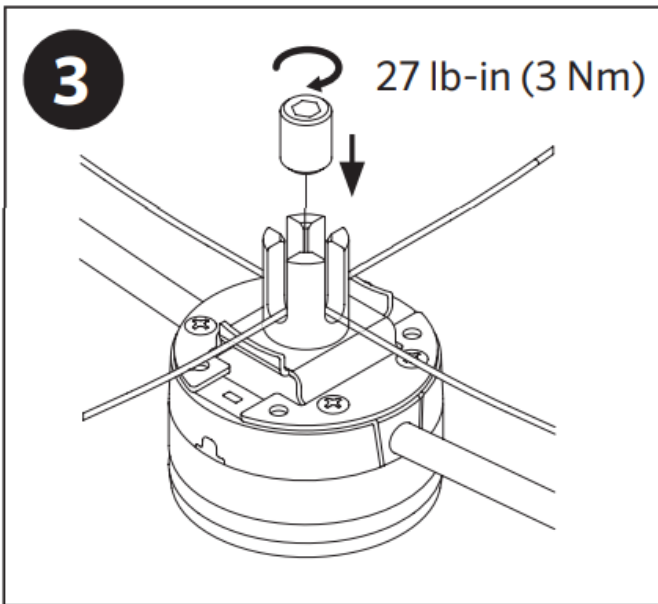
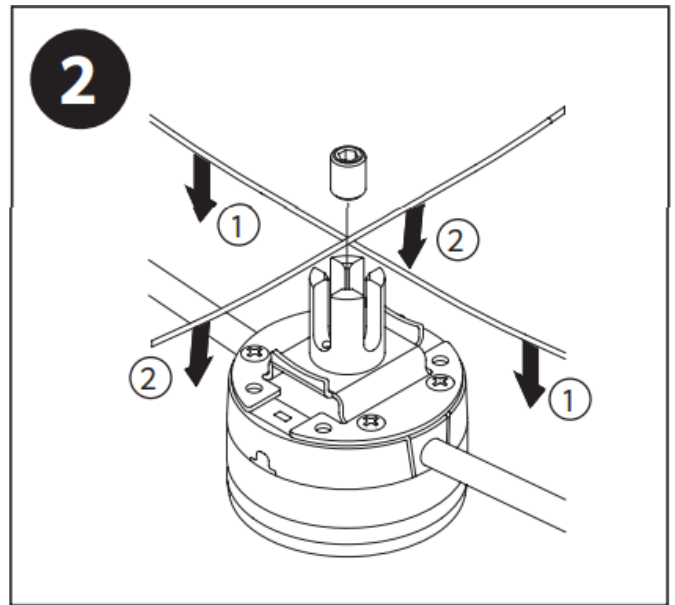
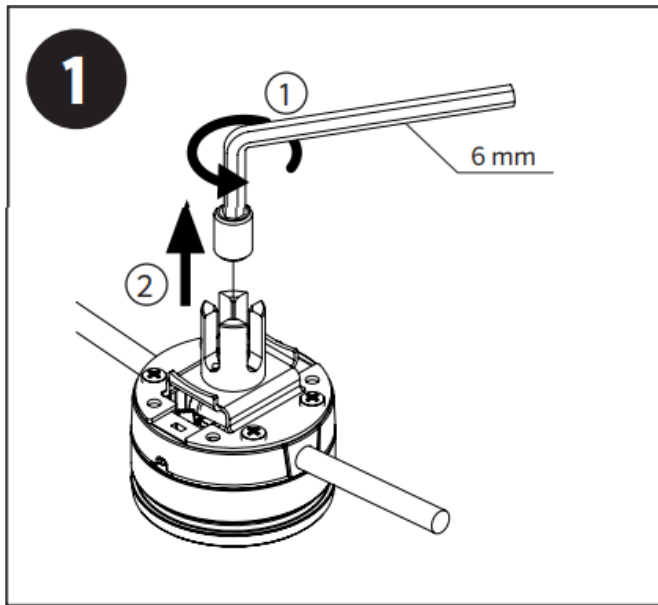

SURFACE

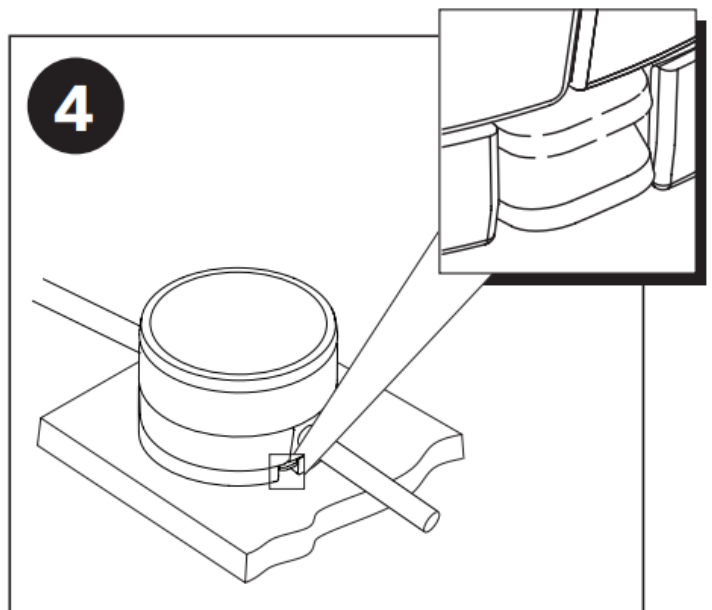
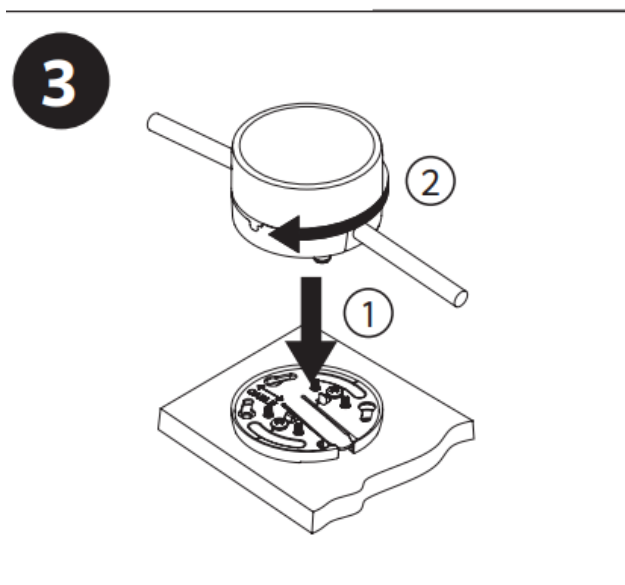
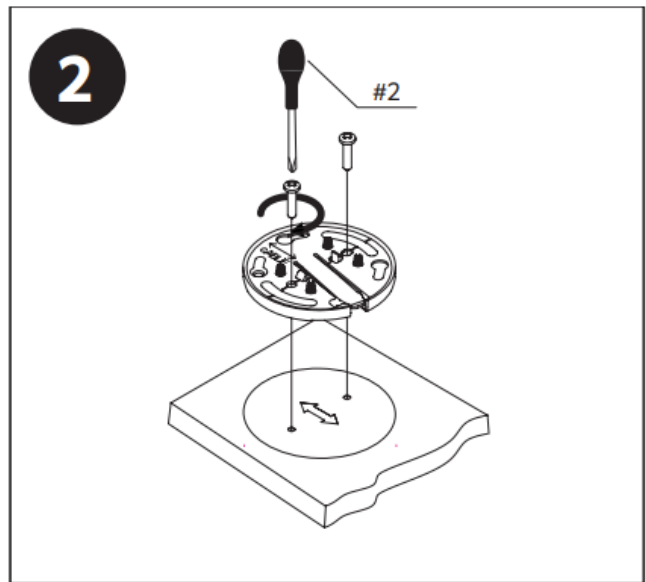
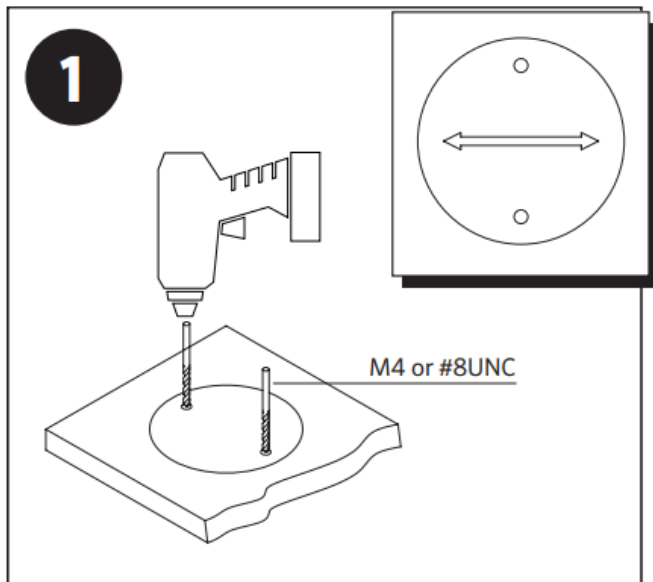

STRAP

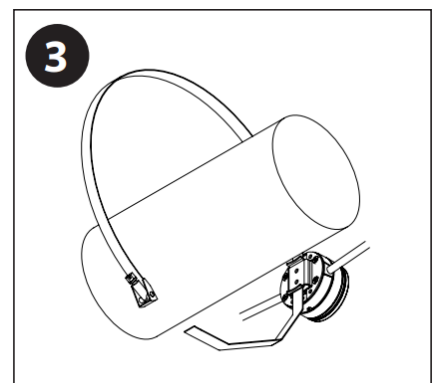
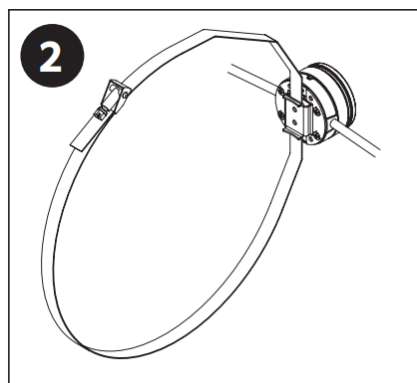
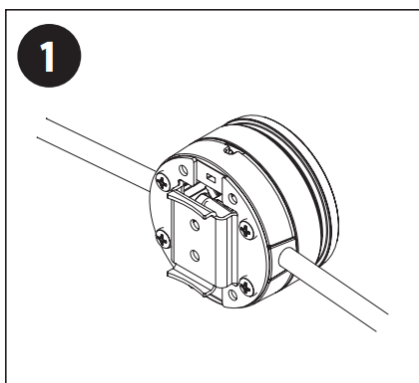

SCREW MOUNT

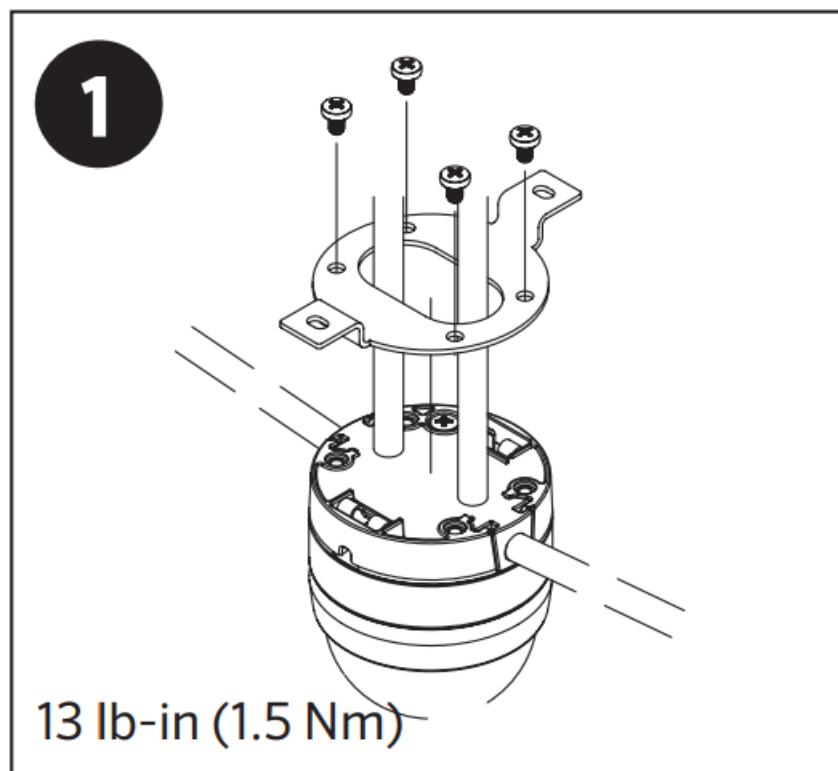

Suitable for use on custom brackets.

Wiring Designations

PowerSync (6-Core)

Designation	Color
Positive	Red
Negative	Black
Data +	Orange & White
Data –	Orange
Data GND	Green & White
Data GND	Green

Do not Hi-Pot test

Mounting

Montage

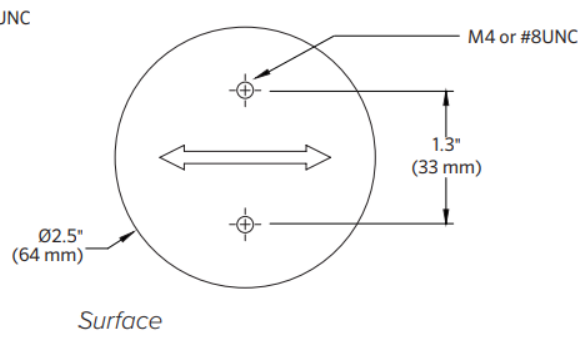
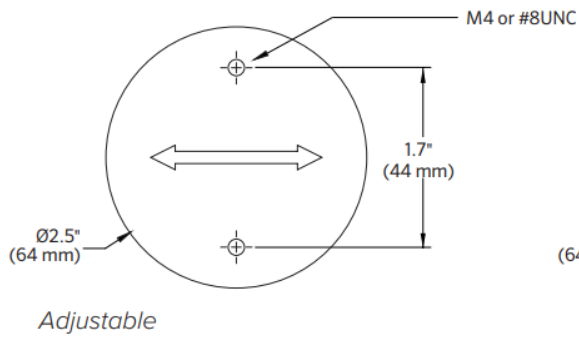

Dimensions

Type S: Surface Mount (Side Entry Only)	Type A: Adjustable Bracket (Side Entry Only)
<p>Front View</p> <p>Top View</p>	<p>Front View</p> <p>Side View</p> <p>Rotation</p>
Type C: Catenary Mount (Side Entry Only)	Type F: Strap Mount (Side Entry Only)
<p>Front View</p> <p>Catenary wire or cable ties not included</p>	<p>Front View</p> <p>Side View</p> <p>Strap not included</p>

Type D: Screw Mount (Side and Bottom Entry)

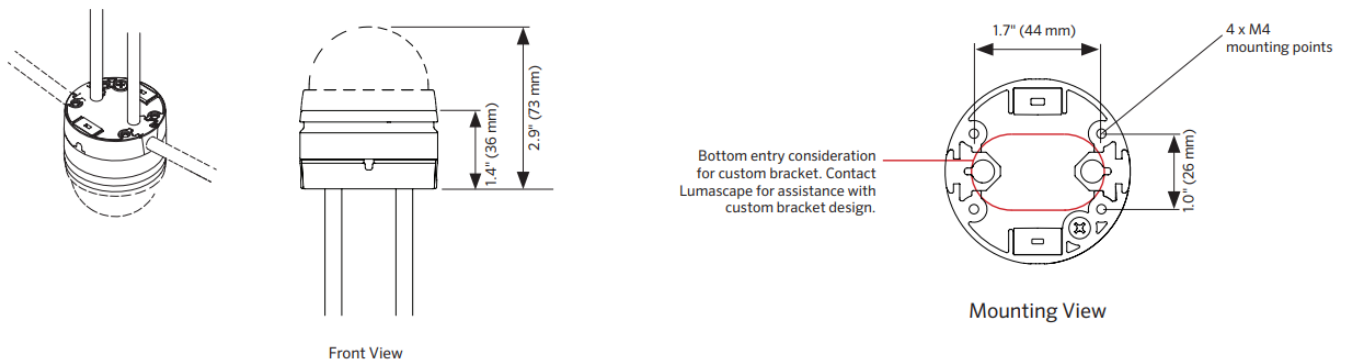

Note:

No mounting bracket is supplied.

4 x M4 screw points are provided for attaching to custom mounting plates and hardware.

Find more product resources at lumascope.com

Documents / Resources

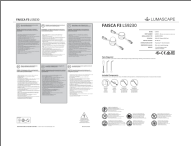
	<p>LUMASCAPE FAISCA F3 LS9230 [pdf] Instruction Manual LS9230, FAISCA F3 LS9230, FAISCA F3, FAISCA</p>
---	---