



LUMASCAPE dAria-6 Directional Luminaire Instruction Manual

[Home](#) » [LUMASCAPE](#) » LUMASCAPE dAria-6 Directional Luminaire Instruction Manual 



LUMASCAPE



DIRECTIONAL LUMINAIRES

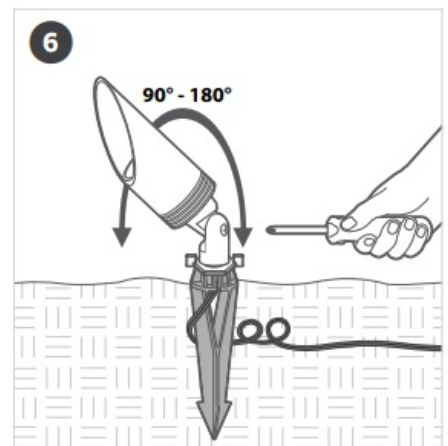
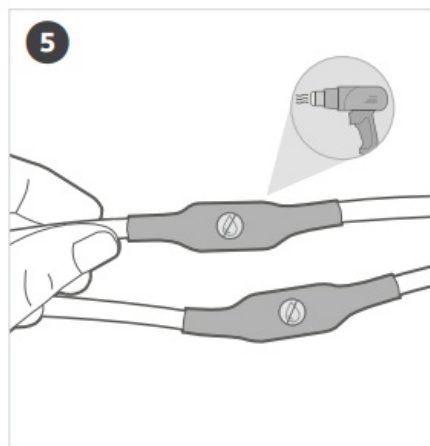
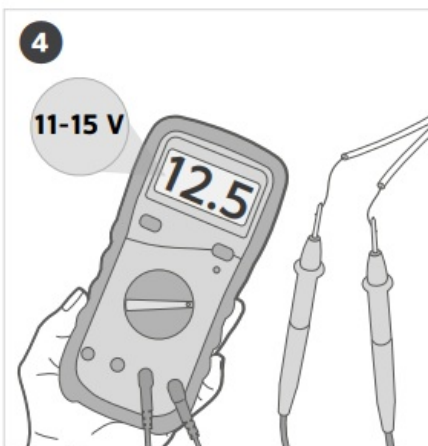
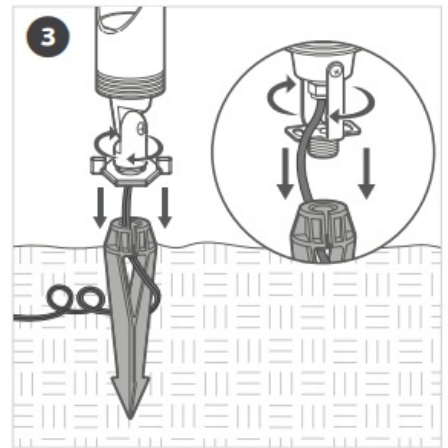
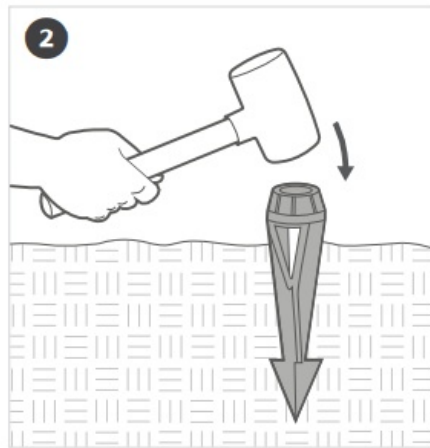
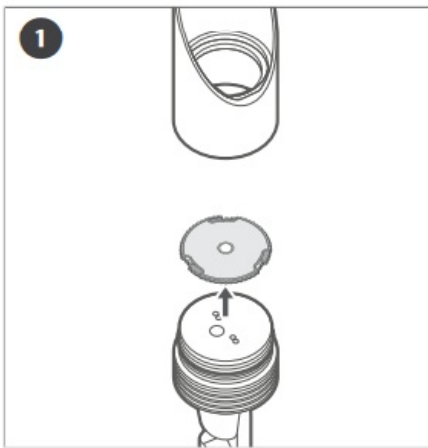

Contents

1 INSTALLATION

2 CIRCUITING GUIDELINES

3 TRANSFORMERS

4 Documents / Resources

5 Related Posts

INSTALLATION

1. Change beam angle lens by removing and replacing existing components (optional).
2. Pound stake into the ground.
3. Thread luminaire into the stake. Coil extra wire for future servicing.
4. Use a voltmeter to ensure 11 to 15 V at the luminaire.
5. Connect wiring with a waterproof connector.
6. Aim luminaire as desired.

CIRCUITING GUIDELINES

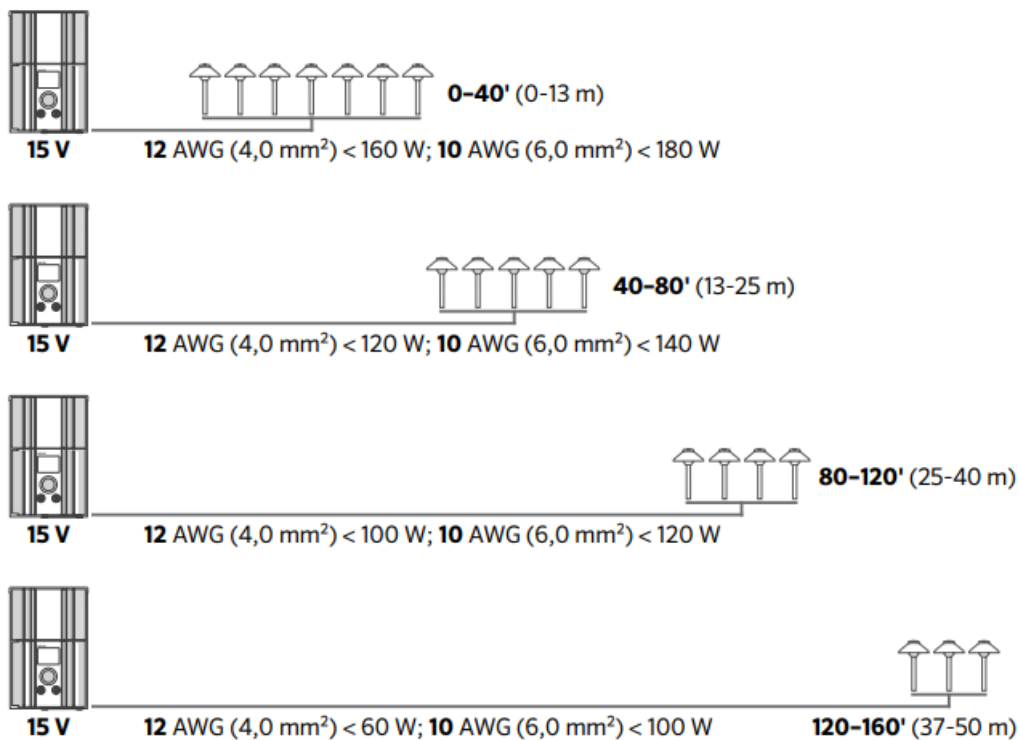

TRANSFORMERS

Single transformer: When using one transformer, center the transformer on the wattage load. Minimize all cable runs to reduce voltage drop.

Multiple transformers: When using multiple transformers, spread the load evenly across all transformers. Avoid voltage drops by installing the transformers as close to the luminaires as possible.

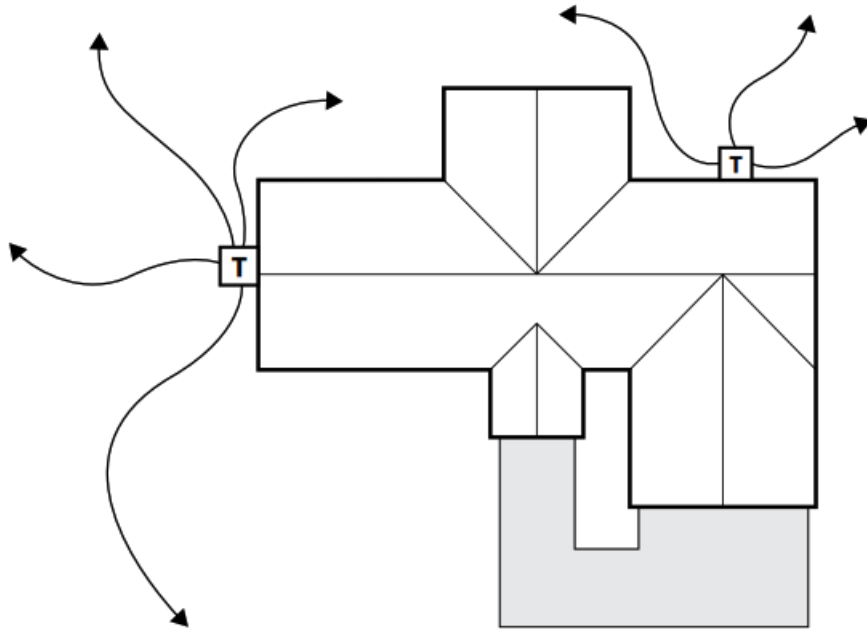

Please read and keep all safety and use instructions. If you have questions, contact your local agent or visit lumascape.com.

WARNING – To reduce the risk of FIRE OR INJURY TO PERSON:

- Turn off/unplug and allow to cool before replacing the lamp.
 - The lamp gets HOT quickly. Contact only switch/plug when turning on.
 - Do not touch the hot lens, guard, or enclosure.
 - Keep the lamp away from materials that may burn.
 - Do not touch the lamp at any time. Use a soft cloth.
- Oil from the skin may damage the lamp.
- Do not operate the luminaire fitting with a missing or damaged shield.

WARNING – Risk of Electric Shock

- Install all luminaires 5' (1.5 m) or more from a pool, spa, or fountain.
- A luminaire shall not use tungsten halogen lamps unless the luminaire is marked for such lamps.
- Supply connection and electrical components are located above ground level, except for the secondary cord that is suitable for wet locations.

LOW-VOLTAGE CABLE SHALL:

- Be protected by routing in close proximity to the luminaire or fitting, or next to a building structure such as a house or deck.
- Not be buried except for a maximum of 6" (152 mm) in order to connect to the main low-voltage cable.
- Have the length cut off so that it is connected to a connector within 6" (152 mm) from a building structure, a luminaire, or a fitting.

These products contain a light source of energy efficiency class G.



ARCHITECTURAL & FACADE LIGHTING |
Learn more. Visit lumascape.com

Documents / Resources



[LUMASCAPE dAria-6 Directional Luminaire](#) [pdf] Instruction Manual
dAria-6, Directional Luminaire, dAria-6 Directional Luminaire, Luminaire

[Manuals+](#).