

Lumary Smart Wi-Fi Speed Ceiling Fan Switch User Guide

[Home](#) » [Lumary](#) » Lumary Smart Wi-Fi Speed Ceiling Fan Switch User Guide 

Contents

- [1 Lumary Smart Wi-Fi Speed Ceiling Fan Switch](#)
- [2 What's in the Box](#)
- [3 Get Ready](#)
 - [3.1 Download the Lumary app](#)
 - [3.2 Register a Lumery account](#)
- [4 Install](#)
- [5 Reset and restart](#)
- [6 Connect: Easy Mode](#)
- [7 CONNECT: AUTO SCAN](#)
- [8 Connect: AP Mode](#)
- [9 Documents / Resources](#)
- [10 Related Posts](#)



Lumary Smart Wi-Fi Speed Ceiling Fan Switch



What's in the Box

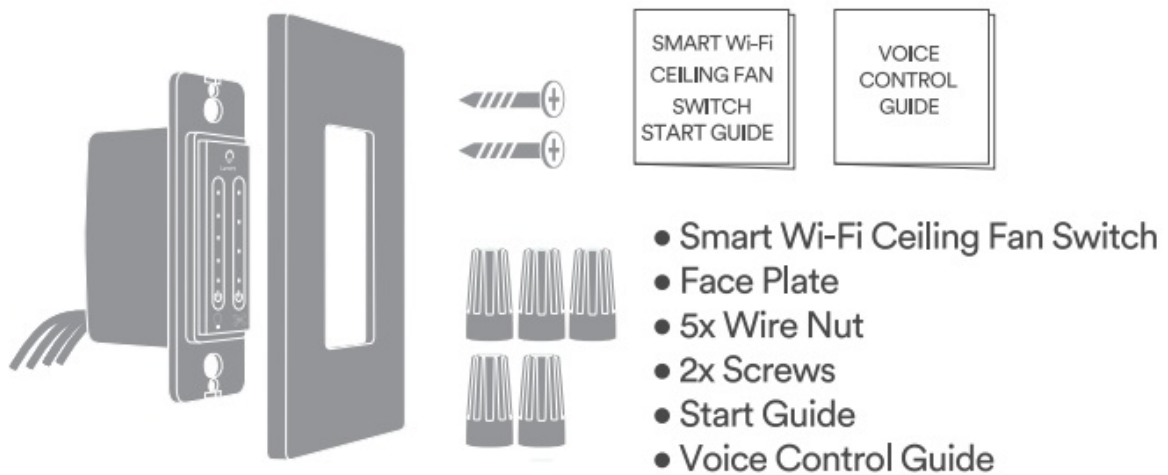

Get Ready

- Turn OFF power supply at the circuit breaker or fuse. Use a noncontact voltage tester to ensure that is off. More than one disconnect switch may be needed to turn off power.
- Confirm that you are replacing a single pole (single switch), one-way switch (not a 3-way switch where two switches control one fixture).
- Make sure the existing switch box has a neutral wire.

Download the Lumery app



Register a Lumery account

STEP 1
Enter your mobile phone number
or email address.

STEP 2
Enter the verification code
and create a password.

STEP1: Enter your mobile phone number or email address.

STEP2: Enter the verification code and create a password.

STEP 3
Log into the app.

Install

Step 1:

Shut off power at the circuit breaker for the switch that you are replacing. More than one disconnection maybe required to turn off power. Use a noncontact voltage tester to ensure that power is off.

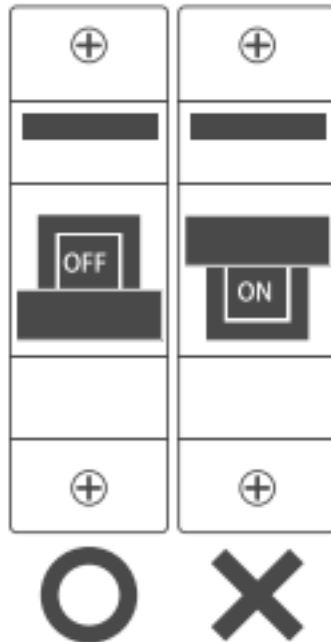

Step 2:

Make sure the existing switch box has a neutral wire. Remove old switch by disconnecting all the wires. Neutral wire is typically white.

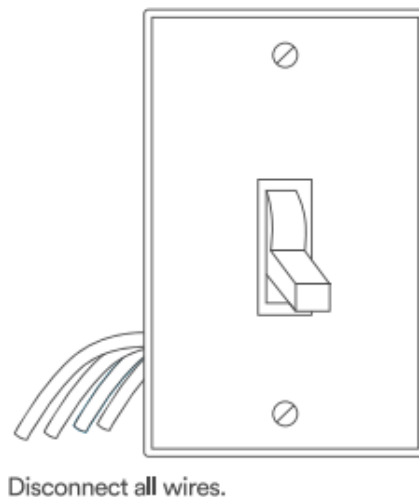

STEP 3:

Connect Switch's neutral wire (White) to your home's neutral wire. Connect Switch's five wire (Black) to your home's hot wire. Connect Switch's Light wire (Brown) to the wire that controls the light. Connect Switch's Fan wire (Blue) to the wire that controls the fan. Connecting the Switch's ground wire (Green) to your home's ground wire is optional. Check that all wire nuts are secured. Mark all wires with included stickers for next reference.

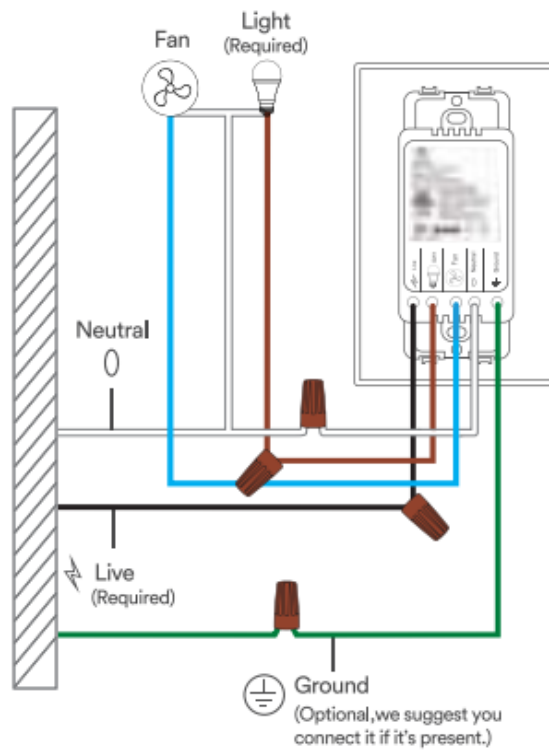

Step 4:

Use screws to secure TAP into your wall. Snap on the included faceplate.

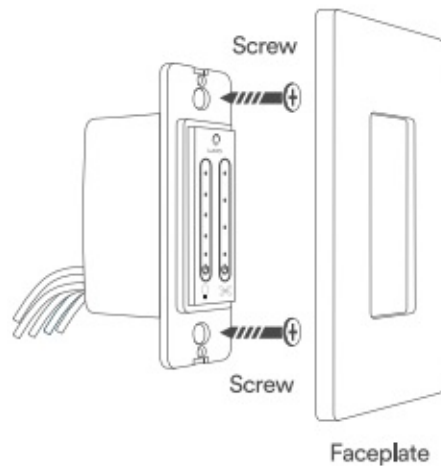

Step 5:

Restore power by reversing step 1.

Step 6:

Once power is connected, the white indicator light will blink to indicate that TAP is ready to connect to Wi-Fi. (Please make sure both light and fan are in OFF status)

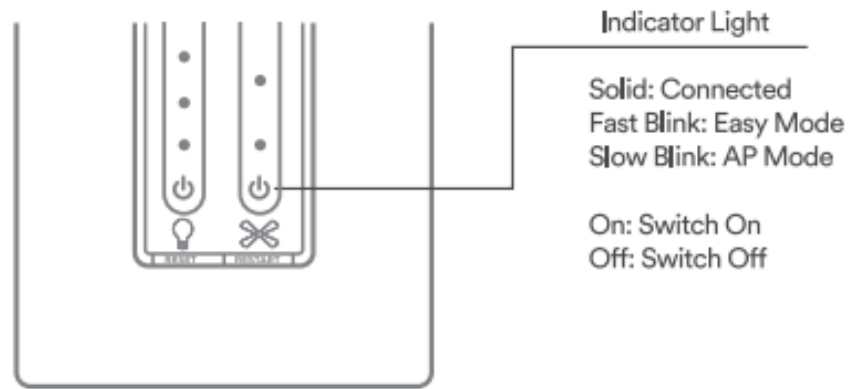

Reset and restart

QUICKTIP: On the switch faceplate, the reset button as the power reset button and the start button is also known as the Wi-Fi reset button.

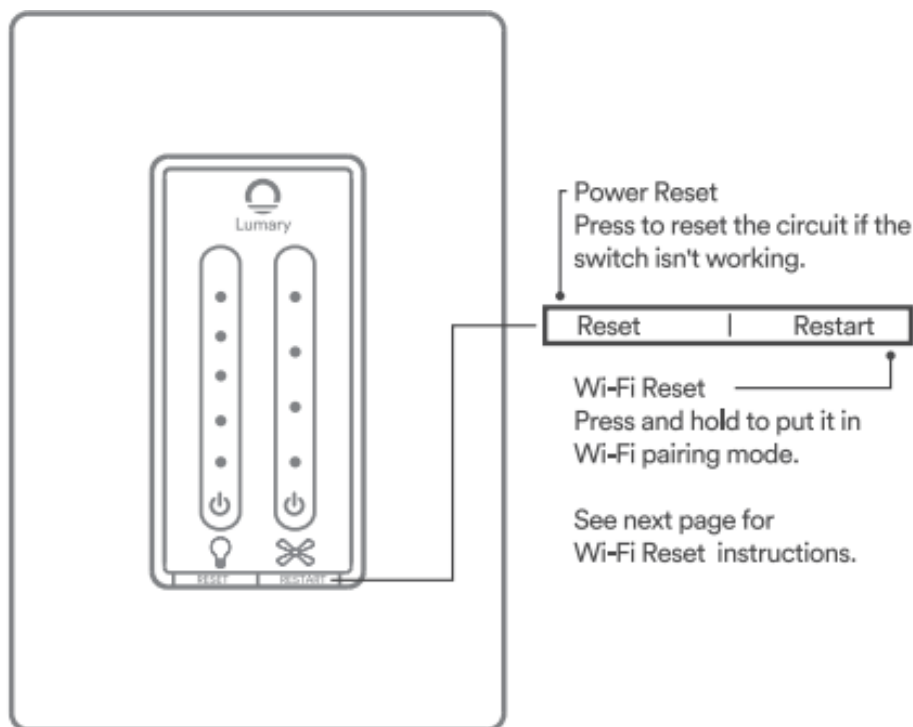

How do I reset TAP and What does the blinking light means?

Reset TAP by pressing and holding the Wi-Fi reset (restart) button for 3 seconds until the indicator begins to rapidly flash. The Wi-Fi reset button is located on the bottom right side of the switch(not the switch plate) labeled "restart"

- Reset one time (press and hold) to reach Easy mode.
- Reset again to reach AP mode

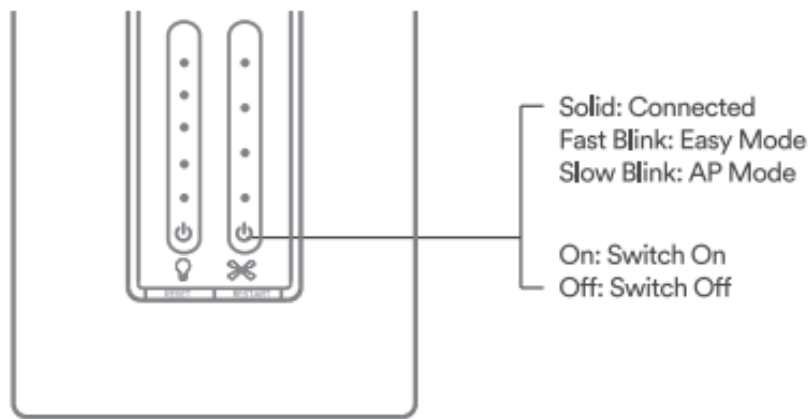

Connect: Easy Mode

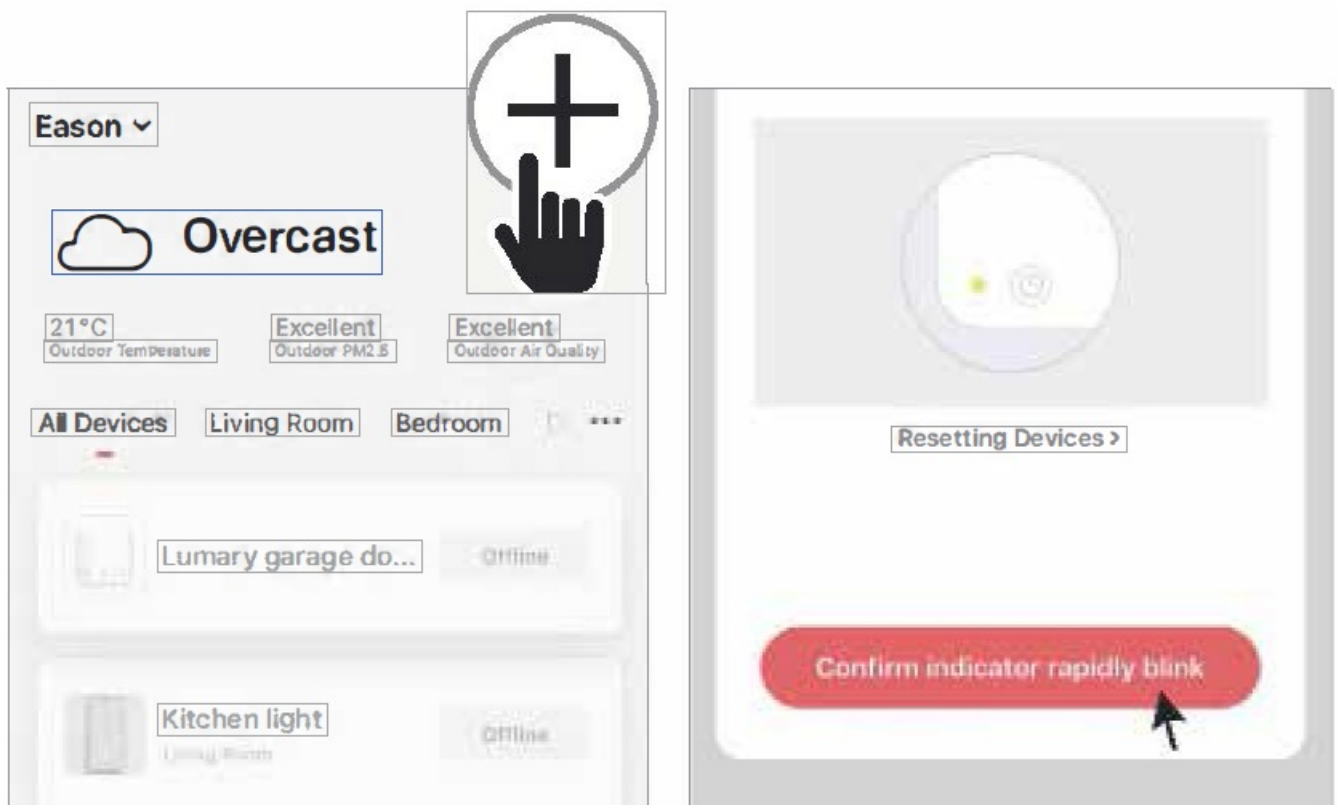

STEP 1:

Open the Lumary app. In the top corner of the Devices screen, click(+). Choose “Electricien-SWitch(Wi-Fi)”, if connection fail, please try “Lighting-Lighting(Wi-Fi)”.

STEP 2:

Make sure Switch’s light is rapidly flashing white. If not, reset to reach Easy Mode to connect (Page 9). Press “Confirm indicator rapidly blink” in the app.

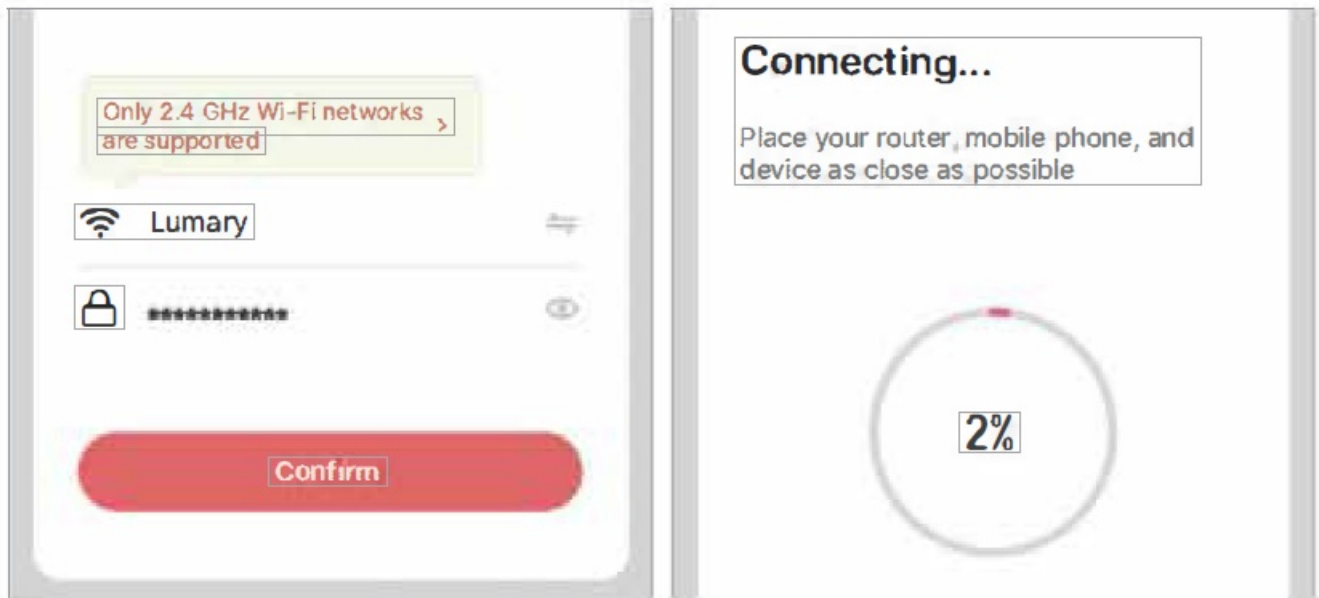

STEP 3:

Enter your Wi-Fi network and password.

STEP 4:

The Lumary app will connect to your switch.

NOTE: Lumary can connect to 5GHz networks. If the connection fails, try to connect using AP Mode.

CONNECT: AUTO SCAN

Step 1:

Connect your smart phone to a 2.4GHz Wi-fi, Open the Lumary app, in the top right corner of screen, click (+). Choose Auto-Scan.

Step 2:

Power on the smart garage opener, press and hold the reset button for 5 seconds until it is rapidly flashing white.

Step 3:

Click start scan, the app will search for device automatically. Wait 5-20 Seconds until the device appears on the screen. Click Next, customize the device name as needed, then click done to complete connection.

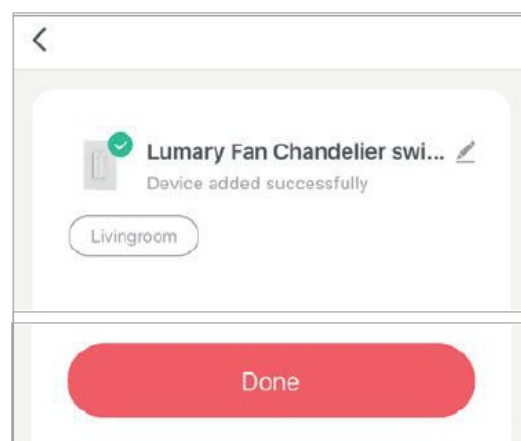
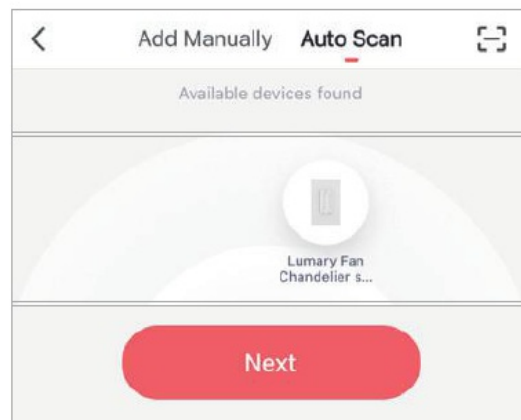
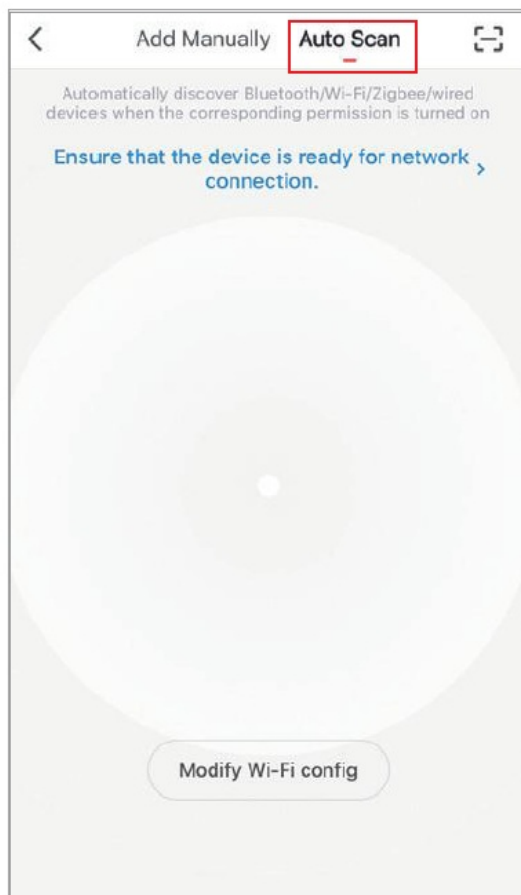

Connect: AP Mode

Step 1:

Press and hold the restart button for 5 seconds until indicator light is rapidly flashing. then press and hold the restart button for another 5 seconds until indicator light is slowly flashing.

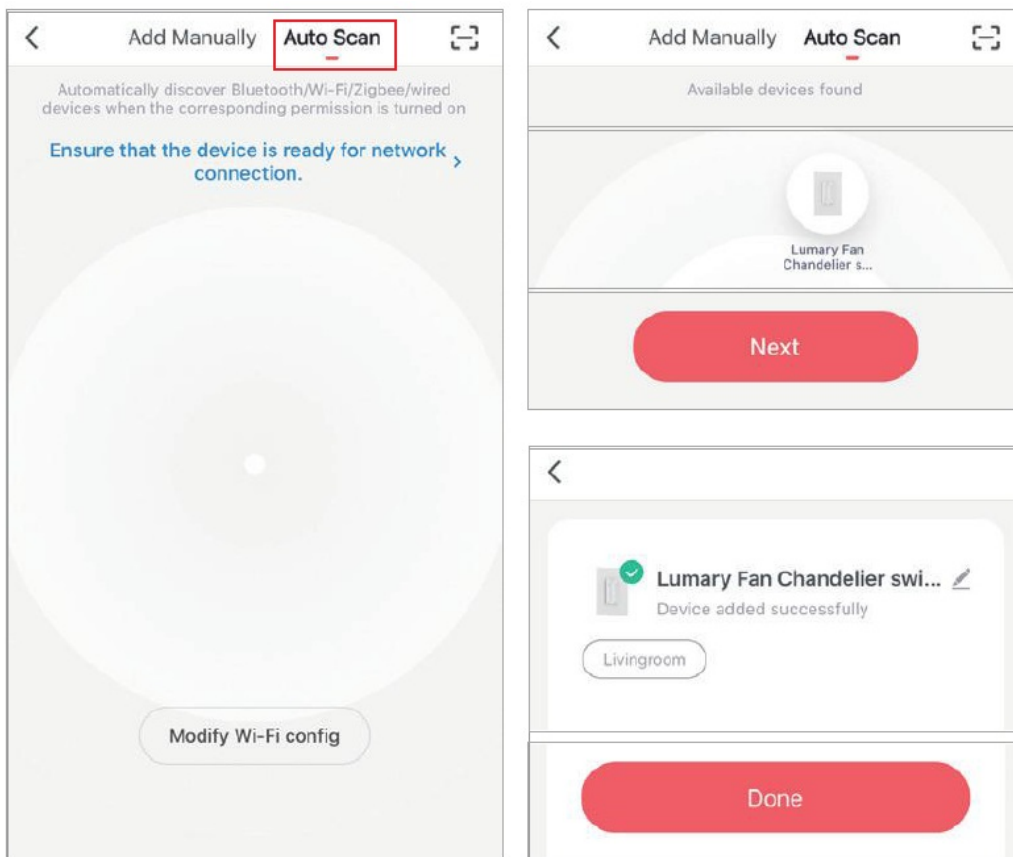

Step 2:

Open the Lumary app. In the top corner of the Devices screen, click (+). Choose “Electrician-Switch(Wi-fi)”. Choose “AP Mode” in the “Other Mode”.

Step-3:

Enter the Wi-Fi name and password, then Confirm.

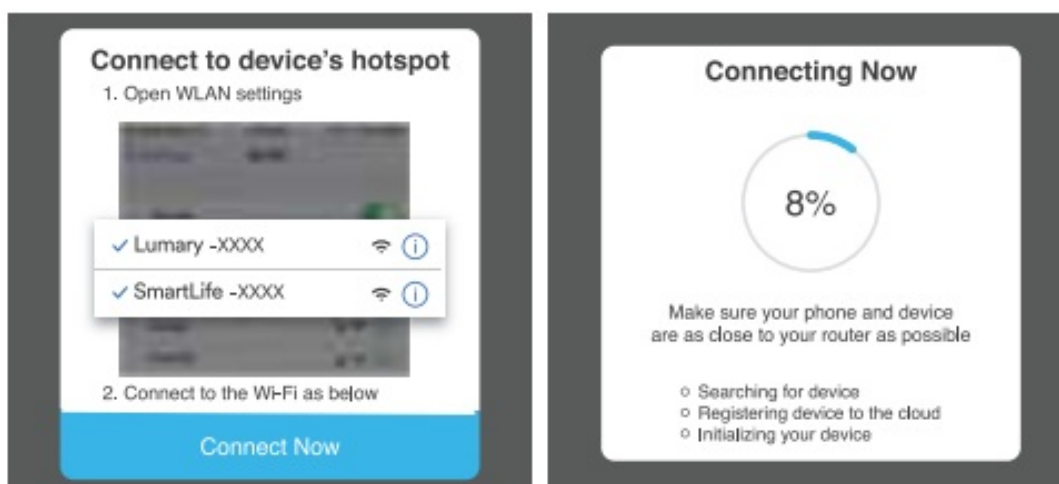

Step 4:

Follow the instruction to choose the device from your Wi-Fi list.

Step 5:

The Lumary App will connect to your garage door opener.

Note: Lumary can't Connect to 5GHz networks.



Documents / Resources

	Lumary Smart Wi-Fi Speed Ceiling Fan Switch [pdf] User Guide Smart Wi-Fi Speed Ceiling Fan Switch
--	--

[Manuals+](#).