



Lucci fresco 240190 Alert LED Sensor in Silver Instruction Manual

[Home](#) » [Lucci fresco](#) » Lucci fresco 240190 Alert LED Sensor in Silver Instruction Manual 



Alert

SKU # 240190, 240191, 240192

Rated Voltage 220-240V~ 50Hz

Thank you for purchasing this quality Lucci product. To ensure correct function and safety, please read and follow all instructions carefully before using the product. Please keep instructions for future reference.

Contents

- [1 Warranty](#)
- [2 Installation requirements](#)
- [3 Installation directions](#)
- [4 Specifications](#)
- [5 Documents / Resources](#)
- [6 Related Posts](#)

Warranty

- The sensor is covered by a 12 month warranty. Please retain proof of purchase and evidence of installation by a licensed electrician.
- Warranty will be void if there is any damage due to improper usage or modification to the sensor. There are no user serviceable parts inside the sensor.
- The sensor is not suitable for use with dimmer switches. Warranty will be void if the sensor is used on the same

circuit which has a dimmer switch.

Installation requirements

- Must be installed by a licensed electrician.
- All wiring and installation of the light fitting must adhere to local and national wiring rules.eg. AS/NZS 3000:2007/Amendment 2:2012 Electrical installations.
- Do not exceed the maximum rated loading.
- Consider the following points when positioning the sensor and select a suitable location for installation;
 - The sensor is rated IP44 and is suitable for indoor or outdoor use.
 - The sensor is not suitable for use with dimmer switches and should not be used with a circuit which has a dimmerswitch.
 - The mounting point must support 2 times the weight of the sensor.
 - The sensor is designed for optimum performance when mounted 2.5 meters above ground level.
 - The sensor is most sensitive to movement across the detection area as opposed to directly towards or away from the sensor. Position the sensor to point across the area of detection.
 - Avoid positioning close to trees or shrubs which may cause false triggering during wet or windy weather.
 - Avoid pointing at or positioning close to heat sources such as flues or heat extraction units, which may cause false triggering.
 - Avoid mounting near any strong electromagnetic fields, as it may cause false triggering.
 - Avoid pointing at bright lights as the sensor will not function when you set Lux control level to dark (position).
- This fitting is not suitable for use with dimmer switches and must not be used with a circuit that has a dimmer switch.
- Take care not to pull any electrical wires during unpacking as this may damage the connection.
- Lay out all the components on a smooth surface and make sure there are no components missing before assembling. If parts are missing, return the complete product to the place of purchase for inspection or replacement.
- Check whether the fitting has been damaged during transport. Do not operate/install any product which appears damaged in any way. Return the complete product to the place of purchase for inspection, repair or replacement.
- Ensure power to the circuit you are working on has been switched OFF before commencing any electrical work.

Installation directions

1. Remove all packaging material from the product.
2. Remove the back plate from the sensor by loosening the screw on the bottom and use a small flat head screw driver to loosen the clip at the top (figure A).
3. The back plate has a drain hole and cable hole which can be punched out if required. (figure B)
If the cable hole has been punched out, the drain hole must also be opened.
4. Use the back plate as a template to mark the screw positions on the wall.
5. Install the back plate onto the wall by using appropriately sized mounting screws and anchors.
Ensure the screws and anchors used are suitable for the mounting surface. (figure C and D)
6. Connect the mains supply wire and load/lamp wire to the terminal block. Ensure the wires pass through the

rubber gasket. Ensure the wires are secure and no bare wires are exposed. (figure E)

7. Install the sensor back onto the back plate and re-fit the screw to secure.
8. After finishing the installation, adjust the detection area, lux and time duration settings.

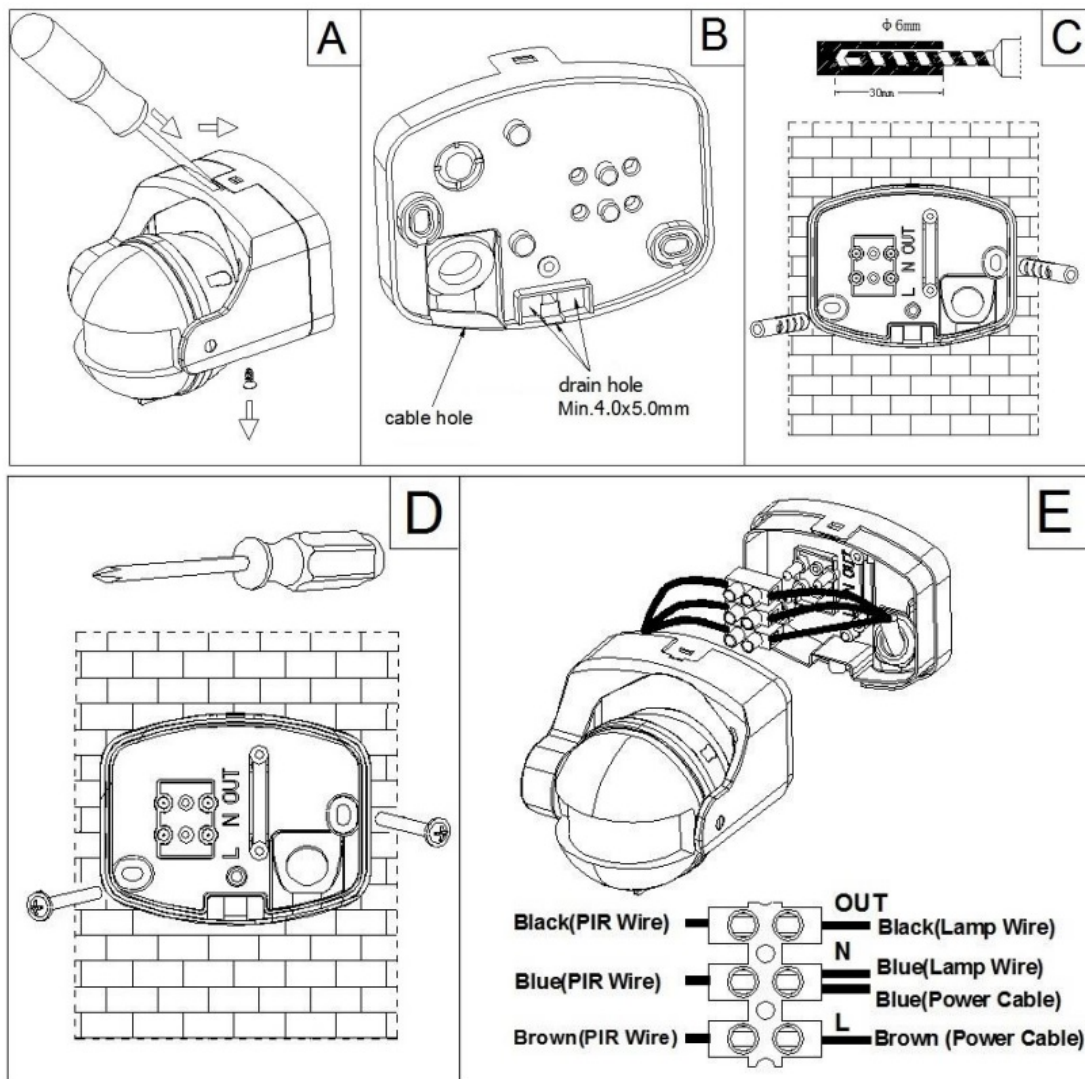

Once the fitting is fully installed, the indoor wall switch (not included) will control the sensor. Turning the indoor wall switch OFF will turn the sensor completely off. When turning the indoor wall switch ON, the sensor will be in "AUTO MODE".

Leave the wall switch ON for continued normal operation. The sensor will switch the lights on and off automatically.

DETECION AREA – WALKING TEST

1. When power is switched on, the sensor will enter into a "WARM UP" period for approximately 1 minute and then automatically change into "AUTO MODE".
2. After it has entered into the "AUTO MODE", you can then carry out a walking test by adjusting the LUX knob to the day position (*) and the TIME knob to minimum (-).
3. Once the sensor receives a valid trigger signal (such as movement of a human body) within the detection area, the lamps will be turned on for the pre-set period of time. You will be able to determine and adjust the detection area by walking slowly.

After completing the walking test, set the LUX knob to the night position to ensure the sensor only

operates at night and set TIME knob to the desired duration time.

ADJUSTING THE LUX CONTROL LEVEL:

The lux control module has a built-in sensor that detects daylight and darkness.

(*) position denotes that the lamp will be turned on by the sensor during day and night.

(D) position denotes that the lamp will be turned on by the sensor only at night.

You can set to operate the unit at the desired level by adjusting the LUX knob.

ADJUSTING THE DURATION TIME:

The duration time is the length of time that the sensor will keep the lamps 'on' after activation. The duration time can be adjusted from (10±5) seconds to (4±1) minutes. Rotating the TIME knob from (+) to (-) will reduce the duration time.

NOTE: Once the lamps have been triggered by the sensor any subsequent detection will start the timed period again from the beginning.

MANUAL CONTROL – OVERRIDE FUNCTION

1. When power is switched on, the sensor will enter into a "WARM UP" period for approximately 1 minute and then automatically change into "AUTO MODE".

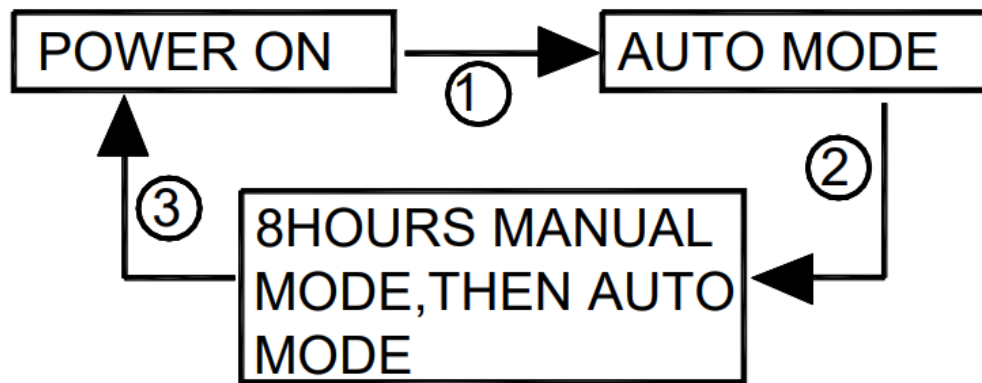

2. During AUTO MODE to switch into MANUAL MODE, turn the wall switch off and on twice within three seconds. In MANUAL MODE, the Lamps will remain ON, not affected by duration time and Lux control.
3. After 8 hours in MANUAL MODE, the sensor will automatically change into AUTO MODE.

NOTE: During MANUAL MODE or AUTO MODE, by switching off the main switch for over 15 seconds and then on again, the sensor will reset to WARM UP period and then AUTO MODE.

WARM UP period may be less than 1 minute in some instances.

Safety tips

- Always ensure the power is OFF before performing any maintenance or cleaning to the sensor.
- To avoid injury or damage to the fitting, ensure that power leads and screws are secure before connecting the power.
- Select a suitable location away from liquids and hazards.
- Ensure that the sensor does not come in contact with corrosive chemicals, etc.
- To clean, wipe with a damp clean cloth. Never soak the sensor with water.

Specifications

SKU #	240190	240191	240192
Model #	LD-AL173-1/SL	LD-AL173-1/BK	LD-AL173-1/VVH
Rated Voltage	220-240V— 50Hz		
Rated Loading	Incandescent:1000W Fluorescent:300W LED:150W		
IP Rating	IP44		
Detection Area	Angle:180° Range:12m (approximately)		
Duration Time	10±5 seconds to 4±1 minutes		
Weight	0.2kg		
Dimensions	W:85mm H:85mm E:95mm		

Documents / Resources

	<p>Lucci fresco 240190 Alert LED Sensor in Silver [pdf] Instruction Manual 240190, 240191, Alert LED Sensor in Silver, Sensor in Silver, Alert LED Sensor, LED Sensor, S ensor</p>
--	--