



LTECH WiFi-104 LED CONTROLLER User Manual

[Home](#) » [LTECH](#) » LTECH WiFi-104 LED CONTROLLER User Manual 



WiFi-104 LED CONTROLLER User Manual



iOS



Andriod



WiFi-104 is a WiFi lighting control system, consisting of APPs and Wi-Fi controllers. Controls various types of LED lighting products by installing the related App on our iOS or Android mobile devices which support WiFi connection.

With DIM, CT adjustment, RGB, and RGBW changing 4 in 1 operation, plus 12 zones control function, you can connect directly or by a router.

Contents

- [1 Product Parameter:](#)
- [2 Configuration Diagram:](#)
- [3 Controller Operating Instructions:](#)
- [4 The Instructions of APP Software:](#)
- [5 WiFi Network SSID Name and Password Setting](#)
- [6 Remote Operating Instructions](#)
- [7 Wiring Diagram](#)
- [8 Documents / Resources](#)
 - [8.1 References](#)
- [9 Related Posts](#)

Product Parameter:

WiFi-104 Technical Parameters:	
Communication	2.4GHz WiFi, 802.11b/g/n
Standard:	Protocol
Input Voltage:	12~24Vdc
Output Current:	4A×4CH Max 16A
Max Output Power:	(0~48W...96W)×4CH Max. 384W
Control Distance:	Max 100m
Output Control:	Dimming, CT, RGB, RGBW
Operating Temp.:	-30°C~55°C
Dimensions:	L128×W73×H45(mm)
Package Size:	L135×W80×H64(mm)
Weight (G.W.):	390g

Software Technical Parameters:	
Platform:	Android 4.0 or above, iOS 8.0 or above
Language:	English
Category:	Appliance

R4-5A Constant Voltage Zone Receiver	
Wireless Frequency:	2.4GHz
Input Voltage:	5-24Vdc
Max Current Load:	5A×4CH Max 20A
Max Output Power:	(0~25W...120W)×4CH Max. 480W
Working Temp.:	-30°C~55°C
Dimensions:	L175×W44×H30(mm)
Package Size:	L178×W48×H33(mm)
Weight (G.W.):	150g

R4-CC Constant Current Zone Receiver	
Wireless Frequency:	2.4GHz
Input Voltage:	12-48Vdc
Output Voltage:	3-46Vdc
Output Current:	CC 350/700/1050mA×4CH
Output Power:	(1.05W~48.3W)×4CH Max. 193.2W
Working Temp.:	-30°C~55°C
Dimension:	L175×W44×H30(mm)
Package Size:	L178×W48×H33(mm)
Weight (G.W.):	165g

Note: Receiver is sold separately

Configuration Diagram:

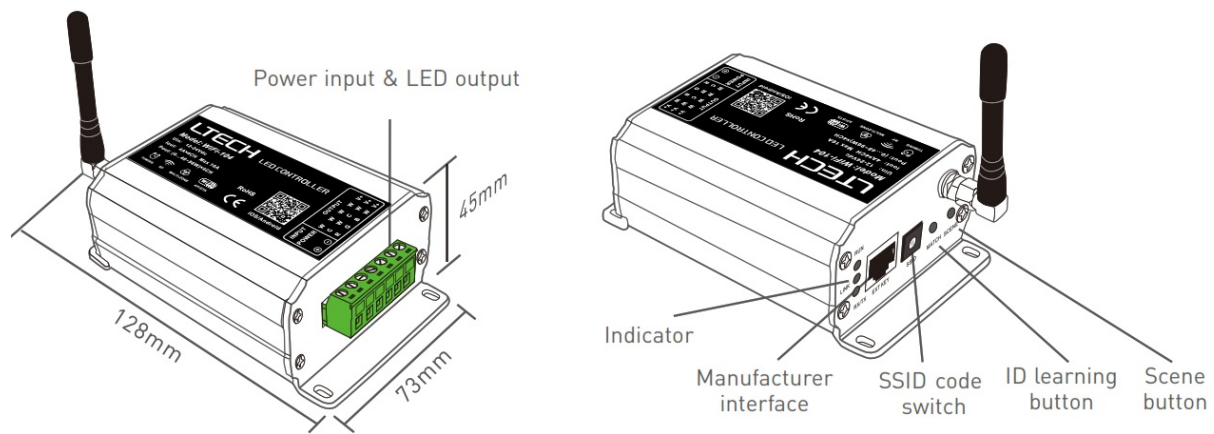

Controller Operating Instructions:

3.1 Install/Uninstall ANT:

Clockwise to install the WiFi-104 ANT, counterclockwise to take off.

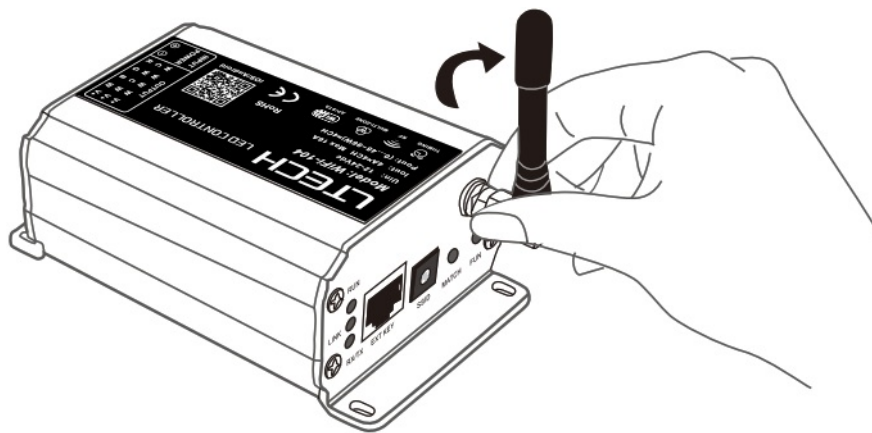

3.2 Work Status Indicator Instructions:

RUN: The indicator light flashes quickly about 25s during the electric initialization. Flashes once per second after initialization.

LINK: The indicator light stays lit when the mobile device connects to WiFi-104, and turns off when disconnect.

RX/TX: The indicator light turns on when WiFi-104 receives or transmits the WiFi data, and turns it off in its free time.

3.3 SSID Number Setting:

Use code switch to set the controller's SSID number, WiFi-104-SSID-X, X stands for a certain No. ranging from 0-F, a total of 16 options. which means our product could set 16 isolated LANs in the same area. WiFi-104 will initialize with a run LED indicator flashing about 25s quickly, each time the SSID NO. is changed. Mobile devices need to search and connect to WiFi again after Initialization is finished.

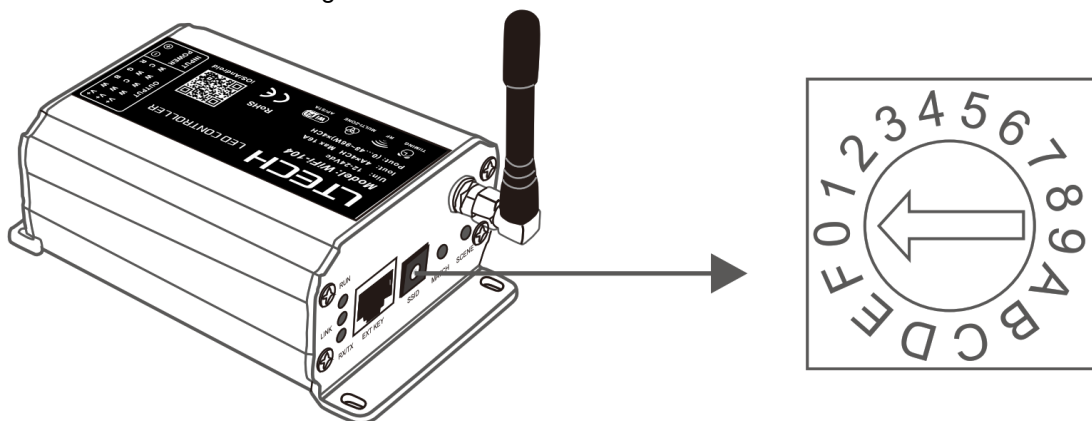

3.4 "MATCH" and "SCENE" Button:

Short press the MATCH button, WiFi controller begins its learning ID status for the M12 remote (learning method, see P13). Short press the "SCENE" button entering into the user-saved scene modes sequentially, 4 scenes total.

[Restore factory settings/Delete password]

Long press the “MATCH” and “SCENE” buttons simultaneously for more than 2 seconds, and the machine will back to the default parameter, including the parameters of changing modes, zone, group, and network. Machine default parameters: Only the 1st zone is present, default RGBW mode, the changing mode is RGB jumping, white is the brightest, no groups, network SSID is WiFi-104-SSID-X (X is the actual coding switch corresponding SSID values), WiFi-104 controller restores as direct connection and the connection password is blank.

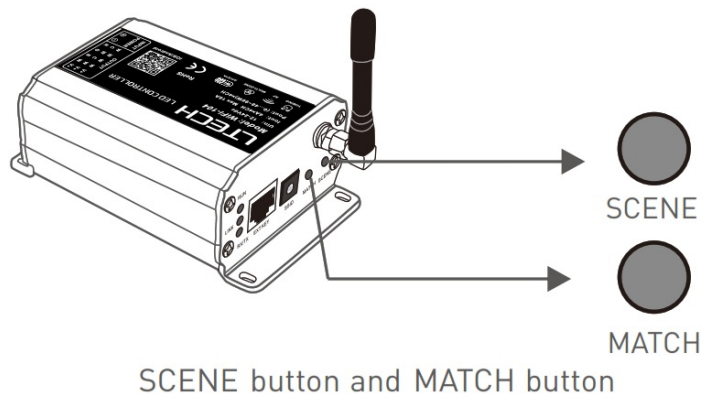

SCENE button and MATCH button

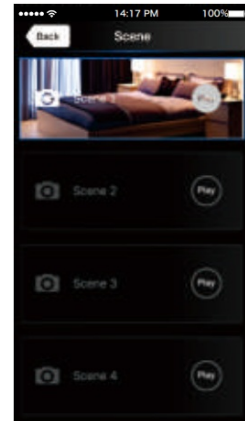

Scene interface

The Instructions of APP Software:

4.1. WiFi-104 Software Installation:

Scan QR Code to download the APP via mobile phone.



iOS/Android

<http://www.ltech.cn/wifi-104-app.html>

4.2 Software Operating Instructions:

4.2.1 WiFi Connection and Settings

WiFi-104 supports 2 connection modes: Direct connection as a router or connect by an additional router.

A. WiFi-104 Controller Direct Connection as a Router:

Enter the mobile device's WiFi setting, click the WiFi function, mobile device search the WiFi and list the working WiFi controller automatically(As Figure-1), and click the SSID number to connect (default is no password).



Android WiFi connection



Apple WiFi connection

(Figure-1)

B. Connection with an Additional Router:

Connect WiFi-104 Controller to the Additional Router Network:

a. Connect to the WiFi-104 controller, the same step as (4.2.1)

b. Click the mobile device's icon  to start the software, the software will search and list the working WiFi controller automatically, and there is a blue wireless icon  (as Figure-2-1)

Delete WiFi-104
controller list
Workable zone NO.
Connect to WiFi-104
Disconnect to
WiFi-104 controller

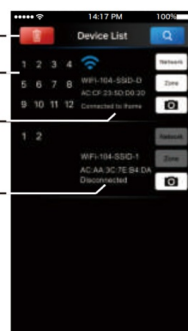

WiFi-104 as
a router interface
(Figure-2-1)



Connect an additional
router interface
(Figure-2-2)

Manual searching the WiFi-104
controller which connect to the
additional router

Workable WiFi-104
Network
Zone function
Change the background
Connect to the additional
router TP-LINK1

c. Click the "Network" key to enter the Network interface(as Figure-3-1), and start "connect to exiting LAN", the software will search the workable WiFi net SSID list, choose the specified router to connect (Attn: do not choose WiFi-104 controller), can add the WiFi-104 controller to the wireless router (as figure-3-2 the wireless router TP-LINK1)

Repeat the ABC steps if you need to connect multiple WiFi-104 controllers to this wireless router

d. Exit WiFi-104 software, enter the mobile device setting-wireless network setting and choose the wireless router to connect. The device list interface shows in Figure 2-2 when re-opening the WiFi-104 software. Now completes the steps to connect to the additional router.

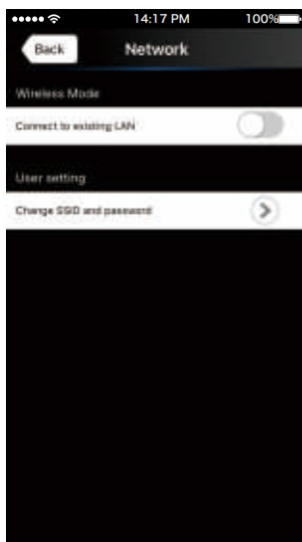

(Figure-3-1)

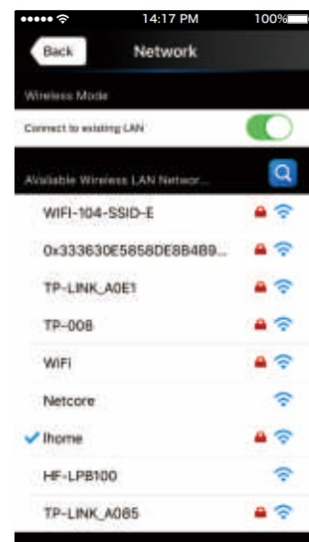

(Figure-3-2)

Network interface

Attn: In this connection mode, to avoid the mobile device automatically connecting to WiFi-104 after the setting has completed, please click on the connected WiFi-104 which is under the mobile device "WiFi setting". and at the message box please click "Ignore the network," (Apple iOS) or "cancel save" (SAMSUNG mobile phone is "forget") to cancel the save of the WiFi-104 connection.



Android cancellation of the save of WiFi-104 connection

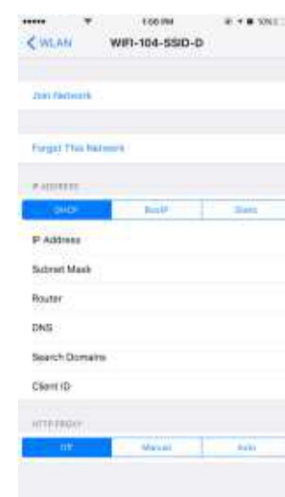

Apple cancellation of the save of WiFi-104 connection

4.2.2 Main Interface (5 types)

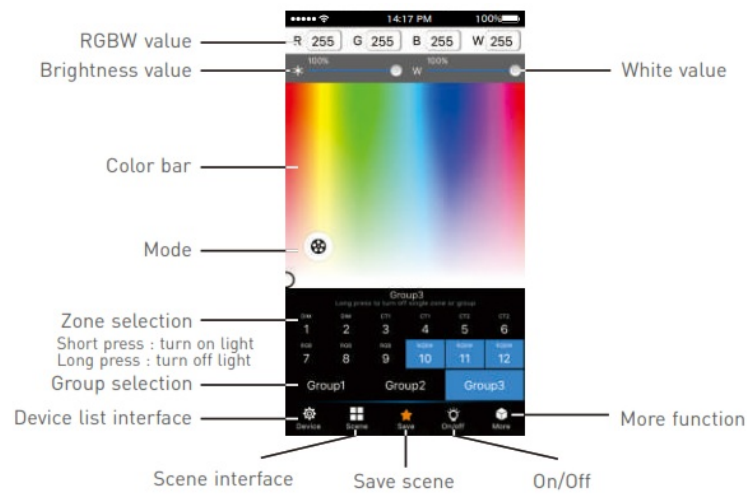

4.2.3 The Learning Method of Zone Control

A. Turn On Zones Control

Click "Zone" on the **Device List** interface, and enter **Zone set** interface. turn on each zone, and choose the LED type accordingly (zones are nameable).

[Attn]: WiFi-104 itself defaults as zone NO.1, connecting lights is optional, and slave control will be zone NO.1 if not connected.

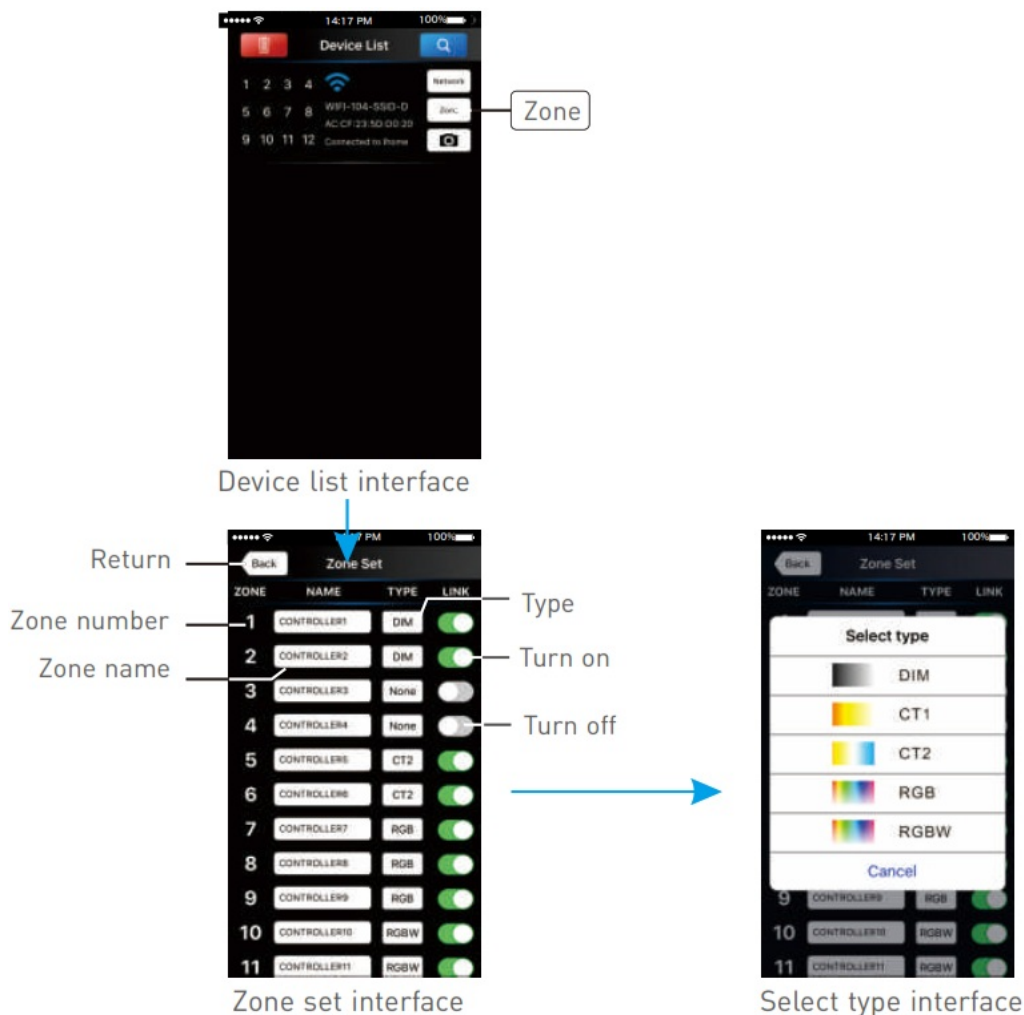

B. Learning ID:

Short press the “ID learning button”  on the receiver, the running light keeps on, select the zone No. on the App, and touch the color screen for 2s-3s. The buzzer long beep (meanwhile the running light on the receiver back to flash state), ID matched.

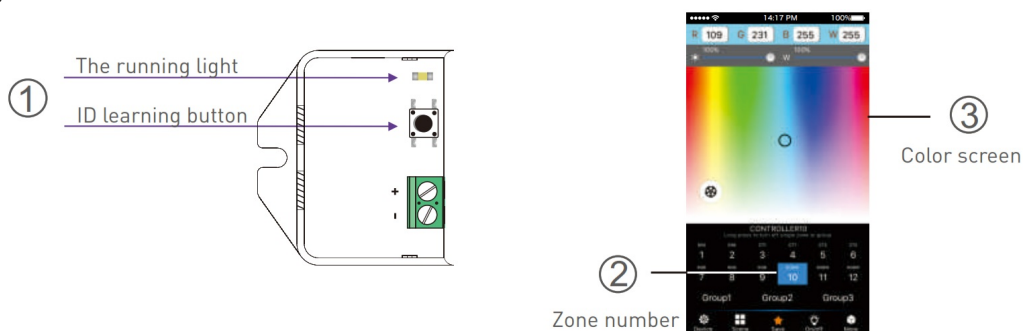

C. Cancelling ID:

Long press” ID learning button”  on the receiver for 5s, the buzzer long beep, ID canceled.

[Attn]: The reset function is available during ID cancellation. Considering dysfunction in rare cases, please cancel the ID and re-sync.

4.2.4 Scene Interface



Scene

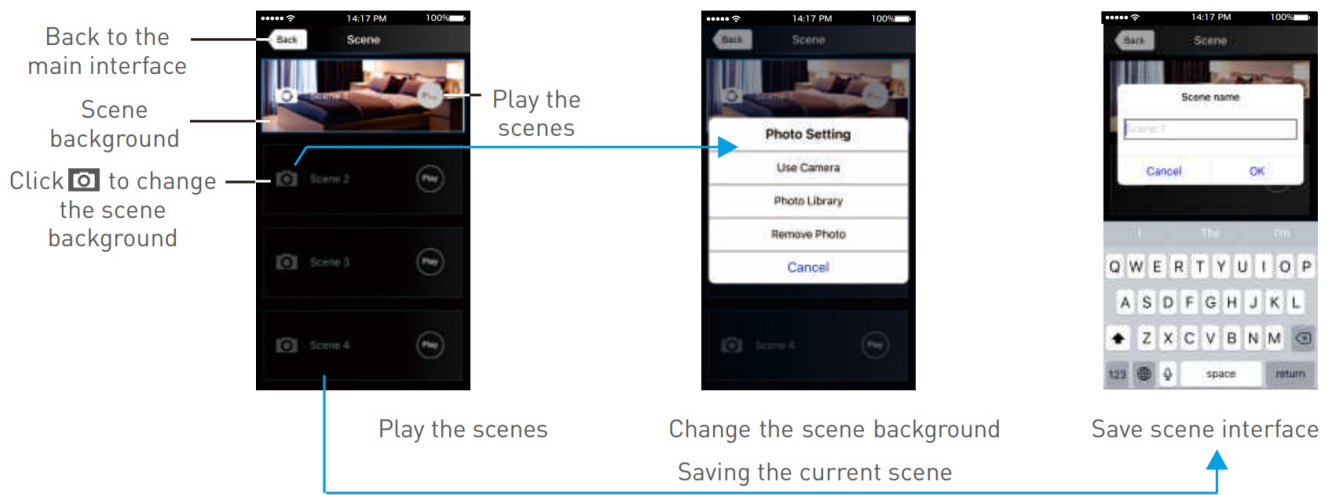

4.2.5 Save scene



Save

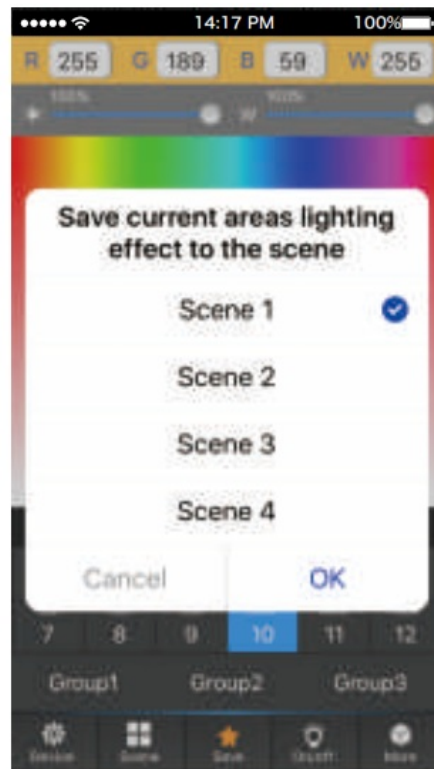

Save current areas lighting
effect to the scene

4.2.6 Mode Interface for RGB / RGBW Type



Mode

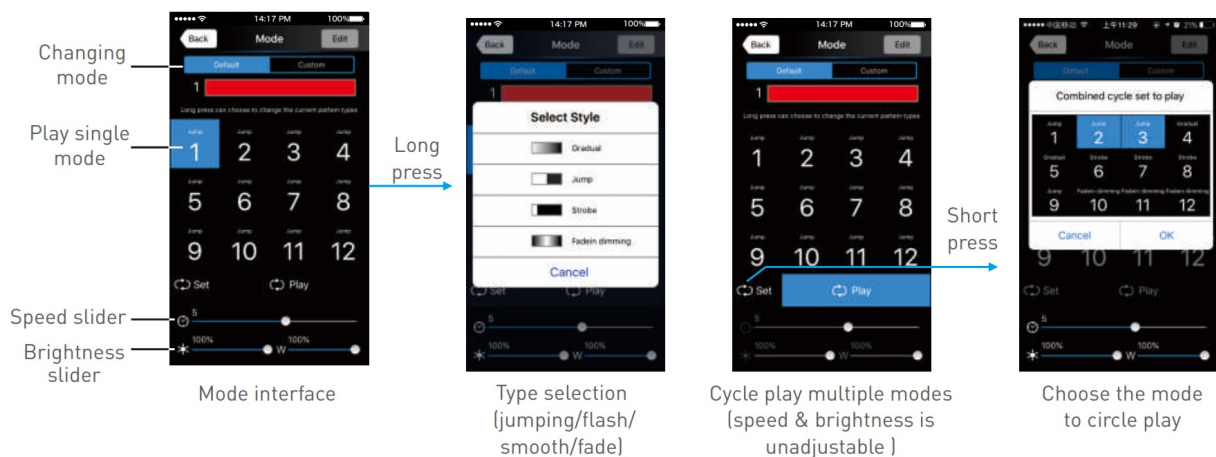

4.2.7 DIY Interface



Mode

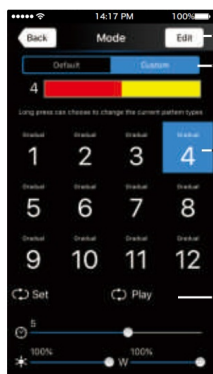

Edit DIY mode

DIY mode

Play single
DIY mode

Playback loop
several
DIY mode

DIY mode interface



Save
DIY

Long press
color box
to delete
current color

Color
box

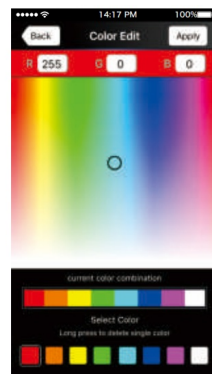

Edit single DIY mode

4.2.8 More Function



More

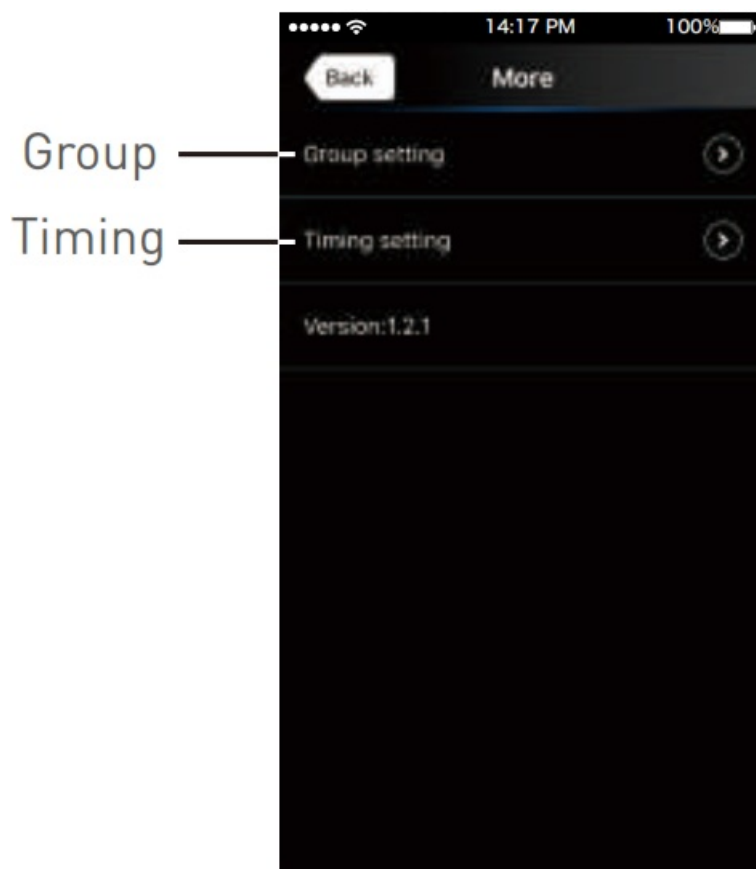

Group Features:

- Choose several zones as one group and control in sync.
- Max 3 groups, same LED types in one group and one zone could join multiple groups.
- Enable the group status, the corresponding group will appear on the main interface.
- Group settings will be auto-off if the zone LED type on & off state changes.

A. Group

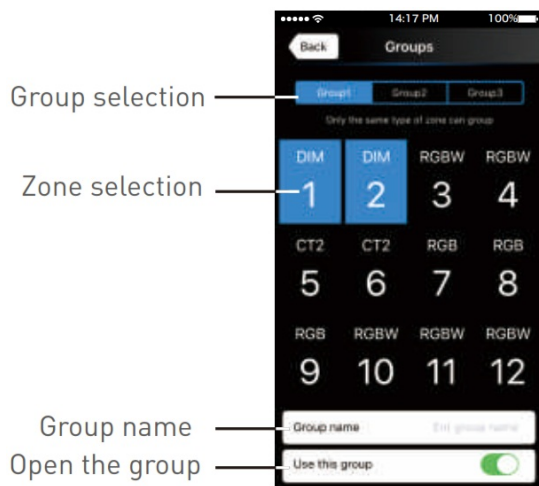

Group selection

Zone selection

Group name
Open the group

Group interface

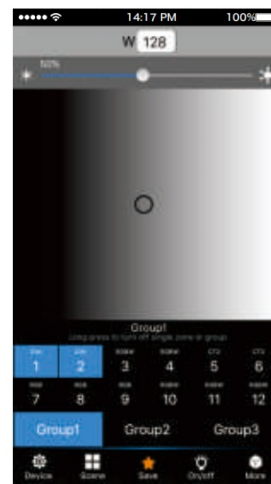

Group operations in main interface

B. Timing

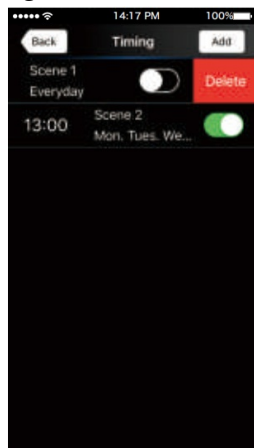

Slide left to delete timing

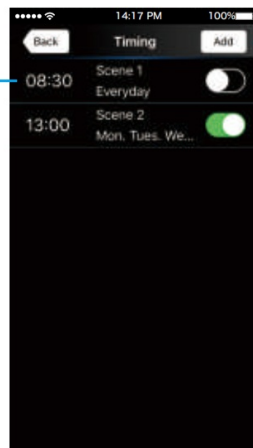

Timing interface

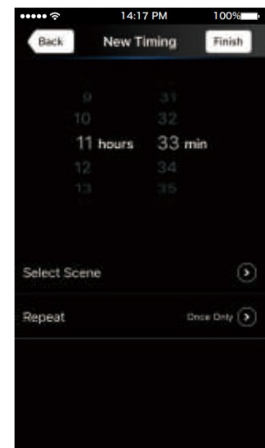

Add new timing

WiFi Network SSID Name and Password Setting

On-device list interface, click the “Network” key to enter the Network interface, and select “Change SSID and Password” (Click “>”) to enter the User Setting interface. Type new SSID name and password (min. 8 characters, consisting of 0-9, a-z, and A-Z). Click the “Apply” button on the top right corner of the interface to save the changes.



1.
Device list interface

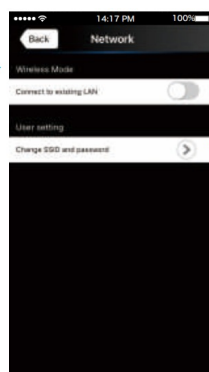

2.
Network interface

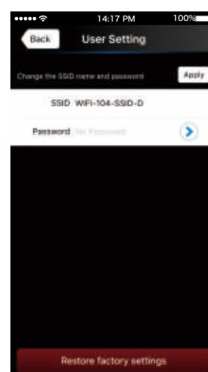

3.
SSID name
change interface

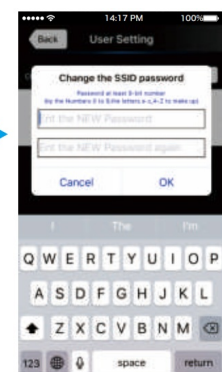

4.
SSID password
change interface

[Attn]: Direct connection of using WiFi-104 as a router, exit the App after the SSID name and the password changed, and reconnect the WiFi-104 on the mobile devices.

For extra router connection, just press “” on the Device List interface to research WiFi-104.

[Attn]: If forget the WiFi network password, press the “MATCH” and “SCENE” buttons simultaneously above 2s to restore the factory default settings and delete the WiFi network password (see P3)

[Restore factory settings / Delete password]

Remote Operating Instructions

M12 Remote	
Working Voltage:	3Vdc (CR2032 button battery)
Transmitting Frequency:	2.4GHz
Dimensions:	L106×W60×H9(mm)
Weight (G.W):	42g

Learning ID

Short press "MATCH" on WiFi-104, the buzzer long beep, press any key on M12, the buzzer beep again, ID matched.

Canceling ID

Long press "MATCH" on WiFi-104 above 6s, the buzzer long beep, ID canceled (canceled all matched remotes).

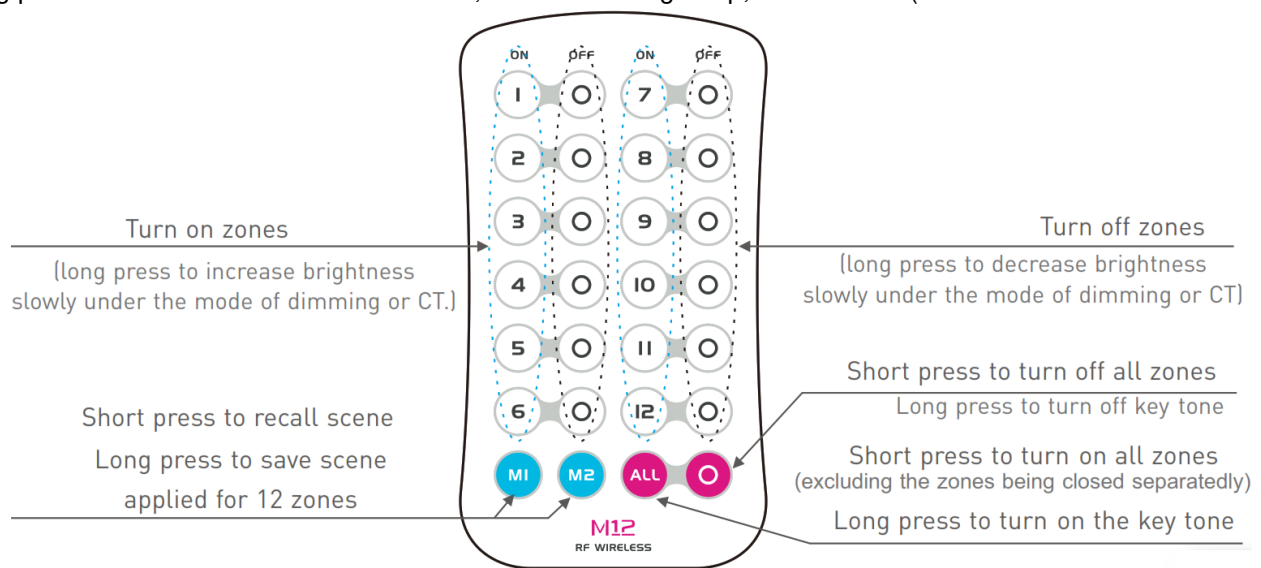

Wiring Diagram

7.1 Connection Between Zone Receiver to LEDs (Same as WiFi-104)

[Attn]: WiFi-104 itself defaults as zone NO.1, connecting lights is optional, and slave control will be zone NO.1, if not connected.

All zones could be used for the same LED types or not. e.g. single color dimming in all zones, all set to DIM type. Set different LED types in each zone accordingly (Dimming, CT or RGB, etc.).

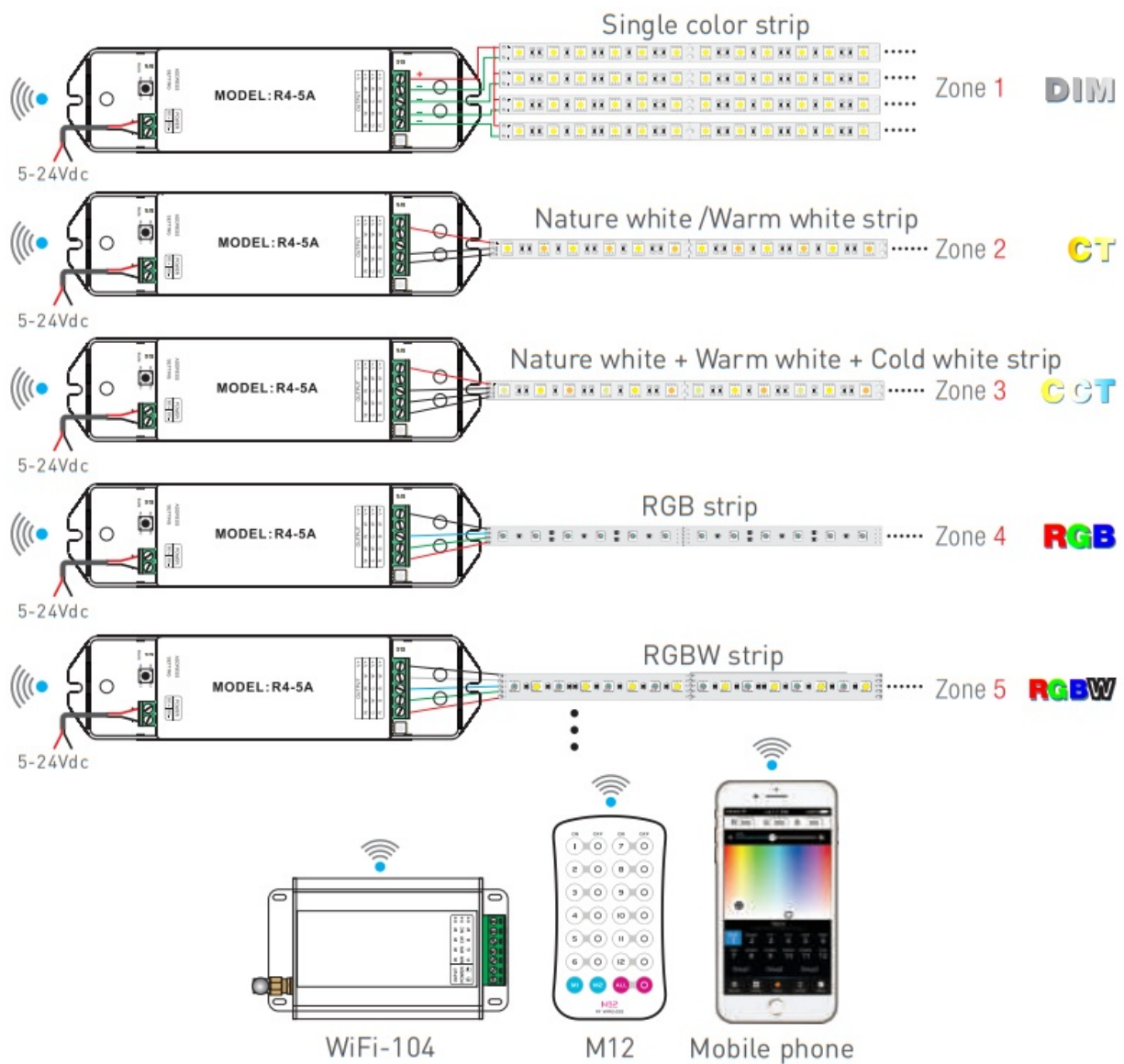

7.2 Direct Connection of Using WiFi-104 as Router

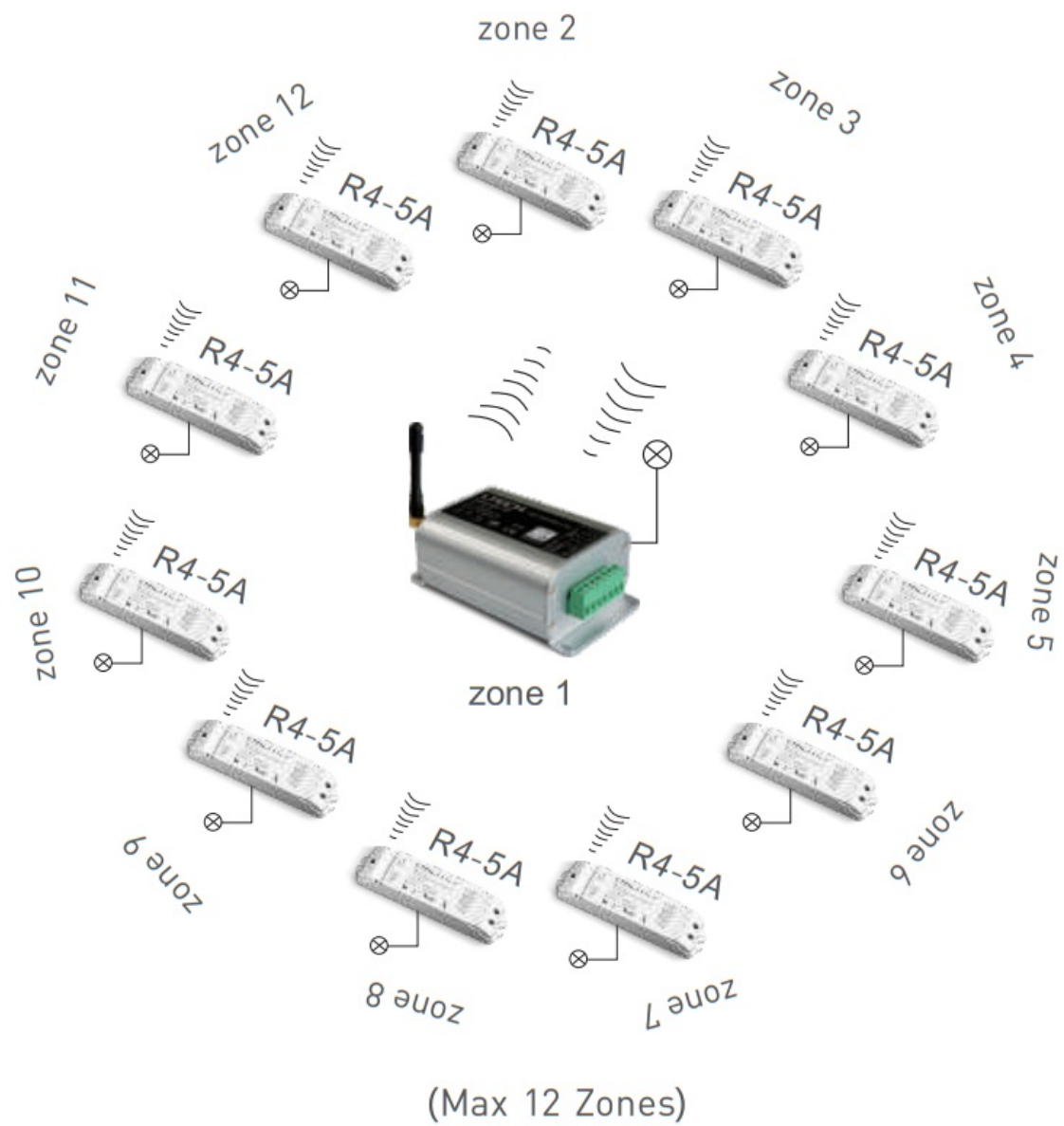

7.3 Extra Router Connection

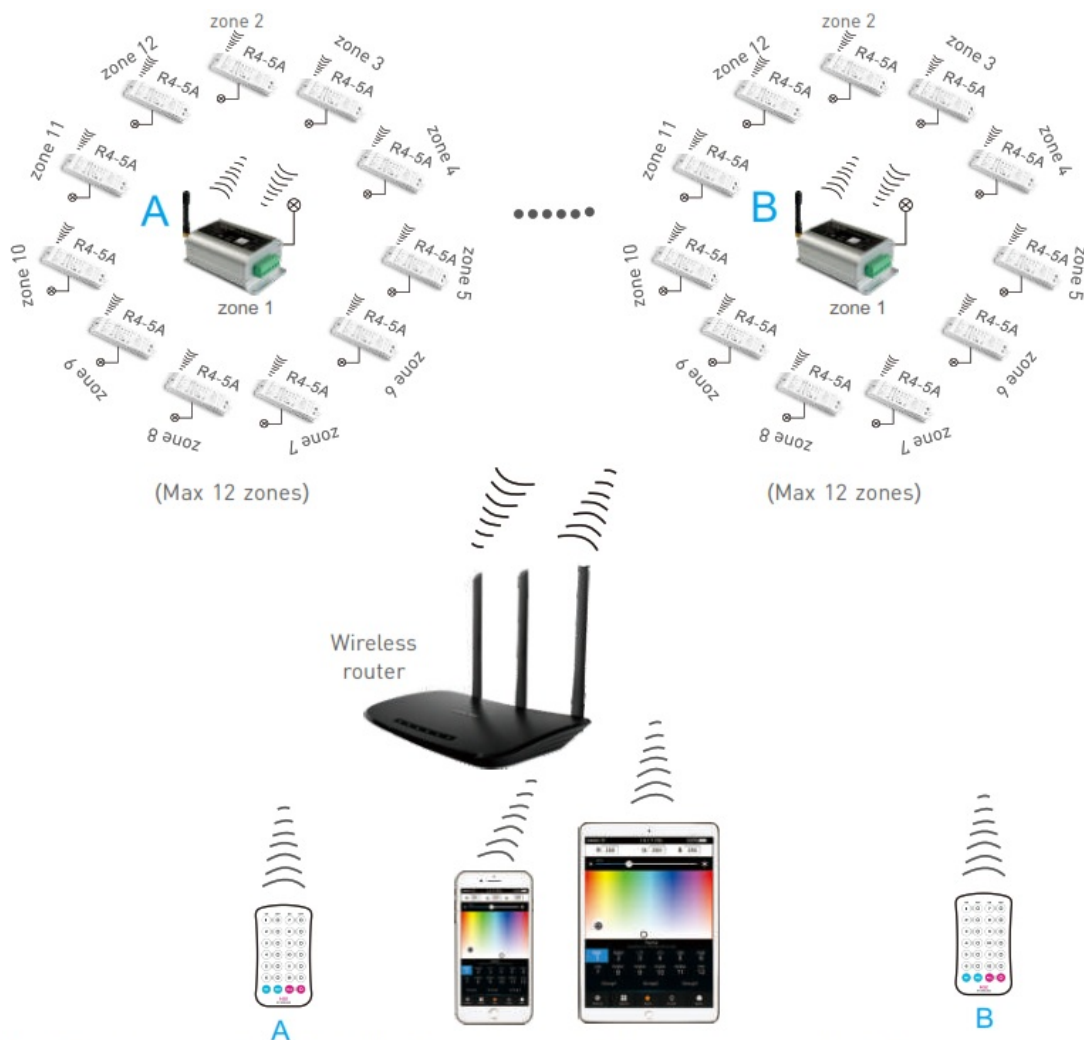

[Attn] unlimited zone receiver R4-5A/R4-CC can be installed for each zone within effective range.

7.4 Remote Distance Reference

[Attn]: The following distance figures are measured in a spacious environment. Please refer to the actual test distance before installation.

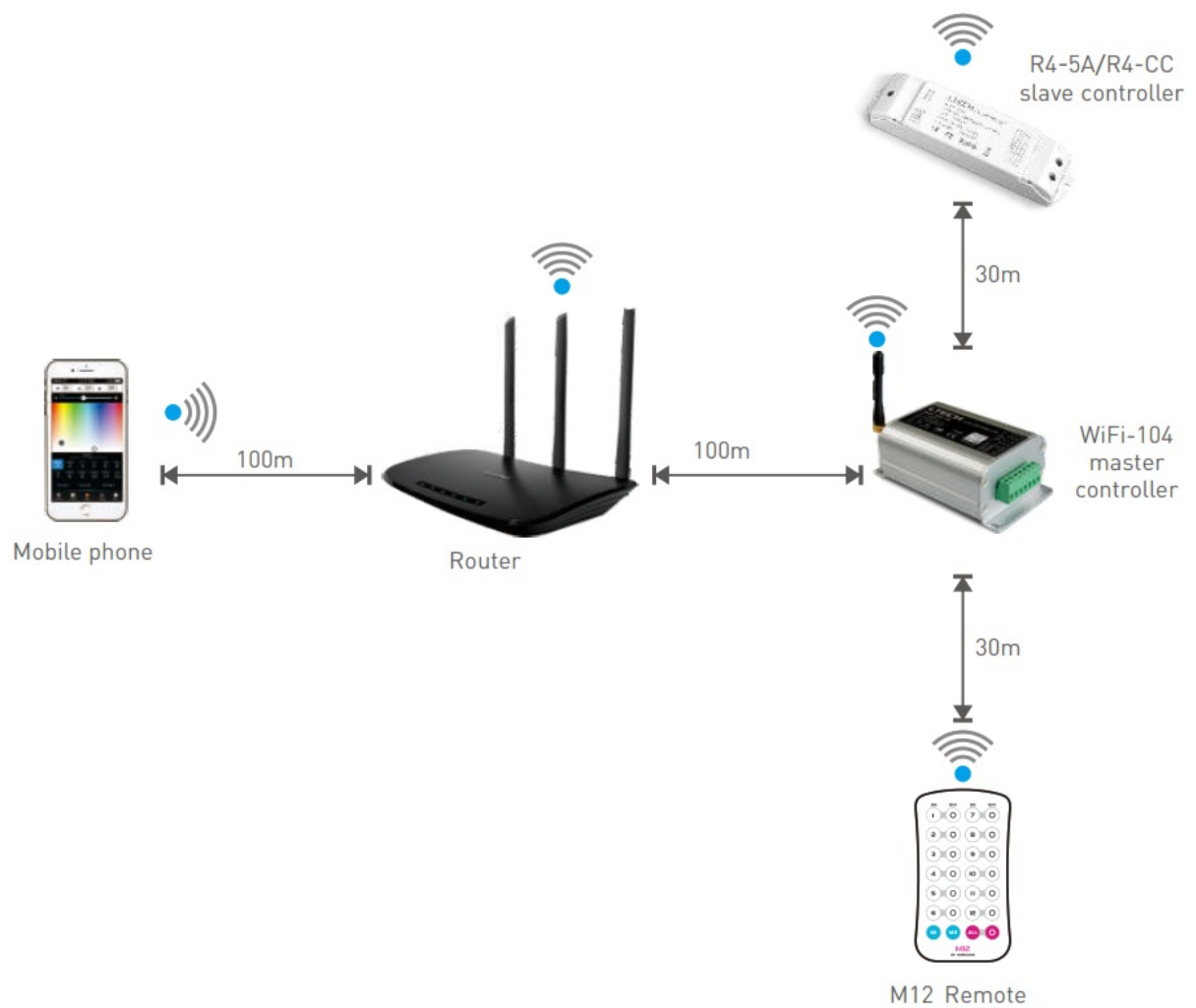

FC CE RoHS

[warranty
5 years]



www.ltech-led.com

Update time: 2017.07.21_A4

Documents / Resources



[LTECH WiFi-104 LED CONTROLLER](#) [pdf] User Manual
WiFi-104 LED CONTROLLER, LED CONTROLLER

References

- [🌐 LED Controller | LED Dimmable Driver | LED Intelligent Lighting | Intelligent Home -LTECH](#)

Manuals+,