



LTECH M4/M8 M4-5A M series LED controller User Manual

[Home](#) » [LTECH](#) » LTECH M4/M8 M4-5A M series LED controller User Manual

Contents [[hide](#)]

- 1 [LTECH M4/M8 M4-5A M series LED controller User Manual](#)
 - 1.1 [1. Parameter](#)
- 2 [2. System Diagram:](#)
 - 2.1 [3. Product Size:](#)
 - 2.2 [4. The Learning ID Method of Remote Control:](#)
 - 2.3 [5. Operating Instruction for Receiver](#)
 - 2.4 [6. Operating Instruction for Remote Control :](#)
 - 2.5 [7. Wiring Diagram:](#)
- 3 [Read More About This Manual & Download PDF:](#)
- 4 [Documents / Resources](#)
 - 4.1 [References](#)
- 5 [Related Posts](#)

LTECH M4/M8 M4-5A M series LED controller User Manual



M series LED controller is compatible with 8 kinds remotes of different function (patent technology) . which means using one receiver could experience single color/CT dimming, RGB/RGBW adjustment to meet customers' different lighting requirements. With the RF remote, speed/brightness adjustment. customise color and lighting changing modes selection could all be achieved

1. Parameter

Remote(RGBW):		CV Receiver (RGBW):	
Model:	MM-M0	Model:	MM-5A
Working Voltage:	3Vdc (battery CR2032)	Input Voltage:	12-24Vdc
Working Frequency:	433.92MHz	Current Load:	5A~4CH Max 20A
Remote Distance:	30m	Max Output Power:	(0...60W~120W) × 4CH
Working Temp.:	-30℃~55℃	Protection:	Short circuit / Over-load
Weight(N.W.):	42g	Working Temp.:	-30℃~55℃
		Weight(N.W.):	125g

2. System Diagram:

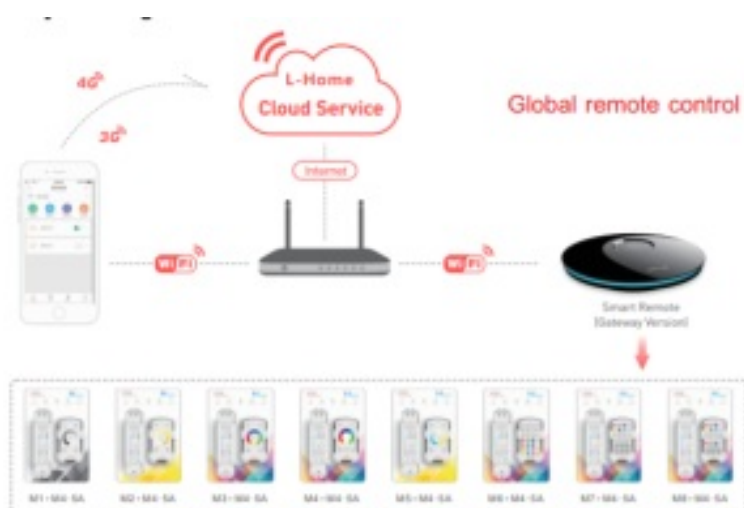

3. Product Size:

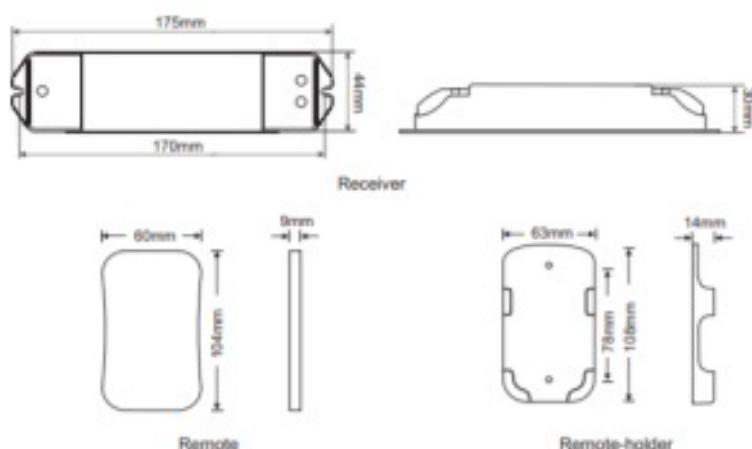

4. The Learning ID Method of Remote Control:

Remote control has been matched to the receiver before leave factory, if deleted accidentally, you can learn ID as follow.

Learning ID: Short press ID learning button on the M4-5A receiver, the running light is on, then press any key on the M4/M8 remote control, the running light flashes several times, activated.

Cancel ID: Long press ID learning button on the M4-5A receiver for 5 seconds.

Attn: one receiver can be matched with max 10 same or different kinds remote.

5. Operating Instruction for Receiver

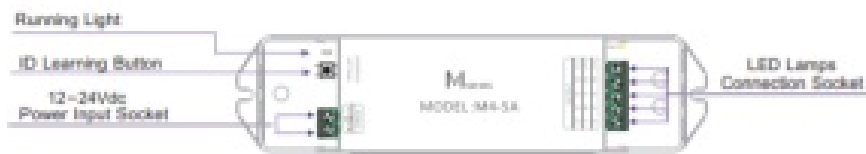

6. Operating Instruction for Remote Control :

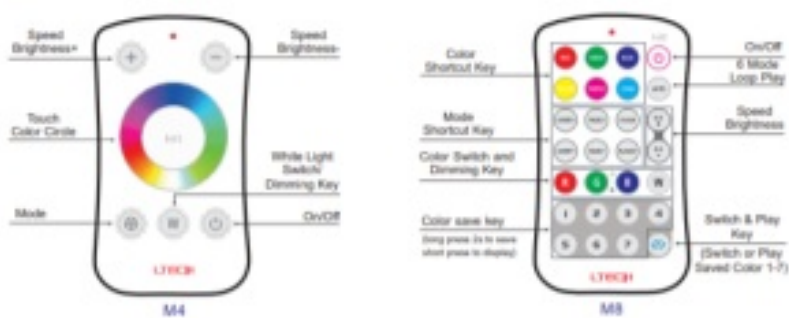

M4 Changing Mode Table

No.	Mode	Instrucion	No.	Mode	Instrucion
1	Static Red	Brightness Adjustable	7	Static White	Brightness Adjustable
2	Static Green	Brightness Adjustable	8	RGB Skipping	Speed/Brightness Adjustable
3	Static Blue	Brightness Adjustable	9	7 Colors Skipping	Speed/Brightness Adjustable
4	Static Yellow	Brightness Adjustable	10	RGB Color Smooth	Speed/Brightness Adjustable
5	Static Purple	Brightness Adjustable	11	Full-color Smooth	Speed/Brightness Adjustable
6	Static Cyan	Brightness Adjustable	12	Static Black	White light can be turn/off and adjusted

7. Wiring Diagram:

E.g. 1: Connected 12V lamp, loads 0~240W (5A×4CH×12V).



E.g. 2: Connected 24V lamp, loads 0~480W (5A×4CH×24V).

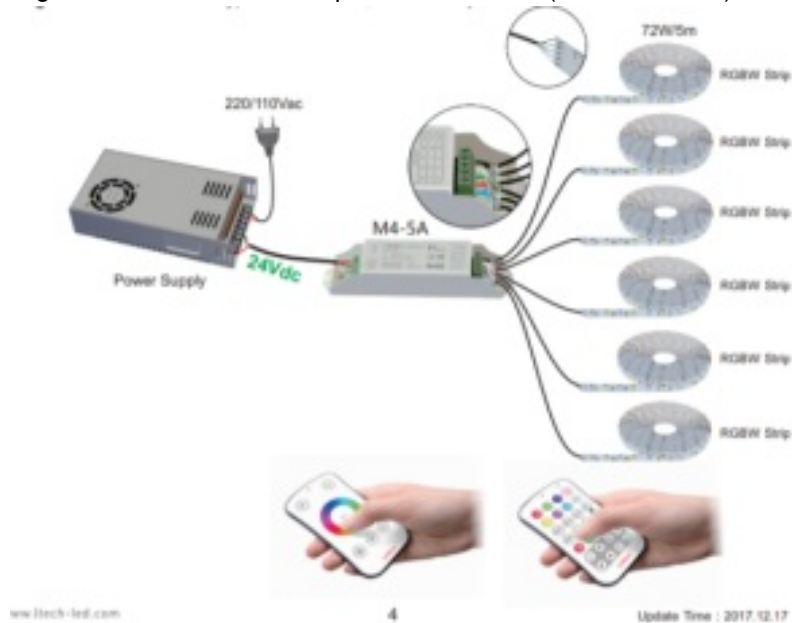

Read More About This Manual & Download PDF:

Documents / Resources

	<p>LTECH M4/M8 M4-5A M series LED controller [pdf] User Manual M4 M8 M4-5A, M series LED controller</p>
--	---

References

- [LED Controller](#) | [LED Dimmable Driver](#) | [LED Intelligent Lighting](#) | [Intelligent Home -LTECH](#)