

Loyal Electronics
Loyal Electronics
D1367C10
Wireless Mouse
Smart Fly
Scrolling With
Silent Key



Loyal Electronics D1367C10 Wireless Mouse Smart Fly Scrolling With Silent Key User Guide

[Home](#) » [Loyal Electronics](#) » Loyal Electronics D1367C10 Wireless Mouse Smart Fly Scrolling With Silent Key User Guide 

Contents

- [1 Loyal Electronics D1367C10 Wireless Mouse Smart Fly Scrolling With Silent Key](#)
- [2 Product Usage Instructions](#)
- [3 Power switch](#)
- [4 Switching wireless signal](#)
- [5 DPI Adjustment](#)
- [6 Functions](#)
- [7 FCC Warning](#)
- [8 Documents / Resources](#)
 - [8.1 References](#)
- [9 Related Posts](#)

Loyal Electronics

Loyal Electronics D1367C10 Wireless Mouse Smart Fly Scrolling With Silent Key



Product Specifications

- Model: Wireless Mouse Smart Fly Scrolling With Silent Key
- FCC ID: 2AAVD-D1367C10
- Charging Voltage: 5.0V
- DPI Options: 1000, 1600, 2400, 3200

Product Usage Instructions

Checking Accessories

Ensure the following accessories are included in the package:

- A. Mouse
- B. Charging Cable

Wireless USB Receiver Storage and Use

To store and use the wireless USB receiver:

- A. Open the case from the mouse tail arrow
- B. Take out the wireless USB receiver

Charging Precautions

Warning: Charging limited to 5.0V voltage. Do not use a fast charger to avoid damaging the mouse. Use the provided charging cable and connect it to your computer port.

Power Switch

Switch between Win, Mac1, and Mac2.

Switching Wireless Signal

Switch between different connections by following the light indications for USB receiver signal, Bluetooth 1, and Bluetooth 2.

DPI Adjustment

Click the DPI button to adjust DPI speed. The number of light flickers indicates the DPI level.

Fast Switching Between Multiple Devices

Easily switch between connected devices by pressing the device switch key. Bluetooth will automatically connect to the corresponding device.

Low Battery Indicator Light

When battery is low (<7 days of expected use time), the indicator light will flash, indicating the need for charging.

Smart Flying Scroll Wheel & Left/Right Scroll

Use scroll wheel for quick navigation in Excel files or websites by scrolling up/down or left/right.

About Using on Mac OS

Instructions specific to using the mouse with Mac operating systems.

About Mouse Wheel Direction on Mac OS

Functionality and language support for Mac1 and Mac2 systems.

Frequently Asked Questions (FAQ)

- **Q: Can I use a fast charger to charge the mouse?**
 - A: No, charging should be limited to 5.0V voltage using the provided cable connected to a computer port to avoid damage.
- **Q: How do I switch between DPI levels?**
 - A: Press the DPI button on the mouse to cycle through different DPI speeds indicated by light flickers.

Wireless Mouse

Smart Fly Scrolling With Silent Key

FCC ID:2AAVD-D1367C10

Please check if the accessories are completed in the package.

- Mouse
- Charging Cable

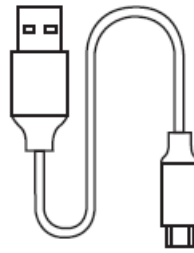
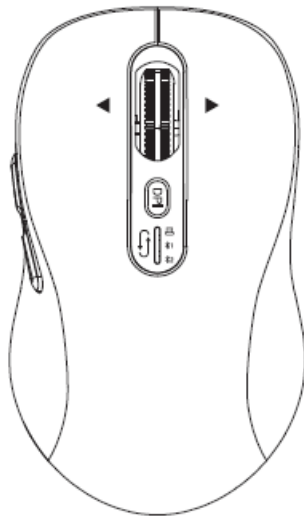

Charging precautions

Warning :Charging limited to 5.0V voltage, don't use fast charger otherwise it may harm the mouse. We advise to use the charging cable we provided and charge the mouse through your computer port.

Wireless USB receiver storage location and use

- Open the case from the mouse tail arrow
- Take out the wireless USB receiver
- Plug it into the device port and use it

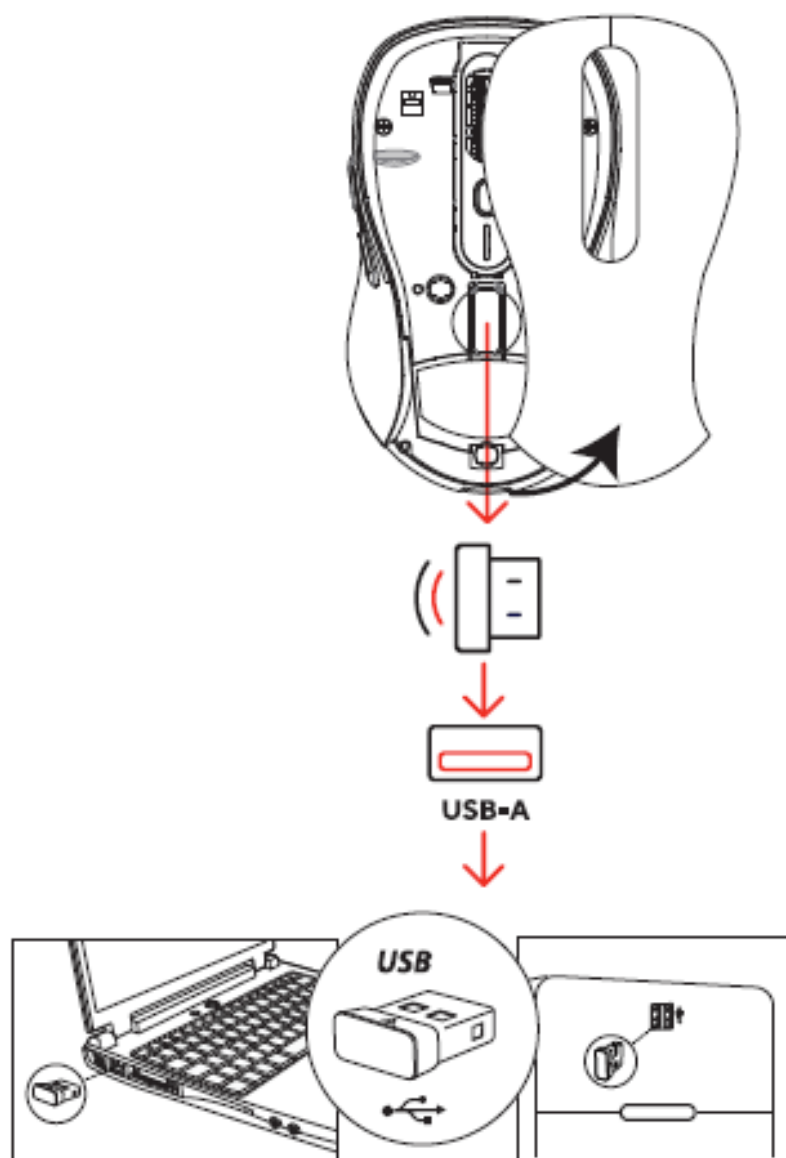

Power switch

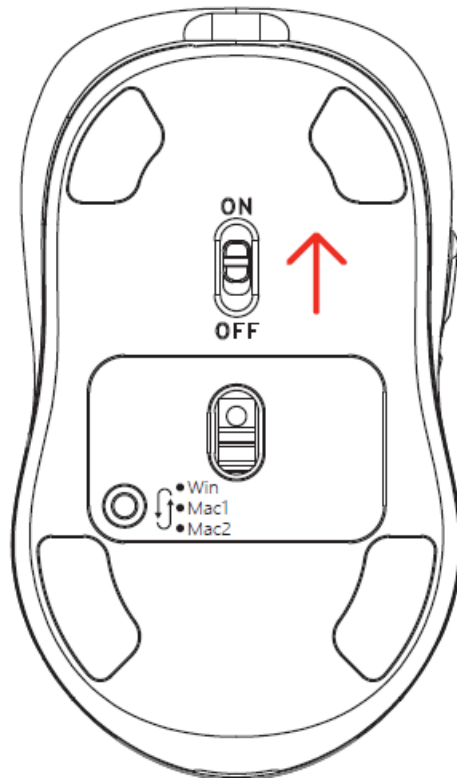

Switching wireless signal

-  (White light) : Wireless USB receiver signal
-  (Blue light) : Bluetooth 1
-  (Green light) : Bluetooth 2

After switching to the corresponding connection type, insert the USB receiver into the corresponding device or find the Bluetooth signal on the corresponding device and connect it.

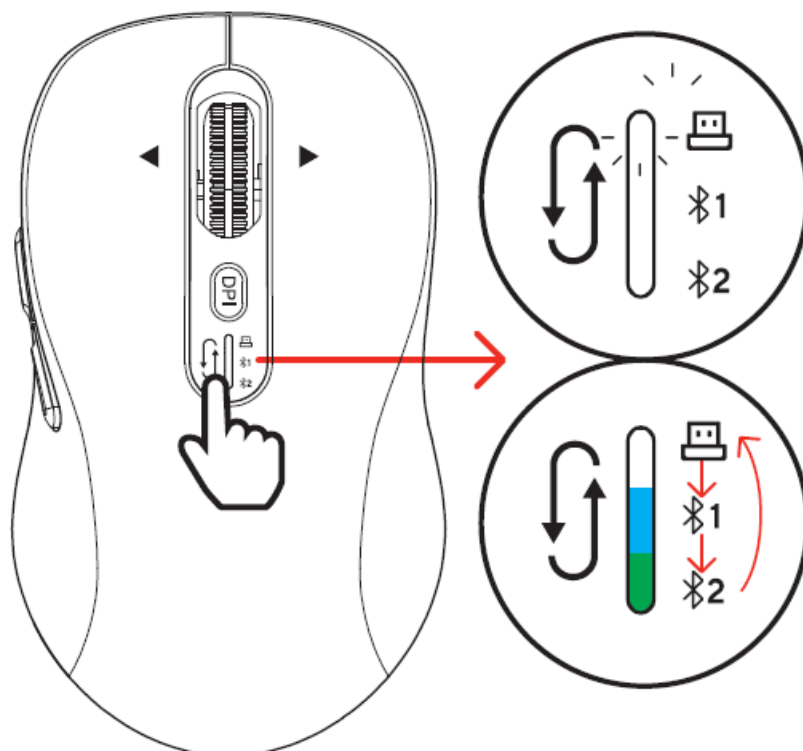

Change stored wireless information

Each Bluetooth can only record the information of one device, when using the same Bluetooth to connect to another new device, please clear the memory information of the Bluetooth Settings, then the Bluetooth can be found by the new device.

Clear method: as shown in the figure, click and switch to blue/green light, then hold down the button again for 3 seconds, the light will go into a rapid flashing state, at this time, the old device information has been cleared, can be found by the new device.

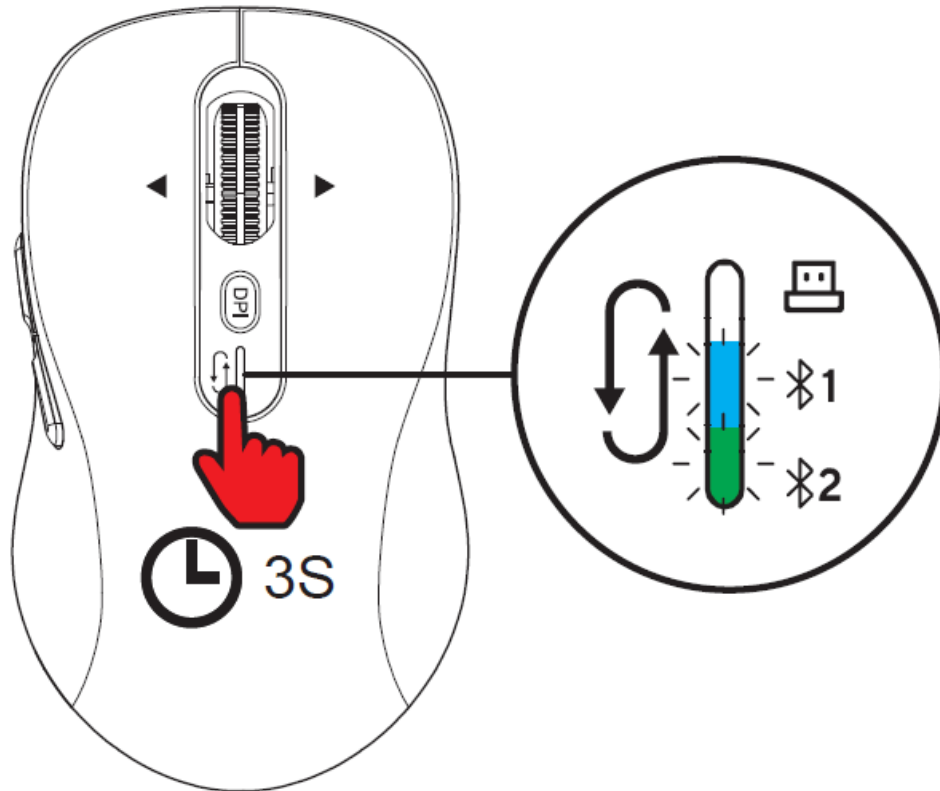

*You need to press this button with much force. We design this considering any touch by mistake.

Fast switching between multiple devices

For connected devices, Bluetooth will remember the information of the device, at this time, If the device's wireless signal is on, only need to click the device switch key, Bluetooth will automatically connect to the corresponding device, so that users can fast switch between multiple devices.

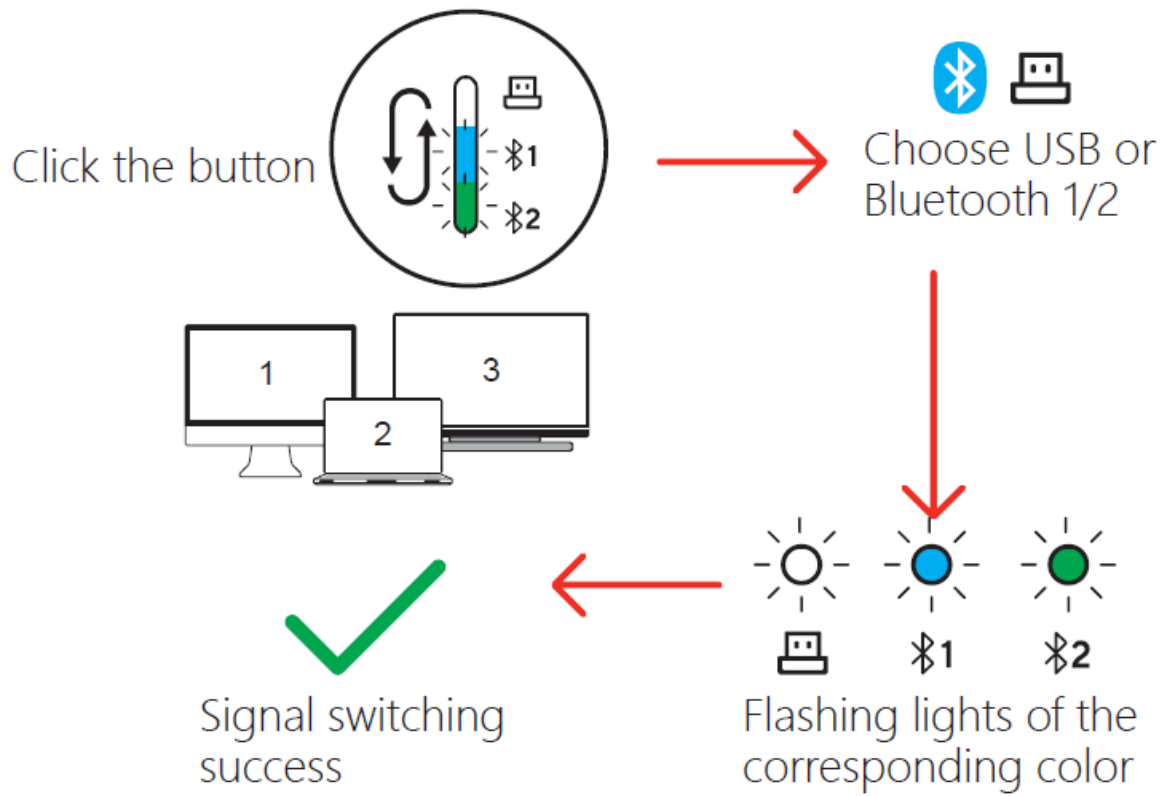

DPI Adjustment

Click the DPI button to adjust the different DPI speed, It can be judged by the number of times the light flicker.

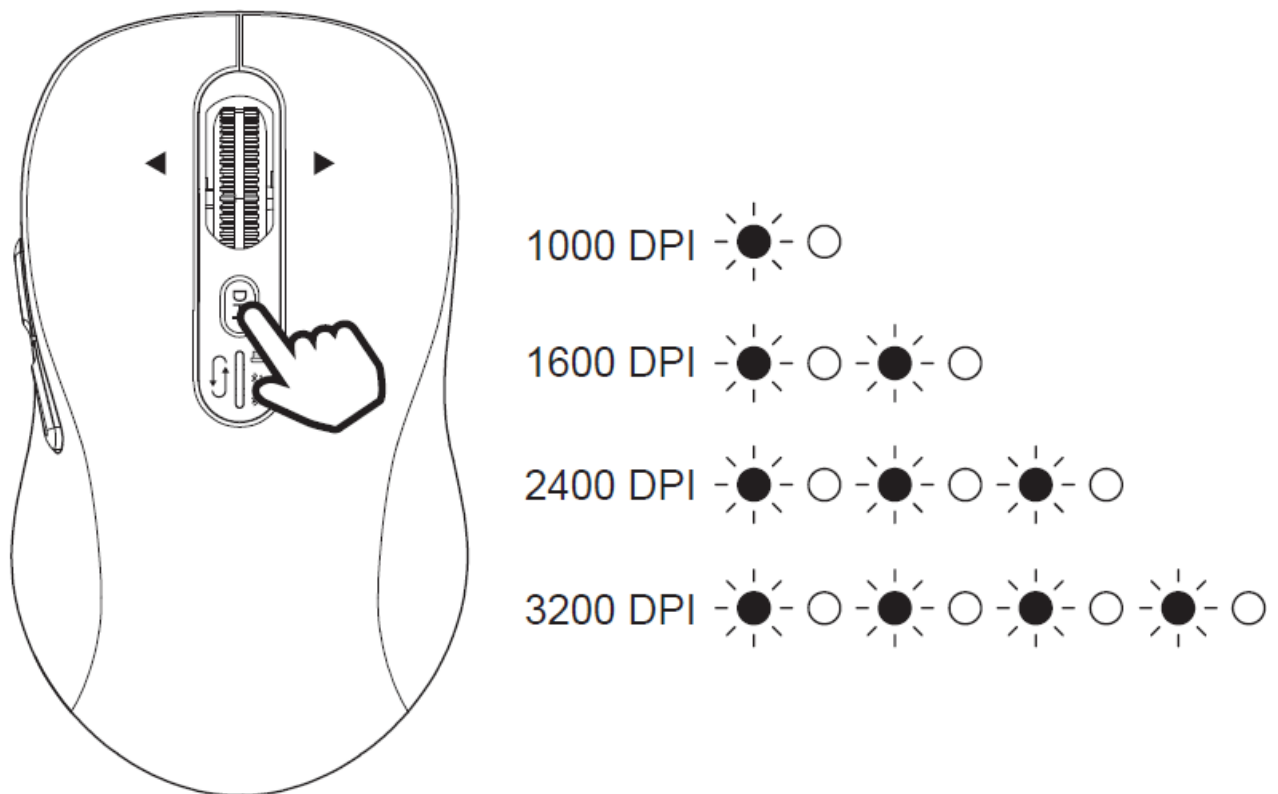

Low battery indicator light

When the mouse battery is low and the expected use time is less than 7 days, the low battery warning light will automatically light up and flicker (corresponding light), at this time, please charge in time.

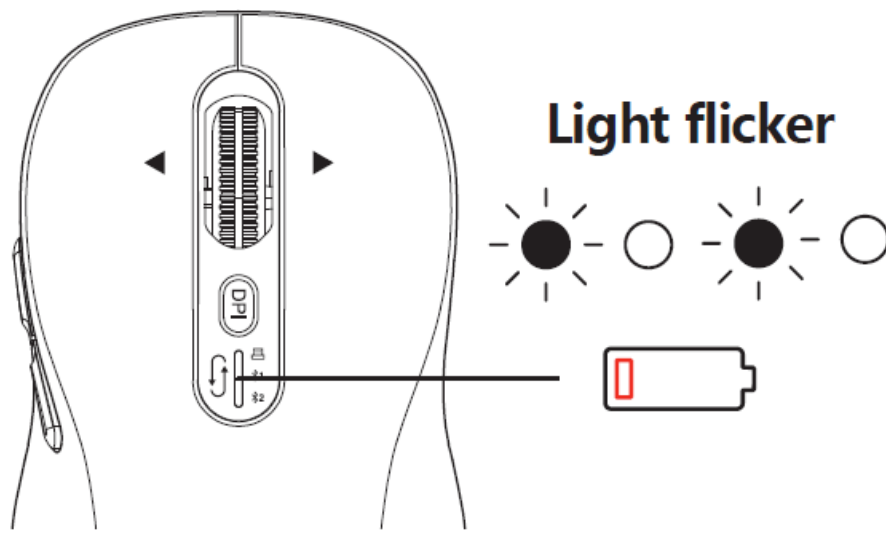

Smart Flying Scroll Wheel&Left scroll&Right scroll

- When you are browsing an Excel file or a website, you could go to the top or bottom of the file or website quickly by giving the scroll wheel a up or down speed.
- When you are browsing an Excel file or a website, you could go to the left side or right side of the file or website quickly by pressing the scroll wheel to the left or right.

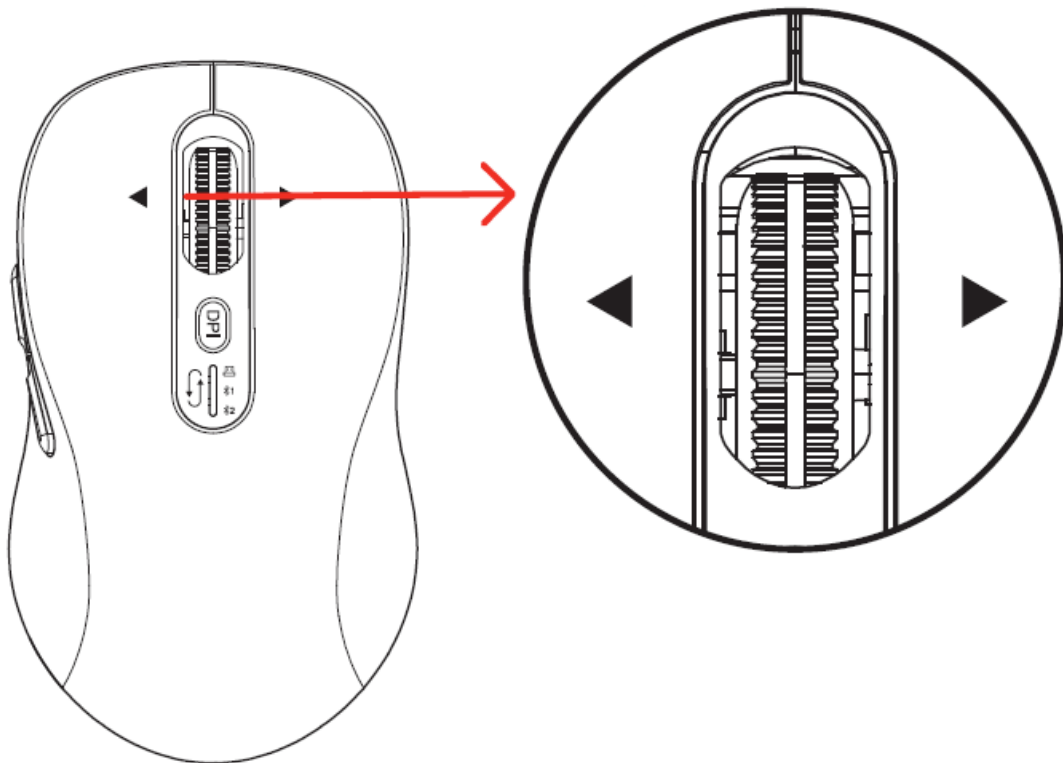

About using on Mac OS

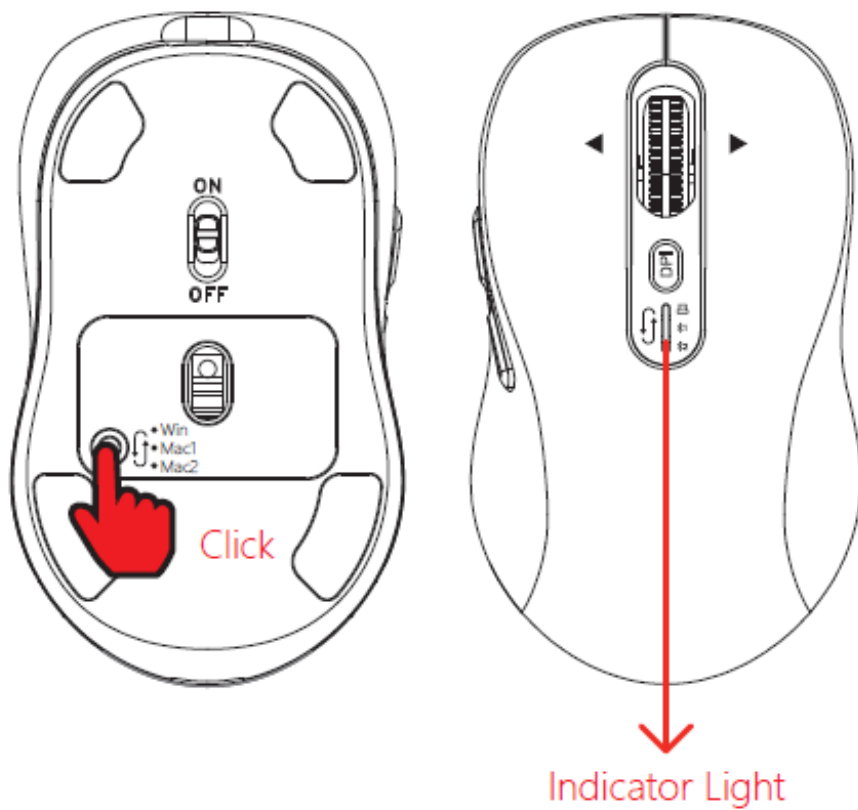

Short Click, top light flashes twice



Short Click, top light flashes 3 times



Short Click, top light flashes 4 times



Long-press for 5S all top lights on for 2S Restore factory defaulted setting Three channels for Windows OS

Windows OS



Mac1 OS



Mac2 OS

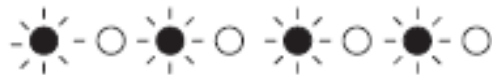

Windows OS



When you connect this mouse with your Mac,the function of Back and Forward buttons may be unavailable if you do not switch the system button at the bottom of mouse.

Please switch to corresponding system(Mac1 and Mac2)based on the system language you are using listed as below.

Mac1 Support Language	Mac2 Support Language
Chinese	German
English	Spanish
Russian	Italian
Arabic	Portuguese
Japanese	Norwegian
Korean	Icelandic
French	Swedish
Greek	Danish
Czech	Finnish
Belgian	
Canadian	
Irish	
Brazilian	
Farsi	
Faroese	
Romanian	
Dutch	

About mouse wheel direction on Mac OS

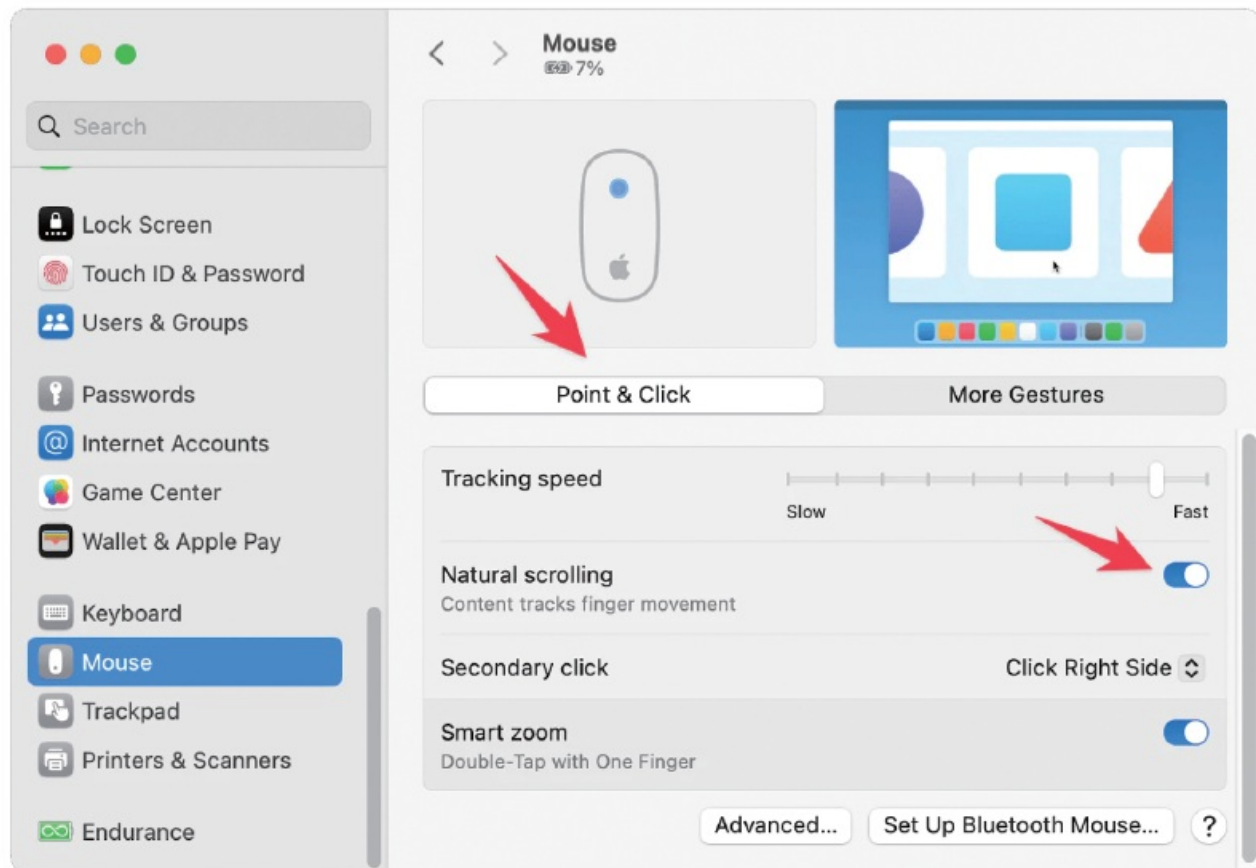

Mouse Wheel Direction Adjustment on Mac OS

1. Open the computer Settings, go to the Mouse Settings page, open "Natural scrolling".
2. Click the System switch button (red button) at the bottom of the mouse to switch to Mac.

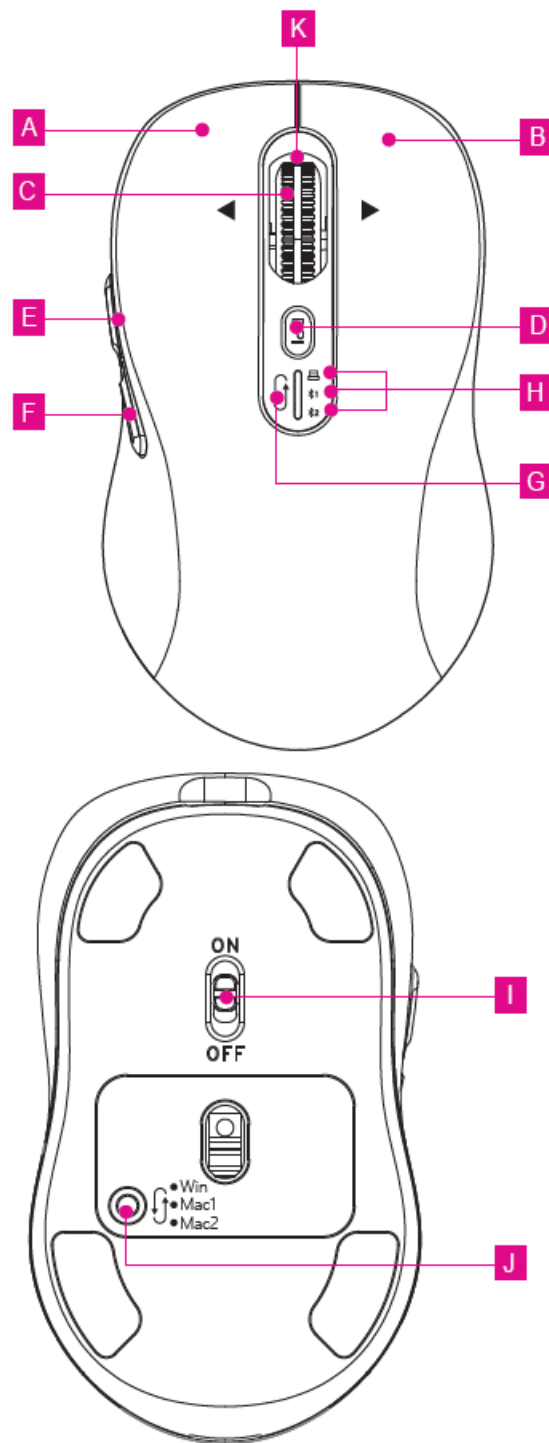

Functions



Windows

- A Left Button
- B Right Button
- C Smart Flying Scroll Wheel *
- D DPI Button
- E Forward Button
- F Back Button
- G Devices Switch Button
- H Devices Indicators:

-  2.4G White Indicator



-  Bluetooth 1 Blue Indicator
-  Bluetooth 2 Green Indicator
- DPI Indicator
- Low power indicator
- I ON/OFF Button
- J Windows/Mac OS= Switch Button
- K Charging indicator light

Mac 1

- A Left button
- B Right Button
- C Smart Flying Scroll Wheel
-



D DPI Button

- E Forward Button(Command+])
- F Back Button(Command+[)
- G Devices Switch Button
- H Devices Indicators:
 -  2.4G White Indicator
 -  Bluetooth 1 Blue Indicator
 -  Bluetooth 2 Green Indicator
 - DPI Indicator
 - Low power indicator
- I ON/OFF Button
- J Windows/Mac OS Switch Button
- K Charging indicator light

Refer to item 12(Mac defaulted setting)



Mac 2

- A Left Button
- B Right Button
- C Smart Flying Scroll Wheel *

Natural scrolling

Content tracks finger movement



- D DPI Button
- E Forward Button(Command+')
- F Back Button(Command+;)
- G Devices Switch Button
- H Devices Indicators:
 -  2.4G White Indicator
 -  Bluetooth 1 Blue Indicator
 -  Bluetooth 2 Green Indicator
 - DPI Indicator
 - Low power indicator
- I ON/OFF Button
- J Windows/Mac OS Switch Button
- K Charging indicator light

Refer to item 12(Mac defaulted setting)

FCC Warning

This device complies with Part 15 of the FCC Rules. Operation is subject to the following two conditions:

1. This device may not cause harmful interference, and
2. This device must accept any interference received, including interference that may cause undesired operation.

NOTE 1: This equipment has been tested and found to comply with the limits for a Class B digital device, pursuant to part 15 of the FCC Rules. These limits are designed to provide reasonable protection against harmful interference in a residential installation. This equipment generates, uses and can radiate radio frequency energy and, if not installed and used in accordance with the instructions, may cause harmful interference to radio communications. However, there is no guarantee that interference will not occur in a particular installation. If this equipment does cause harmful interference to radio or television reception, which can be determined by turning the equipment off and on, the user is encouraged to try to correct the interference by one or more of the following measures:

- Reorient or relocate the receiving antenna.
- Increase the separation between the equipment and receiver.
- Connect the equipment into an outlet on a circuit different from that to which the receiver is connected.
- Consult the dealer or an experienced radio/TV technician for help.

NOTE 2: Any changes or modifications to this unit not expressly approved by the party responsible for compliance could void the user's authority to operate the equipment.

The device has been evaluated to meet general RF exposure requirement. The device can be used in portable exposure condition without restriction

Documents / Resources

	<p>Loyal Electronics D1367C10 Wireless Mouse Smart Fly Scrolling With Silent Key [pdf] Use r Guide</p> <p>D1367C10 Wireless Mouse Smart Fly Scrolling With Silent Key, D1367C10, Wireless Mouse S mart Fly Scrolling With Silent Key, Mouse Smart Fly Scrolling With Silent Key, Fly Scrolling With Silent Key, With Silent Key, Silent Key, Key</p>
---	--

References

- [User Manual](#)

[Manuals+](#), [Privacy Policy](#)

This website is an independent publication and is neither affiliated with nor endorsed by any of the trademark owners. The "Bluetooth®" word mark and logos are registered trademarks owned by Bluetooth SIG, Inc. The "Wi-Fi®" word mark and logos are registered trademarks owned by the Wi-Fi Alliance. Any use of these marks on this website does not imply any affiliation with or endorsement.