



[Home](#) » [Lotus Lantern](#) » **Lotus Lantern Software App button type RGB Light Strip User Manual** 

Contents [[hide](#)]

- [1 Lotus Lantern Software App button type RGB Light Strip](#)
- [2 Software Overview](#)
- [3 Operating Environment](#)
- [4 Instuctions](#)
- [5 Compliance FCC Statement](#)
- [6 Caution](#)
- [7 Frequently Asked Questions \(FAQ\)](#)
- [8 Documents / Resources](#)
 - [8.1 References](#)

Lotus Lantern

Lotus Lantern Software App button type RGB Light Strip

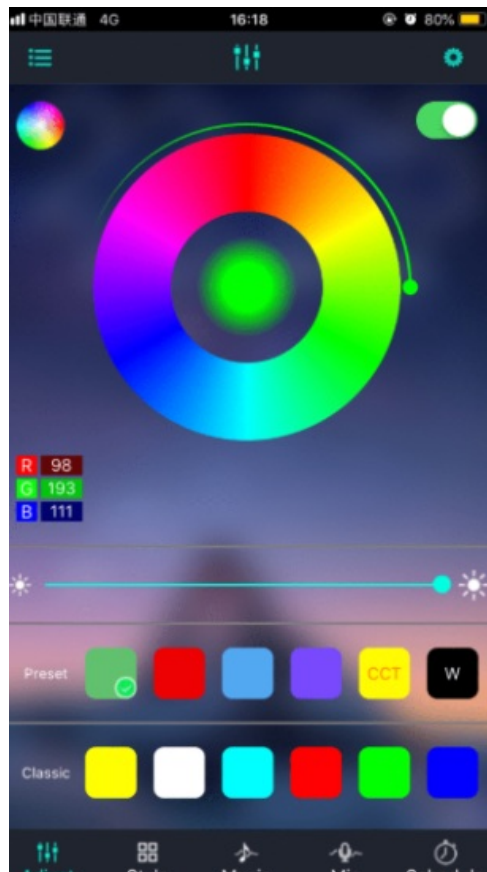

Software Overview

Overview

- LotusLantern is a mobile APP to control LED strip by both Apple and Android phones.
- The traditional control ways like infrared, 433MHz, 2.4GHz and others old wired ways will be replaced by mobile phone control way with convenient, powerful and scalable features.
- Through this mobile APP you can not only control the color, brightness and color temperature of the LED strips but also set up all kinds of fancy flash mode Also this APP can change the light of the LED strip according to the rhythm of the music. This APP can set and control several LED strips through Bluetooth and the operation is very simple, easy to learn and easy to use.

Features

- Adjust color LED strips with 60,000 colors to change color and brightness and adjust monochrome LED strips to change brightness and color temperature
- Play music or turn on a sound playback device, you can let the light change the color and brightness with the rhythm of music, the music rhythm beautiful

- Inside multiple setting mode for color change and control LED strips without mobile
- Long distance control with omni-directional antenna, and many-to-many group control mode
- Once the connection is successful, connect automatically next time

Performance

LotusLantern APP is easy for use as well as great compatible for all kinds of smart phones; After the actual test of hundreds of mobile phones verification, the compatibility is above 95% of mobile phones in the market. APP is small and convenient, it consumes less system resources, so the requirements of the mobile configuration are low. Control delay is small, the operation feel good, light control is smooth with people's visual sense.

Operating Environment

This APP program requires phones of system above Andriod 4.3 and iOS 8.0.
Mobile phone configuration is not limited.

Instuctions

Note: Android version and iOS version download and use the same method, here in the Android version as an example.

APP Download

Scan the QR code

iOS and Android systems can download the "LotusLantern" APP by scanning the QR code. Open the browser or other tools with "Scan QR code" function, scan the "LotusLantern" QR code as below:



App Operation

1. Click on the LotusLantern APP icon, enter the APP page:

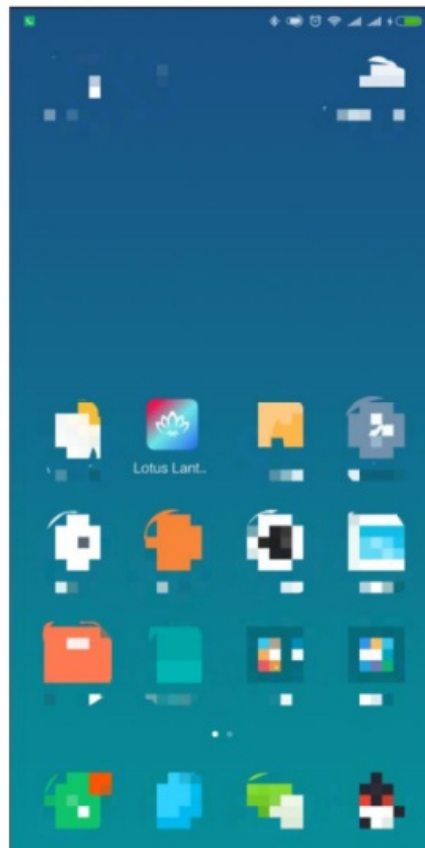

2. After entering the APP interface, if Bluetooth is not enabled, “Louts Lantern wants to turn on Bluetooth.” Click [Allow]

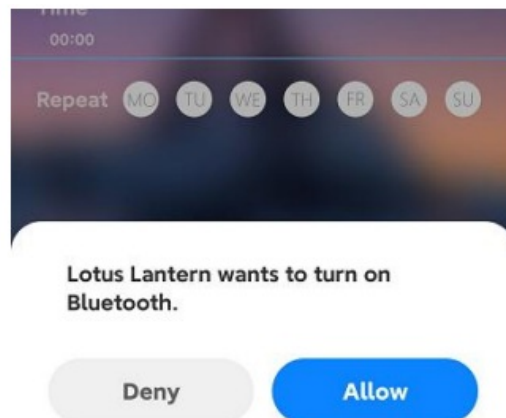

3. Switch to color and brightness interface:

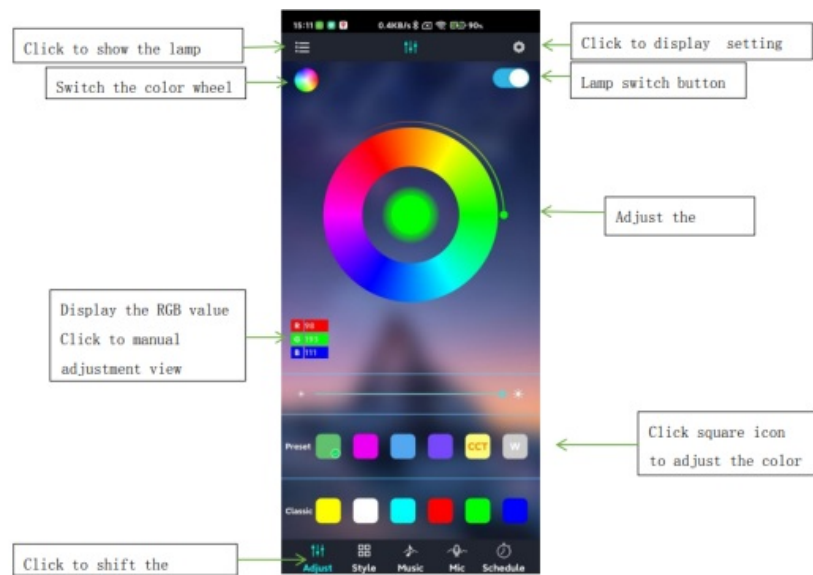

4. Click to show the lamp list, view lamp list:



5. Click to RGB manual adjustment view:

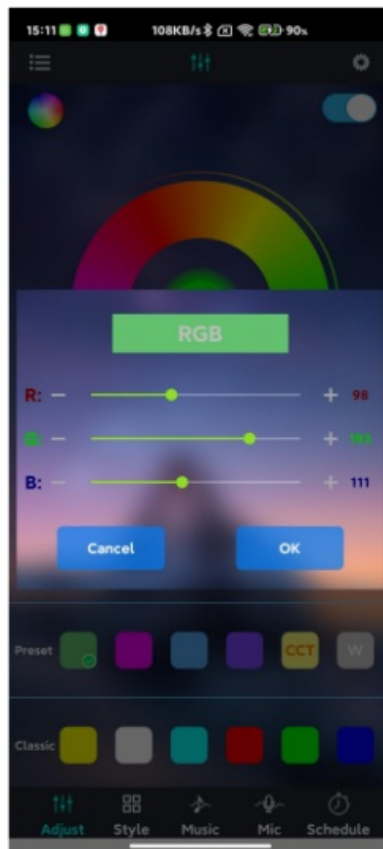

6. Switch to the mode interface:

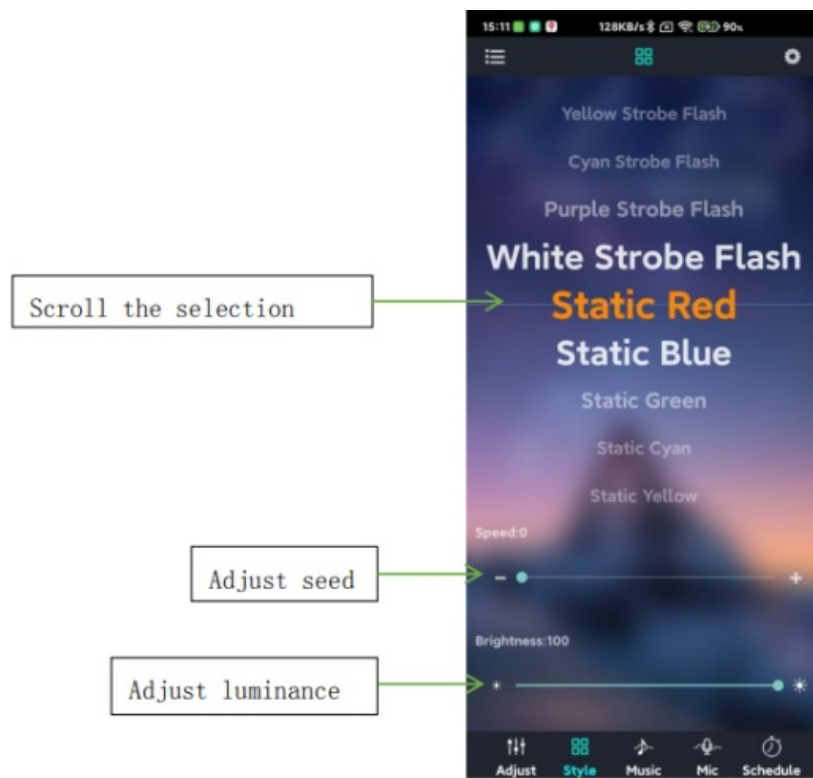

7. Switch to the music rhythm interface:

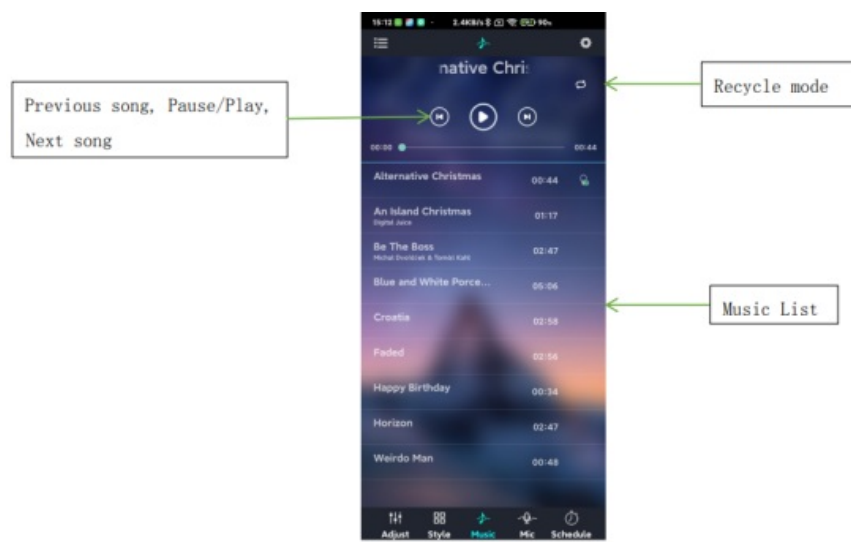

8. Switch to the microphone rhythm interface:



9. Switch to the schedule interface:

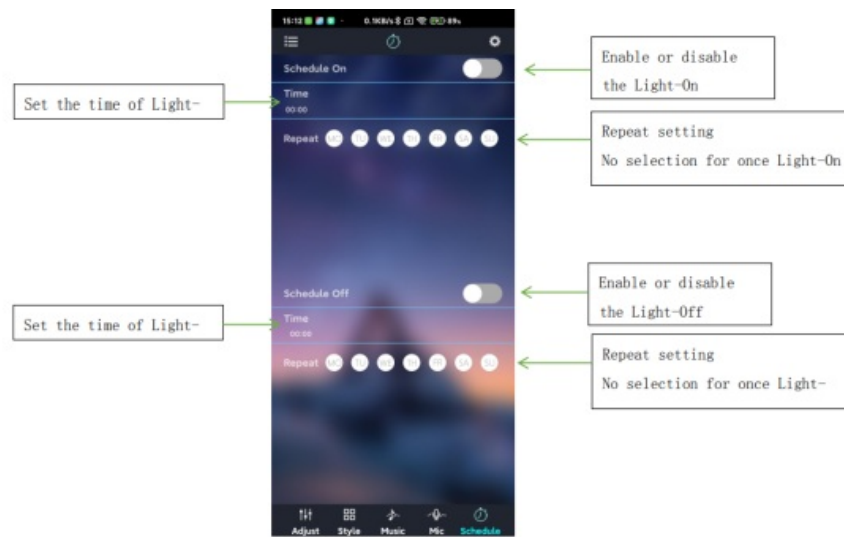

10. Switch to the modify pin sequence interface:

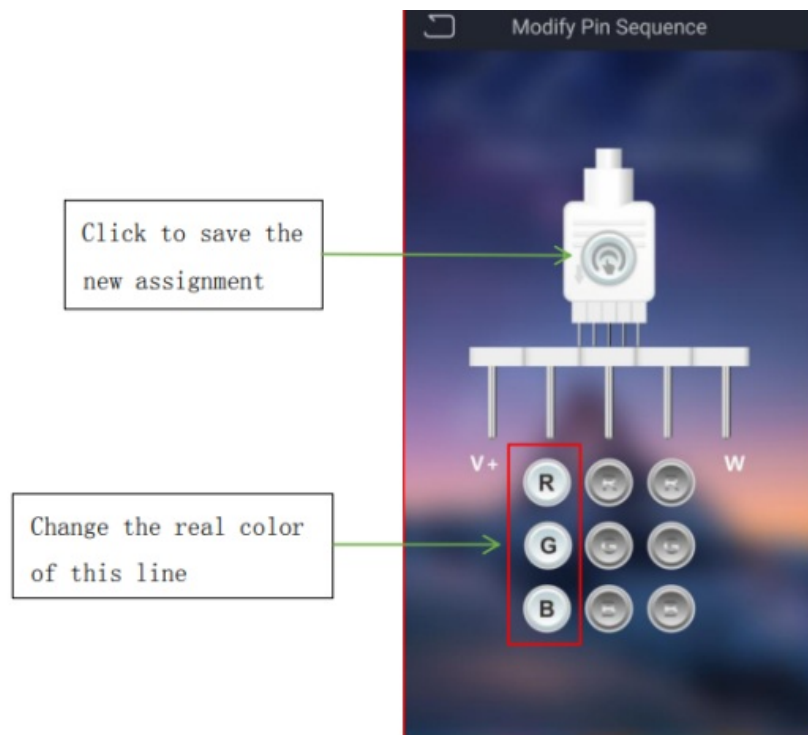

Compliance FCC Statement

This equipment has been tested and found to comply with the limits for a Class B digital device, pursuant to part 15 of the FCC Rules. These limits are designed to provide reasonable protection against harmful interference in a residential installation. This equipment generates, uses, and can radiate radio frequency energy and, if not installed and used in accordance with the instructions, may cause harmful interference to radio communications. However, there is no guarantee that interference will not occur in a particular installation. If this equipment does cause harmful interference to radio or television reception, which can be determined by turning the equipment off and on, the user is encouraged to try to correct the interference by one or more of the following

measures:

- Reorient or relocate the receiving antenna.
- Increase the separation between the equipment and receiver.
- Connect the equipment to an outlet on a circuit different from that to which the receiver is connected.
- Consult the dealer or an experienced radio/ TV technician for help.

This device complies with part 15 of the FCC Rules. Operation is subject to the following two conditions: (1) This device may not cause harmful interference, and (2) this device must accept any interference received, including interference that may cause undesired operation.

Caution

Any changes or modifications not expressly approved by the party responsible for compliance could void the user's authority to operate the equipment.

FCC Radiation Exposure Statement

This equipment must be installed and operated in accordance with the provided instructions and the antenna(s) used for this transmitter must be installed to provide a separation distance of at least 20 cm from all persons and must not be co-located or operating in conjunction with any other antenna or transmitter. End-users and installers must be provided with antenna installation instructions and transmitter operating conditions for satisfying RF exposure compliance

Frequently Asked Questions (FAQ)

- **Q: What devices are compatible with the LotusLantern app?**
 - **A:** The LotusLantern app is compatible with all kinds of smartphones with system versions above Android 4.3 and iOS 8.0.
- **Q: Can I control multiple LED strips simultaneously using the app?**
 - **A:** Yes, you can set and control several LED strips through Bluetooth easily using the LotusLantern app.
- **Q: How many colors can be adjusted for color LED strips?**

- **A:** You can adjust color LED strips with up to 60,000 colors using the LotusLantern app.

Documents / Resources

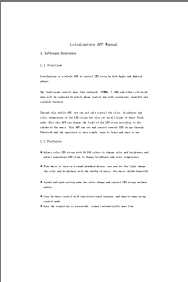
	Lotus Lantern Software App button type RGB Light Strip [pdf] User Manual 2BPVW-RGB, 2BPVWRGB, Software App button type RGB Light Strip, App button type RGB Light Strip, RGB Light Strip, Light Strip, Strip
---	---

References

- [User Manual](#)

Lotus
Lantern

2BPVW-RGB, 2BPVWRGB, App button type RGB Light Strip, Light Strip, Lotus Lantern, RGB Light Strip, Software App button type RGB Light Strip, strip

Leave a comment

Your email address will not be published. Required fields are marked *

Comment *

Name

Email

Website

☐ Save my name, email, and website in this browser for the next time I comment.

Post Comment

Search:

e.g. whirlpool wrf535swhz

Search

[Manuals+](#) | [Upload](#) | [Deep Search](#) | [Privacy Policy](#) | [@manuals.plus](#) | [YouTube](#)

This website is an independent publication and is neither affiliated with nor endorsed by any of the trademark owners. The "Bluetooth®" word mark and logos are registered trademarks owned by Bluetooth SIG, Inc. The "Wi-Fi®" word mark and logos are registered trademarks owned by the Wi-Fi Alliance. Any use of these marks on this website does not imply any affiliation with or endorsement.