



Loti-BOT IT10415 Block Based Programmable Robot User Guide

[Home](#) » [Loti-BOT](#) » Loti-BOT IT10415 Block Based Programmable Robot User Guide 

Contents

- [1 Loti-BOT IT10415 Block Based Programmable Robot](#)
- [2 WHAT'S IN THE BOX](#)
- [3 SETTINGS](#)
- [4 POWER AND CONNECT](#)
- [5 USING INSTRUCTIONS](#)
- [6 BATTERY](#)
- [7 Statements](#)
- [8 FCC Statements](#)
- [9 Charging Cable Statements](#)
- [10 More information At](#)
- [11 Documents / Resources](#)
 - [11.1 References](#)



Loti-BOT IT10415 Block Based Programmable Robot



WHAT'S IN THE BOX

Loti-Bot

USB Cable

Quick start
guide

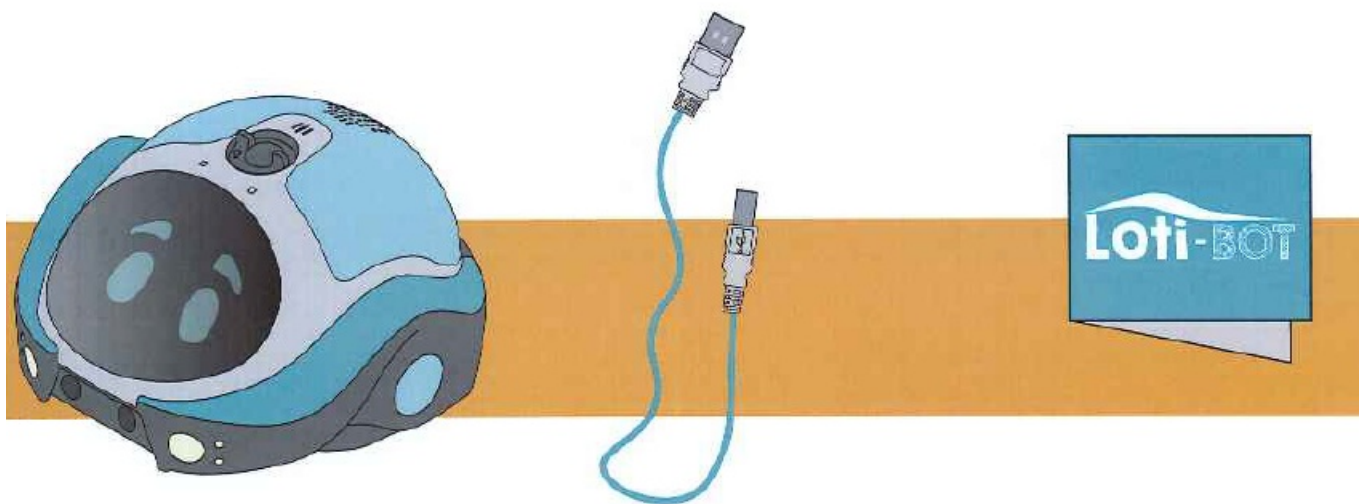

SETTINGS



USING INSTRUCTIONS

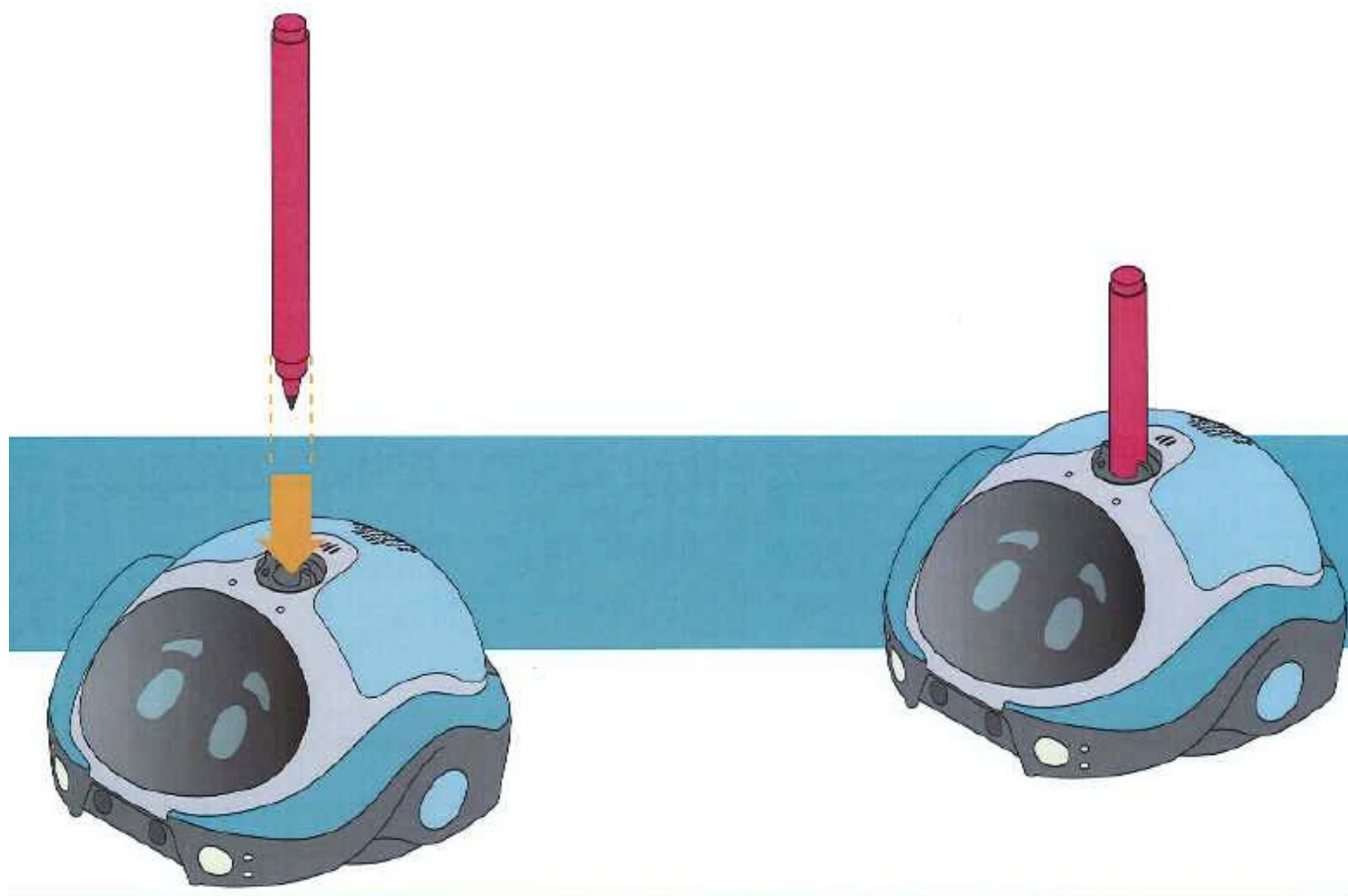

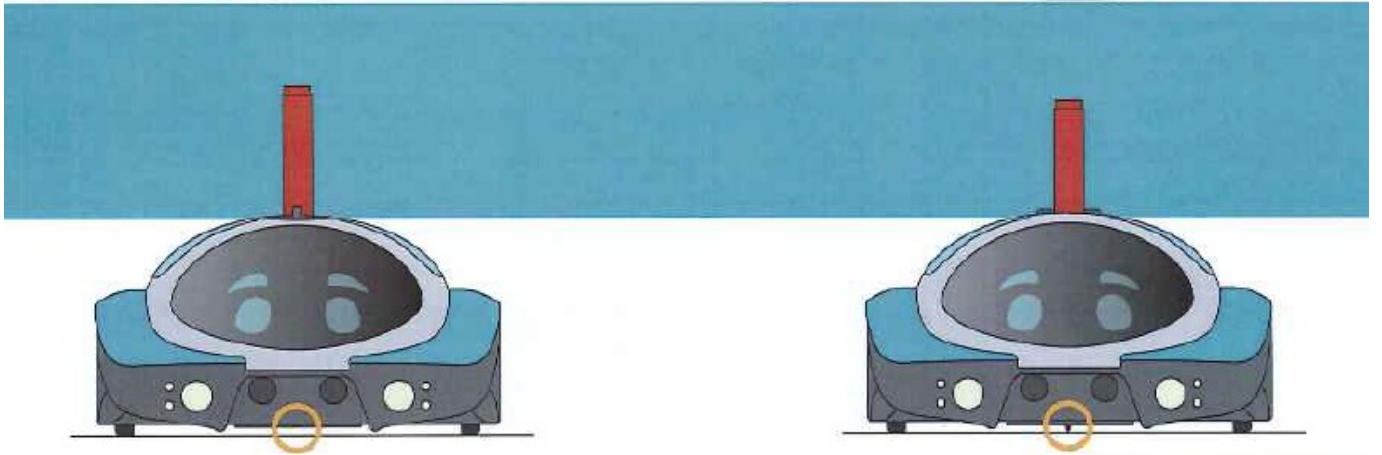
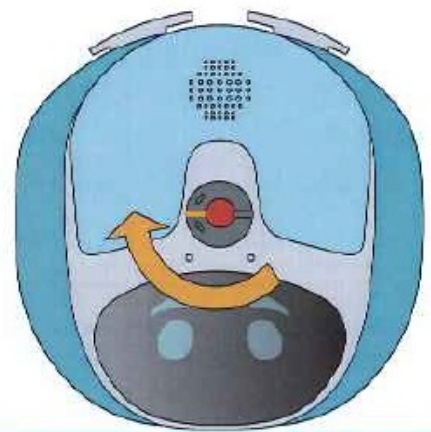
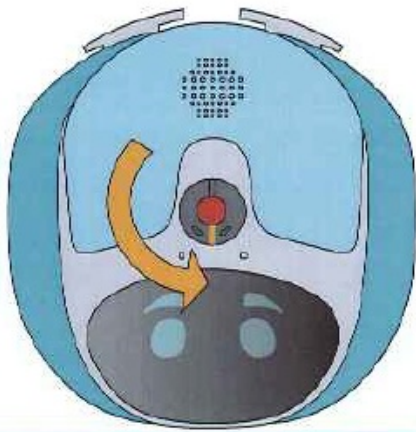

BLUETOOTH CONNECT

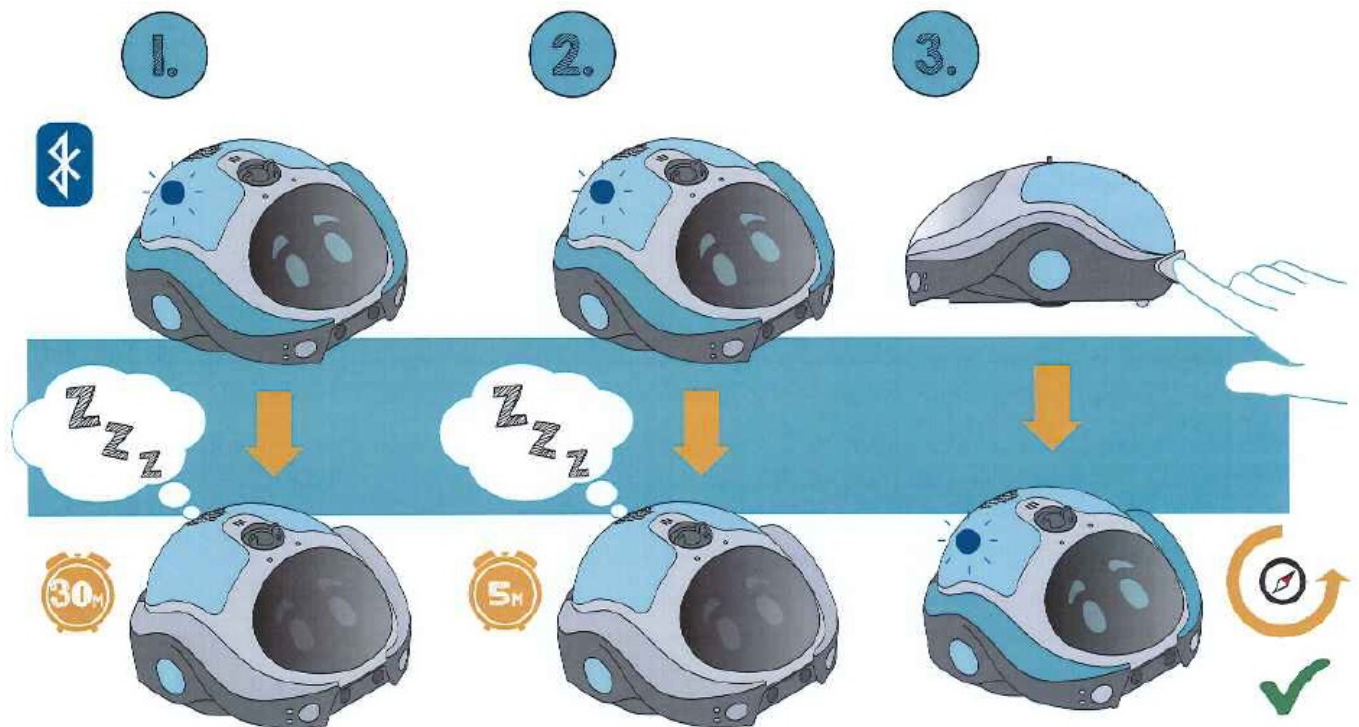

BATTERY

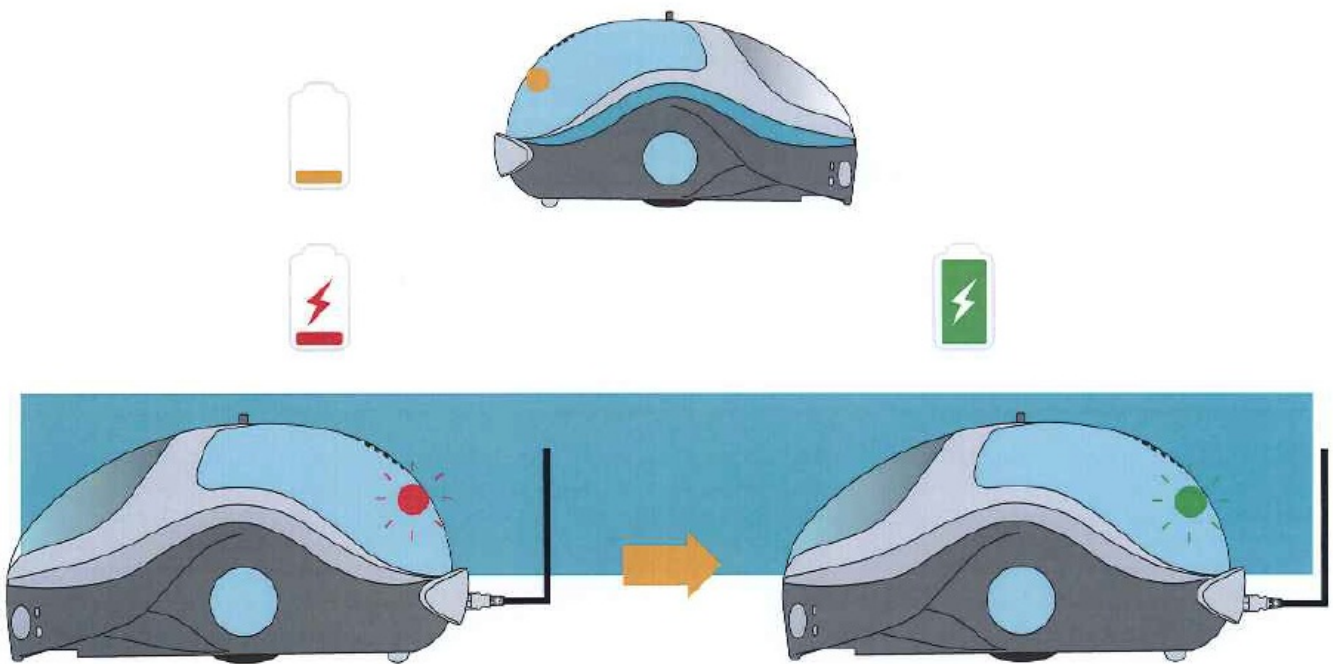

Statements

WEEE Statements

Waste Electrical and Electronics Equipment (WEEE) – When this appliance is out of use, please remove all batteries and dispose of them separately. Bring electrical appliances to the local collecting points for waste electrical and electronic equipment. Other components can be disposed of in domestic refuse.

Directive 2014/53/EU Statements

- RM Resources hereby declares that this wireless device – IT10415 Loti-Bot is in compliance with Directive 2014/53/EU.

EU Conformity Statements

- The full text of the EU declaration of Conformity is available at the following internet address – <https://www.tis-group.co.uk/DoCs.html>

FCC Statements

This device complies with part 15 of the FCC Rules. Operation is subject to the following two conditions:

1. this device may not cause harmful interference.
2. this device must accept any interference received, including interference that may cause undesired operation.

Note: This equipment has been tested and found to comply with the limits for a Class B digital device, pursuant to part 15 of the FCC Rules. These limits are designed to provide reasonable protection against harmful interference in a residential installation. This equipment generates, uses, and can radiate radio frequency energy which, if not properly installed and used, may cause harmful interference to radio communications. However, there is no guarantee that interference will not occur in a particular installation. If this equipment does cause harmful interference to radio or television reception, which can be determined by turning the equipment off and on, the user is encouraged to try to correct the interference by one or more of the following

measures:

- Reorient or relocate the receiving antenna.
- Increase the separation between the equipment and receiver.
- Connect the equipment to an outlet on a circuit different from that to which the receiver is connected.
- Consult the dealer or an experienced radio/TV technician for help.

Warning: Changes or modifications not expressly approved by the party responsible for compliance could void the user's authority to operate the equipment.

USB Statements



- This toy is only to be connected to equipment bearing either of the following symbols.

RF warning for Mobile device

- This equipment complies with FCC radiation exposure limits set forth for an uncontrolled environment.
- This equipment should be installed and operated with minimum distance 20cm between the radiator & your body.

Please retain this manual as it contains important information.
If necessary, wipe the product gently with a clean damp cloth.

Charging Cable Statements

- Chargers used with the toy are to be regularly examined for damage to the cord, plug, enclosure and other parts, and that, in the event of such damage, the toy must not be used with the charger until the damage has been repaired
- Under the environment with electrostatic discharge, the toy may malfunction and require user to reset the toy.
- Please remove the USB cable after charging and keep away from children.

Rechargeable Batteries Statements

- For electric toys using rechargeable batteries, the batteries should be charged under adult supervision.

Battery Replacement

- To replace the batteries, remove the battery hatch cover with a screwdriver and responsibly dispose of any exhausted batteries.
- Insert new batteries, following the polarity marking on the product.

Battery Information

- Batteries are to be inserted with the correct polarity.

- The supply terminals are not to be short-circuited.
- Only batteries of equal size and type should be used.
- Non-rechargeable batteries are not to be recharged.
- Do not mix different types, or old and new batteries.
- Replacement of batteries should only be performed by an adult, and all batteries should be stored out of reach of children.
- Please ensure batteries are removed from the product before storage.

More information At

- www.tts-group.co.uk
- **RM Resources**
 - Building 1 Heyworth Road Hucknall, NG15 6XJ, UK
- **RM Resources**
 - Papendorp Park Papendorpseweg 100 Utrecht 3528 BJ Netherlands
- **Tel:** 0800 138 1370
- **Fax:** 0800 137 525

Please retain this manual as it contains important information

Chargers used with the toy are to be regularly examined for damage to the cord, plug, enclosure and other parts, and that, in the event of such damage, the toy must not be used with the charger until the damage has been repaired. Under the environment with electrostatic discharge, the toy may malfunction and require user to reset the toy. Rechargeable batteries should be charged under adult supervision. This toy contains batteries that are replaceable.

Battery: DC 3.7V, 2600mAh Lithium polymer (replaceable)

Frequency Band Range: 2.402 – 2.480 GHz

Maximum Radio – Frequency Power: <10mW

Made in China on behalf of RM Resources

Product Code: IT10415

FCC ID – 2ADRE-IT10415

Documents / Resources



[Loti-BOT IT10415 Block Based Programmable Robot](#) [pdf] User Guide

IT10415 Block Based Programmable Robot, IT10415, Block Based Programmable Robot, Base d Programmable Robot, Programmable Robot, Robot

References

- [User Manual](#)

[Manuals+](#), [Privacy Policy](#)