



## LOREX SL300 2K Wi-Fi Smart Lightbulb Camera User Guide

[Home](#) » [Lorex](#) » LOREX SL300 2K Wi-Fi Smart Lightbulb Camera User Guide 

### Contents

- [1 LOREX SL300 2K Wi-Fi Smart Lightbulb Camera](#)
- [2 Product Information](#)
- [3 Product Usage Instructions](#)
- [4 FAQ](#)
- [5 What's Included](#)
- [6 Safety Information](#)
- [7 Overview](#)
- [8 Status Indicator](#)
- [9 Installation](#)
- [10 Connecting to the Lorex App](#)
- [11 FCC Statement](#)
- [12 Documents / Resources](#)
  - [12.1 References](#)



**LOREX SL300 2K Wi-Fi Smart Lightbulb Camera**



## Product Information

### Specifications

- **Model:** SL300
- **Product Name:** 2K Wi-Fi Smart Lightbulb Camera
- **Socket Compatibility:** E27 (E26 Compatible)
- **Features:** LED Light, Microphone, Speaker, Camera Lens, IR Lights, Status Indicator, Reset Button, MicroSD Card Slot

## Product Usage Instructions

### Safety Information

Ensure the power is off before installation to prevent electrical hazards.

### Installation

1. Turn off the light switch.
2. Screw the lightbulb camera into an E26/E27 light socket.
3. Do not turn on the light until the app setup is complete.

### Connecting to the Lorex App

1. Download the Lorex App from your app store or scan the QR code.
2. Create a new Lorex account or log in to an existing one.
3. Turn on the light to power your lightbulb camera and follow the on-screen instructions.
4. In the app, add a new device and scan the QR code on the packaging or the camera.
5. Confirm the Device ID and connect to the camera's hotspot.
6. Set a device password, connect to your Wi-Fi network, and adjust settings as needed.
7. Name your device and complete the optional cloud storage setup if desired.

## Status Indicator

The status indicator provides visual cues about the camera's operation. Refer to the manual for specific status indications.

## FAQ

- **Q: What should I do if I cannot see the device hotspot in the app?**
  - **A:** If the device hotspot is not visible, try opening your phone's Wi-Fi settings and selecting SL300-XXXX. If it still doesn't show up, reset the device and restart the setup process.
- **Q: How can I adjust the camera's view orientation?**
  - **A:** During setup in the Lorex App, you can select the installation orientation to adjust the camera's view as needed.

## What's Included

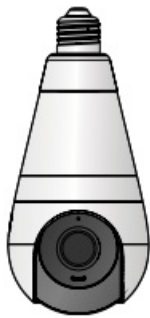

2K Wi-Fi Smart  
Lightbulb Camera



Quick Start Guide

## Safety Information

- **WARNING:** Risk of electric shock – Always turn off the light switch before installation or replacement. Never disassemble the device.
- **WARNING:** Secure the device firmly to prevent falls or injury.
- **WARNING:** Keep out of reach of children.
- Operate only within specified temperature and humidity ranges.
- Clean with a dry cloth only.
- Not suitable for emergency lighting.



- Do not use in enclosed fixtures.
- Control brightness and dimming through the app.
- To register your device for warranty, visit [www.lorex.com/warranty](http://www.lorex.com/warranty).

## Overview

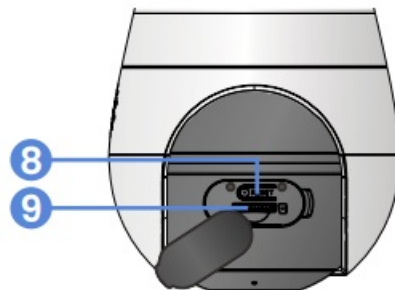
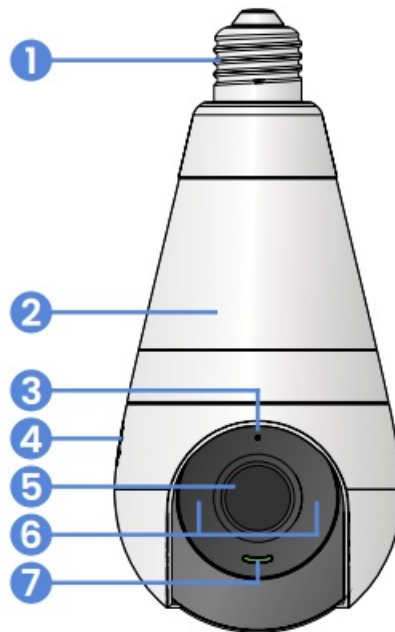
1. E27 Socket (E26 Compatible)
2. LED Light
3. Microphone
4. Speaker
5. Camera Lens
6. IR Lights
7. Status Indicator
8. Reset Button
9. MicroSD Card Slot



## Status Indicator

	Ready for pairing Prêt pour le jumelage Listo para emparejamiento
	Network connection failed La connexion au réseau a échoué Conexión de red fallida
	Operating correctly Bon fonctionnement Funcionamiento correcto
	Starting or resetting Démarrage ou réinitialisation Iniciar o reiniciar
	Updating Mise à jour Actualizando

## Installation

1. Turn off the light.

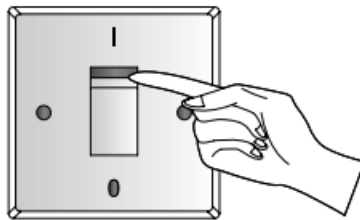

2. Screw the lightbulb camera into an E26/E27 light socket.
  - Do not turn on the light until you have downloaded and logged into the app.

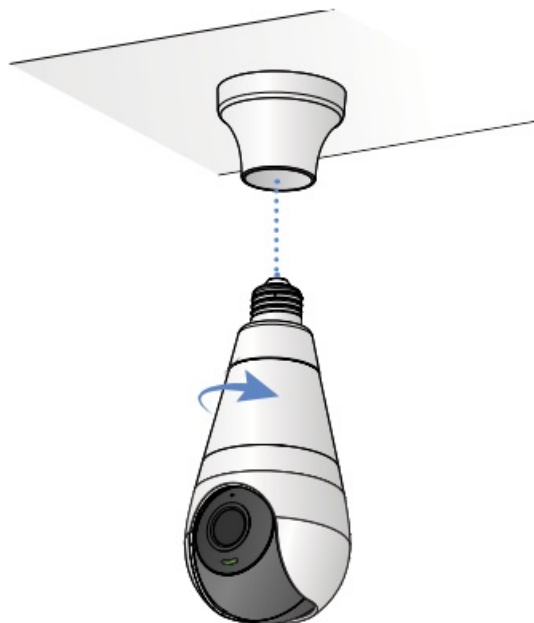

## Connecting to the Lorex App

1. Download the Lorex App by scanning the QR code or searching in your app store.

- If you already have the app, ensure it's up to date.



- **Note:** App screens and steps may change with updates.

2. Sign up for a new Lorex account or log in to your existing one.

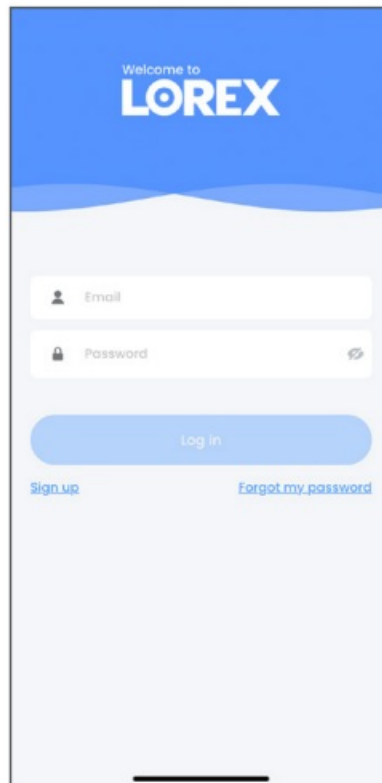

3. Turn on the light to power your lightbulb camera.

- Stay close to the lightbulb camera until setup is complete.

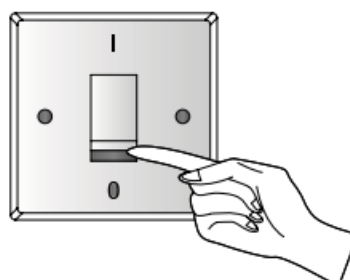
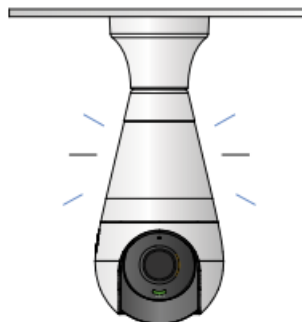

4. In the app, tap the [+] icon to add a new device.

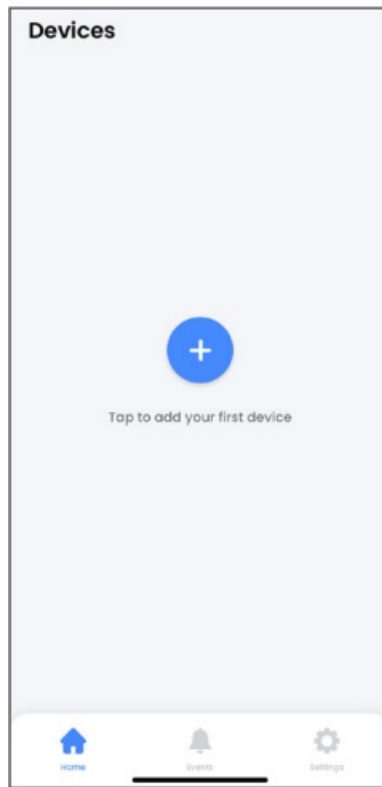

5. Tap “Scan QR Code” and scan the code on the packaging or the lightbulb camera.



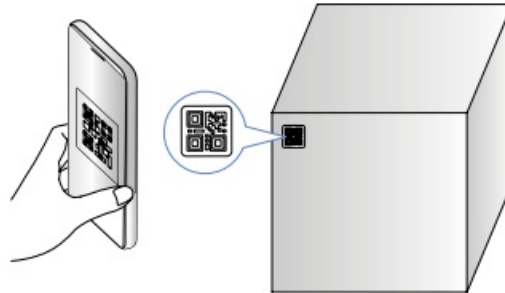
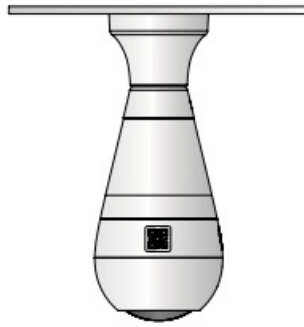

6. A message will confirm when the Device ID is successfully scanned.

7. Join the lightbulb camera's hotspot.

- If it does not show in the app, open your phone's Wi-Fi settings and select "SL300-XXXX." Wait up to two minutes if it is not listed right away.
- If you cannot see the device hotspot after two minutes, please reset the device and restart the camera setup process.

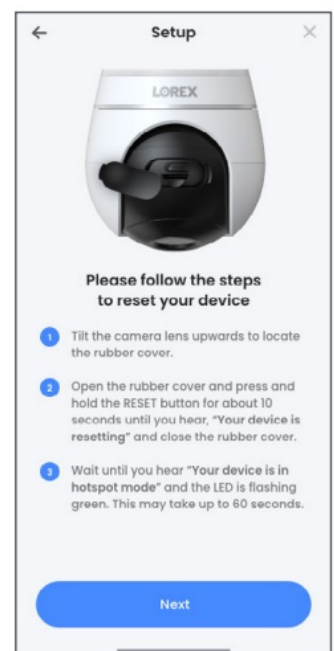
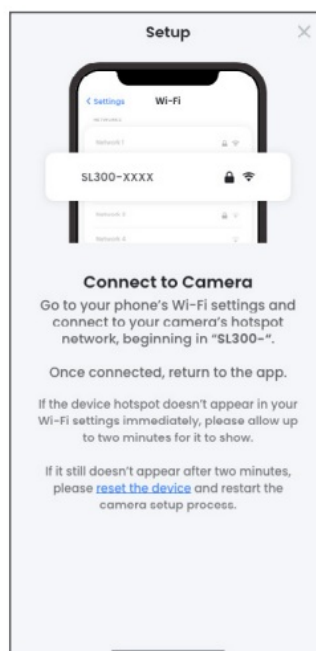
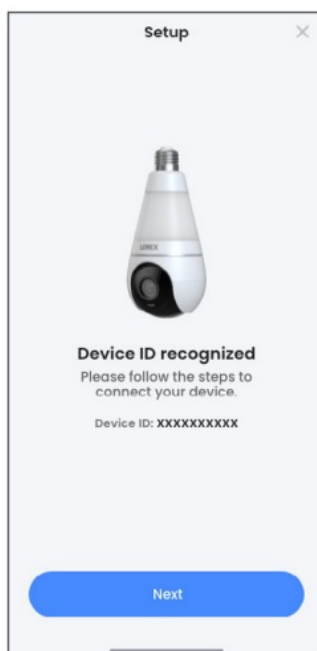

8. Set a device password.

9. Select your Wi-Fi network, enter the password, and connect the lightbulb camera.

10. Enable or disable audio recording and thumbnails.



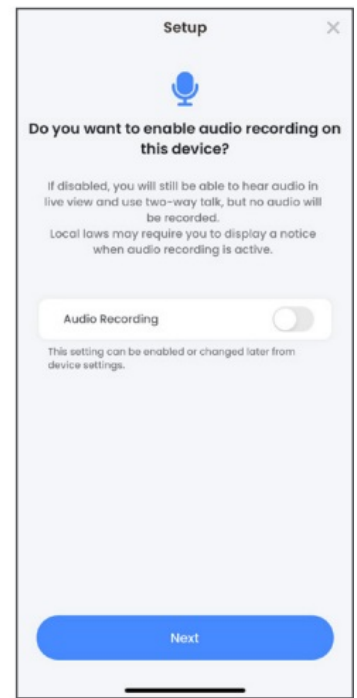
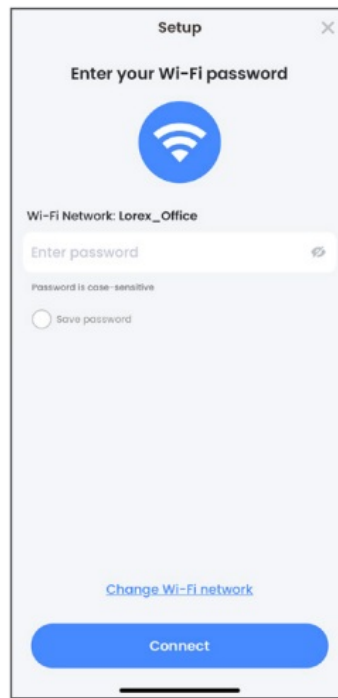
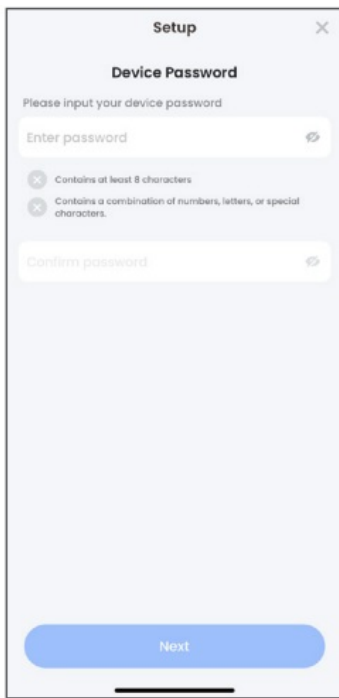

11. Select the lightbulb camera's installation orientation to adjust its view.
12. Name your device.
13. **Optional:** Set up Lorex Cloud Subscription. For cloud storage options, visit [www.lorex.com/cloud](http://www.lorex.com/cloud).

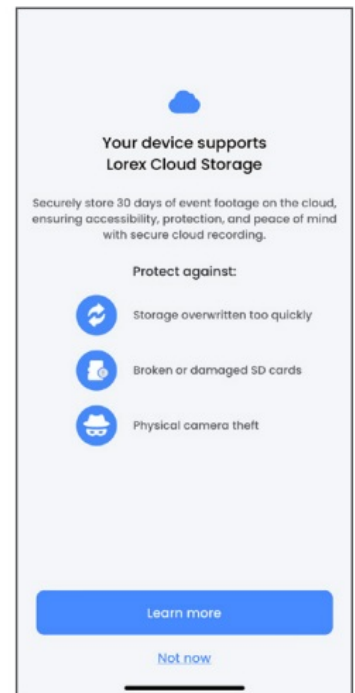
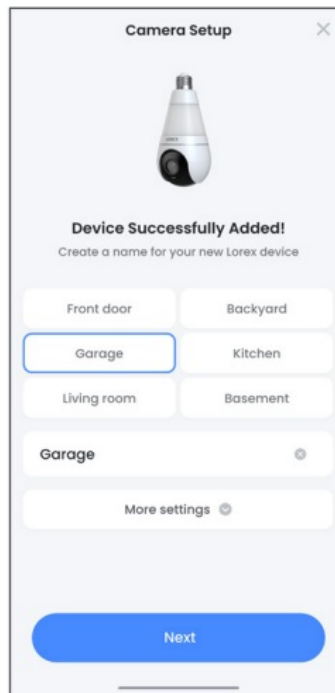
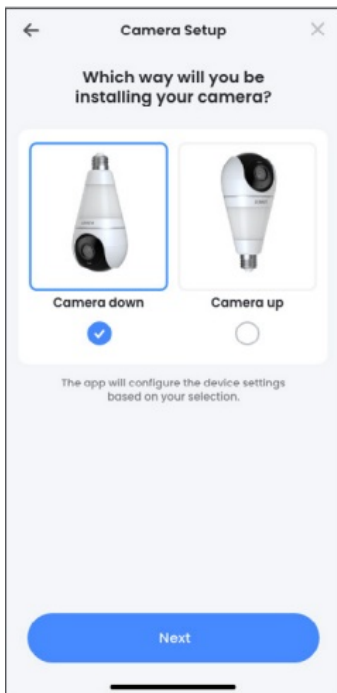

## Need Help?

- For detailed instructions and additional support material, scan the QR code or visit: [www.help.lorex.com/SL300-series](http://www.help.lorex.com/SL300-series).
- Copyright © 2024 Lorex Technology Inc.
- As our products are subject to continuous improvement, Lorex reserves the right to modify product design, specifications and prices, without notice and without incurring any obligation. E&OE. All rights reserved.

## FCC Statement

This device complies with part 15 of the FCC Rules. Operation is subject to the following two conditions:

1. This device may not cause harmful interference,
2. This device must accept any interference received, including interference that may cause undesired operation.

### IC Compliance Statement:

This device complies with Industry Canada's license-exempt RSS standards. Operation is subject to the following two conditions:

1. This device may not cause interference.
2. This device must accept any interference, including interference that may cause undesired operation of the device.

- [www.lorex.com](http://www.lorex.com)
- [www.help.lorex.com/SL300-series](http://www.help.lorex.com/SL300-series)

### Documents / Resources

	<b><a href="#">LOREX SL300 2K Wi-Fi Smart Lightbulb Camera</a></b> [pdf] User Guide SL300, SL300 2K Wi-Fi Smart Lightbulb Camera, 2K Wi-Fi Smart Lightbulb Camera, Smart Lightbulb Camera, Lightbulb Camera, Camera
--	--

### References

-  [Protect What Matters Most - Shop Security Systems & Cameras | Lorex](#)
-  [Lorex Cloud Subscriptions](#)
- [User Manual](#)

#### Manuals+, Privacy Policy

This website is an independent publication and is neither affiliated with nor endorsed by any of the trademark owners. The "Bluetooth®" word mark and logos are registered trademarks owned by Bluetooth SIG, Inc. The "Wi-Fi®" word mark and logos are registered trademarks owned by the Wi-Fi Alliance. Any use of these marks on this website does not imply any affiliation with or endorsement.