

**LOREX E910AB 12MP IP Wired Bullet Security Camera**



# LOREX E910AB 12MP IP Wired Bullet Security Camera User Guide

[Home](#) » [Lorex](#) » **LOREX E910AB 12MP IP Wired Bullet Security Camera User Guide** 

## Contents

- [1 LOREX E910AB 12MP IP Wired Bullet Security Camera](#)
- [2 Safety Precautions](#)
- [3 What's Included](#)
- [4 Overview](#)
- [5 Camera Placement Tips](#)
- [6 Mounting Your Camera](#)
- [7 Weather-resistant Cap](#)
- [8 Documents / Resources](#)
  - [8.1 References](#)
- [9 Related Posts](#)

**LOREX<sup>®</sup>**

**LOREX E910AB 12MP IP Wired Bullet Security Camera**





## Safety Precautions

- Follow all instructions for safe use and handling of the product.
- Use the camera within the given temperature, humidity, and voltage levels noted in the camera specifications.
- Do not disassemble the camera.
- Do not point the camera directly at the sun or a source of intense light.
- Periodic cleaning may be required. Use a damp cloth only. Do not use any harsh, chemical-based cleaners.
- The supplied cable is rated for surface mounting only (Non-UL). Cables for in-wall and floor-to-floor installations are sold separately (CMR type). These and other cables are available at [lorex.com](http://lorex.com).
- It is recommended to connect the camera to the NVR or an external PoE switch.
- If using a power adapter with this camera, a REGULATED power supply is REQUIRED (not included).
- Use of a non-regulated, non-conforming power supply can damage this product and void the warranty.

## Disclaimers

- Use the camera only with compatible Lorex recorders. For a full list, visit [lorex.com/compatibility](http://lorex.com/compatibility).
- Not intended for submersion in water. Installation in a sheltered location is recommended.
- This camera includes an Auto Mechanical IR Cut Filter. When the camera changes between Day/Night viewing modes, an audible clicking noise may be heard from the camera.
- This clicking is normal and indicates that the camera filter is working.
- Audio recording and/or face recording without consent is illegal in certain jurisdictions.
- Lorex Corporation assumes no liability for the use of its products that do not conform with local laws.

## What's Included



**Note:** Based on 1 camera

- **Bullet/E91 OAB**

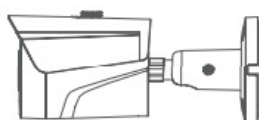

4K+ Bullet Camera



Ethernet Extension Cable

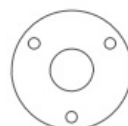

Mounting Template



Anchors & Screws (3×)

- **Dome/E91 ODD**



4K+ Dome Camera



Ethernet Extension Cable



Mounting Template



Anchors & Screws (4×)



Allen Key

## Overview

### Bullet/E91 DAB

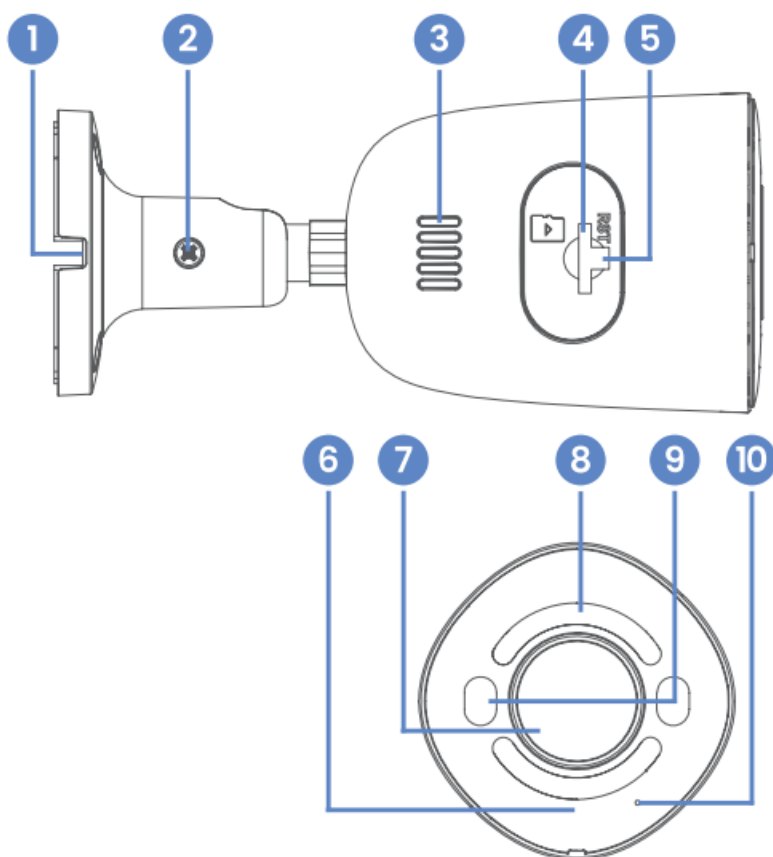

2

1. Cable Notch
2. Adjustment Screw
3. Speaker
4. MicroSD Card Slot
5. Reset Button
6. IR (Infrared) Light
7. Camera Lens
8. Smart Security Lighting



- 9. Warning Lights
- 10. Microphone

### Dome/E91 ODD

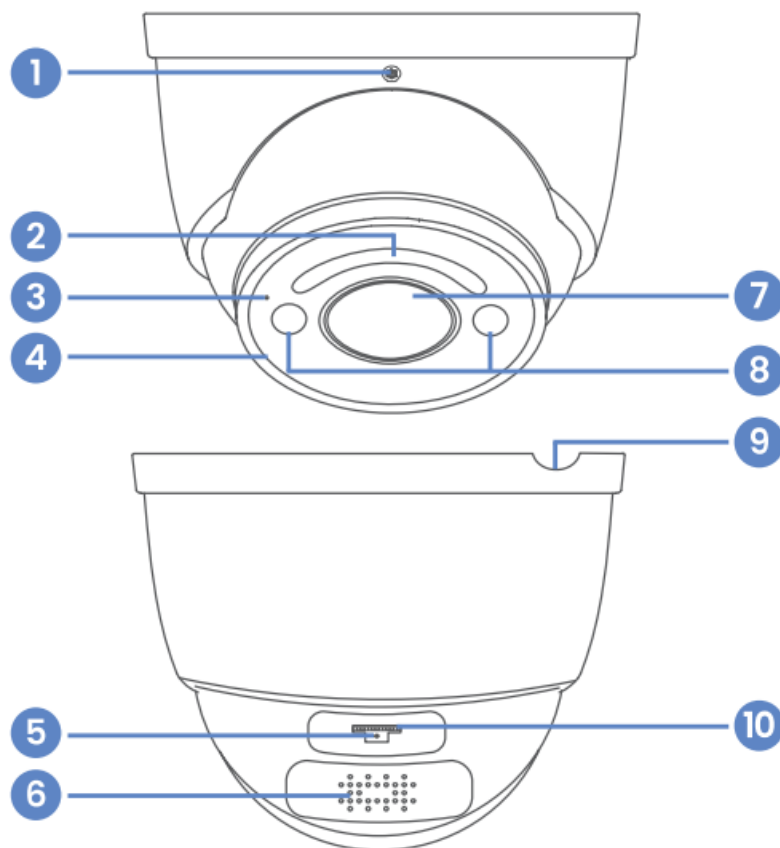

- 1. Adjustment Screw
- 2. Smart Security Lighting
- 3. Microphone
- 4. IR (Infrared) Light
- 5. Reset Button
- 6. Speaker
- 7. Camera Lens
- 8. Warning Lights
- 9. Cable Notch
- 10. MicroSD Card Slot

### Camera Placement Tips

- Take into consideration what you want to monitor and where is the best coverage area.
- Place your camera close to the area of interest.
- Point the camera where there is the least amount of obstructions (i.e. tree branches).
- Install the camera in a location that is difficult for thieves and vandals to reach.
- The best position is 10 ft (3 m) above ground, angled 15° down.
- Secure cabling so that it is not exposed or easily cut.



## Mounting Your Camera

### Bullet/E910AB

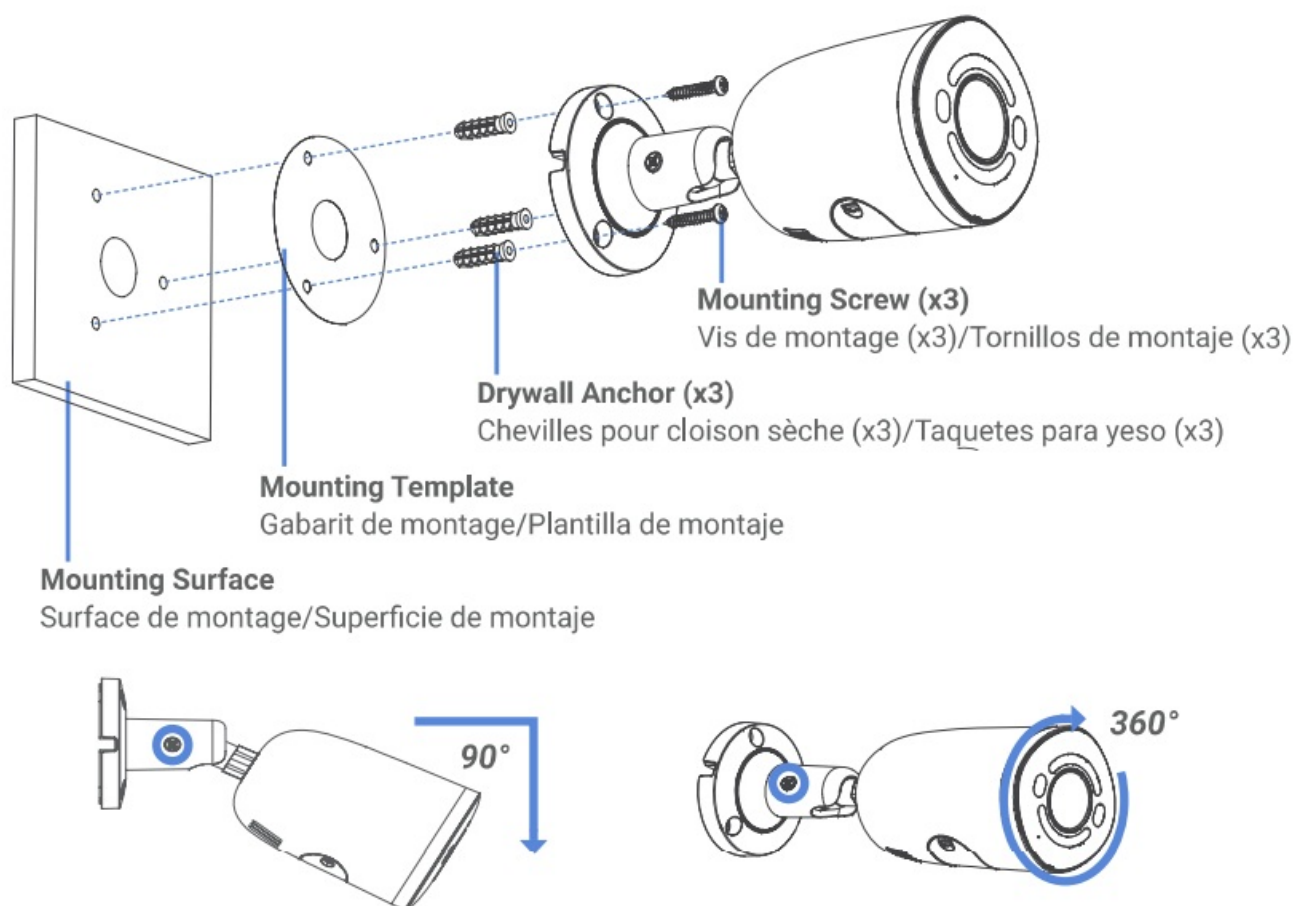

1. Use the mounting template to drill holes for screws, then insert the drywall anchors. Drill a hole for the camera's cable if you plan to run it through the mounting surface.
2. Use the screws to mount the camera base to the surface. If you are running cables along a wall/ceiling, make sure to pass the cable through the cable notch.
3. Feed the camera's cable through the camera base, then connect the cables (see page 14).
4. Loosen the adjustment screw and position your camera as needed, then tighten to secure it in place.
5. Remove the vinyl film from the camera lens once your installation is complete.

### Dome/E910DD



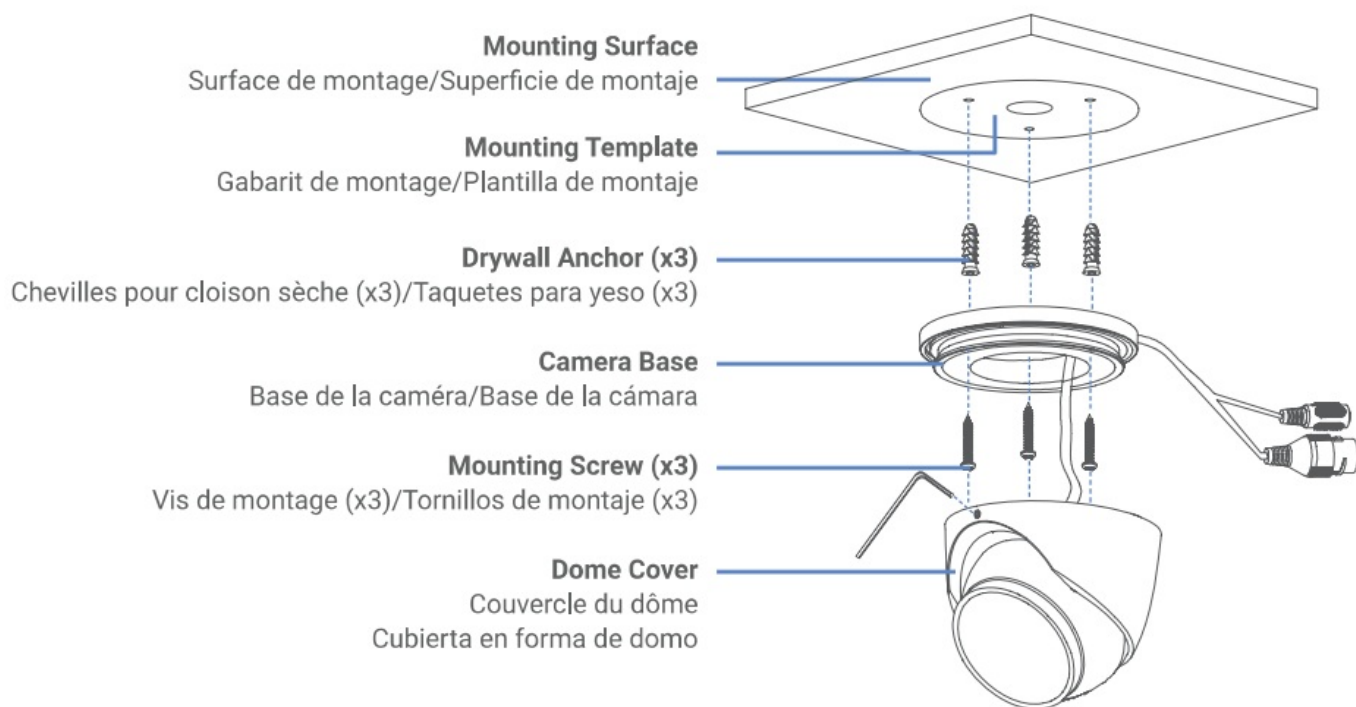

1. Use the mounting template to drill holes for screws, then insert the drywall anchors. Drill a hole for the camera's cable if you plan to run it through the mounting surface.
2. Use the Allen key to loosen the camera's adjustment screw, then remove the dome cover from the camera base.
3. Use the screws to mount the camera base to the surface. If you are running cables along a wall/ceiling, make sure to pass the cable through the cable notch.
4. Feed the camera's cable through the camera base, then connect the cables (see page 14).
5. Angle your dome camera, then use the Allen key to tighten the dome cover firmly onto the camera base.
6. Remove the vinyl film from the camera lens once your installation is complete.

### Connecting Your Camera

Connect your camera directly to your recorder using the camera's Ethernet extension cable.

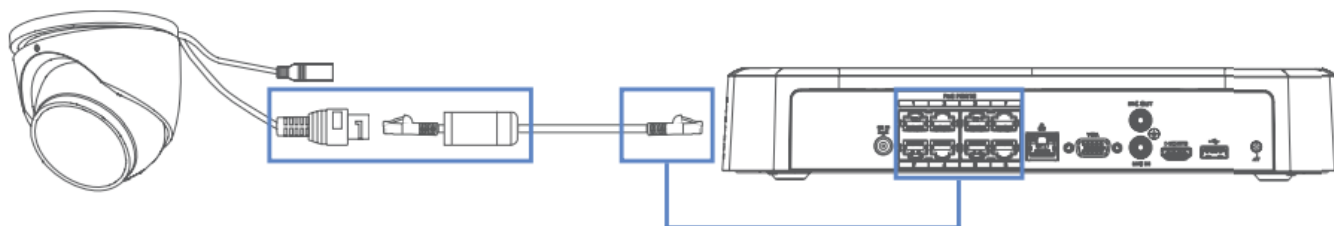

### Weather-resistant Cap

Twist the Ethernet extension cable's pre-attached weather-resistant cap securely onto your camera's Ethernet connector. If exposed to regular precipitation, seal the cap with silicone and electrical tape.



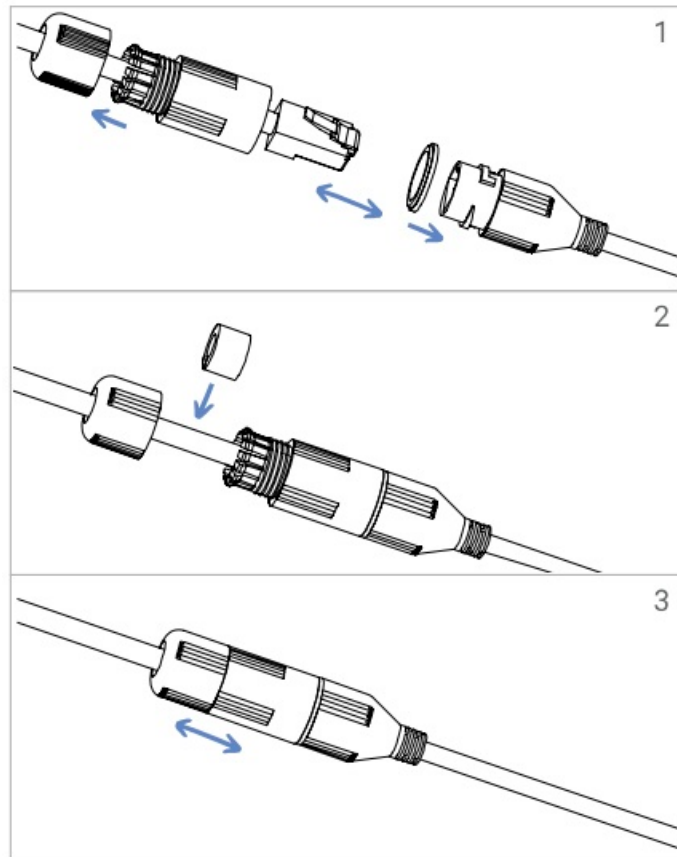

### Need Help?

For related support, scan the QR code or visit:



[help.lorex.com/E910AB](https://help.lorex.com/E910AB)



[help.lorex.com/E910DD](https://help.lorex.com/E910DD)

- [help.lorex.com/E910AB](https://help.lorex.com/E910AB)
- [help.lorex.com/E910DD](https://help.lorex.com/E910DD)

### Register Your Product

Please see our full Terms of Service and Limited Hardware Warranty Policy at: [lorex.com/warranty](https://lorex.com/warranty)

Copyright© 2023 Lorex Technology Inc.

As our products are subject to continuous improvement, Lorex reserves the right to modify product design, specifications and prices, without notice and without incurring any obligation. E&OE. All rights reserved.

[lorex.com](https://lorex.com)  
[help.lorex.com](https://help.lorex.com)

**Documents / Resources**





[LOREX E910AB 12MP IP Wired Bullet Security Camera](#) [pdf] User Guide  
E910AB 12MP IP Wired Bullet Security Camera, E910AB, 12MP IP Wired Bullet Security Came  
ra, Wired Bullet Security Camera, Bullet Security Camera, Security Camera, Camera

References

- [User Manual](#)

[Manuals+](#), [Privacy Policy](#)

This website is an independent publication and is neither affiliated with nor endorsed by any of the trademark owners. The "Bluetooth®" word mark and logos are registered trademarks owned by Bluetooth SIG, Inc. The "Wi-Fi®" word mark and logos are registered trademarks owned by the Wi-Fi Alliance. Any use of these marks on this website does not imply any affiliation with or endorsement.