

# LOREX E896 4K Smart Deterrence IP Wired Bullet Camera User Guide

[Home](#) » [Lorex](#) » LOREX E896 4K Smart Deterrence IP Wired Bullet Camera User Guide 

## LOREX E896 4K Smart Deterrence IP Wired Bullet Camera

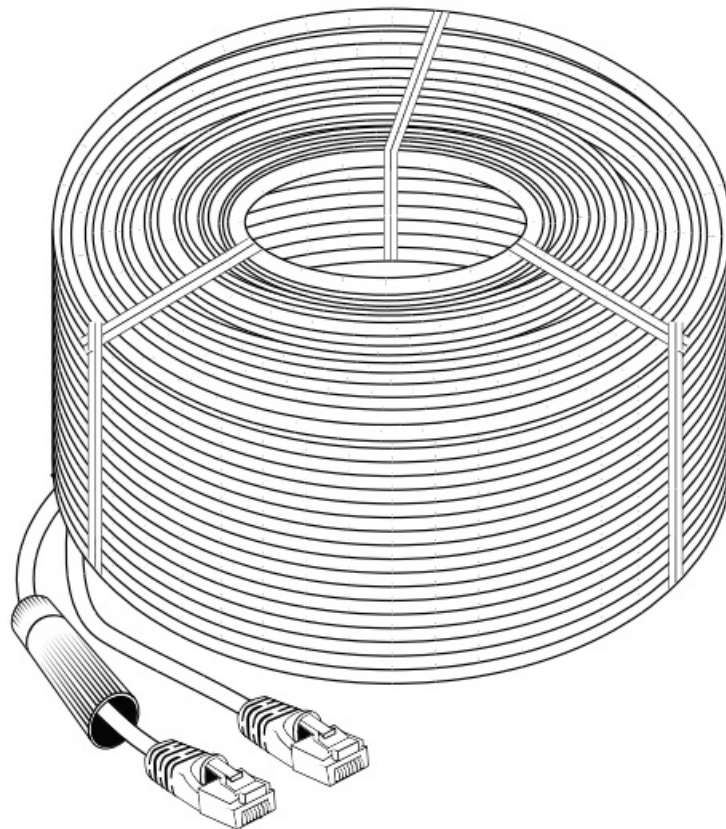

## Contents

- [1 Safety Precautions](#)
- [2 Disclaimers](#)
- [3 Package Contents](#)
- [4 Overview](#)
- [5 Camera Placement Tips](#)
- [6 Mounting Your Camera](#)
- [7 Connecting Your Camera](#)
- [8 Weather-resistant Cap](#)
- [9 Cable Extension Options](#)
- [10 Documents / Resources](#)
  - [10.1 References](#)
- [11 Related Posts](#)

## Safety Precautions

- Follow all instructions for safe use and handling of the product.
- Use the camera within given temperature, humidity and voltage levels noted in the camera specifications .
- Do not disassemble the camera .
- Do not point the camera directly at the sun or a source of intense light.
- Periodic cleaning may be required. Use a damp cloth only. Do not use any harsh, chemical-based cleaners .
- The supplied cable is rated for surface mounting only (Non-UL). Cables for in-wall and floor-to-floor installations are sold separately (CMR type). These and other cables are available at [lorex.com](http://lorex.com).
- It is recommended to connect the camera to the NVR or an external PoE switch. If using a power adapter with this camera, a REGULATED power supply is REQUIRED (not included). Use of a non-regulated, non-conforming power supply can damage this product and voids the warranty.

## Disclaimers

- Use the camera only with compatible Lorex recorders. For a full list, visit [lorex.com/compatibility](http://lorex.com/compatibility).
- Not intended for submersion in water. Installation in a sheltered location recommended.
- This camera includes an Auto Mechanical IR Cut Filter. When the camera changes between Day/Night viewing modes, an audible clicking noise may be heard from the camera. This clicking is normal, and indicates that the camera filter is working.
- Audio recording and/or face recording without consent is illegal in certain jurisdictions. Lorex Corporation assumes no liability for use of its products that does not conform with local laws.

## Package Contents

- 4K Deterrence Bullet AI PoE IP Wired Camera

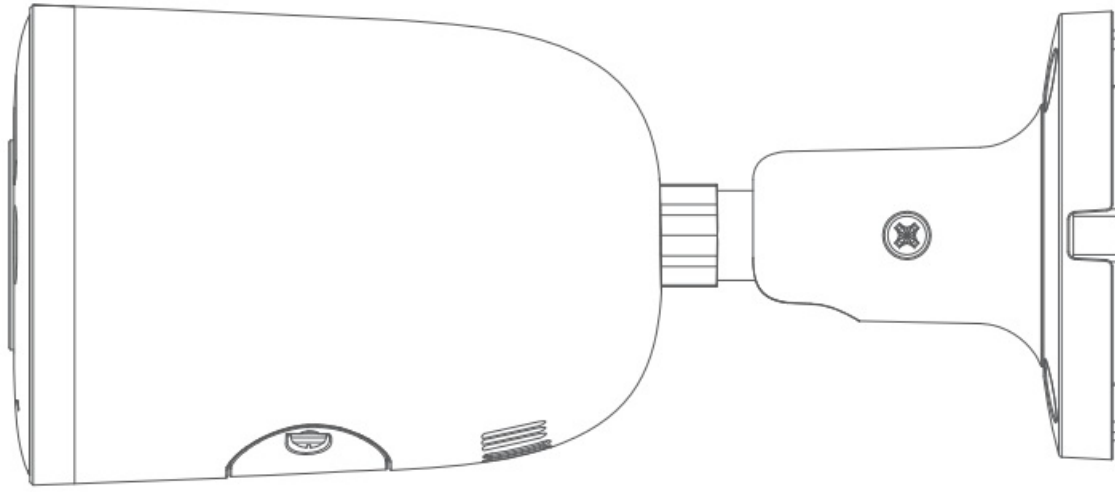

- Mounting Kit\*

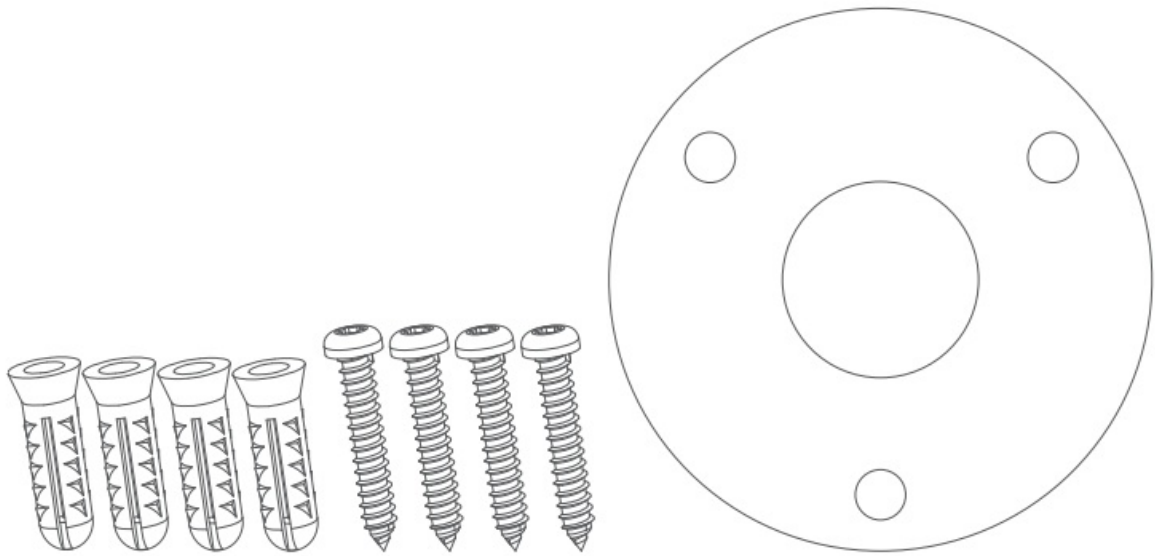

- Ethernet Extension Cable with Pre-attached Weather-resistant Cap\*

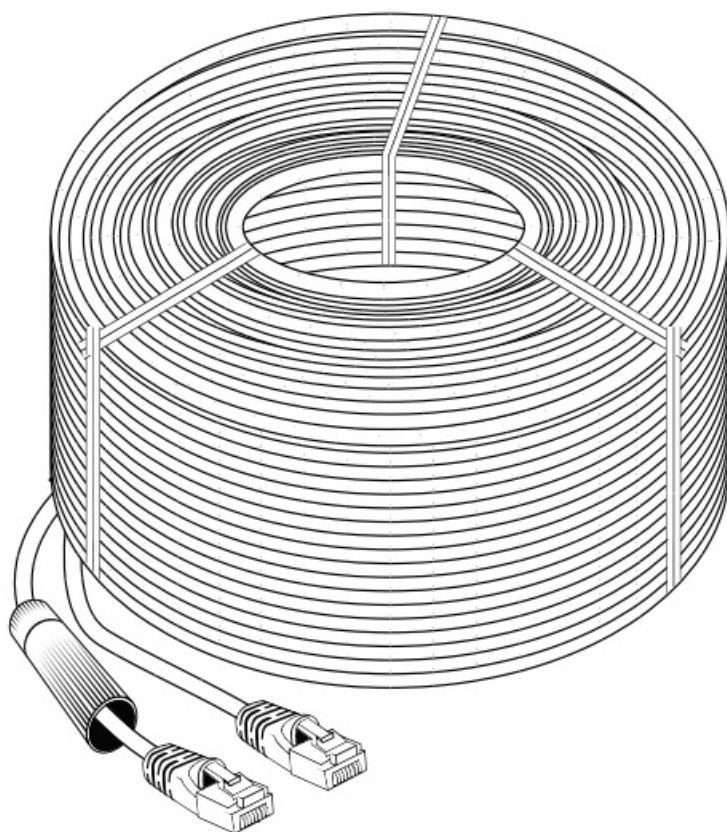

\*Per camera in multi-camera packs.

## Overview

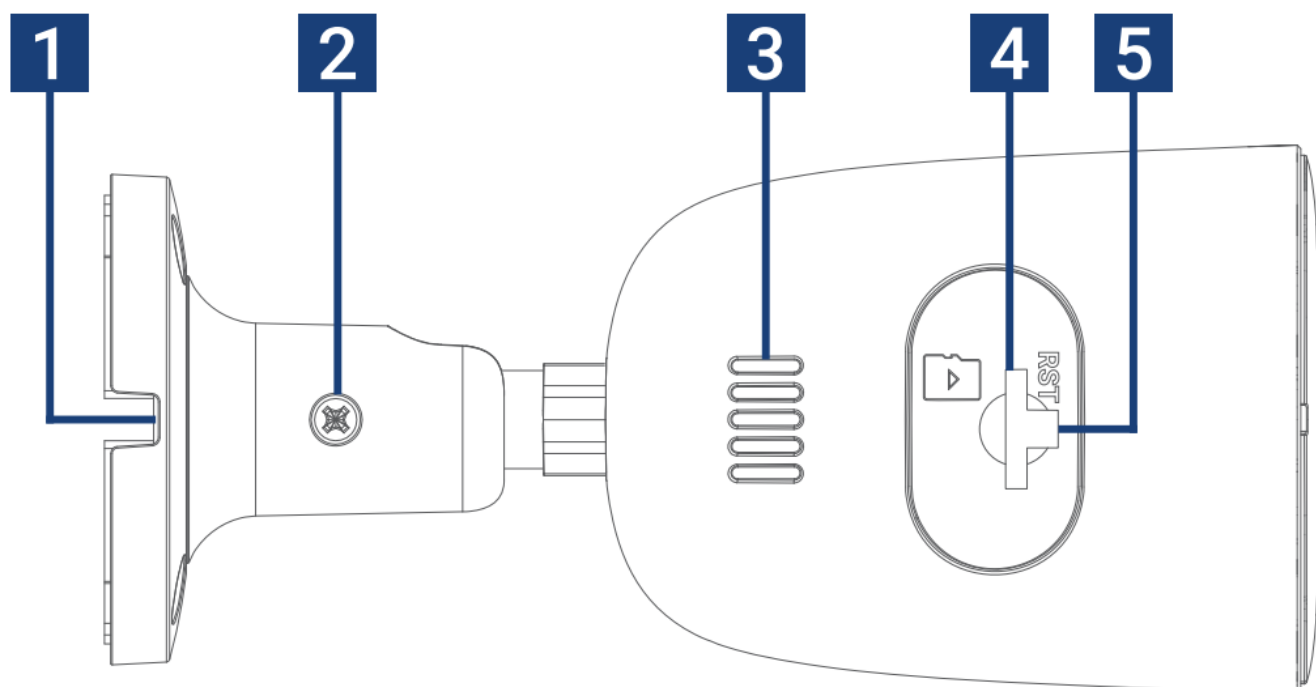

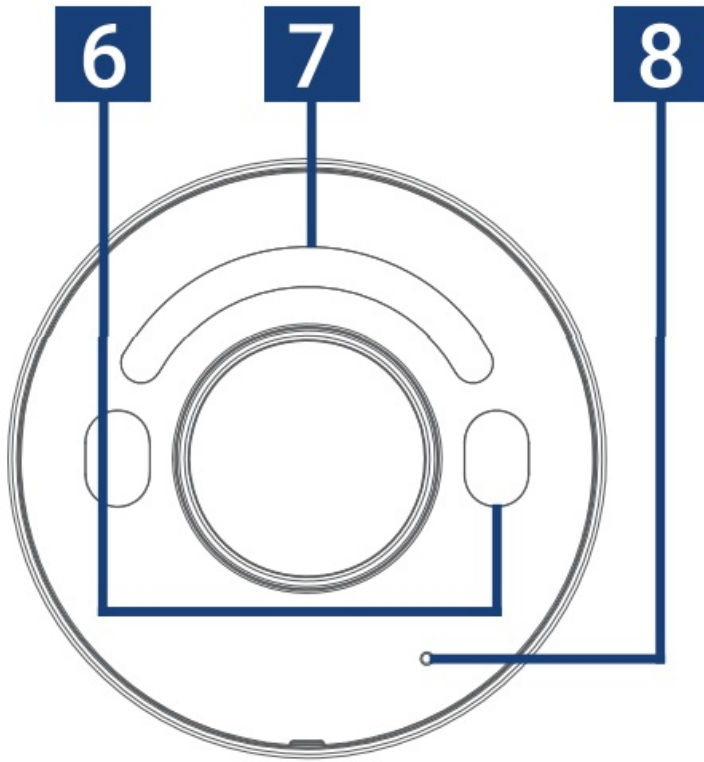

1. Cable Notch
2. Adjustment Screw
3. Speaker and Siren
4. MicroSD Card Slot
5. Reset Button
6. Warning Lights
7. Smart Security Lighting\*
8. Microphone

\*Design differs per camera.

### Camera Placement Tips

- Install the camera in a location that is difficult for thieves and vandals to reach.
- Secure cabling so that it is not exposed or easily cut.
- Point the camera where there is the least amount of obstructions (i.e. tree branches).
- Take into consideration what you want to monitor and where is the best coverage area.
- Place your camera close to the area of interest. The best position is 10ft/3m above ground, angled 15° down.

For smart motion detection tips, scan the QR code or visit:



[help.lorex.com](http://help.lorex.com)

## Mounting Your Camera

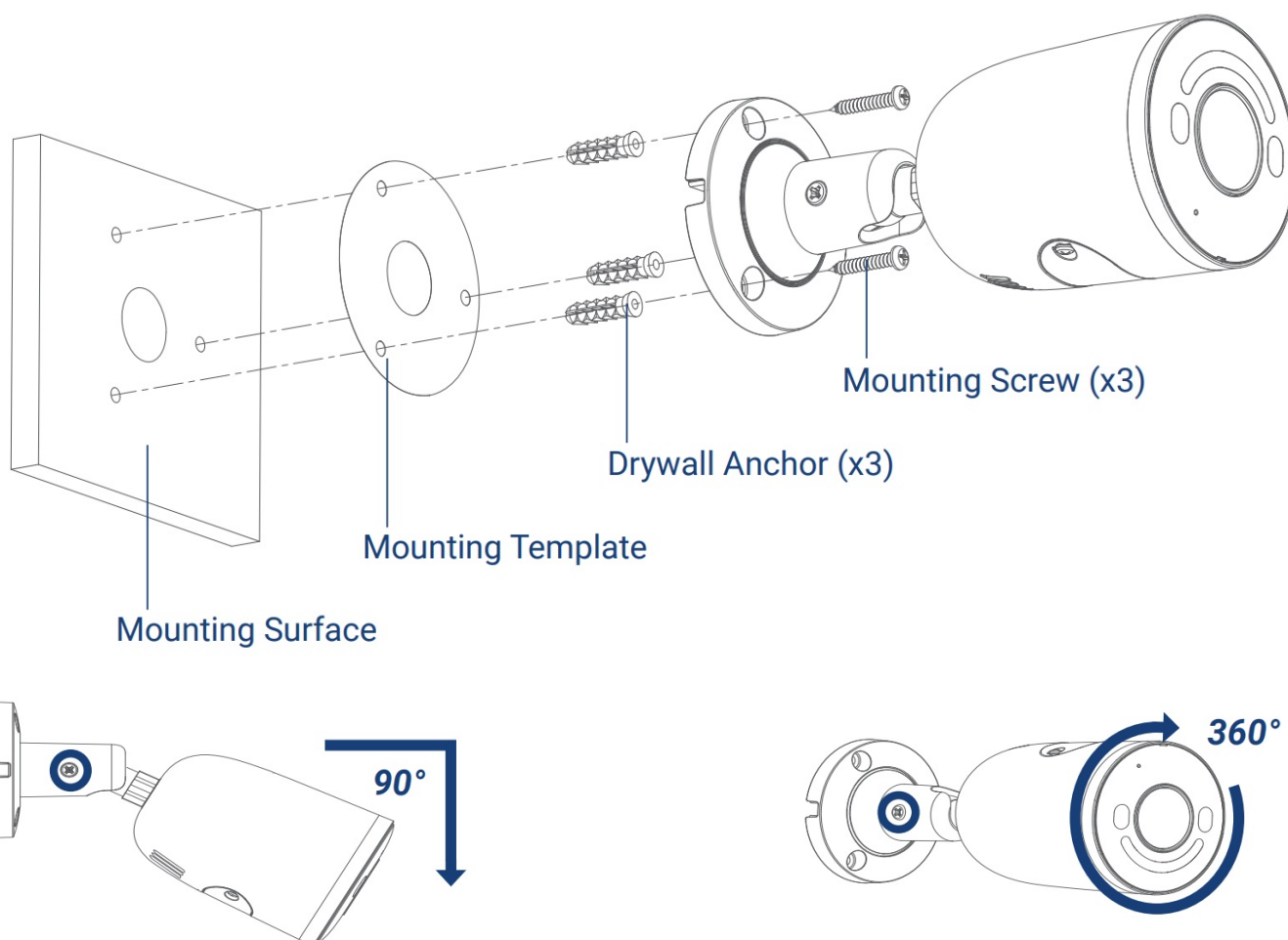

Test your camera prior to selecting a permanent mounting location.

1. Use the included mounting template to drill holes for screws. Insert the included drywall anchors.

- 2. Feed the cable through the mounting surface or your camera’s cable notch, and then connect the cables as shown in “Connecting Your Camera”, pages 7-8.
- 3. Mount the camera stand to the surface using the included screws.
- 4. Loosen the adjustment screw and adjust your camera’s position as needed, and then tighten to secure it in place.
- 5. Remove the vinyl film from your camera lens when your installation is complete.

**Connecting Your Camera**

**Option 1**

Connect your camera directly to your recorder’s PoE port using the included Ethernet extension cable.

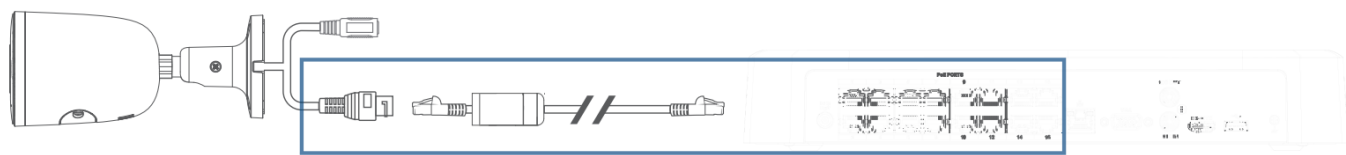

**Option 2**

Connect your camera to a PoE switch on your network using the included Ethernet extension cable. Ensure your switch is connected to the same network as your recorder.

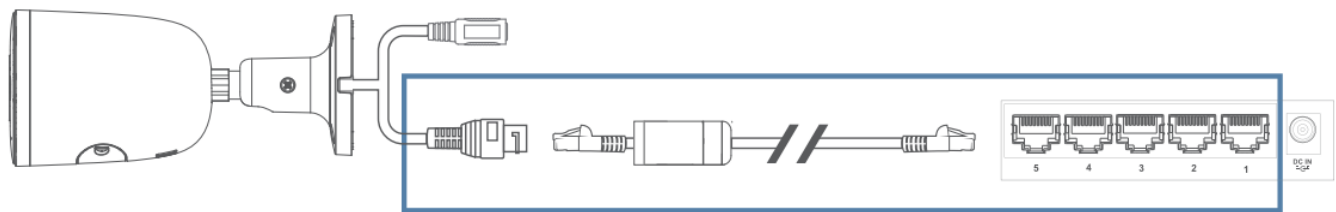

**Weather-resistant Cap**

The pre-attached weather-resistant cap covers both the camera’s Ethernet connector and the Ethernet extension plug to provide protection from weather, dust, dirt and other environmental contaminants. If exposed to regular precipitation, seal the cap with silicone and electrical tape for additional sealing.  
To use the weather-resistant cap: Twist the cap securely onto your camera’s Ethernet connector.



**Cable Extension Options**

To extend the Ethernet cable up to 300ft (91 m), an Ethernet coupler or network switch (not included) will be required to connect the cables together. We recommend using UL CMR approved cables available at [lorex.com](http://lorex.com).

Cable Type	Max. Cable Run Distance	Max. Number of Extensions
CAT5e (or higher) Ethernet Cable	300ft (91 m)	3

**Need Help?**

For up-to-date information and resources, scan the QR code or visit:

- E894



- E895 [help.lorex.com](https://help.lorex.com)



- E896





- Download product guides
- Watch how-to-videos
- Find related troubleshooting tips & FAQs

### **Register your Product**

Please see our full Terms of Service and limited Hardware Warranty Policy at:

[lorex.com/warranty](https://lorex.com/warranty)

Copyright© 2022 Lorex Technology Inc

As our products are subject to continuous improvement, Lorex reserves the right to modify product design, specifications and prices, without notice and without incurring any obligation. E&OE. All rights reserved.



LOREX

Quick Start Guide  
Routin de configuration rapide  
Routin de configuration rapide  
E896 Smart Deterrence  
All trademarks are the property of their respective owners.  
© 2018 Lorex Corporation

## [LOREX E896 4K Smart Deterrence IP Wired Bullet Camera](#) [pdf] User Guide

E896 4K Smart Deterrence IP Wired Bullet Camera, E896, 4K Smart Deterrence IP Wired Bullet Camera, Deterrence IP Wired Bullet Camera, IP Wired Bullet Camera, Bullet Camera

## References

- [🌐 Lorex Technical Support | LOREX Support](#)
- [📺 Security Cameras - Home Security Camera Systems | Lorex](#)
- [📺 Product Compatibility Chart - Expand Your System | Lorex](#)
- [📺 Lorex Limited Warranty - Exceptions, Obligations | Lorex](#)
- [📖 User Manual](#)

### Manuals+, Privacy Policy

This website is an independent publication and is neither affiliated with nor endorsed by any of the trademark owners. The "Bluetooth®" word mark and logos are registered trademarks owned by Bluetooth SIG, Inc. The "Wi-Fi®" word mark and logos are registered trademarks owned by the Wi-Fi Alliance. Any use of these marks on this website does not imply any affiliation with or endorsement.