

Lorex E89 Series IP Wired 4K AI Smart Security Bullet Camera



Lorex E89 Series IP Wired 4K AI Smart Security Bullet Camera Instruction Manual

[Home](#) » [Lorex](#) » Lorex E89 Series IP Wired 4K AI Smart Security Bullet Camera Instruction Manual 

Contents

- [1 Lorex E89 Series IP Wired 4K AI Smart Security Bullet Camera](#)
- [2 Safety Precautions](#)
- [3 What's Included](#)
- [4 Overview](#)
- [5 Camera Mounting](#)
- [6 Camera Connection](#)
- [7 Documents / Resources](#)
 - [7.1 References](#)
- [8 Related Posts](#)



Lorex E89 Series IP Wired 4K AI Smart Security Bullet Camera



Safety Precautions

- Follow all instructions for safe use and handling of the product.
- Use the camera within given temperature, humidity and voltage levels noted in the camera specifications.
- Do not disassemble the camera.
- Do not point the camera directly at the sun or a source of intense light.
- Periodic cleaning may be required. Use a damp cloth only. Do not use any harsh, chemical-based cleaners.
- The supplied cable is rated for surface mounting only {Non-UL}. Cables for in-wall and floor-to-floor installations are sold separately {CMR type}. These and other cables are available at [lorex.com](https://www.lorex.com).
- It is recommended to connect the camera to the NVR or an external PoE switch. If using a power adapter with this camera, a REGULATED power supply is REQUIRED (not included). Use of a non-regulated, non-conforming power supply can damage this product and voids the warranty.

Disclaimers

- Use the camera only with compatible Lorex recorders. For a full list, visit [lorex.com/compatibility](https://www.lorex.com/compatibility).
- Not intended for submersion in water. Installation in a sheltered location recommended.
- This camera includes an Auto Mechanical IR Cut Filter. When the camera changes between Day/Night viewing modes, an audible clicking noise may be heard from the camera. This clicking is normal, and indicates that the camera filter is working.
- Audio recording and/or face recording without consent is illegal in certain jurisdictions. Lorex Corporation assumes no liability for use of its products that does not conform with local laws.

What's Included

Note: Based on 1 camera
E894AB, E895AB, E896AB

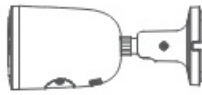

4K Bullet Camera



Mounting Template



Anchors & Screws (4x)



Ethernet Extension Cable

Tools Needed

Drill

E896DD, E896DDB

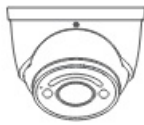

4K Dome Camera

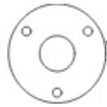

Mounting Template



Anchors & Screws (4x)



Ethernet Extension Cable



Allen Key

Overview

1. Cable Notch
2. Adjustment Screw
3. Speaker & Siren
4. . MicroSD Card Slot
5. Reset Button
6. Smart Security Lighting*
7. Camera Lens
8. Warning Lights
9. Microphone
10. IR (Infrared) Light

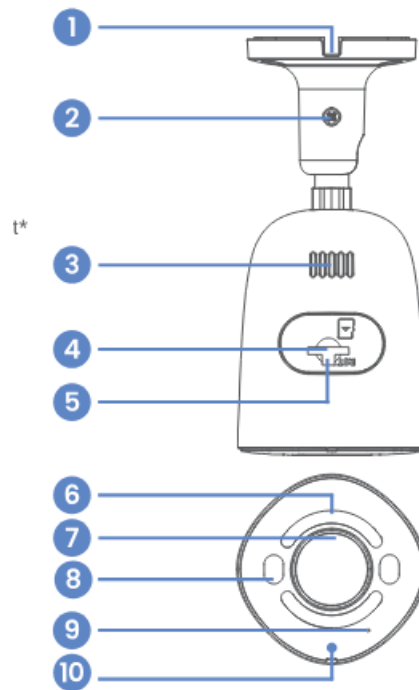

Design differs per model

1. Vis de réglage
2. Eclairage de securite intelligent
3. Microphone
4. Voyant IR (infrarouge)
5. Lumieres d'alarme
6. Lentille de la camera
7. Encoche du cable
8. Fente pour carte MicroSD
9. Bouton de reinitialisation
10. Haut-parleur et Sirene

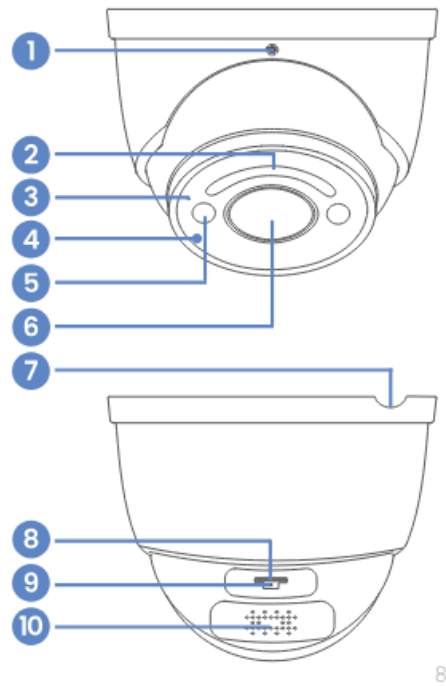

8

Camera Placement Tips

- Install the camera in a location that is difficult for thieves and vandals to reach.
- Secure cabling so that it is not exposed or easily cut.
- Point the camera where there is the least amount of obstructions (i.e. tree branches).
- Take into consideration what you want to monitor and where is the best coverage area.
- Place your camera close to the area of interest. The best position is 10ft/3m above ground, angled 15° down.

Camera Mounting

Test your camera prior to selecting a permanent mounting location, see page 17.

E894AB, E895AB, E896AB

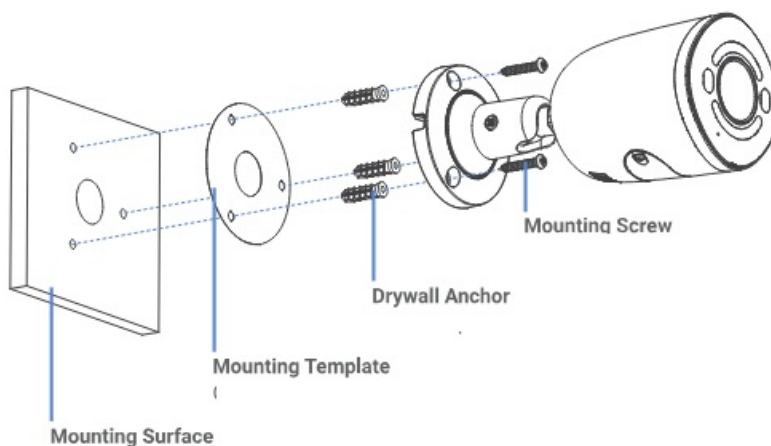

11

1. Use the mounting template to drill holes for screws, then insert the drywall anchors.
2. Drill a hole for the camera's cable if you plan to run it through the mounting surface. 2. Use the screws to mount the camera base to the surface. If you are running cables along a wall/ceiling, make sure to pass the cable

through the cable notch.

3. Feed the camera's cable through the camera base, then connect the cables (see page 17).
4. Loosen the adjustment screw and position your camera as needed, then tighten to secure it in place.
5. Remove the vinyl film from the camera lens once your installation is complete.



E896DD, E896DDB

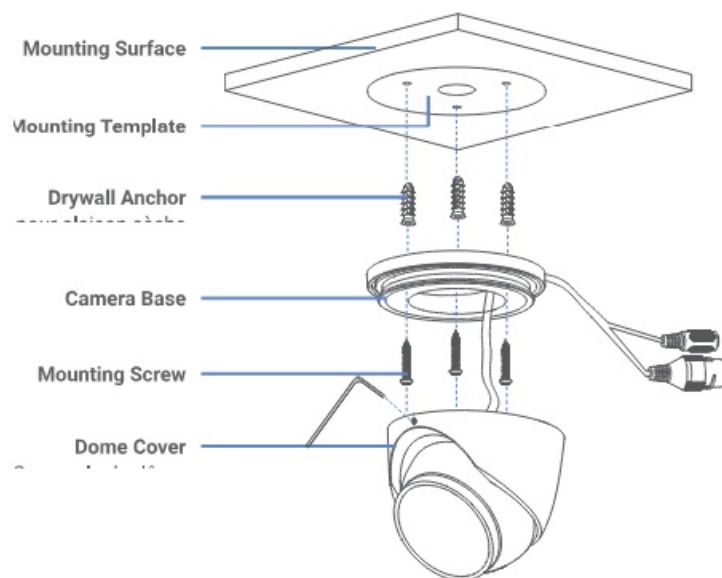

1. Use the mounting template to drill holes for screws, then insert the drywall anchors. Drill a hole for the camera's cable if you plan to run it through the mounting surface.
2. Use the Allen key to loosen the camera's adjustment screw, then remove the dome cover from the camera base.
3. Use the screws to mount the camera base to the surface. If you are running cables along a wall/ceiling, make sure to pass the cable through the cable notch.
4. Feed the camera's cable through the camera base, then connect the cables (see page 17).
5. Angle your dome camera, then use the Allen key to tighten the dome cover firmly onto the camera base.
6. Remove the vinyl film from the camera lens once your installation is complete.

Camera Connection

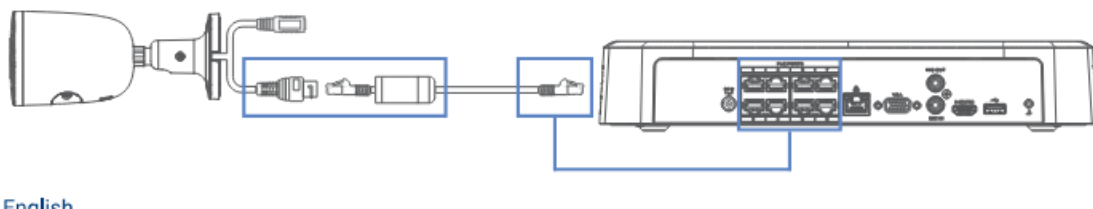

Connect your camera directly to your recorder using the camera's Ethernet extension cable.

weather-resistant Cap

Twist the Ethernet extension cable's pre-attached weather-resistant cap securely onto your camera's Ethernet connector. If exposed to regular precipitation, seal the cap with silicone and electrical tape.

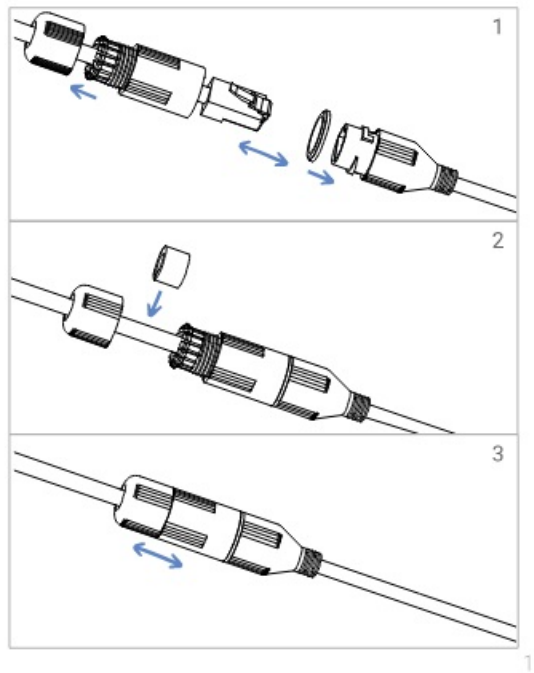

Need Help?

For related support, scan the QR code or visit:



help.lorex.com/E894AB



help.lorex.com/E895AB



help.lorex.com/E896AB



help.lorex.com/E896DD

- help.lorex.com/E894AB
- help.lorex.com/E895AB
- help.lorex.com/E896AB
- help.lorex.com/E896DD

Register Your Product

Please see our full Terms of Service and Limited Hardware Warranty Policy at:

Copyright© 2023 Lorex Technology Inc.
As our products are subject to continuous improvement, Lorex reserves the right to modify product design, specifications and prices, without notice and without incurring any obligation. E&OE. All rights reserved.

Documents / Resources

	<p>Lorex E89 Series IP Wired 4K AI Smart Security Bullet Camera [pdf] Instruction Manual E89 Series IP Wired 4K AI Smart Security Bullet Camera, IP Wired 4K AI Smart Security Bullet Camera, Smart Security Bullet Camera, Security Bullet Camera, Bullet Camera, Camera</p>
---	---

References

- [User Manual](#)

[Manuals+](#), [Privacy Policy](#)

This website is an independent publication and is neither affiliated with nor endorsed by any of the trademark owners. The "Bluetooth®" word mark and logos are registered trademarks owned by Bluetooth SIG, Inc. The "Wi-Fi®" word mark and logos are registered trademarks owned by the Wi-Fi Alliance. Any use of these marks on this website does not imply any affiliation with or endorsement.