



LOREX D881 Series 4K Fusion Wired DVR System User Guide

[Home](#) » [Lorex](#) » LOREX D881 Series 4K Fusion Wired DVR System User Guide 

Contents

- [1 LOREX D881 Series 4K Fusion Wired DVR System](#)
- [2 Package Contents](#)
- [3 Overview](#)
- [4 Documents / Resources](#)
 - [4.1 References](#)
- [5 Related Posts](#)



LOREX D881 Series 4K Fusion Wired DVR System



Package Contents

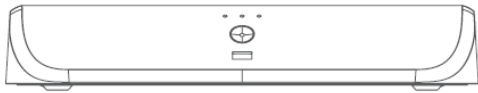

4K Fusion DVR

DVR Fusion 4K
DVR 4K Fusion



Ethernet Cable

Câble Ethernet
Cable Ethernet



USB Mouse

Souris USB
Mouse USB

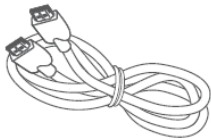

HDMI Cable

Câble HDMI
Cable HDMI

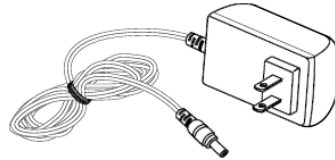

Power Adapter

Bloc d'alimentation
Adaptador de corriente

Overview

Front • Avant • Parte frontal

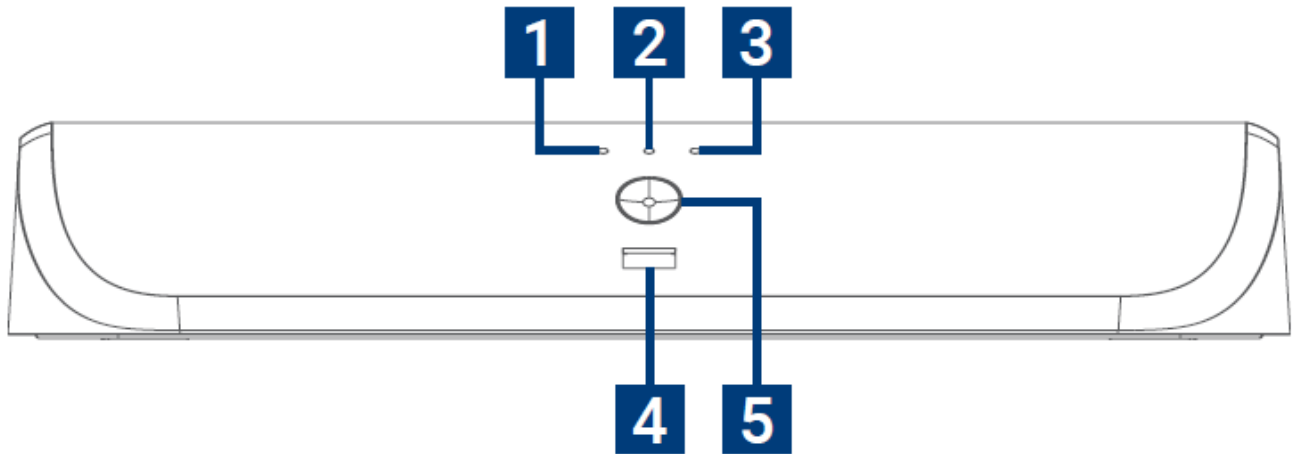

Back • Arrière • Parte trasera

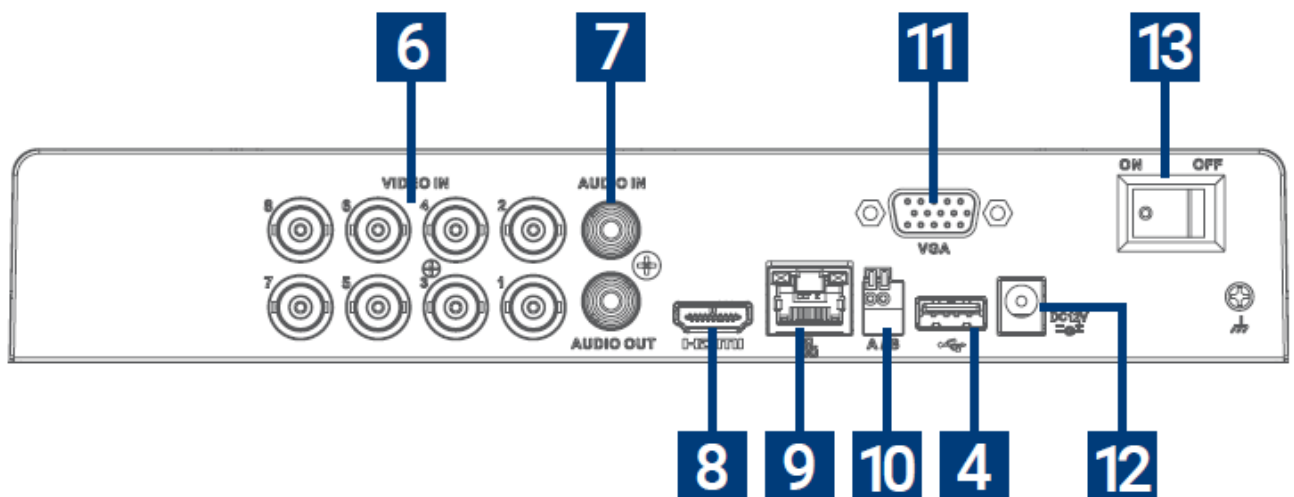

1. Hard Drive LED
2. Power LED
3. Network LED
4. USB Ports
5. Info/Panic Button
6. Video Inputs
7. Audio In/Out
8. HDMI Port
9. LAN Port
10. RS-485 Port
11. VGA Port
12. Power Port
13. Power Switch

Step 1: Wired Camera

1. Connect the BNC and male power end of the extension cable to your camera.
2. Connect the other BNC end of the extension cable to a video input on your recorder.
3. Connect the female power end of the extension cable to the camera's power adapter.

Note: The extension cable must be a single stretch of cable between your recorder and camera. You cannot connect multiple extension cables to each other.

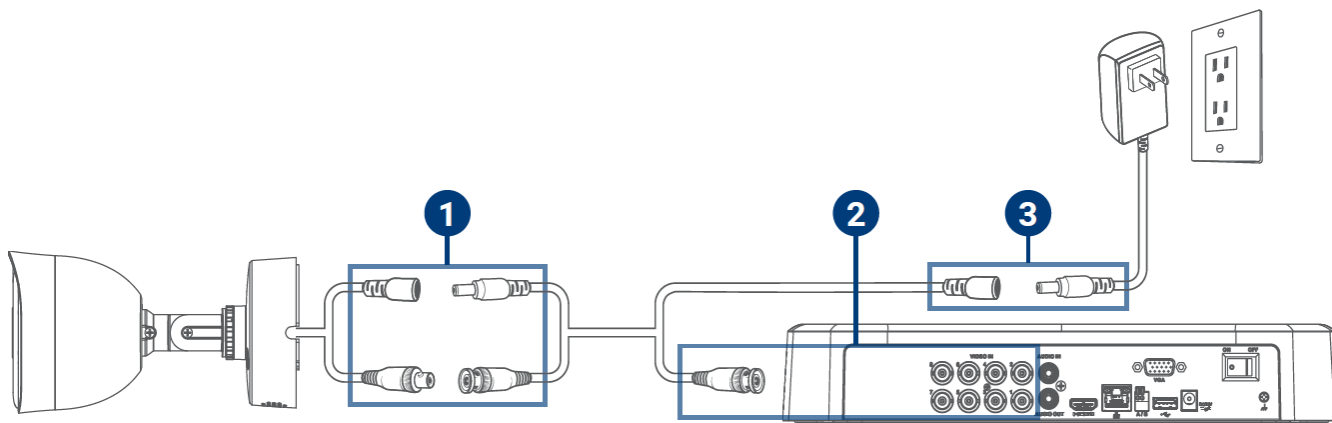

Test your cameras prior to selecting a permanent mounting location.

Step 2: Connect to your network: Connect your recorder to your Wi-Fi router using the included Ethernet cable.

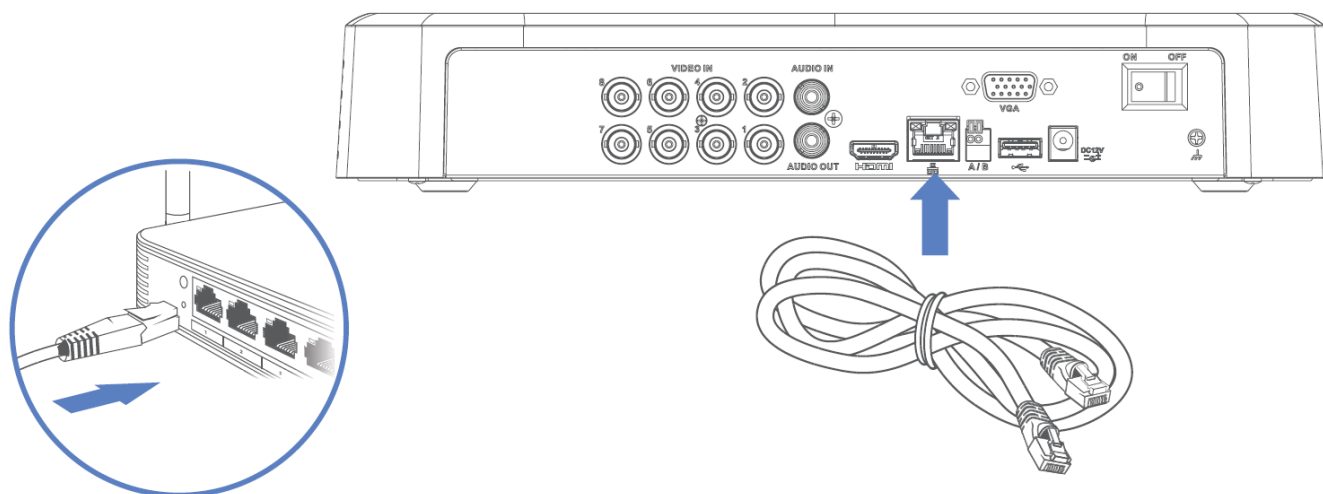

Step 3: Connect your mouse: Connect the included USB mouse to the USB port on your recorder. To copy events or to perform a firmware update, connect a USB flash drive.

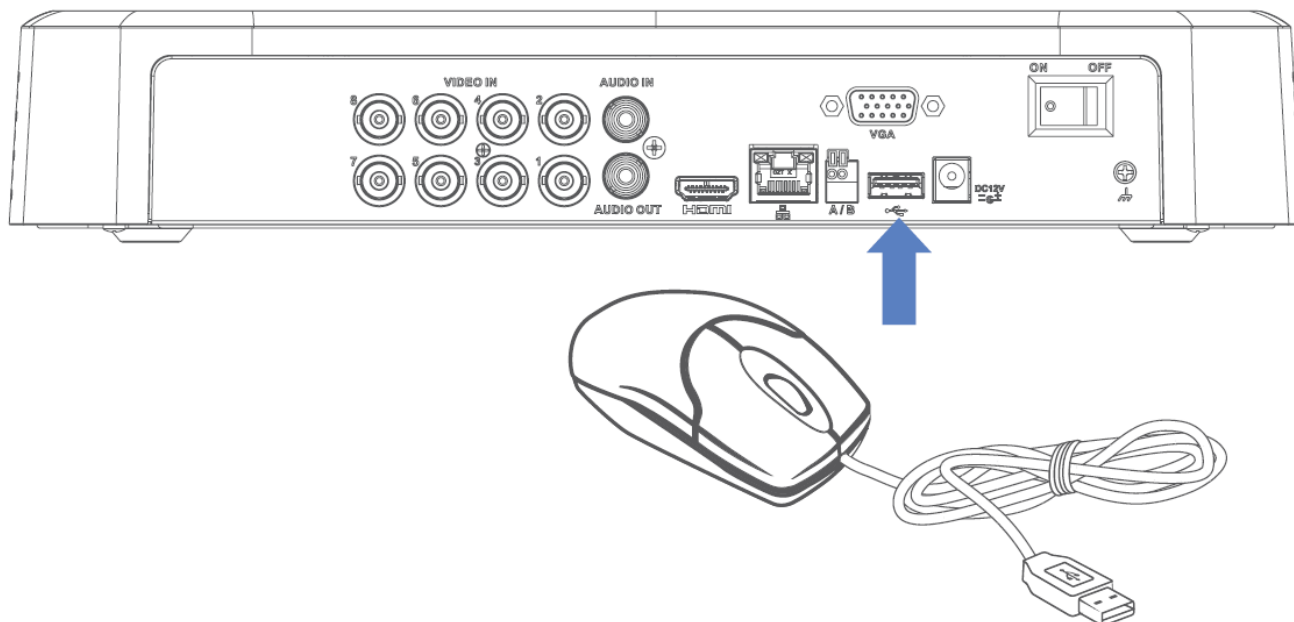

Step 4: Connect to your TV: Connect your recorder to your TV using the included HDMI cable. The HDMI supports up to 4K resolution and VGA supports up to 1080p.

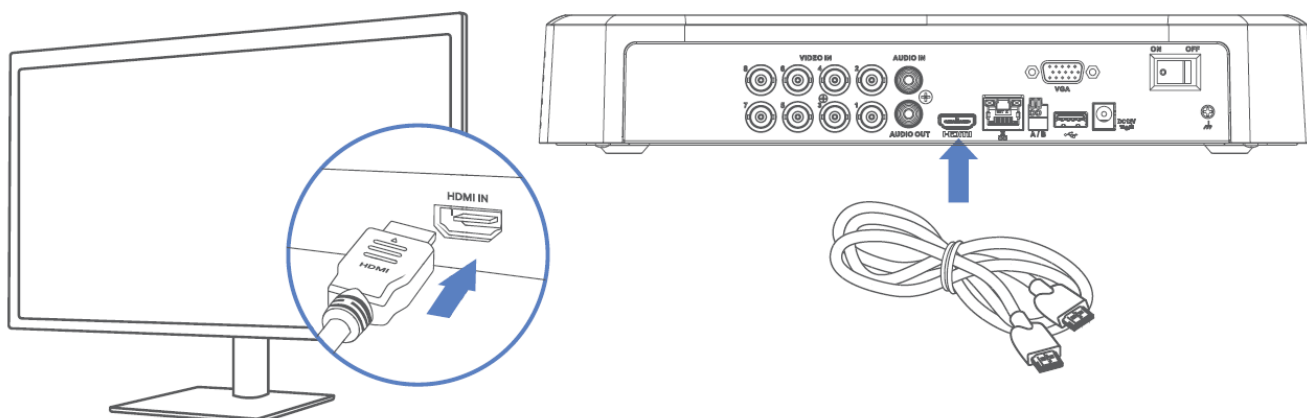

Step 5: Connect your power adapter: Connect the included power adapter to your recorder and a power outlet. Flip the power switch ON and complete the Lorex Setup Wizard.

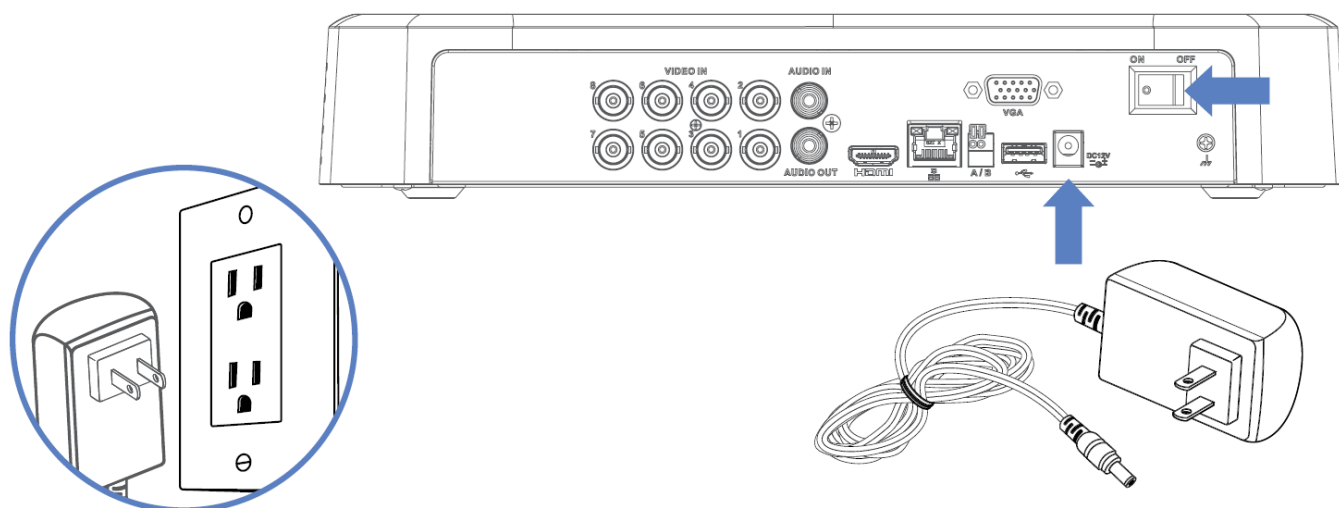

Download the Lorex Home App

To enable remote viewing with mobile apps, you will need to:

- Have high-speed Internet
- Have an upload speed of 6Mbps for one 4K channel and at least 20Mbps for the whole system
- Find your recorder's Device ID

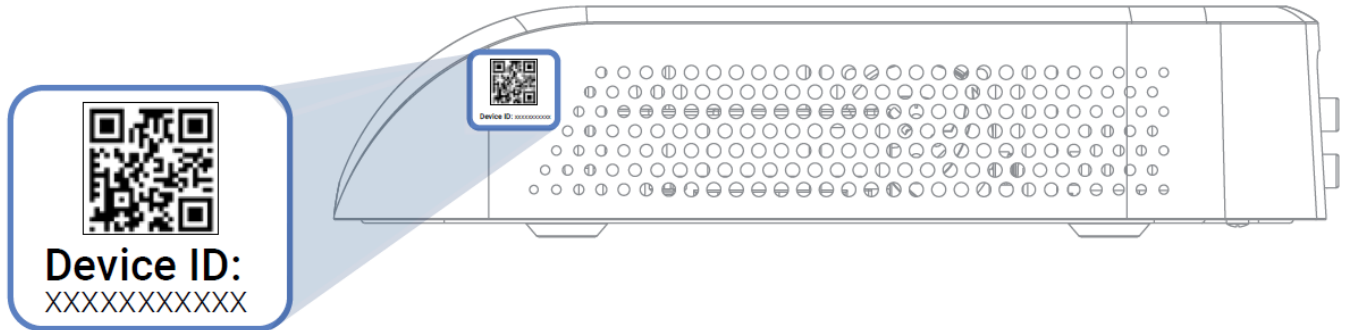

To connect your recorder to the app:

1. Download Lorex Home app.



2. In the app tap + to add your recorder.
3. Follow the in-app steps to complete the setup.

Fusion Setup

Connect your Wi-Fi device to your recorder: Set up your recorder and wired cameras. Next, download the Lorex Home app and add your recorder and Wi-Fi device. From your recorder, navigate to the camera's setup page and scan your network to connect your Wi-Fi device. To learn more or get support, scan the QR code or visit:



lorex.com/fusion

Need Help?

For up-to-date information and resources, scan the QR code or visit:



help.lorex.com

- Download your recorder's manual
- Watch how-to-videos
- Find related troubleshooting tips & FAQs

Register Your Product

Please see our full Terms of Service and Limited Hardware Warranty Policy at: lorex.com/warranty

Copyright © 2022 Lorex Technology Inc

As our products are subject to continuous improvement, Lorex reserves the right to modify product design, specifications and prices, without notice and without incurring any obligation. E&OE. All rights reserved.

Documents / Resources

	<p>LOREX D881 Series 4K Fusion Wired DVR System [pdf] User Guide D881 Series 4K Fusion Wired DVR System, D881 Series, 4K Fusion Wired DVR System, Fusion Wired DVR System, Wired DVR System, DVR System, System</p>
---	---

References

-  [Lorex Technical Support | LOREX Support](#)
-  [Lorex Fusion](#)
-  [Lorex Limited Warranty - Exceptions, Obligations | Lorex](#)

Manuals+.