



Loocam DS1 Door And Window Sensor User Manual

[Home](#) » [Loocam](#) » Loocam DS1 Door And Window Sensor User Manual 

Loocam DS1 Door And Window Sensor User Manual



Contents

- [1 What's in the Box](#)
- [2 Product Introduction](#)
- [3 How to Use?](#)
- [4 Installation](#)
- [5 Documents / Resources](#)
 - [5.1 References](#)

What's in the Box

Door & Window Sensor



Quick Start Guid

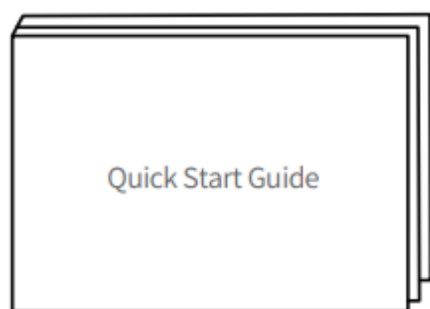

3M Adhesive Pad

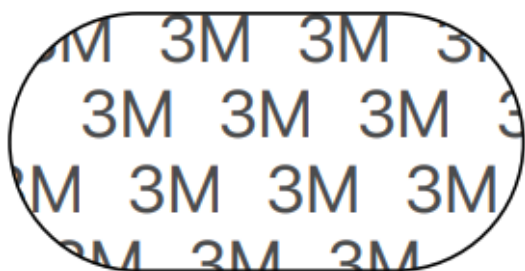

Product Introduction

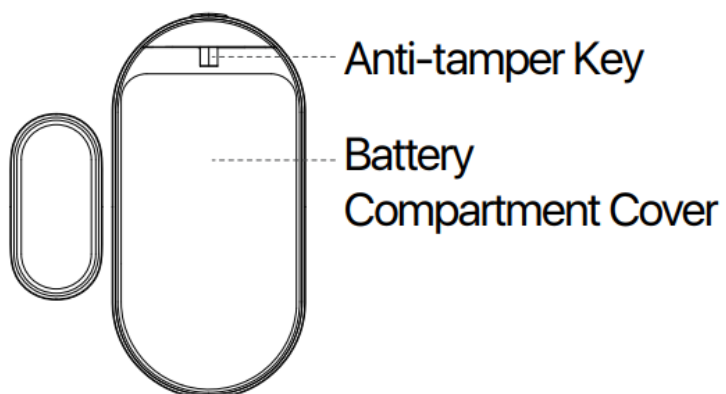
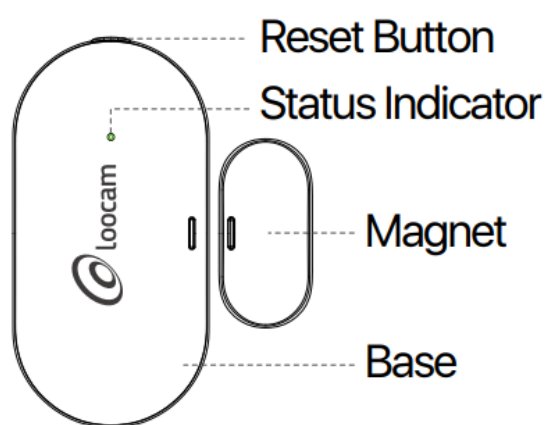

Note: Pictures are for reference only, please refer to the actual product.

Tip: The anti-tamper key will turn on after the base is mounted on the wall and will not be triggered until the base is removed.

How to Use?

Download Loocam App

Scan the QR code below with your smartphone or search in the App Store or Google Play to download Loocam app.



Add Devices

1. Connect WiFi to your phone.
2. Please follow the corresponding adding operation to add gateway to the App.
3. Enter the Gateway interface and select “Add Sensor”—“Door & Window Sensor”.
4. Remove the battery slot cover (as shown in the picture), power on the device after taking out the insulating sheet.

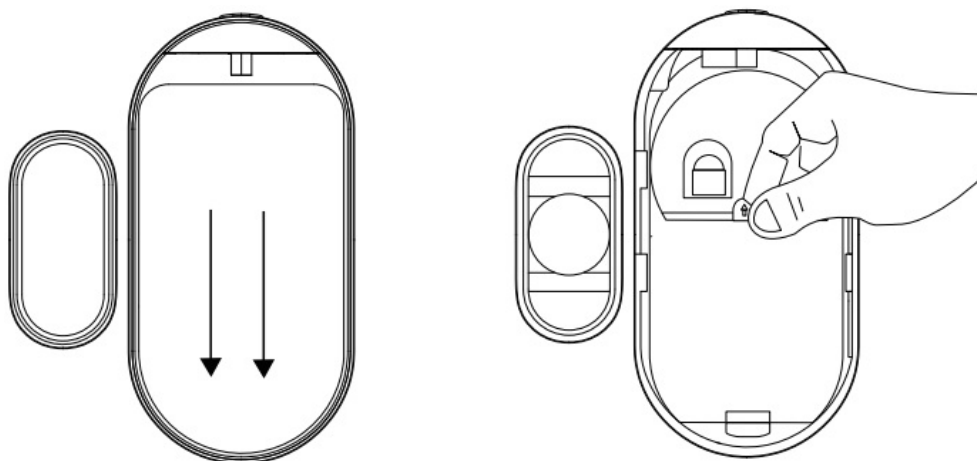

5. Press and hold the Reset Button for about 5 seconds until the red light flashes on the device and release it. Then press the button one more time and you will see the blue light flashes on the device. At this time, the device enters the pairing mode.

Important Notice: When replacing the battery, please use insulated tools to remove the battery. Do not use metal tools for prying the battery to avoid short-circuiting and damaging the motherboard.

Indicator Light Description

Installation

You can install the product on doors, windows, cabinets and other scenes, please install the base on a fixed door or window, the specific method is shown in the picture.

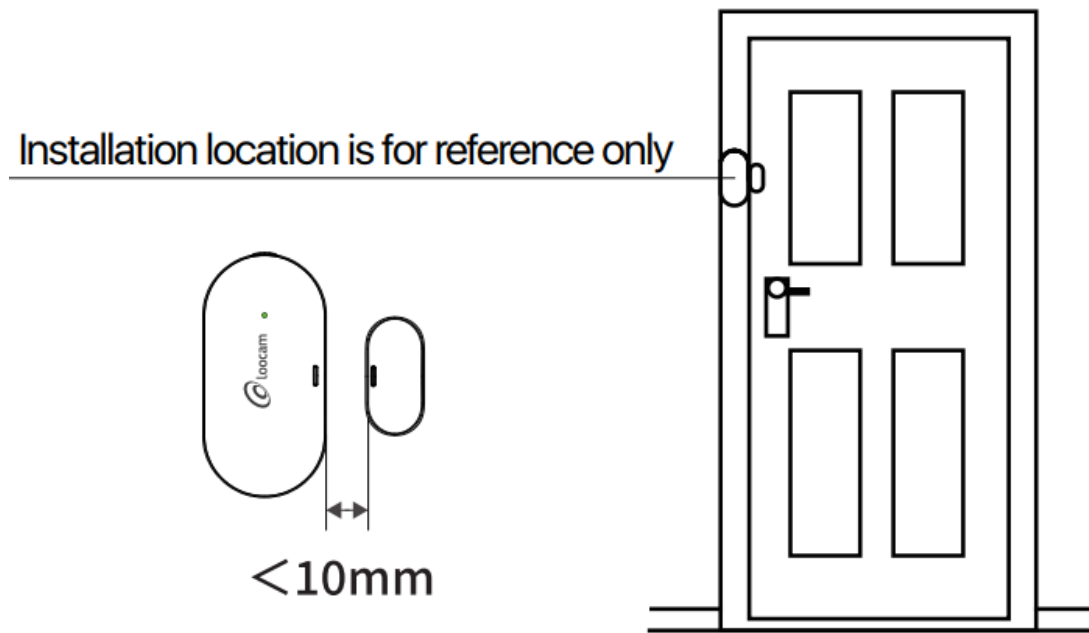

Installation location is for reference only, the specific usage location is subject to user requirements.

Note:

- Please do not install the sensor in outside where is unstable or raining.
- Please do not install the sensor next to the metallic magnet or others that may interfere with the sensor's operation.

NOTE: This equipment has been tested and found to comply with the limits for a Class B digital device, pursuant to part 15 of the FCC Rules. These limits are designed to provide reasonable protection against harmful interference in a residential installation. This equipment generates, uses and can radiate radio frequency energy and, if not installed and used in accordance with the instructions, may cause harmful interference to radio communications. However, there is no guarantee that interference will not occur in a particular installation. If this equipment does cause harmful interference to radio or television reception, which can be determined by turning the equipment off and on, the user is encouraged to try to correct the interference by one or more of the following measures:

- Reorient or relocate the receiving antenna.
- Increase the separation between the equipment and receiver.
- Connect the equipment into an outlet on a circuit different from that to which the receiver is connected.
- Consult the dealer or an experienced radio/TV technician for help

Changes or modifications not expressly approved by the party responsible for compliance could void the user's authority to operate the equipment.

This device complies with Part 15 of the FCC Rules. Operation is subject to the following two conditions: (1) this device may not cause harmful interference, and (2) this device must accept any interference received, including interference that may cause undesired operation.



Documents / Resources

	Loocam DS1 Door And Window Sensor [pdf] User Manual DS1 Door And Window Sensor, DS1, Door And Window Sensor, And Window Sensor, Window Sensor, Sensor
---	--

References

- [System.de/ear-verzeichnis/eba#no-back](#)
- [@Loocam | Look After Yours](#)
- [User Manual](#)

[Manuals+](#), [Privacy Policy](#)

This website is an independent publication and is neither affiliated with nor endorsed by any of the trademark owners. The "Bluetooth®" word mark and logos are registered trademarks owned by Bluetooth SIG, Inc. The "Wi-Fi®" word mark and logos are registered trademarks owned by the Wi-Fi Alliance. Any use of these marks on this website does not imply any affiliation with or endorsement.