



LOKK Latch CSI724 Gate Locking Latch Installation Guide

[Home](#) » [LOKK Latch](#) » LOKK Latch CSI724 Gate Locking Latch Installation Guide 

LOKK Latch CSI724 Gate Locking Latch Installation Guide



Not suitable for child safety gates – Use MagnaLatch instead.

Contents

[1 Tools](#)

[2 Installation](#)

[Instructions](#)

[3 Documents /
Resources](#)

[3.1 References](#)

[4 Related Posts](#)

Tools

5/32" (4mm) 1/2" (13mm)

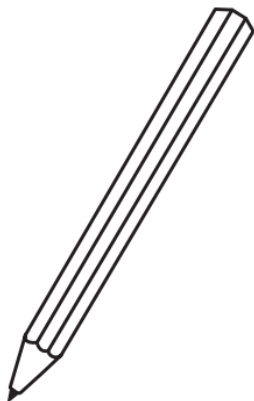

3 1/2" (90mm)

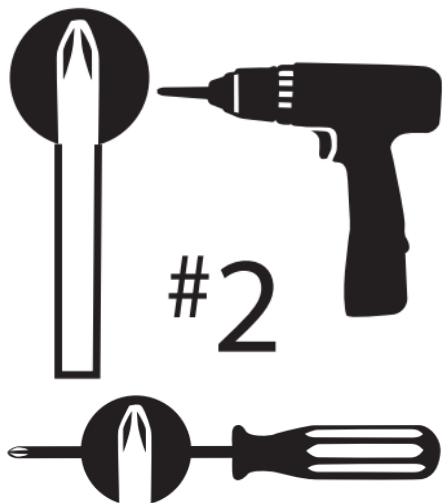

#2

File



Installation Instructions

GAP VARIANCE

GATE FRAME $3/8'' - 1 1/4''$ (10mm-32mm)

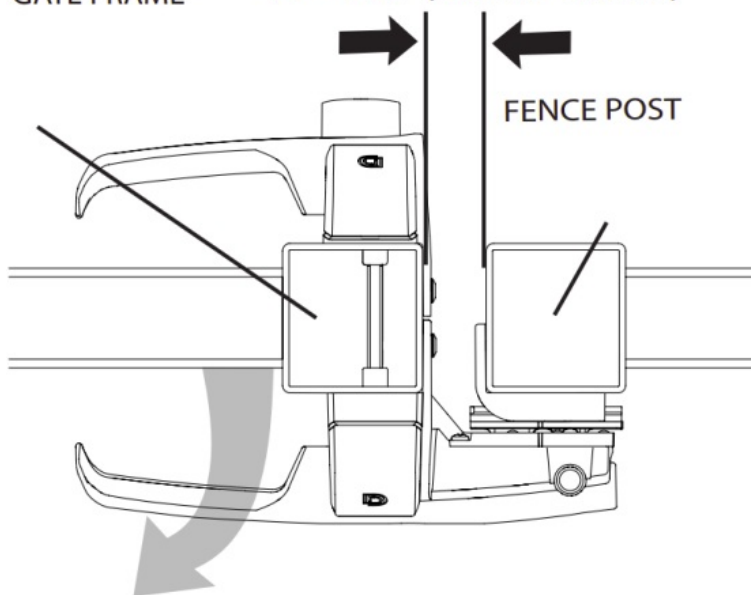

1. FIT THE TRIM COVERS

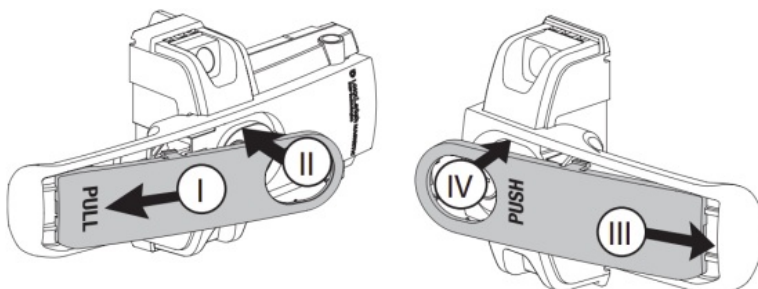

Trim covers cannot be removed once fitted.

2. INSERT PUSH ROD FIRMLY INTO HOUSING UNTIL GROOVE IS ALIGNED WITH HOUSING

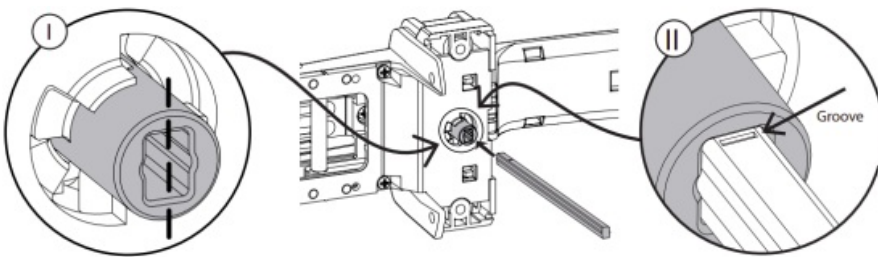

3. DRILL PUSH-ROD THROUGH-HOLE INTO GATE

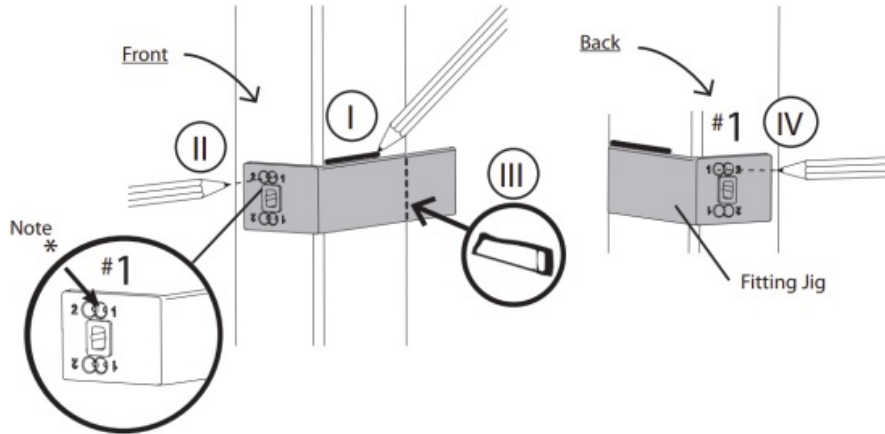

⚠ #2 Refer to B on back page

⚠ * Refer to A on back page

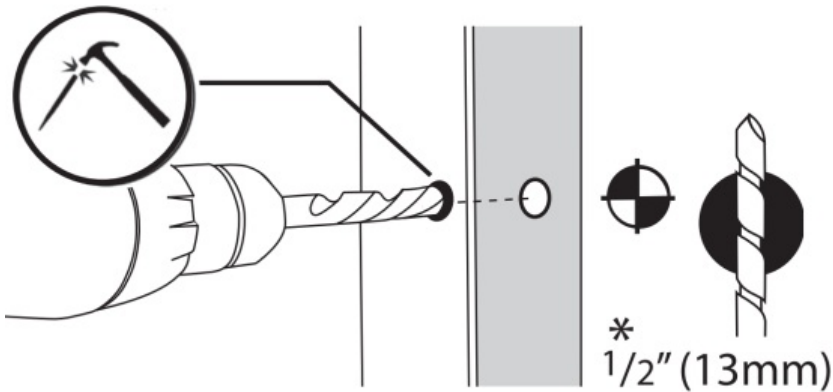

4. FASTEN LATCH TO GATE

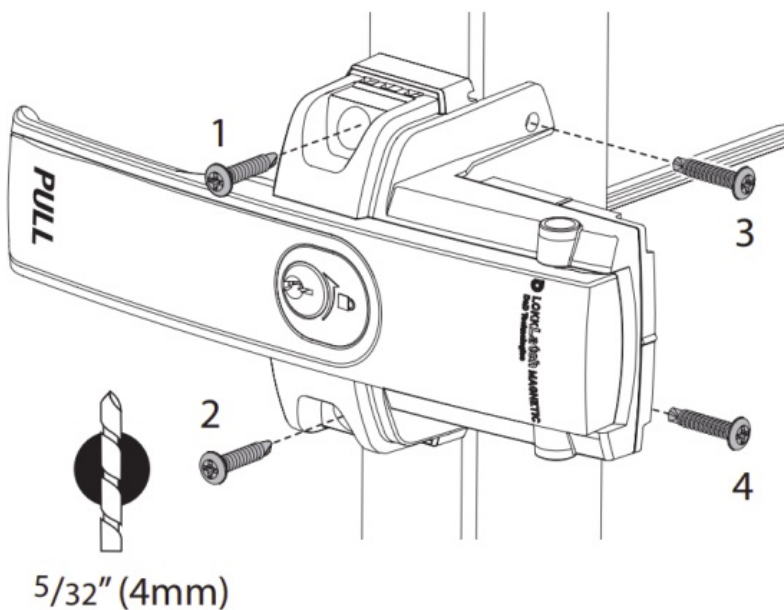

5. SAW PUSH-ROD FLUSH WITH FITTING JIG

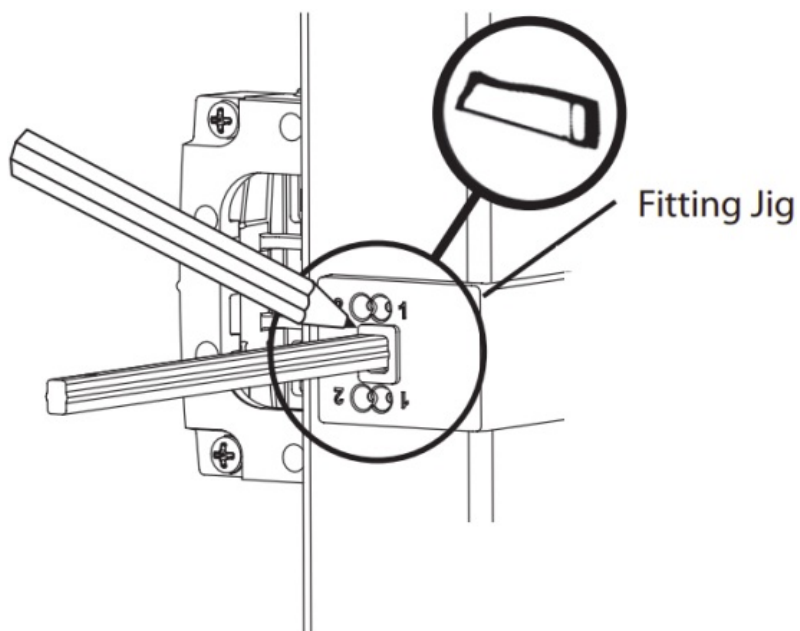

6. Use file to ensure push rod is square and does not extend beyond post more than 3/16" (5mm).

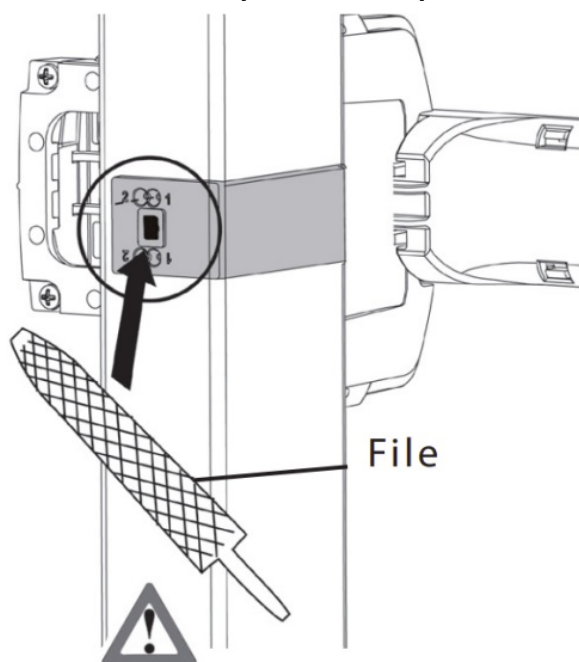

⚠ Do NOT cut push-rod at an angle

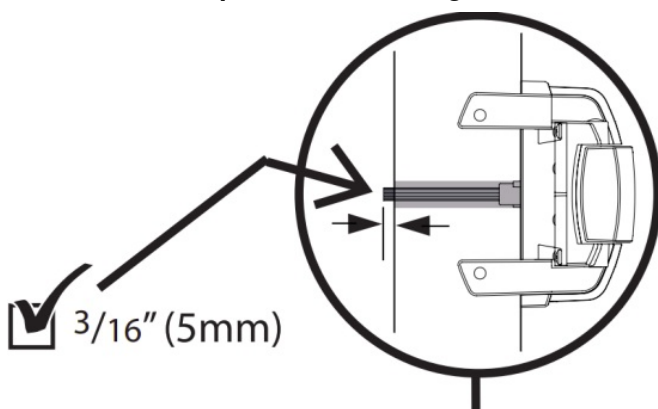

7. INSTALLING EXTERNAL ACCESS KIT (EAK)

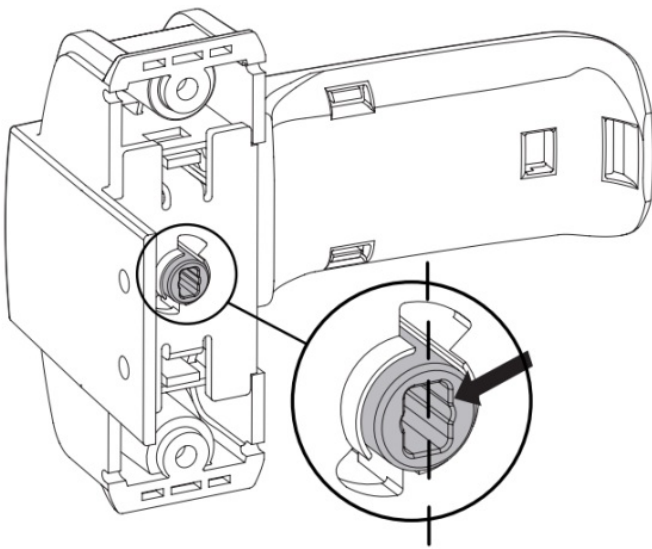

Ensure housing is in vertical position before fitting the Push Rod.

8. ALIGN AND FASTEN THE EAK

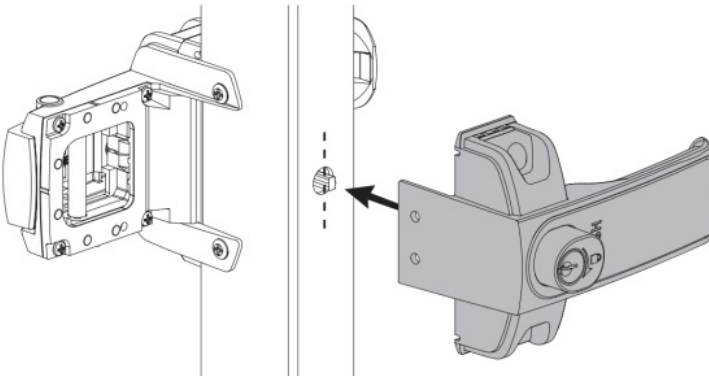

Firmly tighten screws on all components.

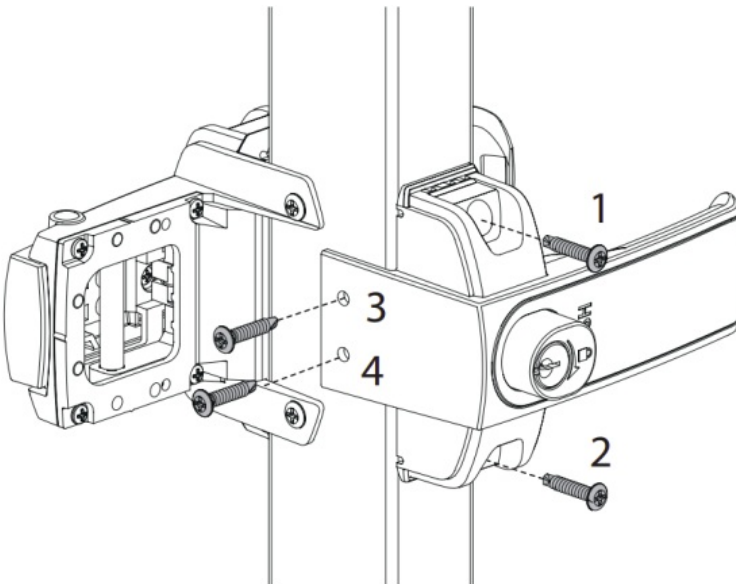

9. INSERT DRESS CAPS

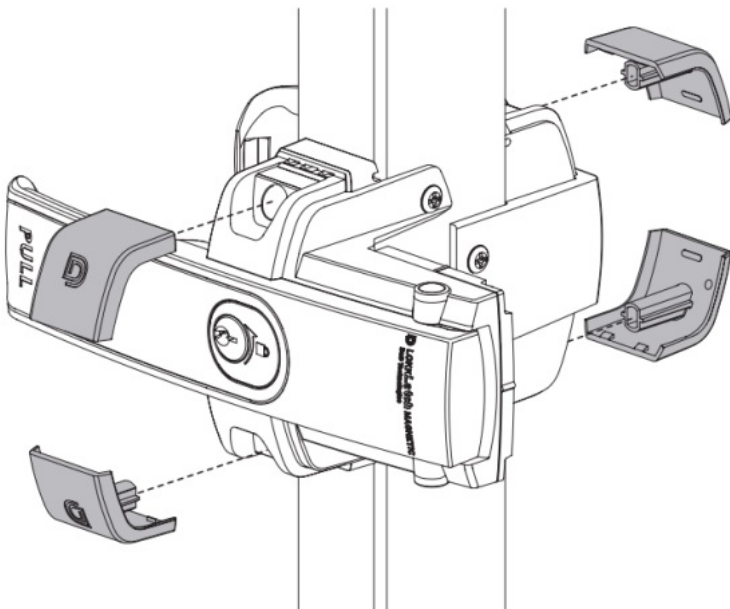

10. MARK AND INSTALL KEEPER TO POST

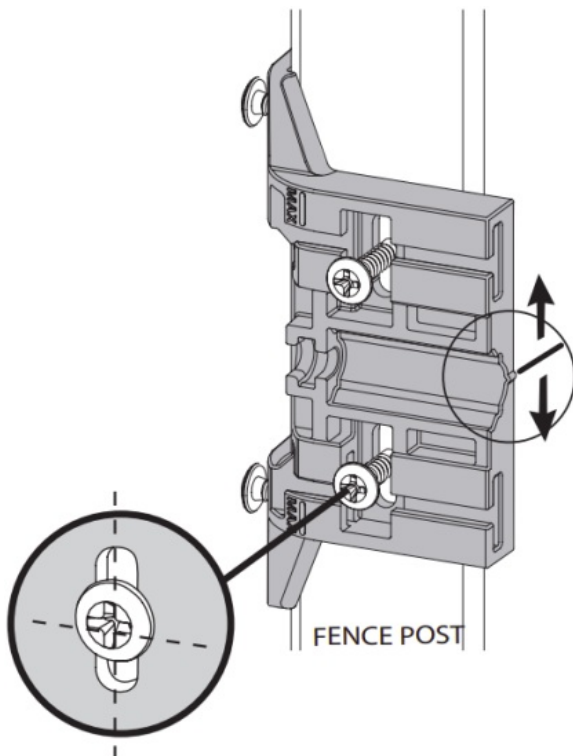
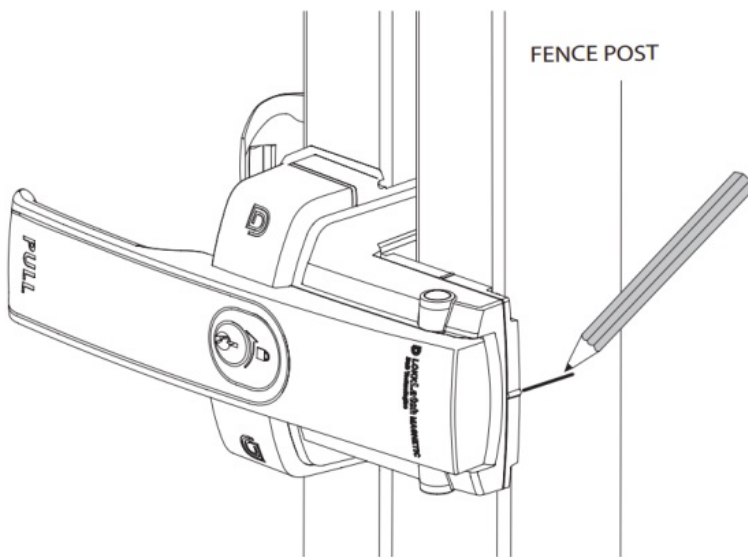

11. CHECK VERTICAL ALIGNMENT

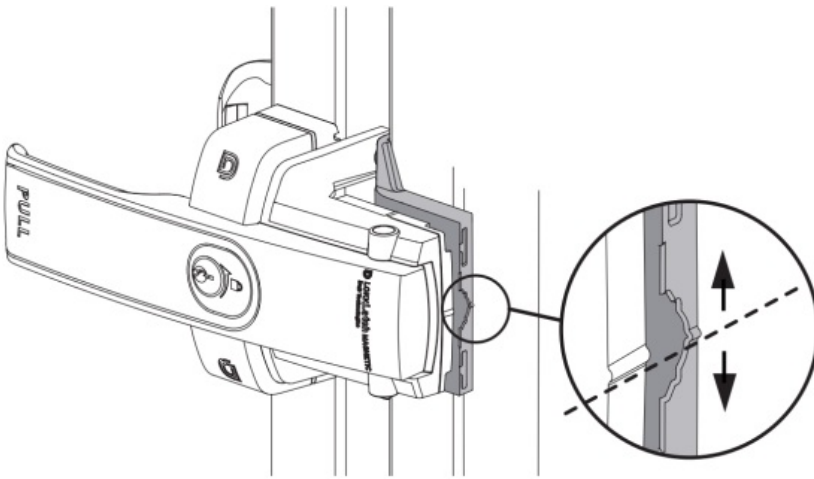

Adjust keeper so that the raised bump aligns with same on latch

12. WIND SCREW TO JOIN COMPONENTS

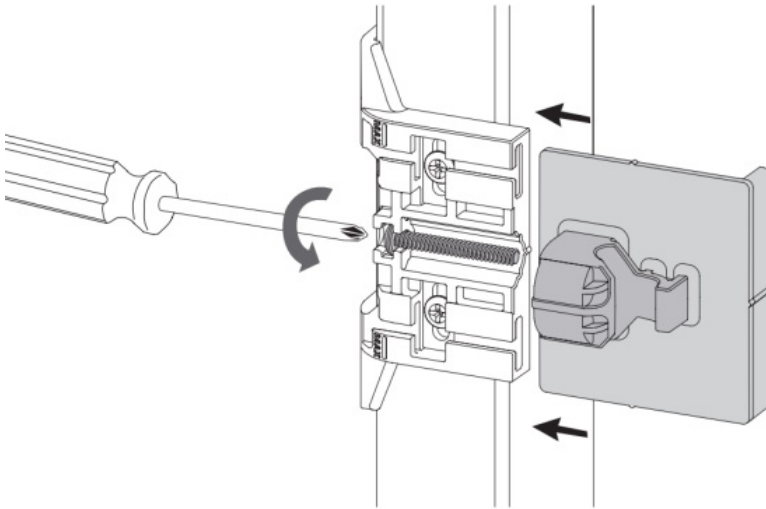

13. CHECK HORIZONTAL ALIGNMENT

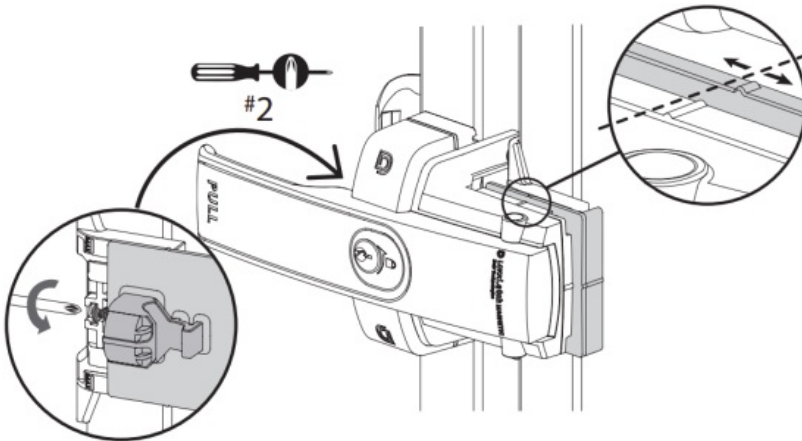

Adjust keeper so that the raised bump aligns with same on latch.

Removing Screw Covers (if necessary)

1. Insert blade horizontally underneath cover
2. Twist screwdriver and remove
3. See Step 8 to replace

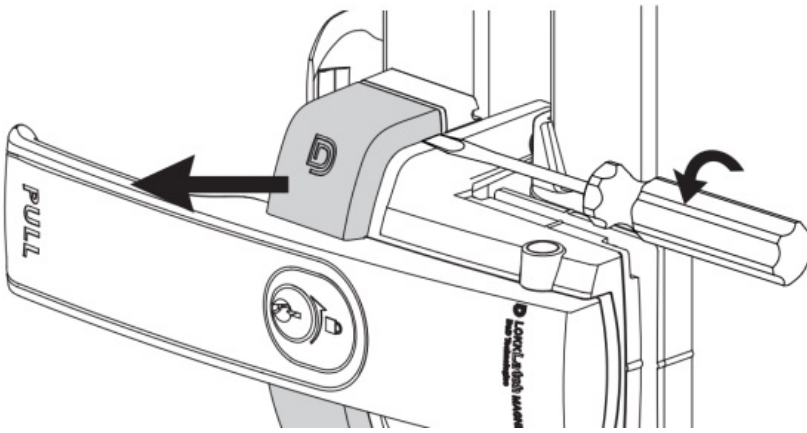

Tube helps protect locks from corrosion. NOT mandatory.

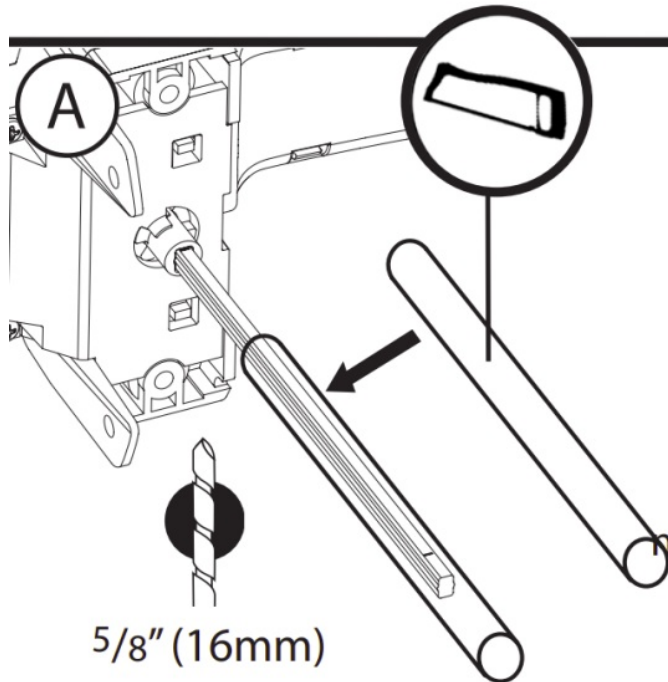

GATE FRAME

Hole # 2 on fitting jig is for recessing side fixing legs on Latch for wood gates

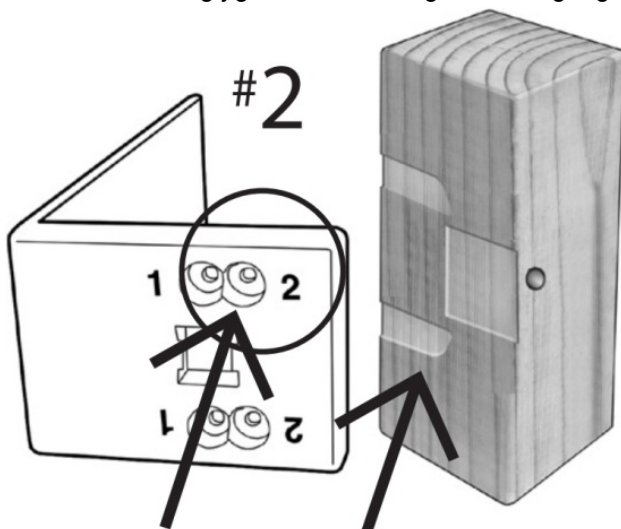

MAINTENANCE: REMOVE KEY FROM LOCK AFTER USE. Do not lubricate with petroleum-based products. Ensure all screws are tightened firmly and that the latch is kept free of ice, dirt and other debris which could impair performance. Periodic horizontal and/or vertical adjustment may be required.

For a downloadable Adobe Acrobat (PDF) version of our Limited LIFETIME WARRANTY, go to our website at www.ddtechglobal.com

www.LinearGateOpeners.com
[800-878-7829](tel:800-878-7829)
Sales@LinearGateOpeners.com



Documents / Resources



[LOKK Latch CSI724 Gate Locking Latch](#) [pdf] Installation Guide
CSI724 Gate Locking Latch, CSI724, Gate Locking Latch, Locking Latch

References

-  [Index of /](#)
- [User Manual](#)

[Manuals+](#), [Privacy Policy](#)

This website is an independent publication and is neither affiliated with nor endorsed by any of the trademark owners. The "Bluetooth®" word mark and logos are registered trademarks owned by Bluetooth SIG, Inc. The "Wi-Fi®" word mark and logos are registered trademarks owned by the Wi-Fi Alliance. Any use of these marks on this website does not imply any affiliation with or endorsement.