



logitech Zone Wireless Receiver User Guide

[Home](#) » [Logitech](#) » logitech Zone Wireless Receiver User Guide 

logitech Zone Wireless Receiver User Guide



Contents

[1 KNOW YOUR PRODUCT](#)

[2 WHAT'S IN THE BOX](#)

[3 CONNECTING THE RECEIVER TO THE HEADSET](#)

[4 DIMENSIONS](#)

[5 Documents / Resources](#)

[6 Related Posts](#)

KNOW YOUR PRODUCT

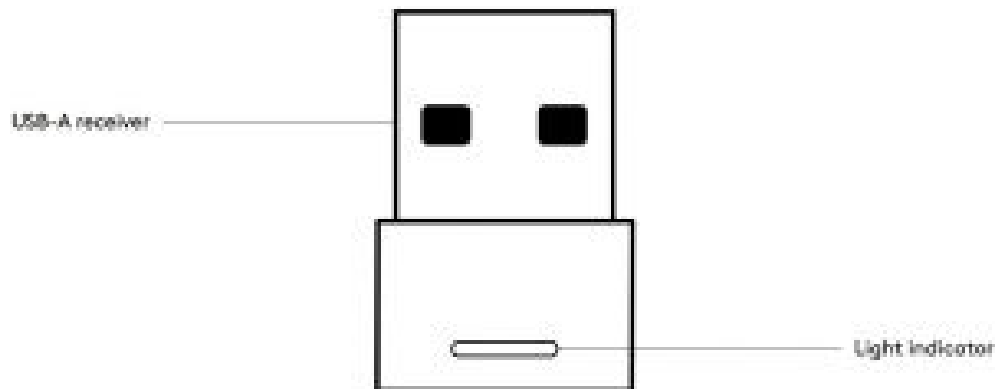

WHAT'S IN THE BOX

- USB-A receiver

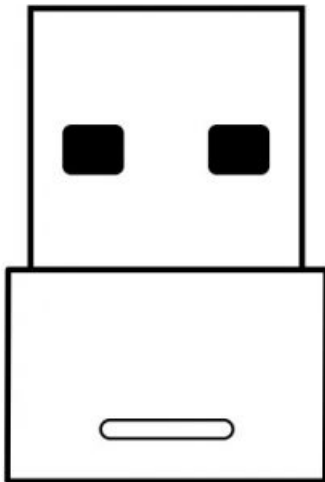

CONNECTING THE RECEIVER TO THE HEADSET

1. **a.** Insert the receiver into the computer USB-A port.
 - b.** Insert the receiver into the USB-C adapter.

Then insert the adapter into the computer USB-C port.

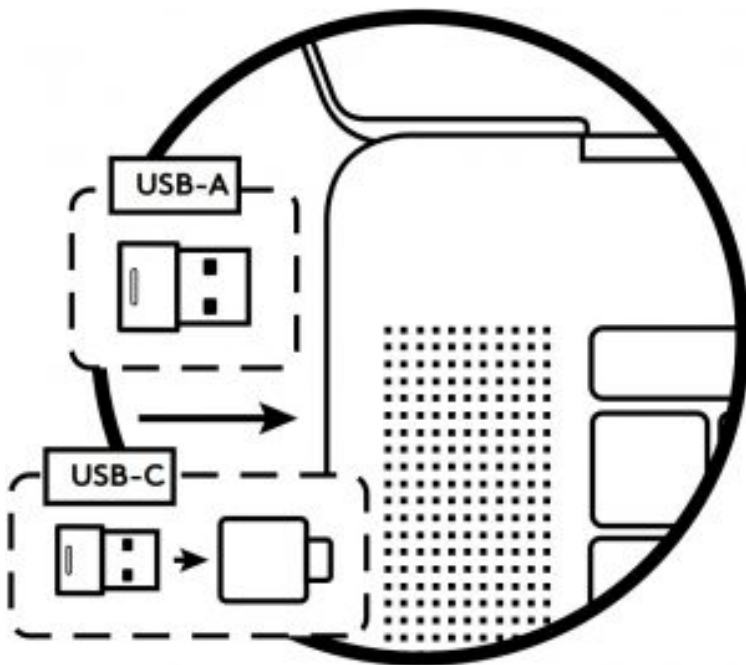

2. Install and open Logi Tune Desktop. Download it from www.logitech.com/logitune

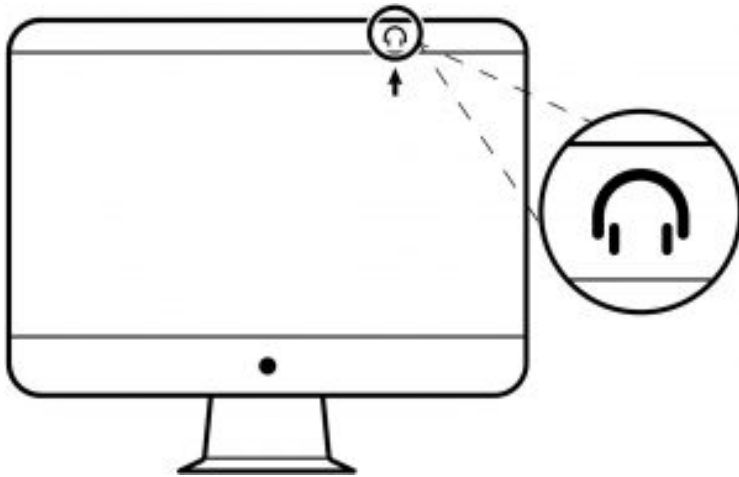

3. Logi Tune Desktop will confirm that a new receiver is found. Enter pairing mode on headset by pressing the power button for 3 seconds. Click Continue.

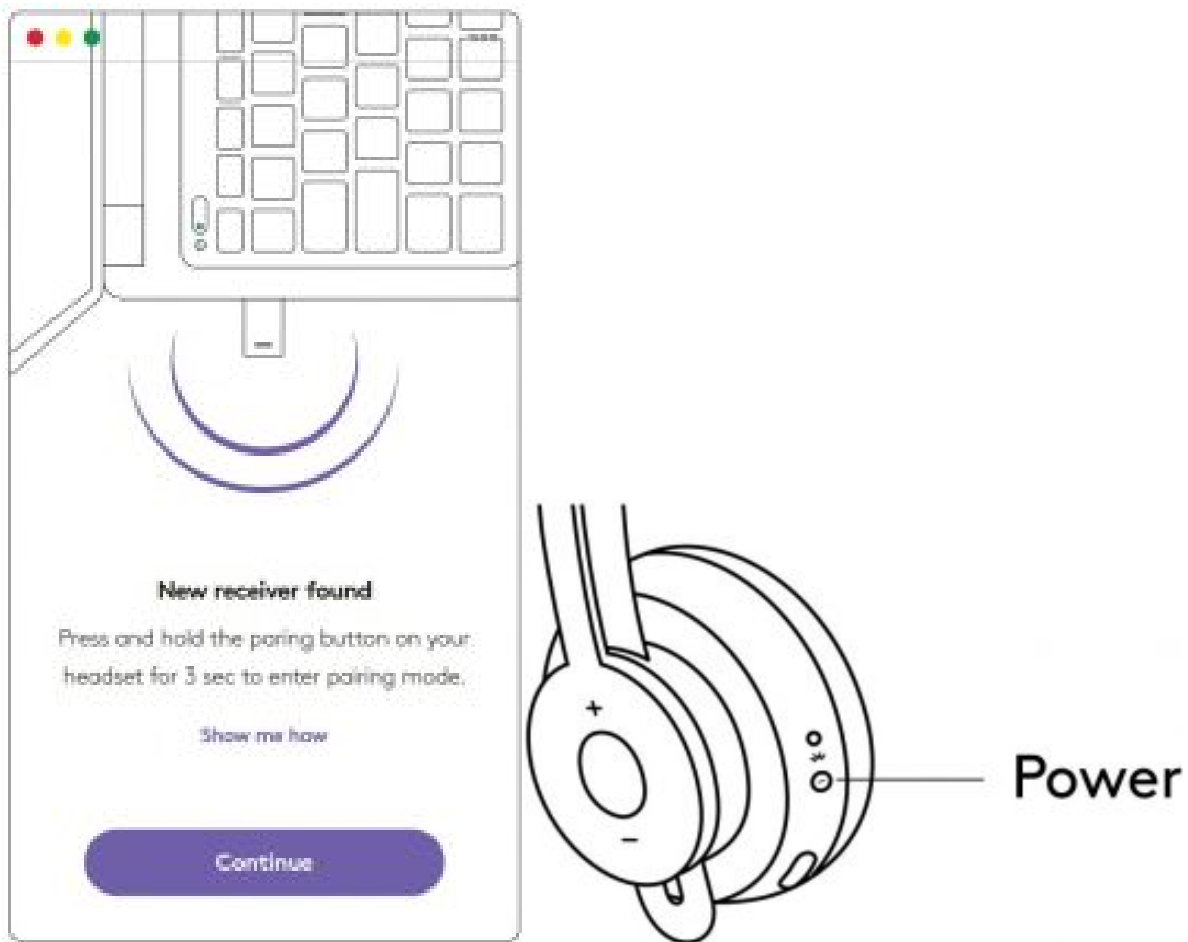

4. If pairing mode is successful, light indicators on the receiver and headset will flash white.

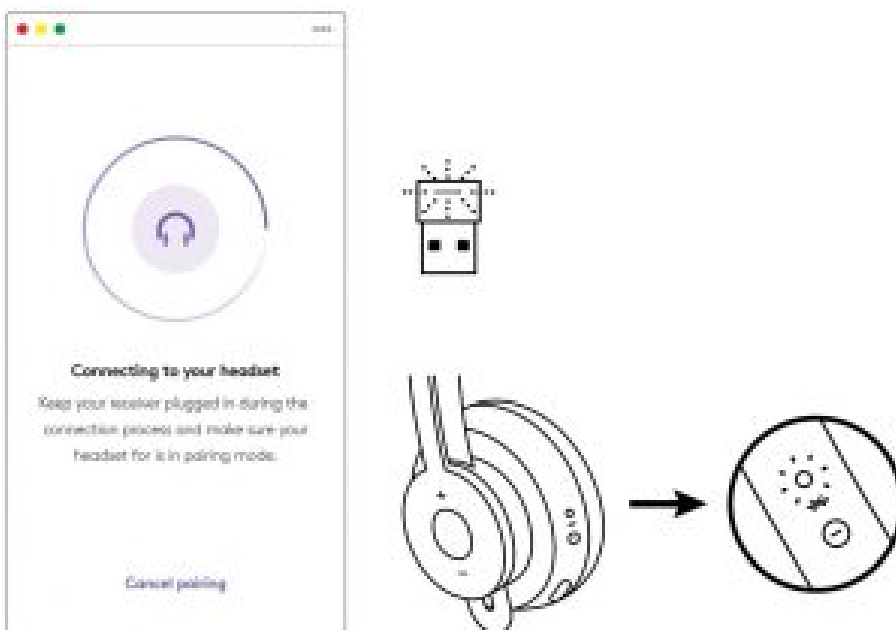

5. Once you see this screen, the receiver is now paired with the headset. Light indicators on the receiver and headset will turn solid white.

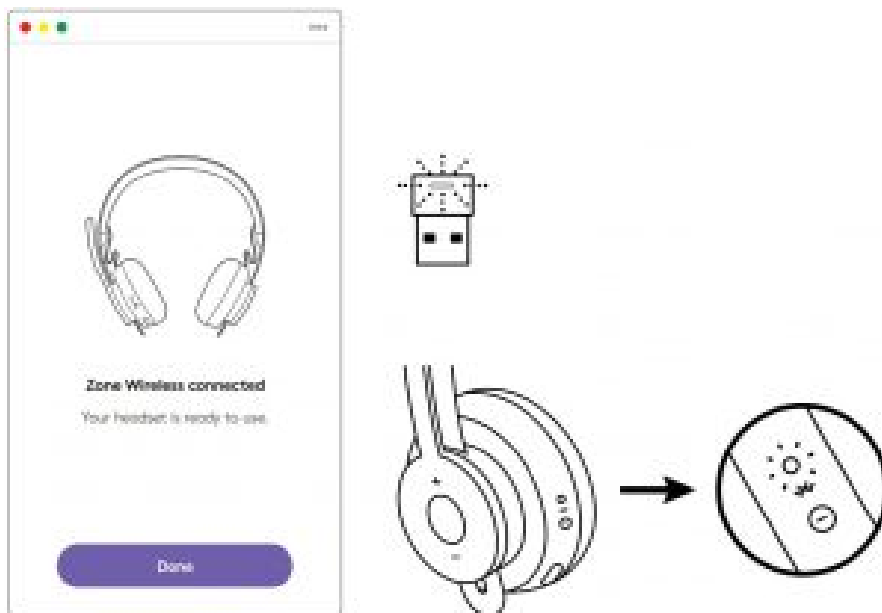

DIMENSIONS

- **RECEIVER:** Height x Width x Depth: 21.5 mm x 13.6 mm x 6 mm

www.logitech.com/support/zone-wireless-receiver

© 2020 Logitech, Logi and the Logitech Logo are trademarks or registered trademarks of Logitech Europe S.A. and/or its affiliates in the U.S. and other countries. Logitech assumes no responsibility for any errors that may appear in this manual. Information contained herein is subject to change without notice.

Documents / Resources

<p>ZONE WIRELESS RECEIVER</p> <p>Complete Setup Guide Quick Installation Summary</p>  <p>logitech</p>	<p>logitech Zone Wireless Receiver [pdf] User Guide Zone Wireless Receiver</p>
--	--