



Logitech Zone Wireless Plus User Manual

[Home](#) » [Logitech](#) » Logitech Zone Wireless Plus User Manual

Contents [[hide](#)]

- 1 Logitech Zone Wireless Plus User Manual
- 2 KNOW YOUR PRODUCT
 - 2.1 WHAT'S IN THE BOX
 - 2.2 POWER ON/OFF
 - 2.3 PAIRING VIA BLUETOOTH®
 - 2.4 PAIRING HEADSET, KEYBOARD AND MICE VIA USB RECEIVER
 - 2.5 ADJUSTING HEADSET
 - 2.6 ADJUSTING THE MICROPHONE BOOM
- 3 HEADSET CONTROLS
 - 3.1 Mute
 - 3.2 ACTIVE NOISE CANCELLATION (ANC)
- 4 HEADSET LIGHT INDICATOR
- 5 RECEIVER INDICATOR LIGHT
- 6 CHARGING
- 7 LOGI TUNE APP
- 8 ADJUSTING SIDETONE
 - 8.1 AUTO SLEEP TIMER
 - 8.2 UPDATE YOUR HEADSET
 - 8.3 RESET YOUR HEADSET
- 9 Specifications
 - 9.1 DIMENSIONS
 - 9.2 TECHNICAL SPECIFICATIONS
- 10 FAQ – FREQUENTLY ASKED QUESTIONS
- 11 Documents / Resources
 - 11.1 References
- 12 Related Posts

Logitech Zone Wireless Plus User Manual

logitech®

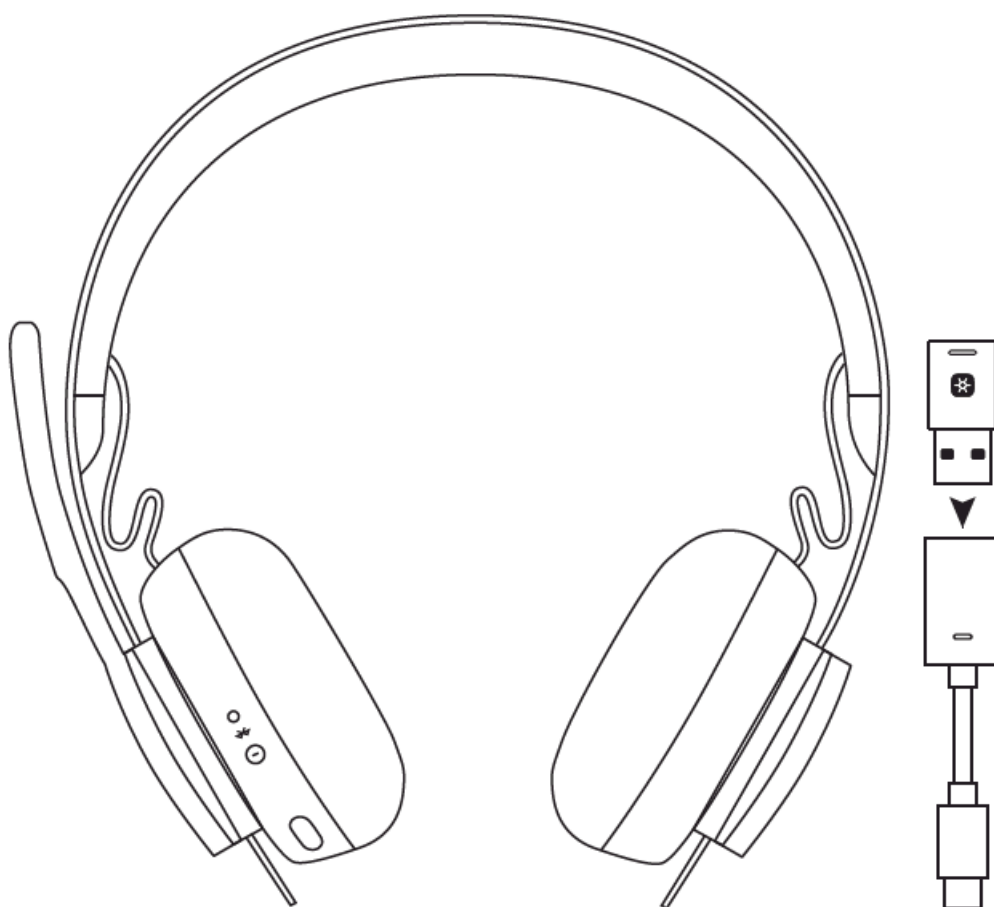

KNOW YOUR PRODUCT

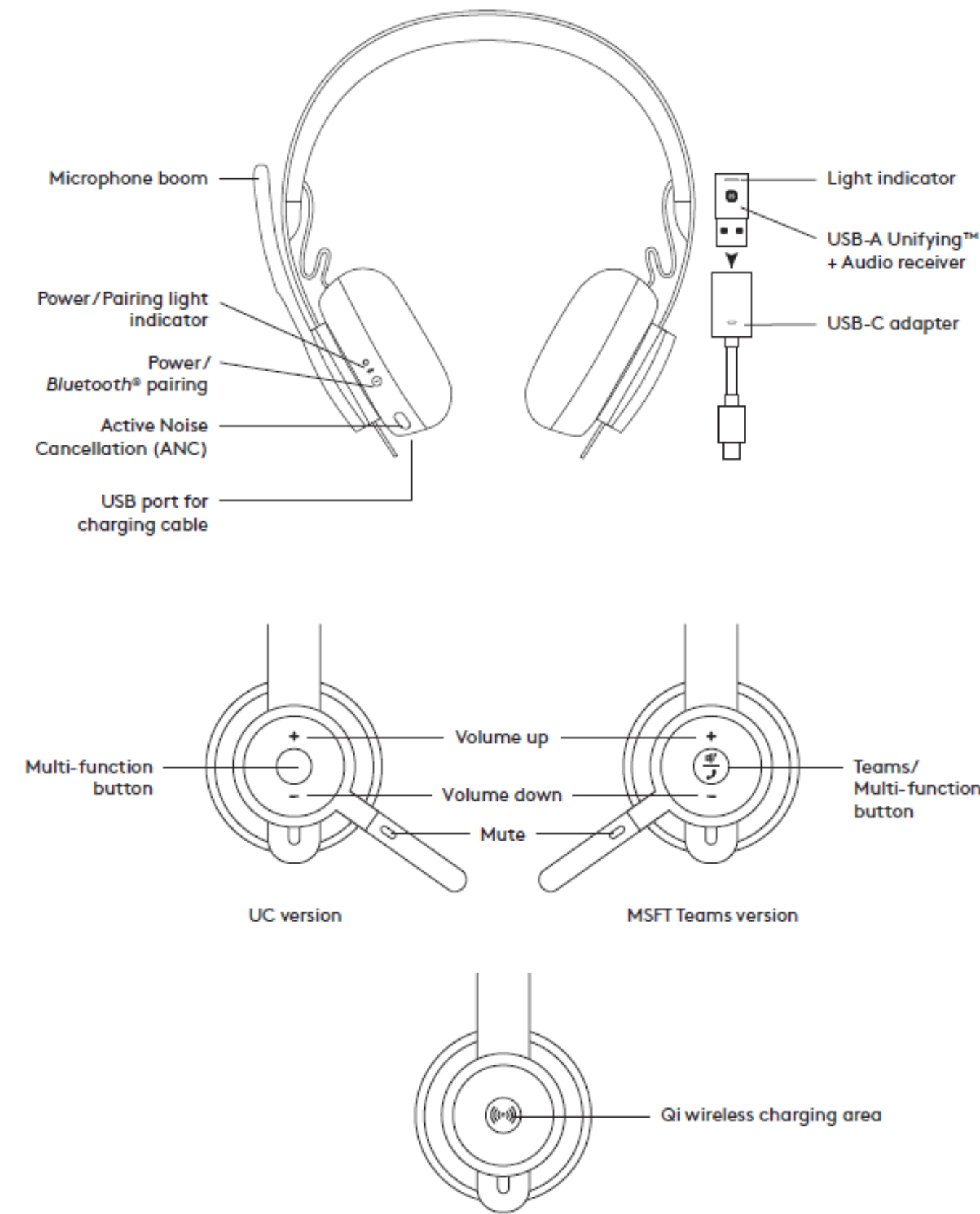

WHAT'S IN THE BOX

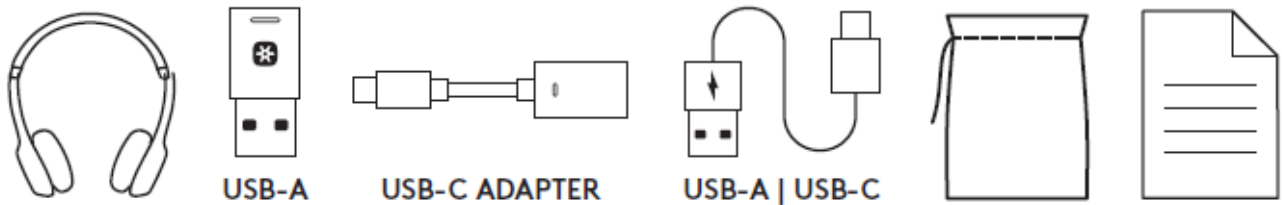

1. Headset
2. USB-A Unifying™ + audio receiver
3. USB-C to A adapter
4. USB-A to C charging cable
5. Travel bag
6. User documentation

POWER ON/OFF

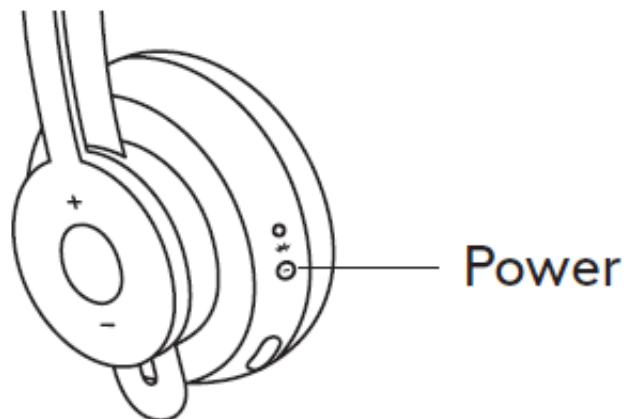

1. Press power button for 1 second.
2. Once powered on, light indicator turns white
If no device is connected, it will flash white slowly.

PAIRING VIA BLUETOOTH®

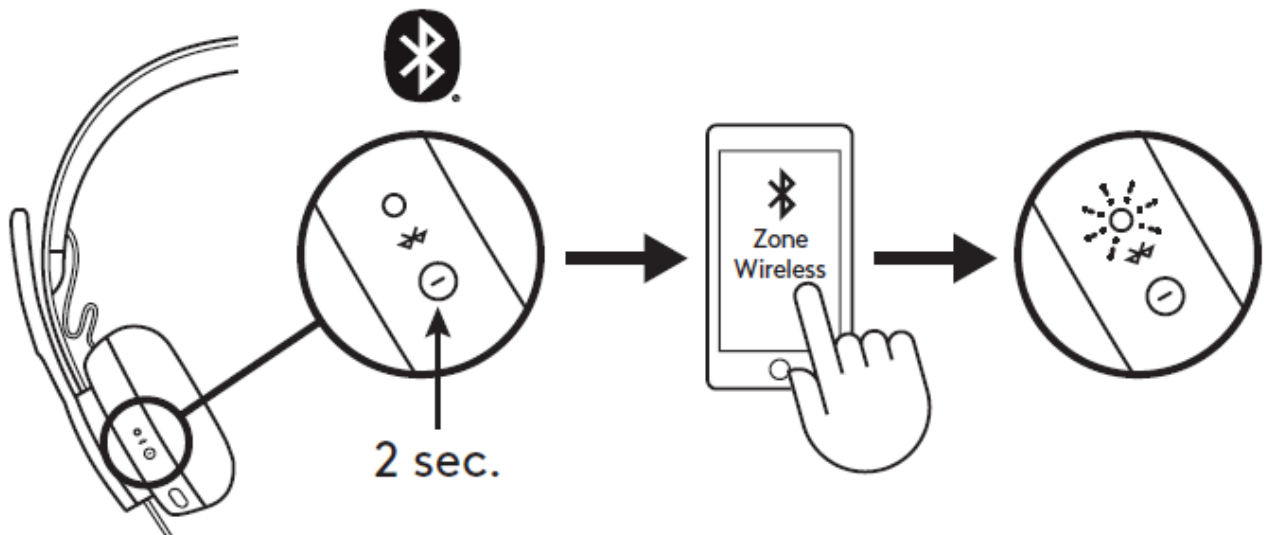

1. Press power button for 2 seconds. Light indicator will flash white rapidly.
2. Open Bluetooth® settings on your device.
3. Select Zone Wireless Plus in discoverable devices.
4. Once successfully paired, light indicator will turn solid white.

PAIRING HEADSET, KEYBOARD AND MICE VIA USB RECEIVER

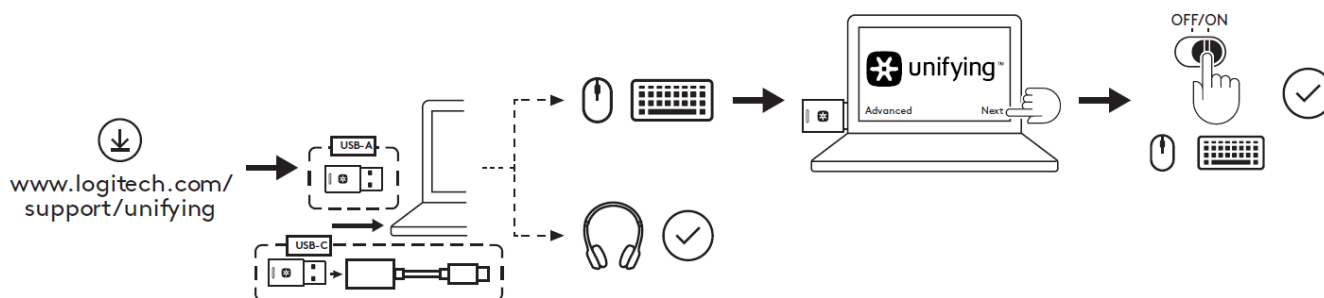

1. Download Logitech® Unifying Software at www.logitech.com/support/unifying.

2. USB-A

Insert the Zone Wireless Plus receiver into the computer USB-A port.

USB-C

Insert the USB-A receiver into the USB-C adapter. Then insert the adapter into the computer USB-C port.

3. **Zone Wireless Plus** headset is already paired to the receiver it ships with. Just power on the headset.

Once successfully paired, the light indicator on the receiver will remain solid white. Light indicator on the headset will turn solid white.

4. To pair mice and **keyboard**,

- Open the software and continue clicking “**Next**” on the bottom right corner. If you already have other unifying receivers (with logo), please unplug them.
- Locate the OFF-ON slider on your mice and keyboard. Turn each device off and back on to restart your devices and finish pairing.
 - If paired, please follow the on-screen prompt and test it out to confirm successful pairing.
 - If pairing failed, please retry or refer to our support page

www.logitech.com/support/zonewirelesspluspairing

NOTE: you can pair up to 6 Logitech Unifying peripherals.

ADJUSTING HEADSET

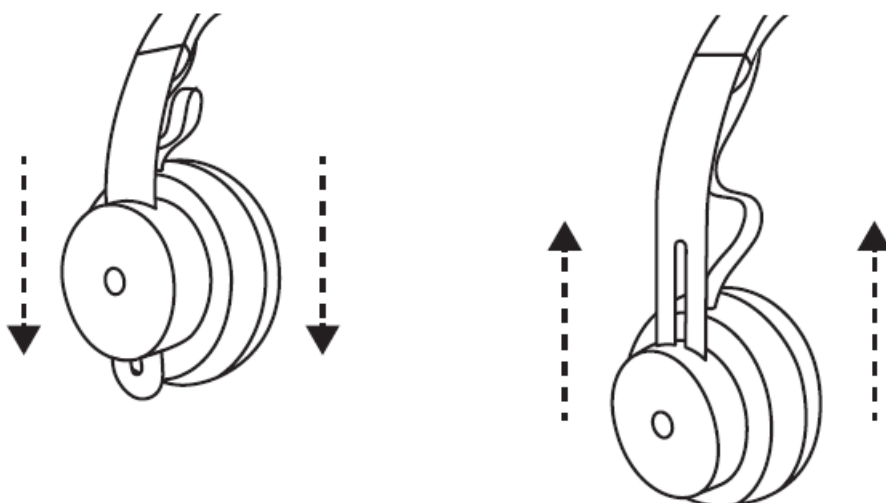

1. Adjust headset by sliding earcups up and down the headband.
2. It may be easier to adjust the headset on your head.

ADJUSTING THE MICROPHONE BOOM

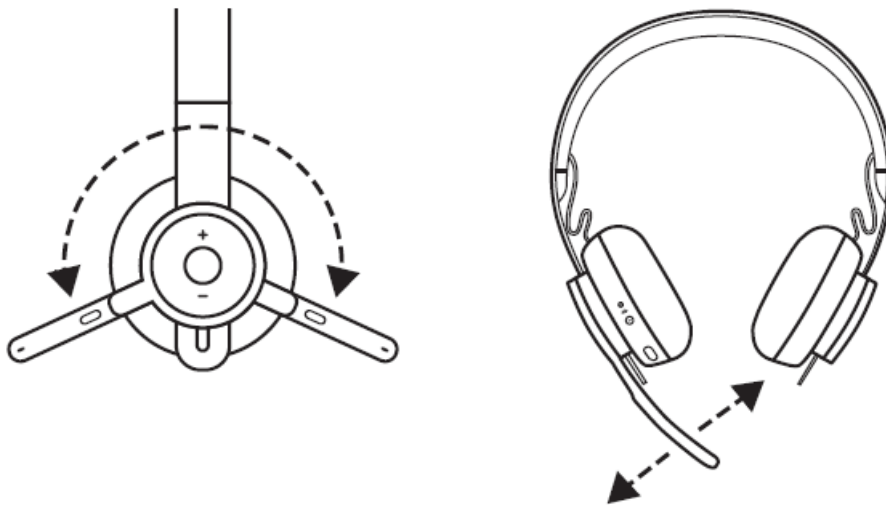

1. Microphone boom rotates 270 degrees. Wear it on either left or right side. Audio channel will switch automatically, depending on the direction you are wearing the microphone.
2. Flexible microphone boom — adjust boom location to capture voice better.

HEADSET CONTROLS

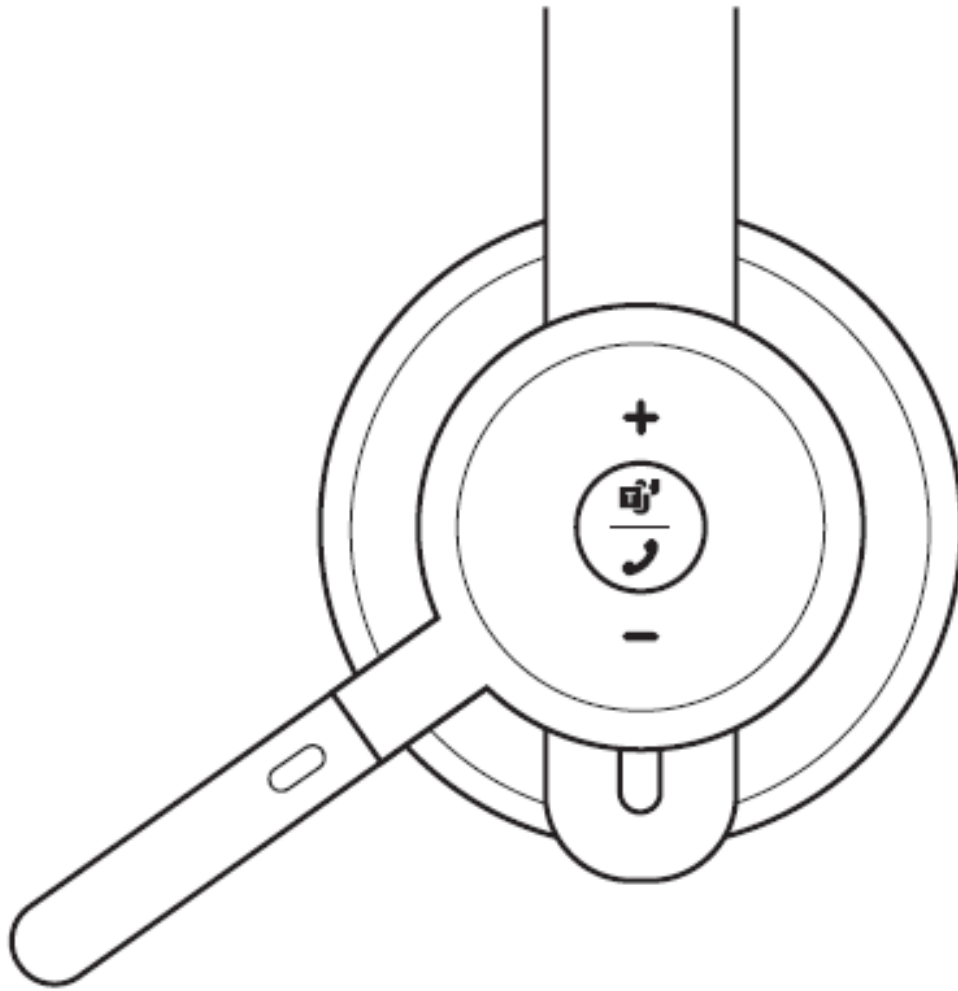

MSFT Teams version

| TEAMS version | | | |
|---------------|-------------------|--------|----------------|
| | Usage | Button | Action |
| | Answer / End call | | Short press |
| | Reject call | | 2 second press |
| | Resume call | | Short press |
| | | | |

| | | | |
|-------------------------|--------------------------------------|------------------------|----------------|
| Call controls | Transfer active call to other device | | Short press |
| | | | |
| Teams activities | Check connection to teams | Multi-function | Short press |
| | Quick access to Teams | | Short press |
| | Respond to Teams notifications | | Short press |
| | Trigger Teams voice skills (Cortana) | | 2 second press |
| | | | |
| Media controls | Play / Pause | Multi-function | Double press |
| | Track forward | Multi-function and “+” | Short press |
| | Track backward | Multi-function and “-” | Short press |
| | Volume up | “+” | Short press |
| | | | |

| | | | |
|---------------------------------------|-------------------------------------|-----------|-------------|
| Volume | Volume down | “—” | Short press |
| Headset connection and battery status | Check connectivity and battery life | “+”and“—” | Short press |

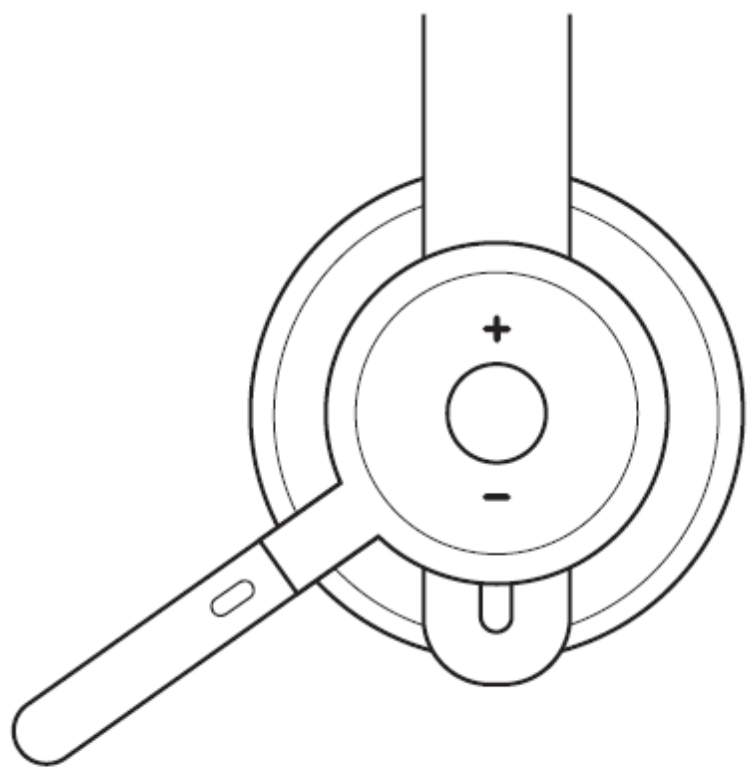

UC version

| UC version | | | |
|------------|-------------------|--------|-------------|
| | Usage | Button | Action |
| | Answer / End call | | Short press |
| | | | |

| | | | |
|------------------------|-------------------------------------|------------------------|----------------|
| Call controls | Reject call | Multi-function | 2 second press |
| Voice assistant | | Multi-function | 2 second press |
| Media controls | Play / Pause | Multi-function | Double press |
| | Track forward | Multi-function and “+” | Short press |
| | Track backward | Multi-function and “—” | Short press |
| Volume | Volume up | “+” | Short press |
| | Volume down | “—” | Short press |
| Headset status | Check connectivity and battery life | “+”and“—” | Short press |

Note:

- Teams activities are only functional when Teams is running on an unlocked computer
- Media control functionality depends on type of application
- Call activities are always the first priority When two devices are connected, the **Bluetooth®** connection will be prioritized over receiver When two **Bluetooth®** devices are connected, the last active device will override the

other

Tip: Button customizations and Music EQ controls available on Logi Tune app

Mute

MUTE

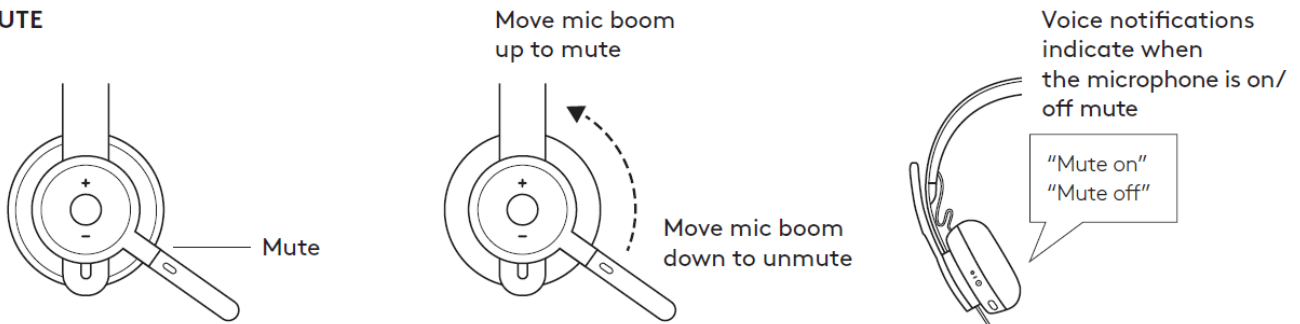

ACTIVE NOISE CANCELLATION (ANC)

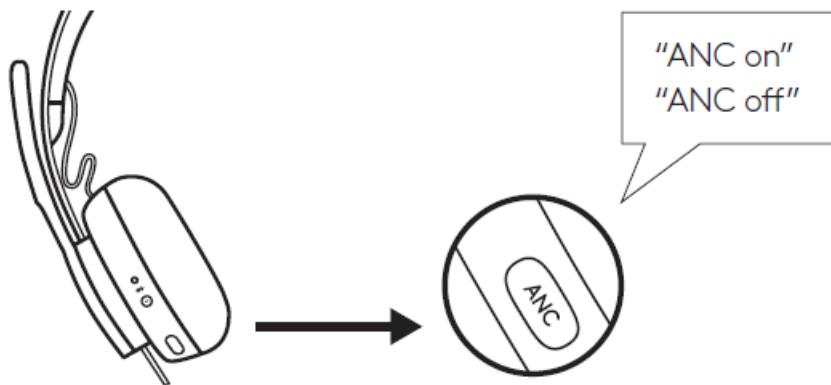

ANC blocks out the noise around you to help you concentrate on the task at hand.

1. Press the ANC button on the side of the earcup.
2. There will be voice notifications when turning ANC on and off. These can be turned off in the Logi Tune app.

HEADSET LIGHT INDICATOR

| Light | | Status |
|-------|--------------|--|
| White | Solid | Powered on or fully charged |
| | Breathing | Battery charging |
| | Fast pulsing | <i>Bluetooth®</i> pairing mode |
| | Slow pulsing | No paired device |
| Red | Solid | Low battery |
| | Fast pulsing | <i>Bluetooth®</i> pairing mode while low battery |
| | Slow pulsing | No paired device while low battery |

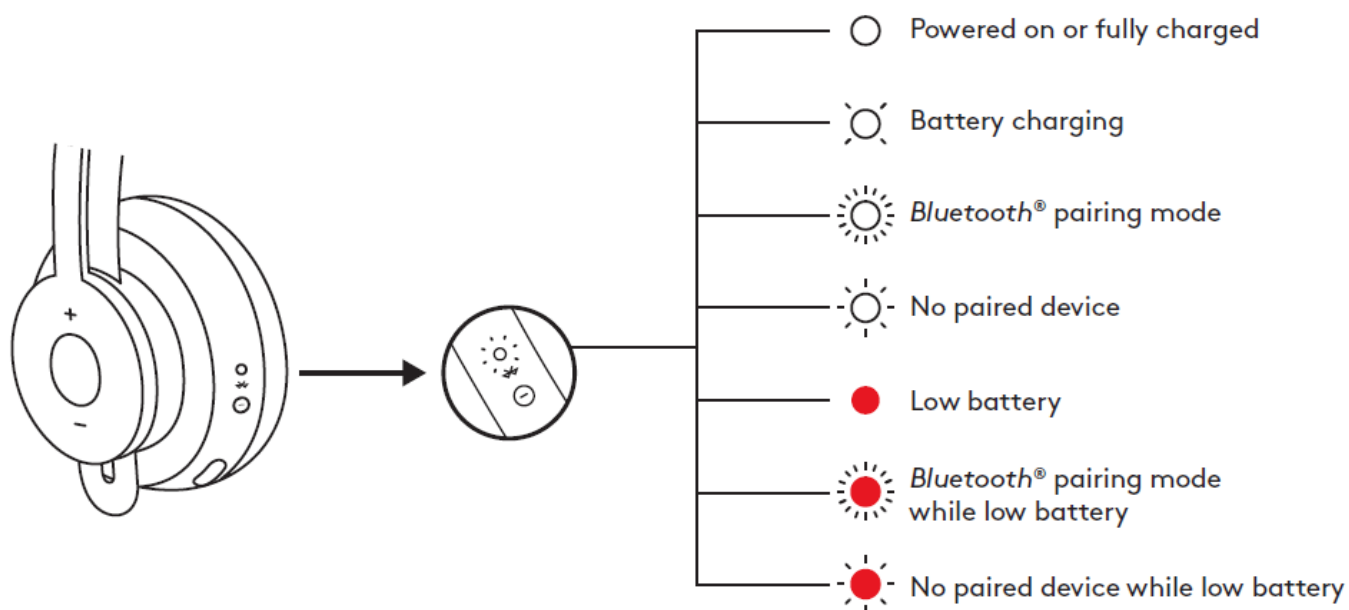

RECEIVER INDICATOR LIGHT

| TEAMS version | | |
|---------------|---------------------------------|---|
| Light | | Status |
| White | Fast flashing | Pairing mode |
| | Solid | Paired |
| | Repeat flashing on and off | Incoming call |
| Purple | Pulsing | Connecting to Teams / Teams notifications |
| | Flashing for 10 seconds and off | Failed connection to Teams |
| | Flashing 3 times and off | Not connected to Teams |
| | Solid | Connected to Teams |
| Red | Solid | Mute on |

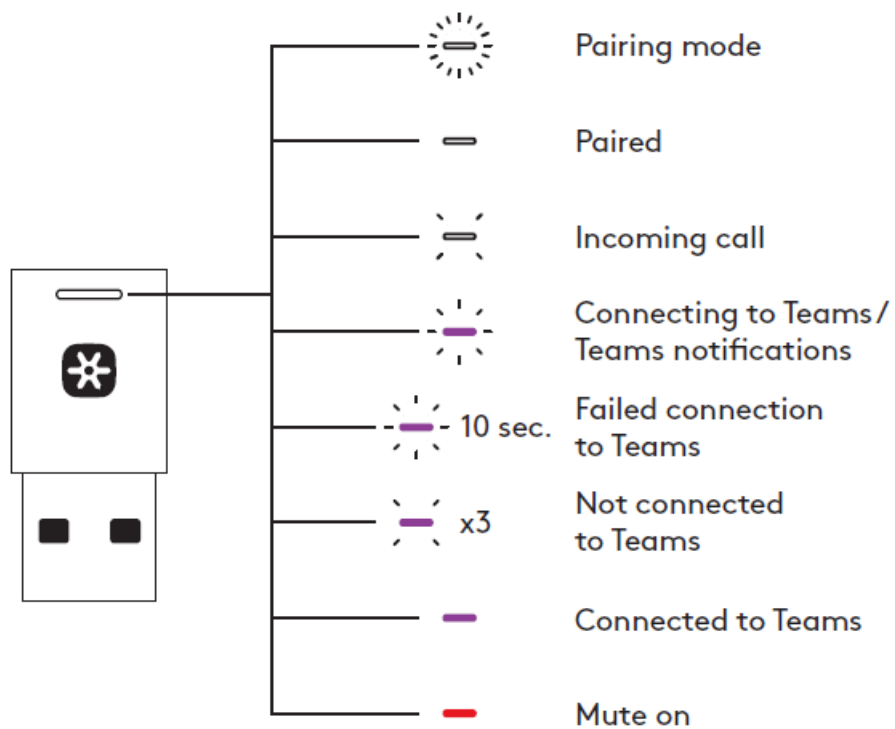

| UC version | | |
|------------|----------------------------|---------------|
| Light | | Status |
| White | Fast flashing | Pairing mode |
| | Solid | Paired |
| | Repeat flashing on and off | Incoming call |
| Red | Solid | Mute on |

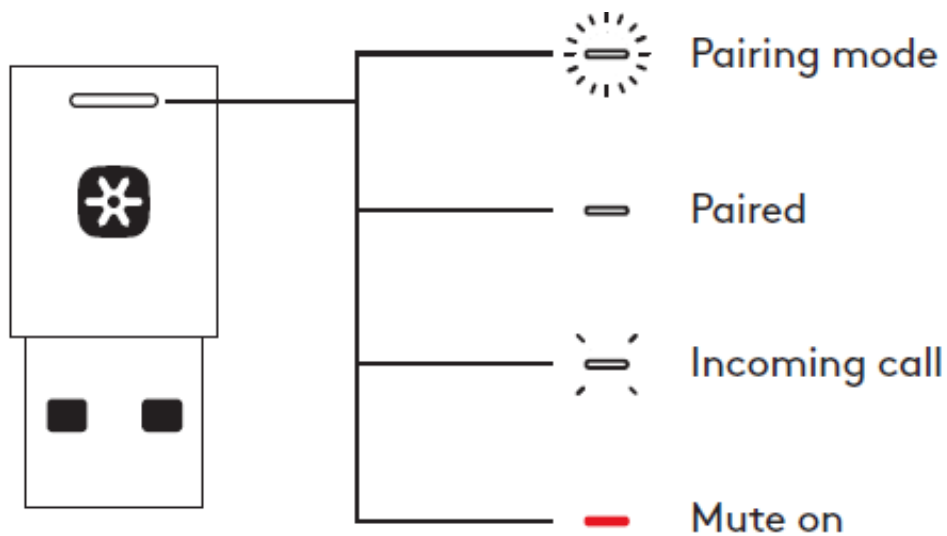

Note: Receiver light indicates headset status only.

CHARGING

Headset automatically powers off when left idle. Sleep timer can be changed in the Logi Tune App. Headset indicator light will turn RED when battery is low.

Charging via USB cable:

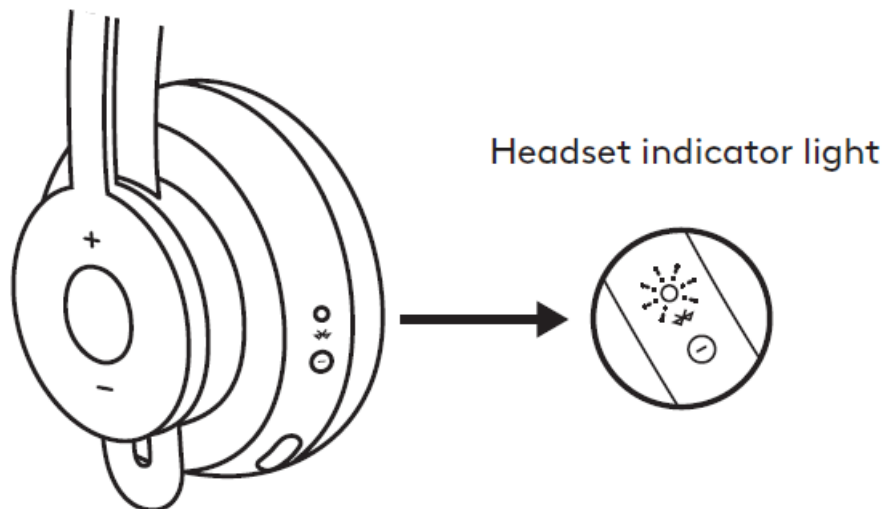

1. Plug the USB-C cable end into the USB-C port on the bottom of the earcup.
2. Plug the USB-A end into the USB-A charging port on your computer or AC adapter.
3. Indicator light will be a breathing white light for charging.
4. Indicator light will be solid white when fully charged
 - 2 hours will fully charge the battery.
 - 5 minutes will give you 1 hour of talk time.
5. Headset can be used with receiver and Bluetooth® paired while charging.

Charging via Qi wireless charger:

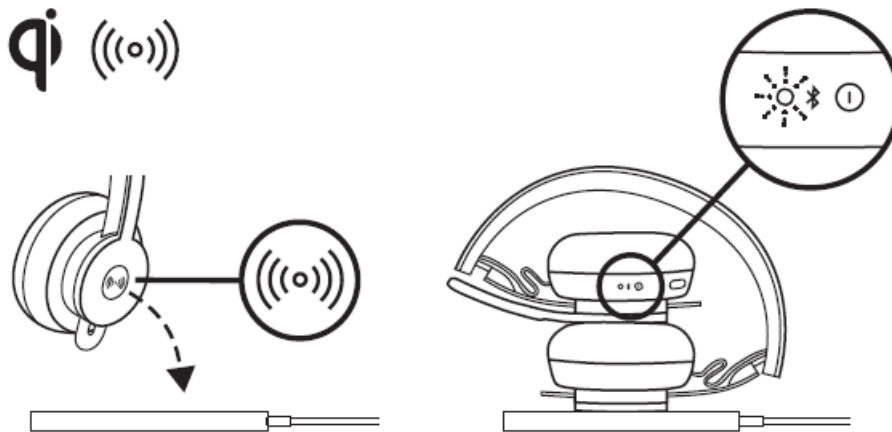

1. Fold headset with the wireless charging icon on the earcup to the outside.
2. Place earcup with wireless charging icon on top of any Qi wireless charging base.*
3. Indicator light will be a breathing, white light when charging.
4. Indicator light will be solid white when fully charged.
 - 2 hours of charging fully charges the battery.

LOGI TUNE APP

Install application

1. Download Logi Tune Desktop from www.logitech.com/tune
2. Download the Logi Tune mobile app from the Apple **App Store®** or **Google Play** stores by searching for “**Logi Tune**”



ADJUSTING SIDETONE

Side tone lets you hear your own voice during conversations so you are aware of how loud you are talking. In the Logi Tune app, select the side tone feature, and adjust the dial accordingly.

- A higher number means you hear more external sound.
- A lower number means you hear less external sound.

AUTO SLEEP TIMER

By default, your headset will automatically power off when not in use for one hour. Adjust the sleep timer in the Logi Tune App.

UPDATE YOUR HEADSET

It is recommended to update both your headset and receiver. To do so, download the Logi Tune Desktop from www.logitech.com/tune

RESET YOUR HEADSET

To reset your headset back to its original state, power headset on, press and hold the ANC button and volume '–' button for 5 seconds. The headset is successfully reset when it powers off and indicator light turns off.

Specifications

DIMENSIONS

HEADSET:

Height x Width x Depth: 174.7 x 176.7 x 70.7 mm

WEIGHT: 0.1808Kg

EARPADS: Height x Width x Depth: 70.7 x 70.7 x 16.4 mm

RECEIVER: Height x Width x Depth: 35.5 x 16.2 x 5.3 mm

ADAPTER: Height x Width x Depth: 106.7 x 17.5 x 10.1 mm

TECHNICAL SPECIFICATIONS

- **Microphone Type:** Omni-directional dual MEMS mic array Frequency response (Headset): 30~13kHz @ -10dB (music mode), 100~8kHz (talk mode)
- Frequency response (Microphone): 85~20kHz @-3dB
- **Battery type:** Built-in battery (Lithium ion)
- Battery life (talk time): 14 hrs (ANC on), 15 hrs (ANC off) Battery life (listening time): 14 hrs (ANC on), 16 hrs (ANC off) Bluetooth® version: 5.0
- **Wireless range:** Up to 30m /100 ft (open field line of sight)
- Qi Wireless charging enabled
- USB-A to C charging cable: 4.25 ft (130 cm)

www.logitech.com/support/zonewirelessplus

FAQ – FREQUENTLY ASKED QUESTIONS

Is my device supported on Windows 7?

Microsoft ended support for Windows 7 on January 14, 2020. While your device may still be compatible with Windows 7, we no longer provide technical support to products running on Windows 7. We recommend you upgrade your machine to Windows 8 or above to receive technical support.

You may also refer to Microsoft's information page regarding the end of support for Windows 7: <https://www.microsoft.com/windows/windows-7-end-of-life-support-information>

Is my device supported on Windows Vista?

Microsoft ended support for Windows Vista on April 11, 2017. While your device may still be compatible with Windows Vista, we no longer provide technical support to products running on Windows Vista. We recommend you upgrade your machine to Windows 8 or above to receive technical support.

You may also refer to Microsoft's information page regarding the end of support for Windows Vista: <https://docs.microsoft.com/lifecycle/products/windows-vista>

Can I connect to multiple headsets at the same time?

Mobile and PC devices allow connections to multiple Bluetooth devices, including multiple Logitech Zone Wireless Plus Headsets.

- Typically only one at a time can be used for listening.
 - Some mobiles support a “dual audio” feature, that allows media to play on two headsets simultaneously.
- The USB receiver connects to a single headset — it is not possible to connect it to more than one headset.

Multiple connections for Logitech Unifying peripherals

The Zone Wireless Plus receiver lets you connect up to six active Logitech Unifying keyboards and mice and one Zone Wireless Plus headset.

The Zone Wireless Plus receiver lets you connect up to six active Logitech Unifying keyboards and mice and one Zone Wireless Plus headset.

Multi-Functional Button (MFB)

The Multi-Functional Button (MFB) lets you answer, end, or reject calls, control your music, and use voice assistance such as Siri or Google Assistant.

HEADSET CONTROLS

| TEAMS version | | | |
|---------------------------------------|--------------------------------------|------------------------|----------------|
| | Usage | Button | Action |
| Call controls | Answer / End call | Multi-function | Short press |
| | Reject call | | 2 second press |
| | Resume call | | Short press |
| | Transfer active call to other device | | Short press |
| Teams activities | Check connection to teams | | Short press |
| | Quick access to Teams | | Short press |
| | Respond to Teams notifications | | Short press |
| | Trigger Teams voice skills (Cortana) | | 2 second press |
| Media controls | Play / Pause | Multi-function | Double press |
| | Track forward | Multi-function and “+” | Short press |
| | Track backward | Multi-function and “-” | Short press |
| Volume | Volume up | “+” | Short press |
| | Volume down | “-” | Short press |
| Headset connection and battery status | Check connectivity and battery life | “+” and “-” | Short press |

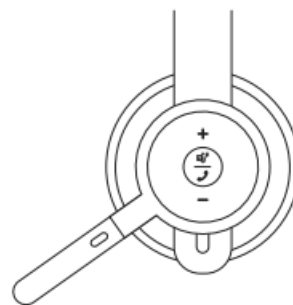

MSFT Teams version

| UC version | | | |
|-----------------|-------------------------------------|------------------------|----------------|
| | Usage | Button | Action |
| Call controls | Answer / End call | Multi-function | Short press |
| | Reject call | | 2 second press |
| Voice assistant | | Multi-function | 2 second press |
| Media controls | Play / Pause | Multi-function | Double press |
| | Track forward | Multi-function and "+" | Short press |
| | Track backward | Multi-function and "-" | Short press |
| Volume | Volume up | "+" | Short press |
| | Volume down | "-" | Short press |
| Headset status | Check connectivity and battery life | "+" and "-" | Short press |

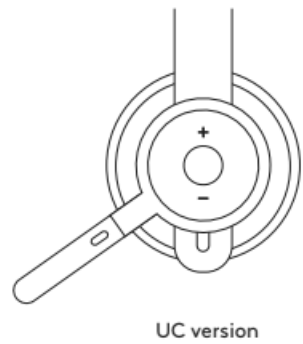

Note:

- Teams activities are only functional when Teams is running on an unlocked computer.
- Media control functionality depends on type of application.
- Call activities are always the first priority. When two devices are connected, the Bluetooth® connection will be prioritized over receiver. When two Bluetooth® devices are connected, the last active device will override the other.

Tip: Button customizations and Music EQ controls available on Logi Tune app.

How many Logitech peripherals can I pair to the Zone Wireless Plus receiver?

Any combination of keyboards and mice is allowed, as long as the total number of devices per Zone Wireless Plus receiver does not exceed seven (including your headset), and as long as all peripherals and the receiver carry the Unifying logo.

Documents / Resources

| | |
|---|--|
|  <p>LOGITECH ZONE WIRELESS PLUS 罗技 ZONE WIRELESS PLUS USB-C / USB-A 10/18/2021</p> <p>logitech</p> | Logitech Zone Wireless Plus [pdf] User Manual Zone Wireless Plus, Logi Tune Desktop |
|---|--|

References

- [Logitech | Defy Logic - Tools to Create a Better Tomorrow](#)
- [Logi Tune - Software App for Webcams, Headsets & Logi Dock](#)