

[Skip to content](#)

[Manuals+](#)

User Manuals Simplified.

logitech Z333 Speaker System with Subwoofer User Guide



[Home](#) » [Logitech](#) » logitech Z333 Speaker System with Subwoofer User Guide

Contents [hide](#)

[1 logitech Z333 Speaker System with Subwoofer](#)

[2 KNOW YOUR PRODUCT](#)

[3 CONNECT THE SPEAKERS](#)

[4 CONNECT TO AUDIO SOURCE](#)

[5 CONNECT TO TWO DEVICES SIMULTANEOUSLY](#)

[6 ADJUST THE VOLUME](#)

[7 Documents / Resources](#)

[7.1 References](#)

[8 Related Posts](#)



logitech Z333 Speaker System with Subwoofer



KNOW YOUR PRODUCT

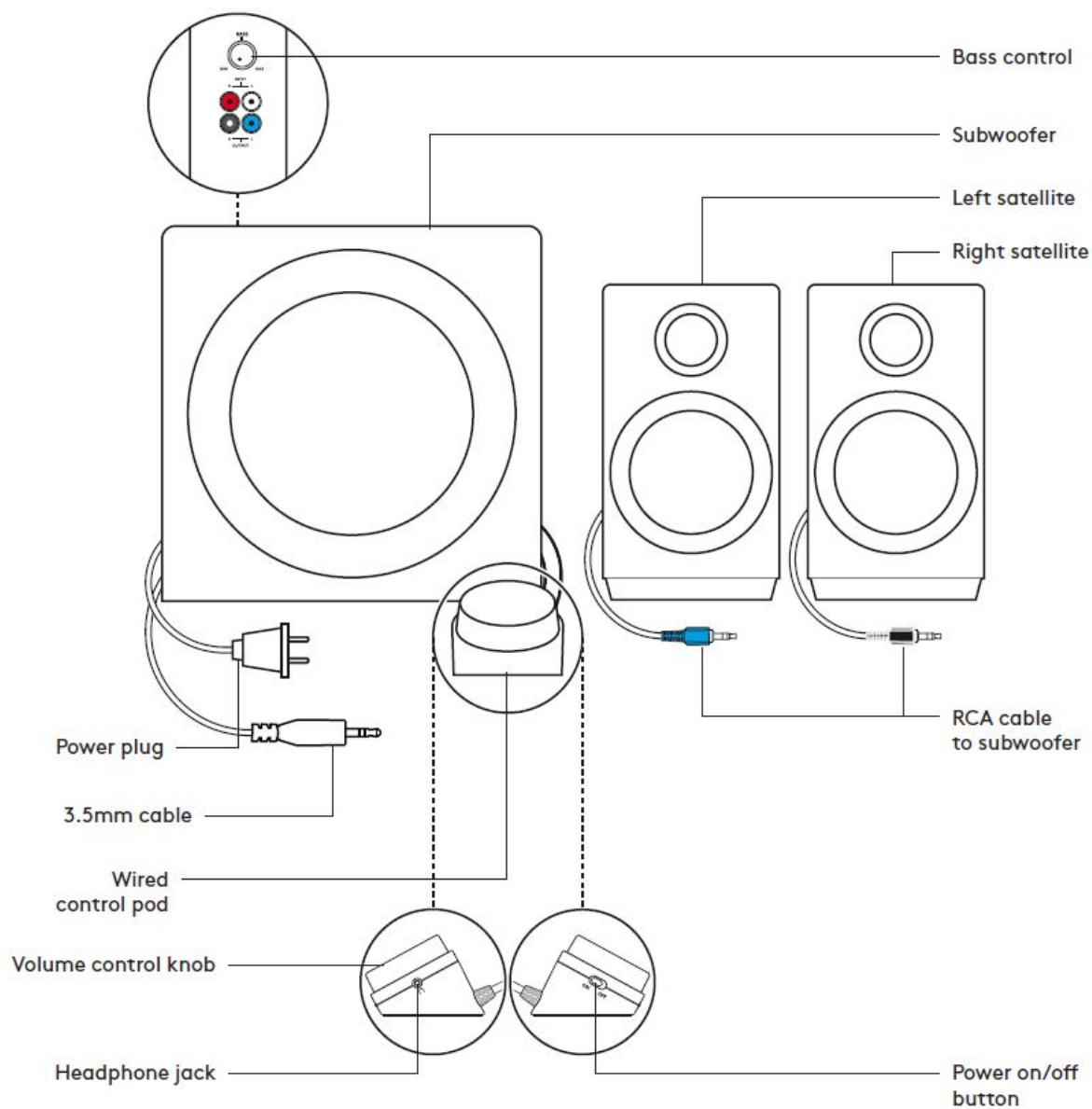

CONNECT THE SPEAKERS

1. Plug the black RCA connector on the right satellite into the black subwoofer jack.
2. Plug the blue RCA connector on the left satellite into the blue subwoofer jack.
3. Plug the power plug into an electrical outlet.

1

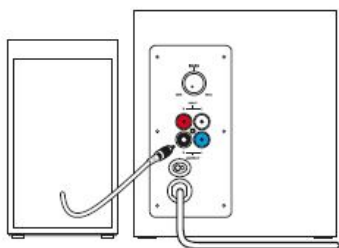

2

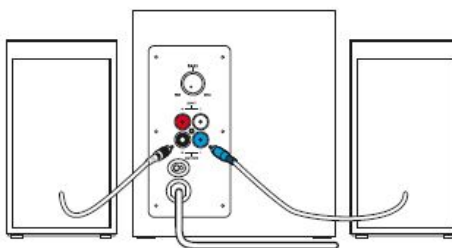

3

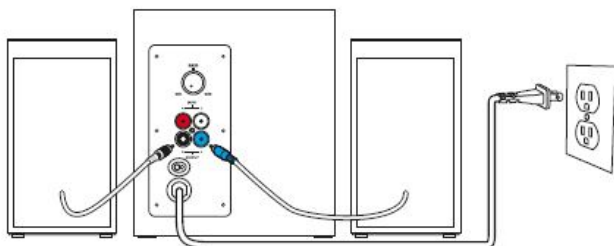

CONNECT TO AUDIO SOURCE

1. 1A. For 3.5 mm connection:

Connect the 3.5mm plug from the subwoofer to the audio jack on your device (computer, tablet, smartphone, etc.)

• 1B. For RCA connection:

Connect one end of the RCA cable to the corresponding RCA jack on the back of the subwoofer. Insert the other end of the RCA cable into the RCA outlet on your device (TV, Gaming Console, etc)

Note: The RCA cable is not included in the box and must be purchased separately.

2. Plug your headphones into the headphone jack on the control pod. Adjust the volume either from the control pod or the audio source.
3. Power speakers on/off by sliding the power on/off button on the wired control pod.

1A

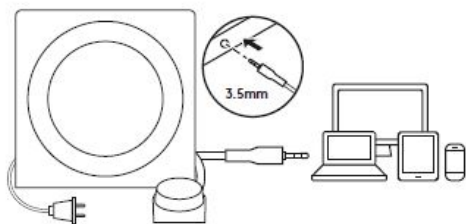

1B

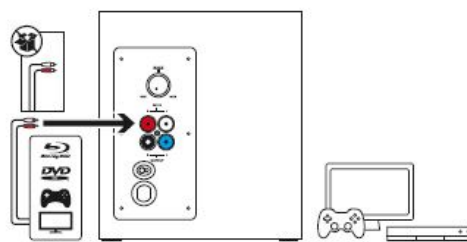

2

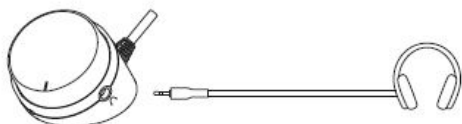

3

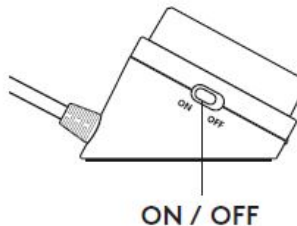

CONNECT TO TWO DEVICES SIMULTANEOUSLY

1. Connect to two devices at the same time through the RCA connector on the back of the subwoofer and the 3.5mm cable on the subwoofer.
2. To switch between audio sources just pause audio on one connected device and play audio from the other connected

device.

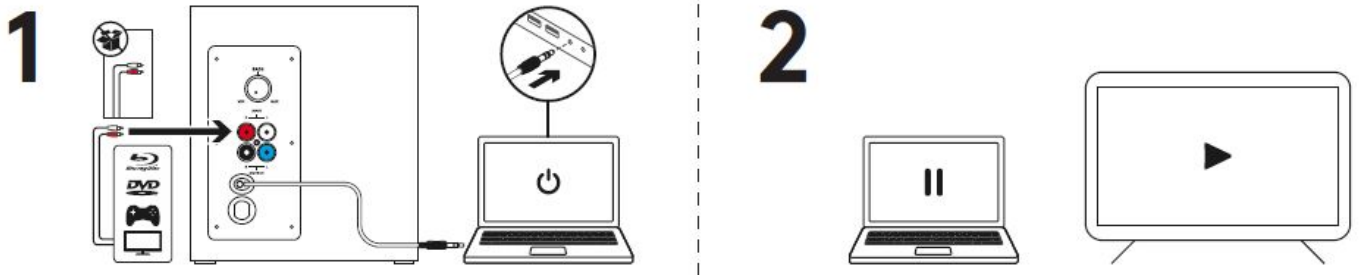

ADJUST THE VOLUME

1. Adjust the volume of Z333 with the knob on the control pod.
 - Turn the knob clockwise (to the right) to increase volume.
 - Turn the knob counter-clockwise (to the left) to decrease volume.

ADJUST THE BASS

2. Adjust the bass level by turning the bass control knob located at the back of your subwoofer. Turn the bass knob to the right for deeper bass or to the left for less bass.



© 2019 Logitech. Logitech, Logi, and other Logitech marks are owned by Logitech and may be registered. All other trademarks are the property of their respective owners. Logitech assumes no responsibility for any errors that may appear in this manual. Information contained herein is subject to change without notice.

www.logitech.com/support/Z333.

Documents / Resources

Z333 SPEAKER SYSTEM
WITH SUBWOOFER
Complete Setup Guide

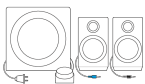

logitech

[logitech Z333 Speaker System with Subwoofer](#) [pdf] User Guide

Z333 Speaker System with Subwoofer, Z333, Z333 Speaker System, Z333 Subwoofer, Speaker System with Subwoofer, Speaker System, Subwoofer

References

- [Logitech Support + Download](#)

[Manuals+](#),

- [home](#)
- [privacy](#)