



logitech Wireless Combo MK330 User Guide

[Home](#) » [Logitech](#) » logitech Wireless Combo MK330 User Guide 

Contents

- [1 logitech Wireless Combo MK330](#)
- [2 WHAT IN THE BOX](#)
- [3 POWER](#)
- [4 CONNECTION](#)
- [5 Mouse Features](#)
- [6 Keyboard features](#)
- [7 Getting started is easy](#)
- [8 Help with setup](#)
- [9 CONTACT](#)
- [10 Documents / Resources](#)
 - [10.1 References](#)
- [11 Related Posts](#)



logitech Wireless Combo MK330



WHAT IN THE BOX

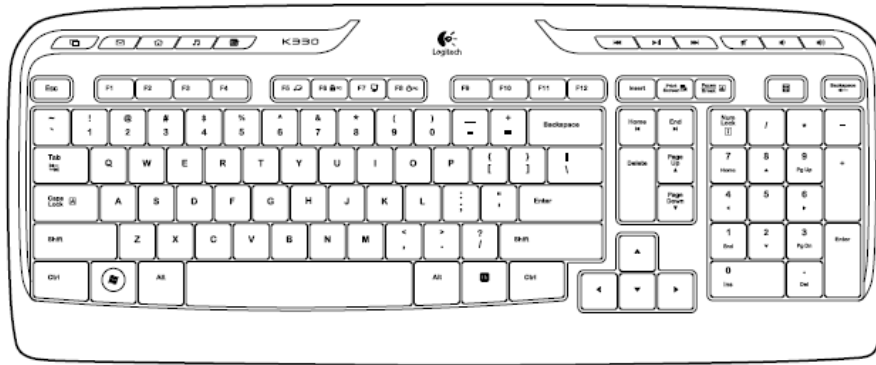

K330

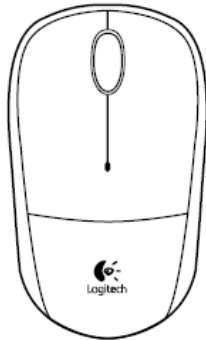

M215

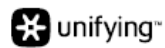

POWER

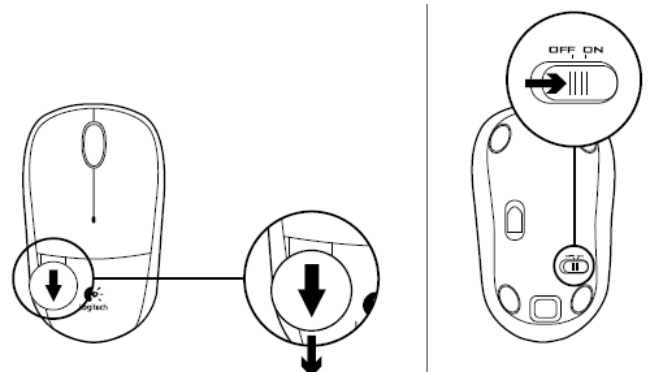
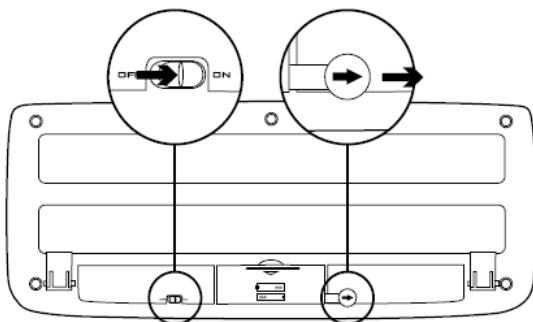
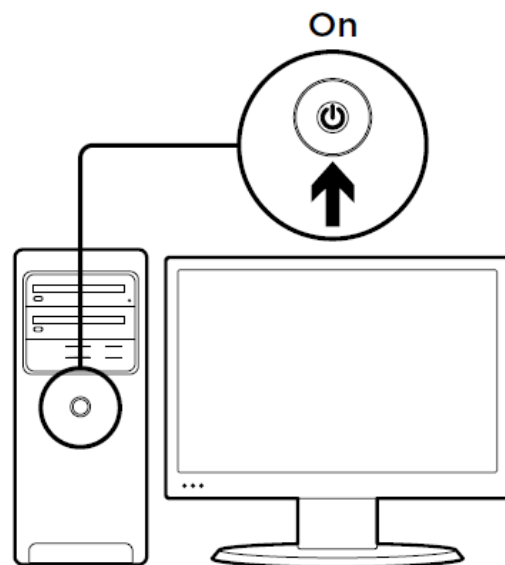
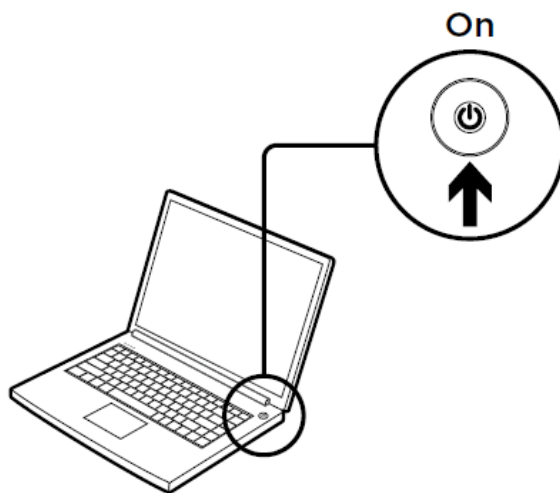

- Your mouse and keyboard are now ready for use.

CONNECTION

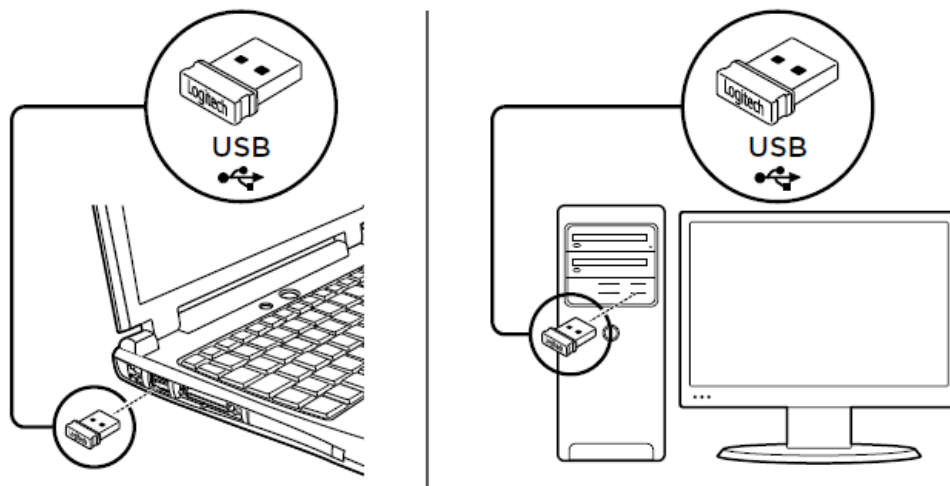

Mouse Features

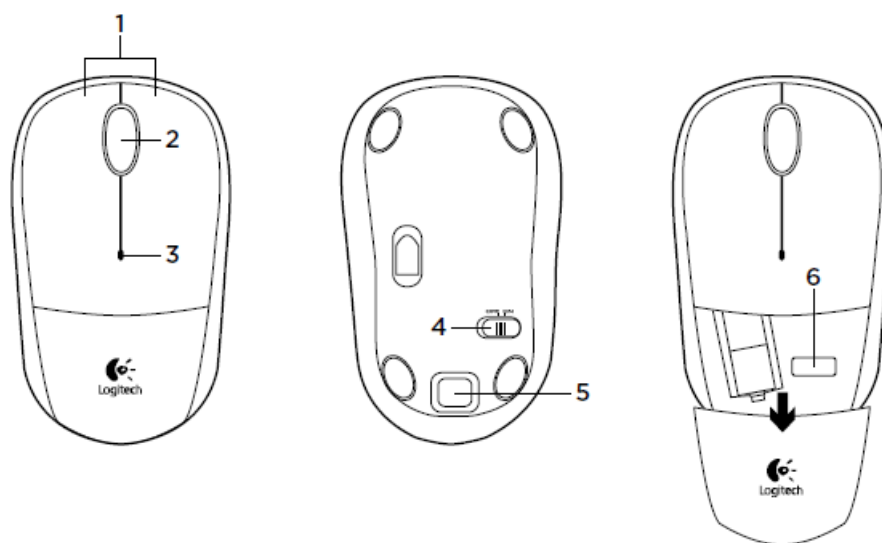

1. Left and right mouse buttons
2. Scroll wheel
 - Press the wheel down for middle button (function can vary by software application)
3. Battery LED
 - Flashes red when battery power is low
4. On/Off slider switch
5. Battery door release button
6. Unifying receiver storage

Keyboard features

Hotkeys

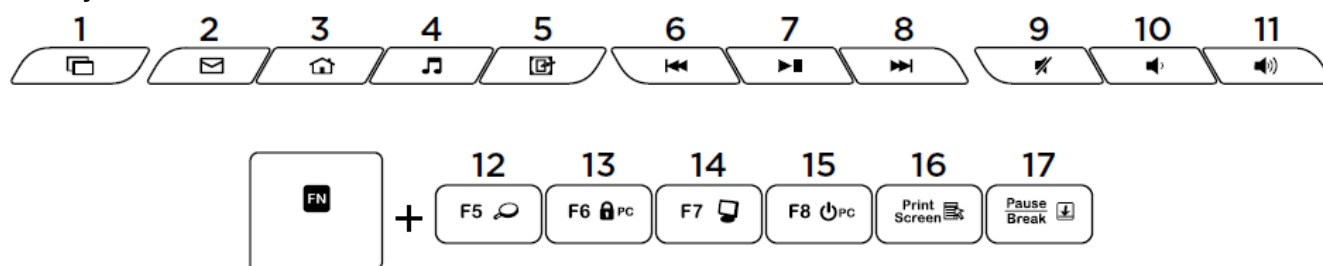

1. Switch applications
2. Launch e-mail
3. Home
4. Launch media player
5. Show Desktop
6. Previous track
7. Play/pause
8. Next track
9. Mute
10. Volume down
11. Volume up

- **FN keys**

- To use the FN function, press and hold the FN key, and then press the F-key you want to use.

12. Search
13. Lock PC
14. My computer
15. PC sleep
16. Contextual menu
17. Scroll lock

The Logitech® Unifying receiver

Plug it. Forget it. Add to it.

Your new Logitech product ships with a Logitech Unifying receiver. Did you know you can add a compatible Logitech wireless device that uses the same receiver as your current Logitech Unifying product?

Are you Unifying-ready?

If you have a Logitech wireless device that's Unifying-ready, you can pair it with additional Unifying devices. Just look for the orange Unifying logo on the new device or its packaging. Build your ideal combo. Add something. Replace something. It's easy, and you'll use only one USB port for up to six devices.

Getting started is easy

If you're ready to pair your device(s) via Unifying, here's what you need to do:

1. Make sure your Unifying receiver is plugged in.
2. If you haven't already, download the Logitech® Unifying software from www.logitech.com/unifying.
3. Start the Unifying software* and follow the onscreen instructions to pair the new wireless device with your existing Unifying receiver.

- Go to Start / All Programs / Logitech / Unifying / Logitech Unifying Software.

Help with setup

- Are the mouse and keyboard powered on?
- Is the Unifying receiver securely plugged into a computer USB port? Try changing USB ports.
- If the Unifying receiver is plugged into a USB hub, try plugging it directly into a USB port on your computer.
- Did you pull the battery tab on the mouse and keyboard? Check the orientation of the batteries inside the mouse and keyboard, or replace the batteries. The mouse uses one AA alkaline battery and the keyboard uses two AAA alkaline batteries.
- Remove metallic objects between the mouse/keyboard and the Unifying receiver.
- Try moving the Unifying receiver to a USB port closer to the mouse and keyboard.
- Try reconnecting the mouse/keyboard and Unifying receiver using the Logitech Unifying software. (Refer to the Unifying section in this guide.)

CONTACT

What do you think?

Please take a minute to tell us.
Thank you for purchasing our product.

www.logitech.com/ithink

- **Argentina:** +0800-555-3284
- **Brasil:** +0 800-891-4173
- **Canada:** +1 866-934-5644
- **Chile:** 1230 020 5484
- **Colombia:** 01-800-913-6668
- **Mexico:** 01.800.800.4500
- **United States:** +1 646-454-3200



www.logitech.com

M/N: C-UO007

- **Rating:** 5V= 100mA
- **FCC ID:** JNZCUO007
- **IC:** 4418A-CU0007

MADE IN CHINA

- **CNC:** C-8941
- **CFT:** RCPLOCU10-1356

M/N: C-U0008

- **Rating:** 5V= 100mA
- **FCC ID:** JNZCUO008
- **IC:** 4418A-CUO008

MADE IN CHINA

- **SUBTEL:** 2217
- **CNC:** C-9341
- **CFT:** RCPLOCU11-0321



© 2013 Logitech. All rights reserved. Logitech, the Logitech logo, and other Logitech marks are owned by Logitech and may be registered. All other trademarks are the property of their respective owners. Logitech assumes no responsibility for any errors that may appear in this manual. Information contained herein is subject to change without notice.

621-000227.002

Documents / Resources

	logitech Wireless Combo MK330 [pdf] User Guide Wireless Combo MK330, Wireless Combo, MK330
---	---

References

-  [Logitech | Official Online Store](#)
-  [Logitech | Defy Logic - Tools to Create a Better Tomorrow](#)
-  [Logitech Support + Download](#)