



# logitech SCRIBE User Guide

[Home](#) » [Logitech](#) » logitech SCRIBE User Guide 

## Contents

### 1 SCRIBE

- 1.1 Setup Guide
- 1.2 WHAT'S IN THE BOX
- 1.3 CAMERA I/O
- 1.4 CONNECTIONS OVERVIEW
- 1.5 RECOMMENDED CAMERA PLACEMENT HEIGHT
- 1.6 STEP 1: ATTACH THE CAMERA MOUNTING BRACKET
- 1.7 STEP 2: PLUG IN THE CAT5E CABLE AND CHOOSE A ROUTING OPTION
- 1.8 STEP 3: ATTACH THE CAMERA ONTO THE CAMERA MOUNTING BRACKET
- 1.9 STEP 4: CONNECT THE CAT5E CABLE TO THE POWER INJECTOR
- 1.10 STEP 5: CONNECT THE POWER INJECTOR TO A POWER OUTLET
- 1.11 STEP 6: CONNECT SECOND CAT5E CABLE TO THE POWER INJECTOR
- 1.12 STEP 7: CONNECT THE OTHER END TO THE DONGLE TRANSCEIVER. PLUG THE DONGLE TRANSCEIVER INTO THE MEETING ROOM PC.
- 1.13 RECOMMENDED BUTTON PLACEMENT HEIGHT
- 1.14 STEP 8: INSTALL SHARE BUTTON
- 1.15 STEP 9: START WHITEBOARD SHARING FROM MEETING ROOM TOUCH CONTROLLER
- 1.16 STEP 10: CONFIRM CALIBRATION TO FINISH SETUP
- 1.17 STEP 11: READY TO GO!
- 1.18 [www.logitech.com/support](http://www.logitech.com/support)

### 2 Documents / Resources

#### 2.1 References

### 3 Related Posts

## SCRIBE

### Setup Guide





## WHAT'S IN THE BOX

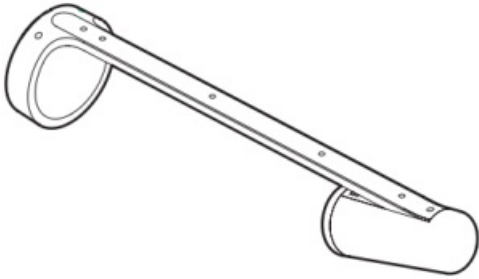

Camera Unit

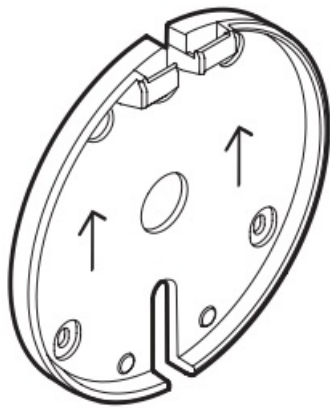

Camera Mounting Bracket

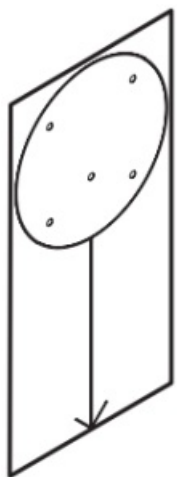

Mounting Template

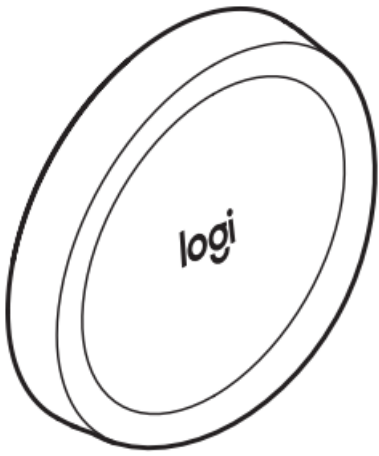

Share Button

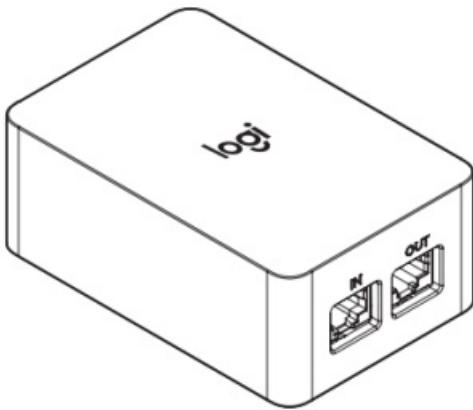

Power Injector

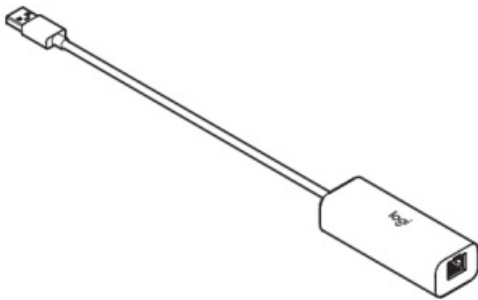

Dongle Transceiver

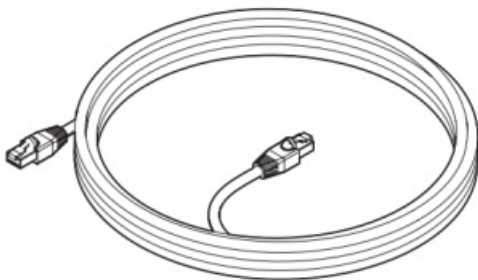

(2x)

CAT5e Cables

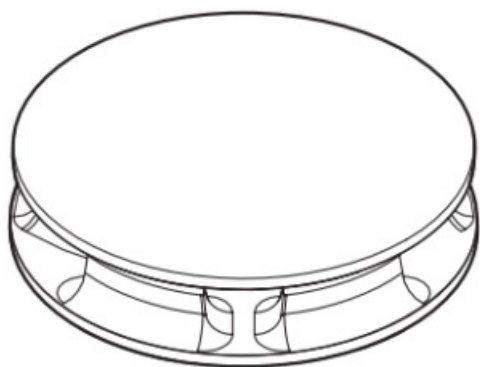

(2x)

Cable Clips

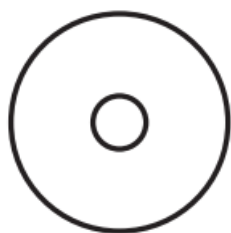

(4x)

Boundary Stickers

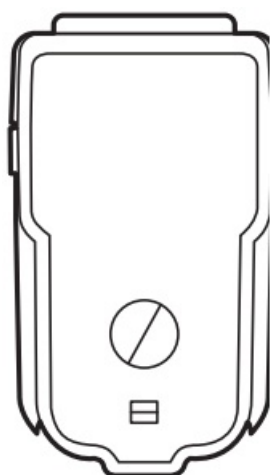

IEC C8 Power Cord Adapter

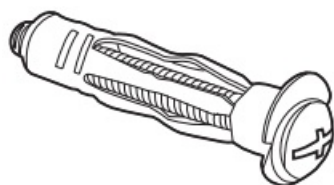

(4x)

Molly Bolts

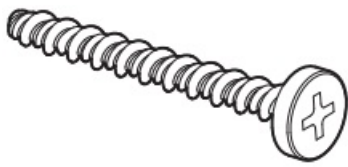

(4x)

Wood Screws

## CAMERA I/O

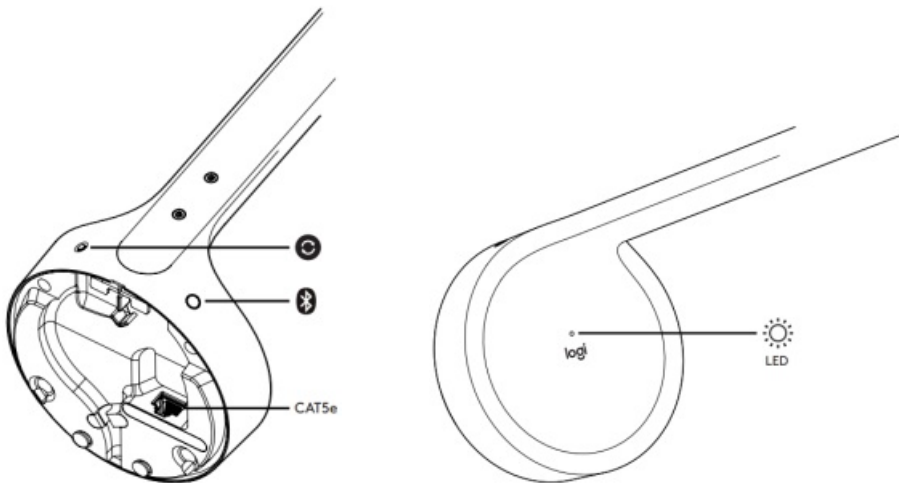

## CONNECTIONS OVERVIEW

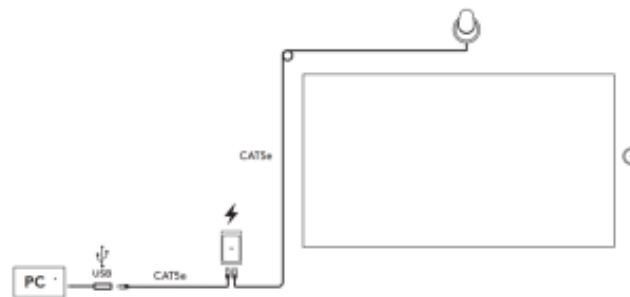

## RECOMMENDED CAMERA PLACEMENT HEIGHT

If needed, apply boundary stickers to mark the max capture area.

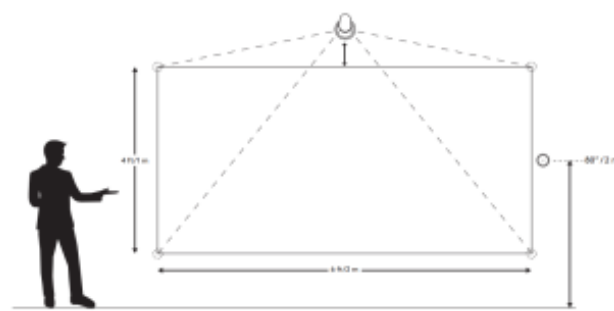

## STEP 1: ATTACH THE CAMERA MOUNTING BRACKET

Mark screw hole locations using the mounting template.

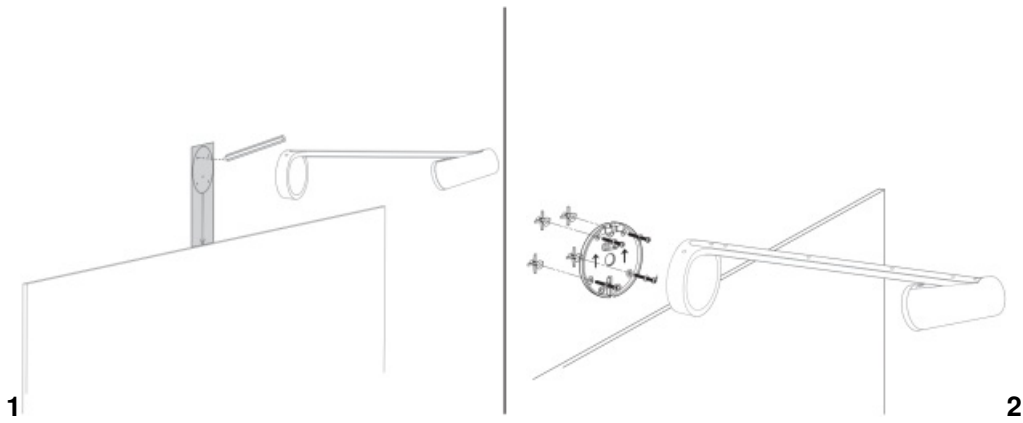

## STEP 2: PLUG IN THE CAT5E CABLE AND CHOOSE A ROUTING OPTION

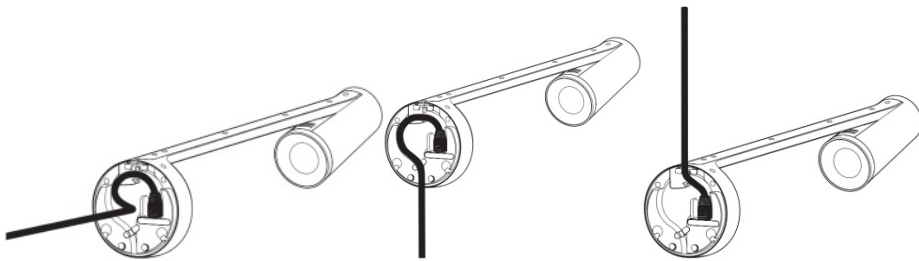

## STEP 3: ATTACH THE CAMERA ONTO THE CAMERA MOUNTING BRACKET

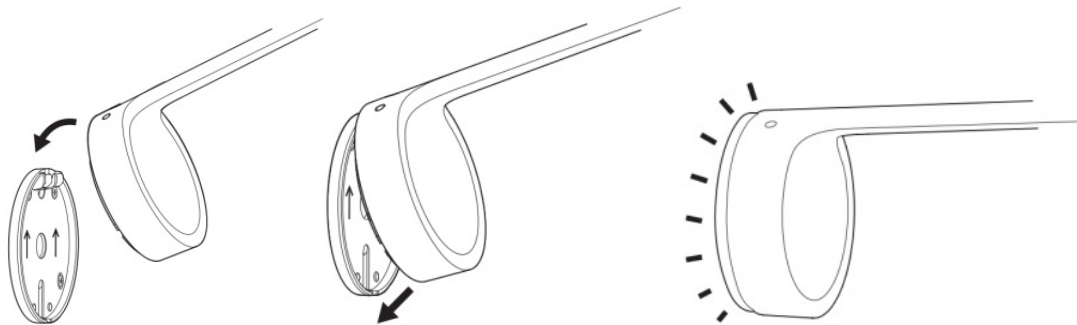

## STEP 4: CONNECT THE CAT5E CABLE TO THE POWER INJECTOR

Insert cable connected to camera to "OUT".

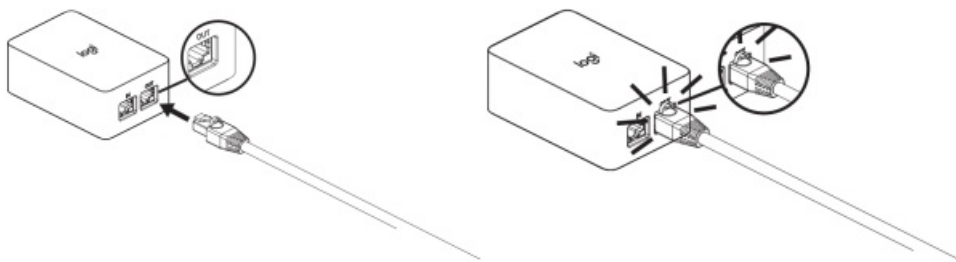

## STEP 5: CONNECT THE POWER INJECTOR TO A POWER OUTLET

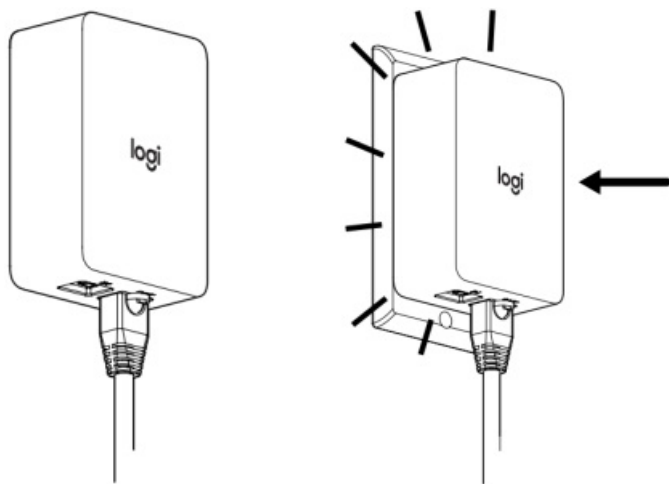

#### STEP 6: CONNECT SECOND CAT5E CABLE TO THE POWER INJECTOR

Insert cable connected to camera to “IN”.

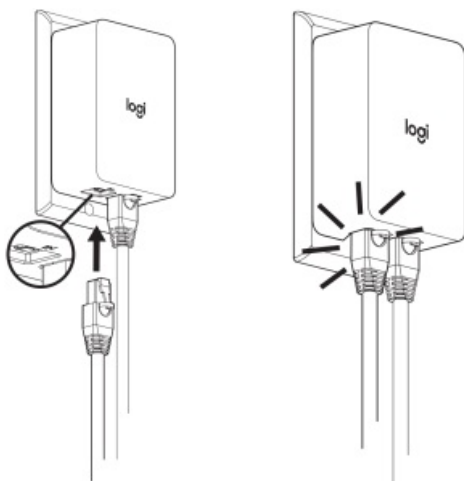

#### STEP 7: CONNECT THE OTHER END TO THE DONGLE TRANSCEIVER. PLUG THE DONGLE TRANSCEIVER INTO THE MEETING ROOM PC.

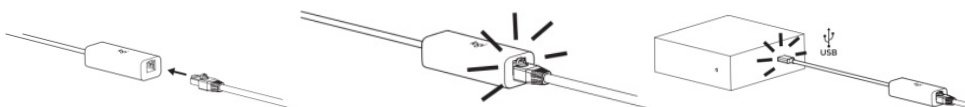

#### RECOMMENDED BUTTON PLACEMENT HEIGHT

Install the button 30"- 48" from the floor.

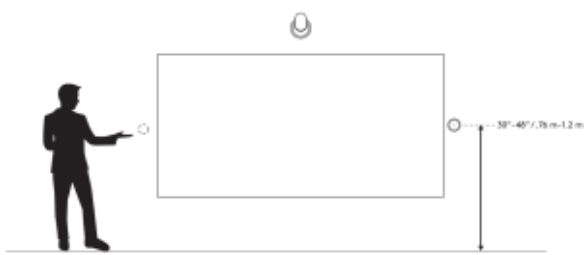

#### STEP 8: INSTALL SHARE BUTTON



Remove the battery pull tabs only after you have mounted Share Button to the wall.

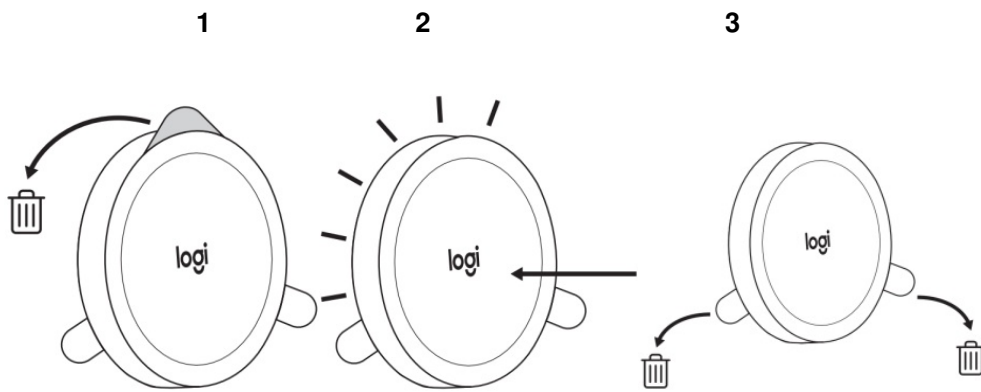

#### STEP 9: START WHITEBOARD SHARING FROM MEETING ROOM TOUCH CONTROLLER

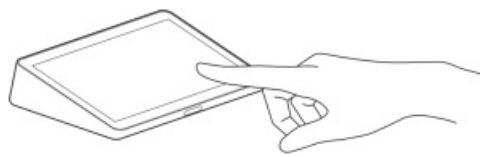

#### STEP 10: CONFIRM CALIBRATION TO FINISH SETUP

If calibration is correct, press the Share button to confirm. If calibration is incorrect, download Logitech Sync to adjust boundaries. [logitech.com/sync](https://www.logitech.com/sync).

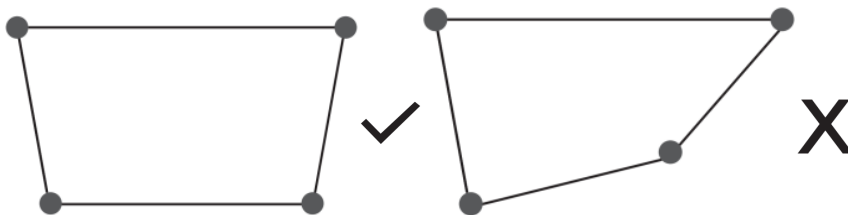

#### STEP 11: READY TO GO!

Press Share Button to easily start/stop whiteboard sharing into meetings.



[www.logitech.com/support](https://www.logitech.com/support)

© 2021 Logitech, Logi and the Logitech Logo are trademarks or registered trademarks of Logitech Europe S.A. and/or its affiliates in the U.S. and other countries. All other trademarks are the property of their respective owners. Logitech assumes no responsibility for any errors that may appear in this manual. Information contained herein is subject to change without notice.



Documents / Resources

	<a href="#">logitech SCRIBE</a> [pdf] User Guide logitech, SCRIBE
---	--

References

- [logi Sync | Video Conferencing Device Management Software](#)
- [logi Logitech Support + Download](#)