



logitech MK550 Wireless Wave Ergonomic Keyboard and Mouse Combo User Guide

[Home](#) » [Logitech](#) » logitech MK550 Wireless Wave Ergonomic Keyboard and Mouse Combo User Guide 

Contents

- [1 logitech MK550 Wireless Wave Ergonomic Keyboard and Mouse Combo](#)
- [2 Product Information](#)
- [3 FAQ](#)
- [4 WHAT IS IN THE BOX](#)
- [5 Keyboard features: F-key usage](#)
- [6 Keyboard features](#)
- [7 Keyboard features](#)
- [8 Mouse features](#)
- [9 Battery management](#)
- [10 Troubleshooting](#)
- [11 Documents / Resources](#)
 - [11.1 References](#)

logitech[®]

logitech MK550 Wireless Wave Ergonomic Keyboard and Mouse Combo



Product Information

Specifications

- Keyboard Model: K350
- Mouse Model: M510
- Keyboard Battery Life: Up to 3 years*
- Mouse Battery Life: Up to 2 years*

Keyboard Features

The keyboard features user-friendly enhanced F-keys that allow you to easily launch applications. To use the enhanced functions with yellow icons, follow these steps:

1. Press and hold the FN key on the keyboard.
2. While holding the FN key, press the desired F-key.

Note: In the software settings, you can invert the FN mode if you prefer to access the enhanced functions directly without having to press the FN key.

Enhanced Functions

The keyboard offers various enhanced functions for different tasks:

- Application Switcher
- Zoom in/out documents
- Bring up Windows desktop gadgets or settings
- Open Windows Photo Gallery
- Multimedia navigation
- Media player
- Windows Media Center

- Windows Calculator
- PC sleep

Productivity Zone

The keyboard has a dedicated Productivity Zone that allows you to launch specific document, spreadsheet, and calendar applications using the FN key in combination with the corresponding F-keys.

Favorites Zone

The Favorites Zone allows you to program your favorite applications, folders, or websites using a long, simultaneous press of the FN key and the corresponding F4, F5, or F6 key.

Internet Zone

The Internet Zone enables you to easily launch your internet browser, instant message application, e-mail application, and Windows search using the FN key in combination with the corresponding F-keys.

Convenience Zone

The Convenience Zone provides quick access to battery status check and CD-DVD tray opening/closing using the FN key in combination with the corresponding F-keys.

Mouse Features

- Battery LED indicator
- Vertical and side-to-side scrolling (Side-to-side scrolling requires software installation.)
- Back and forward buttons (Customizable with preferred functions through Logitech software)
- On/Off slider
- Battery-door release
- Unifying receiver storage

Battery Management

The keyboard has a battery life of up to three years, and the mouse has a battery life of up to two years.* Both devices automatically go into sleep mode after a few minutes of inactivity to conserve battery power. They will resume operation immediately when used again.

Checking Keyboard Battery Level

You can check the keyboard's battery level using either of the following options:

1. Press FN + F11. If the battery status indicator glows green for 10 seconds, the batteries are good. If it blinks red, the battery level is at 10% and you have a few days of battery power left.
2. Launch the SetPoint Software and click on the Keyboard Battery tab to see the current keyboard battery level.

Checking Mouse Battery Level

To check the mouse's battery level, follow these steps:

1. Turn the mouse off and then back on using the On/Off switch located on the bottom of the mouse.
2. If the LED on top of the mouse glows green for 10 seconds, the batteries are good. If it blinks red, the battery level is at 10% and you have a few days of battery power left.

FAQ

Q: How long does the keyboard battery last?

The keyboard has a battery life of up to three years.*

Q: How long does the mouse battery last?

The mouse has a battery life of up to two years.*

Q: What should I do if the battery level is low?

If the battery level is low, replace the batteries with new ones.

Q: Do I need to install any software for advanced features?

Yes, you need to install the SetPoint Software to access advanced features such as application switching, customization, and battery level monitoring.

Q: How can I customize the back and forward buttons on the mouse?

You can customize the back and forward buttons to perform different functions using the Logitech software.

Getting started with Logitech® Wireless Wave Combo MK550

WHAT IS IN THE BOX



K350



M510



1



2

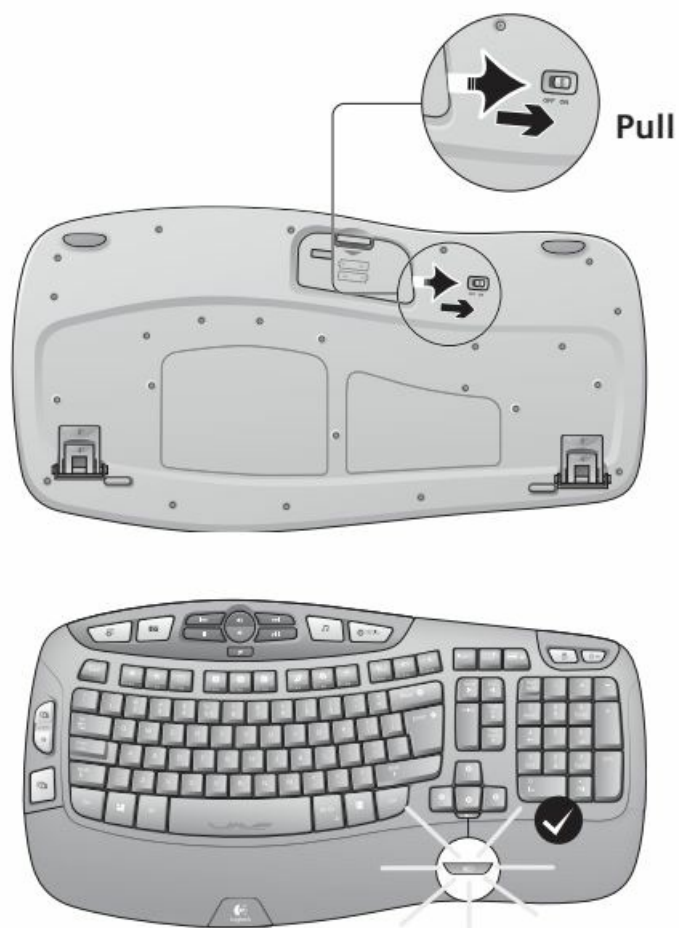

Español TIRAR

Français TIRER

Português PUXE

3

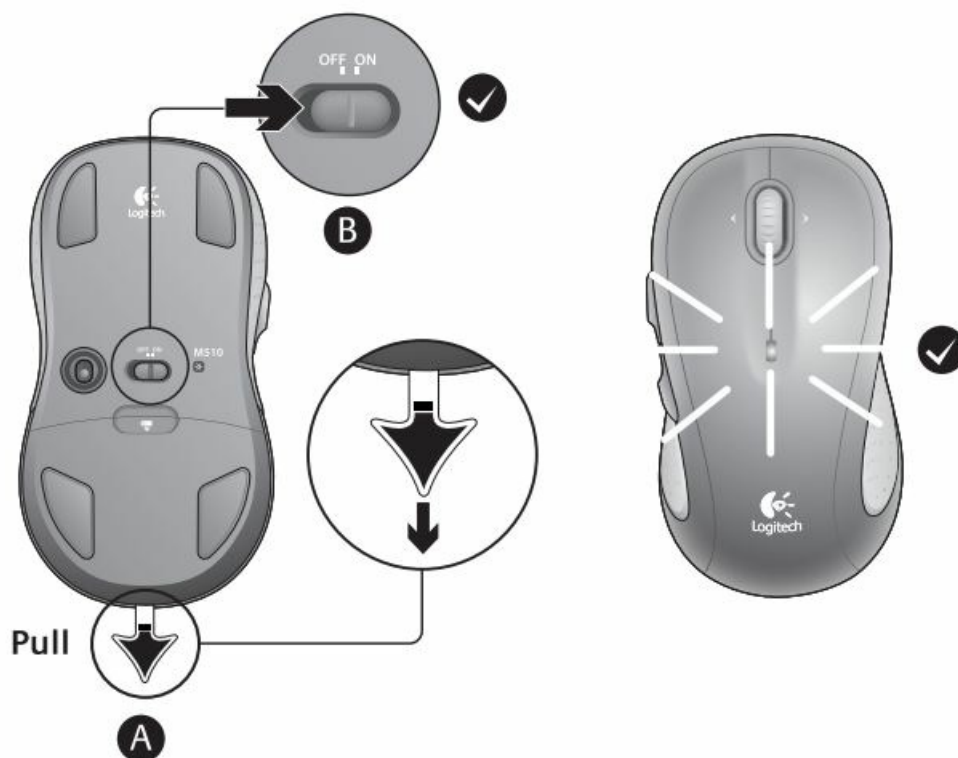

Your Keyboard and mouse are now ready for use. Install the Logitech® SetPoint™ Software to do the following:

- Enable and customize the keyboard hotkeys (F-keys and media keys)
- Enable the tilt wheel and customize up to 5 buttons on the mouse

Keyboard features: F-key usage

User-friendly enhanced F-keys let you launch applications easily. To use the enhanced functions (yellow icons), first press and hold the FN key; second, press the F-key you want to use.

Tip In the software settings, you can invert the FN mode if you prefer to access directly the enhanced functions without having to press the FN key.

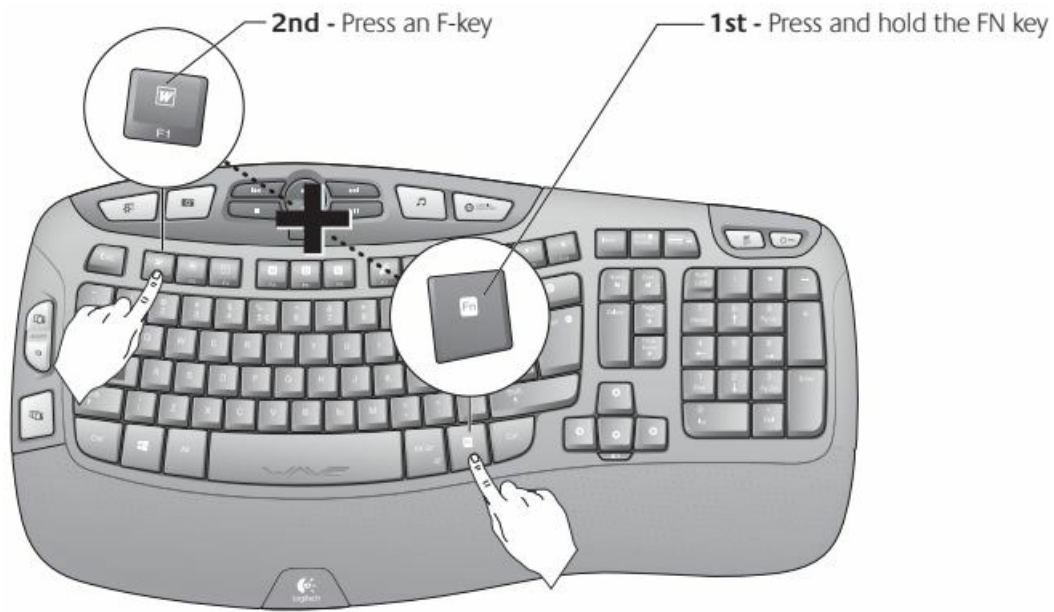

Keyboard features

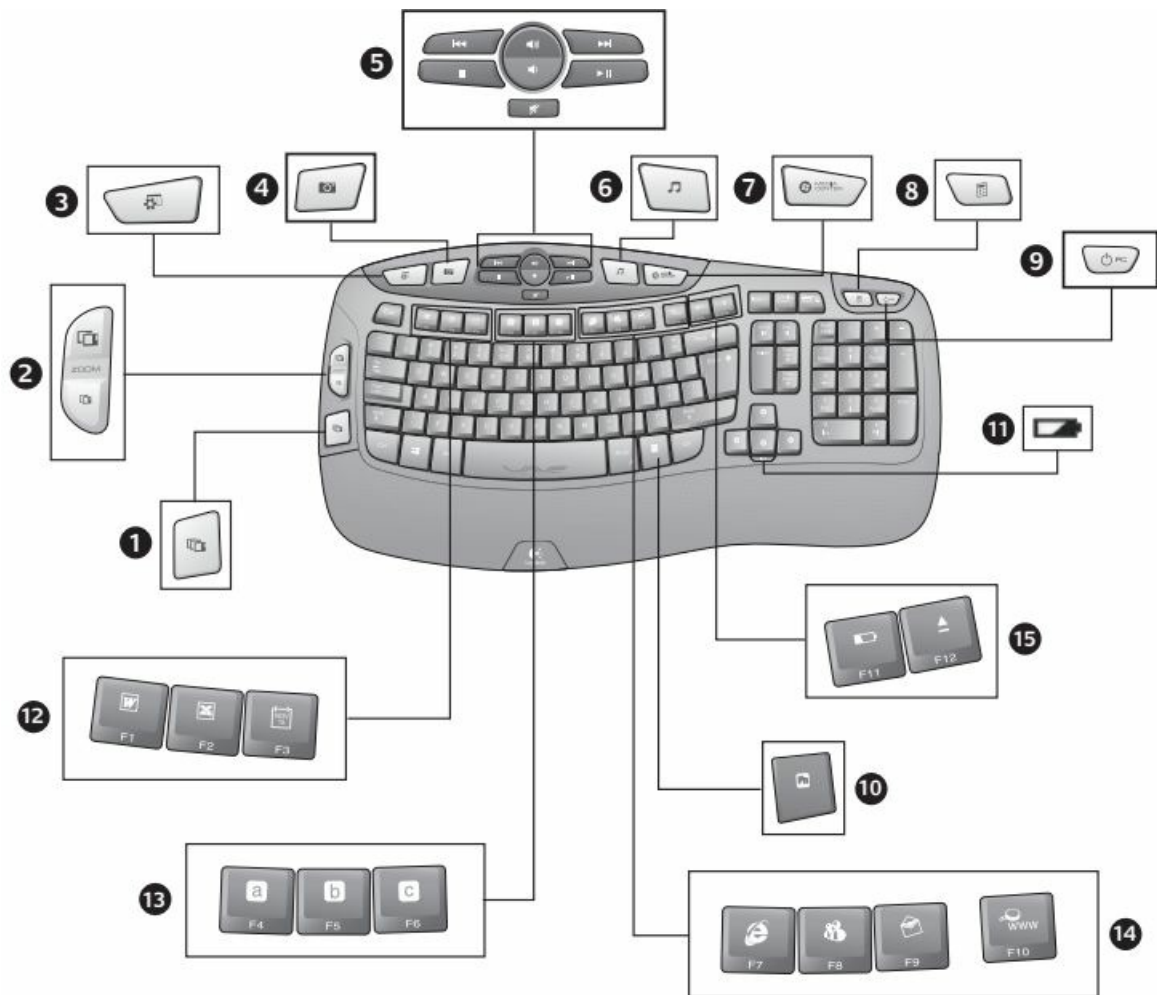

Keyboard features

1. Application Switcher*
2. Zoom in/out documents
3. Bring up Windows desktop gadgets or Settings
4. Open Windows Photo Gallery
5. Multimedia navigation
6. Media player
7. Windows Media Center*
8. Windows Calculator
9. PC sleep
10. FN key (for use with F-keys)
11. Battery status indicator (FN + F11)
12. **Productivity zone**
 - FN + F1 Launches document application*
 - FN + F2 Launches spreadsheet application*
 - FN + F3 Launches calendar*
13. **Favorites zone**
 1. FN + F4 to F6 program your favorite application, folder, or web site with a long, simultaneous press of and the corresponding F4, F5, or F6 key (just like the presets of a car radio).
 - * This feature is only available when on the desktop.
14. **Internet zone**

- FN + F7 Launches Internet browser
- FN + F8 Launches instant message application*
- FN + F9 Launches e-mail application
- FN + F10 Launches Windows search

15. Convenience zone

- FN + F11 Battery status check
- FN + F12 Opens/closes CD-DVD tray*

Requires SetPoint™ Software.

Mouse features

1. Battery LED
2. Vertical and side-to-side scrolling (Side-to-side scrolling requires software installation.)
3. Back and forward buttons. Customize with other preferred functions, like application switch or full screen, through Logitech software.
4. On/Off slider
5. Battery-door release
6. Unifying receiver storage



1. Battery LED
2. Vertical and side-to-side scrolling (Side-to-side scrolling requires software installation.)
3. Back and forward buttons. Customize with other preferred functions like application switch or full screen, through Logitech software.
4. On/Off slider
5. Battery-door release
6. Unifying receiver storage



Battery management

Your keyboard has up to three years of battery life and your mouse has up to two.*

Battery sleep mode

Did you know that your keyboard and mouse go into sleep mode after you stop using them for a few minutes? This feature helps limit battery usage and eliminates the need to keep switching your devices on and off. Both your keyboard and mouse are up and running immediately once you begin using them again.

How to check the battery level for the keyboard

1. **Option 1:** Press FN + F11 to check keyboard battery level. If the battery status indicator glows green for 10 seconds, the batteries are good. If the indicator blinks red, the battery level has dropped to 10% and you have only a few days of battery power left.
2. **Option 2:** Launch the SetPoint Software, and click the Keyboard Battery tab to see the current keyboard battery level.

How to check the battery level for the mouse

- **Option 1:** Turn the mouse off then back on using the On/Off switch on the mouse bottom. If the LED on top of the mouse glows green for 10 seconds, the batteries are good. If the LED blinks red, the battery level has dropped to 10% and you have only a few days of battery power left.
- **Option 2:** Launch the SetPoint Software, and click the Mouse Battery tab to see the current mouse battery level.

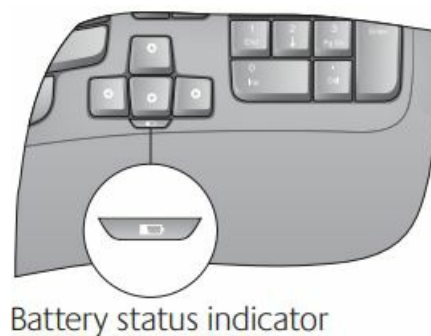

Battery status indicator



Mouse bottom

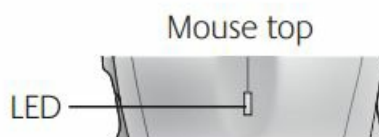

Mouse top

* Battery life varies with usage and computing conditions. Heavy usage usually results in shorter battery life.



Plug it. Forget it. Add to it.

You've got a Logitech® Unifying receiver. Now add a compatible wireless keyboard or mouse that uses the same receiver. It's easy. Just start the Logitech® Unifying software and follow the onscreen instructions. For more information and to download the software, visit www.logitech.com/unifying

Plug it. Forget it. Add to it.

You've got a Logitech® Unifying receiver. Now add a compatible wireless keyboard or mouse that uses the same receiver. It's easy. Just start the Logitech® Unifying software and follow the onscreen instructions. For more information and to download the software, visit www.logitech.com/unifying

Troubleshooting

Keyboard and mouse are not working

- **Check the USB** connection. Also, try changing USB ports.
- **Move closer?** Try moving the keyboard and mouse closer to the Unifying receiver, or plug the Unifying receiver into the receiver extender cable to bring it closer to the keyboard and mouse.
- Check battery installation. Also check the battery power of each device. (See Battery management for more information.)

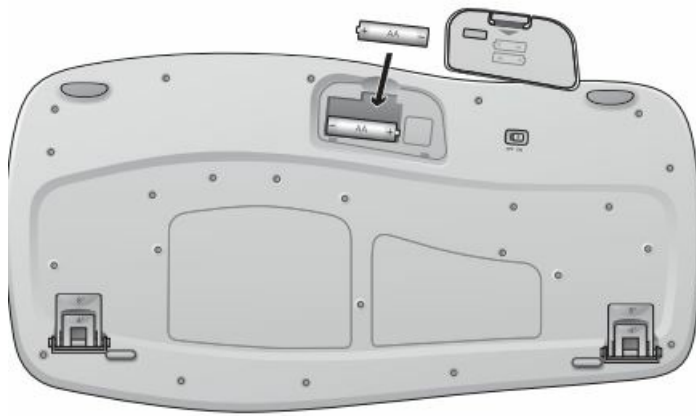

On the mouse bottom, slide the On/Off switch right to turn on the mouse. The Battery LED on the mouse top case should light green for 10 seconds. (See Battery management for more information.)

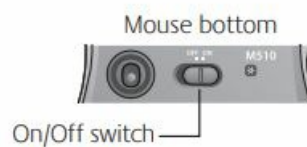

- **Are you experiencing slow or jerky cursor movement?** Try the mouse on a different surface (e.g., deep, dark surfaces may affect how the cursor moves on the computer screen).
- **Is the keyboard turned on?** Slide the keyboard Off/On switch to the On position, as shown in the image below. The keyboard Status icons should light up.

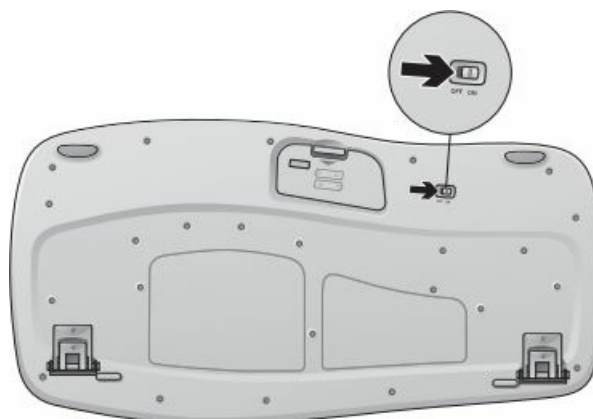

- **Re-establish the connection.** Use the Unifying software to reset the connection between the keyboard/mouse and Unifying receiver. Refer to the Unifying section in this guide for more information.
- Install Logitech SetPoint Software to verify your battery level and customize your hotkeys.

www.logitech.com/downloads

For additional help, refer to the Customer Support telephone numbers.

Also visit www.logitech.com/comfort for more information about using your product, and for ergonomics.

M/N:C-U0007

- **Rating:** 5V = 1 00mA
- **FCC ID:** JNZCU0007
- **IC:** 4418A-CU0007 MADE IN CHINA CNC:C-8941
- **CFT:** RCPLOCUI0-1356



M/N:C-U0008

- **Rating:** 5V = 100mA
- **FCC ID:** JNZCU0008
- **IC:** 4418A-CU0008
MADE IN CHINA
- **SU8TEL:** 2217
- **CNC:** C-9341
- **CFT:** RCPLOCUII-0321



www.logitech.com/support

Latin America

+1 800-578-9619

United States

+1 646-454-3200

Canada

+1 866-934-5644

www.logitech.com

© 2012 Logitech. All rights reserved. Logitech, the Logitech logo, and other Logitech marks are owned by Logitech

and may be registered. All other trademarks are the property of their respective owners. Logitech assumes no responsibility for any errors that may appear in this manual. Information contained herein is subject to change without notice.

620-004615.004

Documents / Resources

 <p>Getting started with Premiere of the Logitech® Wireless Wave Combo MK550</p> <p>unboxing</p>	<p>logitech MK550 Wireless Wave Ergonomic Keyboard and Mouse Combo [pdf] User Guide K350, M510, MK550, MK550 Wireless Wave Ergonomic Keyboard and Mouse Combo, Wireless Wave Ergonomic Keyboard and Mouse Combo, Wave Ergonomic Keyboard and Mouse Combo, Ergonomic Keyboard and Mouse Combo, Keyboard and Mouse Combo, Mouse Combo, Combo</p>
---	--

References

- [logi Logitech | Official Online Store](#)
- [logi Logi Options+ \(Plus\): Customization App for Logitech Devices](#)
- [logi Logitech Customer Support & Business Support](#)
- [User Manual](#)