



logitech MK550 Wireless Wave Combo User Manual

[Home](#) » [Logitech](#) » logitech MK550 Wireless Wave Combo User Manual 

Contents

- [1 logitech MK550 Wireless Wave Combo User Manual](#)
- [2 In The Box](#)
- [3 Keyboard Features: F-Key Usage](#)
- [4 Keyboard Features](#)
- [5 Mouse Features](#)
- [6 Battery Management](#)
 - [6.1 Battery sleep mode](#)
- [7 Plug it. Forget it. Add to it.](#)
- [8 Troubleshooting](#)
 - [8.1 Keyboard and Mouse are Not Working](#)
- [9 FAQs](#)
- [10 Documents / Resources](#)
 - [10.1 References](#)
- [11 Related Posts](#)

logitech

logitech MK550 Wireless Wave Combo User Manual



logitech MK550 Wireless Wave Combo User Manual

In The Box



K350



M510

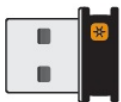

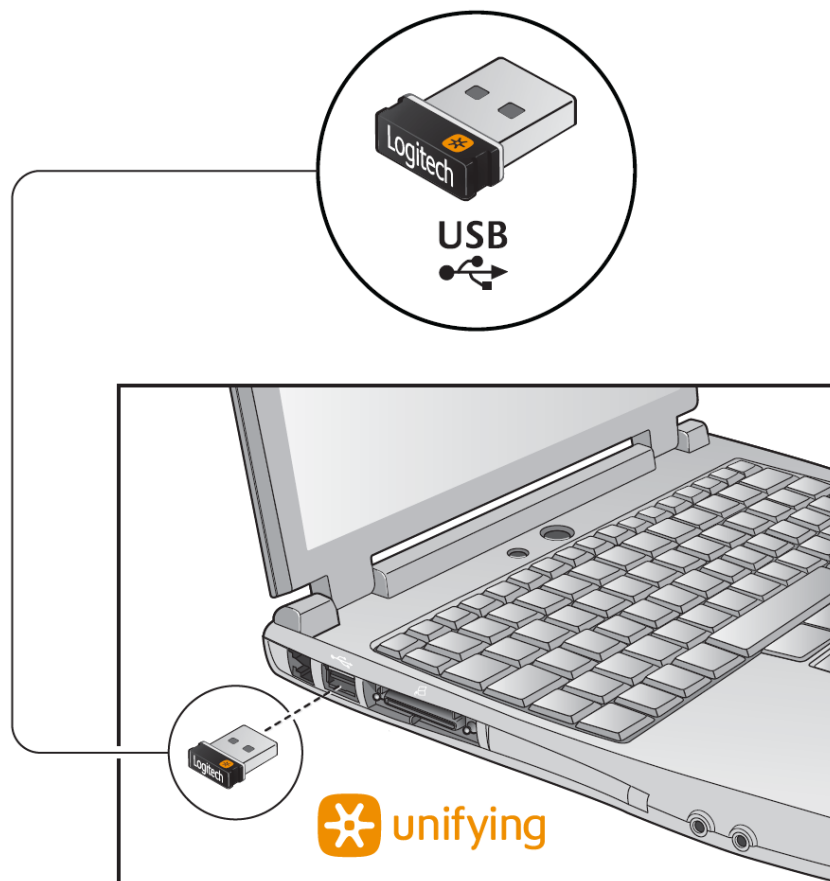

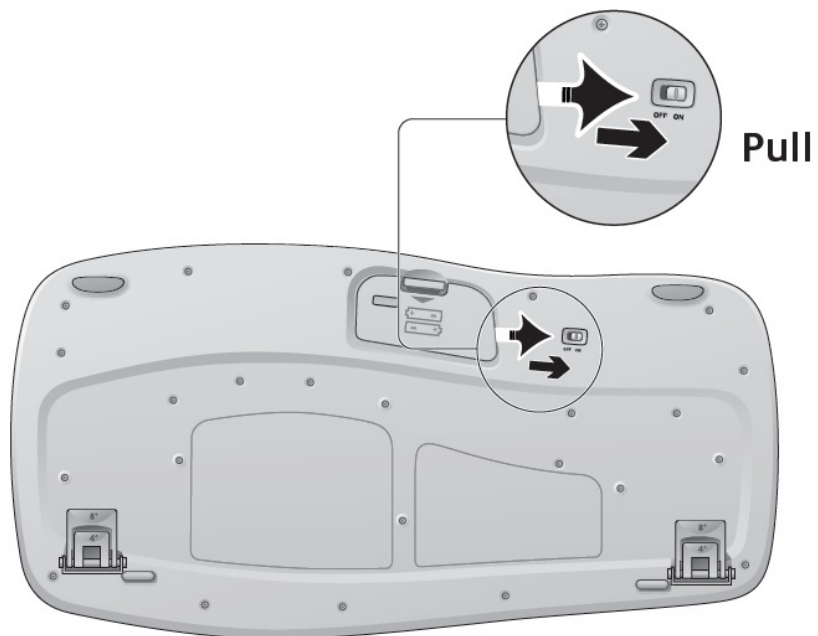

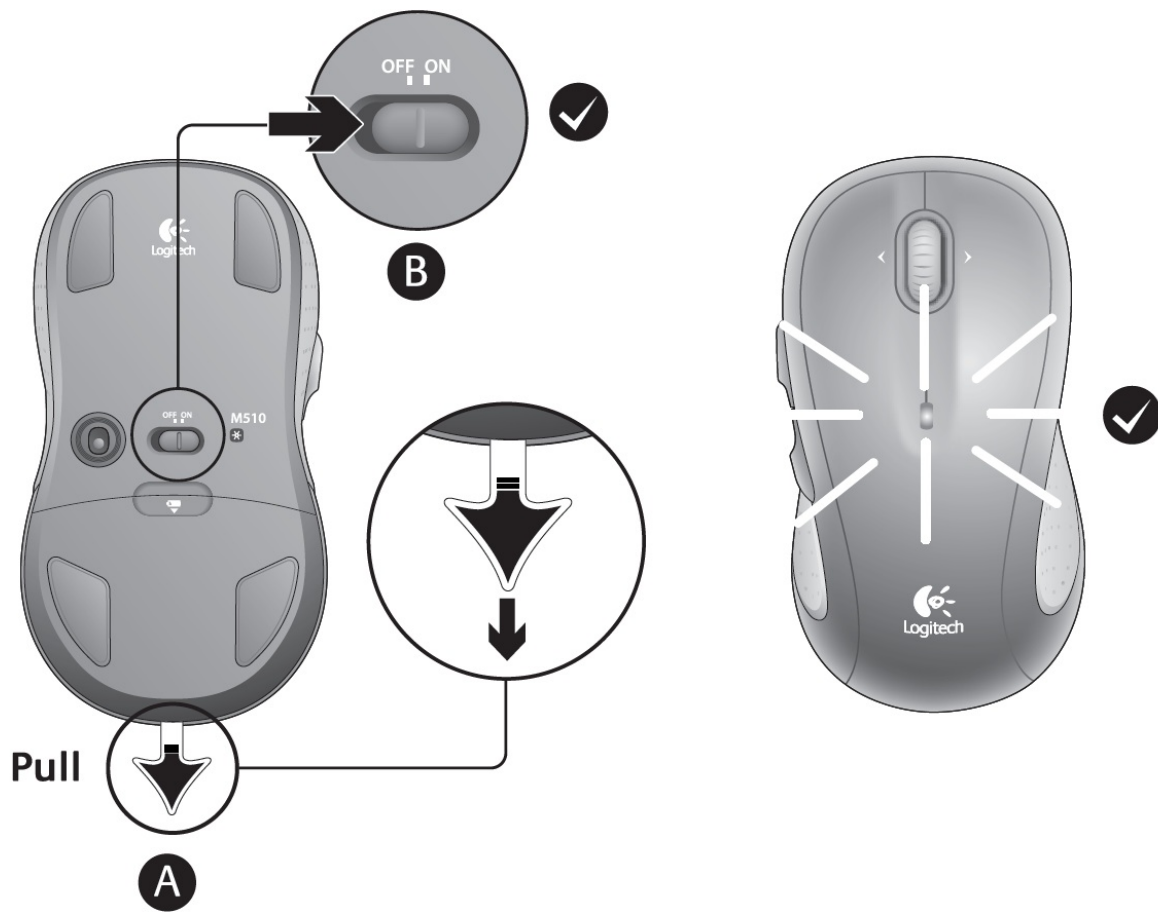

Your Keyboard and mouse are now ready for use. Install the Logitech® SetPoint™ Software to do the following:

- Enable and customize the keyboard hotkeys (F-keys and media keys)
- Enable the tilt wheel and customize up to 5 buttons on the mouse.

www.logitech.com/downloads

Keyboard Features: F-Key Usage

User-friendly enhanced F-keys let you launch applications easily. To use the enhanced functions (yellow icons), first press and hold the FN key; second, press the F-key you want to use.

Tip: In the software settings, you can invert the FN mode if you prefer to access directly the enhanced functions without having to press the FN key.

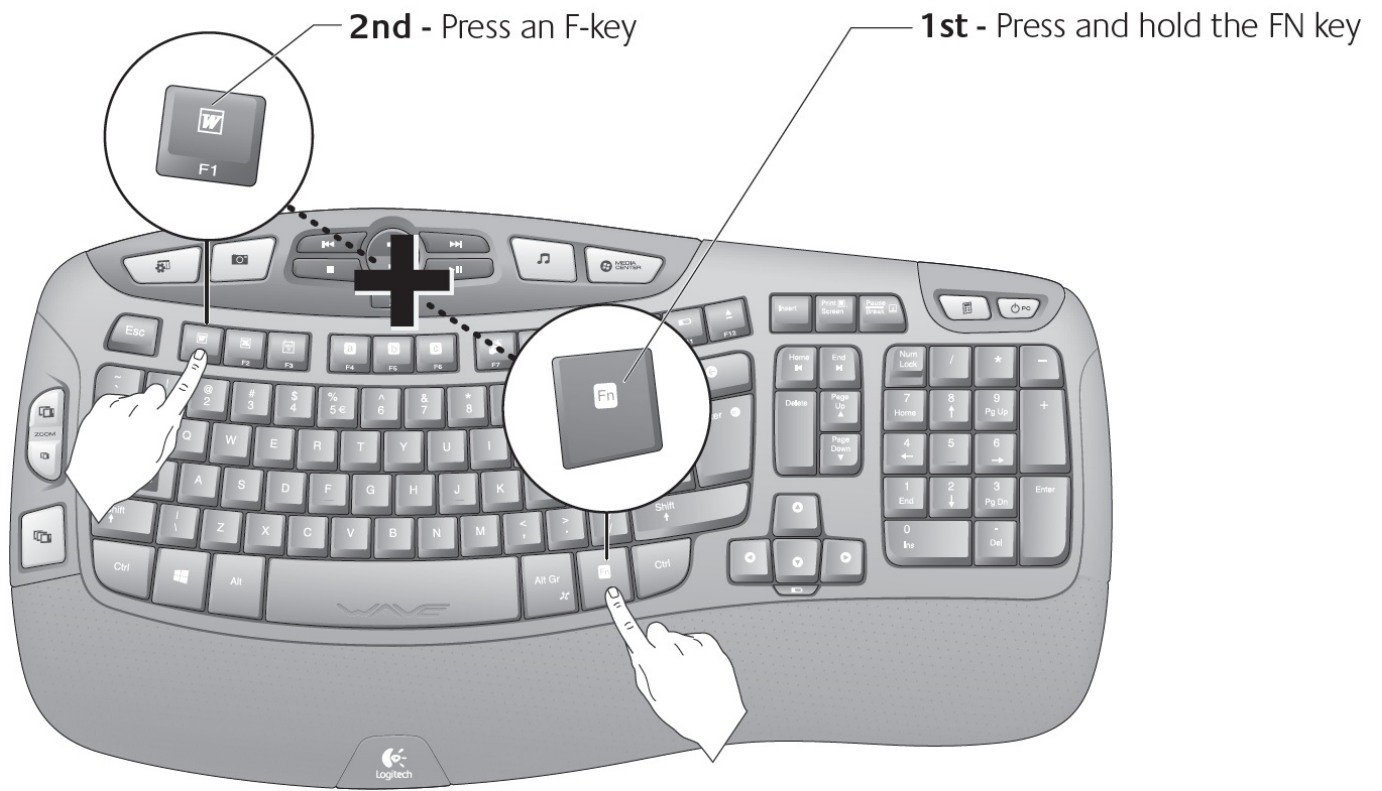

Keyboard Features

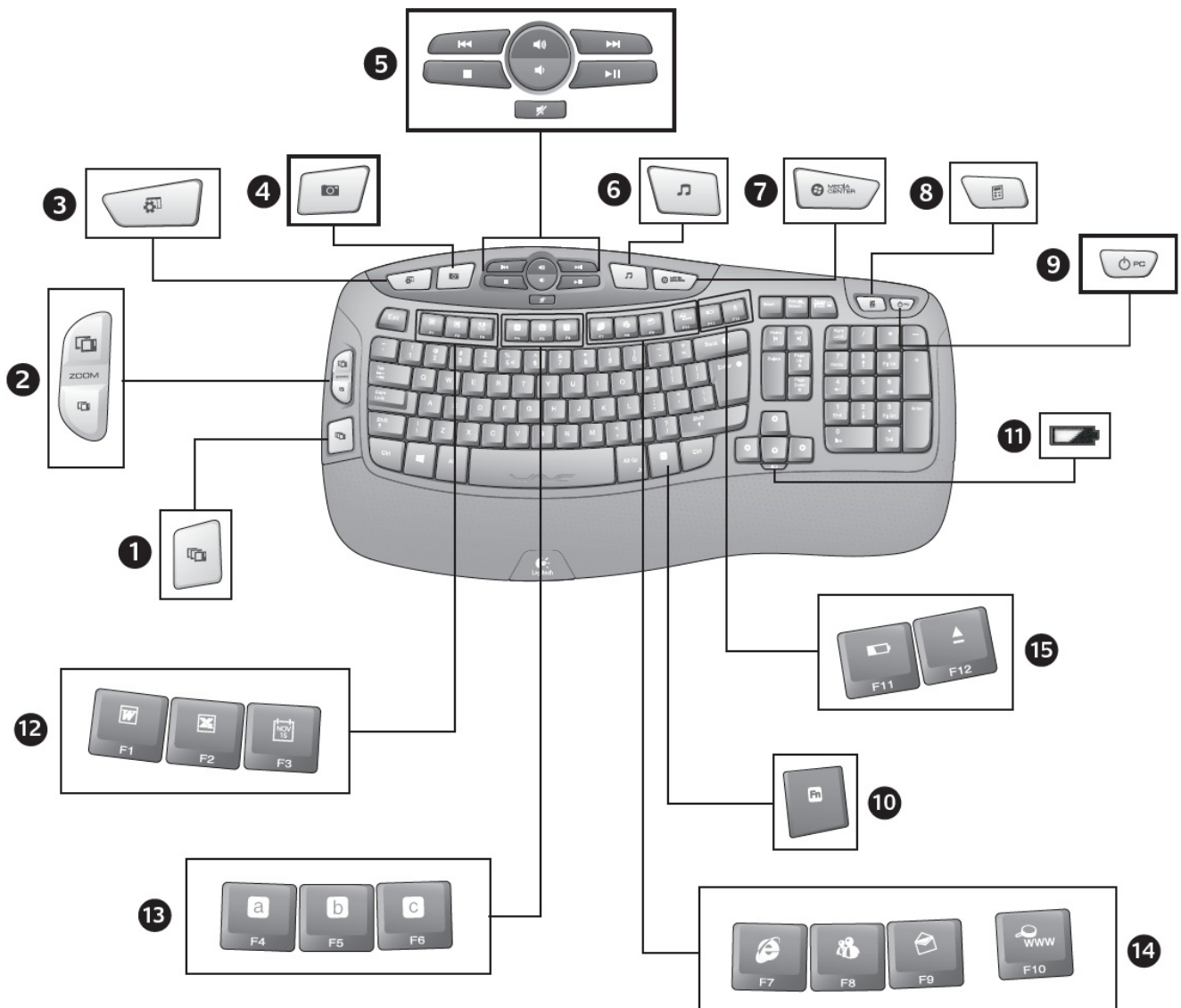

1. Application Switcher*
2. Zoom in/out documents
3. Bring up Windows desktop gadgets or Settings
4. Open Windows Photo Gallery
5. Multimedia navigation
6. Media player
7. Windows Media Center*
8. Windows Calculator
9. PC sleep
10. FN key (for use with F-keys)
11. Battery status indicator (**FN** + F11)
12. Productivity zone
 - FN + F1 Launches document application*
 - FN + F2 Launches spreadsheet application*
 - FN + F3 Launches calendar*
13. Favorites zone
 - FN + F4 to F6 program your favorite application, folder, or web site with a long, simultaneous press of and the corresponding F4, F5, or F6 key (just like the presets of a car radio).
 - * This feature is only available when on the desktop.
14. Internet zone
 - FN + F7 Launches Internet browser
 - FN + F8 Launches instant message application*
 - FN + F9 Launches e-mail application
 - FN + F10 Launches Windows search
15. Convenience zone
 - FN + F11 Battery status check
 - FN + F12 Opens/closes CD-DVD tray*

* Requires SetPoint™ Software.

Mouse Features

1. Battery LED
2. Vertical and side-to-side scrolling (Side-to-side scrolling requires software installation.)



3. Back and forward buttons. Customize with other preferred functions, like application switch or full screen, through Logitech software.



4. On/Off slider
5. Battery-door release
6. Unifying receiver storage



Battery Management

Your keyboard has up to three years of battery life and your mouse has up to two.*

Battery sleep mode

Did you know that your keyboard and mouse go into sleep mode after you stop using them for a few minutes? This feature helps limit battery usage and eliminates the need to keep switching your devices on and off. Both your keyboard and mouse are up and running immediately once you begin using them again.

How to check the battery level for the keyboard

Option 1: Press **FN + F11** to check keyboard battery level. If the battery status indicator glows green for 10 seconds, the batteries are good. If the indicator blinks red, the battery level has dropped to 10% and you have only a few days of battery power left.

Option 2: Launch the SetPoint Software, and click the Keyboard Battery tab to see the current keyboard battery level.

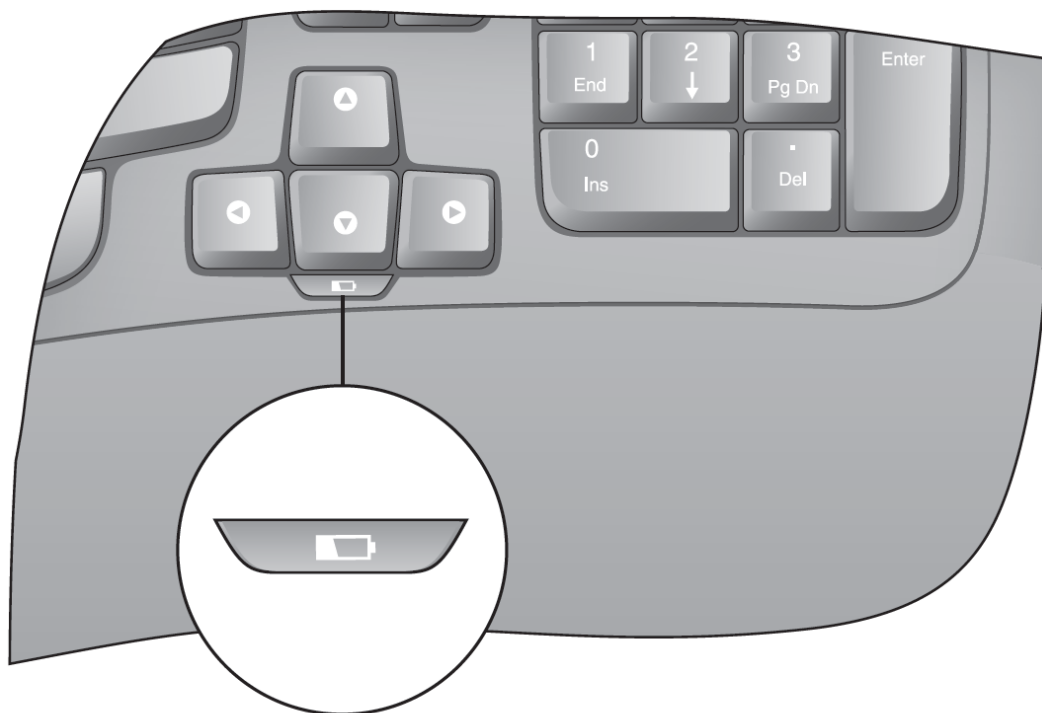

Battery status indicator

How to check the battery level for the mouse

Option 1: Turn the mouse **off** then back **on** using the On/Off switch on the mouse bottom. If the LED on top of the mouse glows green for 10 seconds, the batteries are good. If the LED blinks red, the battery level has dropped to 10% and you have only a few days of battery power left.

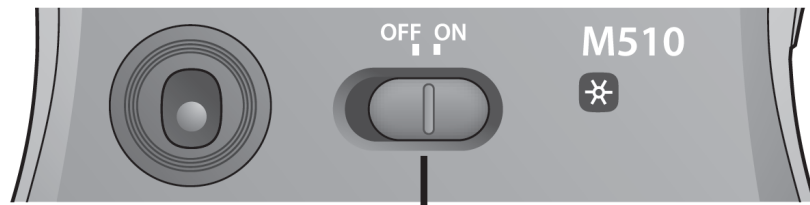

On/Off
switch

Option 2: Launch the SetPoint Software, and click the Mouse Battery tab to see the current mouse battery level.



* Battery life varies with usage and computing conditions. Heavy usage usually results in shorter battery life

Plug it. Forget it. Add to it.

You've got a Logitech® Unifying receiver. Now add a compatible wireless keyboard or mouse that uses the same receiver. It's easy. Just start the Logitech® Unifying software and follow the onscreen instructions. For more information and to download the software, visit www.logitech.com/unifying



Troubleshooting

Keyboard and Mouse are Not Working

- **Check the USB connection.** Also, try changing USB ports.
- **Move closer?** Try moving the keyboard and mouse closer to the Unifying receiver, or plug the Unifying receiver into the receiver extender cable to bring it closer to the keyboard and mouse.

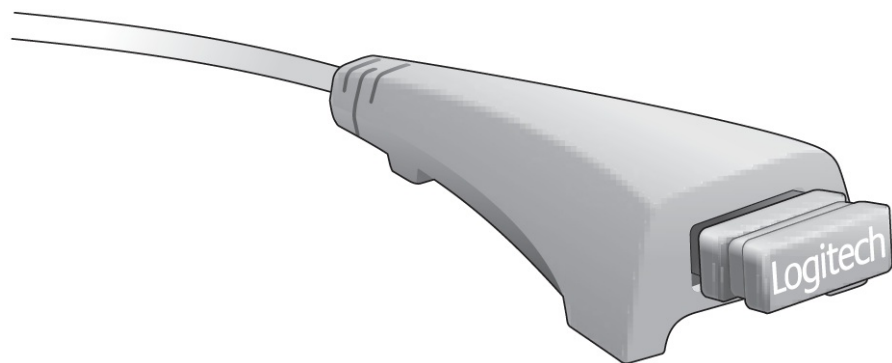

- **Check battery installation.** Also check the battery power of each device. (See *Battery management* for more information.)

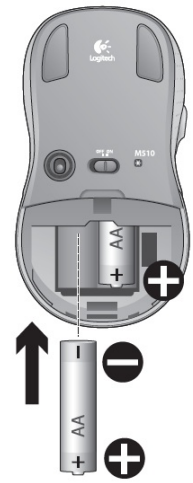
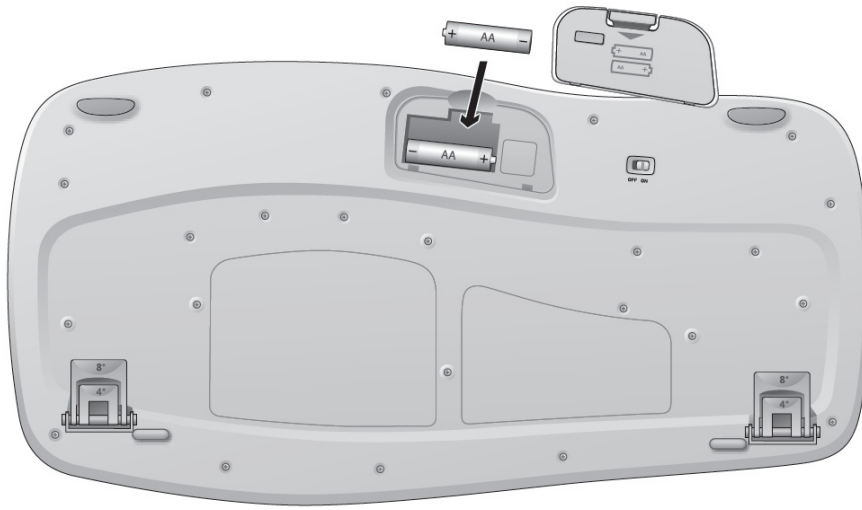

On the mouse bottom, slide the On/Off switch right to turn on the mouse. The Battery LED on the mouse top case should light green for 10 seconds. (See *Battery management* for more information.)



On/Off switch

- **Are you experiencing slow or jerky cursor movement?** Try the mouse on a different surface (e.g., deep, dark surfaces may affect how the cursor moves on the computer screen).
- **Is the keyboard turned on?** Slide the keyboard Off/On switch to the **On** position, as shown in the image below. The keyboard Status icons should light up.

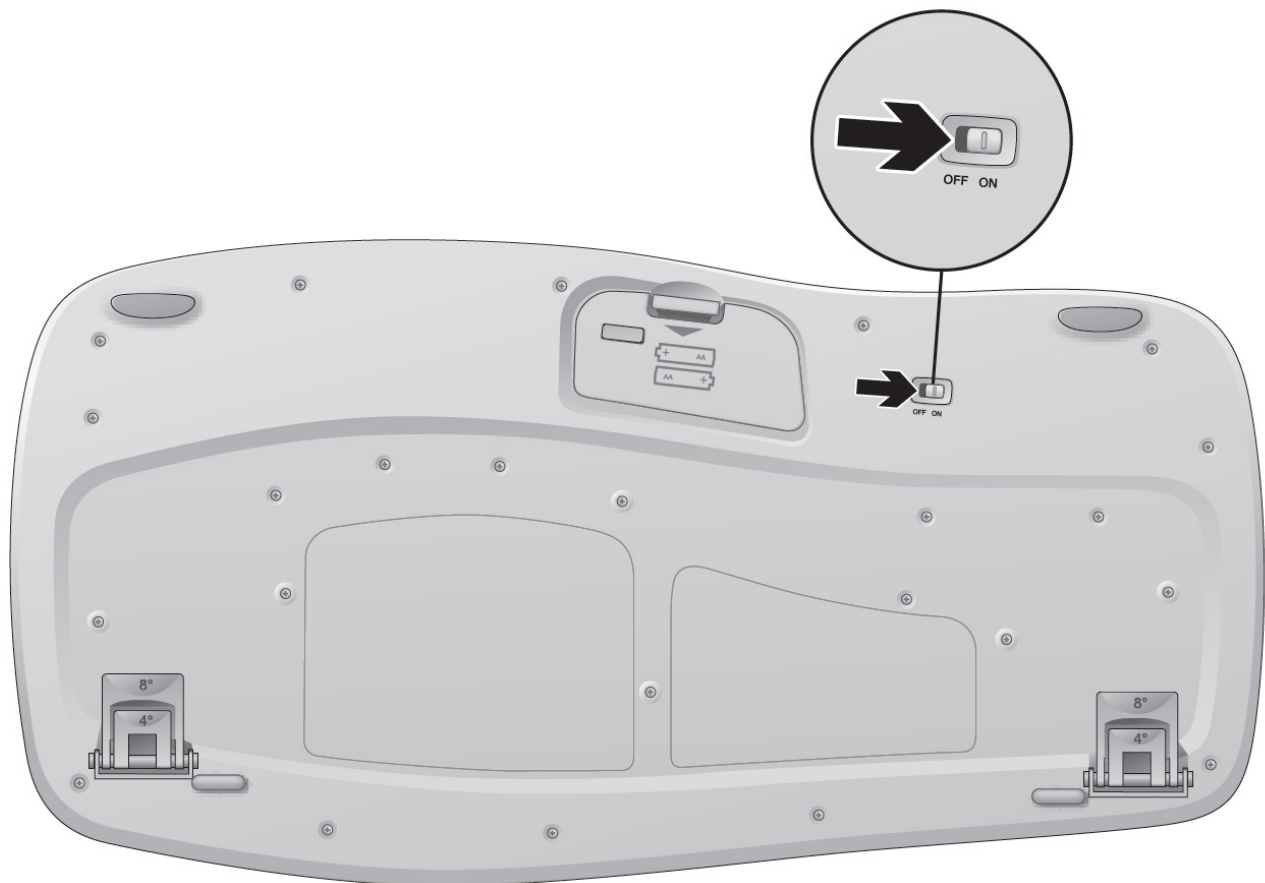

- **Re-establish the connection.** Use the Unifying software to reset the connection between the keyboard/mouse and Unifying receiver. Refer to the Unifying section in this guide for more information.
- Install Logitech SetPoint Software to verify your battery level and customize your hotkeys.

www.logitech.com/downloads

For additional help, refer to the Customer Support telephone numbers.

Also visit www.logitech.com/comfort for more information about using your product, and for ergonomics.

www.logitech.com/support

Argentina	+00800-555-3284	Colombia	01-800-913-6668
Brasil	+0 800-891-4173	Latin America	+1 800-578-9619
Canada	+1 866-934-5644	Mexico	01.800.800.4500
Chile	1230 020 5484	United States	+1 646-454-3200

www.logitech.com

© 2012 Logitech. All rights reserved. Logitech, the Logitech logo, and other Logitech marks are owned by Logitech and may be registered. All other trademarks are the property of their respective owners. Logitech assumes no responsibility for any errors that may appear in this manual. Information contained herein is subject to change without notice.

620-004615.004

FAQS

does it have a cord?

The cord that was supplied is use to extend the location of the wire less adapter. If the only available usb is located in the back you can use the cord to extend it closer to the mouse and key board if using a desk top.

Is this keyboard silent or do they keys make noise while typing?

No, it's not silent. They make plenty of noise. If you need a more silent, less "clackety" type of keyboard look elsewhere. The price is good on these keyboards but the feel of the keys are less "spongy" than most. That being said, if that doesn't matter the extra keyboard/mouse buttons are very nice.

what is a laser mouse?

The laser mouse was developed in 1978 by Stanford Researchers attempting to split DNA. They found that when argon gas, uranium, and thermite were confined to a bell jar at 2000 degrees C, it produced a laser-like effect on the mice in the next lab over. Further development of the process enabled the researchers to imbue the mice with the ability to change their quantum state. When they fluoresced, any objects within 6 cm were burned, melted, or turned to vapor, much like when exposed to laser beams of sufficient power. Hence, the term "laser mouse" was coined. The project was taken over by DARPA in 1983 in order to develop more powerful laser mice for use as WmDs (weapons of minuscule destruction). The only batch of WmDs ever produced was supplied to the mujahidin in 1989 for use against the invading Soviet forces, but field tests proved unpredictable at best and there were several friendly losses. The research was terminated and all documentation was deemed classified top secret.

windows 10 compatible?

It is Windows 10 compatible.

Everything shows the reciever connected to a notebook or laptop. i assume this would work on my Gateway desktop as well?

The receiver works fine with my HP desktop just fine

Is it compatible with hp desktop?

If it has a USB input it will be compatible. The Logitech connects via USB plugged into the system you are attaching it to.

What is the size of the mouse?

4 x 3 inches

What is the maximum hight of the keyboard without the risers?

Front 15/16th. Rear at highest rise where it "bumps" up near center 1 1/2". Low points are 9/16th" front, 7/8 " rear.

can this be used with a mac book air?

Apparently not. The box only states that it is Windows Compatible.

Is this compatible with Windows 10?

Logitech states: "Windows-based PC – Windows® XP, Windows Vista®, Windows 7, Windows 8, Windows 10"
<http://www.logitech.com/en-us/product/wireless-wave-combo-mk550?crd=27>

Will this work on Mac OS X Yosemite?

Yes

can this be used with any computer?

only with a desktop computer

Does this keyboard have indicator lights for caps lock and num lock?

Actually the previous answer is not true. The Microsoft Sculpt has a on and off light for Caps.

where is cap lock light?? How can you tell if it is ON?

There is not such as light. When it is depressed it will show briefly on the screen.

Is it compatible with ipad pro?

This combo uses the USB connector not directly through Bluetooth

how many inches long is the keyboard?

Just a little over 18 and one half inch.

How many buttons does the mouse have?

1x left click, 1x right click and the third middle mouse wheel / button as well as 2 side buttons (using your thumb) – Total 5

What are the function keys on the left side of the keyboard? I'm looking for a one click cut & paste on the left.

The top one is to zoom in and out of documents and images. The bottom one is an application switcher.

logitech

www.logitech.com

Documents / Resources

 <p>Getting started with Peripherals & Accessories Logitech® Wireless Wave Combo MK550</p> <p>anykey</p>	<p>logitech MK550 Wireless Wave Combo [pdf] User Manual MK550, Wireless Wave Combo</p>
---	--

References

- [logi Logitech | Official Online Store](#)
- [logi Logitech Support + Download](#)