



logitech MK270 Wireless Combo User Guide

[Home](#) » [Logitech](#) » logitech MK270 Wireless Combo User Guide 



WIRELESS COMBO MK270 Setup Guide

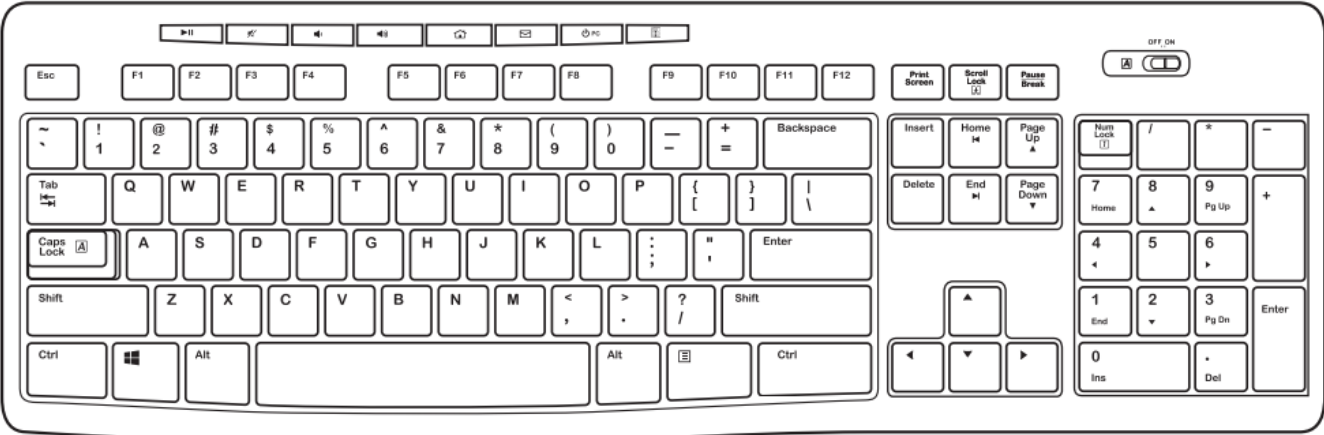

K270

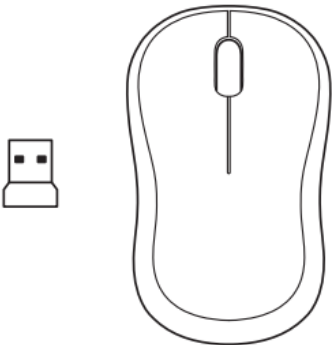

M185

Contents

- [1 KNOW YOUR PRODUCT](#)
- [2 KEYBOARD FEATURES](#)
- [3 WHAT'S IN THE BOX](#)
- [4 CONNECTING THE KEYBOARD AND MOUSE](#)
- [5 DIMENSION](#)
- [6 Documents / Resources](#)
 - [6.1 References](#)
- [7 Related Posts](#)





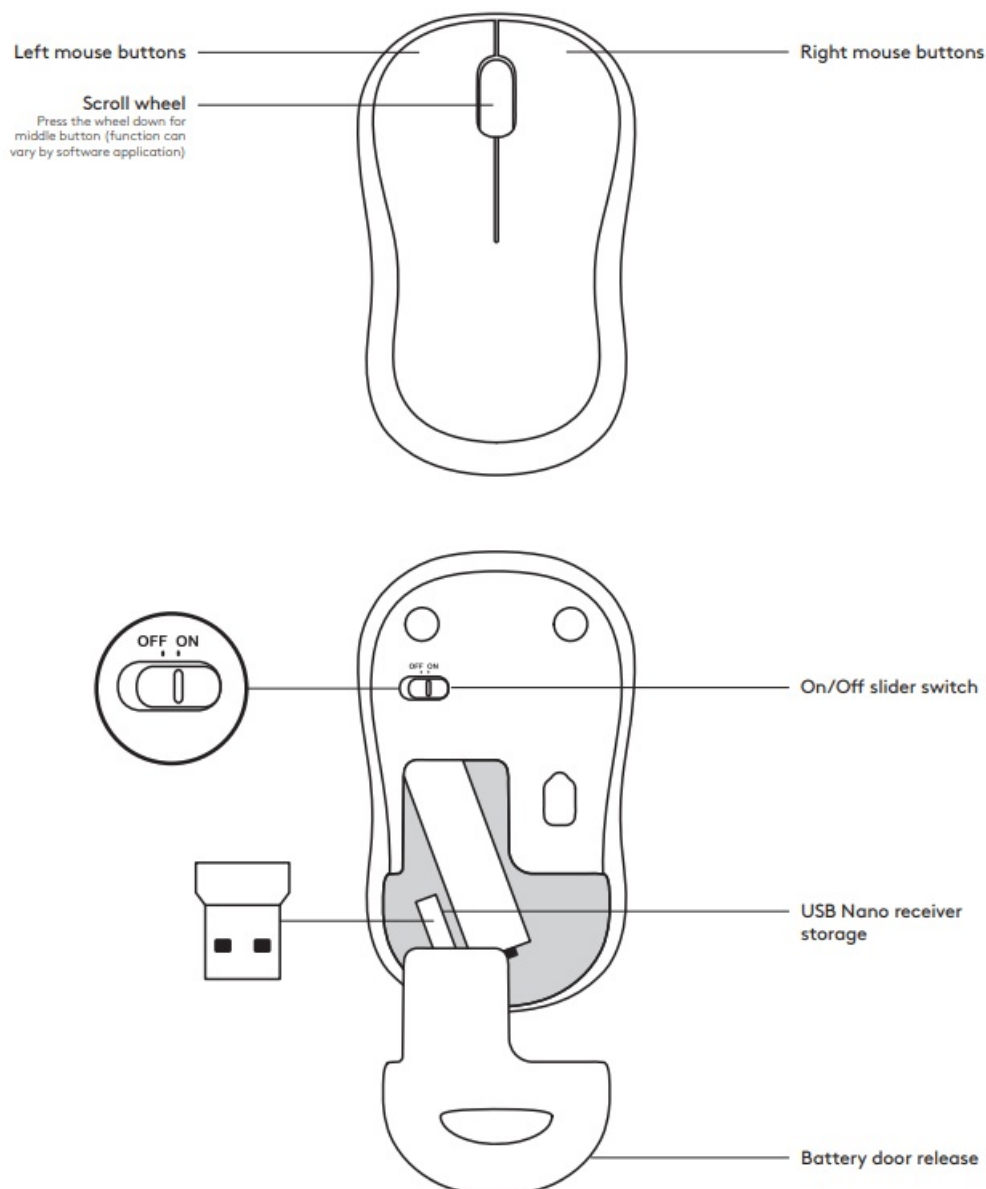



KNOW YOUR PRODUCT

MOUSE FEATURES



KEYBOARD FEATURES

Hot keys

	Play / Pause		Mute volume
	Decrease volume		Increase volume
	Navigate to Internet home		Launch email application
	Place PC in standby mode		Launch calculator

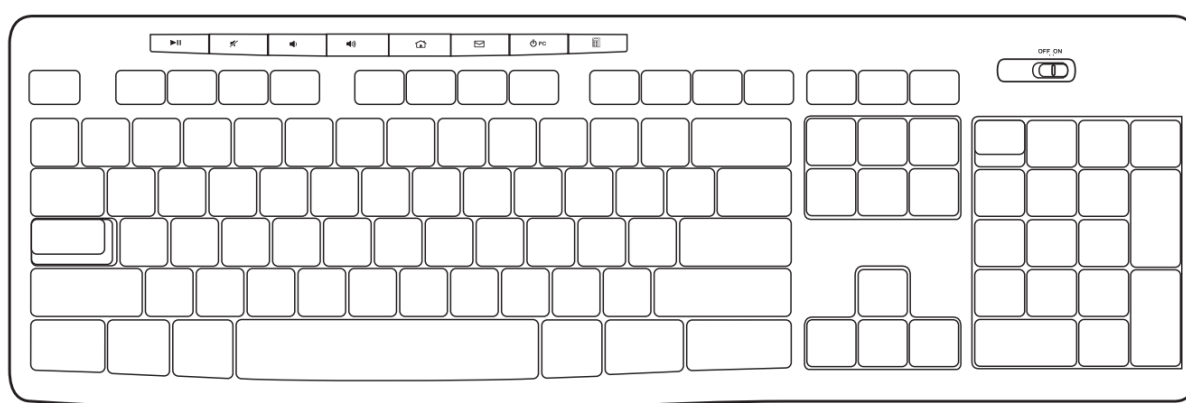
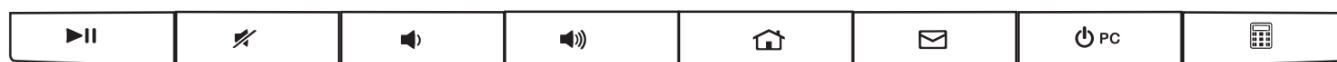

WHAT'S IN THE BOX

1. Logitech K270 Keyboard
2. Logitech M185 Mouse
3. AAA Battery x 2
4. AA Battery x 1
5. USB Nano receiver
6. User documentation



CONNECTING THE KEYBOARD AND MOUSE

www.logitech.com/support/mk270

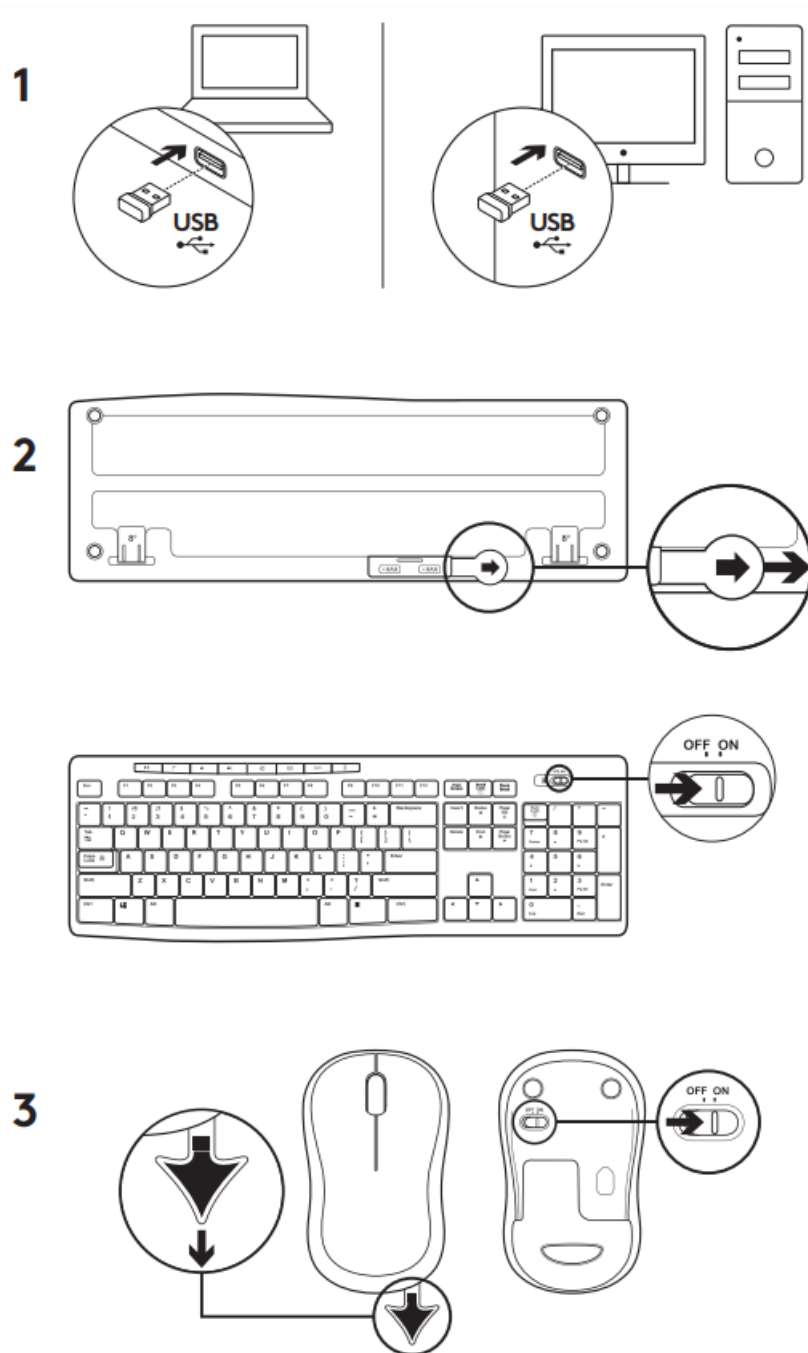

DIMENSION

Keyboard:

Height x Width x Depth: 22 75mm x 441 53mm x 149mm Keyboard Weight(With Battery): 495g Keyboard Weight(Without Battery): 480g

Mouse:

Height x Width x Depth: 38 6mm x 59 8mm x 99 5mm Mouse Weight(With Battery): 73 4g Mouse Weight(Without Battery): 50 4g

Dongle:

Height x Width x Depth: 6mm x 14mm x 19mm Weight: 2g

SYSTEM REQUIREMENTS

Windows ® 10 or later, Windows ® 8, Windows ® 7, Windows Vista ® , indows

® XP Chrome OS™ USB port Internet connection (for optional software download)



Documents / Resources

 A small image of the Logitech MK270 Wireless Combo, showing a white keyboard and a white mouse. The text "WIRELESS COMBO MK270" is visible at the top of the keyboard image, and the Logitech logo is at the bottom.	<p>logitech MK270 Wireless Combo [pdf] User Guide</p> <p>MK270 Wireless Combo, MK270, MK270 Combo, Wireless Combo, M185, K270, M185 Mouse, K270 Keyboard</p>
--	--

References

- [logi Logitech Support + Download](#)

Manuals+.