



# logitech M720 Triathlon Multi Device Wireless Mouse User Guide

[Home](#) » [Logitech](#) » logitech M720 Triathlon Multi Device Wireless Mouse User Guide 

# Logitech®

M720 Triathlon Mouse  
M720  
Setup Guide



## **Contents**

**1 PRODUCT FEATURES**

**2 GET STARTED**

**3 CONNECT WITH**

**4 LOGITECH OPTIONS**

**5 Documents /  
Resources**

**5.1 References**

**6 Related Posts**

## **PRODUCT FEATURES**

1. Easy-switch
2. Forward button
3. Back button
4. Toggle & connect button
5. Hyper-fast scroll-wheel
6. Battery LED
7. Thumb button
8. Dual Connectivity
9. Battery & Receiver storage



## GET STARTED

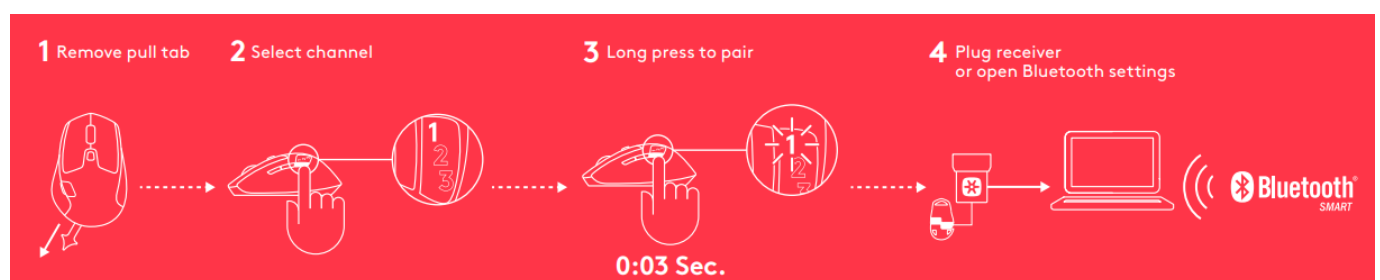

<a href="http://www.logitech.com/m720">www.logitech.com/m720</a>	<a href="http://www.logitech.com/downloads">www.logitech.com/downloads</a> Logitech® Options

## CONNECT WITH

**Requirements:**

USB port  
Unifying Software  
Windows 7, 8, 10 or later  
Mac OS X 10.10 or later  
Chrome OS

**How to connect with Unifying:**

1. Download Unifying Software: <http://support.logitech.com/software/unifying>
2. Make sure your M720 is turned on and a Unifying receiver is plugged in
3. Press and hold the toggle button below the display for 3 seconds (the LED on selected channel will start to blink fast)
4. Open the Unifying software and follow the on-screen instructions Re-pair in Unifying!

**Note!** You need Unifying Software to pair with a second receiver or to pair the mouse to another channel on the same receiver

All three Easy-Switch channels can be paired in either Bluetooth Smart or Unifying One Unifying receiver included in the box

**CONNECT WITH****Requirements:**

Your device has to support Bluetooth Smart

- Windows 8 or later
- Mac OS X 10.10 or later
- Android 5.0 or later

## How to pair a Bluetooth device:

1. Make sure your M720 is turned on
2. Press and hold the toggle button below the display for 3 seconds (the LED on selected channel will start to blink fast)
3. Open Bluetooth settings or Bluetooth device manager on your device and pair with “M720 Triathlon Mouse”



## LOGITECH OPTIONS

Unlock the full potential of your M720 by installing Logitech Options software. In addition to optimizing the mouse for your operating system, the software lets you customize buttons and actions to fit your needs. Logitech Options software also enables gestures for managing media, panning, zoom, and rotation, plus custom tasks.

Mac | Windows



[www.logitech.com/downloads](http://www.logitech.com/downloads)

© 2016 Logitech. All rights reserved. Logitech, Logi and other Logitech marks are owned by Logitech and may be registered. The Bluetooth® word mark and logos are registered trademarks owned by Bluetooth SIG, Inc. All other trademarks are the property of their respective owners.  
WEB-621-000744 003

## Documents / Resources



[logitech M720 Triathlon Multi Device Wireless Mouse](#) [pdf] User Guide  
M720 Triathlon Multi Device Wireless Mouse, M720, Triathlon Multi Device Wireless Mouse, Multi Device Wireless Mouse, Device Wireless Mouse, Wireless Mouse, Mouse

## References

-  [Home - Identity Digital](#)
-  [Logitech M720 Triathlon Multi-Computer Wireless Mouse](#)

Manuals+.