



**M280 2.4
GHz
Wireless
Mouse**



logitech M280 2.4 GHz Wireless Mouse User Guide

[Home](#) » [Logitech](#) » logitech M280 2.4 GHz Wireless Mouse User Guide 

Contents

- [1 logitech M280 2.4 GHz Wireless Mouse](#)
- [2 What's in the box](#)
- [3 Set-up](#)
- [4 Mouse features](#)
- [5 Troubleshooting](#)
- [6 FAQ](#)
- [7 Documents / Resources](#)
 - [7.1 References](#)



logitech M280 2.4 GHz Wireless Mouse



What's in the box

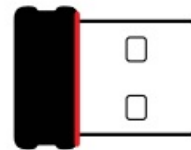
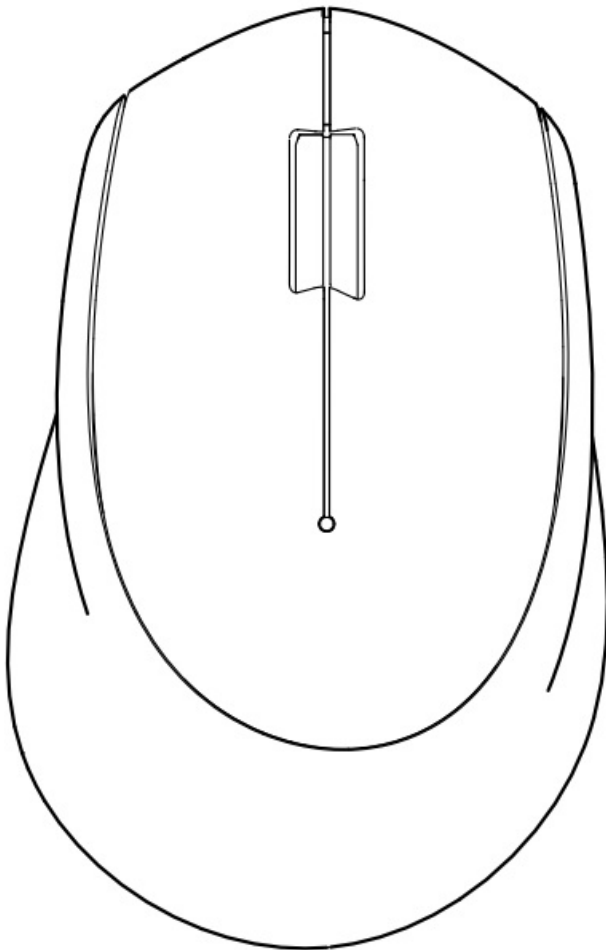

Set-up

1

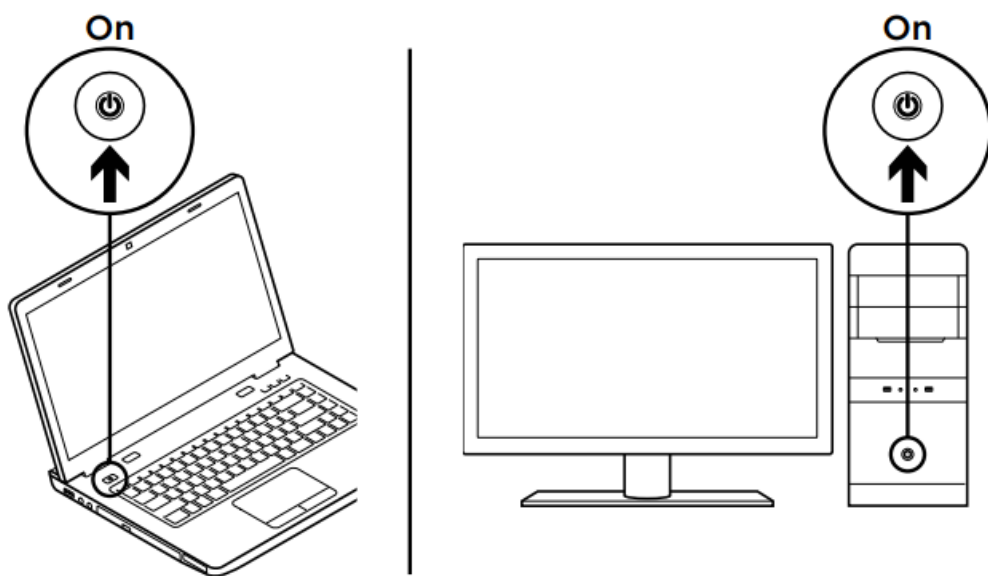

2

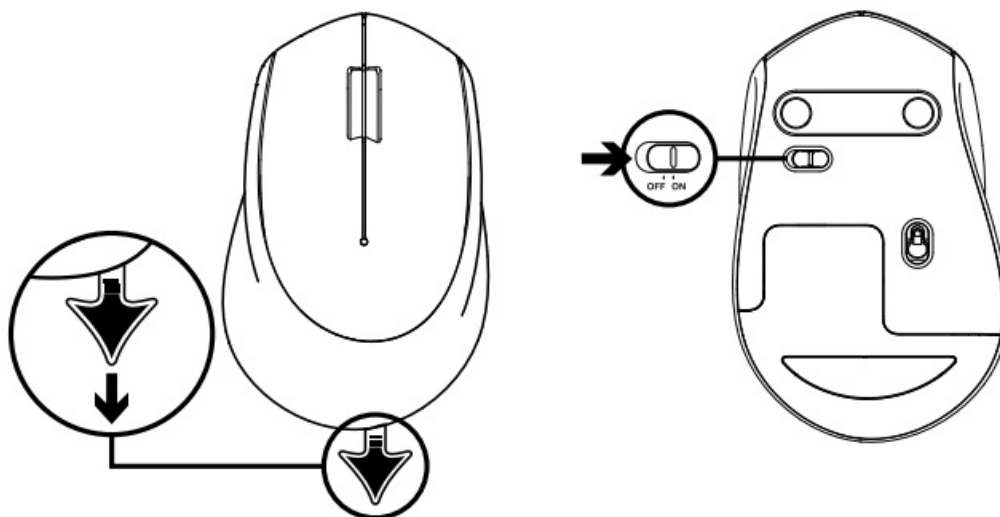

3

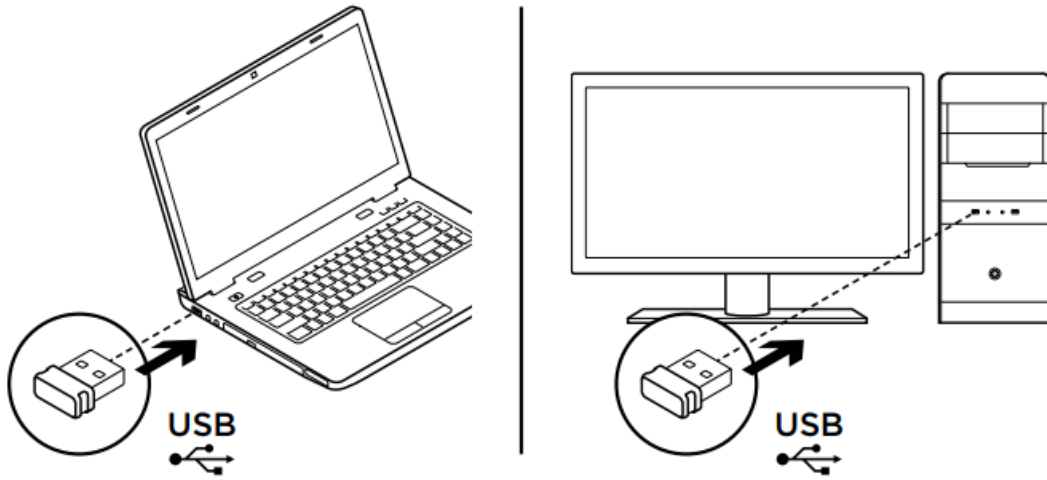

Mouse features

1. Left and right buttons
2. Scroll wheel

Press the wheel down for middle click. Function can vary by software application:

- In most Internet browsers, the middle click will close browser tabs by clicking anywhere on the tab, without the need of clicking the X.
- In most Internet browser, the middle click on a link will open the link in a new tab.
- In most Internet browsers, when you middle-click a folder located in your bookmarks/favorites bar, each website in the folder will open in its own tab.
- In many applications, if you click and hold the middle button, you will then be able to scroll in any direction by dragging the mouse.

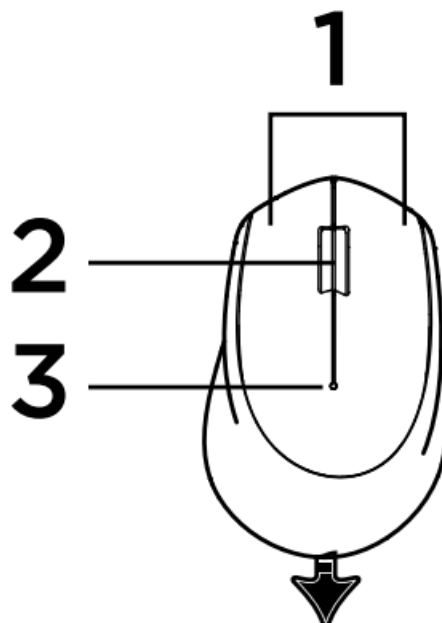

3. Battery LED

Flashes red when battery power is low. If the battery is not low, the LED indicator will turn green for 10 seconds when the mouse is switched on or after deep-sleep mode recovery.

On/Off slider switch

The mouse will go into sleep mode if no movement is detected. We recommend switching the mouse off to avoid accidental clicking when carrying it around and to further save battery life.

4. Battery door release

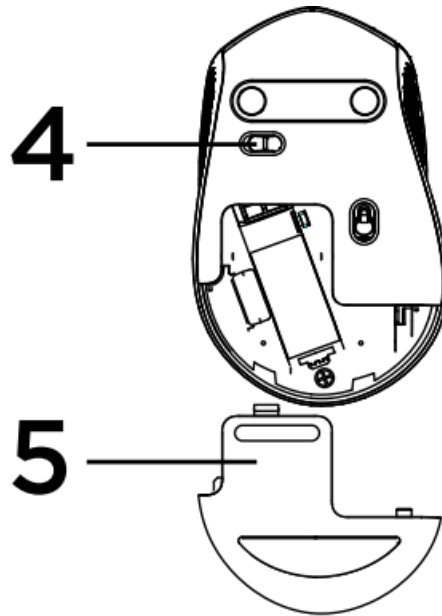

Sleep mode

The mouse will go into sleep mode after 10 seconds of inactivity and can be woken up by clicking or moving the mouse. The mouse will go into deep sleep mode after 5 minutes of inactivity and can be woken up by clicking.



The receiver with this mouse does not integrate with the Logitech® Unifying technology. However, the mouse itself is Unifying-ready and can be used with any Logitech® Unifying receivers you may already have. Logitech® Unifying technology connects up to six compatible Logitech mice and keyboards to the same receiver, using only one USB port for multiple devices. To learn more, visit www.logitech.com/unifying.

Troubleshooting

Mouse is not working

- Is the mouse powered on?
- Is the receiver securely plugged into a USB port? Try changing USB ports.
- If the receiver is plugged into a USB hub, try plugging it directly into a USB port on your computer.
- Check the orientation of the battery inside the mouse.
- Try a different surface. Remove metallic objects between the mouse and the receiver.
- Try moving the receiver to a USB port closer to the mouse.

www.logitech.com/support/M280

responsibility for any errors that may appear in this manual. Information contained herein is subject to change without notice.

FAQ

- **Q: How do I know when the battery is low?**
 - **A:** The battery LED indicator will flash red when the battery power is low.
- **Q: How can I wake up the mouse from sleep mode?**
 - **A:** Simply click or move the mouse to wake it up from sleep mode.
- **Q: Can I replace the battery myself?**
 - **A:** Yes, you can easily replace the battery using the battery door release feature.

Documents / Resources

 <p>Logitech Getting started with Premium utilization Logitech® Wireless Mouse M280</p>	<p>logitech M280 2.4 GHz Wireless Mouse [pdf] User Guide</p> <p>M280 2.4 GHz Wireless Mouse, M280, 2.4 GHz Wireless Mouse, Wireless Mouse, Mouse</p>
--	--

References

- [🎀 One moment, please...](#)
- [User Manual](#)

[Manuals+.](#) [Privacy Policy](#)

This website is an independent publication and is neither affiliated with nor endorsed by any of the trademark owners. The "Bluetooth®" word mark and logos are registered trademarks owned by Bluetooth SIG, Inc. The "Wi-Fi®" word mark and logos are registered trademarks owned by the Wi-Fi Alliance. Any use of these marks on this website does not imply any affiliation with or endorsement.