



logitech M240 Silent Bluetooth Mouse User Guide

[Home](#) » [Logitech](#) » logitech M240 Silent Bluetooth Mouse User Guide 

logitech®

M240 FOR BUSINESS
Setup Guide



Contents

1 STEP 1: WHAT'S IN THE BOX

2 STEP 2A: CONNECTING THE MOUSE VIA Bluetooth

®

3 STEP 2B: CONNECTING THE MOUSE VIA LOGI BOLT

4 STEP 3: CUSTOMIZE YOUR MOUSE WITH OPTIONS+

5 REPLACING THE BATTERY

6 GET LOGI TUNE FOR ADDITIONAL FEATURES

7 DIMENSIONS

8 Documents / Resources

8.1 References

STEP 1: WHAT'S IN THE BOX

1. Mouse with included 1 AA battery and Logi Bolt receiver
2. User documentation

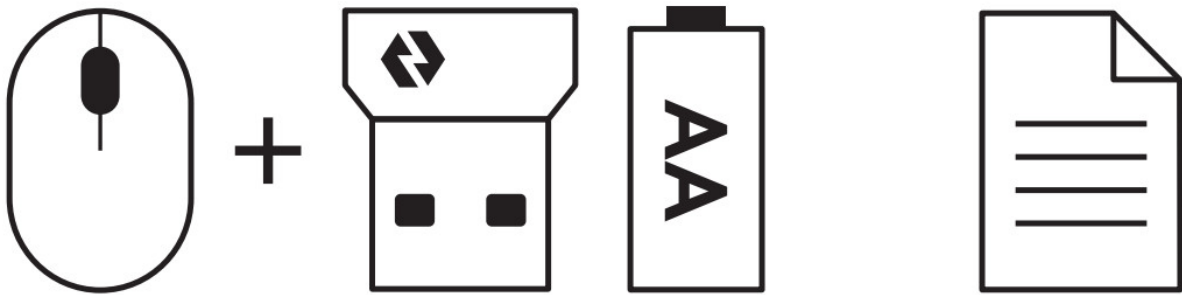

STEP 2A: CONNECTING THE MOUSE VIA Bluetooth ®

1. Remove the pull tab from the mouse
It will automatically turn on

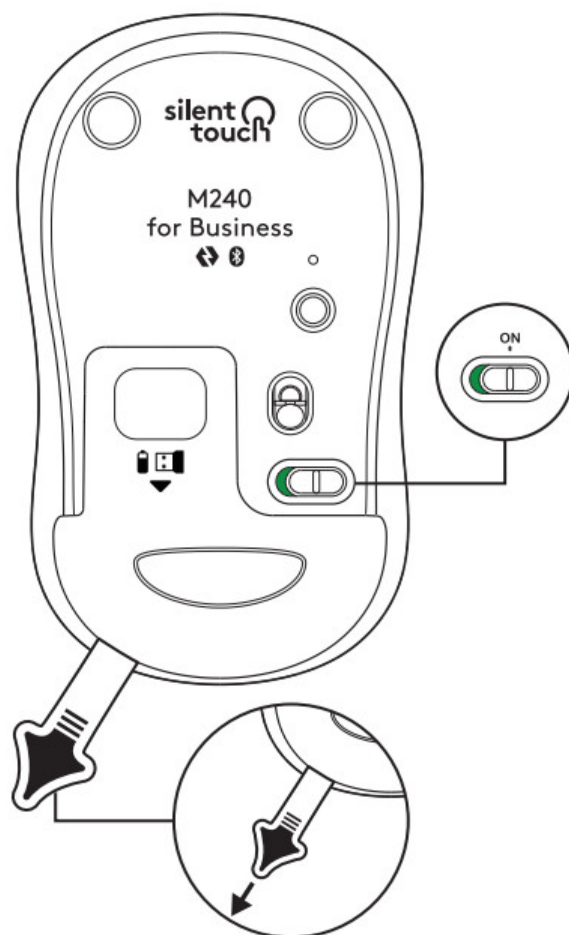

2. Long press the pairing button to start pairin

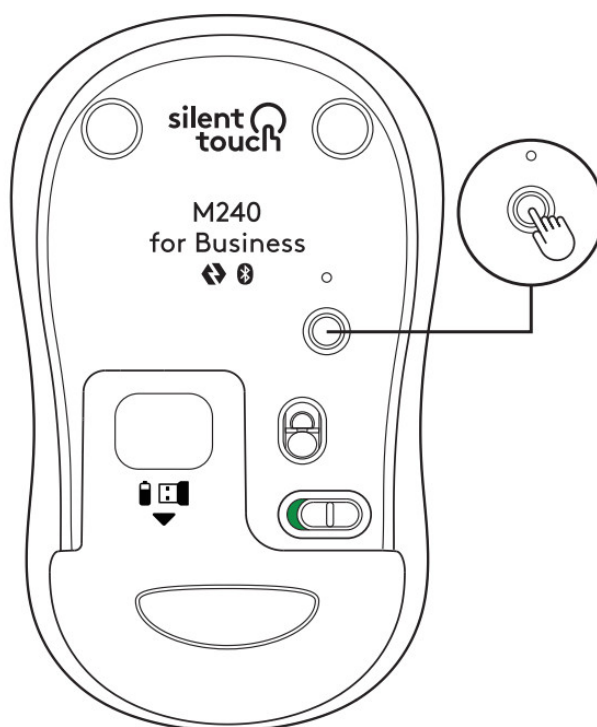

3. In your computer's Bluetooth® settings, select "LOGI M240 B"

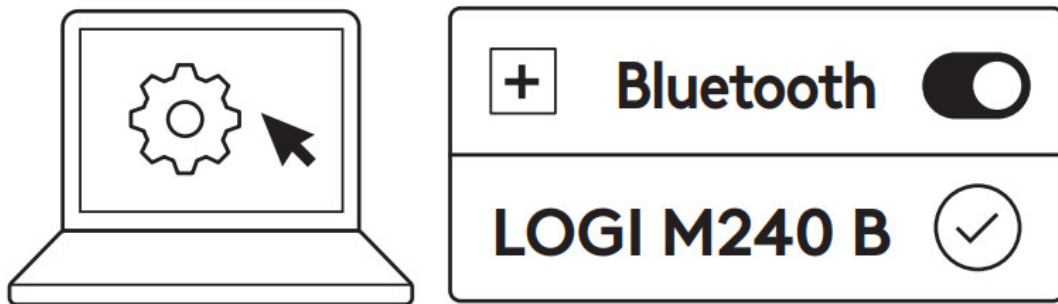

STEP 2B: CONNECTING THE MOUSE VIA LOGI BOLT

1. Remove the Logi Bolt receiver from the battery and receiver compartment, but don't remove the pull tab yet.

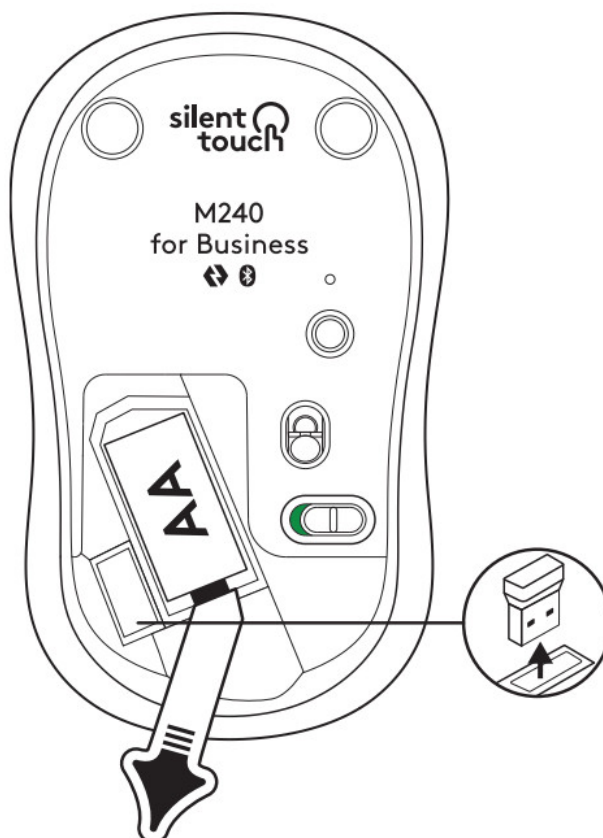

2. Insert the receiver into any available USB-A port on your desktop, laptop or docking station

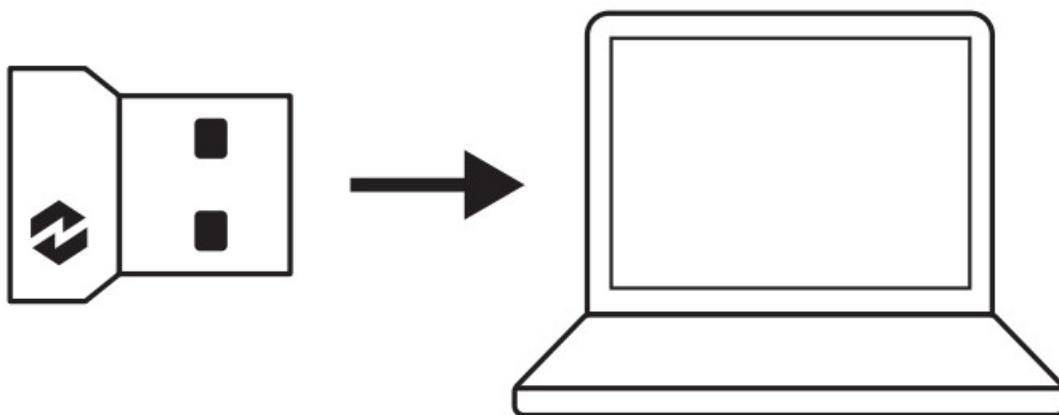

3. Now you can remove the pull tab from the mouse. It will automatically turn on and your mouse will be ready to use.

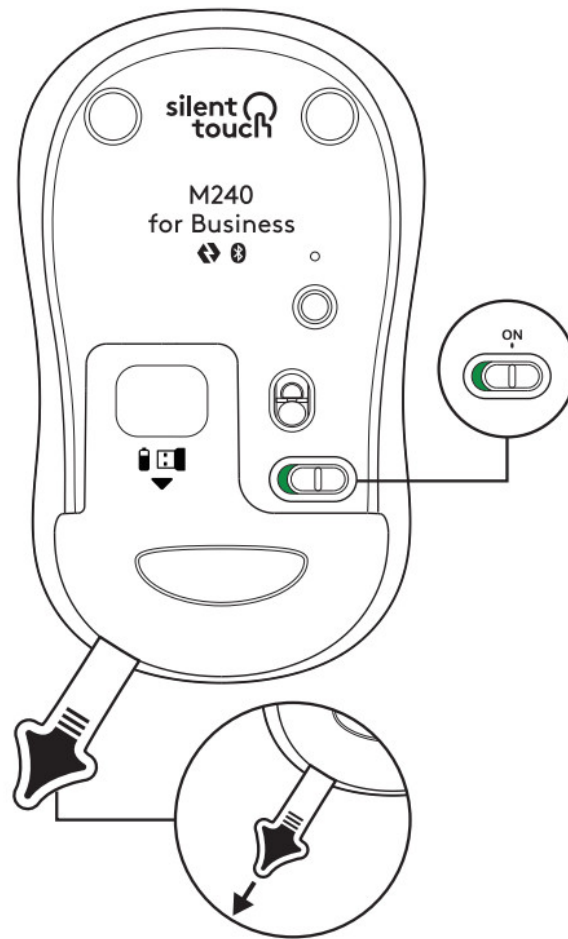

STEP 3: CUSTOMIZE YOUR MOUSE WITH OPTIONS+

1. Make sure you have the Logi Options+ App installed. If not, download it from logi.com/optionsplus
2. An installer window will pop up on your screen — click Install Options+
3. Once Options+ is installed, a window will open and you'll be able to see an image of your mouse. Click on it.
4. You will be taken into a quick onboarding process that shows you how to customize your mouse. We highly recommend not to skip it.
5. You can set up the pointer speed and customize the middle button during the onboarding process.
6. App-specific profiles can also be set up.
7. Once you're finished, on the left side of the window, click Buttons, and then click on the middle button to customize the setting if needed.
8. Select the function you like to set on that button from the options that appear on the right side of the screen and you are done.



logi.com/optionsplus

REPLACING THE BATTERY

1. Slide the battery compartment cover down and then lift it off.



2. Replace a new AA alkaline battery, make sure that it faces the correct direction and then put back the battery cover

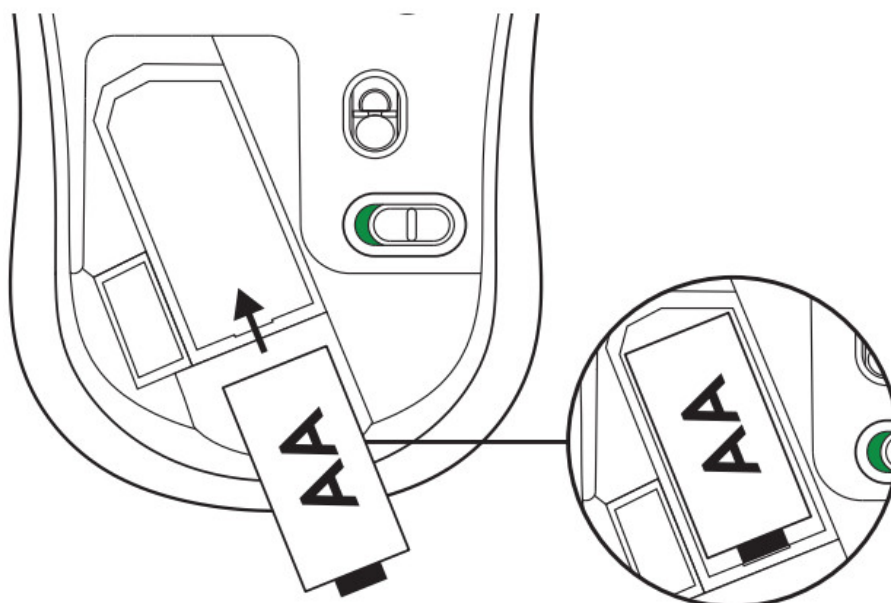

GET LOGI TUNE FOR ADDITIONAL FEATURES

Logi Tune supports battery life monitoring for Logitech mice and keyboards, and extensive customization settings are available for Logitech webcams, headsets and docks You can also view your day's schedule and stay informed on upcoming meetings with Logi Tune's calendar integration



DIMENSIONS

M240 FOR BUSINESS:

Height: 99 mm (3 90 in)
Width: 60 mm (2 36 in)
Depth: 39 mm (1 54 in)
Weight (with receiver and battery): 75 2 g (2 65 oz)

LOGI BOLT USB RECEIVER:

Height: 18 7 mm (0 74 in)
Width: 14 4 mm (0 57 in)
Depth: 6 1 mm (0 24 in)
Weight: 1 7 g (0 06 oz)

www.logitech.com/support/m240b

© 2023 Logitech, Logi, Logi Bolt, Logi Options+ and their logos are trademarks or registered trademarks of Logitech Europe S A and/or its affiliates in the US and other countries App Store is a service mark of Apple Inc Android, Chrome are trademarks of Google LLC The Bluetooth® word mark and logos are registered trademarks owned by Bluetooth SIG, Inc and any use of such marks by Logitech is under license Windows is a trademark of the Microsoft group of companies All other 3rd party trademarks are the properties of their respective owners Logitech assumes no responsibility for any errors that may appear in this manual Information contained herein is subject to change without notice

WEB-621-002468 002



Documents / Resources

	<p>logitech M240 Silent Bluetooth Mouse [pdf] User Guide</p> <p>M240 Silent Bluetooth Mouse, M240, Silent Bluetooth Mouse, Bluetooth Mouse, Mouse</p>
--	---

References

- [User Manual](#)