

# logitech M196 Bluetooth Mouse



## logitech M196 Bluetooth Mouse Instructions

[Home](#) » [Logitech](#) » logitech M196 Bluetooth Mouse Instructions 

### Contents

- [1 logitech M196 Bluetooth Mouse](#)
- [2 Specifications](#)
- [3 Product Usage Instructions](#)
- [4 FAQs](#)
- [5 USING INSTURCTION](#)
- [6 Mouse plastic content](#)
- [7 WHAT IN THE BOX](#)
- [8 WARRANTY](#)
- [9 BATTERY](#)
- [10 FCC](#)
- [11 CONTACT INFORMATION](#)
- [12 Documents / Resources](#)
  - [12.1 References](#)
- [13 Related Posts](#)

# logitech

logitech M196 Bluetooth Mouse



## Specifications

- Model: M196
- Plastic Content: Minimum 67% post-consumer recycled plastic
- Battery Life: Up to 12 months (varies with use conditions)
- Warranty: 1-year limited hardware warranty
- Compatibility: Windows, macOS

## Product Usage Instructions

### Pairing the Mouse via Bluetooth:

1. Ensure your device's Bluetooth is turned on.
2. Press and hold the ON button on the mouse for a few seconds until the LED light starts blinking.
3. Locate the mouse on your device's Bluetooth settings and select it to pair.

### Battery Replacement:

1. When the battery needs replacement, locate the battery compartment on the mouse.
2. Open the compartment and remove the old battery.
3. Insert a new AA battery into the compartment following the correct polarity.
4. Close the compartment securely.

## Cleaning and Maintenance:

- To clean the mouse, use a soft, dry cloth to wipe the surface. Avoid using harsh chemicals or abrasive materials that may damage the plastic casing.

## FAQs

- **Q: How can I check the battery level on the M196 mouse?**

- A: The M196 mouse does not have a battery level indicator. It is recommended to replace the battery with a fresh one if you experience connectivity issues or notice reduced responsiveness.

- **Q: Is the M196 mouse compatible with Chromebook devices?**

- A: The M196 mouse is designed to work with Windows and macOS systems. While it may work with some Chromebook models, full compatibility cannot be guaranteed.

## USING INSTRUCTION

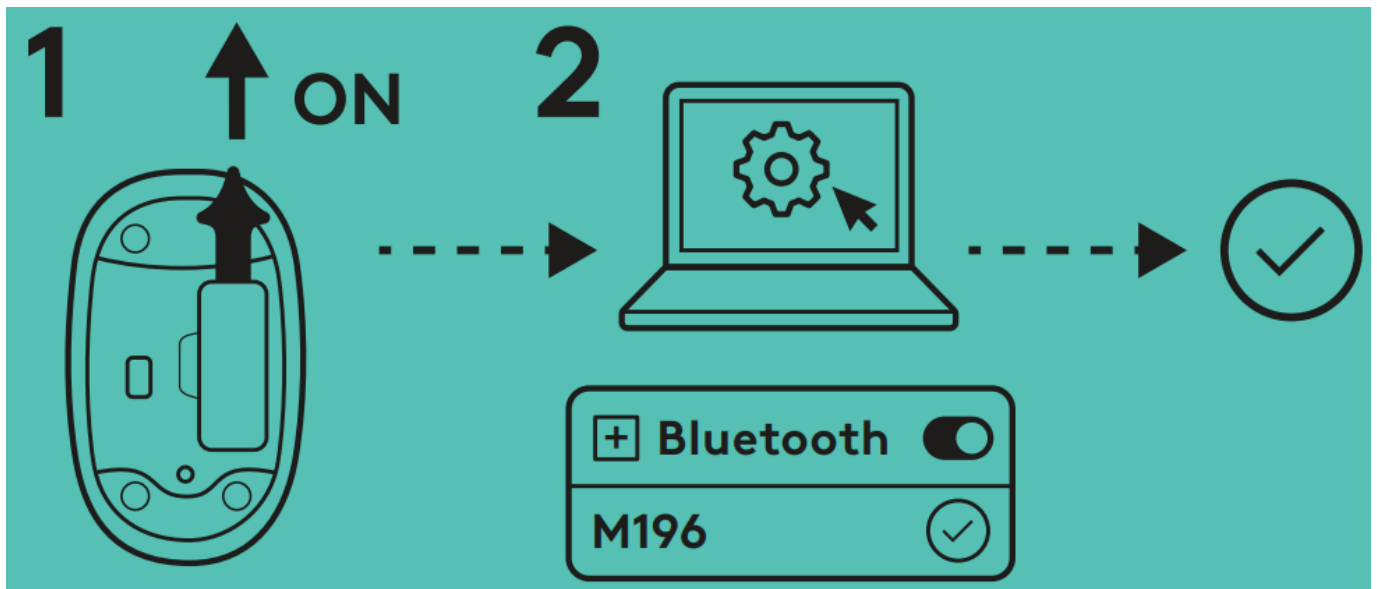

## Mouse plastic content

**Mouse plastic content:** minimum 67% post-consumer recycled plastic. Excludes plastic in printed wiring assembly (PWA) and packaging.

## WHAT IN THE BOX



## WARRANTY

- Battery life varies with use conditions.
- 1-year limited hardware warranty

## BATTERY

- Pair-and-play, no receiver needed.
  - 12-month battery life.

## Compatibility

**Required:** Bluetooth® Low Energy Windows, macOS [logitech.com/product/mice/M196](https://www.logitech.com/product/mice/M196)

## FCC

This device complies with Part 15 of the FCC Rules. Operation is subject to the following two conditions: (1) this device may not cause harmful interference, and (2) this device must accept any interference received, including interference that may cause undesired operation.

## MORE INFO

Images are for reference only. © 2024 Logitech. Logitech, Logi and the Logitech logo are trademarks or registered trademarks of Logitech Europe S.A. and/or its affiliates in the U.S. and other countries. Bluetooth® word mark and logos are registered trademarks owned by Bluetooth SIG, Inc., used under license by Logitech. All other trademarks are the property of their respective owners.

## CONTACT INFORMATION

### Logitech

- 3930 North First Street
- San Jose, CA 95134 USA
- [www.logitech.com](https://www.logitech.com)
- Pat.: [www.logitech.com/patents](https://www.logitech.com/patents)
- NASDAQ: LOGI
- Importer: Logitech do Brasil Com. de
- Acess. de Inform. Ltda.
- CNPJ (SP): 08.573.862/0002-04
- CNPJ (SC): 08.573.862/0003-87
- Website: [support.logitech.com/pt\\_br/contact-warranty](https://support.logitech.com/pt_br/contact-warranty)
- SAC: +55 11 3230 3580
- [logitech.com/support/M196](https://logitech.com/support/M196)

## Documents / Resources

	<p><a href="#">logitech M196 Bluetooth Mouse</a> [pdf] Instructions M196, M196 Bluetooth Mouse, Bluetooth Mouse, Mouse</p>
---	--

## References

- [User Manual](#)

[Manuals+](#), [Privacy Policy](#)

This website is an independent publication and is neither affiliated with nor endorsed by any of the trademark owners. The "Bluetooth®" word mark and logos are registered trademarks owned by Bluetooth SIG, Inc. The "Wi-Fi®" word mark and logos are registered trademarks owned by the Wi-Fi Alliance. Any use of these marks on this website does not imply any affiliation with or endorsement.