



Logitech Z623 400 Watt Home Speaker System, 2.1 Speaker System-Complete Features/Instruction Guide

[Home](#) » [Logitech](#) » Logitech Z623 400 Watt Home Speaker System, 2.1 Speaker System-Complete Features/Instruction Guide 

Contents

- [1 Logitech Z623 400 Watt Home Speaker System, 2.1 Speaker System](#)
- [2 Specifications](#)
- [3 Introduction](#)
- [4 What's In the Box?](#)
- [5 Technical Certifications](#)
- [6 SYSTEM REQUIREMENTS](#)
- [7 Help with Setup](#)
- [8 Frequently Asked Questions](#)
- [9 Related Posts](#)

logitech®

Logitech Z623 400 Watt Home Speaker System, 2.1 Speaker System



Specifications

- **Product Dimensions**

17.31 x 11.87 x 12.25 inches

- **Item Weight**

18.15 pounds

- **Batteries**

1 Lithium-ion battery

- **Speaker Type**

Satellite, Subwoofer

- **Mounting Type**

Plug Mount

- **Connectivity Technology**

Wired

- **Brand**

Logitech

Introduction

With 200 watts (RMS) of power, the Logitech Speaker System Z623 with THX-certified 2.1 system offers large, strong sound from your music, movies, and games. Logitech® Speaker System Z623. For big, bold, 2.1 sound. THX® Certified means quality you can count on – these speakers have met strict performance standards to achieve THX certification. You'll hear – and feel – immersive audio from 200 watts (RMS) of power that brings music, movies, and games to life. Multiple inputs, as well as a built-in headphone jack, make it easy to get great sound from up to three audio devices. Easy, two-satellite setup and a powerful subwoofer give you big sound – even in large spaces. And integrated controls put you in command: dial the volume and bass up or down to customize your listening experience.

What's In the Box?

- Speakers

- 3.5 mm audio input cable
- Speaker connector cables
- User documentation
- 2-year manufacturer's guarantee and full product support

Technical Certifications

- THX Multimedia Certification
- 200 watts (RMS)
- Two 3.5 mm inputs
- One pair of RCA inputs
- Headphone output
- Controls integrated into the right satellite: power, volume, and bass controls
- Total RMS power: 200 watts
- Subwoofer: 130 watts RMS
- Satellites: 2 x 35 watts
- Total peak power: 400 watts
- Frequency response: 35 Hz – 20 kHz

SYSTEM REQUIREMENTS

PC/Mac/Linux, Connectivity, Processor, Memory, HD Space, and other supporting information Works with:

- Computers, music players, TVs, DVD players, and other audio sources with 3.5 mm or RCA audio out
- PlayStation®2, PLAYSTATION®3, Xbox 360® or Wii® using the AV cable that comes with your console

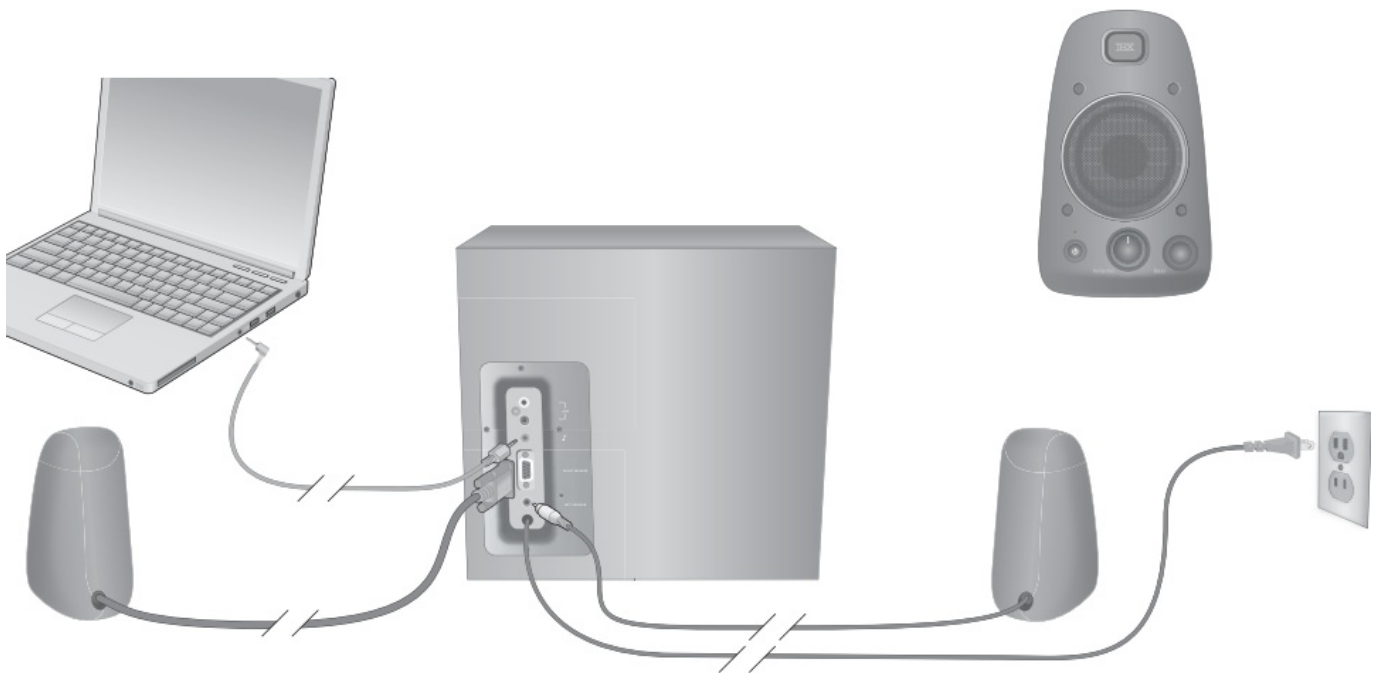

Plug your headphones into the jack on the right speaker. To adjust the volume for your headphones, use the controls on the front of the right speaker.



To use the auxiliary input on the right speaker, plug your MP3 player or another device into the auxiliary jack using the included 3.5 mm cable. If you are using the headphone output on your device, make sure the volume level on your device is set to 80% or higher. To adjust the volume on the speakers, use the controls on the front of the right speaker.

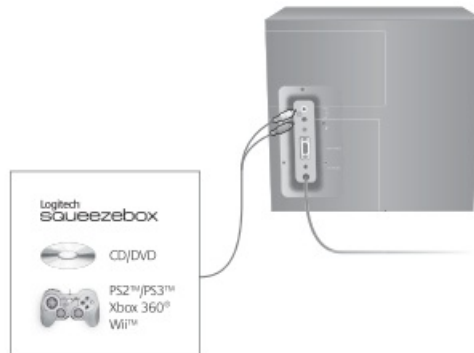

To use the RCA auxiliary input jacks on the rear of the subwoofer, plug your Logitech Squeezebox, DVD player, or game console into the RCA jacks using a 2-channel RCA cable (not included).

Help with Setup

Something does not sound right? No sound at all?

- If one speaker doesn't produce sound, unplug your speakers and plug them in fully.
- Make sure the left speaker is plugged into the black RCA jack on the subwoofer
- Make sure the speakers are plugged into an AC outlet and the power button is on.
- Try connecting the speakers to an alternate audio source-for example, an MP3 or CD player
- Sound from the speaker is muted whenever headphones are plugged in. Try unplugging them to restore sound

to the speakers.

Visit www.logitech.com for more troubleshooting tips

Input:

- 110V-60Hz 900mA (Model: S-00105)
- 220-240 50/60Hz 600mA (Model: S-00104, International except China version)
- 220-240V- 50/60Hz 450mA (Model: S-00104, China version only)

Frequently Asked Questions

- **what is the average life span of these speakers?**

v7+ YEARS STRONG! I purchased these back in December of 2013 in college. Speakers have moved around over 10 times, but I kept the original box for moving purposes. Finally purchased a home and these still remain as my main TV speakers. I recommend this set of speakers for anyone who wants that movie theater and thrilling music experience in their own home.

- **why is there a loud high pitched buzz when I turn on the speakers?**

I had this issue, and connecting the speaker cable from the subwoofer to the pc in the opposite direction as indicated on the directions fixed it for me. So have the 90 degree end of the speaker cable connected to the subwoofer instead of the PC. I had tried making sure they were seated fully before, and have no logical explanation for why this would make a difference but try and see if it works for you as well.

- **What's the difference between the Klipsch ProMedia 2.1 vs Logitech Z623?**

I just replaced a Klipsch ProMedia set that bit the bullet after 10 (or more) great years. I went for the best/cheapest I could find, which led me to the Logitech Z623. The great reviews made me feel I stood a fair chance of liking them. Comparing the two systems, I would have to give a slight nod to the Klipsch for sound quality, but that may just be due to my being more used to them. The Z623s are brighter sounding than my Klipsch's were, and I think I need to get used to that. They aren't bright to the point of sounding harsh. Overall I like the Logitech and plan to keep them. If you can get these for < one hundred, you can't go wrong.

- **Are these good party speakers? Do they create room-filling sound in a mid-large environment?**

YES. I have these in my office/living area of the home, and if I have papers on top or by the speakers they will be on the floor in no time. If you really want to turn them up, your neighbors will hear from the street and also might upset the concrete in your walls. Although..put them at mid-level and you can hear throughout your home really nicely. I can hear the beat, bass and treble really well even from the rooms upstairs. I really have enjoyed these! Love the adjustable bass on the sub-woofer. I have played them so loud...I cannot believe I have not blown them. But check your system for that aspect in regards to what you are hooking them up to. I just have them hooked up to my PC, which probably wouldn't give off enough power to blow them out. But trust me... that hook-up can be loud and crisp

- **Can it be used outside? Is it good for home theater?**

During the Covid thing, our family has been putting on outside house concerts for our neighborhoods. We have a large front yard and live in a neighborhood with very quiet streets. We play inside our home (huge grand piano) and pipe the music outside using the Logitech system as a PA along with a Marshall guitar speaker. The Z623s fill in the high end very nicely and the sub when placed in the alcove of our front door, adds nicely to the lower end. With the audience spaced 6 feet apart, there is quite a large space to push the music out to. For

smaller gatherings outside, we use only the Logitech system which puts out awesome sound over a large area. For a smaller system, it truly kicks.

- **200 watts at this price? What's the catch? Why so much higher than anything else anywhere near this price range?**

As with others, its not really 200 watts. If ur an audiophile, move on. If ur looking to shake the room a little, it,a, steal.

<https://m.media-amazon.com/images/I/B1YHTeVP5gS.pdf>

<https://m.media-amazon.com/images/I/814FgvOkkAL.pdf>

Manuals+