

[Skip to content](#)

Manuals+

User Manuals Simplified.

Logitech Slim Folio Pro Keyboard for iPad

Logitech Slim Folio Pro Keyboard for iPad User Manual

[Home](#) » [Logitech](#) » Logitech Slim Folio Pro Keyboard for iPad User Manual

Contents [hide](#)

[1 Logitech Slim Folio Pro Keyboard for iPad](#)

[2 SLIM FOLIO PRO](#)

[3 KNOW YOUR PRODUCT](#)

[4 SETTING UP THE CASE](#)

[5 TURNING ON THE KEYBOARD](#)

[6 PAIRING IPAD WITH KEYBOARD](#)

[7 THREE USE MODES](#)

[8 REMOVING YOUR IPAD](#)

[9 HOW TO STORE APPLE PENCIL \(2ND GEN\)](#)

[10 LED LIGHT INDICATORS](#)

[11 SHORTCUT KEYS](#)

[12 CHARGE THE BATTERY](#)

[13 BATTERY INFORMATION](#)

[14 BATTERY REMOVAL FOR RECYCLING](#)

[15 Specs & Details](#)

[15.1 Dimensions](#)

[15.2 Technical Specifications](#)

[15.3 Warranty Information](#)

[15.4 Part Number](#)

[15.5 California Warnings](#)

[15.6 Compatible devices](#)

[15.7 Slim Folio Pro for iPad Pro 11-inch \(1st, 2nd and 3rd Gen\)](#)

[15.8 Slim Folio Pro for iPad Pro 12.9-inch \(3rd and 4th gen\)](#)

[16 FAQ – Frequently Asked Questions](#)

[17 Read More About:](#)

[18 Download:](#)

[19 Related Posts](#)

Logitech Slim Folio Pro Keyboard for iPad

User Manual

SLIM FOLIO PRO

Backlit keyboard case with *Bluetooth* for iPad Pro® 11-inch (1st, 2nd & 3rd gen) & 12.9-inch (3rd & 4th gen)

Enjoy laptop-like typing on your iPad Pro with Slim Folio Pro. Three distinct use modes ensure you can always work at your highest level no matter where you are.

KNOW YOUR PRODUCT

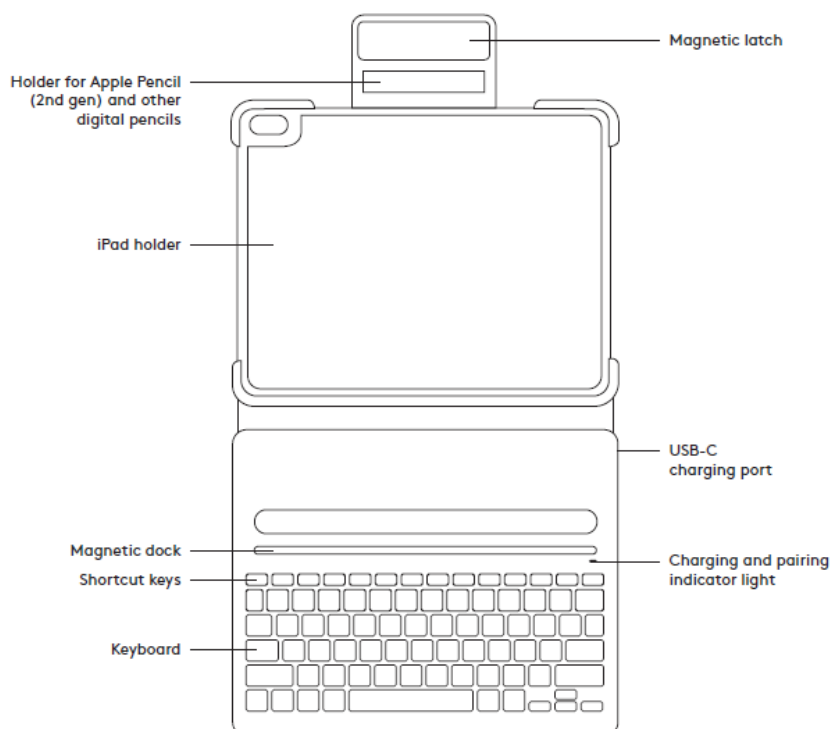

SETTING UP THE CASE

1. Lay keyboard case flat and slide iPad into the bottom part of the holder.
2. Snap the top corners in place to secure iPad.

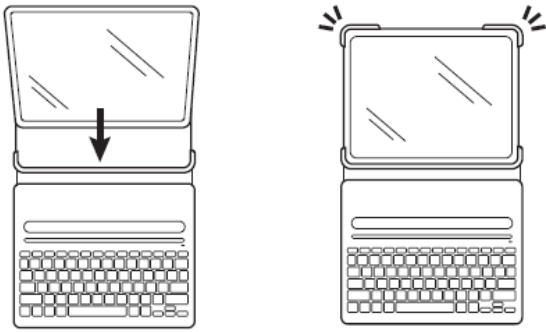

TURNING ON THE KEYBOARD

This product has an automatic wake/sleep feature. Anytime you dock the iPad in the upright typing position, the keyboard will automatically turn on. When lifted out of type mode, the keyboard will automatically turn off to save battery.

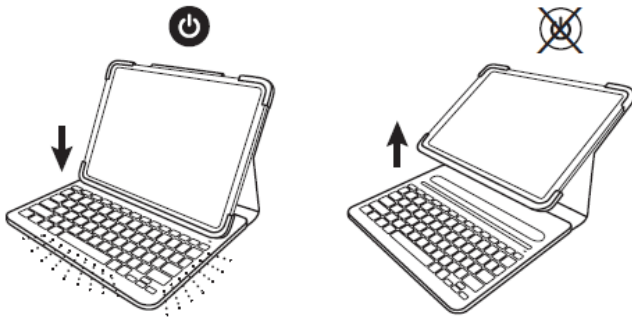

PAIRING IPAD WITH KEYBOARD

1. Place iPad in the upright typing position.

The indicator light will blink, which means the keyboard is ready to pair.

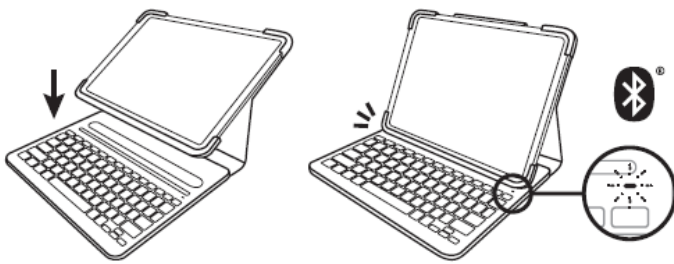

Light isn't blinking?

Go to iPad Settings > Bluetooth > On. Then press the Bluetooth button located in the top row of your keyboard. Hold for 2 seconds until the status light blinks. The keyboard is discoverable for 2 minutes.

2. Go to Settings > Bluetooth > Devices > Slim Folio Pro.



3. A 6-digit code will appear on your iPad screen.

Using the Slim Folio Pro keyboard, type in the numbers.

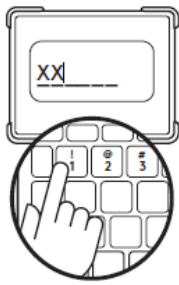

4. Press the ENTER key. Now you're ready to type!

Note: If you want to use another iPad with this keyboard case, you will need to go through the pairing process again.

THREE USE MODES

Type mode

Fold the latch back until it magnetizes to the front of the case. Dock iPad in the upright position and type away.



Sketch mode

Lift iPad from magnetic dock and collapse into sketch mode. Since the keyboard is only on when iPad is in type mode, there is no need to worry about unintentional typing.



Read mode

Open the case and fold the keyboard back. The magnetic latch will keep the two sides of the case held together while you read. Since the keyboard is only on when iPad is in type mode, there is no need to worry about unintentional typing.

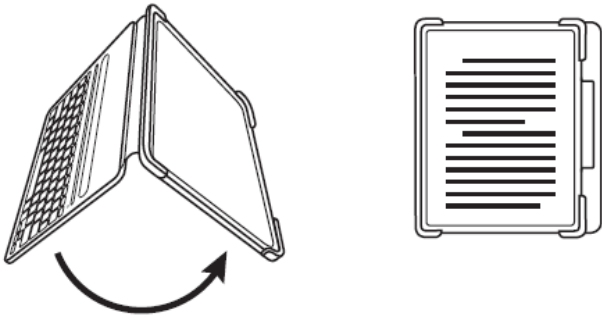

REMOVING YOUR IPAD

1. To detach your iPad from the case, lay it on a flat surface.
2. Push back the top corners of the case, one at a time, and then lift your iPad out of the cradle.

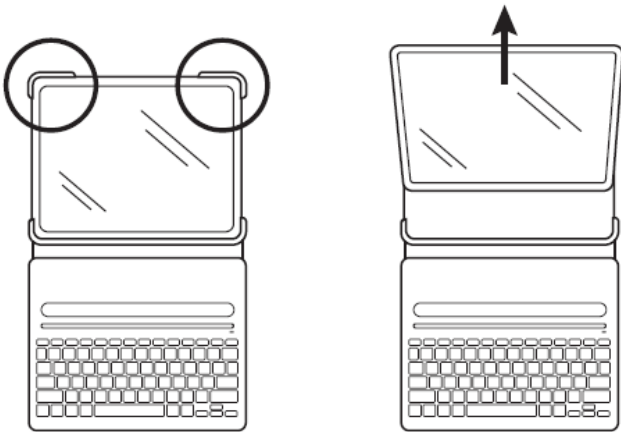

HOW TO STORE APPLE PENCIL (2ND GEN)

The sides of Slim Folio Pro are left open, so you can magnetically attach Apple Pencil (2nd gen) to the side of the iPad Pro while the case is on. There is also a slit on the inside of the Slim Folio Pro magnetic latch to keep Apple Pencil (2nd gen) secure in transit.

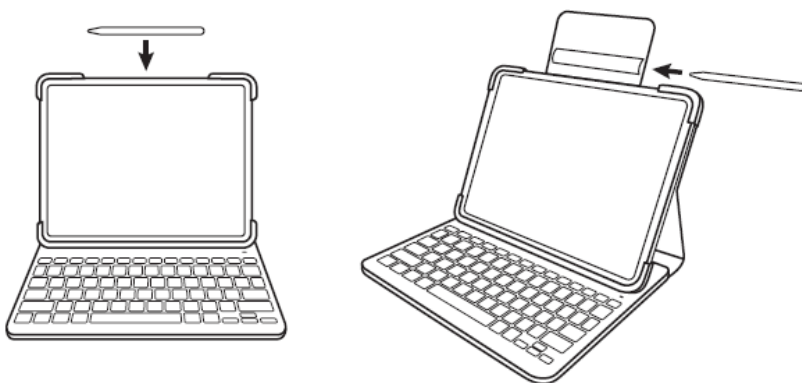

LED LIGHT INDICATORS



LED Behavior

Status

Blinking green	Battery is charging
Solid green	Battery is fully charged (100%)
Red	Battery level is low (less than 10%), recharge the battery
Blinking white	Fast: Keyboard is in discovery mode, ready for pairing Slow: Keyboard is trying to reconnect to iPad
Solid white	Bluetooth™ pairing or reconnection is successful

SHORTCUT KEYS

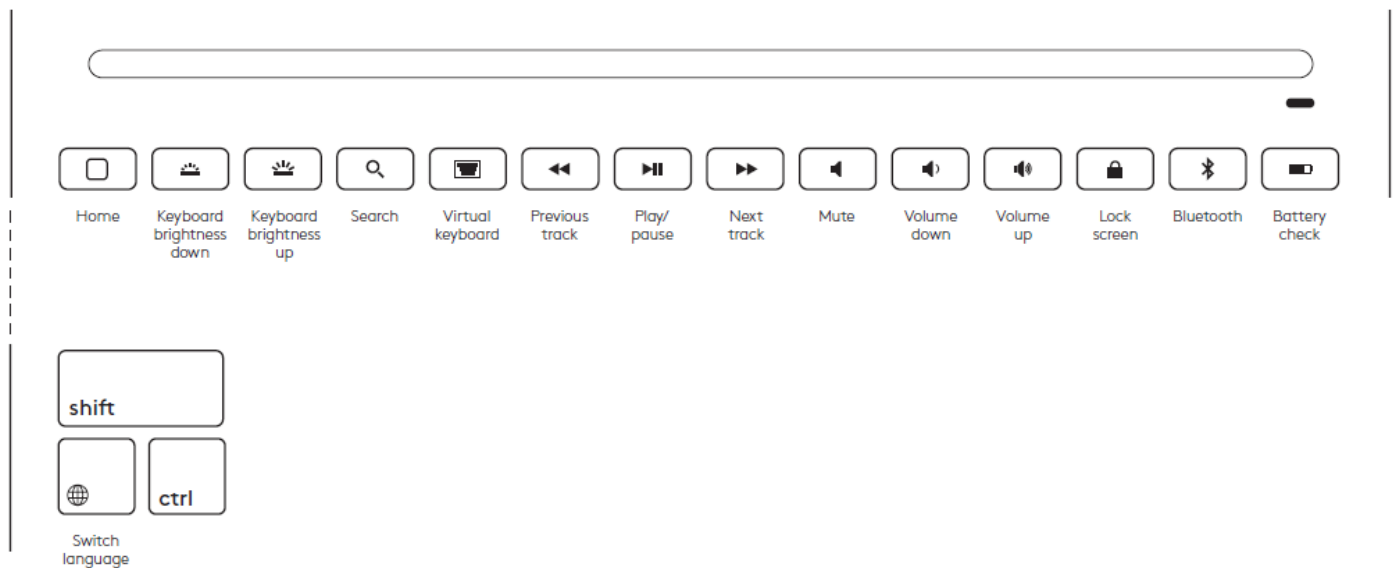

CHARGE THE BATTERY

To check battery life, press the battery check button. If the status light is red, the keyboard needs to be charged. Use a USB-C cable. This is the same cable that is used to charge iPad Pro 11-inch and 12.9-inch (3rd generation).

1. Plug one end of the USB-C cable into the iPad charging port. Plug the other end into a USB-C port on your computer or a wall power adaptor.
2. Charge the battery until the status light turns solid green.

BATTERY INFORMATION

- A fully charged battery provides about 3 months of use when the keyboard is used about two hours a day.
- Charge the battery if the status light turns red briefly after the keyboard turns on.
- The keyboard enters sleep mode automatically if not used for a while in the typing position. Press any key to wake it.
- Once iPad is disconnected from magnetic dock, the keyboard will automatically shut off to save power.

BATTERY REMOVAL FOR RECYCLING

1. Pry off top cover of the keyboard with a screwdriver.

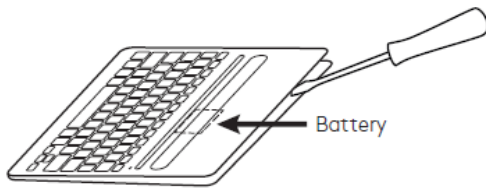

2. Detach battery from circuit board and remove battery.
3. Separate your product and battery from household waste for recycling, where possible, according to local laws.
4. For more information, contact your local authority or place of purchase or visit www.logitech.com/recycling

Specs & Details

Dimensions

Slim Folio Pro for iPad Pro 11-inch (1st, 2nd and 3rd Gen)

- **Height:** 7.68 in (195 mm)
- **Width:** 9.96 in (253 mm)
- **Depth:** 0.89 in (22.55 mm)
- **Weight:** 19.49 oz (552.42 g)

Slim Folio Pro for iPad Pro 12.9-inch (3rd and 4th gen)

- **Height:** 9.06 in (230 mm)
- **Width:** 11.30 in (287 mm)
- **Depth:** 0.88 in (22.46 mm)
- **Weight:** 24.95 oz (707.43 g)

Technical Specifications

Modes

- Type, Sketch, Read

Keyboard Type

- Integrated keyboard

Backlit Keys

- Yes

Viewing Angles: Fixed

- **Type Mode:** 58 degrees
- **View Mode:** 10 degrees

Power and Connectivity

- Powered by rechargeable battery
- Up to 3-month battery life (based on 2 hours of typing per day)
- Pair keyboard with iPad via Bluetooth Low Energy

Case

- **Space to charge and stow Apple Pencil (2nd gen)**
- **Magnetic latch**
- **Front and back protection**
- **Access all ports:** Camera / USB-C

Keyboard

- 3 levels of adjustable backlighting
- Full row of iPadOS shortcut keys
- Slim Folio Pro for iPad Pro 11-inch (1st, 2nd and 3rd Gen)
 - 0.67 in (17 mm) key pitch
 - 0.06 in (1.6 mm) key travel
- Slim Folio Pro for iPad Pro 12.9-inch (3rd and 4th gen)
 - 0.74 in (19 mm) key pitch
 - 0.06 in (1.6 mm) key travel

Row of iPadOS Shortcut Keys (Left to Right)

- Home
- Key brightness down
- Key brightness up
- Search
- Onscreen keyboard
- Previous track
- Play/pause
- Next track
- Volume mute
- Volume down
- Volume up
- Lock
- Bluetooth LE connect
- Keyboard battery check

Warranty Information

1-Year Limited Hardware Warranty

Part Number

- **For iPad Pro 12.9-inch (3rd & 4th gen):** 920-009703
- **For iPad Pro 11-inch (1st, 2nd & 3rd gen):** 920-009682

California Warnings

- WARNING: Proposition 65 Warning

Compatible devices

Slim Folio Pro for iPad Pro 11-inch (1st, 2nd and 3rd Gen)

- iPad Pro 11-inch (3rd gen)
Model: A2377, A2459, A2301, A2460
- iPad Pro 11-inch (2nd Gen)
Model: A2228, A2068, A2230, A2231
- iPad Pro 11-inch (1st Gen)
Model: A1980, A2013, A1934, A1979

Slim Folio Pro for iPad Pro 12.9-inch (3rd and 4th gen)

- iPad Pro 12.9-inch (4th gen)
Model: A2229, A2069, A2232, A2233
- iPad Pro 12.9-inch (3rd Gen)
Model: A1876, A2014, A1895, A1983

FAQ – Frequently Asked Questions

I'm having a charging issue with my Slim Folio Pro. What do I do?

The keyboard case uses a USB-C cable to charge the battery. To charge the keyboard, connect the USB-C cable that came with your iPad Pro to your Slim Folio Pro and any USB power source. When the Slim Folio Pro is successfully charging, the green LED light, located on the top right corner of the keyboard, will breathe (pulse on and off). If the LED light does not turn on after you've connected the Slim Folio Pro to a power source, please try the following:

- Make sure the charging port on your Slim Folio Pro is clean and free of any debris; this can be accomplished with canned air. We do not recommend inserting anything into the port to clear obstructions.
- Try charging the Slim Folio Pro with a different USB power source.
- If available, try charging the Slim Folio Pro with a different USB-C cable.

How do I confirm that the Slim Folio Pro keyboard case is connected to my iPad Pro?

To confirm that your Slim Folio Pro keyboard is properly connected using Bluetooth, follow these steps:

1. On your iPad, Select **Settings**

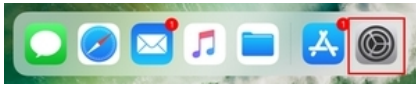

2. Tap on **Bluetooth**.

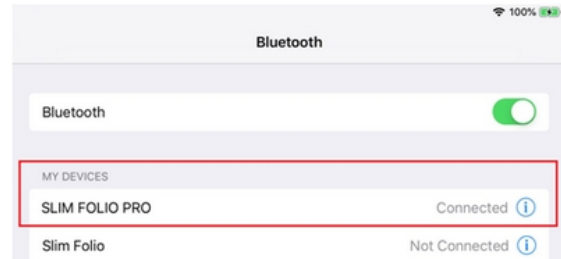

3. In the list of connected devices, you should see the SLIM FOLIO PRO.

– If you don't see the SLIM FOLIO PRO, then the keyboard case and iPad are not properly connected.

Will I be able to use a tempered screen protector with the Slim Folio Pro?

You should be able to use a screen protector with your keyboard case. The gap between the keyboard and the iPad Pro screen is approximately 1 mm. This is enough space to fit most screen protectors.

NOTE: If you are unsure about your screen protector please check the packaging or manufacturer specification for how thick your iPad screen protector is.

What do the LED light colors on the Slim Folio Pro mean?

Your keyboard case has an LED light on the top right corner of the keyboard to indicate Bluetooth and battery status.

Power and battery

- Green, breathing — battery is charging.
- Green, solid — battery is charged.
- Red, solid — battery is low (less than 20%). You should charge your keyboard when you can.

Bluetooth

- White, quickly blinking — keyboard is in discovery mode, ready for pairing.
- White, slowly blinking — the keyboard is trying to reconnect with your Apple device.
- White, solid — pairing or connection is successful. The light then turns off to save energy.

How do I charge the Slim Folio Pro keyboard case and what's the battery life?

To charge the Slim Folio Pro, connect the USB-C cable that came with your iPad Pro to Slim Folio Pro any USB power source. Charging times may vary depending on the power source.

The battery life of your keyboard may also vary with usage. On average, a full battery charge will last up to three months when used for about two hours a day.

I'm having issues connecting my Slim Folio Pro and iPad Pro. What do I do?

- Go to Settings on your iPad and check if Bluetooth is active.
- Make sure your keyboard case is charged. Turn your keyboard on by placing it upright into Type Mode. The status indicator will be red if your keyboard has less than 20% battery life left. In this case, connect Slim Folio Pro to a power source before proceeding.
- Try moving away from other wireless or Bluetooth sources — you could be experiencing interference.
- On your iPad, turn Bluetooth off and then back on again.
- Try un-pairing and re-pairing your keyboard case with your iPad. Here's how:

1. On your iPad, tap **Settings** and then **Bluetooth**.
2. Find "SLIM FOLIO PRO" in the **Devices** list, tap the arrow to the right and then tap **Forget this device**.
3. Place iPad in the upright typing position to turn the keyboard on. The status indicator on the top right corner of the keyboard will glow green.
4. Press the Bluetooth connection button on the right side of the keyboard for three seconds to put it into discovery mode.
5. On your iPad, tap **Settings**, then **Bluetooth** settings, locate "SLIM FOLIO PRO" in the **Devices** list, and select it.
6. Once the connection is made, the LED indicator light will turn solid white. Your keyboard is now ready to use.

- Make sure your iPad is using the latest iOS update. If not, please follow these directions to update your iPad using Wi-Fi.
1. Plug your iPad into power and connect to the Internet with Wi-Fi.
 2. Tap **Settings** > **General** > **Software Update**.
 3. Tap Download and Install. If a message asks to temporarily remove apps because iOS needs more space for the update, tap **Continue** or **Cancel**. Later, iOS will reinstall apps that it removed.
 4. If asked, enter your passcode and the update will process.
 5. After the update is completed, your iPad Pro will restart, then please attempt to re-pair your Slim Folio Pro with your iPad.

Are all the keys on the Slim Folio Pro keyboard capable of back-lighting?

Yes, every single key is backlit and can be adjusted to 3 levels of intensity.

How do I turn the Slim Folio Pro keyboard case on and off?

Your Slim Folio Pro does not have an on/off switch.

When you dock your iPad Pro in the upright Typing Mode position, it will automatically turn on. When you take your iPad Pro out of the Type Mode position, the keyboard will automatically turn off.

Will the Slim Folio Pro keyboard case scratch my iPad screen?

The keyboard case has been designed to ensure screen safety. Rubber padding on the corners of the case creates a 1 mm gap that separates the keys and your iPad screen. This ensures no direct contact or scratching while case is closed. Only safe materials were used to develop the keyboard case, no aluminum, metal or other materials hard enough to damage your iPad.

Read More About:

[Logitech Slim Folio Pro Keyboard for iPad User Manual](#)

Download:

Logitech Slim Folio Pro Keyboard for iPad User Manual – [[Download PDF](#)]

[Manuals+](#),

- [home](#)
- [privacy](#)