



Logitech MK270 Wireless Keyboard User Manual

[Home](#) » [Logitech](#) » Logitech MK270 Wireless Keyboard User Manual 

Contents

- 1 Logitech MK270 Wireless Keyboard User Manual
- 2 KNOW YOUR PRODUCT
 - 2.1 MOUSE FEATURES
 - 2.2 KEYBOARD FEATURES
- 3 WHAT'S IN THE BOX
- 4 DIMENSION
 - 4.1 SYSTEM REQUIREMENTS
- 5 Logitech MK270 Wireless Keyboard User Manual
- 6 Related Posts



Logitech MK270 Wireless Keyboard User Manual







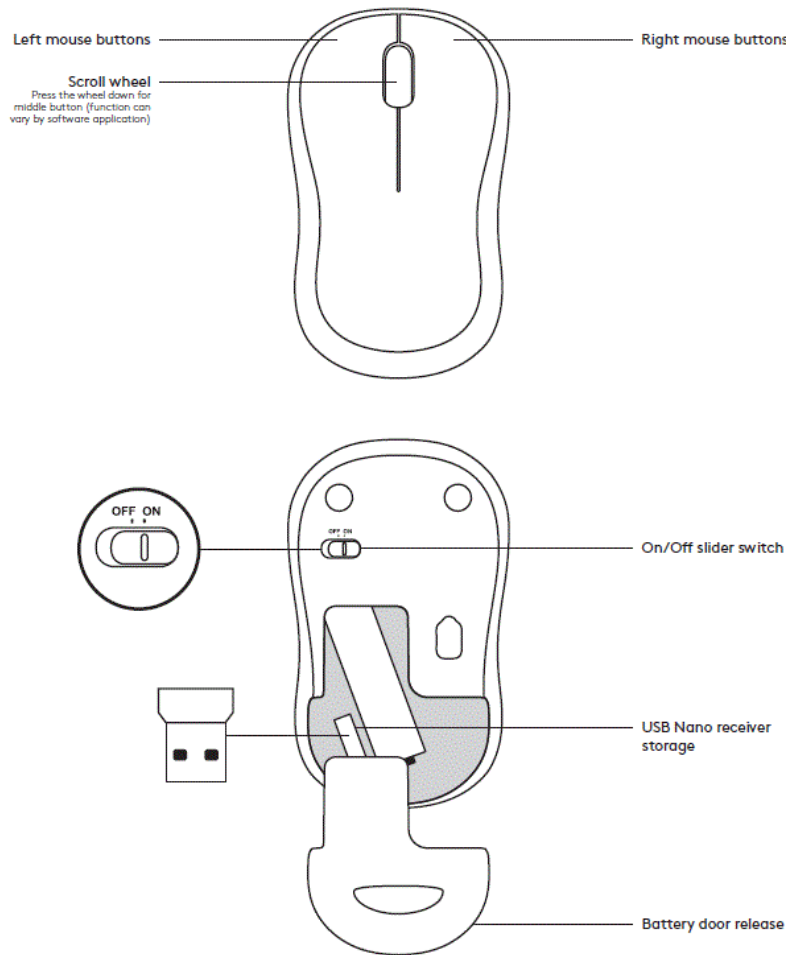



KNOW YOUR PRODUCT

MOUSE FEATURES

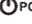

KEYBOARD FEATURES

Hot keys			
	Play / Pause		Mute volume
	Decrease volume		Increase volume
	Navigate to Internet home		Launch email application
 PC	Place PC in standby mode		Launch calculator

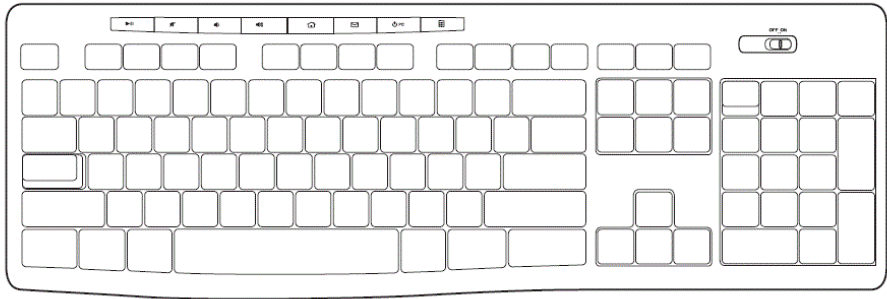

WHAT’S IN THE BOX

- 1. Logitech K270 Keyboard
- 2. Logitech M185 Mouse
- 3. AAA Battery x 2
- 4. AA Battery x 1

5. USB Nano receiver
6. User documentation

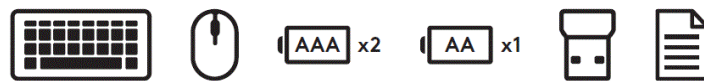

CONNECTING THE KEYBOARD AND MOUSE

www.logitech.com/support/mk270

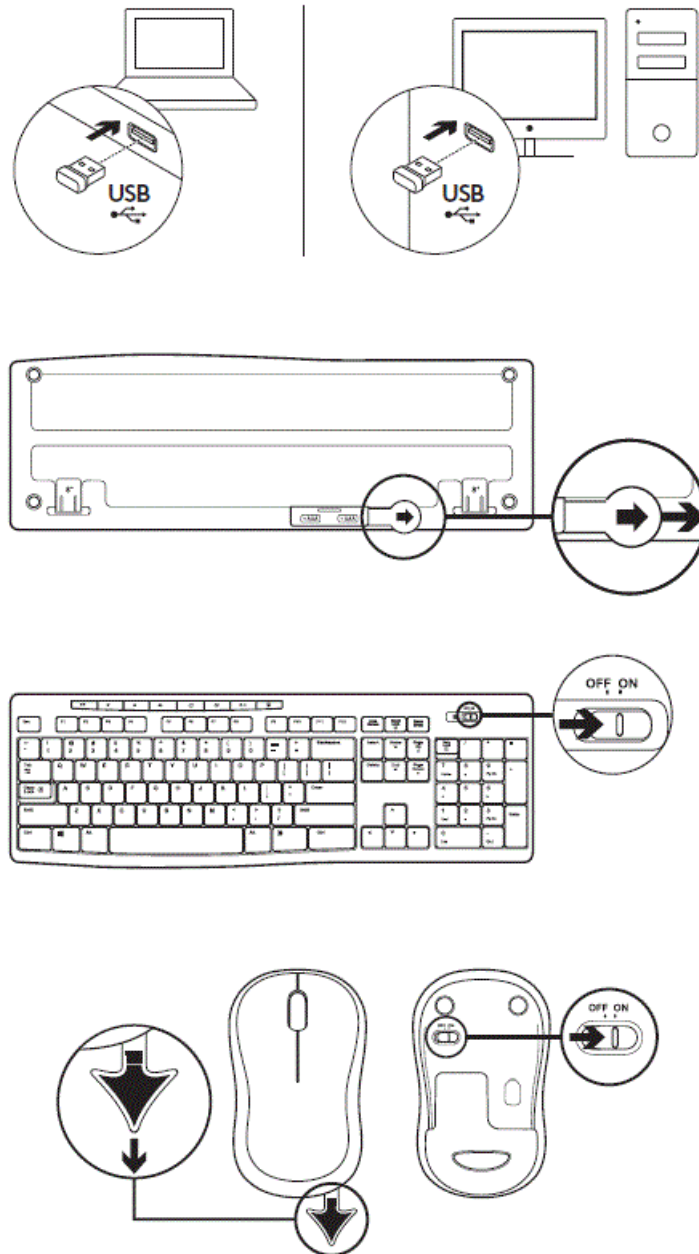

DIMENSION

Keyboard:

- Height x Width x Depth: 22.75mm x 441.53mm x 149mm
- Keyboard Weight(With Battery): 495g
- Keyboard Weight(Without Battery): 480g

Mouse:

- **Height x Width x Depth:** 38.6mm x 59.8mm x 99.5mm
- **Mouse Weight(With Battery):** 73.4g
- **Mouse Weight(Without Battery):** 50.4g

Dongle:

- **Height x Width x Depth:** 6mm x 14mm x 19mm
- **Weight:** 2g

SYSTEM REQUIREMENTS

Windows® 10 or later, Windows® 8, Windows® 7, Windows Vista®, Windows® XP Chrome OS™

USB port

Internet connection (for optional software download)

© 2020 Logitech. Logitech Logi and the Logitech Logo are trademarks or registered trademarks of Logitech Europe S.A. and/or its affiliates in the U.S. and other countries.

Logitech MK270 Wireless Keyboard User Manual

Download PDF: [Logitech MK270 Wireless Keyboard User Manual](#)