

Logitech Harmony IR Extender System



Logitech Harmony IR Extender System User Manual

[Home](#) » [Logitech](#) » Logitech Harmony IR Extender System User Manual 

Contents

- 1 Logitech Harmony IR Extender System User Manual
- 2 Frequently Asked Questions
- 3 To locate manufacturer information
- 4 Setup and positioning of the Harmony IR Extender System
- 5 References



Logitech Harmony IR Extender System User Manual



Frequently Asked Questions

Windows 8 and Windows 10 product support and device compatibility

To check if your Logitech product works with Windows 8 or Windows 10, first select the appropriate product category from the list below.

- Mice and keyboards
- Tablet and laptop accessories
- Gaming products
- Harmony remotes
- Speakers
- Headphones and headsets
- Smart radios
- Squeezebox network music players
- Alert security cameras
- WiLife security cameras
- Webcams

Locating device manufacturer and model number information for my Harmony remote

When you first set up your Harmony remote or any time you add a new device (for example, TV, cable or satellite receiver, DVD player, VCR, etc.) to your home entertainment configuration, you'll need to provide us with the manufacturer and model number information for each device you want your Harmony remote to control.

To locate manufacturer information

You can usually find the manufacturer name (for example, Sony® or Panasonic®) on the front of the device, on a label on the back or side of the device or in the user manual for that device.

Tips for identifying manufacturer information

- May also be referred to as “make” or “brand name”
- Typically located on the front of the device

- Sometimes included on the label with the Model Number

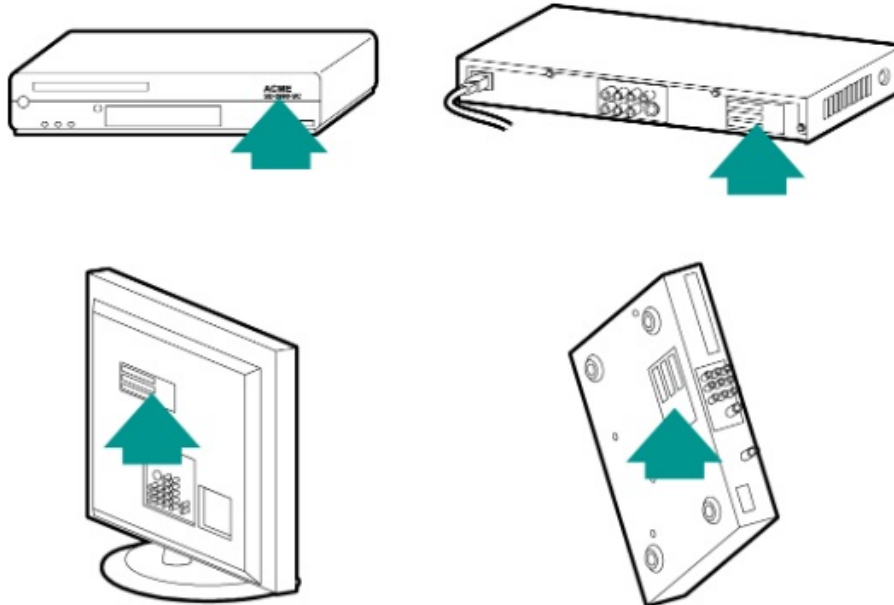

To locate model number information

On most devices, you can usually find the model number on a label located on the front, back, side, or bottom. If you can't find the model number on the device itself, look in the user manual that came with the device.

Tips for identifying model number information

- May also be referred to as "Model" or "M/N"
- Usually located on a label on the front, back or bottom of the device
- The model number may be different than the model name
- Also found in the device's user manual
- NOT the model number on the old remote control
- NOT the serial number (SN) which is usually much longer
- Examples include: CT-36XF36C, Explorer 3100, L32 HDTV 10A, etc.

For more information

If you'd like more help locating manufacturer and model number information, click [here](#) to download a worksheet to record this information.

Can I extend the length of the IR receiver cable of my Harmony IR Extender System?

You can extend the length of the IR receiver cable by using a 3.5mm male-to-female stereo cable (sold separately).



Setup and positioning of the Harmony IR Extender System

For optimal control of your home entertainment system, the Harmony IR Extender System must be properly set up and positioned. To set up your Harmony IR Extender System, follow these steps:

1. Place the IR receiver outside of your cabinet, ensuring that you have a clear line of sight to it from wherever you normally operate your home entertainment system.

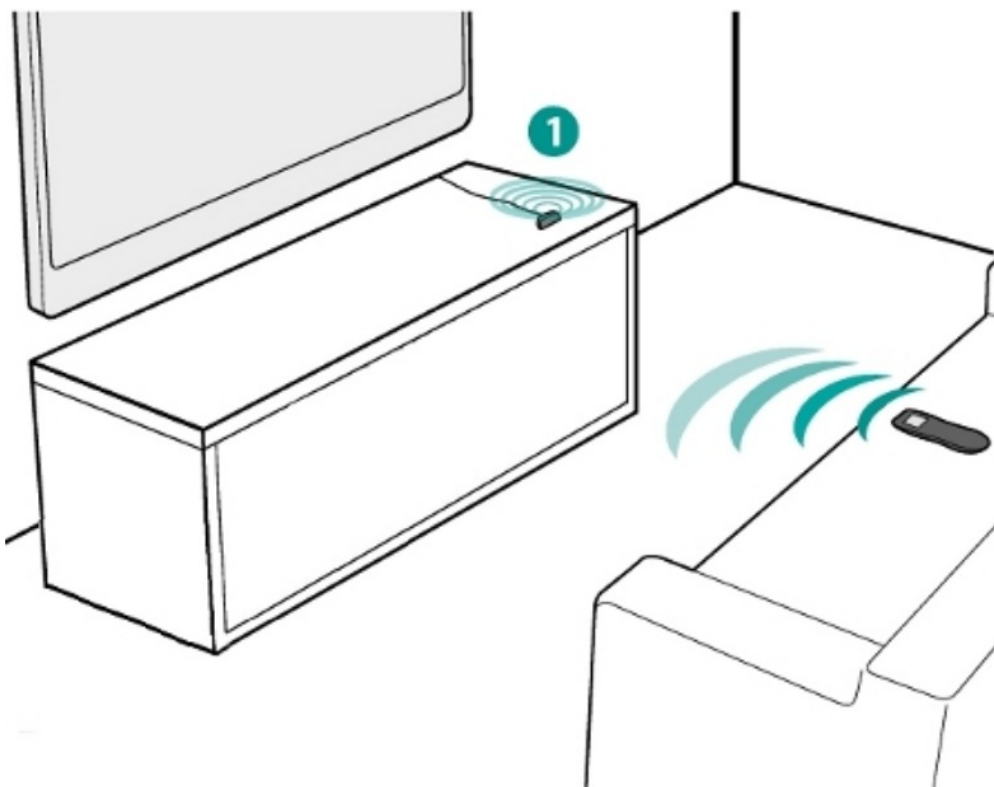

2. Connect the blaster to a power outlet using the AC adaptor provided and place it on a shelf inside your cabinet. Then, connect the IR receiver to the blaster. The status light should blink whenever the IR receiver detects a signal from your remote.

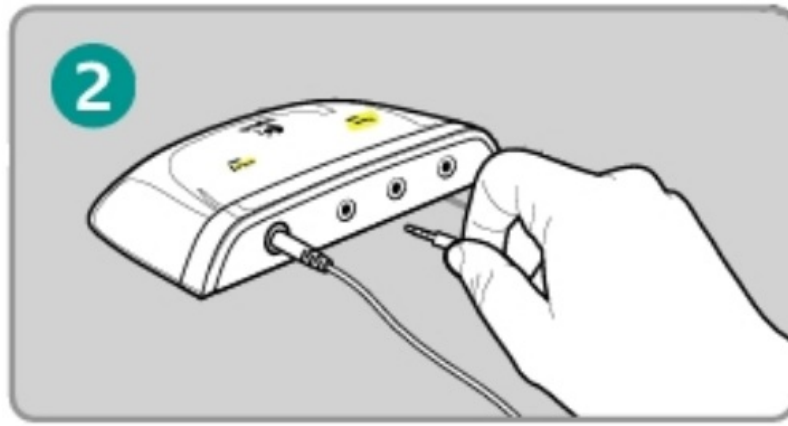

NOTE: The status light sometimes blinks when the IR receiver detects other light sources, such as plasma TVs or direct sunlight. For best performance, position the IR receiver away from these sources of light.

3. Proper positioning of the blaster and mini blasters is essential for optimal control of the devices in your home entertainment system. Below are some examples of how to position the blaster and mini-blasters:

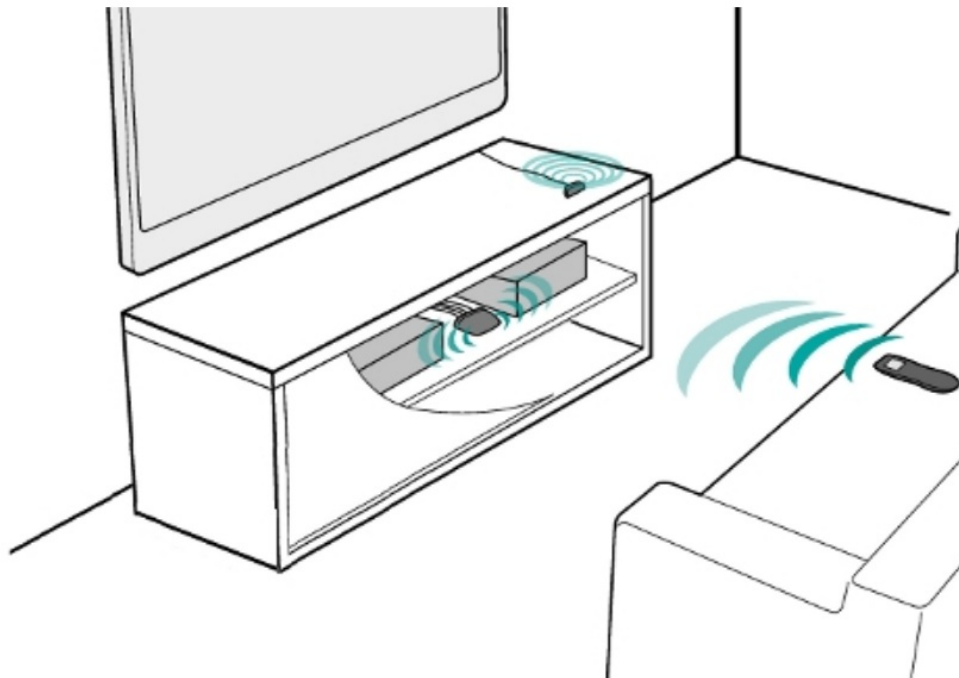

- In this example, only the blaster is used to control the devices

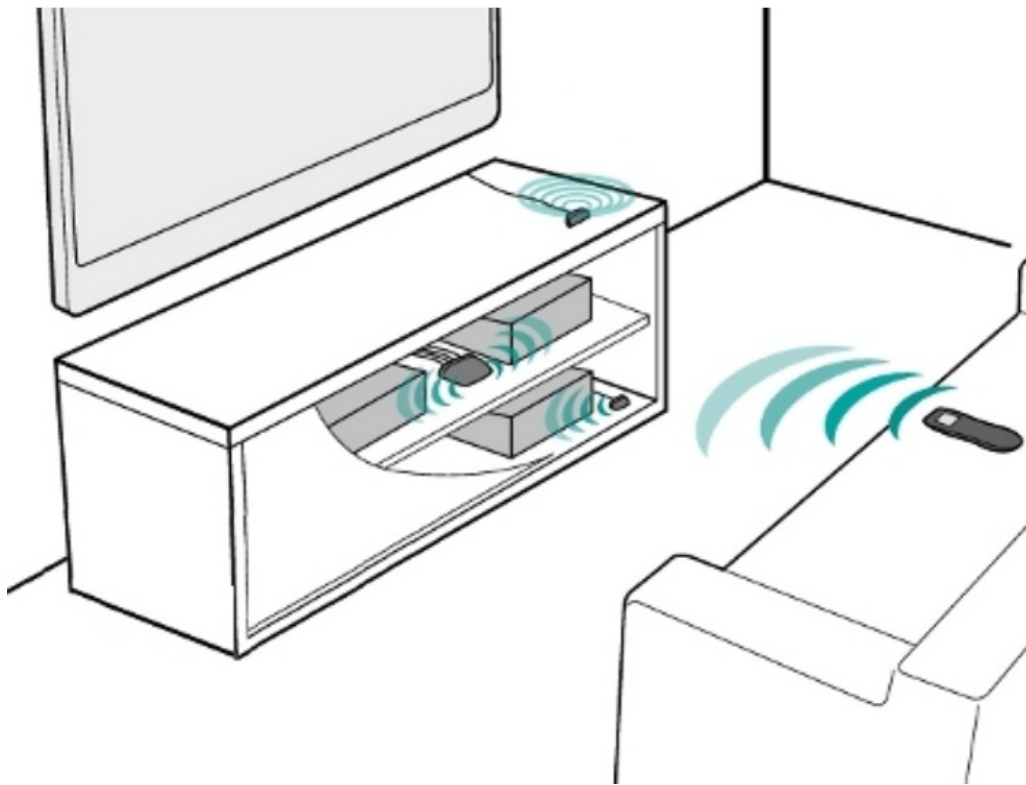

- In this example, the blaster and mini blasters are used to control the devices
- Other examples of how to position the mini blasters

Do I need to have a Harmony remote to use the Logitech Harmony IR Extender System to control my devices?

The Logitech Harmony IR Extender System is compatible with most Infrared (IR) remotes including the original device remote or Harmony remote control.

Slow or sporadic control of my devices when using the Harmony IR Extender System

The placement of the IR receiver, blaster and mini blasters can cause the Harmony IR Extender System to respond sporadically or slowly. It's important to ensure that the infrared signals fired by the blaster and mini blasters do not "escape" the cabinet and are not detected by the IR receiver. If this does occur, you might experience the slow and sporadic control. To prevent infrared signals from escaping, make sure that your cabinet doors are closed and follow the steps below:

1. Ensure the blaster is placed on a shelf inside your cabinet.

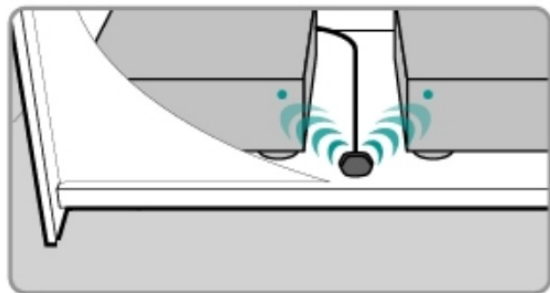
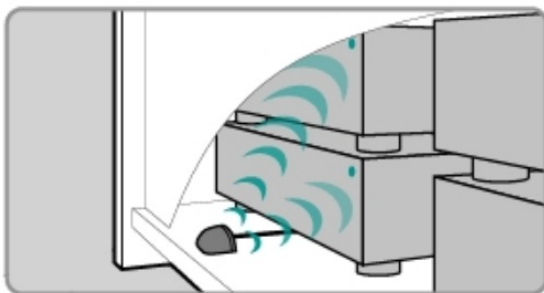

2. Ensure each mini blaster is placed on its shelf inside your cabinet.

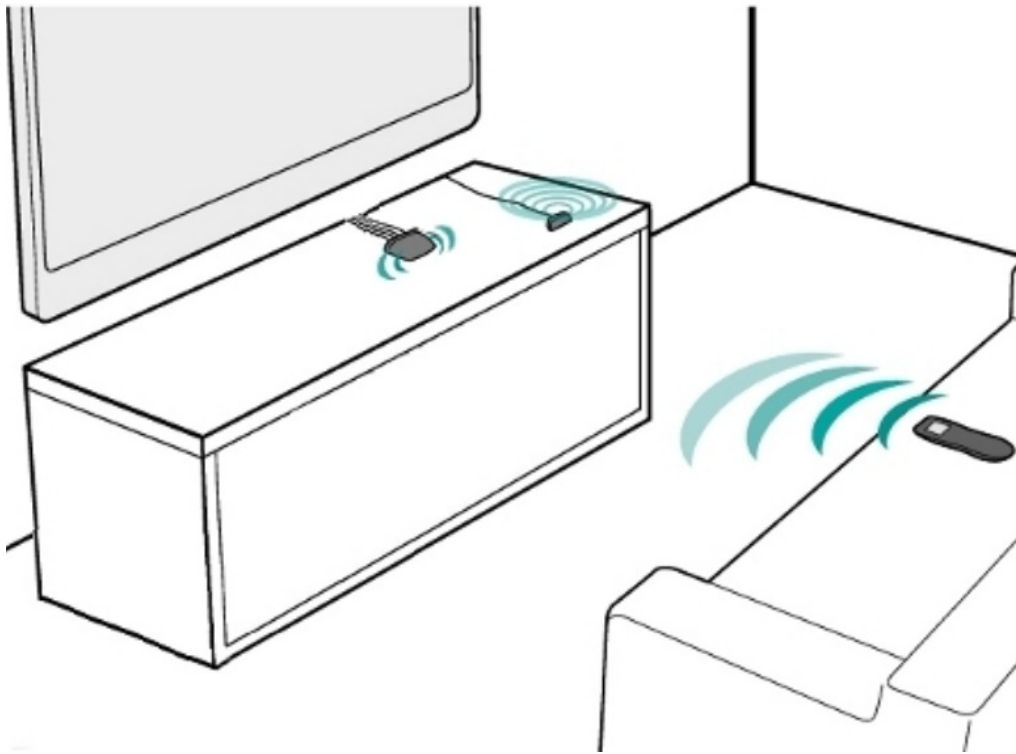

3. Ensure the blaster or mini blasters are not positioned in the vicinity of the IR receiver as shown below

For more information on how to set up your position blaster and mini blasters, please see article 360023221734 – Setup and positioning of the Harmony IR Extender System

References

- [User Manual](#)

Manuals+, Privacy Policy

This website is an independent publication and is neither affiliated with nor endorsed by any of the trademark owners. The "Bluetooth®" word mark and logos are registered trademarks owned by Bluetooth SIG, Inc. The "Wi-Fi®" word mark and logos are registered trademarks owned by the Wi-Fi Alliance. Any use of these marks on this website does not imply any affiliation with or endorsement.