

logitech KEYS-TO-GO 2 Ultra Portable Keyboard with Cover



# logitech KEYS-TO-GO 2 Ultra Portable Keyboard with Cover User Guide

[Home](#) » [Logitech](#) » logitech KEYS-TO-GO 2 Ultra Portable Keyboard with Cover User Guide 

### Contents

- 1 logitech KEYS-TO-GO 2 Ultra Portable Keyboard with Cover
- 2 Usage Instructions
- 3 FAQ
- 4 KNOW YOUR PRODUCT
- 5 SET UP YOUR PRODUCT
- 6 SHORTCUT KEYS
- 7 USE YOUR PRODUCT
- 8 CHANGE / REMOVE BATTERIES
- 9 Documents / Resources
  - 9.1 References



## logitech KEYS-TO-GO 2 Ultra Portable Keyboard with Cover



## Specifications

- Product Name: Keys-To-Go 2
- Type: Ultra-portable keyboard with cover
- Battery: Coin cell battery CR2032 x 2 units
- Connection: Bluetooth

## Product Information

The Keys-To-Go 2 is an ultra-portable keyboard with a protective cover. It features easy-switch keys for seamless connection between multiple devices, shortcut keys for quick access to functions like screen brightness adjustment and media controls, and a battery status LED indicator.

## Setup Guide

1. Turn on the keyboard by removing the battery tray cover.
2. Press the Easy-Switch button to select Keys-To-Go 2 from the device list on your Bluetooth-enabled device.

## Shortcut Keys

The keyboard includes shortcut keys such as Esc, Easy-Switch buttons for connecting to different devices, screen brightness adjustment keys, Mission Control key, Emoji key, and multimedia control keys for playback, volume adjustment, and focus mode.

## Usage Instructions

### Using the Keyboard

To use the keyboard, ensure it is turned on and paired with your device via Bluetooth. Press the Easy-Switch button to toggle between different connected devices.

### Battery Replacement

1. When the battery LED pulses red indicating low battery level, use a T5 screwdriver to remove the screws on the battery tray.
2. Replace the old CR2032 coin cell batteries with 2 new ones.
3. Dispose of old batteries following local laws.

### Software Updates

Keep the keyboard updated by using the Logitech Control app on iPadOS or Logitech Options+ on Windows/macOS for additional features and improvements.

## FAQ

### Q: How do I switch between connected devices using Easy-Switch?

A: To switch between devices, press the corresponding Easy-Switch button for 3 seconds to connect to a different

previously paired device.

## KNOW YOUR PRODUCT

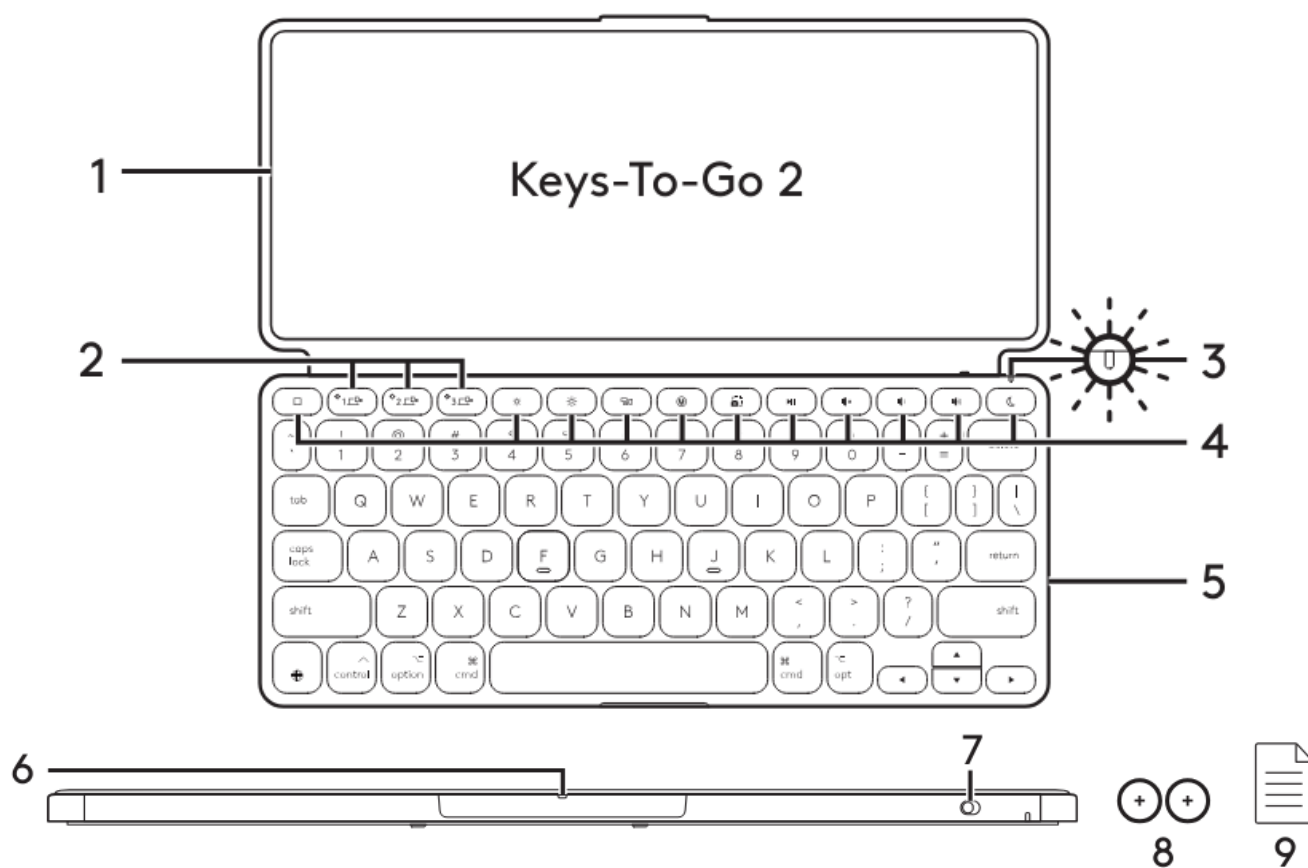

1. Keyboard cover
2. Easy-Switch keys
3. Battery status LED
4. Shortcut keys
5. Keyboard
6. Battery tray
7. ON/OFF switch
8. Coin cell battery CR2032 x 2 units
9. Documentation

## SET UP YOUR PRODUCT

1. Power on the keyboard.
  - Pull the insulation tab out from the battery tray to power on the keyboard.
  - Bluetooth® discovery starts automatically with a fast blinking white LED on Bluetooth® channel 1 and continues for 3 minutes.
2. Establish Bluetooth® connection:
  - Make sure your device's Bluetooth® feature is on. Go to Settings > Bluetooth®, and turn on the Bluetooth® function.
3. Pair the keyboard with your device:

- a. In your device's Bluetooth® settings, select “Keys-To-Go 2” from the device list.
- b. When prompted, enter the passcode displayed using the keyboard and press ENTER.
- c. When successful connection is made, the status light turns solid white for a short time, and then turns off.

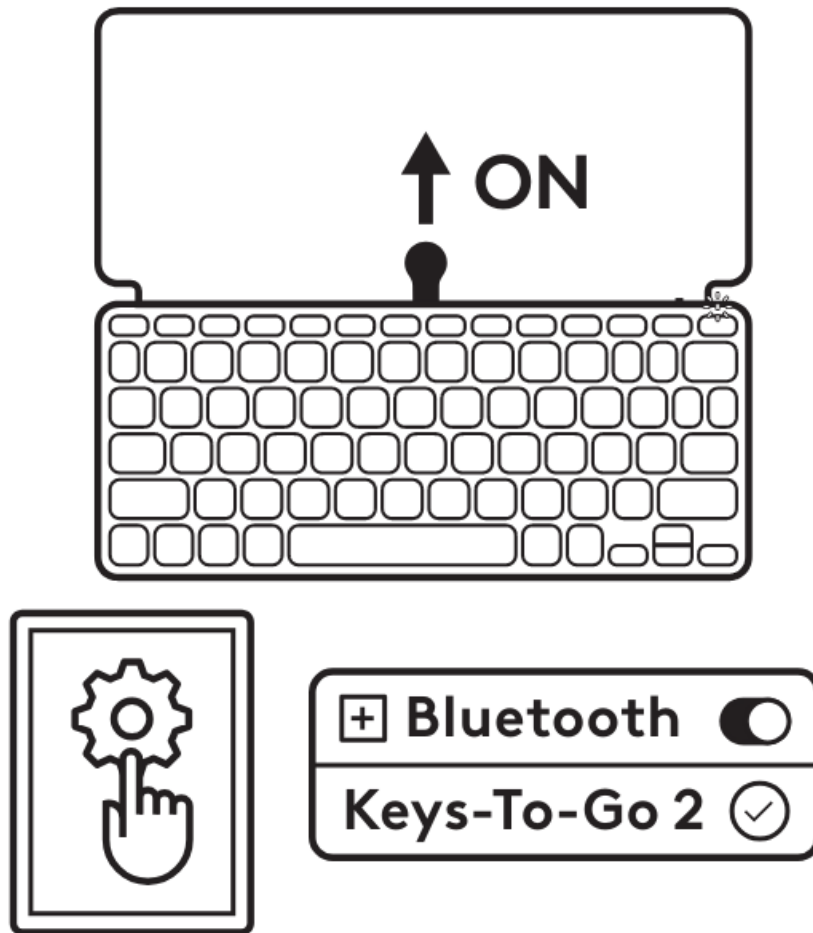

## SHORTCUT KEYS

	Esc		Emoji
	Easy-Switch 1		Screen Capture
	Easy-Switch 2		Play / Pause
	Easy-Switch 3		Mute Sound
	Screen Brightness Down		Volume Down
	Screen Brightness Up		Volume Up
	Mission Control		Focus Mode

## USE YOUR PRODUCT

### Battery Status LED Indication

#### LED/Description

- Pulsing red
  - Battery is at critical level (<5%). Replace the batteries

### Connectivity LED Indication

#### LED/Description

- **Blinking white**
  - Fast: The keyboard is in discovery mode, ready for pairing.
  - Slow: The keyboard is trying to reconnect to your device.
- **Steady white**
  - Bluetooth® pairing or reconnection is successful.

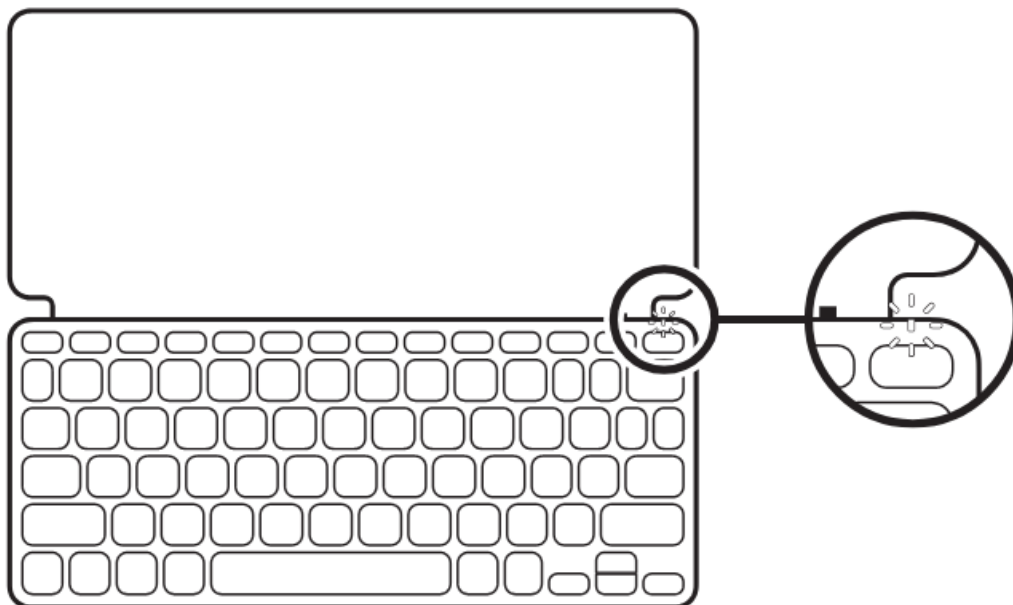

### Connect with multiple devices

1. Select the Bluetooth® channel you want and press and hold the Easy-Switch button for three seconds.
2. Bluetooth® discovery will start with a fast blinking white LED on the Easy-Switch button.
3. On your device, make sure your Bluetooth® is on. Select Settings > Bluetooth® > On.
4. Select “Keys-To-Go 2” from the device list.

## EASY-SWITCH

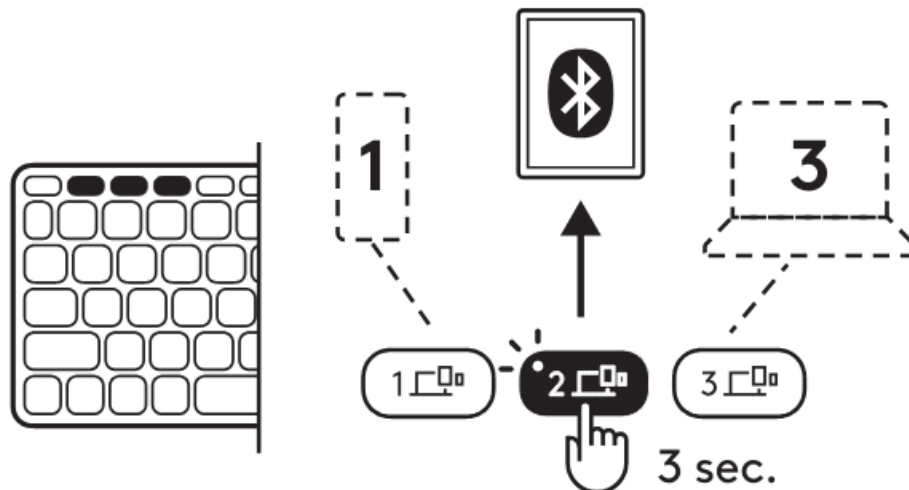

### Switch connection between multiple devices previously connected

Short press the corresponding Easy-Switch button to switch the keyboard connection to previously connected devices

### CHANGE / REMOVE BATTERIES

1. When the keyboard is at critical battery level (5% or below), the battery LED will pulse red.



2. Use a T5 screwdriver to remove both screws on the battery tray.

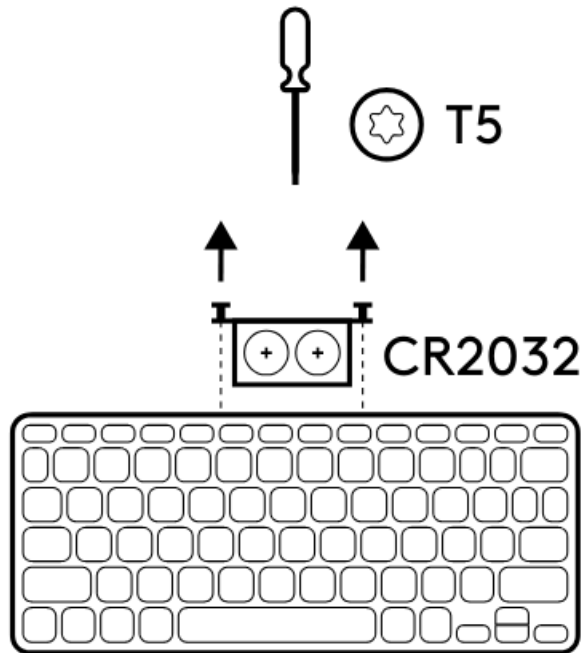

3. Place the tip of the screwdriver into the access hole on the battery tray.
4. Pull the battery tray out and replace the old batteries with 2 new CR2032 coin cell batteries.

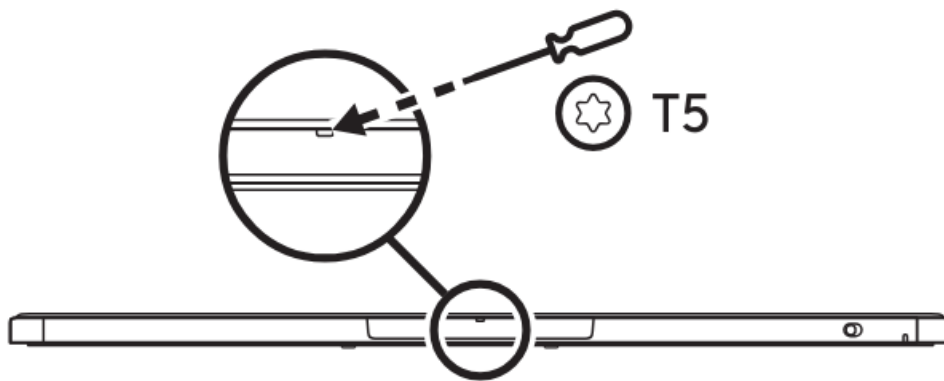

5. Dispose of the batteries according to local laws.

### Keep the keyboard updated with Logitech Control app on iPadOS

Download the Logitech Control app to keep the keyboard updated with the latest improvements and upgrades. To download and learn more go to:



### Use the keyboard with Options+ on Windows / macOS

Download Logitech Options+ to enable additional features. Available only on Windows and macOS. To download and learn more go to [app.logi.com](https://app.logi.com).

### Visit Product Support

There's more information and support online for your product. Take a moment to visit Product Support to learn more about your new Bluetooth® keyboard. Browse online articles for setup help, usage tips, and information

about additional features. If your Bluetooth® keyboard has optional software, learn about its benefits and how it can help you customize your product. Connect with other users in our Community Forums to get advice, ask questions, and share solutions.

**At Product Support, you'll find a wide selection of content including:**

- Tutorials
- Support community
- Online documentation
- Warranty information
- Spare parts (when available)

[www.logitech.com/support/keys-to-go2](http://www.logitech.com/support/keys-to-go2)

© 2024 Logitech. Logitech, Logi, Zone, and their logos are trademarks or registered trademarks of Logitech Europe S.A. and/or its affiliates in the U.S. and other countries. Apple, the Apple logo, App Store, iOS, and Mac are trademarks of Apple Inc. Android, Google Play and the Google Play logo are trademarks of Google LLC. The Bluetooth® word mark and logos are registered trademarks owned by Bluetooth SIG, Inc. and any use of such marks by Logitech is under license. Windows is a trademark of the Microsoft group of companies. Logitech assumes no responsibility for any errors that may appear in this manual. Information contained herein is subject to change without notice.

**Documents / Resources**

	<p><a href="#">logitech KEYS-TO-GO 2 Ultra Portable Keyboard with Cover</a> [pdf] User Guide</p> <p>KEYS-TO-GO 2 Ultra Portable Keyboard with Cover, KEYS-TO-GO 2, KEYS-TO-GO 2 Portable Keyboard, Ultra Portable Keyboard with Cover, Ultra Portable Keyboard, Portable Keyboard with Cover, Portable Keyboard, Keyboard</p>
---	---

**References**

- [Logi Options+ \(Plus\): Customization App for Logitech Devices](#)
- [User Manual](#)

[Manuals+](#), [Privacy Policy](#)

This website is an independent publication and is neither affiliated with nor endorsed by any of the trademark owners. The "Bluetooth®" word mark and logos are registered trademarks owned by Bluetooth SIG, Inc. The "Wi-Fi®" word mark and logos are registered trademarks owned by the Wi-Fi Alliance. Any use of these marks on this website does not imply any affiliation with or endorsement.