



logitech K120 USB Keyboard User Guide

[Home](#) » [Logitech](#) » logitech K120 USB Keyboard User Guide 

logitech K120 USB Keyboard User Guide



Contents

- [1 Package Content](#)
- [2 Power On/Off](#)
- [3 Conecting USB](#)
- [4 Troubleshooting](#)
- [5 Documents / Resources](#)
 - [5.1 References](#)
- [6 Related Posts](#)

Package Content



Power On/Off

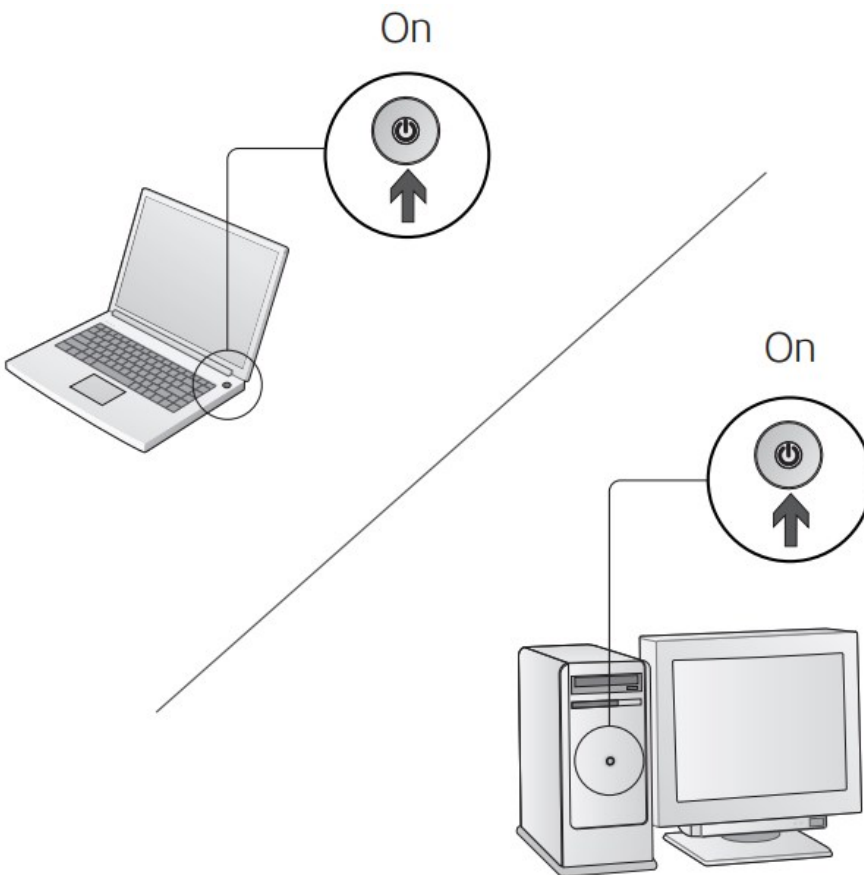

Conecting USB

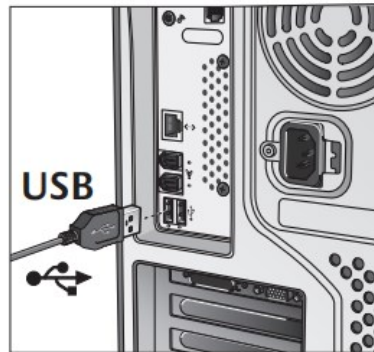
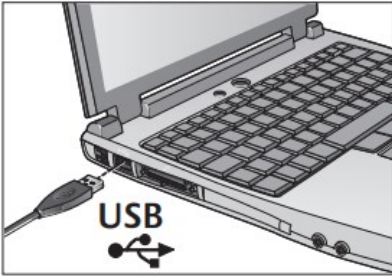

Troubleshooting

My keyboard doesn't work.

- Check your keyboard USB connection.
- Try another USB port on the computer.
- If the keyboard still doesn't work, please restart the computer.



www.logitech.com/support

- **United States:** +1 646-454-3200
- **Argentina:** +0800 555 3284
- **Brasil:** +0800 891 4173
- **Canada:** 1-866-934-5644
- **Chile:** 1230 020 5484
- **Latin America:** +55 11 3444 6761
- **Mexico:** 001 800 578 9619

What do you think?

Please take a minute to tell us. Thank you for purchasing our product.

www.logitech.com/ithink



www.logitech.com

© 2012 Logitech. All rights reserved. Logitech, the Logitech logo, and other Logitech marks are owned by Logitech and may be registered. All other trademarks are the property of their respective owners.

Logitech assumes no responsibility for any errors that may appear in this manual. Information contained herein is subject to change without notice.

Apple, Mac, and Macintosh are trademarks of Apple Inc., registered in the U.S. and other countries.

Documents / Resources

	<p>Logitech K120 USB Keyboard [pdf] User Guide K120 USB Keyboard, K120, USB Keyboard, Keyboard</p>
---	--

References

- [Logitech | Official Online Store](#)
- [Logitech Support + Download](#)

[Manuals+](#)