



logitech G913 Wireless RGB Mechanical Gaming Keyboard User Guide

[Home](#) » [Logitech](#) » logitech G913 Wireless RGB Mechanical Gaming Keyboard User Guide 



G913 Wireless RGB Mechanical Gaming Keyboard

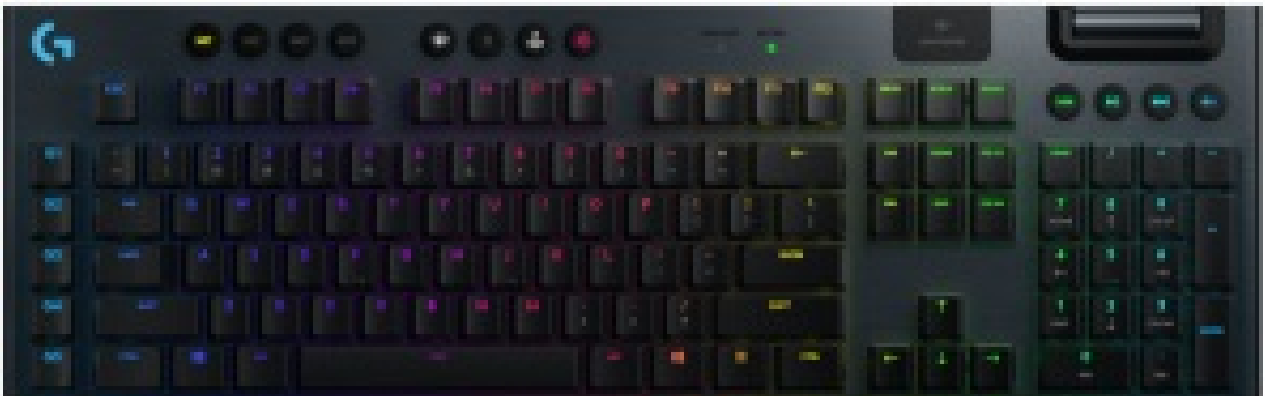

Contents

- [1 LIGHTSPEED CONNECTION](#)
- [2 BLUETOOTH® CONNECTION](#)
- [3 CHARGING](#)
- [4 KEYBOARD FEATURES](#)
- [5 KEYBOARD FEATURES — LIGHTING FUNCTIONS](#)
- [6 KEYBOARD FEATURES — G-KEYS](#)
- [7 GAME MODE BUTTON](#)
- [8 KEYBOARD BACKLIGHTING](#)
- [9 ONBOARD MEMORY](#)
- [10 KEYBOARD FEATURES — MEDIA CONTROLS](#)
- [11 KEYBOARD FEATURES — BATTERY INDICATOR](#)
- [12 KEYBOARD FEATURES — WIRELESS CONTROLS](#)
- [13 KEYBOARD FEATURES — BLUETOOTH®](#)
- [14 KEY CAP REMOVAL + REPLACEMENT](#)
- [15 CARE AND CLEANING](#)
- [16 Documents / Resources](#)
- [17 Related Posts](#)

LIGHTSPEED CONNECTION

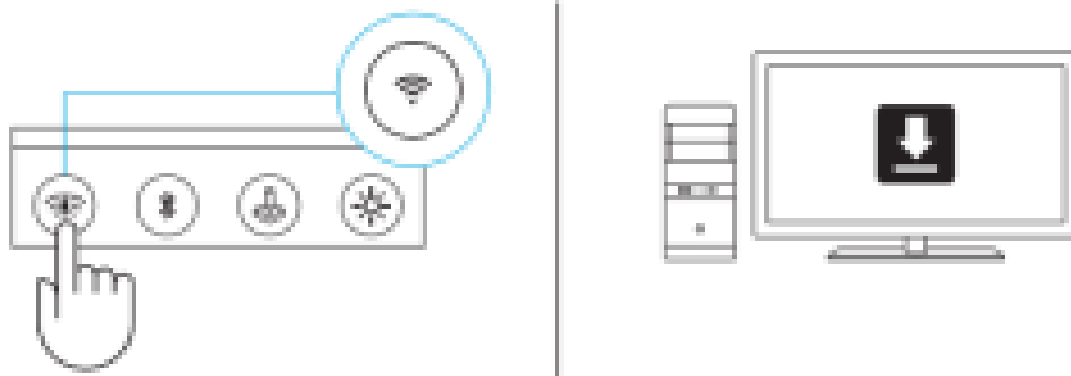
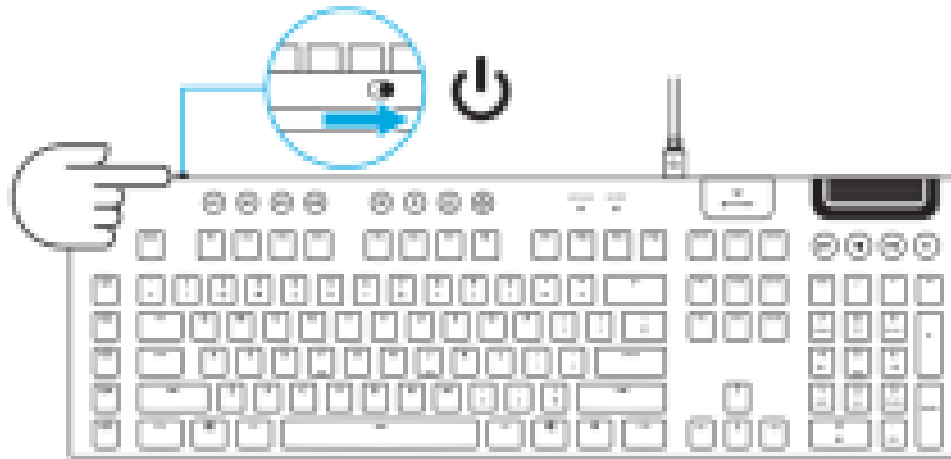
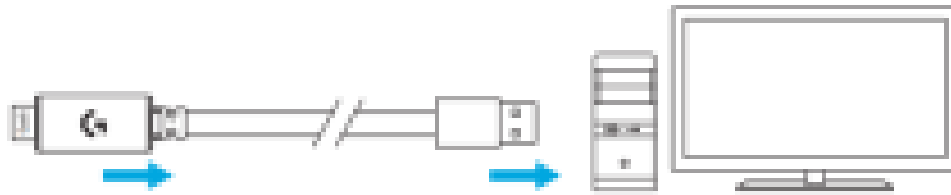

www.logitech.com/support/G913

BLUETOOTH® CONNECTION

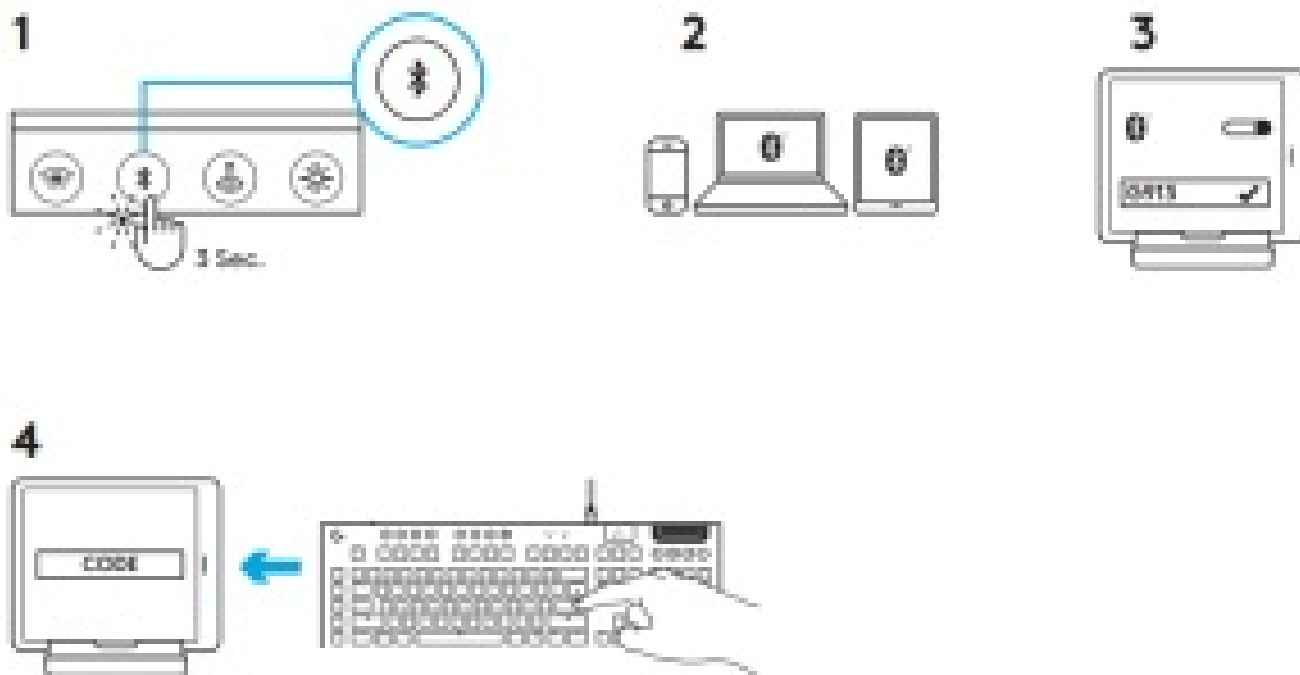

CHARGING

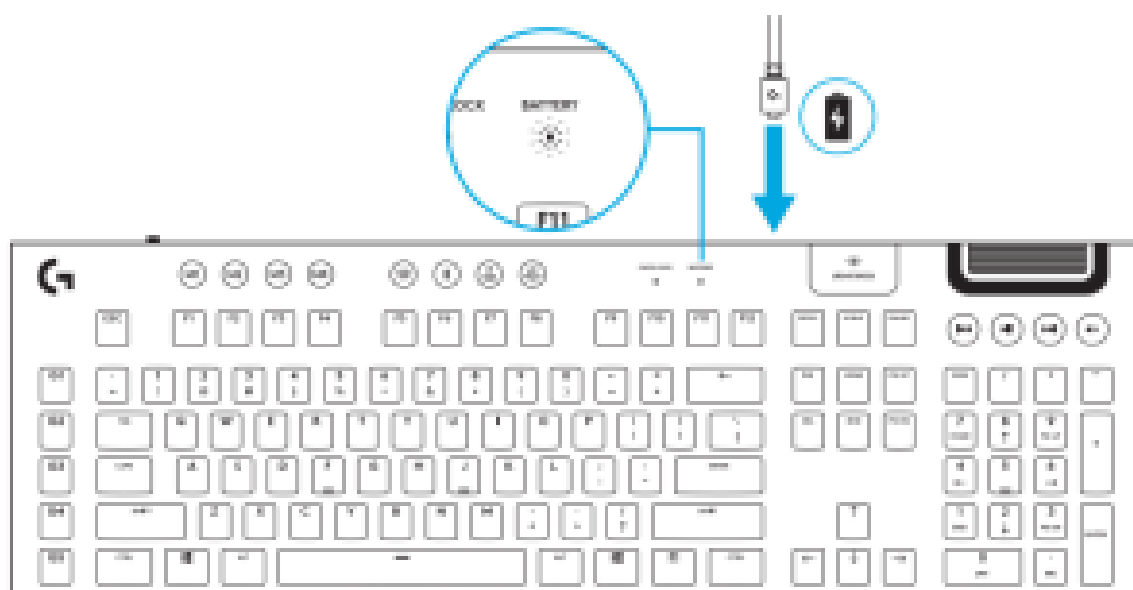

KEYBOARD FEATURES

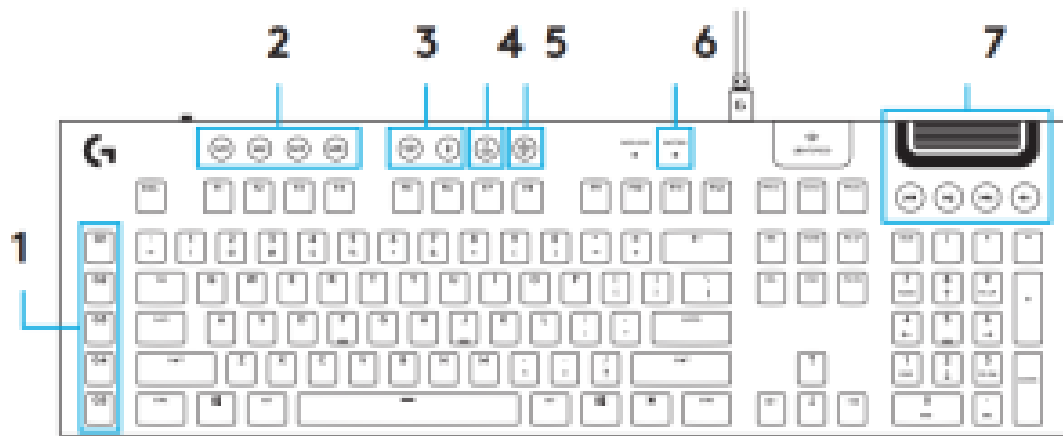

1. G-Keys
2. Mode Switches
3. LIGHTSPEED and Bluetooth
4. Game Mode
5. Brightness
6. Battery Light
7. Media Controls

KEYBOARD FEATURES — LIGHTING FUNCTIONS

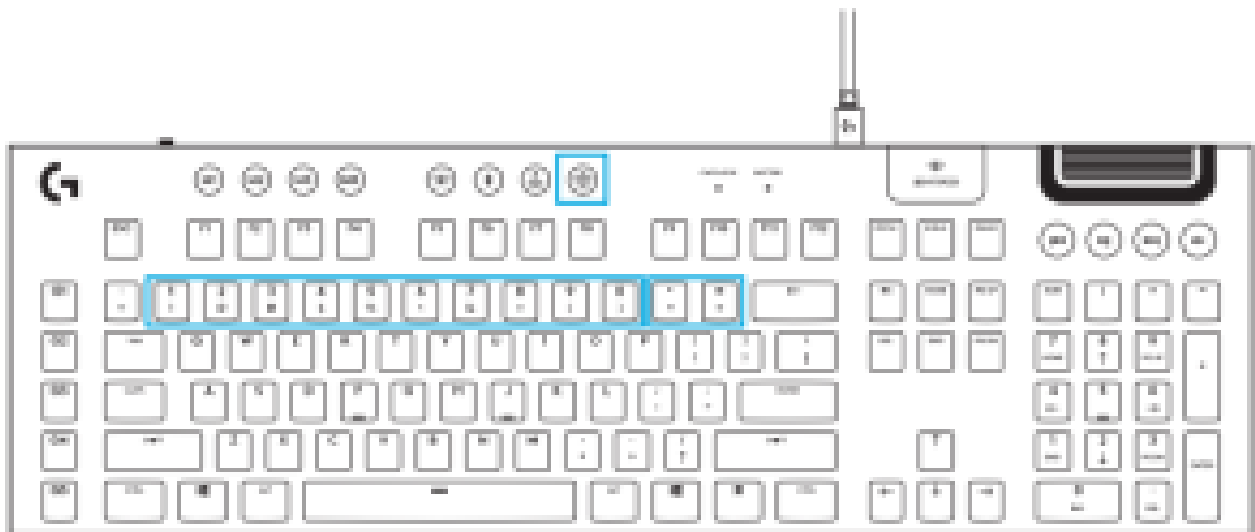

In addition to the lighting features available through G HUB software, G913 has onboard lighting effects. To select these effects, press and hold the Brightness button while pressing the keyboard number keys to select an effect:

- **Brightness + key 1:** Colorwave (left to right)
- **Brightness + key 2:** Colorwave (right to left)
- **Brightness + key 3:** Colorwave (center out)
- **Brightness + key 4:** Colorwave (bottom-up)
- **Brightness + key 5:** Color cycle
- **Brightness + key 6:** Ripple
- **Brightness + key 7:** Breathing
- **Brightness + key 8:** User-stored lighting

- **Brightness + key 9:** User-stored lighting
- **Brightness + key 0:** Cyan blue
- **Brightness + key -:** Decreases effect speed
- **Brightness + key +:** Increased effect speed

User-stored effects are saved to the keyboard by G HUB software

KEYBOARD FEATURES — G-KEYS

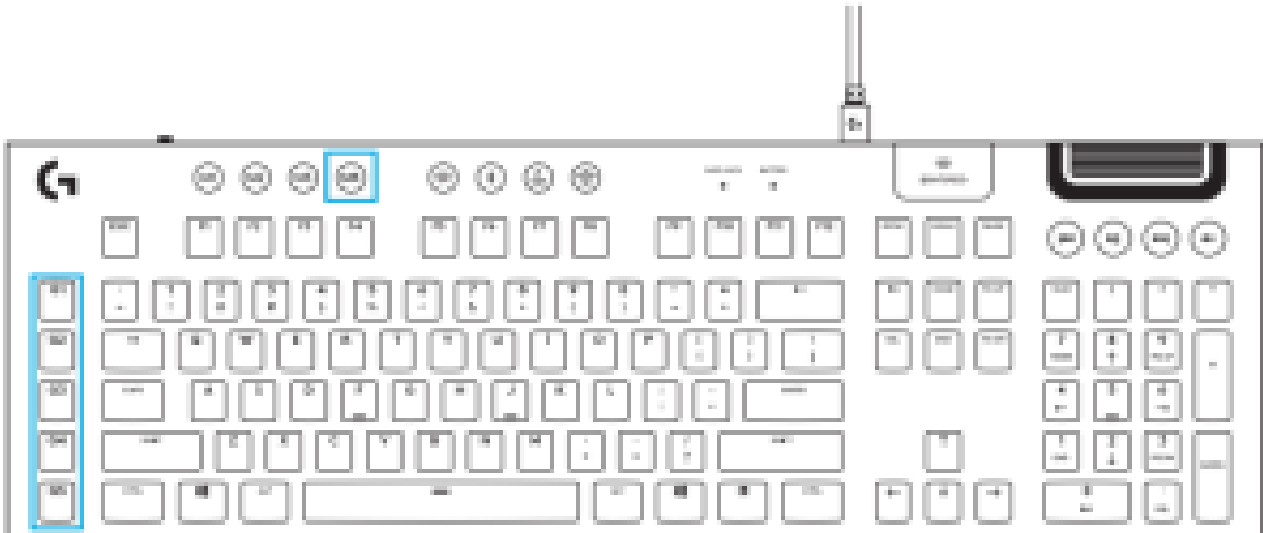

- 5 programmable G-keys and three M-keys provide up to 15 unique functions per game
- Customize the G-keys using Logitech G HUB Software
- To record a macro:

1. Press the MR key
2. Press a G-key
3. Type the keys to be recorded
4. Press the MR key
 - To record a second macro to the same G-key, press M2 and repeat steps 1–4
 - For a third macro, press M3 and repeat steps 1–4

Download and install Logitech G HUB software from logitechG.com/GHUB

GAME MODE BUTTON



This button disables the standard Windows key and Menu key to prevent the Windows Start menu from activating during a game, which might disrupt play. The game mode LED is lit during game mode.

KEYBOARD BACKLIGHTING



Adjust keyboard brightness by cycling the keyboard brightness button

ONBOARD MEMORY



Three onboard profiles can be saved to G913. The profiles are downloaded into the G913 through G HUB software, and are accessed by selecting M1, M2, or M3 when the keyboard is in Onboard mode (selected from G HUB software, or when G HUB software is off or not installed).

KEYBOARD FEATURES — MEDIA CONTROLS

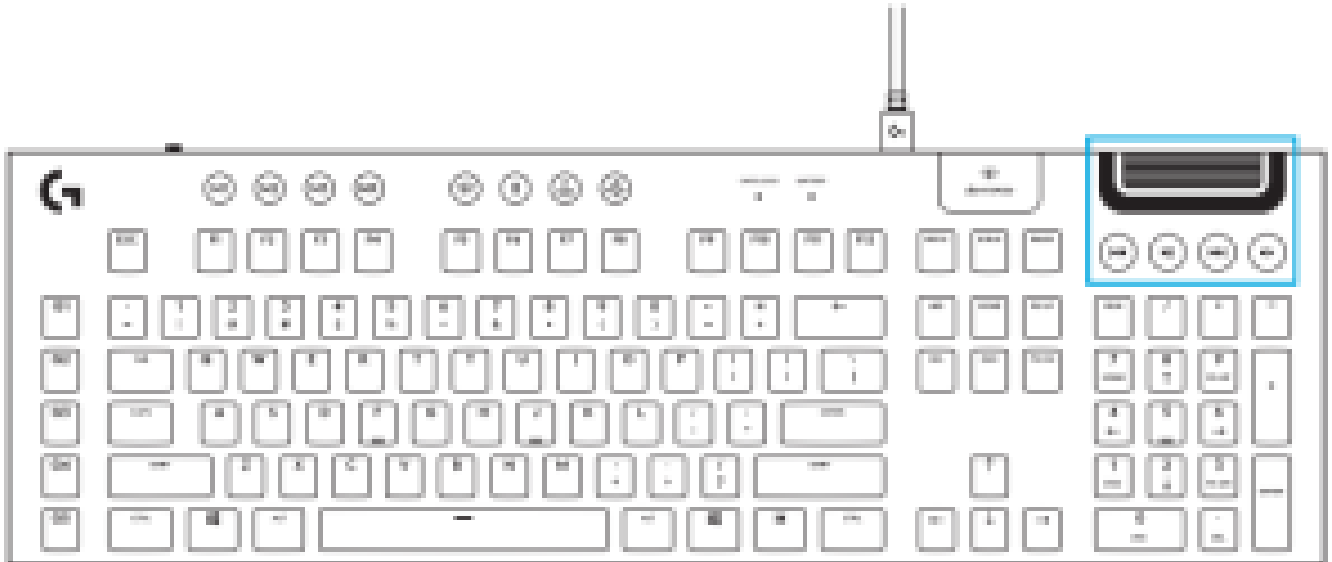

G913 has media controls, located in the upper right corner of the keyboard.

- Volume roller — controls the volume of the active audio on your PC
- Skip back — goes to the beginning of a track, or to a previous track, depending on the application
- Play/Pause — starts or stops the audio or video source playback
- Skip forward — goes to the end of the track or to the next track, depending on the application
- Mute — stop audio output

KEYBOARD FEATURES — BATTERY INDICATOR

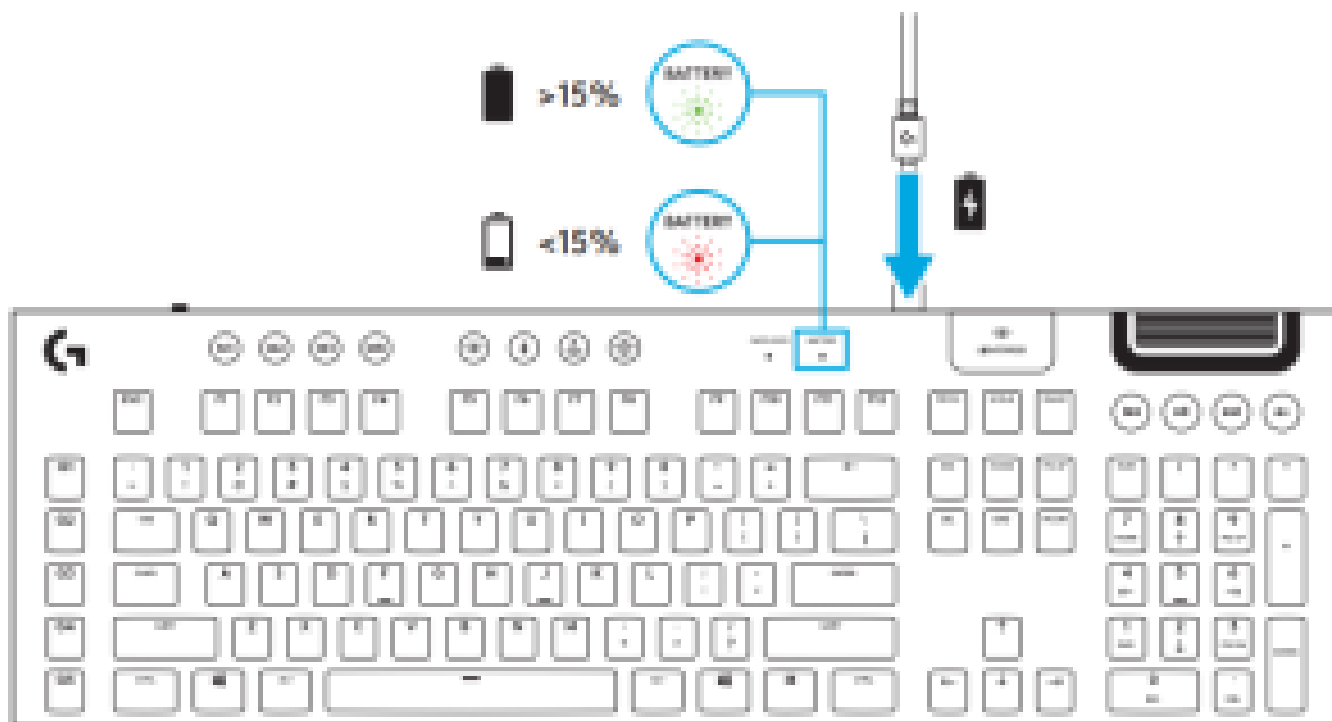

- Pulses green when charging
- Shows green momentarily when started when the battery is above 15%
- Shows red when the keyboard needs charging

KEYBOARD FEATURES — WIRELESS CONTROLS

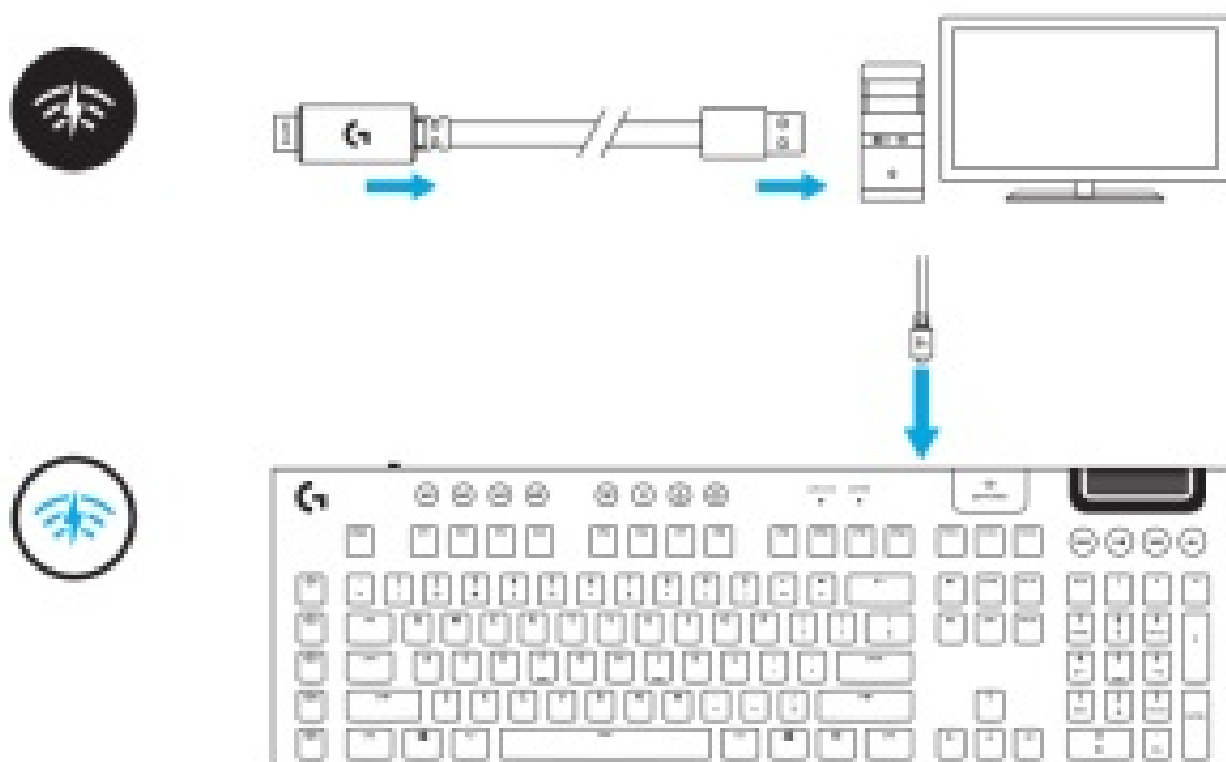

- LIGHTSPEED button selects LIGHTSPEED wireless connection, which connects to the PC or Mac using the included receiver dongle. It shows white when connected, blue when the wired connection

KEYBOARD FEATURES — BLUETOOTH®

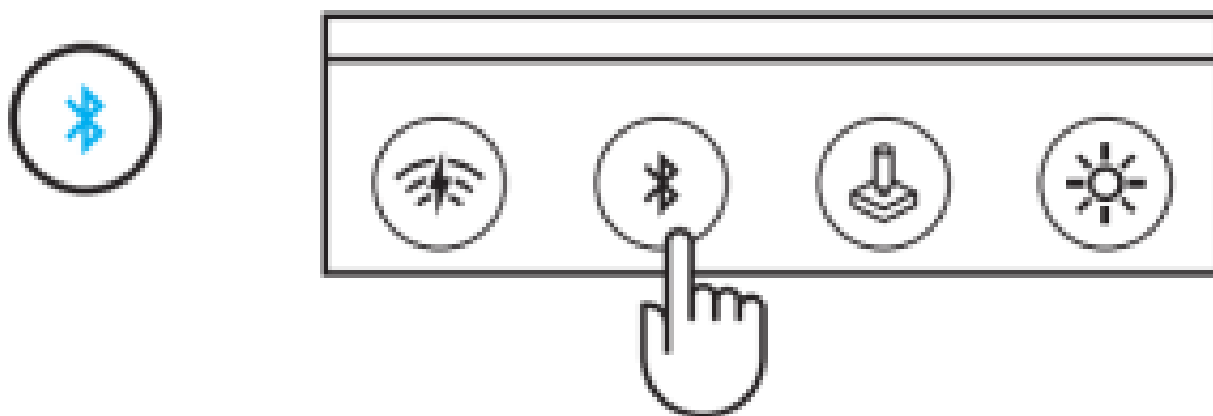

- Bluetooth button connects to devices via a Bluetooth connection. It shows blue when connected.

KEY CAP REMOVAL + REPLACEMENT

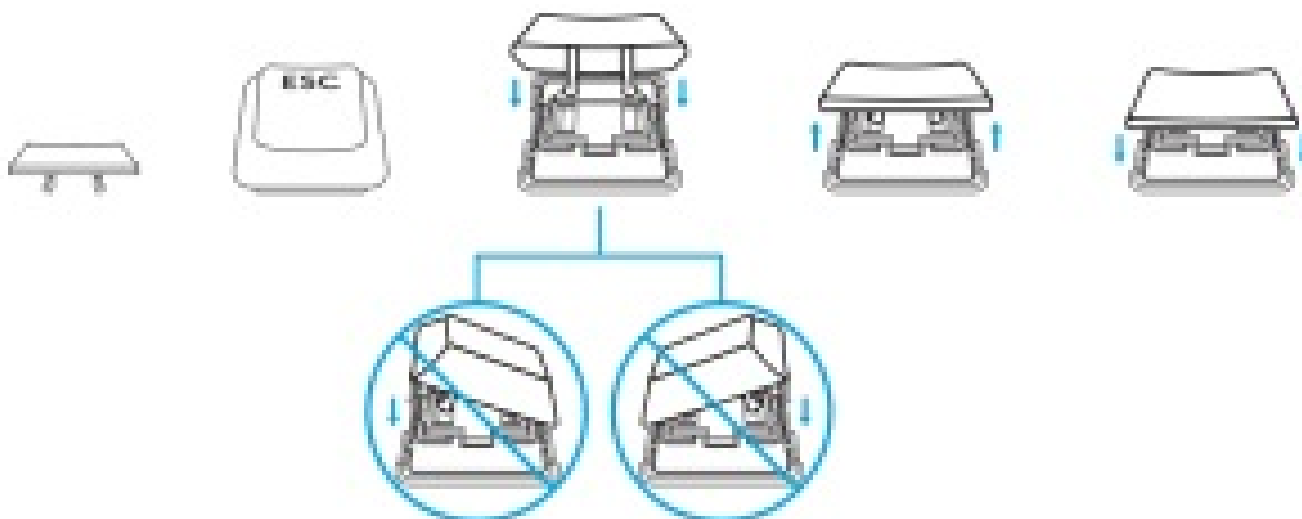

CARE AND CLEANING

To clean the keyboard, use a soft, lint-free, or microfiber cloth. A damp cloth can be used. Do not use harsh cleaning solutions. Do not immerse the keyboard or expose it to liquids.



logitechG.com/support/G913

© 2019 Logitech, Logi, and the Logitech Logo are trademarks or registered trademarks of Logitech Europe S.A. and/or its affiliates in the US and other countries. Logitech assumes no responsibility for any errors that may appear in this manual. Information contained herein is subject to change without notice.

Documents / Resources

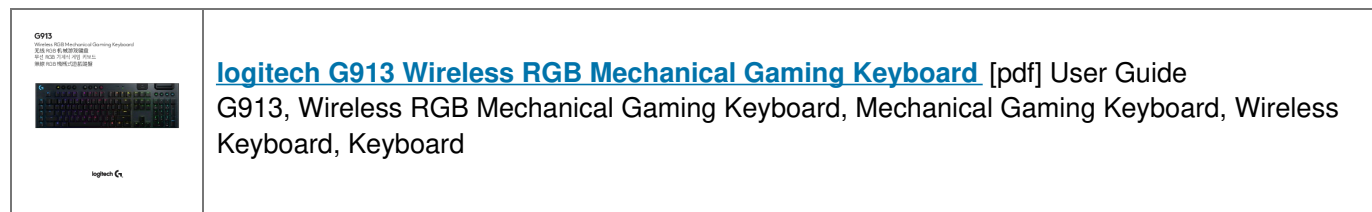

Manuals+,