



## Logitech G715 Manual: Set Up & Bluetooth Pairing Guide

[Home](#) » [Logitech](#) » Logitech G715 Manual: Set Up & Bluetooth Pairing Guide

The Logitech G715 Wireless Gaming Keyboard is a powerful and versatile keyboard that offers gamers a seamless and immersive gaming experience. The keyboard comes with a user guide that provides detailed instructions on how to set up and use the keyboard. The guide covers everything from setting up the keyboard to pairing it with Bluetooth® devices, charging it, and using its various features such as media controls, game mode, and onboard lighting effects. The guide also provides information on how to change the top plate of the keyboard and switch between Lightspeed wireless and Bluetooth® devices. With its advanced features and customizable settings, the Logitech G715 Wireless Gaming Keyboard is designed to meet the needs of even the most demanding gamers. Whether you're a professional gamer or a casual player, this keyboard is sure to enhance your gaming experience and take your skills to the next level.



### G715 KEYBOARD Wireless Gaming Keyboard SETUP GUIDE



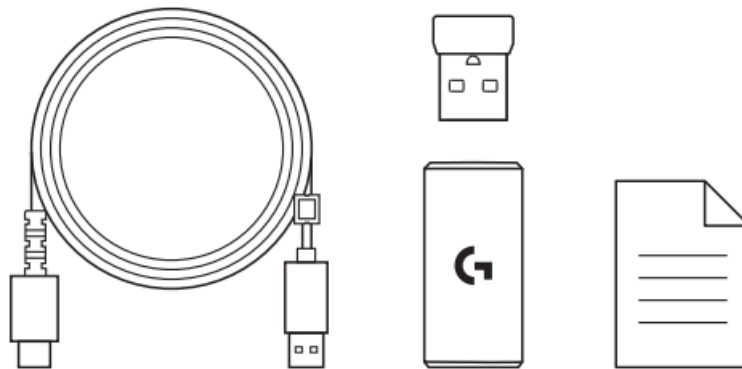
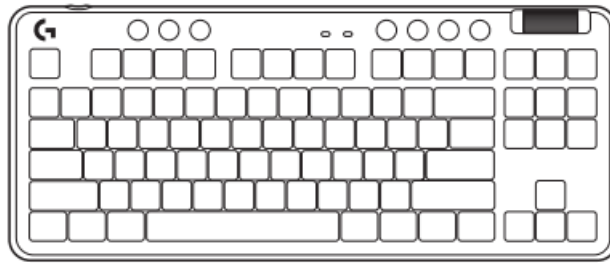

## Contents [ [hide](#) ]

- [1 SETUP INSTRUCTIONS](#)
- [2 BLUETOOTH® CONNECTIVITY](#)
- [3 CHARGING YOUR KEYBOARD](#)
- [4 Media Controls](#)
- [5 ONBOARD LIGHTING EFFECTS](#)
- [6 CHANGING THE TOP PLATE](#)
- [7 Specifications](#)
- [8 FAQ's](#)
- [9 Documents / Resources](#)
  - [9.1 References](#)
- [10 Related Posts](#)

## SETUP INSTRUCTIONS

1. Remove the LIGHTSPEED receiver from the storage slot.

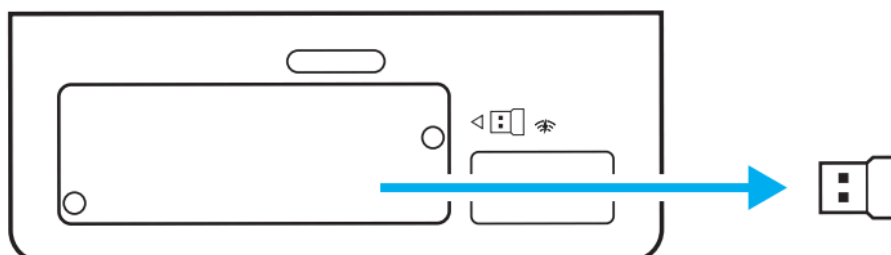

2. Insert the LIGHTSPEED receiver, with the extender and cable into the PC USB port. The receiver can be used without the extender and cable by inserting it directly into a USB port if desired.

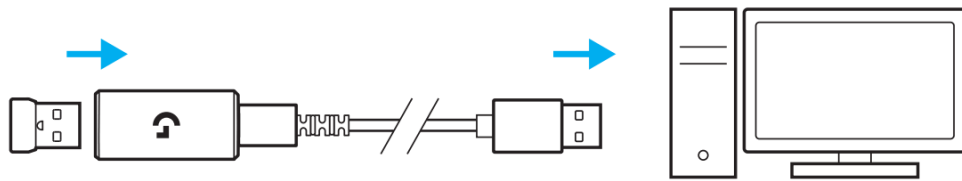

3. Turn on the keyboard by sliding the power button. The Connection button will light up to a cyan color.

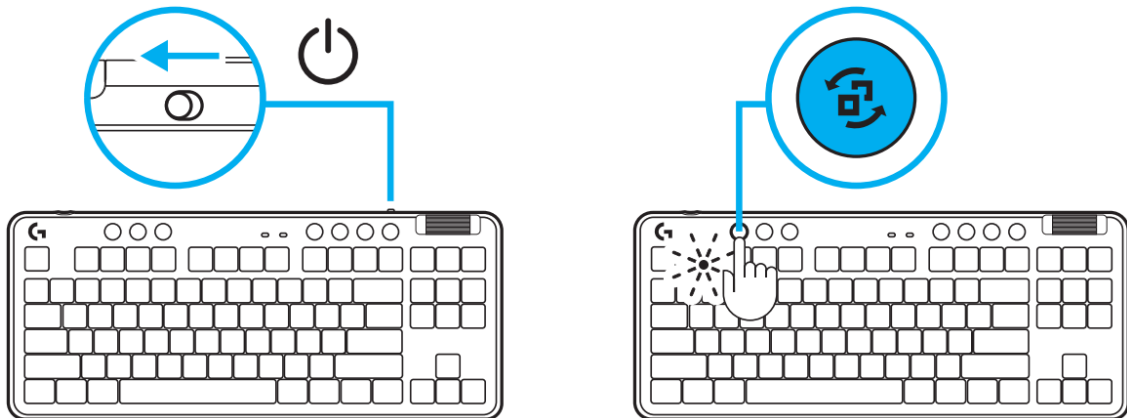

4. Download and install G HUB software to your PC/MAC for the best gaming experience (G HUB has an onboarding story for features). Go to [www.logitechG.com/ghub](http://www.logitechG.com/ghub)

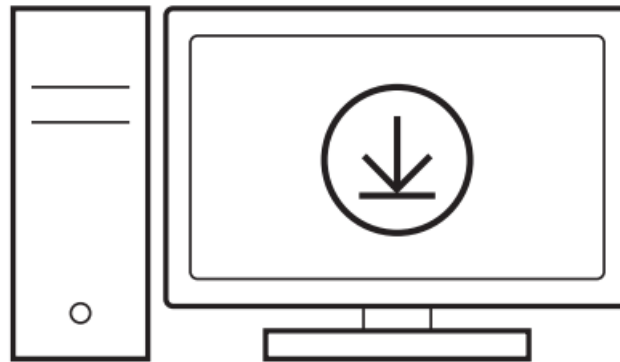

[www.logitechG.com/ghub](http://www.logitechG.com/ghub)

## BLUETOOTH® CONNECTIVITY

1. Turn on the keyboard by sliding the button.

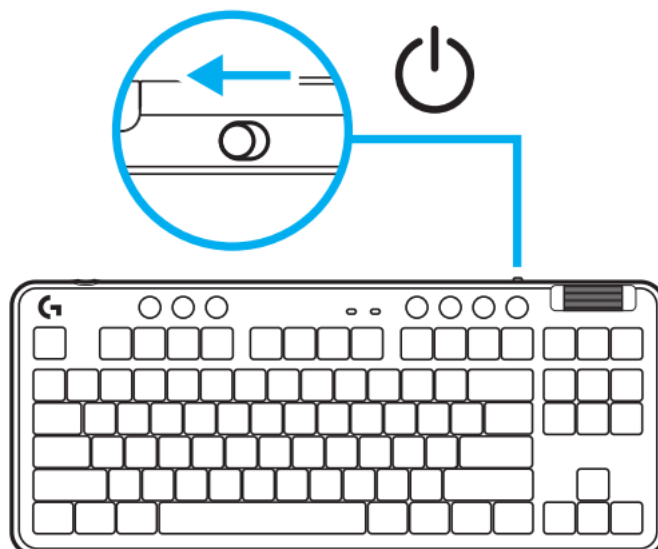

2. Press the Connection button to cycle to Bluetooth®. Light will turn to light blue and flash quickly – waiting to pair.

Follow Bluetooth® connection for your device to pair with the keyboard.

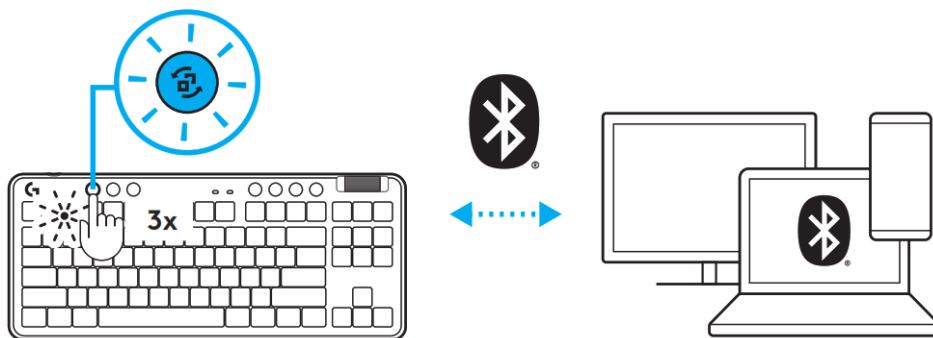

## CHARGING YOUR KEYBOARD

1. Insert the USB-C cable into the port at the front of the keyboard.
2. Connect the cable to your PC.

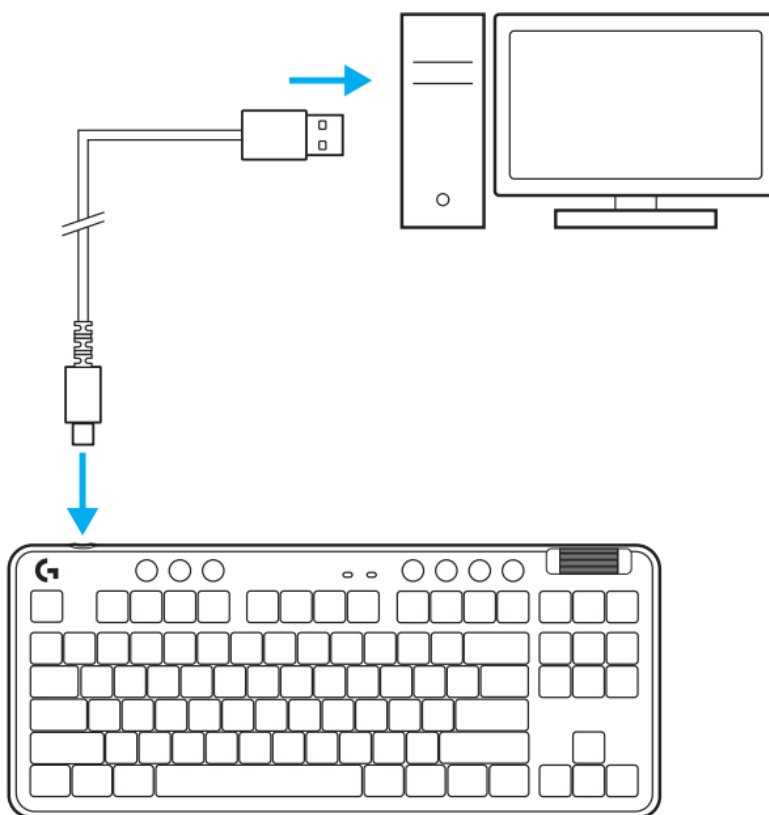

The battery indicator light will pulse green while charging and be solid green when fully charged.

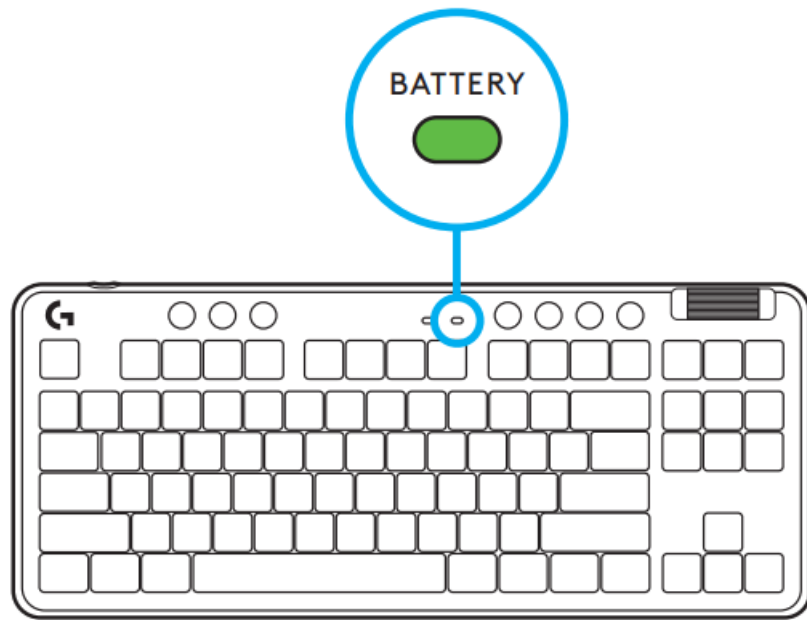

## Media Controls

G715 includes media controls. Skip back, play/pause, skip forward, and mute the key, with a volume roller that controls your device volume.

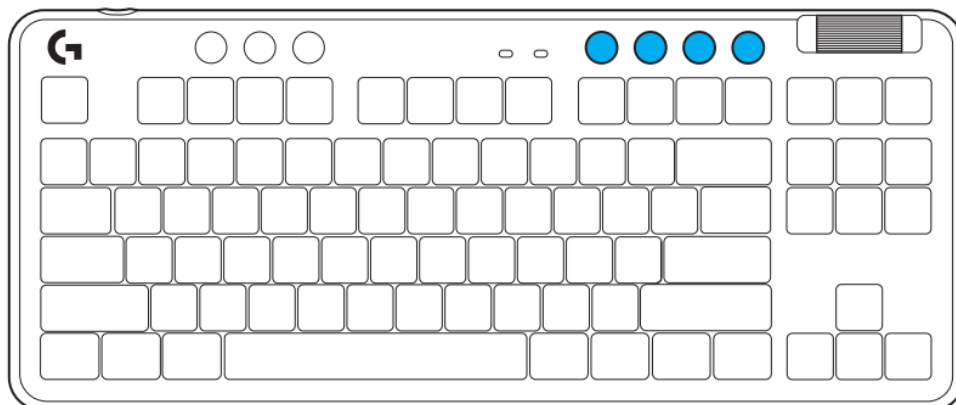

## Game Mode

Pressing the Game mode button blocks the Windows and Menu keys when pressed. additional keys can be blocked using G HUB software.

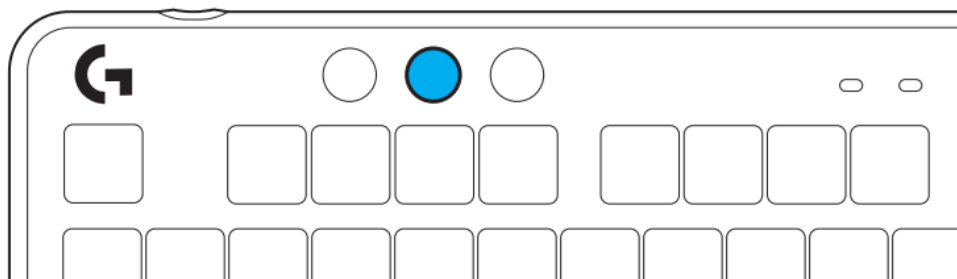

## Brightness

Adjust lighting brightness by pressing the brightness button.

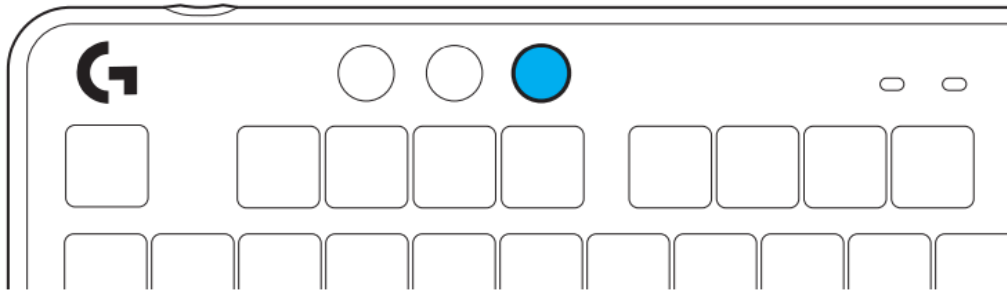

## ONBOARD LIGHTING EFFECTS

The keyboard has 8 different lighting effects stored in its onboard memory. You can select and modify these by pressing the Brightness button and these keys:

- Brightness + 1 = Rainbow > right**
- Brightness + 2 = Rainbow > left**
- Brightness + 3 = Rainbow center out**
- Brightness + 4 = Rainbow ^ up**
- Brightness + 5 = Color cycle**
- Brightness + 6 = Keystroke ripple**
- Brightness + 7 = Breathing cyan**
- Brightness + 8 = Custom lighting effect**
- Brightness + 9 = Custom lighting effect**
- Brightness + 0 = Solid cyan**
- Brightness + - = Animation slower**
- Brightness + = = Animation faster**

G HUB lighting controls will override these settings.

## CHANGING THE TOP PLATE

The top plate can be removed and replaced with optional accessory top plates.

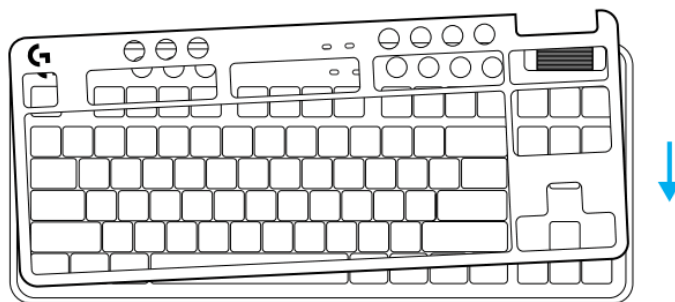
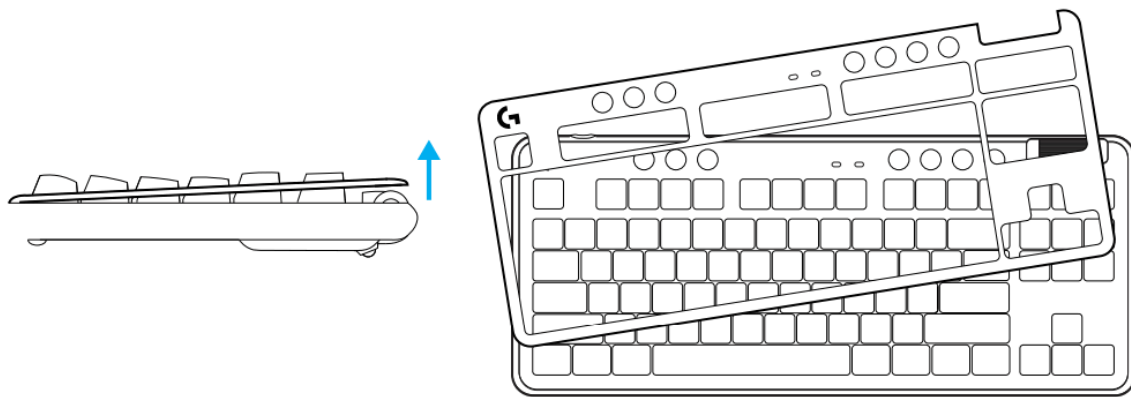

### **SWITCH BETWEEN LIGHTSPEED WIRELESS AND BLUETOOTH® DEVICES**

Once connected, press the connect button to toggle the connection. It will be a light cyan color for LIGHTSPEED, and a blue color for Bluetooth®

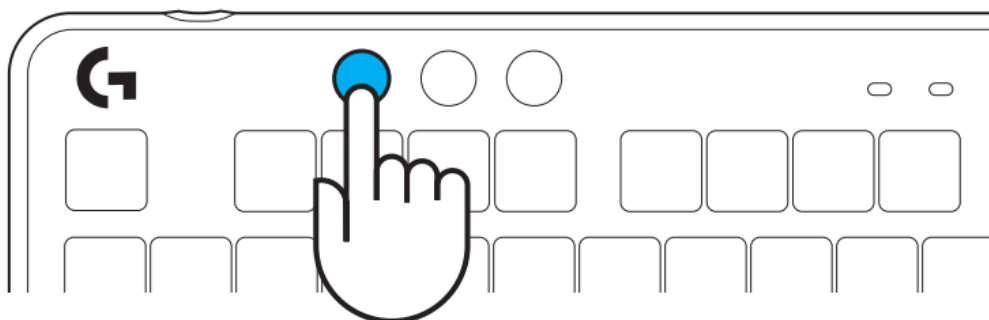

© 2022 Logitech. Logitech, Logitech G, Logi, and their respective logos are trademarks or registered trademarks of Logitech Europe S.A. and/or its affiliates in the U.S. and other countries. All other trademarks are the property of their respective owners. Logitech assumes no responsibility for any errors that may appear in this manual. Information contained herein is subject to change without notice. The Bluetooth® word mark and logos are registered trademarks owned by Bluetooth SIG, Inc. and any use of such marks by Logitech is under license.

**WEB-621-001990 002**

## **Specifications**

Product Specifications	Description
Product Name	Logitech G715 Wireless Gaming Keyboard
Connectivity	Bluetooth® and LIGHTSPEED wireless
Setup	Insert LIGHTSPEED receiver into PC USB port and turn on keyboard
G HUB Software	Download and install for best gaming experience
Charging	USB-C cable connected to PC
Media Controls	Skip back, play/pause, skip forward, mute, and volume roller
Game Mode	Blocks Windows and Menu keys, additional keys can be blocked using G HUB software
Brightness	Adjust lighting brightness with button
Onboard Lighting Effects	8 different lighting effects stored in onboard memory, can be modified with button and specific keys
Top Plate	Can be removed and replaced with optional accessory top plates
Switching between Bluetooth® and LIGHTSPEED wireless	Press connect button to toggle connection

## FAQ's

### How do I set up my Logitech G715 Wireless Gaming Keyboard?

To set up your Logitech G715 Wireless Gaming Keyboard, remove the LIGHTSPEED receiver from the storage slot, insert the LIGHTSPEED receiver into the PC USB port, turn on the keyboard by sliding the power button, and download and install G HUB software to your PC/MAC for the best gaming experience.

### How do I pair my Logitech G715 Wireless Gaming Keyboard with Bluetooth® devices?

To pair your Logitech G715 Wireless Gaming Keyboard with Bluetooth® devices, turn on the keyboard by sliding the button, press the Connection button to cycle to Bluetooth®, and follow Bluetooth® connection for your device to pair with the keyboard.



## How do I charge my Logitech G715 Wireless Gaming Keyboard?

To charge your Logitech G715 Wireless Gaming Keyboard, insert the USB-C cable into the port at the front of the keyboard, and connect the cable to your PC. The battery indicator light will pulse green while charging and be solid green when fully charged.

## What are the media controls on the Logitech G715 Wireless Gaming Keyboard?

The Logitech G715 Wireless Gaming Keyboard includes media controls that allow you to skip back, play/pause, skip forward, and mute the key, with a volume roller that controls your device volume.

## What is Game Mode on the Logitech G715 Wireless Gaming Keyboard?

Game Mode on the Logitech G715 Wireless Gaming Keyboard blocks the Windows and Menu keys when pressed. Additional keys can be blocked using G HUB software.

## How do I adjust the brightness of the Logitech G715 Wireless Gaming Keyboard?

To adjust the brightness of the Logitech G715 Wireless Gaming Keyboard, press the brightness button.

## What onboard lighting effects are available on the Logitech G715 Wireless Gaming Keyboard?

The Logitech G715 Wireless Gaming Keyboard has 8 different lighting effects stored in its onboard memory. You can select and modify these by pressing the Brightness button and specific keys.





## How do I change the top plate of my Logitech G715 Wireless Gaming Keyboard?

The top plate of the Logitech G715 Wireless Gaming Keyboard can be removed and replaced with optional accessory top plates.

## How do I switch between Lightspeed wireless and Bluetooth® devices on my Logitech G715 Wireless Gaming Keyboard?

Once connected, press the connect button to toggle the connection. It will be a light cyan color for LIGHTSPEED, and a blue color for Bluetooth®.

## Documents / Resources

	<a href="#">logitech G715 Wireless Gaming Keyboard</a> [pdf] User Guide G715, Wireless Gaming Keyboard, G715 Wireless Gaming Keyboard, Gaming Keyboard, Keyboard
	<a href="#">logitech G715 Wireless Gaming Keyboard</a> [pdf] User Guide G715 Wireless Gaming Keyboard, G715, Wireless Gaming Keyboard, Gaming Keyboard, Keyboard
	<a href="#">logitech G715 Wireless Gaming Keyboard</a> [pdf] User Guide G715, Wireless Gaming Keyboard, Gaming Keyboard, Wireless Keyboard, Keyboard, G715 Gaming Keyboard
	<a href="#">logitech G715 Wireless Gaming Keyboard</a> [pdf] User Guide G715, Wireless Gaming Keyboard, Gaming Keyboard, Wireless Keyboard, Keyboard, G715 Keyboard

## References

- [↩ Logitech G HUB Advanced Gaming Software, RGB & Game Profiles](#)
- [↩ Logitech G HUB Advanced Gaming Software, RGB & Game Profiles](#)