



logitech G713 Gaming Keyboard User Guide

[Home](#) » [Logitech](#) » logitech G713 Gaming Keyboard User Guide 



G713 KEYBOARD

CLAVIER G713

Corded Gaming Keyboard Clavier gaming filaire

SETUP GUIDE

GUIDE INSTALLATION



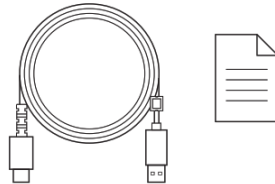
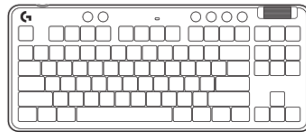

Contents

- [1 SETUP INSTRUCTIONS](#)
- [2 ONBOARD LIGHTING EFFECTS](#)
- [3 CHANGING THE TOP PLATE](#)
- [4 Documents / Resources](#)
 - [4.1 References](#)
- [5 Related Posts](#)

SETUP INSTRUCTIONS

1. Insert the USB-C cable into the port at the front of the keyboard. Connect the cable to your PC.

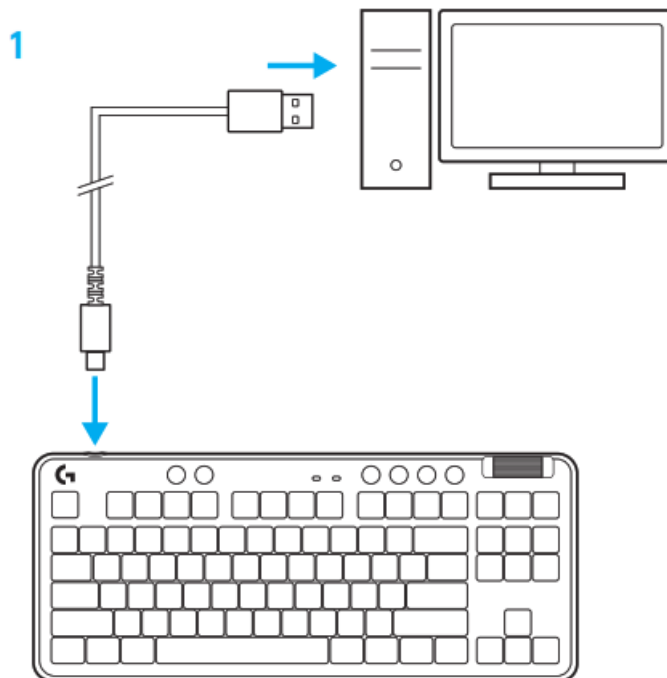

2. Download and install G HUB software to your PC/MAC for the best gaming experience (G HUB has an onboarding story for features). Go to www.logitechG.com/ghub

2

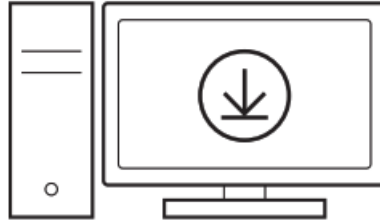

www.logitechG.com/ghub

Media Controls

G713 includes media controls. Skip back, play/ pause, skip forward and mute key, with a volume roller that controls your device volume.

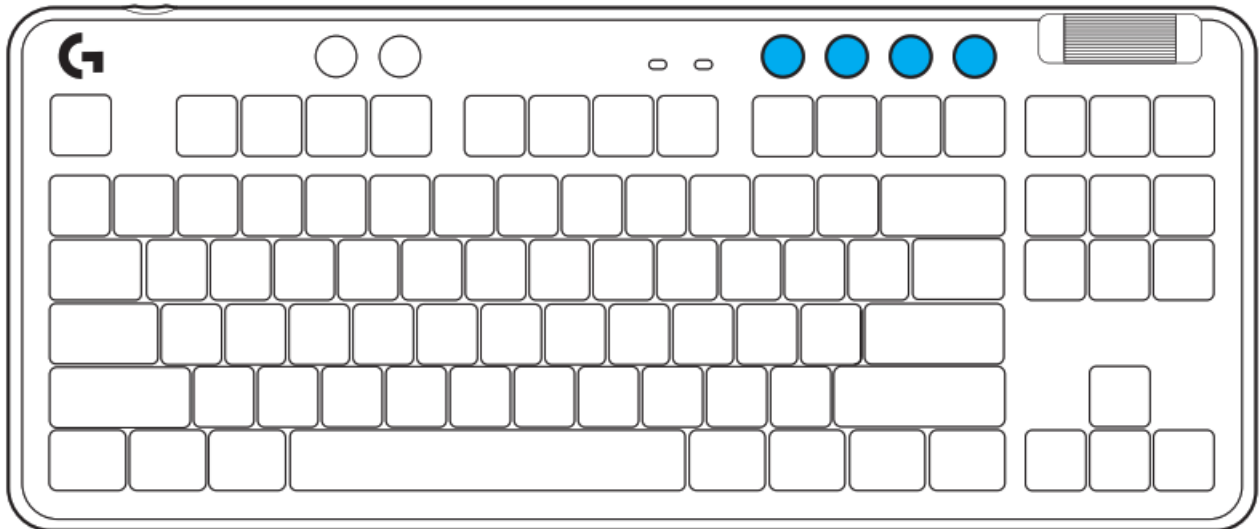

Game Mode

Pressing the Game mode button blocks the Windows and Menu keys when pressed. Additional keys can be blocked using G HUB software.

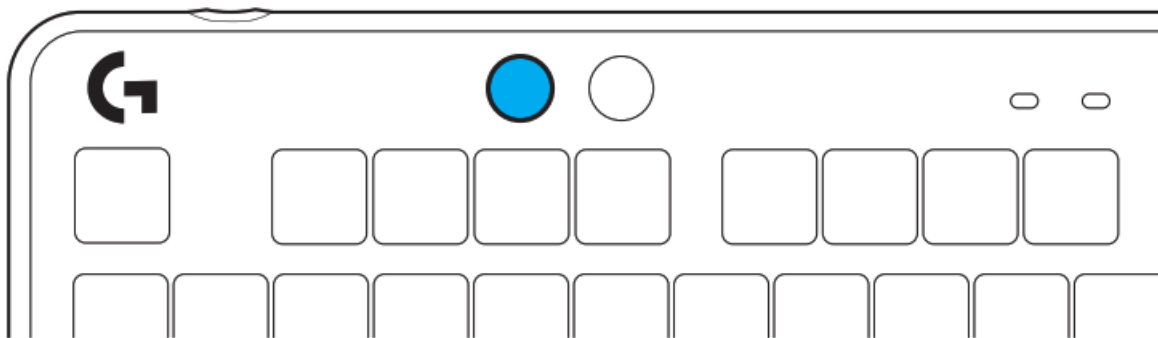

Brightness

Adjust lighting brightness by pressing the brightness button.

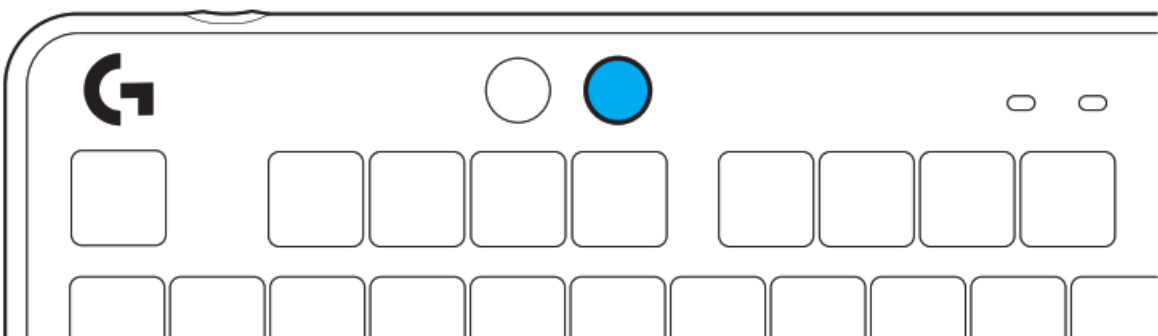

ONBOARD LIGHTING EFFECTS

The keyboard has 8 different lighting effects stored in its onboard memory. You can select and modify these by pressing the Brightness button and these keys:

Brightness + 1 = Rainbow > right

Brightness + 2 = Rainbow > left

Brightness + 3 = Rainbow center out

Brightness + 4 = Rainbow ^ up

Brightness + 5 = Color cycle

Brightness + 6 = Keystroke ripple

Brightness + 7 = Breathing cyan

Brightness + 8 = Custom lighting effect

Brightness + 9 = Custom lighting effect

Brightness + 0 = Solid cyan

Brightness + - = Animation slower

Brightness + = = Animation faster

G HUB lighting controls will override these settings.

CHANGING THE TOP PLATE

The top plate can be removed and replaced with optional accessory top plates.

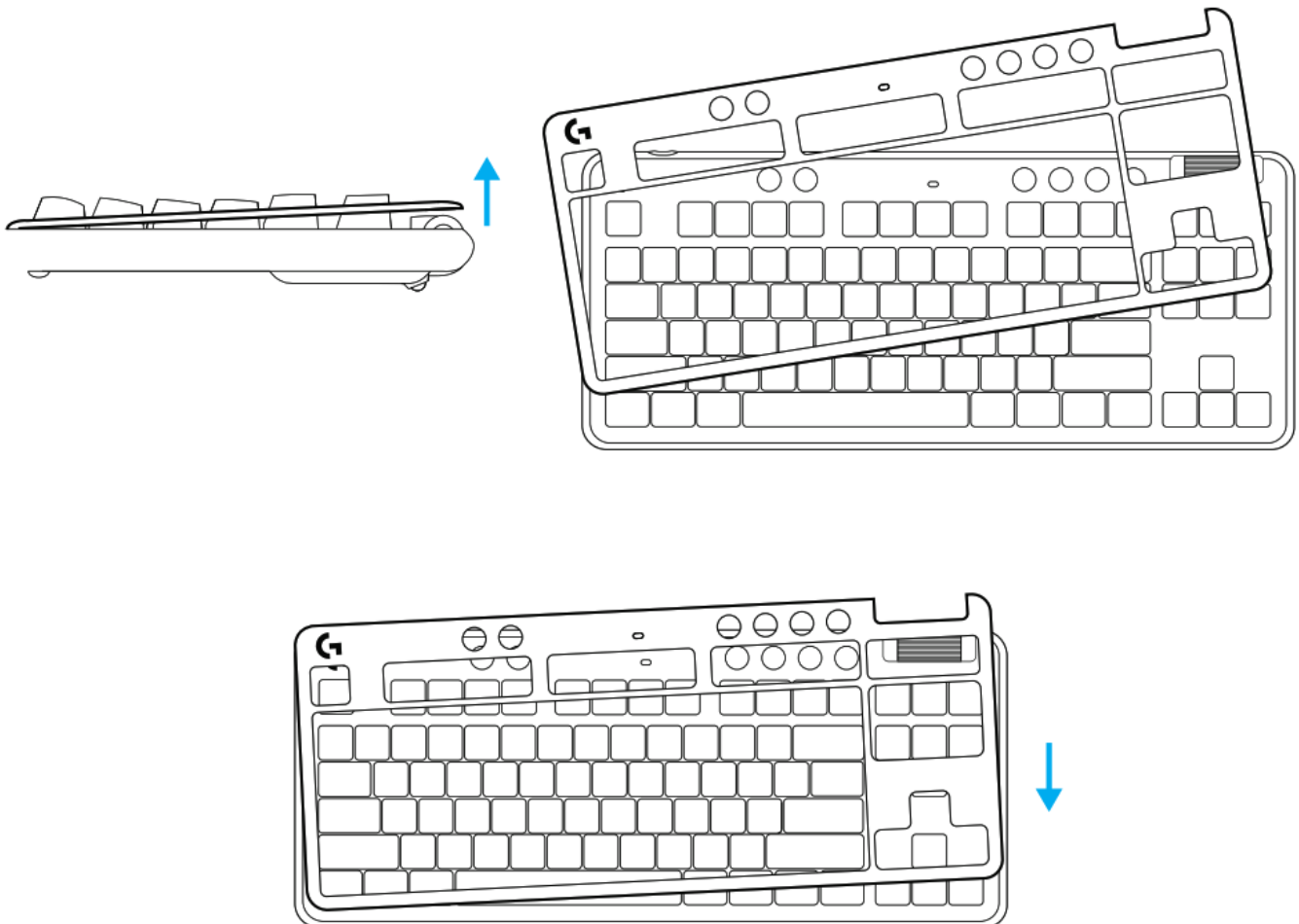

© 2022 Logitech. Logitech, Logitech G, Logi and their respective logos are trademarks or registered trademarks of Logitech Europe S.A. and/or its affiliates in the U.S. and other countries. All other trademarks are the property of their respective owners. Logitech assumes no responsibility for any errors that may appear in this manual. Information contained herein is subject to change without notice. WEB-621-001986 002

Documents / Resources

 <p>G713 KEYBOARD CLAVIER G713 CLAVIER G713 G713 KEYBOARD CLAVIER G713</p>	<p>logitech G713 Gaming Keyboard [pdf] User Guide</p> <p>G713, Gaming Keyboard, G713 Gaming Keyboard, Keyboard</p>
---	--

References

- [🔗 Logitech G HUB Advanced Gaming Software, RGB & Game Profiles](#)
- [🔗 Logitech G HUB Advanced Gaming Software, RGB & Game Profiles](#)