



logitech G203 LIGHTSYNC Gaming Mouse User Guide

[Home](#) » [Logitech](#) » logitech G203 LIGHTSYNC Gaming Mouse User Guide 



G102 | G203 LIGHT SYNC
Gaming Mouse
SETUP GUIDE





Contents

- [1 SETUP INSTRUCTIONS](#)
- [2 FULLY PROGRAMMABLE BUTTONS](#)
- [3 LIGHTSYNC RGB PROGRAMMABLE LIGHTING](#)
- [4 Documents / Resources](#)
 - [4.1 References](#)
- [5 Related Posts](#)

SETUP INSTRUCTIONS

Please read the instructions before operating the product.

1. Plug the mouse into the USB port.

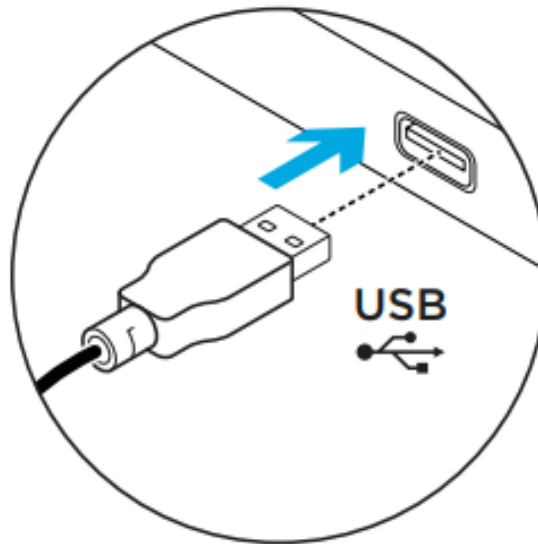

2. Download and install Logitech G HUB software from logitechG.com/GHUB.

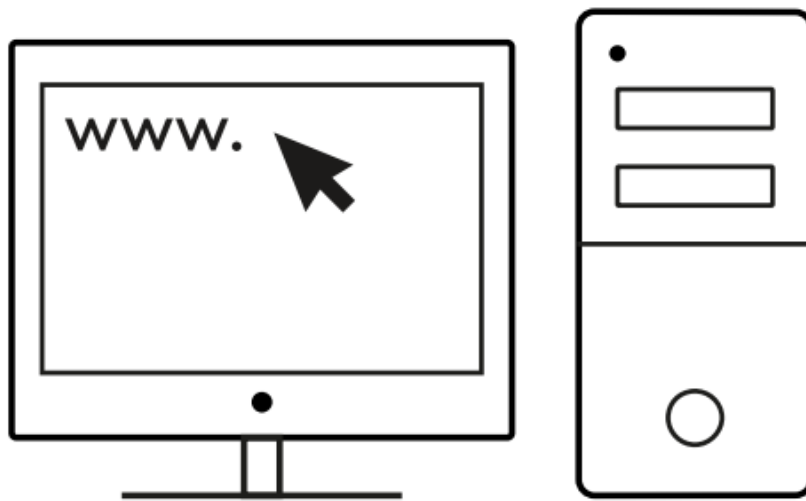

logitechG.com/GHUB

FULLY PROGRAMMABLE BUTTONS

By default these buttons are programmed:

1. Primary click
2. Secondary click
3. Wheel click
4. Forward
5. Back
6. DPI Cycle

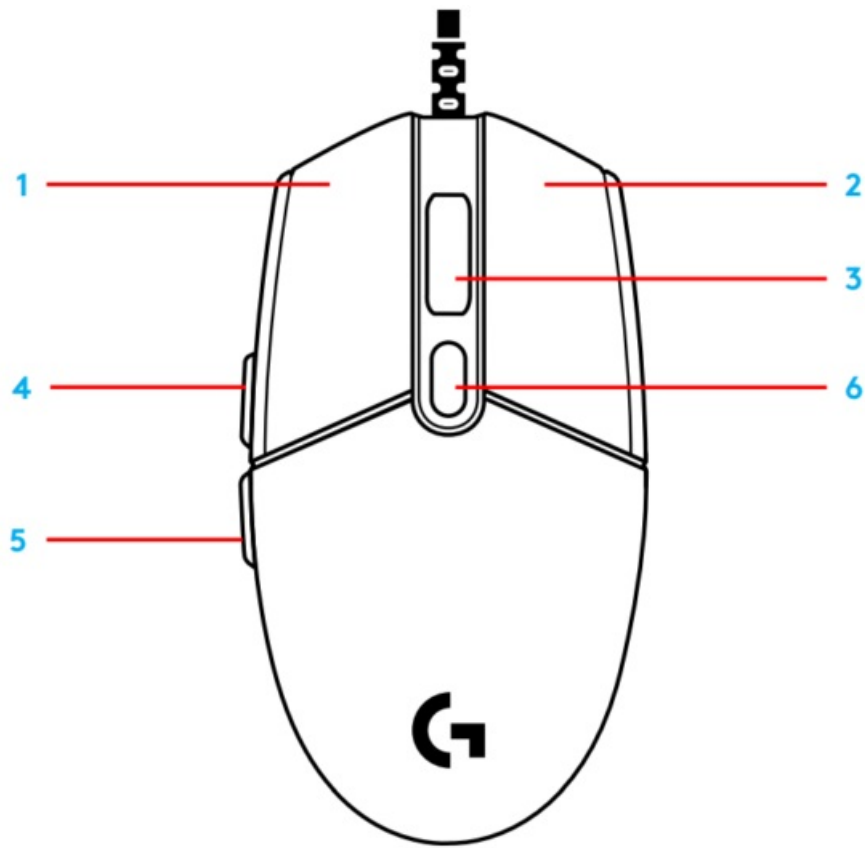

LIGHTSYNC RGB PROGRAMMABLE LIGHTING

G102 / G203 LIGHTSYNC has 3 independent lighting zones that can be customized using the Logitech G HUB software to a variety of solid colors or animated effects like a color cycle or breathing/pulsing.

Lighting can be synchronized with other supported Logitech G devices using the Logitech G HUB software.

Learn more: logitechG.com/GHUB



Logitech Europe S A and/or its affiliates in the US and other countries, All other trademarks are the property of their respective owners, Logitech assumes no responsibility for any errors that may appear in this manual Information contained herein is subject to change without notice

WEB-621-001681 002

Documents / Resources

	logitech G203 LIGHTSYNC Gaming Mouse [pdf] User Guide G203, G102, LIGHTSYNC Gaming Mouse
---	---

References

- [🔗 Logitech G HUB Advanced Gaming Software, RGB & Game Profiles](#)
- [🔗 Logitech G HUB Advanced Gaming Software, RGB & Game Profiles](#)