



LOGIC Portos MIDI Concept Computer Case Installation Guide

[Home](#) » [Logic](#) » LOGIC Portos MIDI Concept Computer Case Installation Guide 

Contents

- [1 LOGIC Portos MIDI Concept Computer Case](#)
- [2 Features](#)
- [3 Accessory Kit Contents](#)
- [4 Panel I/O](#)
- [5 Specifications](#)
- [6 Assembly Instruction](#)
- [7 Quick start guide/installation](#)
- [8 Documents / Resources](#)
 - [8.1 References](#)
- [9 Related Posts](#)



LOGIC Portos MIDI Concept Computer Case



Features

1. Tempered glass side panel door
2. PSU Dust Filter
3. PCI-E Back Cover
4. Top Dust Filter
5. SSD Tray
6. Right Side Panel
7. HDD/SSD cage

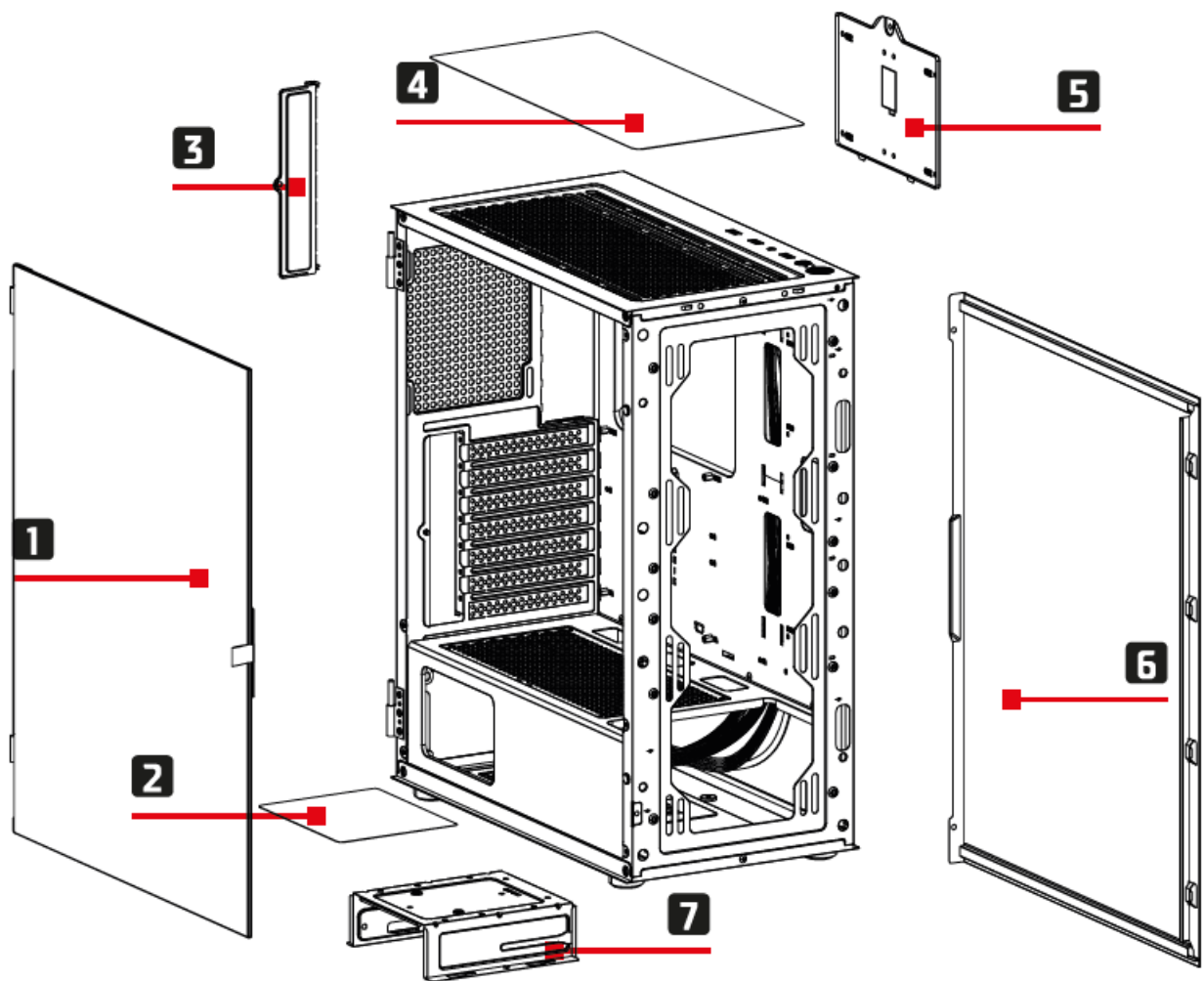

Accessory Kit Contents

1. Motherboard screws
2. HOD screws
3. PSU screws
4. Standoffs
5. Cable ties
6. HOD cage slide rail screws

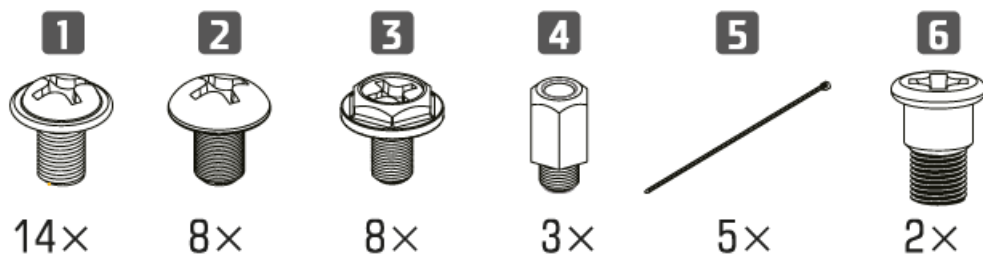

Panel I/O

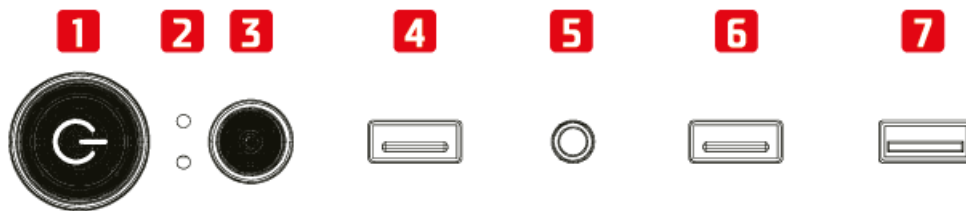

1. Power
2. HOD/ Power LED
3. Reset
4. USB 2.0
5. Headphones/ MIC
6. USB 2.0
7. USB 3.0

Specifications

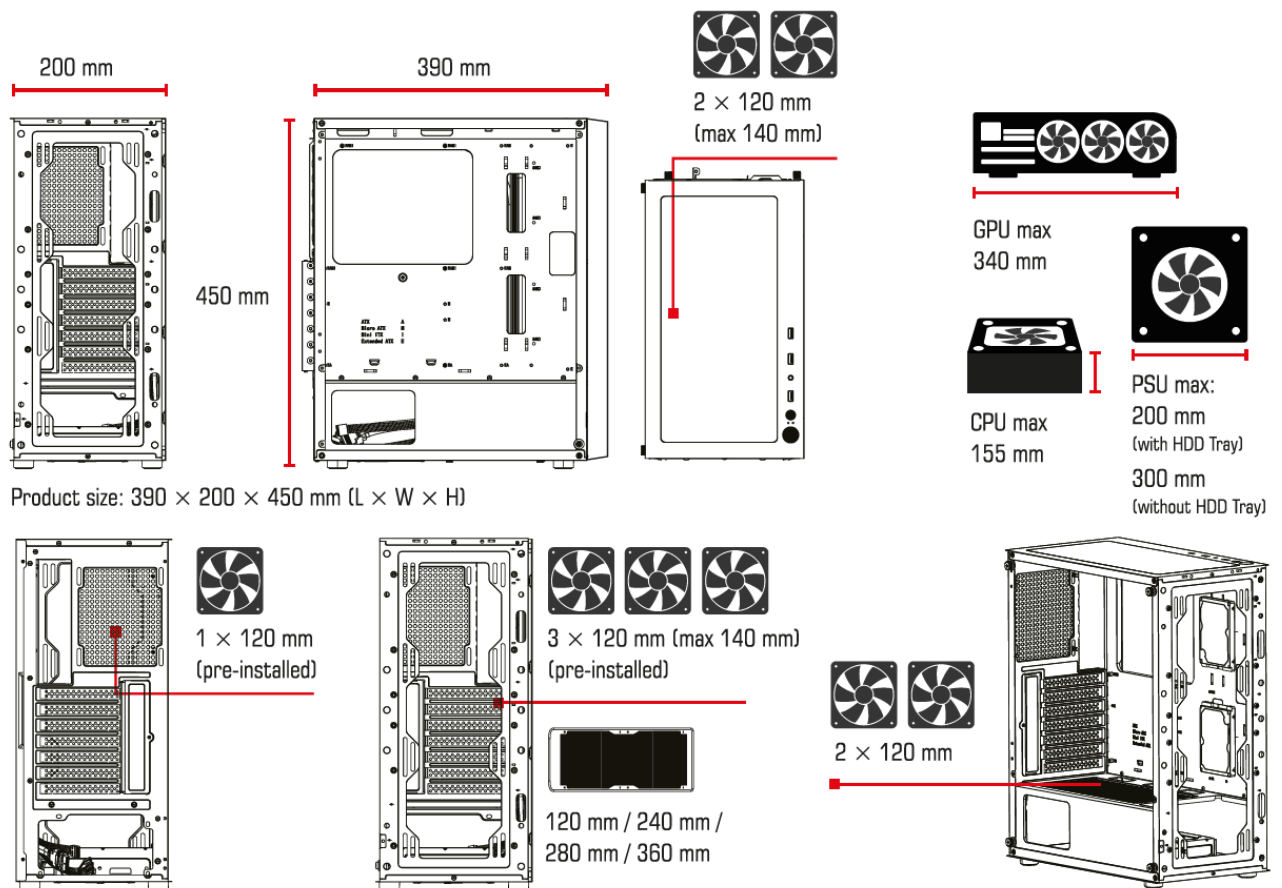

Assembly Instruction

Removing side panels

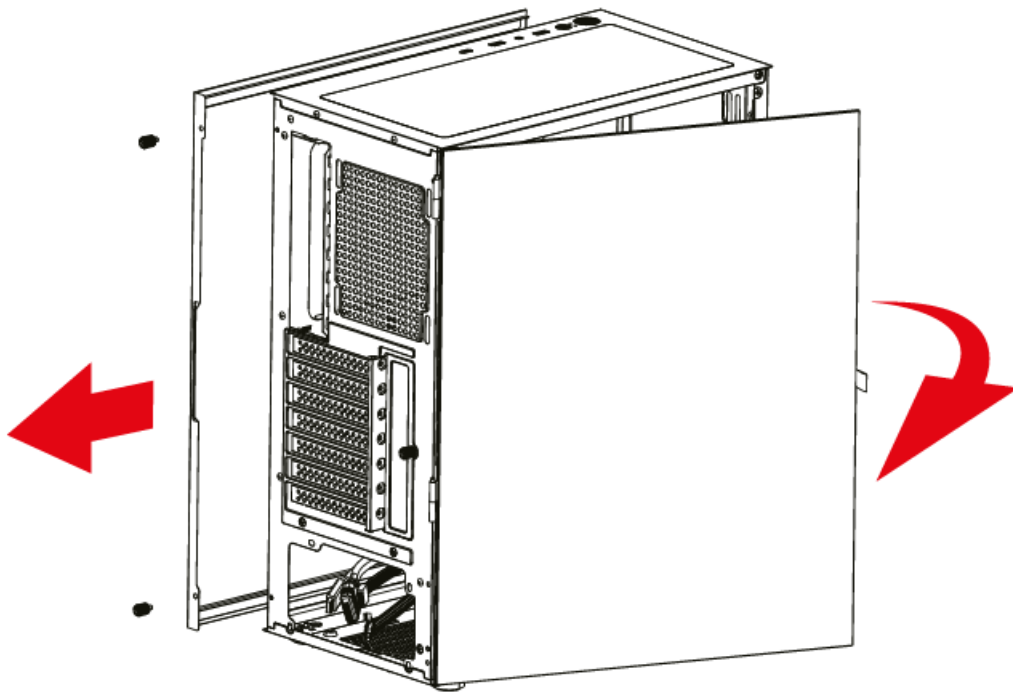

- 1 x Tempered Glass
- 1 x Metal Panel

Installing motherboard

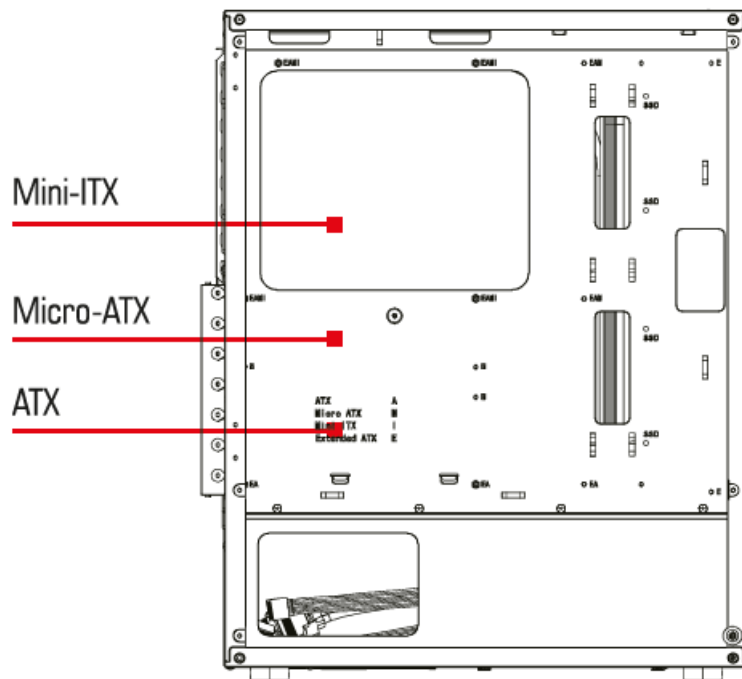

- **Motherboard Support:** ATX / Micro-ATX / Mini-ITX

Installing 3,5" HDDs

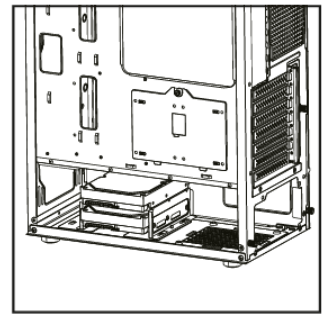
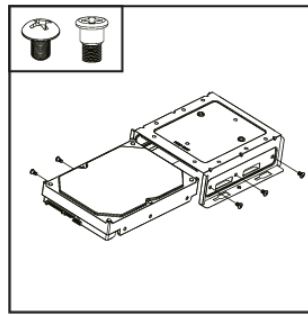
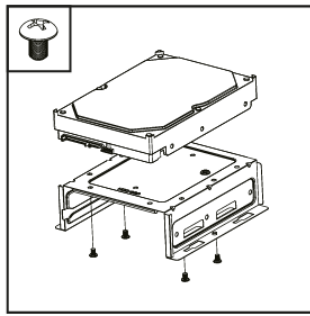
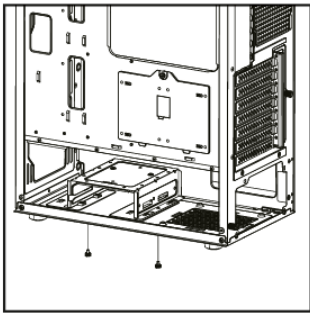

Installing 2.5" SSDs

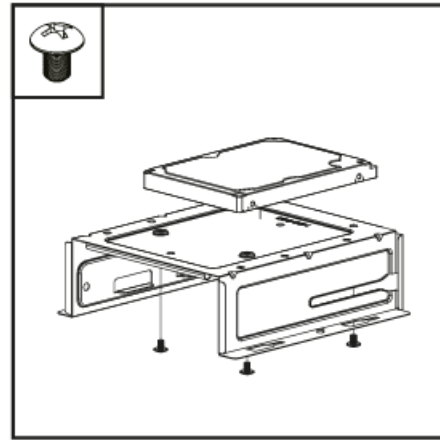
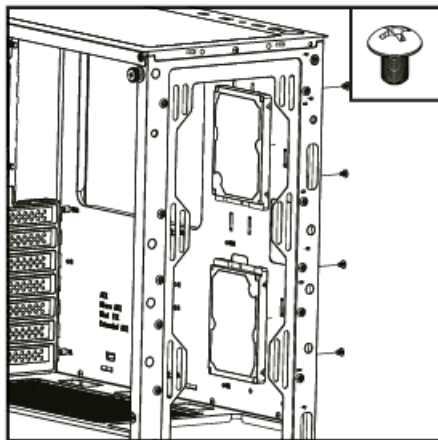
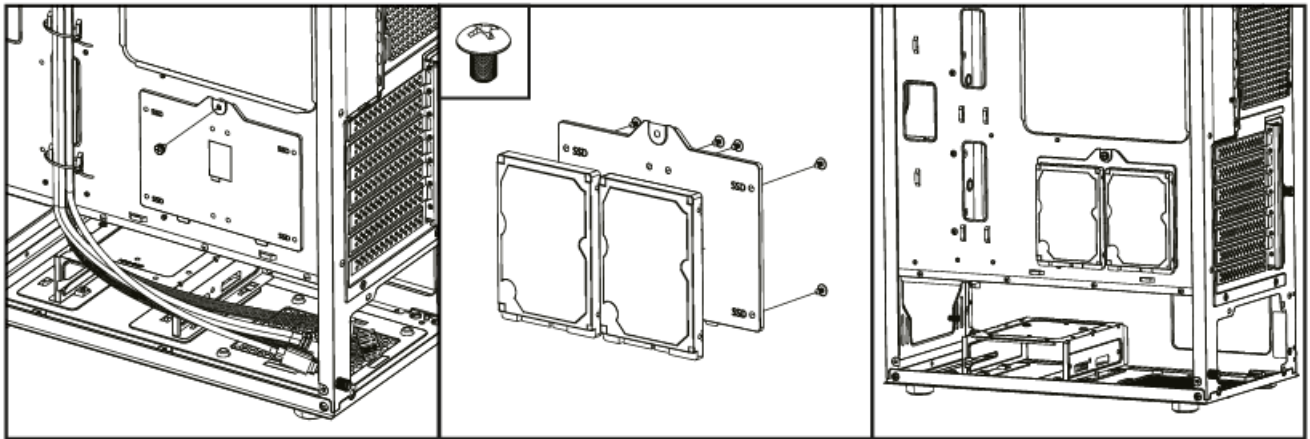

Installing the GPU

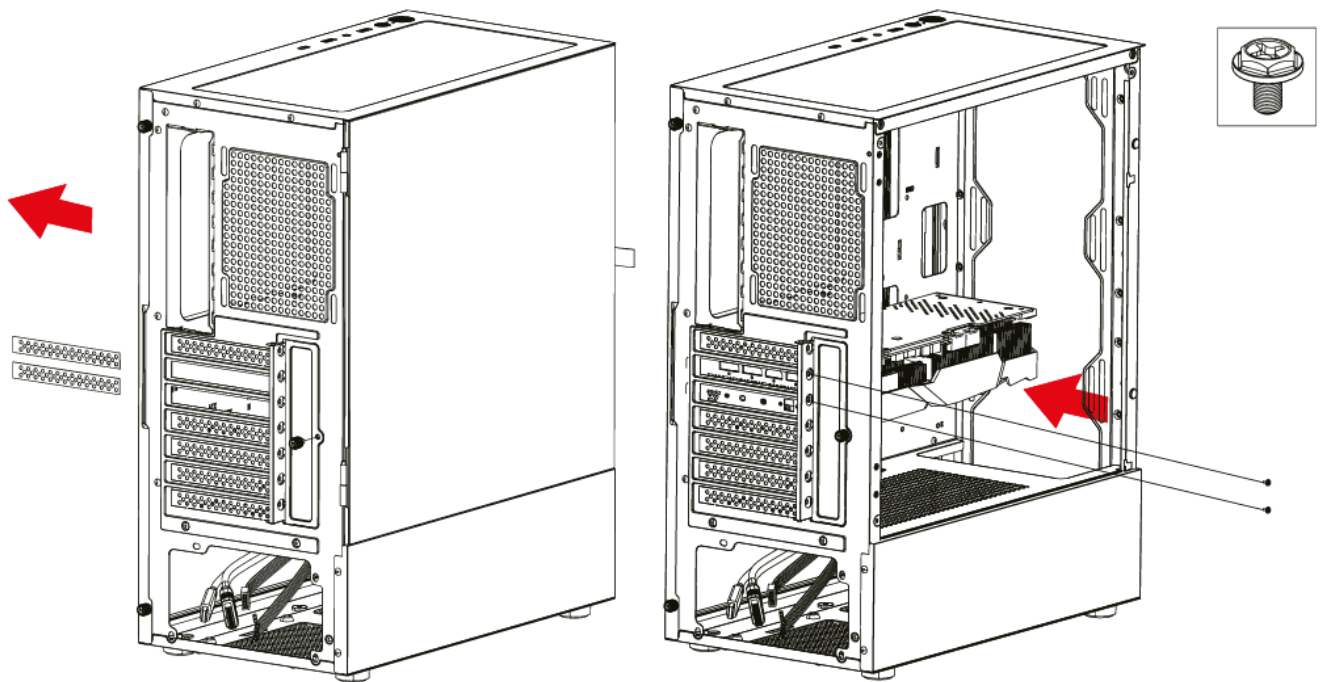

Installing the Power Supply

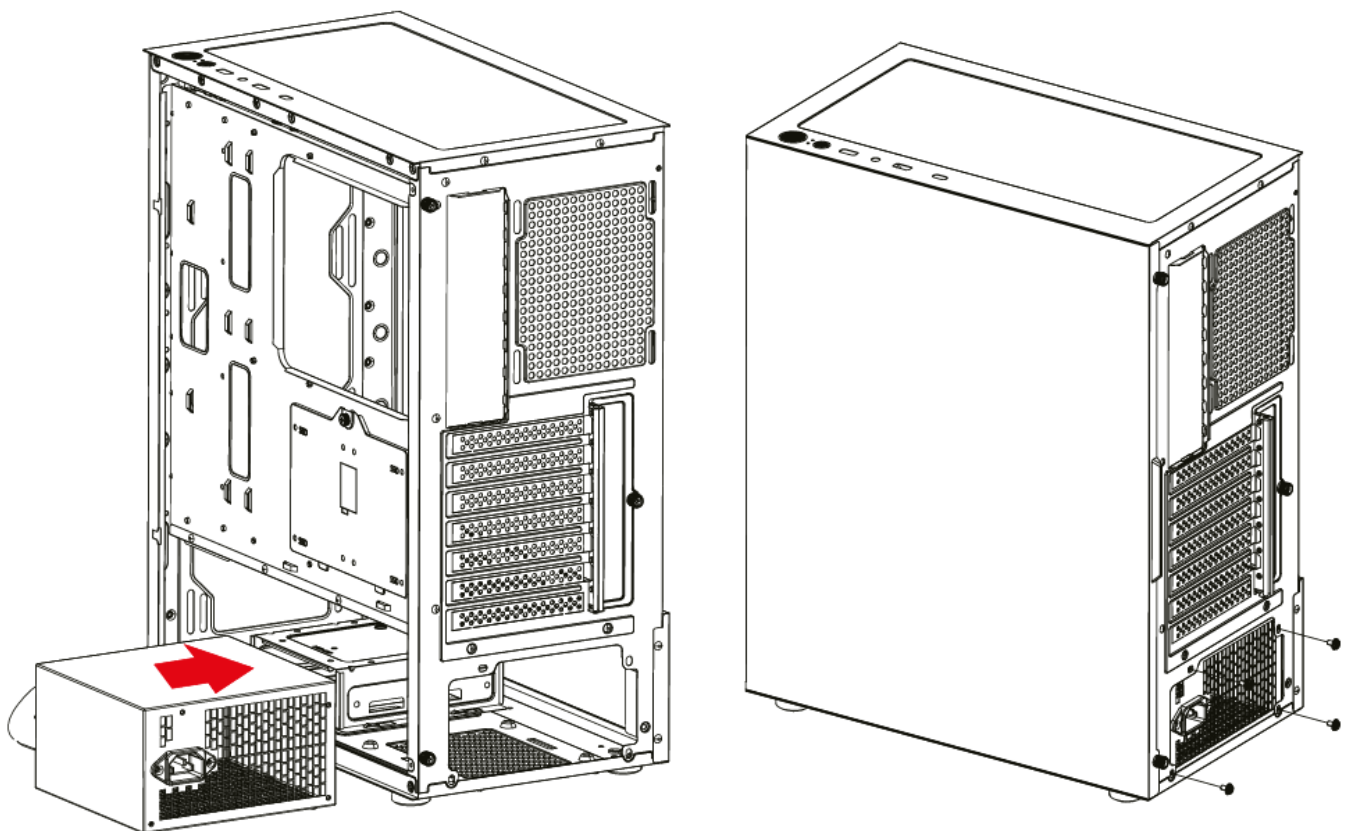

Quick start guide/installation

1. Open the housing.
2. Install all computer components following the instructions in the individual assembly instructions for each component.
3. Mount in the housing and connect the power supply to the required components, following the installation instructions of the power supply and the instructions of the components that require its connection. The power

supply is mounted in a tunnel, in the lower part of the case, with the fan facing outside the case (down).

4. Check the correct assembly of components and the connection of power plugs.
5. Close the housing.
6. Connect the monitor, keyboard, and other accessories to the computer.
7. Connect the power cord to the socket in the power supply and the 230V mains socket.
8. Set the power switch on the PSU housing to the I position (if present).

This device was designed and U made of high-quality reusable materials and components. If the device, its packaging, user's manual, etc. are marked with crossed waste containers, it means they are subject to segregated household waste collection in compliance with the Directive 2012/19/UE of the European Parliament and the Council. This marking informs that electric and electronic equipment shall not be thrown away together with household waste after it's been utilized. The user is obliged to bring the utilised equipment to the electric and electronic waste collection point. Those running such collection points, including local collection points, shops, or commune units, provide a convenient system enabling to scrapping of such equipment. Appropriate waste management aids in avoiding consequences that are harmful to people and the environment and result from dangerous materials used in the device, as well as improper storage and processing. Segregated household waste collection aids recycle materials and components of which the device was made. A household plays a crucial role in contributing to recycling and reusing the waste equipment. This is the stage where the basics are shaped which largely influences the environment being our common good. Households are also one of the biggest users of small electrical equipment. Reasonable management at this stage aids and favors recycling. In the case of improper waste management, fixed penalties may be imposed in accordance with national legal regulations.

Documents / Resources

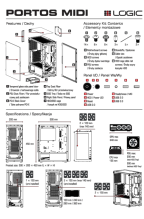
	<p>LOGIC Portos MIDI Concept Computer Case [pdf] Installation Guide Portos MIDI, Portos MIDI Concept Computer Case, Concept Computer Case, Computer Case, Case</p>
---	--

References

- [User Manual](#)