



Lofree XVZQ49 Touch 68 Triple Mode Connection Mechanical Keyboard User Manual

[Home](#) » [Lofree](#) » Lofree XVZQ49 Touch 68 Triple Mode Connection Mechanical Keyboard User Manual 

Contents

- [1 Lofree XVZQ49 Touch 68 Triple Mode Connection Mechanical Keyboard](#)
- [2 Product Information](#)
- [3 Product Usage Instructions](#)
- [4 SPECIFICATIONS](#)
- [5 FEATURE DESCRIPTION](#)
- [6 Detailed user guide](#)
- [7 System Switch](#)
- [8 Multimedia and function keys](#)
- [9 NAME AND CONTENT OF HAZARDOUS SUBSTANCES IN PRODUCT](#)
- [10 FCC Statement](#)
- [11 Documents / Resources](#)
- [12 Related Posts](#)

Lofree

Lofree XVZQ49 Touch 68 Triple Mode Connection Mechanical Keyboard



Product Information

TOUCH 68 Triple Mode Connection Mechanical Keyboard

- The TOUCH 68 Triple Mode Connection Mechanical Keyboard is a product manufactured by SHENZHEN LOFREE CULTURE CO., LTD. It comes in two models, OE902 and OE912.
- This keyboard is designed to work in three different modes: Bluetooth mode, wired mode, and wireless mode. It can be connected to devices such as laptops, desktops, tablets, and smartphones.
- The TOUCH 68 keyboard has a sleek and compact design with round keycaps and a vintage-inspired look. It also features a built-in rechargeable battery that can last up to 3 months on a single charge.
- This product complies with FCC radiation exposure limits set forth for an uncontrolled environment. It is important to note that this transmitter must not be co-located or operating in conjunction with any other antenna or transmitter.

Product Usage Instructions

To use the TOUCH 68 keyboard, follow the steps below:

1. **Bluetooth Mode:** Turn on Bluetooth on your device and press the Bluetooth button on the keyboard. The Bluetooth indicator light will start flashing. Select "Touch 68" from the list of available devices on your device's Bluetooth settings menu. Once connected, the Bluetooth indicator light will stop flashing.
2. **Wired Mode:** Connect one end of the USB cable to the keyboard and the other end to your device's USB port. The wired mode will be activated automatically.
3. **Wireless Mode:** Connect the USB receiver to your device's USB port. Turn on the keyboard and press the wireless button. The wireless indicator light will start flashing. Once connected, the wireless indicator light will stop flashing.

When using the TOUCH 68 keyboard, make sure to keep it away from other antennas or transmitters to avoid interference. To charge the keyboard, connect it to a power source using the USB cable provided.

SPECIFICATIONS

- **Number of keys:** 68(hot-swappable Mechanical Switch)
- **Number of Multimedia Keys:** 12
- **Materials:** ABS Body, PBT Keycaps
- **Interface:** Type-C
- **Mode:** 2,4G & Bluetooth & Wired
- **Device Name:** Touch68@Lofree
- **Dimensions:** 310mm109mm"5L5mm

FEATURE DESCRIPTION

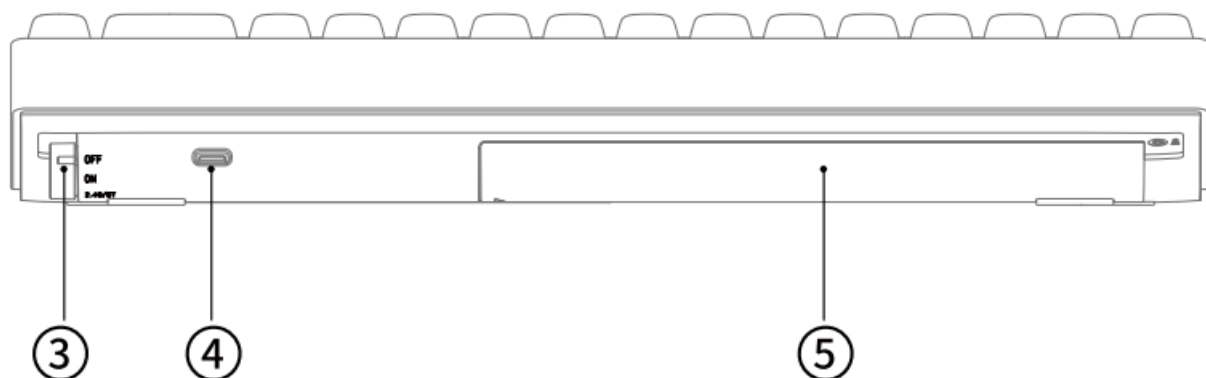
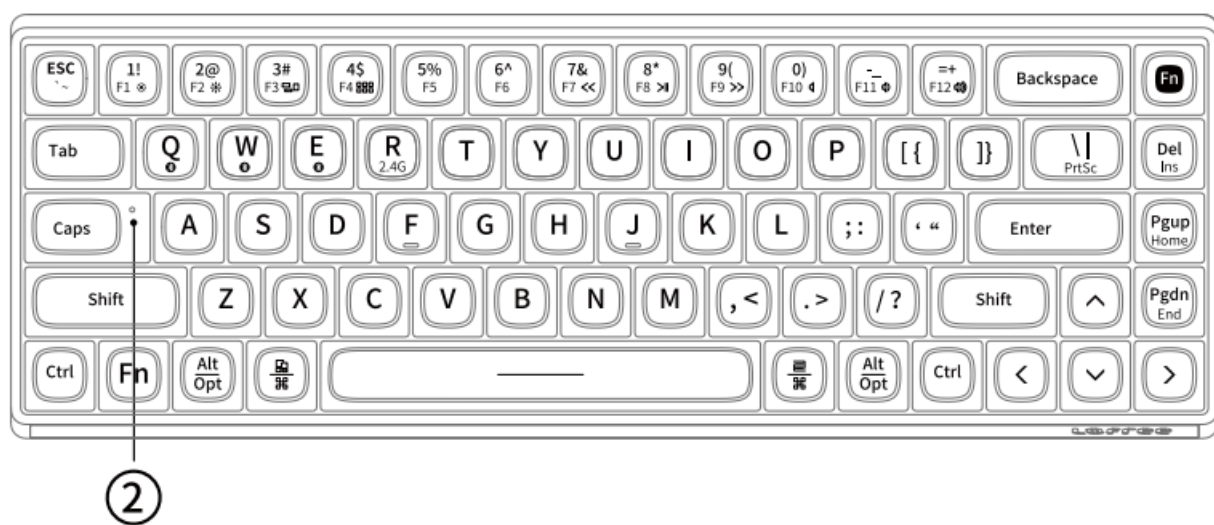
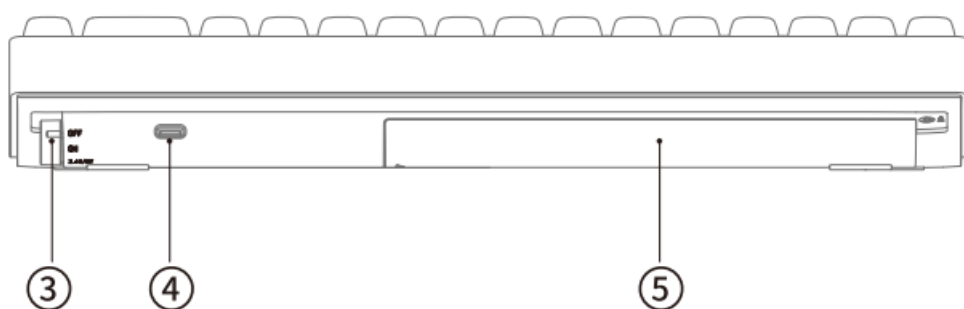
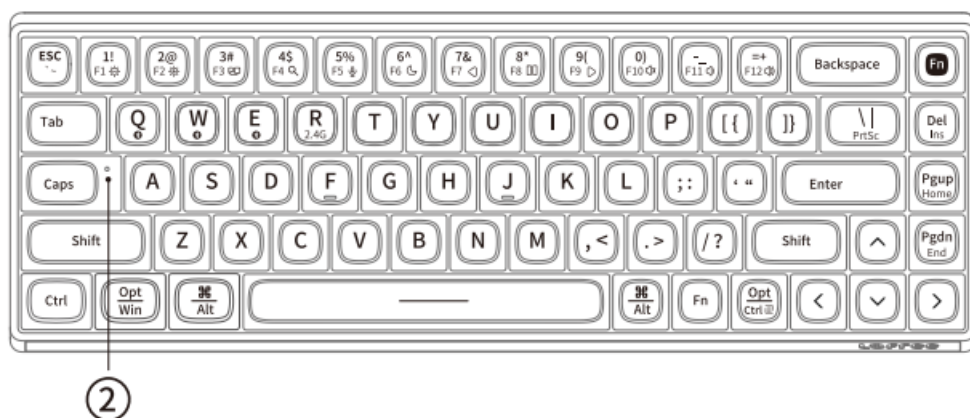
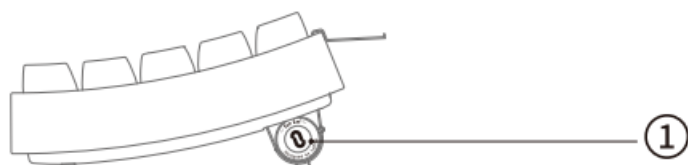

1. Battery Indicator

1. **Wired Mode** the indicator light is steady white. Bluetooth Mode/2.4G Wireless USB mode.

When the power is lower than 20%, the indicator light flashes slowly in red;

When the power is lower than 3%, the indicator Copyfish quickly then automatically turn off;

2. Status indicator (white light)

• Caps Lock Indicator

Solid LED light = The uppercase mode is turned on

LED light off = The uppercase mode is turned off

• Bluetooth Pairing Indicator(white light)

Flashing LED light = The device is in Bluetooth pairing mode; When successfully paired, the Pairing Indicator turns on for 3 seconds, and then turns off again;

During each switch to a new device, the Pairing Indicator flashes quickly for 3 seconds, and then turns off again

• 2.4G Wireless USB Pairing Indicator

When the 2.4G receiver is started for pairing, the Pairing indicator flashes quickly for 3 seconds

When successfully paired, the Pairing Indicator turns on for 3 seconds, and then turns off again

3. Status switch

2.4G/BT: 2.4G/ Bluetooth mode / **ON:** Wired mode/**OFF:** Off

4. Type-C interface

Wired mode interface.

5. Battery cover



Detailed user guide

2.4G Wireless USB mode

1. Swipe to the right to remove the battery cover.

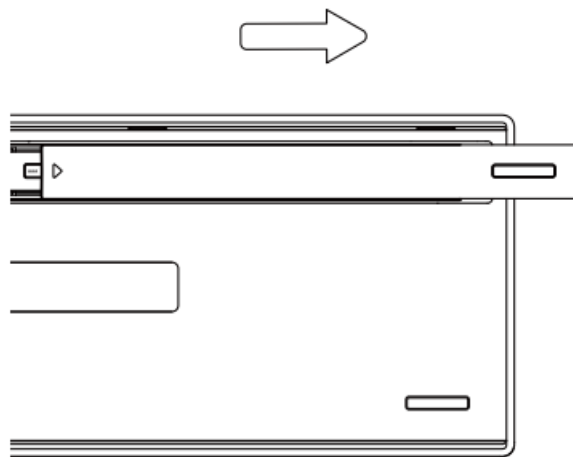

2. Take out the 2.4G receiver.

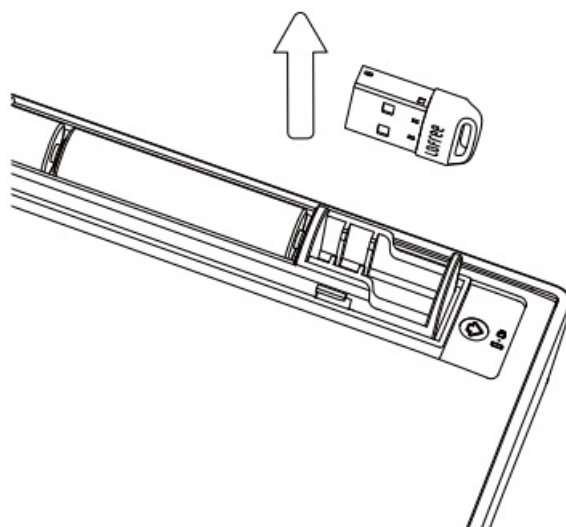

3. Install the battery cover.

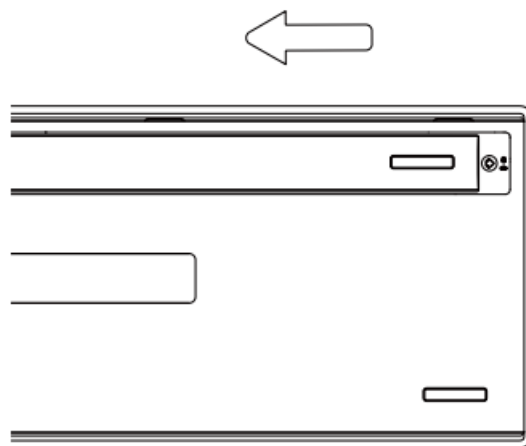

4. Insert the 2.4G receiver into the USB port of the computer.

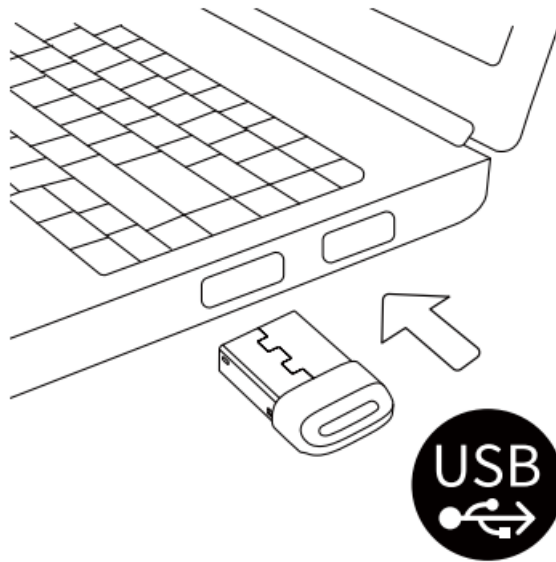

Note: MAC/OS system devices do not support multimedia functions under 2.4G USB Connection.

5. Switch the status to 2.4G/BT gear.

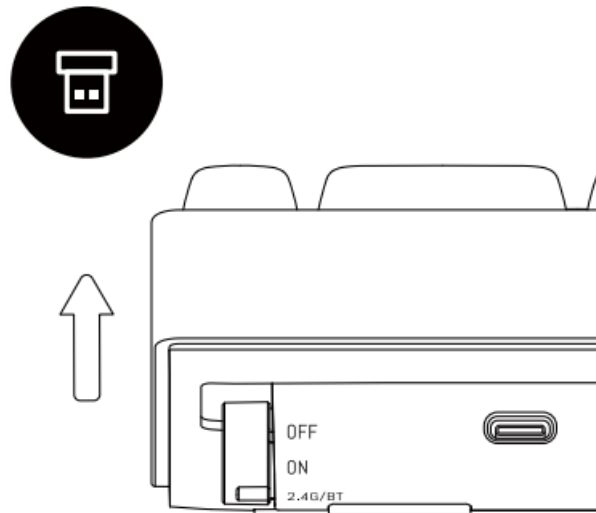

6. Press and hold Fn+R to start 2.4G connection mode.

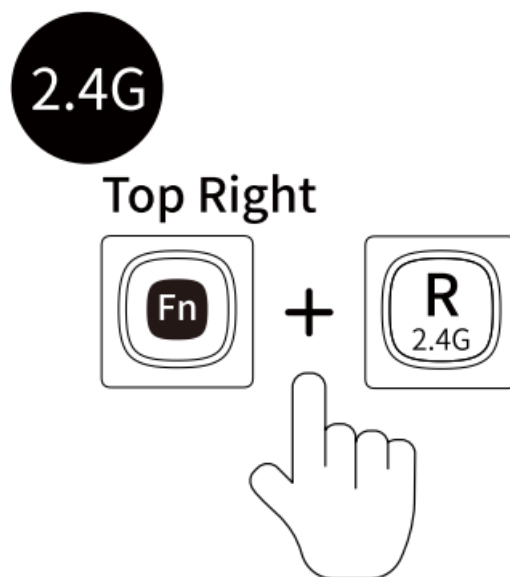

7. The status indicator flashes quickly for 3 seconds then paired successfully.

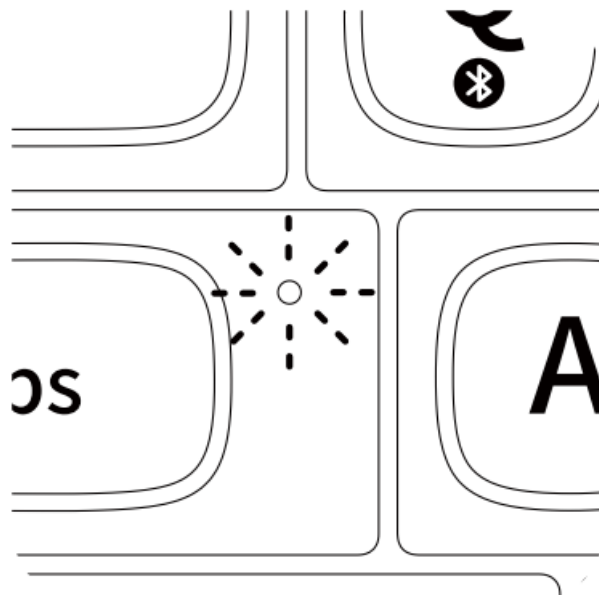

8. This light turns on for 3 seconds then turns off again.

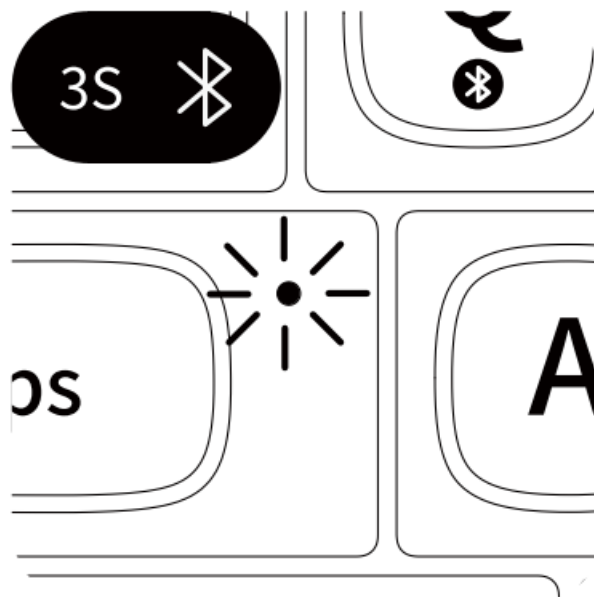

Bluetooth mode:

1. Switch the status to 2.4G/BT gear.

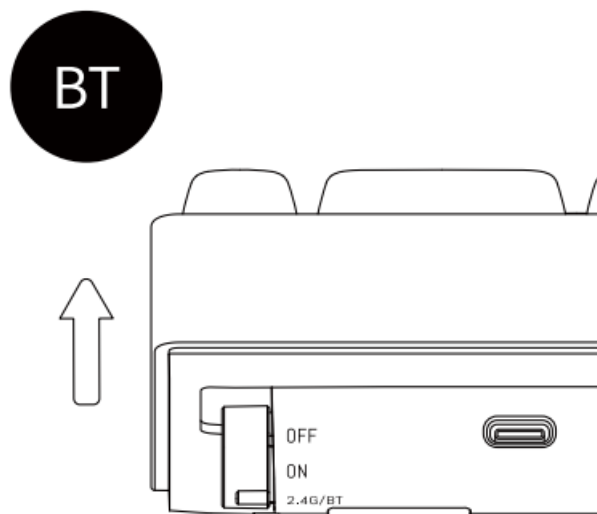

2. Long press Fn+Q/ Fn+W/ Fn+E until the status indicator flashes slowly.

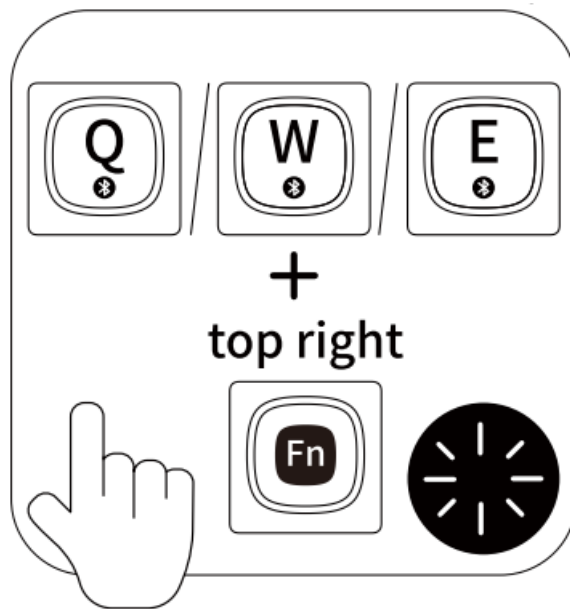

3. Turn on the Bluetooth function of your device, search for “Touch68@Lofree” and connect.



4. When successfully paired, the Pairing Indicator turns on for 3 seconds, and then turns off again.

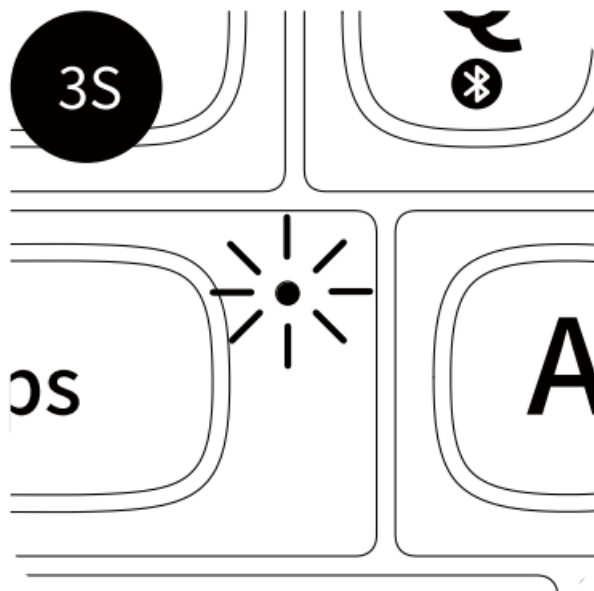

5. Short press Fn+Q/ Fn+W/ Fn+E to switch Bluetooth Connected devices.

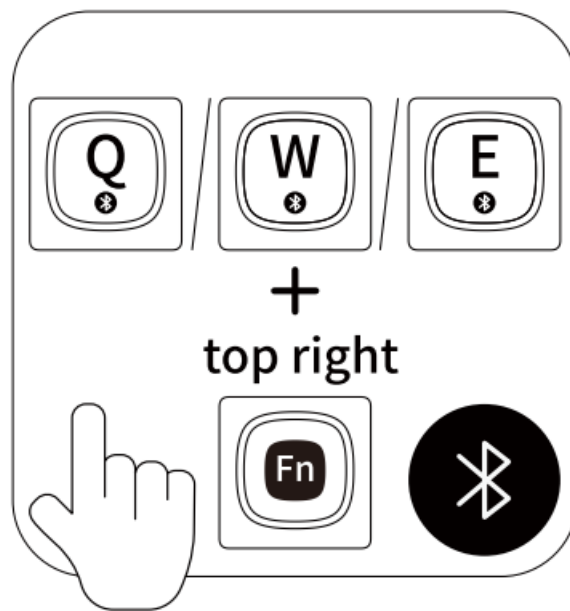

Wired mode:

1. Switch the status to the ON.

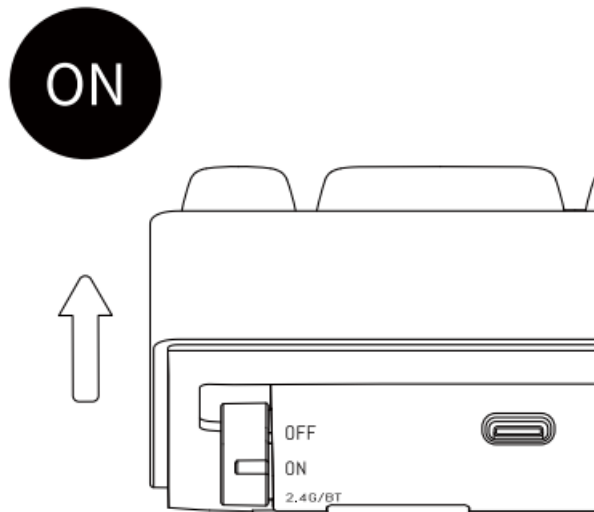

2. Connect the keyboard to computer with Type-C cable to complete the wired connection.

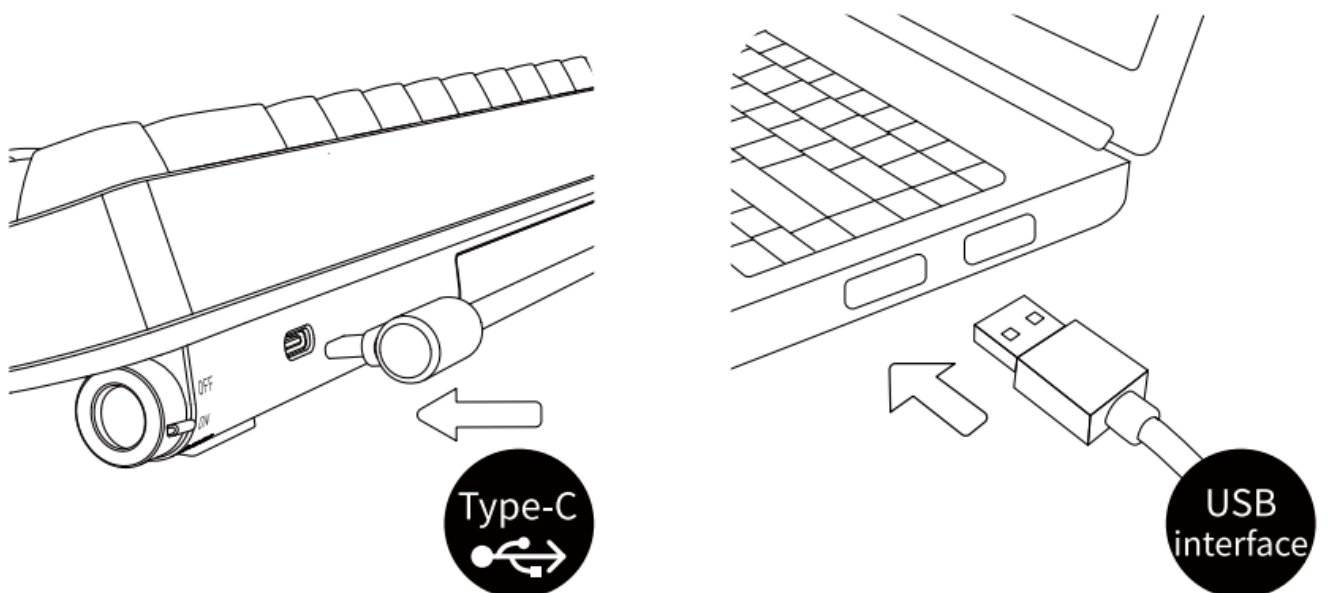

System Switch



- Fn+N in the upper right corner is the key to trigger the corresponding system function of windows
- Fn+M in the upper right corner is the key to trigger the corresponding system function of Mac

Multimedia and function keys



Fn+l in the upper right corner...= the function keys

Function sign	Mac	Windows
+Shift+ESC	`~	`~
+1	F1	F1
+2	F2	F2
+3	F3	F3
+4	F4	F4
+5	F5	F5
+6	F6	F6
+7	F7	F7
+8	F8	F8
+9	F9	F9
+0	F10	F10
+—	F11	F11
++-	F12	F12
+\	PrtSc	PrtSc
+Del	Ins	Ins
+Pgup	Home	Home
+Pgdn	End	End



Fn+1 in the Bottom left corner...= the multimedia keys

Multimedia sign		Mac	Windows
FN+1!	☀	Reduce brightness	Reduce brightness
FN+2@	☀	increase Brightness	increase Brightness
FN+3#	🖥	Multi Screen	Multi Screen
FN+4\$	🔍	Search	Search
FN+5%	🔇	/	ON/Cortana
FN+6^	🌙	/	Sleep Mode/ON
FN+7&	⏮	Previous Track	Previous Track
FN+8*	⏸	Play/Pause	Play/Pause
FN+9(⏭	Next Track	Next Track
FN+0)	🔇	Mute	Mute
FN+_-	🔇	Volume Down	Volume Down
FN+=+	🔊	Volume Up	Volume Up
FN+Opt/Ctrl	☰	Menu Button	Menu Button

Note: Multimedia key FN+5%/FN+6A: Some models of Mac system devices may not support the triggering of this multimedia key due to the problem of matching the connected device model and system version.

NAME AND CONTENT OF HAZARDOUS SUBSTANCES IN PRODUCT

Harmful Elements	Hazardous substances					
	Lead (Pb)	Mercury (Hg)	Cadmium (Cd)	Hexavalent Chromium (Cr, VI)	Polybrominated Biphenyls (PBB)	Polybrominated Diphenyl Ethers (PBDE)
Plastic Components	○	○	○	○	○	○
Circuit Board Assembly	○	○	○	○	○	○
Silicone Components	○	○	○	○	○	○
Spare Partss	○	○	○	○	○	○

This table is prepared in accordance with the provisions of SJ/T 11364.

The classification and marking of this product was performed in accordance with the EU directive 2011/65/EU and the revised directive 2015/863/EU.

- **0:** Indicates that the said hazardous substance contained in all the homogeneous materials for this component is below the limit requirement in GB/T 26572.
- **X:** Indicates that this hazardous substance contained in at least one of the homogeneous materials used for this part is above the limit requirement in GB/T 26572.

ENVIRONMENTAL PROTECTION INSTRUCTIONS:

The hazardous substances contained in the electronic parts of this product will not leak or change under normal use conditions for a period of often years. During the same period, the electronic components of this product will not cause serious environmental pollution or serious damage to human health or property while the products are being used by the consumer. According to the Chinese electronic industry standard SJ/T 11364-2014 and related Chinese government regulations, this product and some of its internal or external components may have an environmentally friendly use period mark, depending on the component and component manufacturer, the mark lifespan on the product and its components may vary. The expiration date on the component takes precedence over any conflicted or different UFUP label on the product.

Warning

- the battery is not replaced properly, there may be leakage or explosion and personal injury hazards.. Do not use the battery when there is leakage, discoloration, deformation, or any other abnormality.
- Do not leave the battery in a discharged or unused state for a long time.
- Do not short-circuit the product
- Battery life varies with usage. Used batteries should be disposed of in accordance with local laws or thrown away in trash cans for recycling electronic devices.
- if any liquid accidentally enters the product, please immediately disconnect the power supply and remove the product. Continue to use the product may cause fire or electric shock. Please contact the agent or the nearest customer service center for inspection and maintenance.

FCC Statement

This equipment has been tested and found to comply with the limits for a Class B digital device, pursuant to Part 15 of the FCC Rules. These limits are designed to provide reasonable protection against harmful interference in a residential installation. This equipment generates uses and can radiate radio frequency energy and, if not installed and used in accordance with the instructions, may cause harmful interference to radio communications. However, there is no guarantee that interference will not occur in a particular installation. If this equipment does cause harmful interference to radio or television reception, which can be determined by turning the equipment off and on, the user is encouraged to try to correct the interference by one or more of the following measures:

- Reorient or relocate the receiving antenna.
- Increase the separation between the equipment and receiver.
- Connect the equipment into an outlet on a circuit different from that to which the receiver is connected.
- Consult the dealer or an experienced radio/TV technician for help.

This device complies with part 15 of the FCC Rules. Operation is subject to the following two conditions:

1. This device may not cause harmful interference, and
2. this device must accept any interference received, including interference that may cause undesired operation.

Changes or modifications not expressly approved by the party responsible for compliance could void the user's

authority to operate the equipment

FCC Radiation Exposure Statement

This equipment complies with FCC radiation exposure limits set forth for an uncontrolled environment. This transmitter must not be co-located or operating in conjunction with any other antenna or transmitter.

Shenzhen Lofree Culture Co.,Ltd.

202-F8, F518 Idea Land, 1065 Bao Yuan Road, Shenzhen

Service Hotline: 4006002083

www.lofree.com.cn

www.lofree.co

Documents / Resources

	Lofree XVZQ49 Touch 68 Triple Mode Connection Mechanical Keyboard [pdf] User Manual XVZQ49, XVZQ49, XVZQ49 Touch 68 Triple Mode Connection Mechanical Keyboard, Touch 68 Triple Mode Connection Mechanical Keyboard, Triple Mode Connection Mechanical Keyboard, Connection Mechanical Keyboard, Mechanical Keyboard, Keyboard
---	---