

**LOfree**

LOFree OE922

FLOW Lite 100 Key

Triple Mode Low

Profile Mechanical

Keyboard



# LOFree OE922 FLOW Lite 100 Key Triple Mode Low Profile Mechanical Keyboard User Guide

[Home](#) » [LOfree](#) » LOFree OE922 FLOW Lite 100 Key Triple Mode Low Profile Mechanical Keyboard User Guide



## Contents

- 1 [LOFree OE922 FLOW Lite 100 Key Triple Mode Low Profile Mechanical Keyboard](#)
- 2 [Product Information](#)
- 3 [Product Usage Instructions](#)
- 4 [SPECIFICATIONS](#)
- 5 [Diagram](#)
- 6 [Detailed Operation](#)
- 7 [Multifunction Keys](#)
- 8 [ENVIRONMENTAL PROTECTION INSTRUCTIONS](#)
- 9 [FCC Statement](#)
- 10 [Documents / Resources](#)
  - 10.1 [References](#)
- 11 [Related Posts](#)

# LOfree

**LOFree OE922 FLOW Lite 100 Key Triple Mode Low Profile Mechanical Keyboard**



## Product Information

### Specifications:

- Product Name: FLOW Lite 100-Key Triple Mode Low-Profile Mechanical Keyboard
- Transmitter/Receiver Compliance: Innovation, Science and Economic Development Canada's licence-exempt RSS(s)
- Operation Conditions:
  1. This device may not cause interference.
  2. This device must accept any interference, including interference that may cause undesired operation of the device.
- Exemption: Meets exemption from routine evaluation limits in section 2.5 of RSS 102
- RF Exposure: Complies with RSS 102 RF exposure regulations
- Radiation Exposure Limits: Complies with Canada radiation exposure limits for uncontrolled environments\

## Product Usage Instructions

### Setting Up the Keyboard:

1. Place the keyboard on a flat surface.
2. Connect the USB cable to your computer or device.
3. Turn on the keyboard using the power switch if available.

### Switching Modes:

The keyboard has three modes: Mode 1, Mode 2, and Mode 3. To switch between modes:

1. Press and hold the designated mode switch key for 3 seconds.
2. The keyboard will indicate the current mode with LED lights or other indicators.
3. Release the mode switch key to confirm the selection.

### Typing and Functionality:

Enjoy typing on the low-profile mechanical keys with a tactile response. Use the keyboard for typing, gaming, or other tasks as needed

## Frequently Asked Questions (FAQ)

• **Q: Can I use this keyboard wirelessly?**

A: No, this keyboard connects via a USB cable to your device.

• **Q: How do I clean the keyboard?**

A: To clean the keyboard, gently remove keycaps using a keycap puller and clean the surface with a soft brush or compressed air. Avoid using liquids.

## FLOW Lite 100-Key Triple Mode Low-Profile Mechanical Keyboard

### SPECIFICATIONS

- Number of keys: 100(hot-swappable Mechanical Switch)
- Numbers of Multifunction Keys: 15
- Materials: ABS Body, PBT+PC
- Keycaps Interface: Type-C
- Mode: Wired/Bluetooth/2.4G
- Bluetooth Name: Flow Lite100@Lofree
- Dimensions: 374.5X138X23.5mm

### Diagram

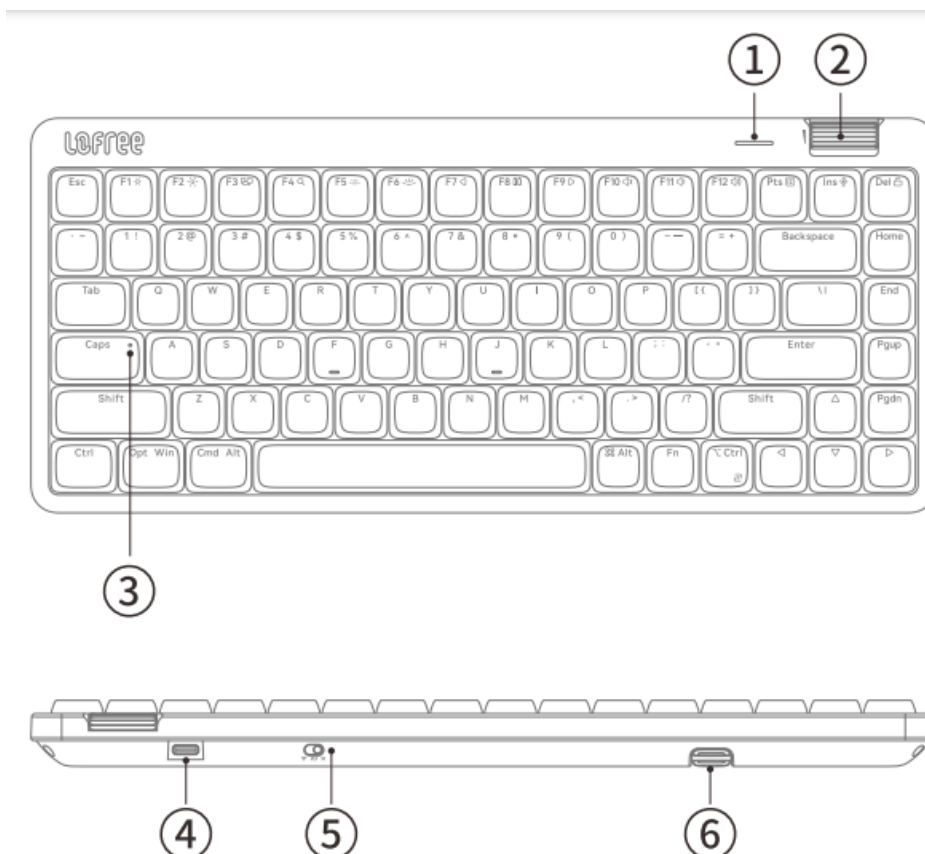

1. Battery Indicator Charging: Indicator on breathing white Charged: Indicator always on white Battery <20%, Indicator on breathing red Battery <5%, Indicator flashing till off
2. Numeric keypad indicator light
3. Volume Rotary Switch scroll up is large, scroll down is small Press to switch between mute and non-mute

#### 4. Caps Lock Indicator(White)/Status Indicator(Blue)

- Caps Lock Indicator(White) Indicator white light enabled: Caps lock on Indicator white light disabled: Caps lock off
- Bluetooth Pairing Indicator(Blue)
- During Bluetooth pairing, Indicator blinks slowly for 1 min, after success, Indicator keeps on for 3s During device switching, Indicator flashes for 3s, after success, Indicator keeps on for 3s During Bluetooth reconnection, the indicator keeps blinking After reconnection, the indicator keeps on for 3 seconds, and then recovers to the previous state

#### 5. Type-C Interface

Wired/Charging port

#### 6. Mode Switch

✕ OFF/  Wired Mode/  Wireless Mode

#### 7. 2.4G Receiver

### Detailed Operation

#### Wired Connection:

1. Toggle the mode switch to 

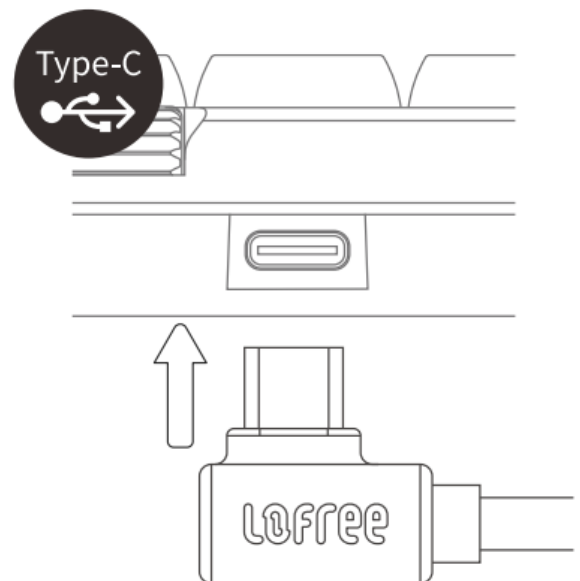
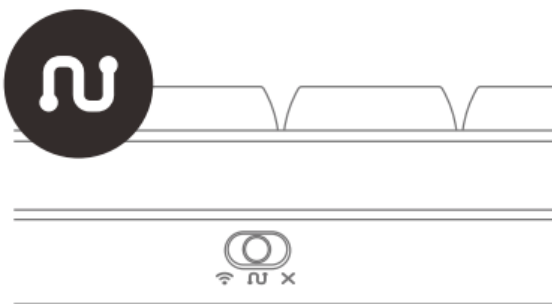

Connect the keyboard to the device with attached Type C cable to complete the wired connection mode

#### Bluetooth Connection:

1. Toggle the mode switch to 
2. Long Press Fn+1/Fn+2 /Fn+3 until indicator blinks slowly on Blue

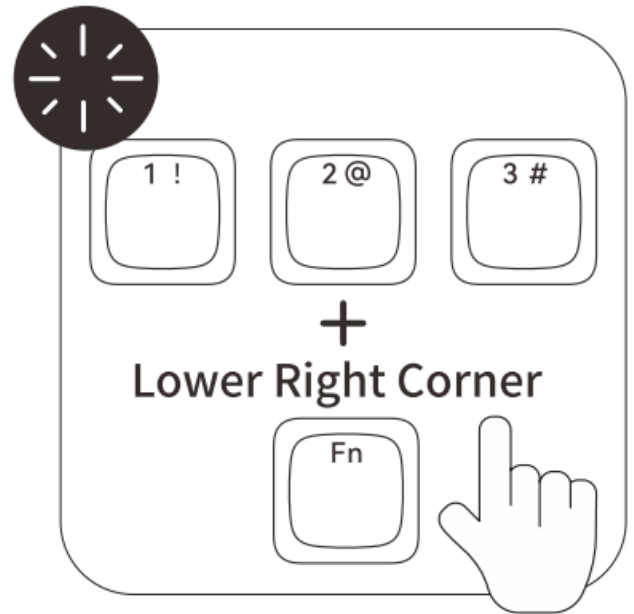
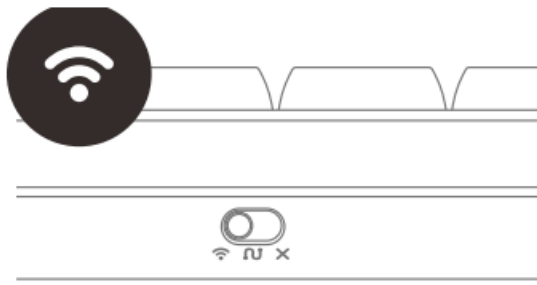

3. Find and pair "Flow Lite100@Lofree" on your list of paired devices

4. Status Indicator: Indicator keeps on for 3s and turns off

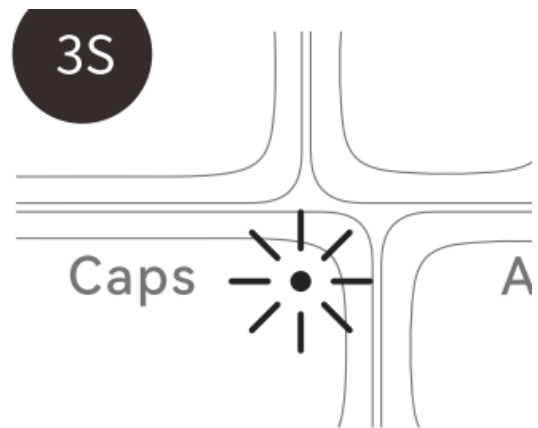

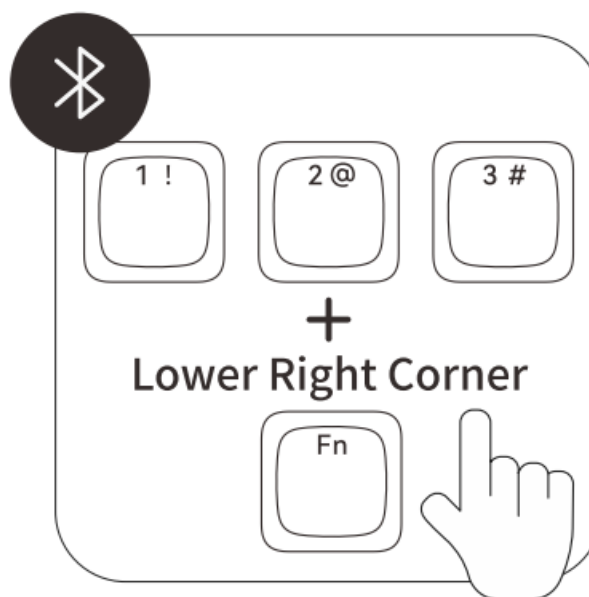

5. Fn+1/Fn+2/Fn+3= Switch Bluetooth Device

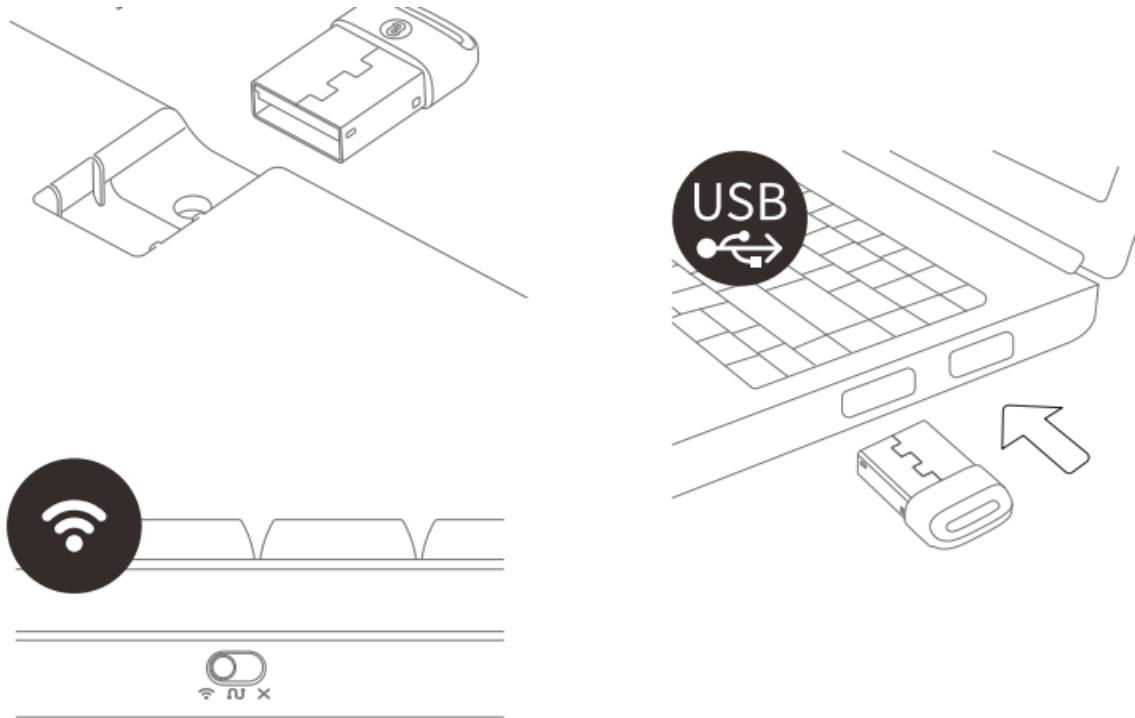

**2.4G Wireless Mode:**

1. Take out the 2.4G receiver from the bottom of the keyboard
2. Insert the 2.4G receiver into the USB port of the device, and the corresponding 2.4G light will always be on after successful connection



3. Toggle the mode switch to 

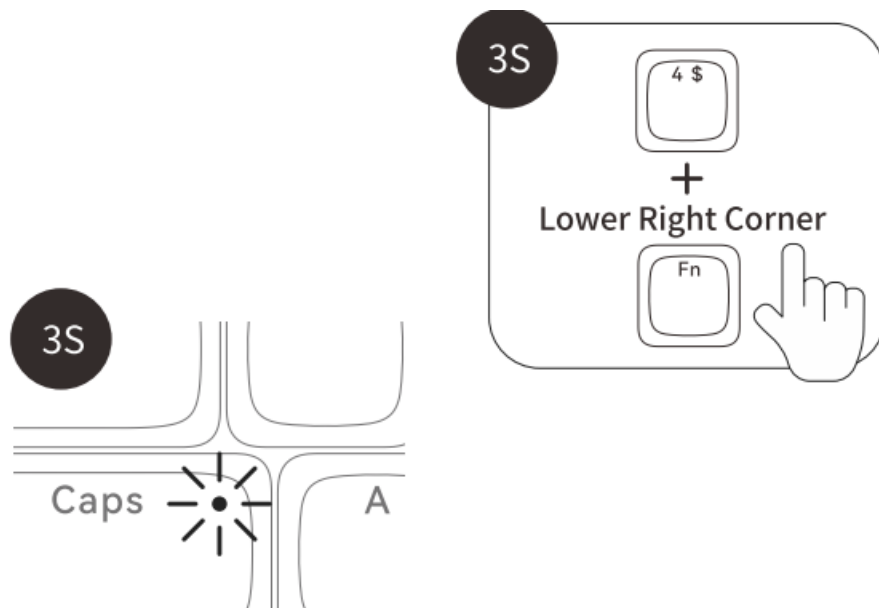

4. Long press Fn+4 to start the 2.4G connection mode
5. The corresponding 2.4G light flashes slowly, After successful connection, the blue light will stay on for 3 seconds and then go off. Restore the current corresponding state

#### Note:

1. No pairing is required for the second use of the same device after successful pairing for the first time. Connect the
2. 4G receiver to the computer, short press Fn+4, the blue light flashes quickly to enter the reconnection mode. After the connection is successful, the blue light will stay on for 3 seconds and then go out, restoring the previous corresponding state.
2. MAC/IOS system devices do not support multimedia functions under



2.4G&USB connection

### 3. Use of Ambient Light:

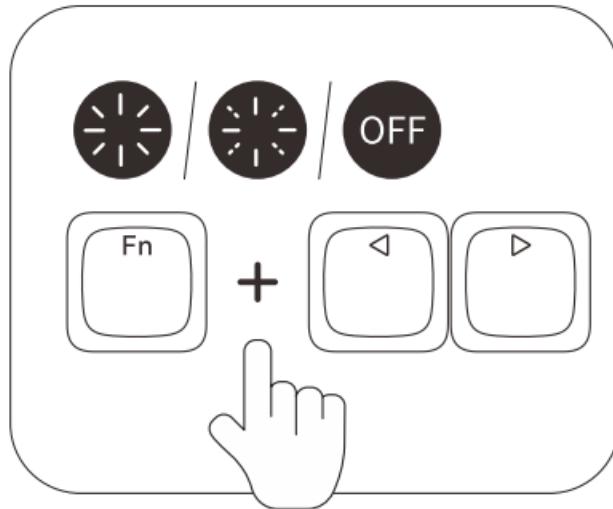
1. Fn + ←/→ : Steady/Breathe/Off

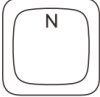
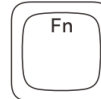

### System Switch

-  +  Fn+N is to trigger the corresponding system function key of windows/Android
-  +  Fn+M is to trigger the corresponding system function key of Mac/10S

### Multifunction Keys

 Fn + F1.....Del = Multimedia Key

|             |    |              |              |
|-------------|----|--------------|--------------|
| FN+F1       | ☼  | Screen BR -  | Screen BR -  |
| FN+F2       | ☼  | Screen BR +  | Screen BR +  |
| FN+F3       | 🖥️ | Multi-Screen | Multi-Screen |
| FN+F4       | 🔍  | Search       | Search       |
| FN+F5       | 🌞  | Backlit -    | Backlit -    |
| FN+F6       | 🌞  | Backlit +    | Backlit +    |
| FN+F7       | ⏮  | Prev Song    | Prev Song    |
| FN+F8       | ⏸  | Play/Pause   | Play/Pause   |
| FN+F9       | ⏭  | Next Song    | Next Song    |
| FN+F10      | 🔇  | Mute         | Mute         |
| FN+F11      | 🔊  | VOL-         | VOL -        |
| FN+F12      | 🔊  | VOL+         | VOL+         |
| FN+Opt/Ctrl | 📄  | /            | Menu         |
| FN+Prtsc    | 🖨  | /            | Calculator   |
| FN+Del      | 🗑  | /            | Lock         |

NAME AND CONTENT OF HAZARDOUS SUBSTANCES IN PRODUCT: 

| Harmful Elements       | Hazardous substances |              |              |                              |                                |                                       |
|------------------------|----------------------|--------------|--------------|------------------------------|--------------------------------|---------------------------------------|
|                        | Lead (Pb)            | Mercury (Hg) | Cadmium (Cd) | Hexavalent Chromium (Cr, VI) | Polybrominated Biphenyls (PBB) | Polybrominated Diphenyl Ethers (PBDB) |
| Plastic Components     | O                    | O            | O            | O                            | O                              | O                                     |
| Circuit Board Assembly | O                    | O            | O            | O                            | O                              | O                                     |
| Silicone Components    | O                    | O            | O            | O                            | O                              | O                                     |
| Spare Partss           | O                    | O            | O            | O                            | O                              | O                                     |

- This table is prepared in accordance with the provisions of SJ/T 11364.
- The classification and marking of this product was performed in accordance with the EU directive 2011/65/EU and the revised directive 2015/863/EU. O:Indicates that the said hazardous substance contained in all the

homogeneous materials for this component is below the limit requirement in GB/T 26572.

- X: Indicates that this hazardous substance contained in at least one of the homogeneous materials used for this part is above the limit requirement in GB/T 26572.

## **ENVIRONMENTAL PROTECTION INSTRUCTIONS**

- The hazardous substances contained in the electronic parts of this product will not leak or change under normal use conditions for a period of ten years. During the same period, the electronic components of this product will not cause serious environmental pollution or serious damage to human health or property while the products are being used by the consumer. According to the Chinese electronic industry standard SJ/T 11364-2014 and related Chinese government regulations, this product and some of its internal or external components may have an environmentally friendly use period mark, depending on the component and component manufacturer, the mark lifespan on the product and its components may vary. The expiration date on the component takes precedence over any conflicted or different UFUP labels on the product.

### **Warning:**

- If the battery is not replaced properly, there may be leakage or explosion and personal injury hazards.
- Do not use the battery when there is leakage, discoloration, deformation, or any other abnormality.
- Do not leave the battery in a discharged or unused state for a long time.
- Do not short-circuit the product
- Battery life varies with usage. Used batteries should be disposed of in accordance with local laws or thrown away in trash cans for recycling electronic devices.
- If any liquid accidentally enters the product, please immediately disconnect the power supply and remove the product. Continuing to use the product may cause fire or electric shock. Please contact the agent or the nearest customer service center for inspection and maintenance.

## **FCC Statement**

This equipment has been tested and found to comply with the limits for a Class B digital device, pursuant to Part 15 of the FCC Rules. These limits are designed to provide reasonable protection against harmful interference in a residential installation. This equipment generates uses and can radiate radio frequency energy and, if not installed and used in accordance with the instructions, may cause harmful interference to radio communications. However, there is no guarantee that interference will not occur in a particular installation.

- If this equipment does cause harmful interference to radio or television reception, which can be determined by turning the equipment off and on, the user is encouraged to try to correct the interference by one or more of the following measures:
  - Reorient or relocate the receiving antenna.
  - Increase the separation between the equipment and receiver.
  - Connect the equipment into an outlet on a circuit different from that to which the receiver is connected.
  - Consult the dealer or an experienced radio/TV technician for help.

This device complies with part 15 of the FCC Rules.  
Operation is subject to the following two conditions:

1. This device may not cause harmful interference, and
  2. This device must accept any interference received, including interference that may cause undesired operation.
- Changes or modifications not expressly approved by the party responsible for compliance could void the user's authority to operate the equipment.

### FCC Radiation Exposure Statement

This equipment complies with FCC radiation exposure limits set forth for an uncontrolled environment This transmitter must not be co-located or operating in conjunction with any other antenna or transmitter.

ISED Statement English: This device contains licence-exempt transmitter(s)/receiver(s) that comply with Innovation, Science and Economic Development Canada's licence-exempt R55(5). Operation is subject to the following two conditions:

1. This device may not cause interference.
2. This device must accept any interference, including interference that may cause undesired operation of the device.

This device meets the exemption from the routine evaluation limits in section 2.5 of RSS 102 and compliance with RSS 102 RF exposure, users can obtain Canadian information on RF exposure and compliance.

- This equipment complies with Canada radiation exposure limits set forth for an uncontrolled environment.
- This equipment should be installed and operated with minimum distance 0cm between the radiator & your body.

### Documents / Resources

|   |  |
|---|--|
|  | <p><a href="#">LOFree OE922 FLOW Lite 100 Key Triple Mode Low Profile Mechanical Keyboard</a> [pdf] User Guide</p> <p>OE922, 2AC59-OE922, 2AC59OE922, oe922, OE922 FLOW Lite 100 Key Triple Mode Low Profile Mechanical Keyboard, OE922, OE922 FLOW Mechanical Keyboard, FLOW Lite 100 Key Triple Mode Low Profile Mechanical Keyboard, 100 Key Triple Mode Low Profile Mechanical Keyboard, FLOW Lite Mechanical Keyboard, Low Profile Mechanical Keyboard, Mechanical Keyboard, Keyboard</p> |
|---|--|

### References

- [User Manual](#)

[Manuals+](#), [Privacy Policy](#)

This website is an independent publication and is neither affiliated with nor endorsed by any of the trademark owners. The "Bluetooth®" word mark and logos are registered trademarks owned by Bluetooth SIG, Inc. The "Wi-Fi®" word mark and logos are registered trademarks owned by the Wi-Fi Alliance. Any use of these marks on this website does not imply any affiliation with or endorsement.