



LODO EVO 2022 Screen Instruction Manual Instructions

[Home](#) » [LODO EVO](#) » LODO EVO 2022 Screen Instruction Manual Instructions 

Contents

- 1 LODO EVO 2022 Screen
- 2 Product Information
- 3 Product Usage Instructions
- 4 Wall brackets installation
- 5 Screen installation
- 6 Eyebolt bracket
- 7 LIMIT-SWITCH PROGRAMMING UNIT
- 8 INFERIOR LIMIT POINTS' CHANGING
- 9 GENERAL SAFETY NORMS
- 10 GENERAL CHARACTERISTICS OF THE PRODUCT
- 11 UNPACKING AND HANDLING THE SCREEN
- 12 WARRANTY
- 13 Documents / Resources
 - 13.1 References
- 14 Related Posts

LODO EVO

LODO EVO 2022 Screen



Product Information

Specifications:

- Product Name: LODO EVO
- Languages: IT, EN

Product Usage Instructions

Installation

Position the packaging in the installation room ensuring the screen is facing the right direction. Unpack the screen carefully. Ensure installation is done by qualified personnel to avoid damage to the system.

Bracket Preparation and Installation

Separate the bracket part to be installed on the screen. Install wall brackets according to the indication of 400/600 mm. Use the provided screws in the correct position. For ceiling brackets installation, follow the provided instructions.

Screen Installation

Rotate the hook to lock the bracket securely. For truss installation, use Aliscraf brackets with a maximum distance of 255mm and a minimum distance of 145mm. Follow the manual to install the lower part of the bracket to the screen.

Safety Measures

Adjust the counterweight to flatten the screen fabric if necessary. Install wall safety chains as an additional safety measure.

FAQ

1. Q: Can I install the screen without professional help?

A: It is recommended to have qualified personnel carry out the installation to ensure proper setup and avoid any damages.

2. Q: What should I do if there are deviations from the installation procedures?

A: Any deviations from the provided procedures may void the warranty, so it is essential to follow the manual

instructions carefully.

Place the empty packaging in the installation room making sure that the screen is positioned with its front side in the right direction.



Unpackaged the screen



The installation must be carried out by qualified staff: the team in charge will have to unload, hoist and anchor the screen and connect the wiring.

The improper installation of the system may damage the motor and the control system. The installation not in compliance with the given instructions will nullify the warranty!

DURING THE HOISTING PROCESS IT IS STRICTLY FORBIDDEN TO WALK IN THE AREA UNDERNEATH THE SCREEN. ANY MISTAKE IN THE INSTALLATION OF THE SYSTEM COULD BE FATAL!

Any divergence from the procedures laid out in this manual will not be covered by the warranty.



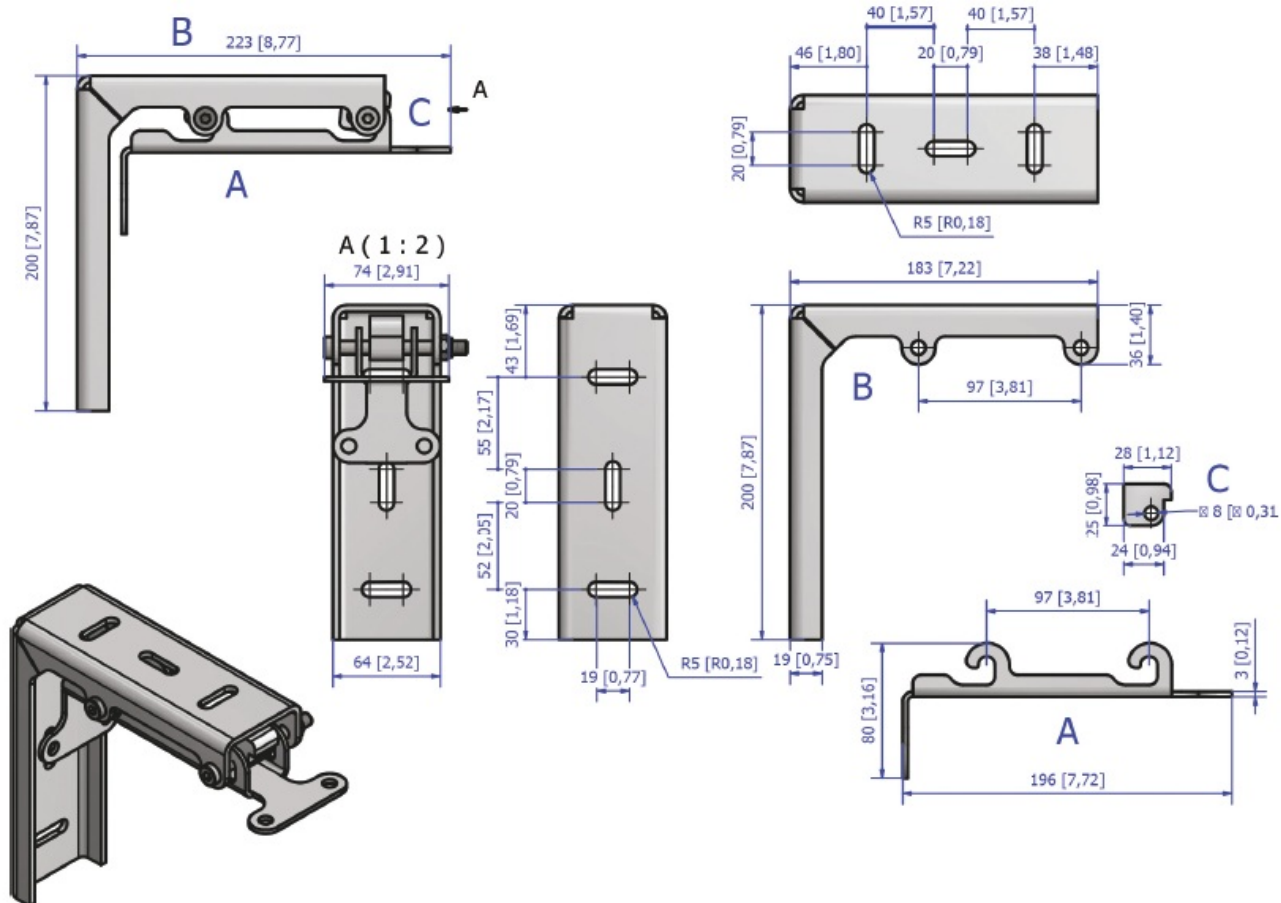

Wall brackets installation

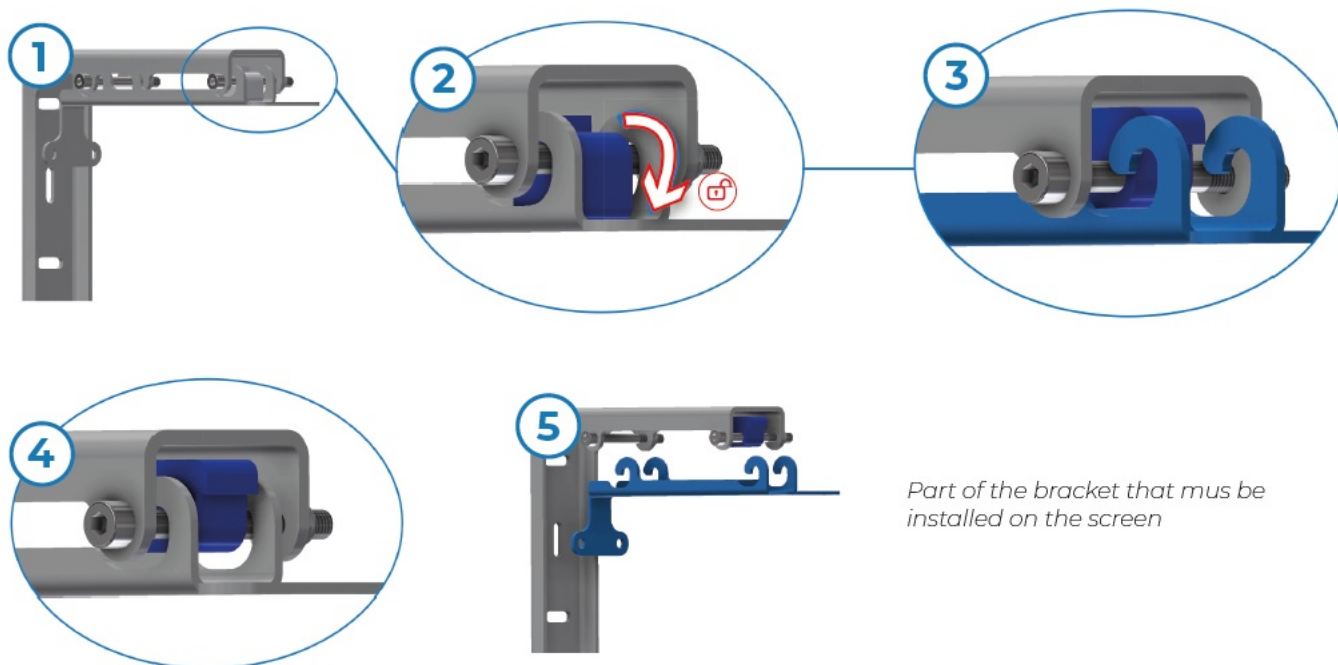

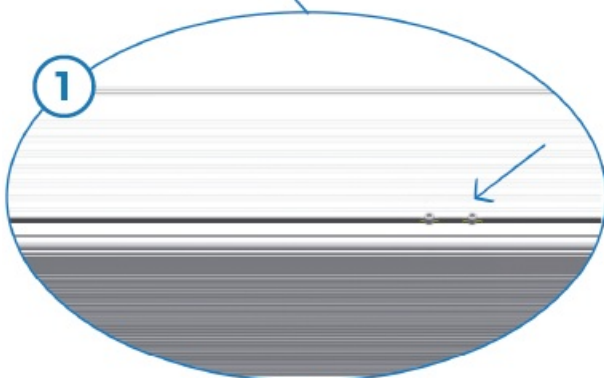
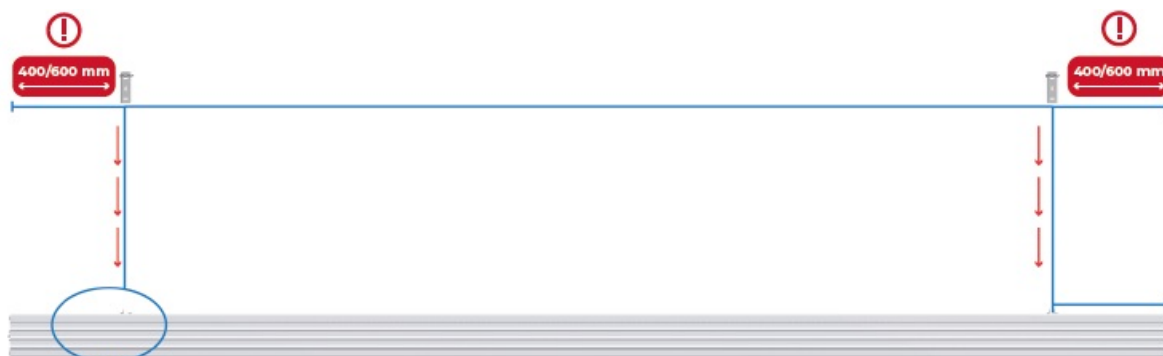

Install brackets according to the indication 400/600 mm. The screws will be already in the correct position 400/600 mm. Install the part of the bracket that must be installed on the screen in the same position of the screws.

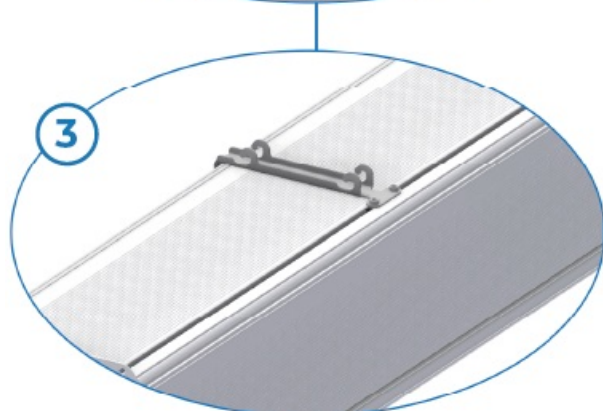
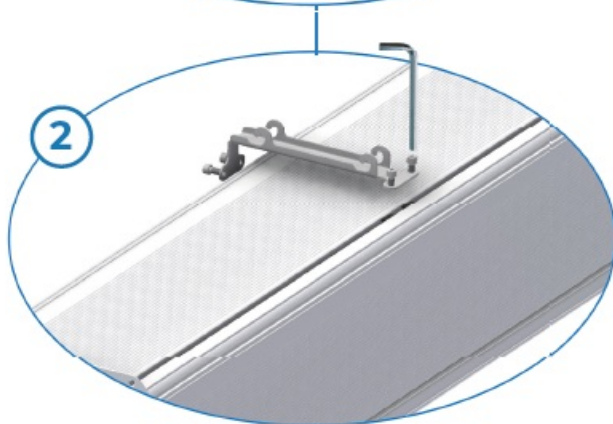

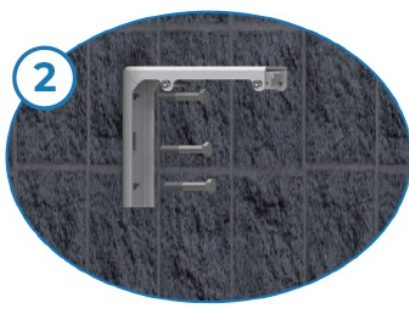
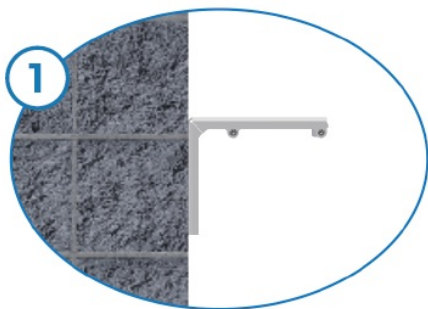

Ceil brackets installation

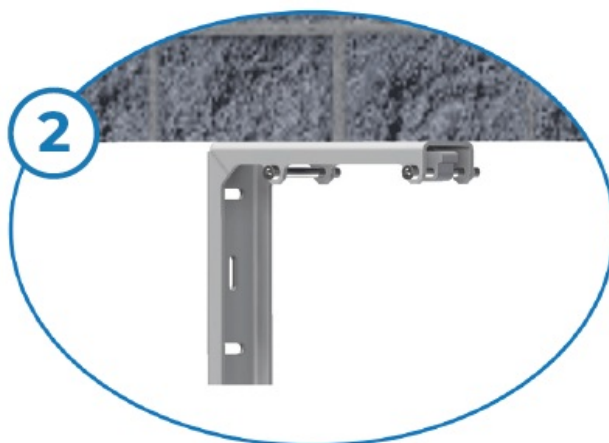
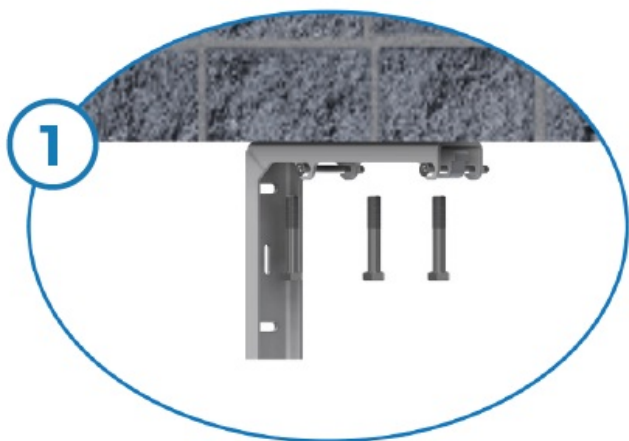

Screen installation

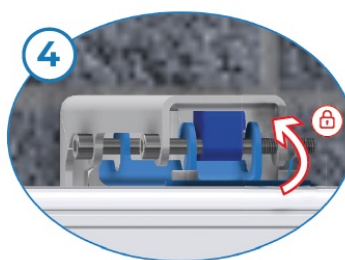
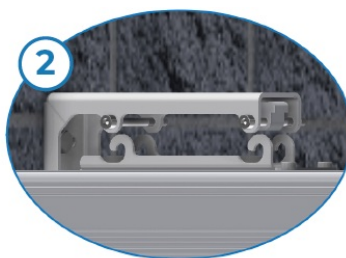
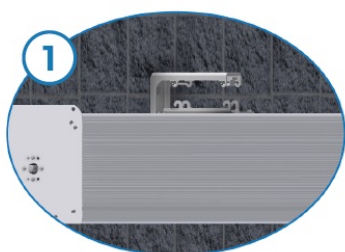

Rotate the hook to lock the bracket



In case of truss installation: Aliscaf brackets

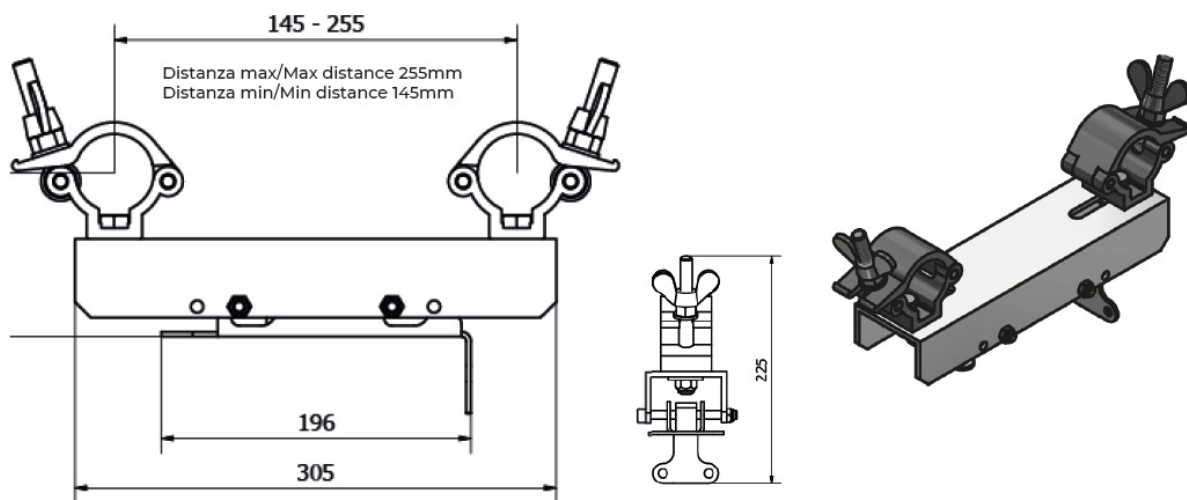

Remove the lower part of the bracket.

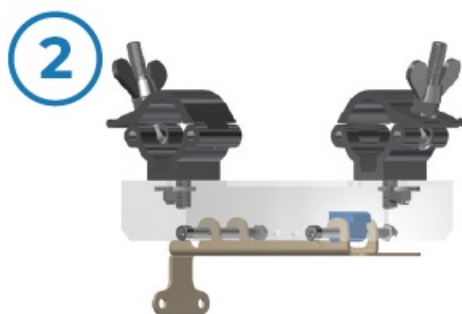

See page 4 to install the lower part of the bracket to the screen

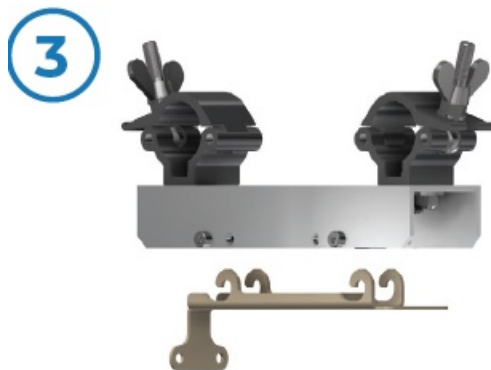

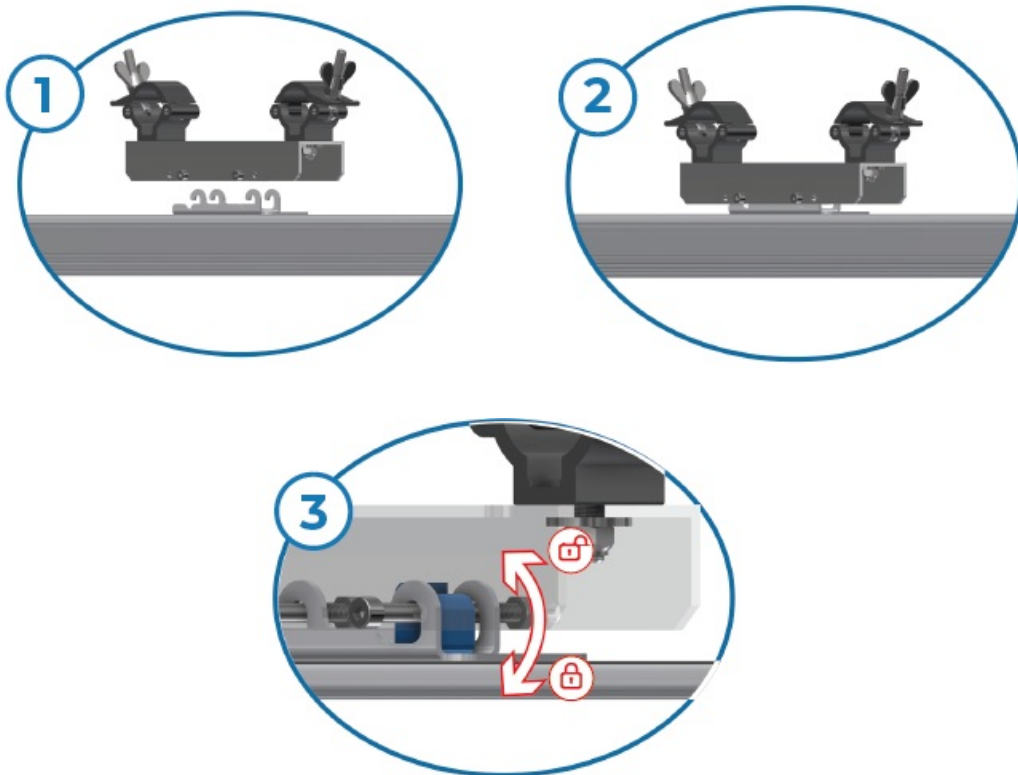

Rotate the hook to open and close the bracket

Eyebolt bracket

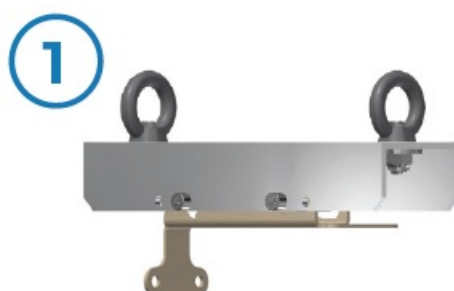
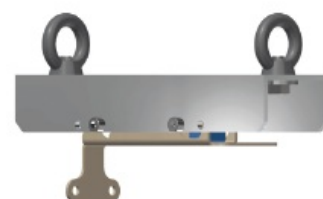
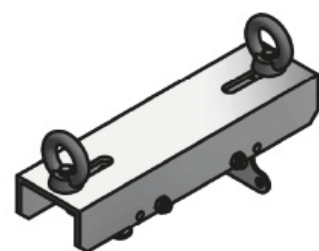
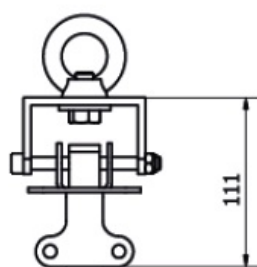
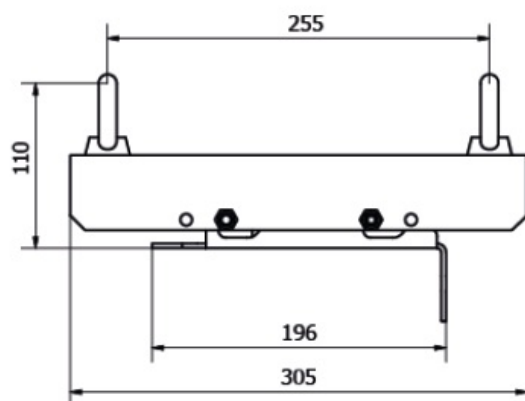

Remove the lower part of the bracket.

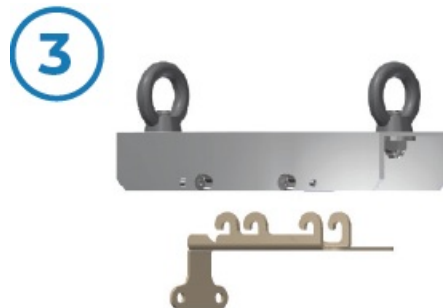
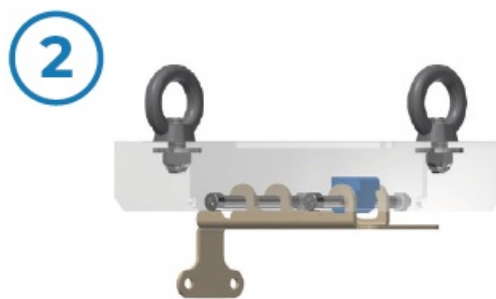

See page 4 to install the lower part of the bracket to the screen

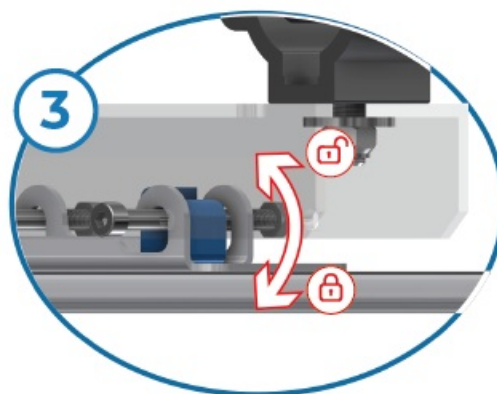
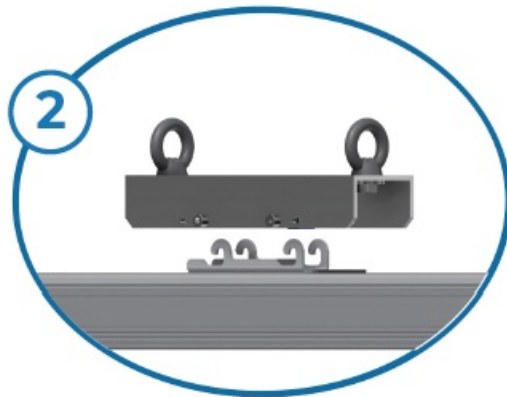
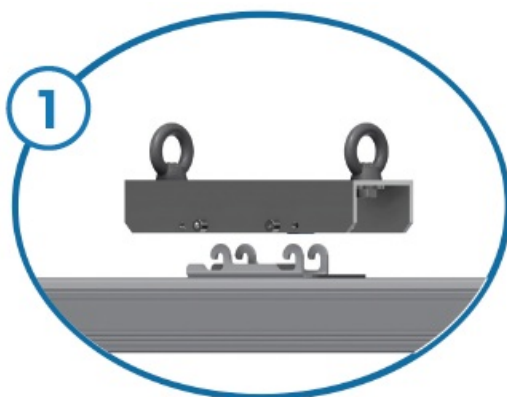

Rotate the hook to open and close the bracket

Wall safety chains

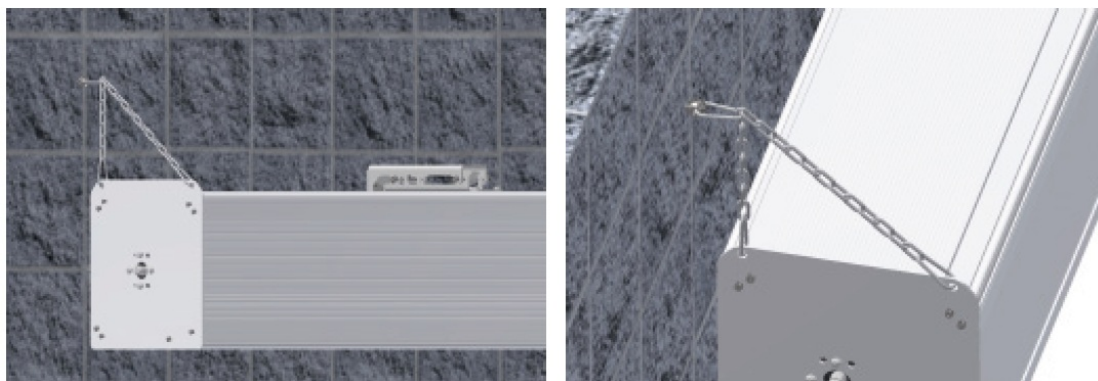

Regulation of the counterweight in order to flat the fabric. Just in case of waves.

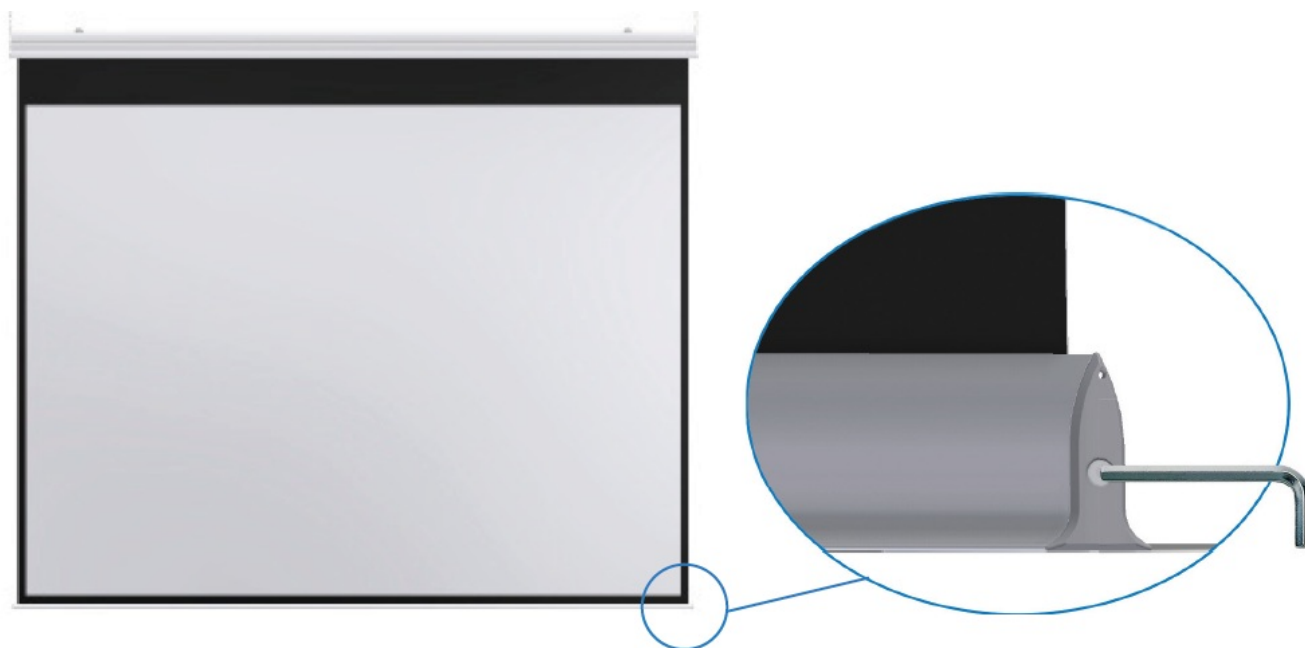

WARNING

The PVC fabric is very sensitive to heating. In a very hot environment the fabric can soften excessively and stretch down by altering the video ratio. You should absolutely avoid placing the screen in front of sunlight windows or above radiators, fireplaces and stove of all kinds. The higher will be the heating absorbed by the screen, the higher will be the deformation of the surface which will assume an elongated shape with curved lateral edges. Electrical installation must be carried out by qualified personnel.

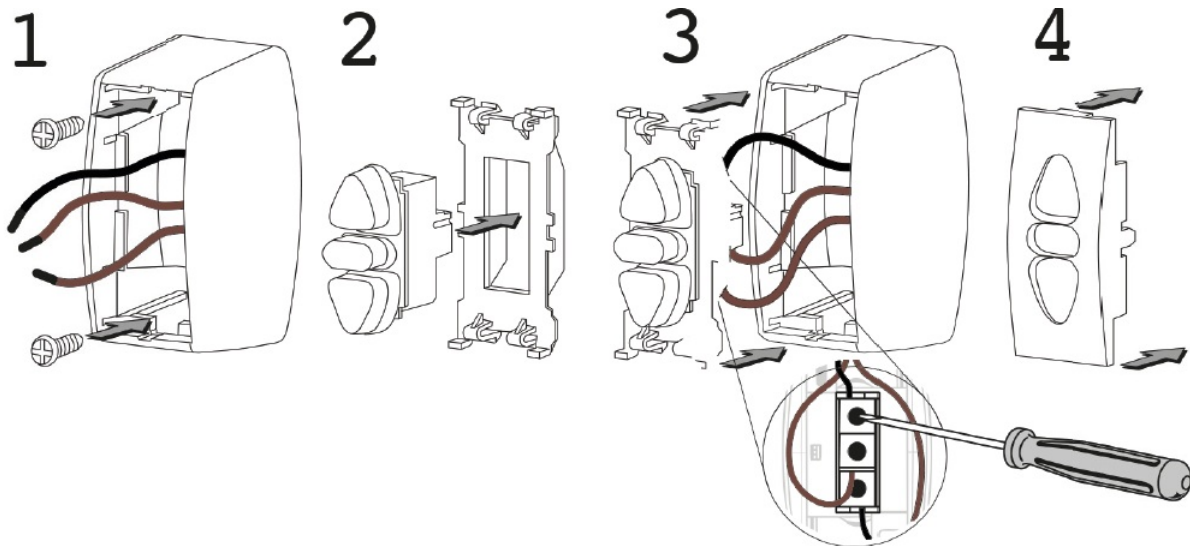
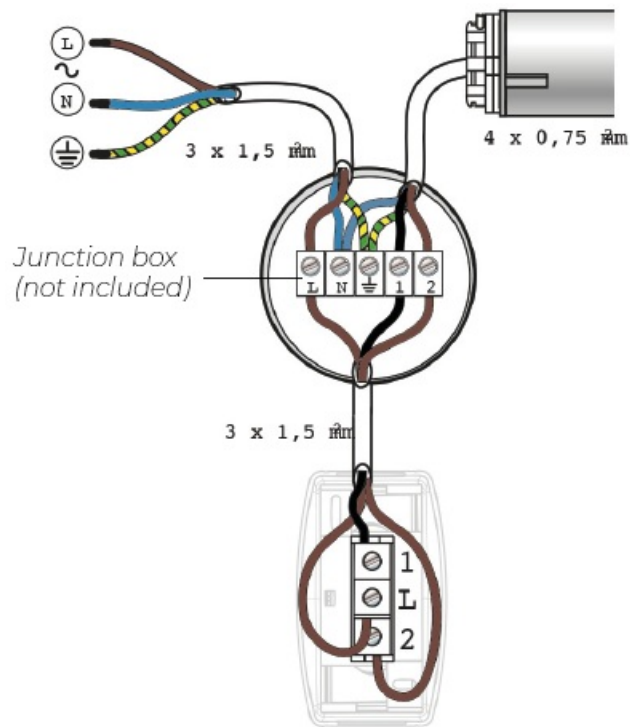

TERMINALS	POWER SUPPLY	MOTOR (EUR)	MOTOR (US)
L	PHASE (L)		
N	NEUTRAL (N)	BLUE	WHITE
W	EARTH (W)	YELLOW/GREEN	GREEN
1		BLACK OR BROWN	BLACK OR RED
2		BLACK OR BROWN	BLACK OR RED

- Disconnect the main supply before carrying out any work.
- Ensure that no forces act on terminals after installation.
- Connect the earth wires before phase and neutral.

LIMIT-SWITCH PROGRAMMING UNIT

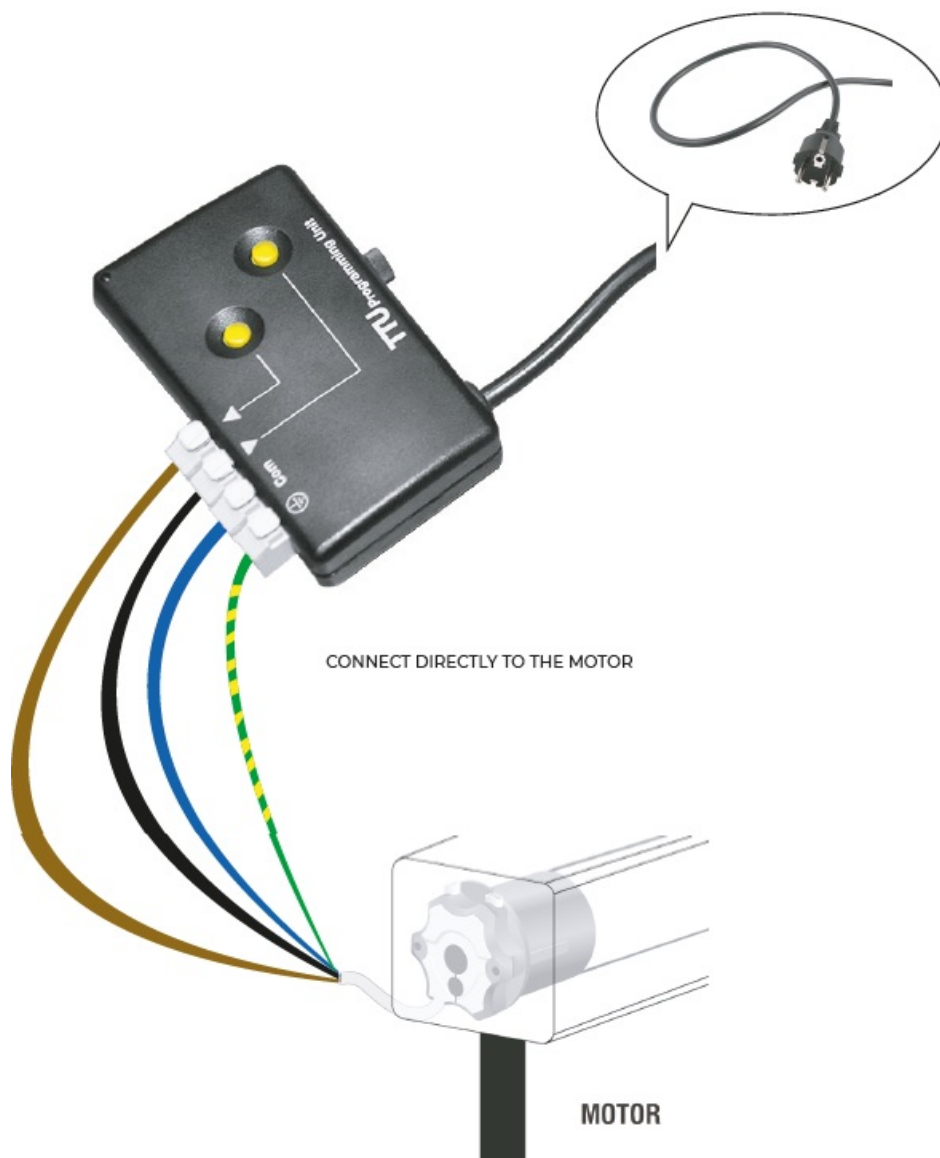

INFERIOR LIMIT POINTS' CHANGING

WARNING: When delivered, the motor is set on "working" mode. To change the set points it is necessary proceed with the cancellation of the points set by the manufacturer.

IT IS ESSENTIAL NOT TO MODIFY THE DOWN LIMIT POINT SET BY MANUFACTURER OVER ± 10 CM. (Otherwise the warranty shall not apply). THE UP LIMIT POINT IS AUTOMATICALLY RECORDED.

1. GET POWER

Open the screen till the middle position.

2.



CLEAR ALL ADJUSTMENTS

(This can only be done using a double button that is not interlocked) Press UP AND DOWN at the same time for 8", until the screen moves UP AND DOWN 2 times.

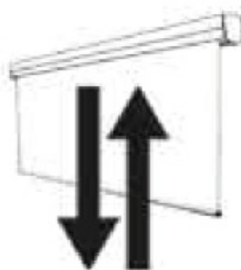

3 s

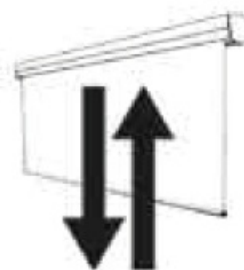

8 s

3. ENTER PROGRAMMING MODE

Press UP and DOWN simultaneously until the screen moves UP and DOWN. Press UP for about 3" until the screen moves UP and DOWN.

4.

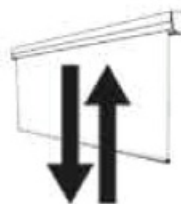
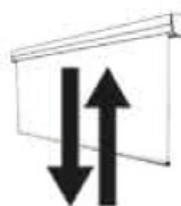

ADJUSTMENT OF THE DOWN LIMIT SWITCH

Pressing DOWN, bring the screen to the down limit point. Press UP quickly, release and press RISE again for 3", until the screen moves UP and DOWN.



<1 s



3 s

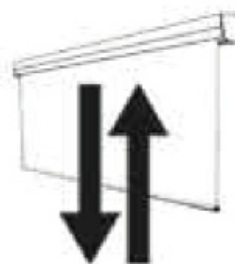

5. STORAGE OF THE LIMIT SWITCH

Press UP AND DOWN at the same time for 3", until the screen moves UP AND DOWN.

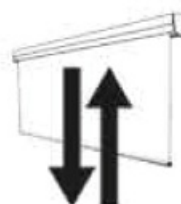

GENERAL SAFETY NORMS

CAUTION: Important safety instructions. Follow the instructions as improper installation can cause serious injury. Always read the instructions and warnings set out in this manual very carefully before using the product or before performing any maintenance interventions.

Installation of the screen above passageway is strictly forbidden. Before and during use, check that the screen poses no risk of hazard. Do not tamper with, remove or damage any part or component of the screen. Never carry out maintenance work on the screen with the motor on and always disconnect the power first. Always disconnect the power when cleaning, carrying out maintenance or replacing parts. Not children safe. It is mandatory to keep children away during operations with the screen. All our screens are covered by guarantee; validity of the same shall be subject to user's full compliance with the instructions contained in this manual.

WARNING: Faulty installation may compromise the safety of the product's operators; manufacturer shall not be held liable for damages to persons or things resulting from faulty installation, improper use, insufficient or inadequate maintenance of the screen. Manufacturer shall not be held responsible for problems associated with installation errors.

Screen installation, electrical connections and verifications in case of malfunction of motorised rolling screens must be performed by authorised vendor or by personnel that is informed and trained in electrical hazards. The connection cable cannot be replaced. If the cable is damaged the screen must be replaced. Tampering with the end stops shall entail the forfeiture of the guarantee. For any necessary clarifications please contact our technical office.

WARNINGS AND RECOMMENDATIONS FOR CORRECT USE AND INSTALLATION

Our screens are suitable for indoor use at normal temperature (20 – 25 °C) and humidity conditions. It is absolutely forbidden to install the video projection screens in front of windows or use them as blackouts exposed to direct sunlight near strong sources of light, near heat sources, such as stoves, fireplaces or flues near air conditioning systems, for both cold or warm air, failure to comply with these prohibitions may cause deformation or permanent stretching of the projection fabric.



PRODUCT'S DISPOSAL

As is the case for installation procedures, when the product reaches the end of its useful life, disposal operations must be carried out by qualified personnel. The product is made up of various types of material: some can be recycled, others have to be disposed of. You must follow applicable recycling or disposal regulations in force in your area for this product category. As shown in the picture on the left, you must not throw the product into a domestic litter bin. Either dispose of the various components separately, pursuant to the regulations applicable in your territory, or hand the product over to a vendor upon purchasing a similar new product.

Warning: local regulations can foresee heavy fines in case of unlawful disposal of this product.

Images contained in this manual are intended to provide a detailed description of the product's functions, characteristics and procedures. Any slight difference, depending on the model.

GENERAL CHARACTERISTICS OF THE PRODUCT

The screen product is manufactured in compliance with the provisions of the following EC directives:

- 2014-35-CE LDV Low voltage
- 2014-30-EU EMC Electromagnetic compatibility
- 2014-53-CE Radio Equipment
- 2009-125-CE CONSUMPTION Ecodesign
- 2011-65-CE ROHS Restriction of Hazardous Substances

- 2012-19-CE RAEE Waste management
- 2001-95-CE SAFETY Safe Product

The screen described in this manual must be used exclusively as a support for video projection. Any other use not covered by this manual, it is not consented. The screen contains one or more Fabric/sheet of projection. The Fabric of projection is a cadmium-free plastic pvc sheet plastified PVC impregnated, any fabric can be classified in category:

- M1 and M2 fire classification under French standards (LNE Laboratoire national de métrologie et d'essais – SME Centre de recherches du Bouchet – WARRINGTONFIRE GENT Laboratoire de métrologie et d'essais – IFTH Laboratoire accrédité)
- B1 and B2 fire classification under German standards (LNE Laboratoire national de métrologie et d'essais – SME Centre de recherches du Bouchet – WARRINGTONFIRE GENT Laboratoire national de métrologie et d'essais)
- UL94HB fire classification under USA standards (THE GOVMARK Organization, Inc.)

In the absence of a standardisation at a European level of the various national classification norms, it should be noted that the French M1 class corresponds to non flammable material and that M2 class corresponds to flame retardant material.

The screens use projection fabrics/sheets composed mainly of plasticized PVC or fiberglass. As these fabrics are sensitive to temperature and humidity, the acceptable size tolerance is 1% in each dimension. There is a tolerance of +/-2 mm on the aluminium profiles used.

The tolerance on the overall size are:

- +/- 3 mm up to an overall size of 2500 mm;
- +/- 5 mm up to an overall size of 4000 mm;
- +/- 10 mm up to an overall size of 8000 mm;
- +/- 20 mm up to an overall size of 16000 mm;
- +/- 30 mm up to an overall size of 24000 mm.

GENERAL SAFETY NORMS

Screens and their projection surfaces are delicate and must be cleaned with great care, according to the following instructions:

Never use solvents, chemical or abrasive products, or pointed tools to clean the surface. Avoid contact with other materials (varnishes, inks etc) as they might be impossible to remove from the canvas.

GENERIC FABRIC: Clean the projection screen with a soft, clean, damp cloth, and a neutral or base detergent as necessary. Since rubbing the screen with a cloth during cleaning operations can cause electrostatic charge to accumulate, we recommend the subsequent application of an antistatic liquid with a clean cloth, to avoid dust being attracted again.

RADIANCE FABRICS: Clean the projection screen with a soft, clean, damp cloth, and water. Do not use detergents. These fabrics are extremely delicated.

GENERIC PROFILE: Remove dust from the case with a soft, clean cloth and a non aggressive detergent as necessary

VELVET PROFILE: Clean profile with a soft clean cloth, or a brush with soft, antistatic bristles. A vacuum-cleaner brush may be used, provided its bristles are soft and perfectly clean.

STRUCTURE and ANCHORING BRACKETS: The state of the product and the anchoring capacity of its brackets must be checked regularly. In case of canvas deformation or rips, or loosening of structural components such as brackets or screws, action must be taken immediately to clear the area around the screen and avoid hazard to people and things, replace the defective component and restore the product's functionality.

UNPACKING AND HANDLING THE SCREEN

Ensure that the screen has suffered no damage during transport. Should any fault be detected, promptly notify your dealer. Verify that all screen accessories have been included.

Warning: do not use cutters or sharp objects to open the wrapping, always use protection gloves when unpacking, handling and installing the product. Depending on the product's weight (reference load: 25 Kg male – 15 Kg female), handling and installing operations should be performed by two, three or four people at least. For heavier loads we recommend the use of specific lifting equipment.

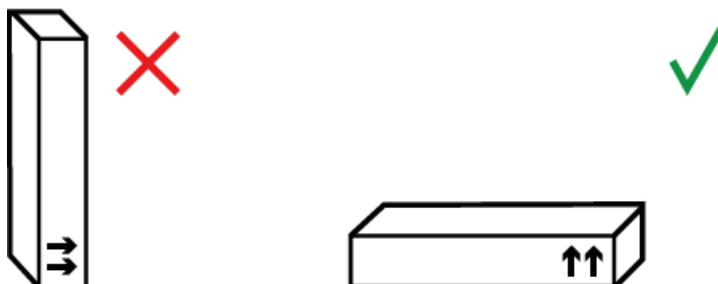

WARRANTY

GUARANTEE LIMITATIONS: The Manufacturer guarantees that all the products it distributes are free of production-, material- and processing-related defects, without prejudice to the following terms and conditions:

* The product is guaranteed for a period of twenty-four (24) months as from the date of the purchase invoice/receipt released to the end user.

CONDITIONS AND LIMITATIONS: This guarantee is subject to the following conditions and limitations: the guarantee shall be deemed null and void if: the product has been used or manipulated in any manner other than those indicated in the user manual's instructions; or damaged as a result of improper use, or owing to accident or negligence during transport; or if the product's defect is the result of repair or manhandling on the part of anyone other than personnel authorized by our Sales department.

The product must be installed by trained and experienced insider professionals, following the instructions provided for the installation and maintenance procedures.

RETURN: No product shall be returned and accepted without an authorization (RC) released by Sales department. Products must be returned in their original (or equivalent) packaging to avoid being damaged during transport.

Any transport damages resulting from inappropriate packaging shall not be covered by this guarantee. The returned product shall be accompanied by a detailed description of the defect and by a photocopy of the original purchase invoice/receipt.

The purchase invoice/receipt shall clearly indicate the following: Model – Serial number – Purchase date – Name and address of the purchaser and authorized dealer.

38060 Besenello (TN) Via Nazionale, 1/n – 1/u | +39 0464830003 info@screenline.it | screenline.it

Documents / Resources

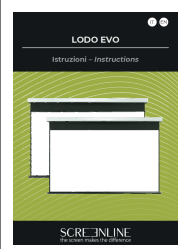
	<p>LODO EVO 2022 Screen Instruction Manual [pdf] Instructions 2022 Screen Instruction Manual, 2022, Screen Instruction Manual, Instruction Manual, Manual</p>
---	---

References

- [User Manual](#)

[Manuals+](#), [Privacy Policy](#)

This website is an independent publication and is neither affiliated with nor endorsed by any of the trademark owners. The "Bluetooth®" word mark and logos are registered trademarks owned by Bluetooth SIG, Inc. The "Wi-Fi®" word mark and logos are registered trademarks owned by the Wi-Fi Alliance. Any use of these marks on this website does not imply any affiliation with or endorsement.