

**LODES**  
19 Cluster  
Suspension  
Lamp



#### Contents

- [1 LODES 2019 Cluster Suspension Lamp](#)
- [2 Specifications](#)
- [3 Product Usage Instructions](#)
- [4 Assembly instructions](#)
- [5 WARRANTY](#)
- [6 Limited Warranty](#)
- [7 FAQ](#)
- [8 Documents / Resources](#)
  - [8.1 References](#)

# LODES

**LODES 2019 Cluster Suspension Lamp**



## Specifications

- **Designer:** Luca Nichetto
- **Year:** 2019
- **Product:** Cluster suspension lamp
- **Light source:** LED included
- **Options:** Jefferson mini, Jefferson small, Jefferson medium
- **Color Temperature:** 2700K
- **Current:** DC 350mA
- **Power:** 3W
- **CRI:** 90
- **MacAdam:** 3-Step
- **Luminous Flux:** 450 lm

## Product Usage Instructions

### Installation Requirements

Suspension lamps must be installed on a Lodes canopy.

### Canopies Options

Rosoni adatti a questa lampada:

- **Single canopies / Rosoni singoli:**

- Recessed micro 350mA
- Single 350mA

- **Multiple canopies / Rosoni multipli:**

- Lights Track 350mA Short & Long

## **Assembly Instructions**

Read and follow the assembly instructions provided with the product.

## **Warranty Information**

The product is covered by a warranty for material and manufacturing defects for a period of 12 months from delivery.

## **Safety Precautions**

This product must be installed by qualified personnel only. Avoid using in damp or salt water environments.

## **Risk of Fire**

Avoid placing flammable materials close to the fixture to prevent the risk of fire.

- **Light source:**

- Jefferson mini
- Jefferson small
- Jefferson medium

- **LED included**

- 2700K
- DC 350mA
- 3W
- CRI 90
- MacAdam 3-Step
- 450 lm

- **Lodes canopies**

- Canopies suitable for this lamp

- **Suspension lamps must be installed on a Lodes canopy**

- **Single canopies:**

- Recessed micro 350mA
- Single 350mA

- **Multiple canopies**

- Round 350mA 3 – 36 Lights
- Rectangular 350mA 7 – 28 Lights
- Lights Track 350mA Short & Long
- Radial 350mA 4 – 28 Lights

Before installing the device and, in any case, before any maintenance work, always disconnect the power supply.

## **MODELS**



Mini



Small



Medium

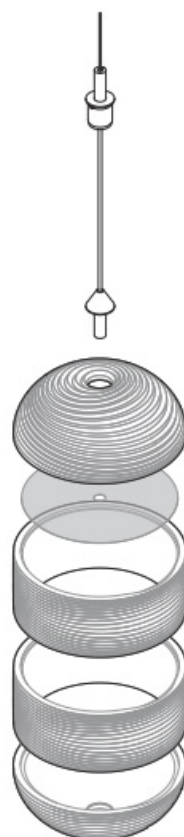
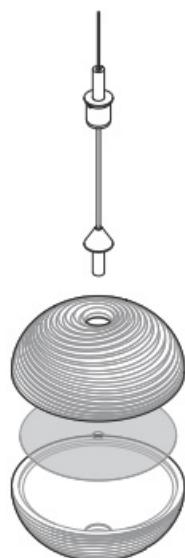

## Assembly instructions



#### Single 350mA

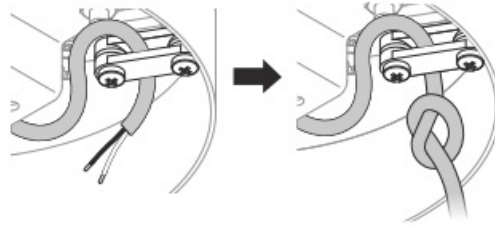

#### Round 350mA 3 - 36 Lights/ Rectangular 350mA 7 - 28 Lights

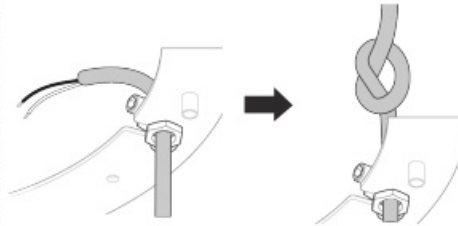

#### Lights Track 350mA Short & Long

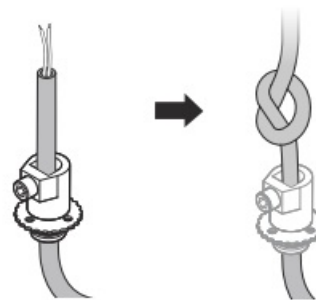

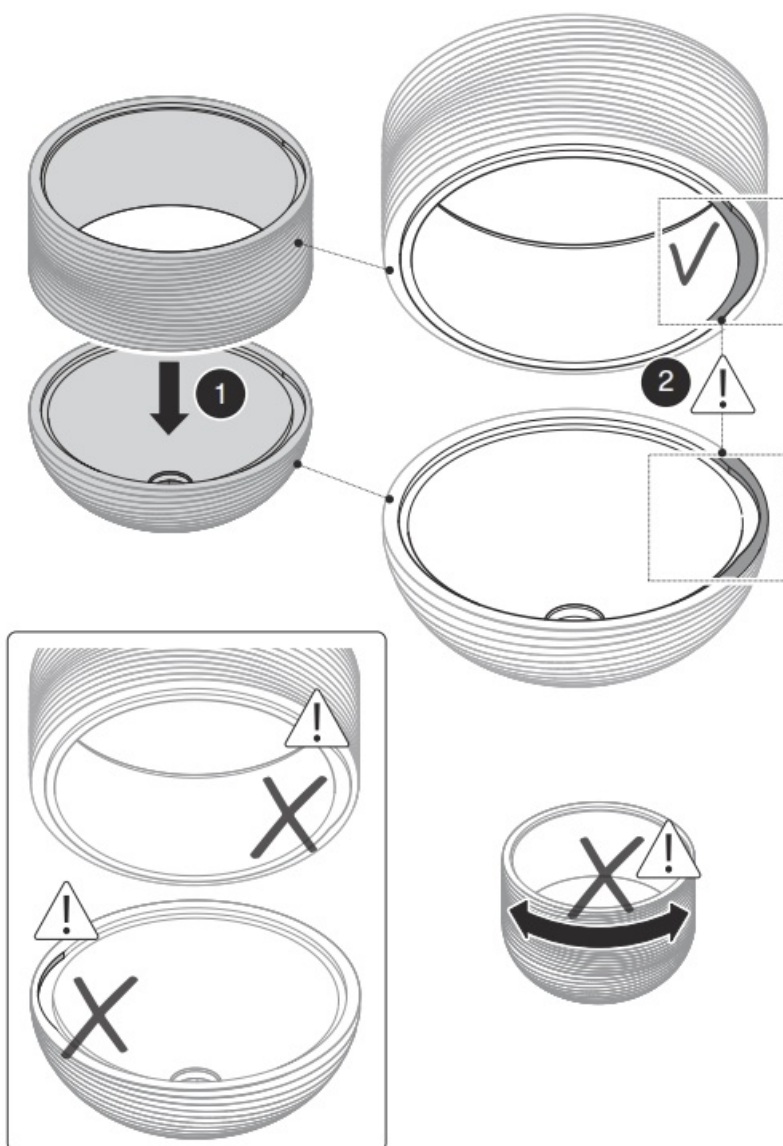

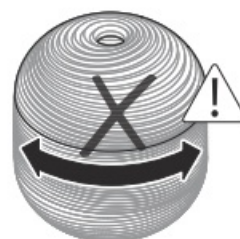
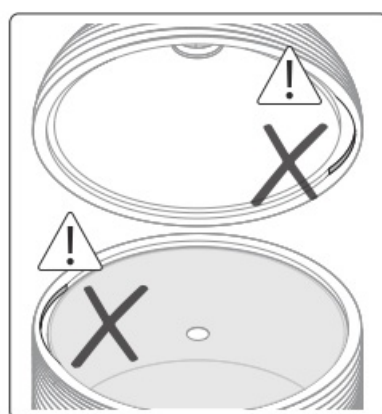
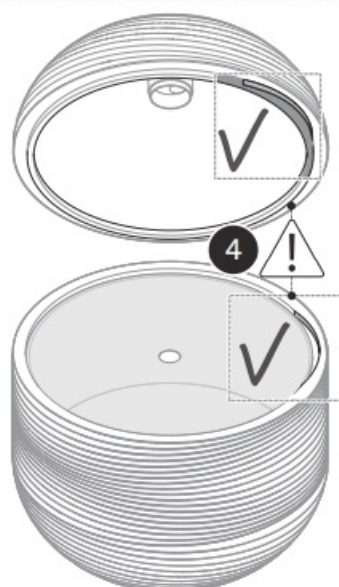
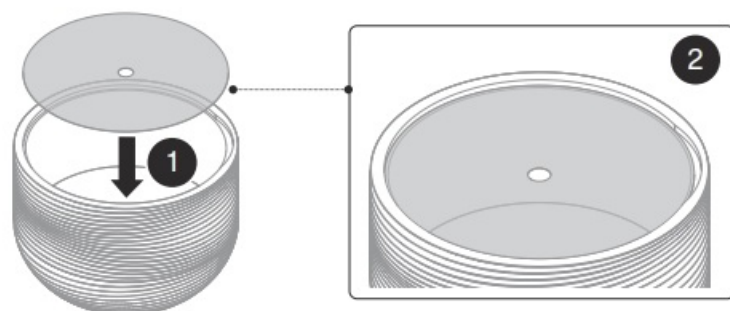

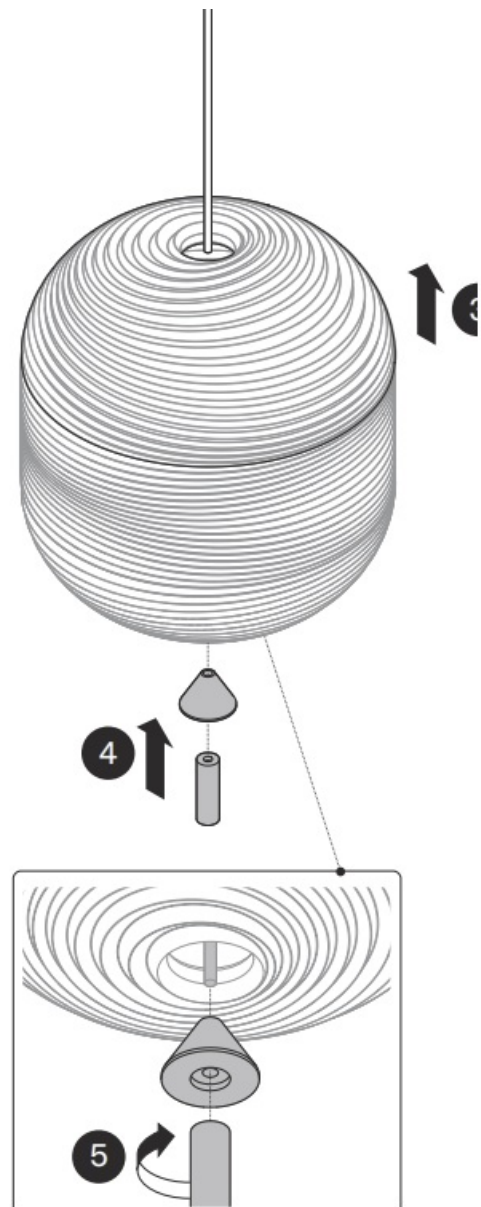
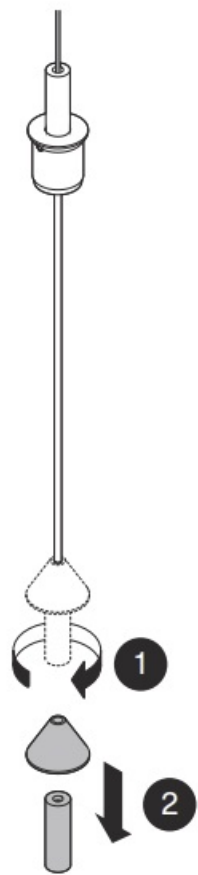

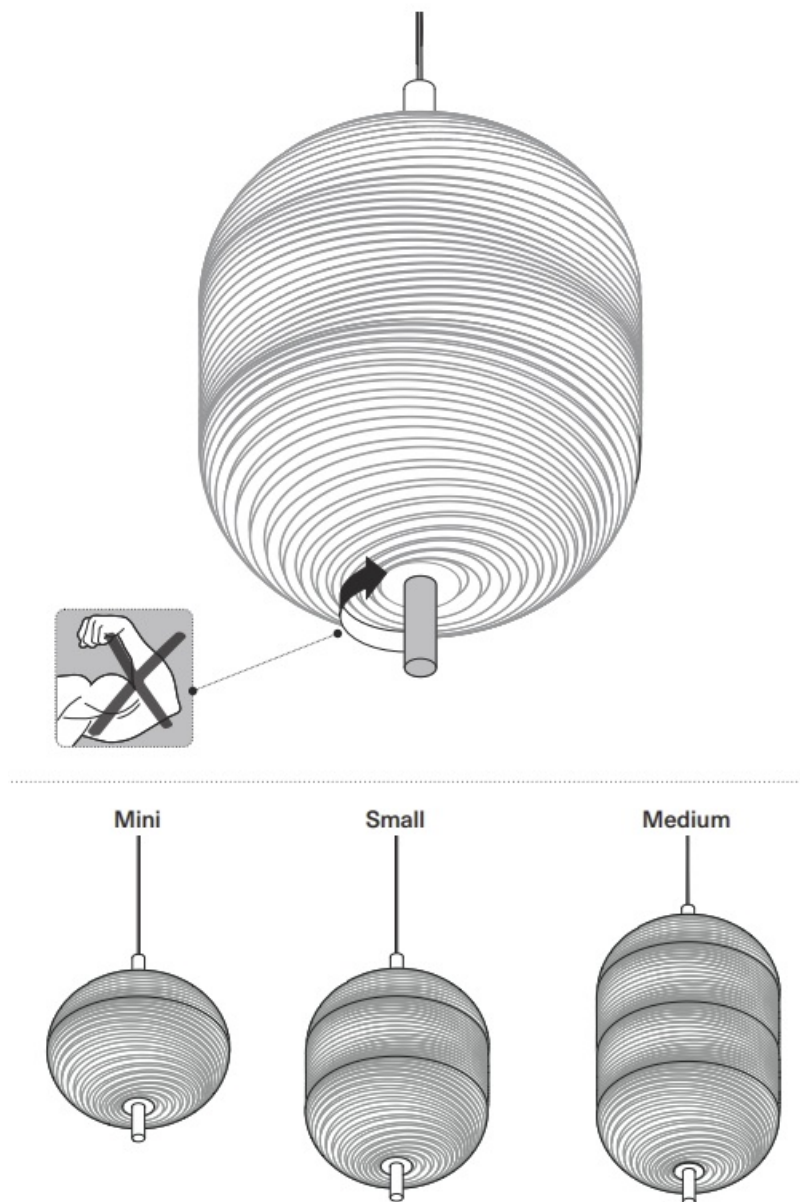

Keep these instructions for future reference. The device must be installed by qualified personnel only.

## WARRANTY

The products are covered by a warranty for material and manufacturing defects for a period of 12 months from delivery, except in cases where the purchaser is an individual, in which case the warranty period shall be 24 months. During this warranty period, Lodes will repair or replace, at its discretion, any product that is proven to be defective. This warranty does not apply to any damage resulting from accidents, alterations, tampering, misuse, negligence or improper use, or that has been caused by incorrect installation or incorrect maintenance work carried out by unauthorised individuals. The device must not be installed in positions or used in ways other than those indicated in the installation instructions. Any modification may compromise safety and cause the product to become dangerous. Lodes shall therefore not be held liable for any damages caused by alterations or tampering or the product not being used/installed in compliance with the installation instructions, also in the event of the electrical system and/or the capacity of said system not being suitable.

## WARNING

- Clean the product using a soft cloth, slightly dampened with soap or detergent, preferably diluted in water. Never use ethyl alcohol or detergents containing even small amounts of acetone, trichloroethylene, ammonia and solvents in general.

- If the external flexible cable of this device is damaged, it must only be replaced by the manufacturer, its support service or by equivalent qualified personnel, in order to avoid danger.
- Fix the device in place using a system that is appropriate for the installation surface.
- This device must only be used indoors. Do not use in damp or salt water environments.
- LODES light fixtures and canopies are made, tested and configured to be installed exclusively with one other.
- The light source contained in this device must only be replaced by the manufacturer or by the latter's assistance service or by equally specialised personnel.
- In order to inspect the electrical connections, it is recommended to follow the installation steps in reverse order until the electrical connections can be inspected.
- Turning the power off using the light switch is not sufficient to prevent electrical shock.
- The luminaire is not intended to support external weight other than the provided diffusers or other components.
- ELECTRICAL CONNECTION: 1-Connect the grounding wire of the luminaire to the grounding conductor of the supply circuit. Attach all grounding conductors to the mounting bracket with the ground wire attachment screw. 2- Referring to the installation instructions, connect the wires.
- **CAUTION:** To reduce the risk of fire, electrical shock, exposure to excessive UV radiation or injury, use this fixture indoors only (DRY LOCATION ONLY) do not look directly at the lighted lamp, do not remain in light if skin feels warm.
- This product can be mounted to standard 4" J\_Box.
- This product must be installed in accordance with the applicable installation code by a person familiar with the construction and operation of the product and the hazards involved. To guarantee the correct and safe functioning of the light fitting, make sure that it is earthed.
- **RISK OF FIRE:** Never place flammable material close to your fixture.

### Legend of symbols

USER INFORMATION ON RECYCLING WEEE (COMMUNITY DIRECTIVE 2014 / 49 / EC).



The WEEE  symbol printed on this product indicates that, at the end of its service life, it must not be disposed of as household waste but is intended for separate collection. Contact your local waste collection agency or ask the seller for information about public waste collection centres in your area. Even the seller can collect the old product if you purchase a new one of the same type. Incorrect disposal may harm people and the environment due to the presence of hazardous substances. Penalties are envisaged for the unlawful disposal of this type of waste.

The ETL Listed mark indicates that the product has been tested by an accredited third party laboratory in compliance with the applicable product regulations (UL standards) and minimum safety requirements in order to be sold and distributed in North America.

Dimmable with TRIAC phase-cut dimmers.

This product was made using specific processing techniques and treatments aimed at creating unique results. Any differences between individual items are therefore designed to ensure that every single product is special and unique.

### Limited Warranty

12 months for the United States and Canada Only

## **COVERAGE**

Lodes, with headquarter in 30020 Marcon (VE), Via Pialoi 32 Italy, VAT N.: 02992370276 (hereinafter, "Lodes" or "WARRANTOR") warrants that each Lodes PRODUCT will be free from defects in material and workmanship for a period of twelve months from the date of shipment/delivery of the PRODUCT (that can be identified by the "Studio Italia Design" trademark, trade name, or logo affixed to them). The Limited Warranty is referred to herein as "the Limited Warranty." The PURCHASER's sole and exclusive remedy under this Limited Warranty for defects in the PRODUCT shall be the repair, replacement or refund of the purchase price, in the WARRANTOR's sole discretion, of the defective PRODUCT, or components thereof.

## **NOT COVERED**

This Limited Warranty also does not apply to, and WARRANTOR shall have no liability or responsibility in respect of, damages or expenses relating to:

- Any PRODUCT purchased from any entity other than WARRANTOR;
- Alteration, change or modification of the PRODUCT, including its subcomponents, parts or assemblies;
- WARRANTOR also makes no warranty that a PRODUCT manufactured does not infringe the intellectual property or other proprietary rights of any third party;
- Accidents, misuse, abuse, abnormal use, improper use, negligent use, wilful misconduct, or use exceeding the recommended and permitted limits of the PRODUCT, and/or normal wear or deterioration;
- Any defect or non-conformity that has not been timely and promptly communicated in writing to WARRANTOR as set forth herein.
- Any damage, cost or expense caused by Act of God; or
- Loss of time, loss of use, inconvenience, loss of profits, lost business, lost business opportunities, damage to reputation, goodwill and any incidental or consequential damages arising out of or relating to the PRODUCT, or other matters not specifically covered hereunder.

## **PROCEDURE**

- Upon delivery, PURCHASER shall, within one (3) business day, inspect the PRODUCT for conformity and visible defects. PURCHASER shall give WARRANTOR immediate written, specific and detailed notice of any non-conformities or defects regarding the PRODUCT. Upon receipt of the written notice of claim, WARRANTOR shall have the right to inspect the PRODUCT.
- In the event of a defect covered by this Limited Warranty, WARRANTOR will, at WARRANTOR's discretion, repair or replace the PRODUCT or any component of the PRODUCT or refund the purchase price for that particular PRODUCT. In the event that PURCHASER submits a warranty claim that, in the sole reasonable discretion of the WARRANTOR, is unfounded, the PURCHASER shall reimburse the WARRANTOR all reasonable costs incurred by the WARRANTOR in evaluating the warranty claim (i.e. travel, lodging, expert evaluations, etc.).
- WARRANTOR must approve, in advance and in writing, all repairs or replacements covered under or performed pursuant to this Limited Warranty. Any warranty repairs or service must be performed exclusively by WARRANTOR or another authorized representative of WARRANTOR or by another servicing facility preapproved in writing by WARRANTOR.
- Acceptance of any Limited Warranty claim is not an admission that any PRODUCT or any of its component parts are defective. The PURCHASER forfeits any rights it may have under this Limited Warranty if the PURCHASER does not follow the procedure described herein.

**All requests and notices under this Limited Warranty shall be directed to:**

- Lodes S.r.l., Via Pialoi n. 32, 30020 Marcon (VE), Italy
- E-mail: [legal@lodes.com](mailto:legal@lodes.com)
- Fax: +39 0414 56 73 37

## **LIMITATION OF DAMAGES**

- Except as expressly provided by this Limited Warranty, WARRANTOR SHALL NOT BE RESPONSIBLE FOR ANY INCIDENTAL OR CONSEQUENTIAL DAMAGES ASSOCIATED WITH THE USE OR NON-USE OF THE PRODUCT OR A CLAIM UNDER THIS LIMITED WARRANTY, WHETHER THE CLAIM IS BASED ON CONTRACT, TORT OR OTHERWISE.
- The foregoing statements of warranty are exclusive and in lieu of all other remedies or damages. Some States do not allow the exclusion or limitation of incidental or consequential damages, so only in this case this limitation or exclusion may not apply to you.
- This Limited Warranty shall be the sole and exclusive remedy available to the PURCHASER with respect to this PRODUCT. In the event of any alleged breach of any warranty or any legal action brought by the PURCHASER, based on breach of warranty, alleged negligence or other tortious conduct by WARRANTOR, the PURCHASER's sole and exclusive remedy will be the repair or replacement of any defective PRODUCT as stated herein. In no event shall the liability of the WARRANTOR exceed the purchase price of the PRODUCT.
- DISCLAIMER. ANY IMPLIED WARRANTY OF MERCHANTABILITY OR FITNESS FOR A PARTICULAR PURPOSE AND ALL IMPLIED WARRANTIES ARISING FROM A COURSE OF DEALING, USAGE OF TRADE, BY STATUTE OR OTHERWISE, IS HEREBY STRICTLY LIMITED
- TO THE TERM OF THIS WRITTEN WARRANTY. This Limited Warranty shall be the sole and exclusive remedy available to the PURCHASER with respect to this PRODUCT. In the event of any alleged breach of any warranty or any legal action brought by the PURCHASER based on alleged negligence or other tortious conduct by WARRANTOR, the PURCHASER'S sole and exclusive remedy will be repair or replacement of defective materials or refund of the purchase price, as stated herein.

## **TRANSFER OF LIMITED WARRANTY**

This warranty is made by WARRANTOR with only first PURCHASER of the PRODUCT and does not extend to any subsequent PURCHASER or any third parties. The unexpired portion of this Limited Warranty may not be transferred to any entity.

## **APPLICABLE LAW**

This Limited Warranty shall be deemed to have been particularly negotiated between parties. The parties expressly acknowledge and irrevocably agree that any and all claims or disputes arising out of or otherwise relating to this Limited Warranty shall be decided exclusively by Court of Venice under Italian Law with the exclusion of any courts of any place. PURCHASER expressly waives any provision of law in the jurisdiction in which PURCHASER is located or any other potentially applicable law that conflicts with any provision of this Limited Warranty at any time.

## **OTHER RIGHTS**

Your acceptance of delivery of The PRODUCT constitutes your acceptance of the terms of this Limited Warranty. This Limited Warranty gives you specific legal rights, and you may also have other rights which vary from state to state. If any term or provision of this Limited Warranty is invalid or unenforceable under any local, state, or federal law, statute, judicial decision, regulation, ordinance, executive order or other rule of law, such term shall be deemed reformed or deleted, but only to the extent necessary to comply with such statute, regulation, ordinance,

order or rule and the remaining provisions of this Limited Warranty shall remain in full force and effect.

## **ENTIRE AGREEMENT**

- This document alone contains the entire Limited Warranty given by WARRANTOR in respect of the PRODUCT.
- Nothing in WARRANTOR's product literature, marketing materials, advertisements and technical specifications expand or enlarge the scope of this Limited Warranty.
- There are no terms, promises, conditions or warranties regarding the PRODUCT other than those expressly contained herein.
- WARRANTOR specifically does not authorize any person, including but not limited to any dealer or other agent or employee of WARRANTOR, to extend the time, scope, terms or conditions of this Limited Warranty or to create or assume for WARRANTOR any other obligation or liability with respect to the PRODUCT or other products designed, manufactured or sold by WARRANTOR. All terms of this Limited Warranty are contractual and not mere recitals, and constitute material terms of this Limited Warranty.
- It is agreed and acknowledged that the provisions of this Limited Warranty allocate the risks between WARRANTOR and PURCHASER, that WARRANTOR's pricing reflects this allocation of risk, and but for this allocation and limitation of liability, WARRANTOR would not have entered into this Limited Warranty. The agents, employees, and dealers of Lodes Products are not authorized to make modifications to this limited warranty or make additional warranties binding on Lodes.
- THIS DOCUMENT AND ALL PROVISIONS CONTAINED HAS BEEN SPECIFICALLY AGREED BETWEEN THE PARTIES.

## **Head offices & showroom**

- Lodes, via Pialoi 32, 30020 Marcon (Venezia) Italy
- T +39 041 45 69 266
- [info@lodes.com](mailto:info@lodes.com)
- @lodesbrand

## **Lodes Milan showroom**

- via della Moscova 33, Cortile della Seta 20121 Milano (MI) Italy
- T +39 02 4940 0999
- [milano@lodes.com](mailto:milano@lodes.com)

## **See our collections**



## FAQ

**Q: How do I replace the light source?**

A: The light source in this device must only be replaced by the manufacturer or by authorized personnel.

**Q: What should I do if the electrical connections are damaged?**

A: If the electrical connections are damaged, it is recommended to contact the manufacturer's support service or qualified personnel for assistance.

**Q: Can this product be used outdoors?**

A: No, this product is designed for indoor use only. Do not use in damp or saltwater environments.

## Documents / Resources

	<p><a href="#">LODES 2019 Cluster Suspension Lamp</a> [pdf] Owner's Manual 2019, 2019 Cluster Suspension Lamp, Cluster Suspension Lamp, Suspension Lamp, Lamp</p>
---	---

## References

- [L Lodes | Illuminazione Decorativa dal 1950 | Venezia](#)
- [User Manual](#)