

LKTOP MINI 34 Series Two Way Charging Hub



LKTOP MINI 34 Series Two Way Charging Hub User Manual

[Home](#) » [LKTOP](#) » LKTOP MINI 34 Series Two Way Charging Hub User Manual 

Contents

- [1 LKTOP MINI 34 Series Two Way Charging Hub](#)
- [2 Matters needing attention](#)
- [3 Product Introduction](#)
- [4 Product instructions](#)
- [5 Discharge steps](#)
- [6 Product specification parameters](#)
- [7 FCC STATEMENT](#)
- [8 Documents / Resources](#)
 - [8.1 References](#)
- [9 Related Posts](#)

LKTOP

LKTOP MINI 34 Series Two Way Charging Hub



Matters needing attention

- Before using this product, please carefully read and follow all safety and compliance instructions related to this product. Do not use the charger in direct sunlight, rain, or damp environments.
- The CHARGING HUB should be kept away from hazardous materials such as heat sources, high pressure, water, flammable gases, corrosive agents, etc.
- In the event of fire, please use dry powder fire extinguishers correctly to extinguish the fire. Using liquid-type fire extinguishers may pose a risk of electric shock.
- It is strictly prohibited to use chargers in lightning and thunderstorm weather.
- Keep the interior of the charging HUB dry and avoid entering liquids such as water and oil. Please pay attention to insulation and fire prevention when using.
- When charging, please stay away from combustible materials and do not place the charging HUB or battery on the carpet for charging.
- Do not touch the metal terminals of the battery interface with your hands or other objects. If there are foreign objects attached to the metal terminals, please wipe them clean with a dry cloth when the power is turned off.

Product Introduction

The LKTOP MINI3/4 SERIES TWO-WAY CHARGING HUB is a multifunctional charging hub that integrates charging, a mobile power bank, illumination, and distress reminder functions. Can charge three batteries, Paired with batteries, it can serve as a flashlight or power bank to charge devices such as mobile phones or remote controllers. The distress reminder function adopts a dynamic SOS intelligent algorithm, providing reliable support and convenience for outdoor exploration, emergency rescue, night flight and other scenarios.

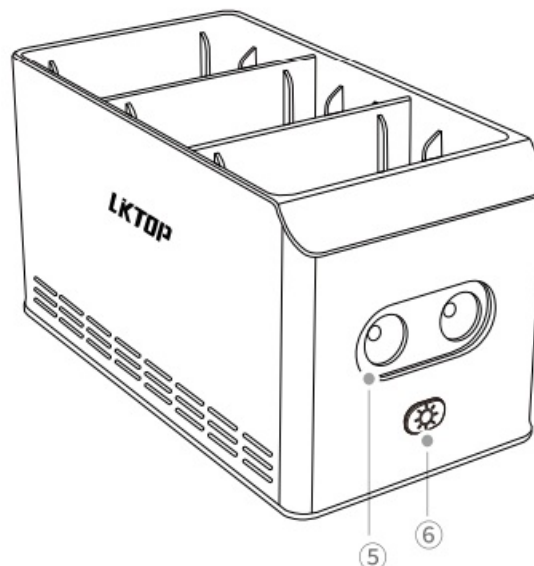
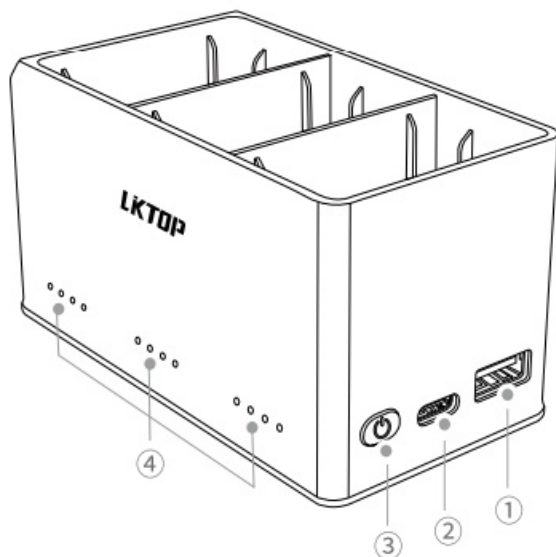

1. CDUSB-A interface
2. USB-Interface
3. Function button
4. Status indicator light
5. LED light s
6. LEDlightingb-button

Function	Operation steps
LED lighting	<p>Long press the LED lighting button ⑥ for more than 2 seconds to activate the LED lighting function, which defaults to 2nd gear; Short press the LED lighting button ⑥ to adjust the brightness of the LED light, and cycle between levels 1-5; Different levels of brightness are different and can be selected according to needs. Level 5 is the burst mode; Press and hold for more than 2 seconds to turn off the LED light.</p>
Call for help reminder	<p>Short press and long press the function button ③ for more than 2 seconds to activate the call for help reminder function. (Same as battery startup method) Start in default SOS sound reminder mode, short press the function button ③ to switch modes. Sequentially: SOS Sound Reminder Mode - SOS Light Reminder Mode - SOS Sound Light Combination Reminder Mode Press and hold the function button ③ for more than 2 seconds in any modes to turn off the function Note: Using dynamic SOS intelligent algorithm: As the battery level decreases, the call for help interval is extended to ensure a longer call for help.</p>
Power display	<p>Short press the function button ③ to display the corresponding battery level for about 5 seconds.</p>

One click storage

Press and hold the function button ③ for Over 2 seconds while charging to activate the 60% storage mode.

Note: The first three compartments of the three sets of status indicator lights flash simultaneously, indicating 60% storage mode. When the power is cut off, it returns to normal mode.

Product instructions

Charging intelligent flight batteries

This manual uses the LKTOP MINI3/4 SERIES TWO-WAY CHARGING HUB and LKTOP 100W GaN Multi-Port Charger as examples for charging the DJI Mini 3/Mini 4 Pro intelligent flight battery. Up to three DJI Mini 3/Mini 4 Pro intelligent flight batteries can be connected.

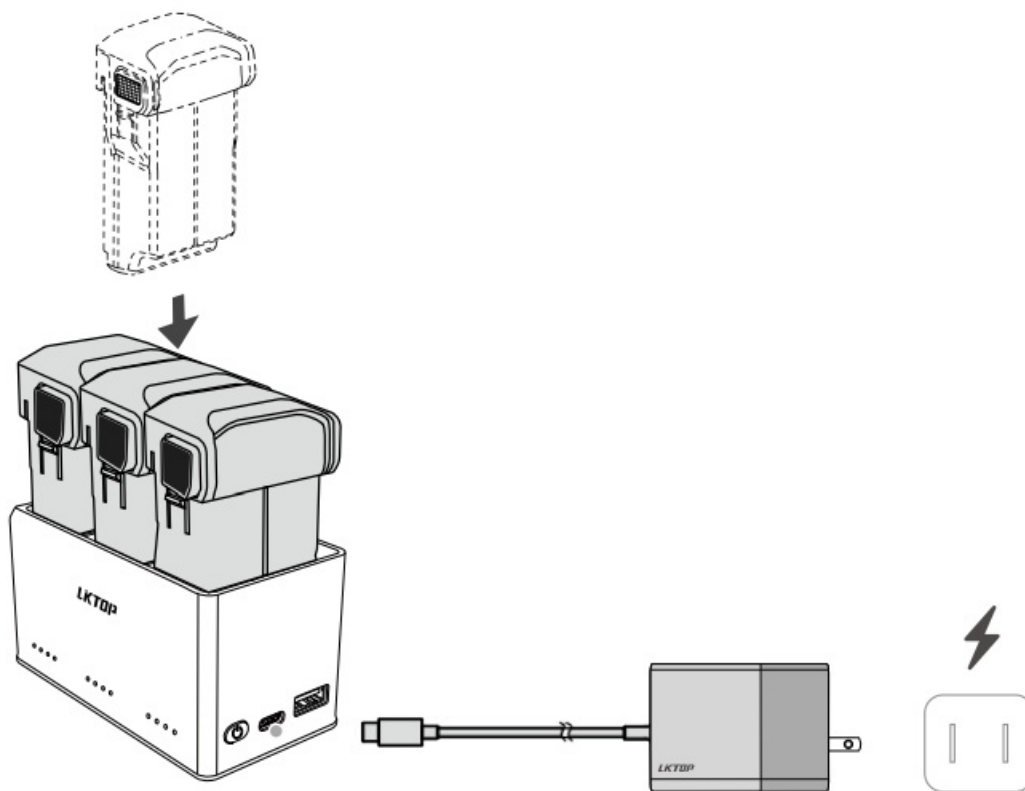

T8kingLICTOPMINI3/4SERIESTWO-WAYO-IARGINGHUB(MM433-100) +LKTOP 1 00-N GaN Multi-Port O,larger as an example

Charging steps

1. Connect the charging hub to the power interface of the AC power supply (100-240V, 50/60Hz), and connect the LKTOP MINI 3/4 SERIES TWO-WAY CHARGING HUB USB-C port to the charger.
2. Insert the intelligent flight battery into the LKTOP MINI 3/4 SERIES TWO-WAY CHARGING HUB
3. In the charging state, the intelligent flight battery level indicator light will cycle and flash, indicating the current battery level.
4. After the charging is completed, the corresponding status indicator light will turn green and remain on. Please promptly remove the battery from the Charging Hub and turn off the charger power.

MM433-37+30W charger charging schematic diagram: (Charging takes turns from high to low based on the remaining battery capacity, and the output power of the charger determines the charging power)

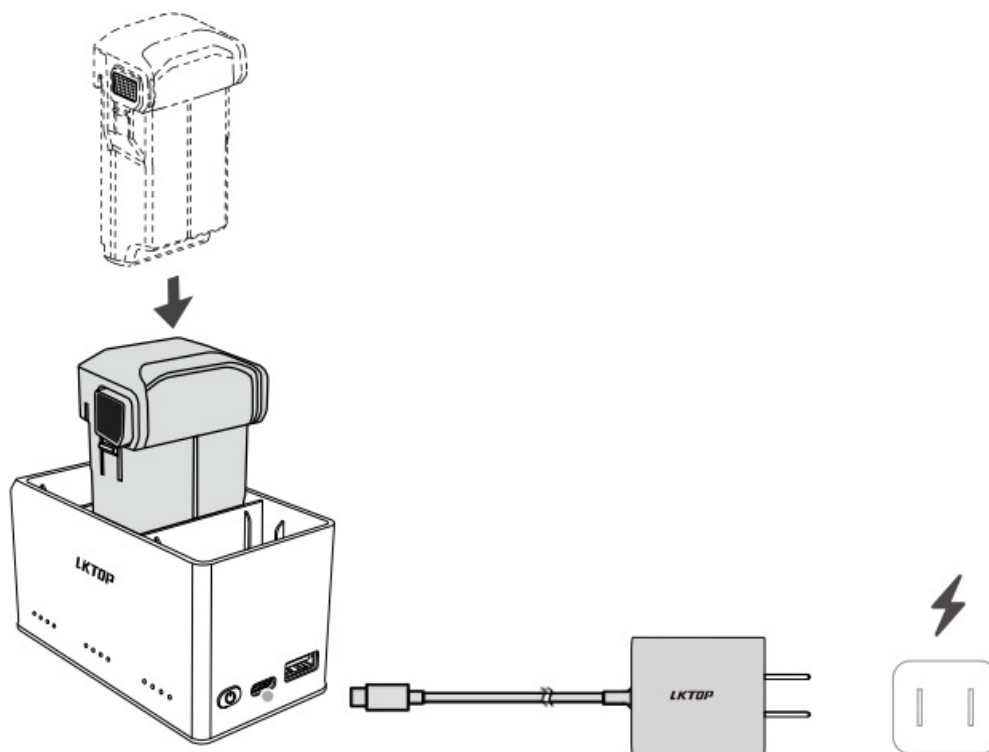

Taking LKTOP MINI3/4 SERIES TWO-WAY CHARGING HUB (MM433-37) + LKTOP 30W USB-C Charger as an example

MM433-37+65W charger charging schematic diagram: (Charging takes turns from high to low based on the remaining battery capacity, and the output power of the charger determines the charging power)

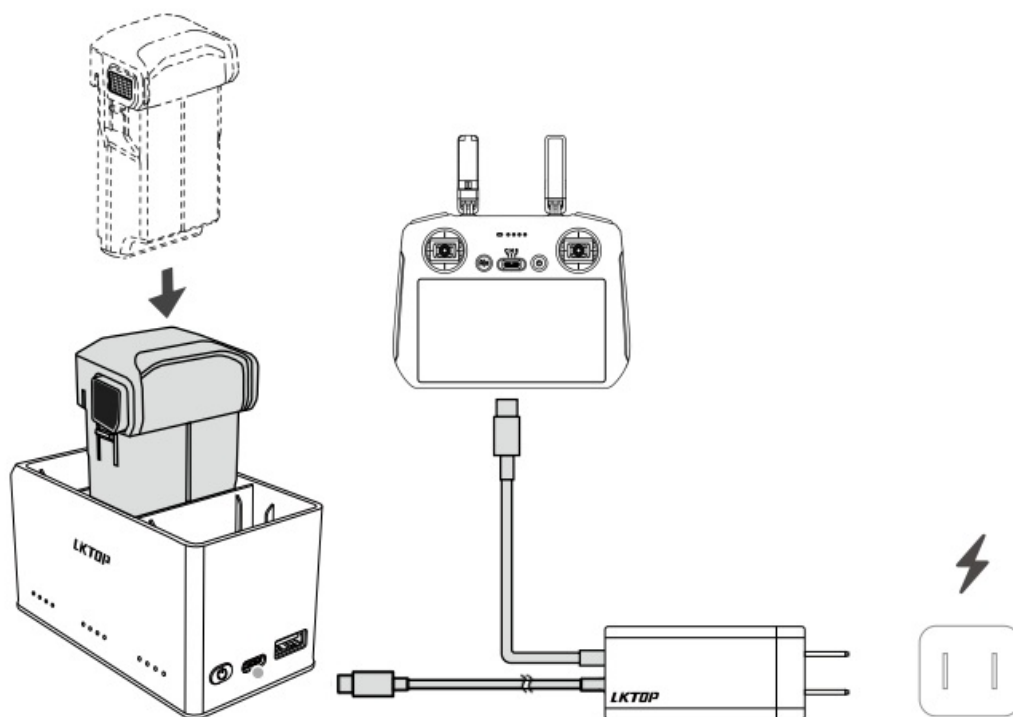

Taking LKTOP MINI3/4 SERIES TWO-WAY CHARGING HUB (MM433-37) +DJI RC2 remote controller + LKTOP 65W portable charger as an example

1. The fully charged indicator light will remain on, indicating that the battery is being used. Please promptly unplug the battery and turn off the charger power.
2. If the input power of the charger is less than 10W (5V/2A), it may not be possible to charge the battery.

MM433-100+100W charger charging schematic diagram: (Charging three batteries simultaneously)

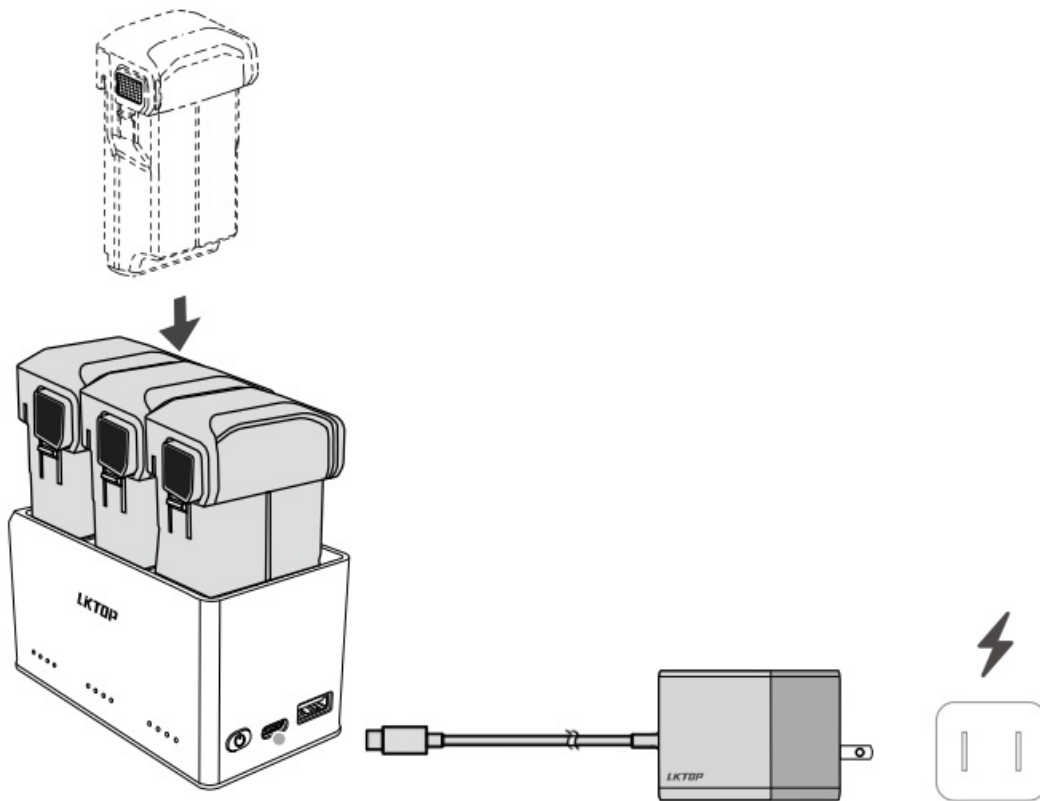

Taking LKTOP MINI3/4 SERIES TWO-WAY CHARGING HUB(MM433-100) +LKTOP 100W GaN Multi-Port Charger as an example

Discharge steps

1. Insert the Mini 3/Mini 4 Pro intelligent flight battery into the LKTOP MINI 3/4 SERIES TWO-WAY CHARGING HUB
2. When there is no power supply connected to the USB-C port, connect the digital device or remote controller to the USB-A port to charge the digital device or remote controller.
3. After waiting for the device to fully charge, please promptly unplug the battery, remote controller, and other external devices.

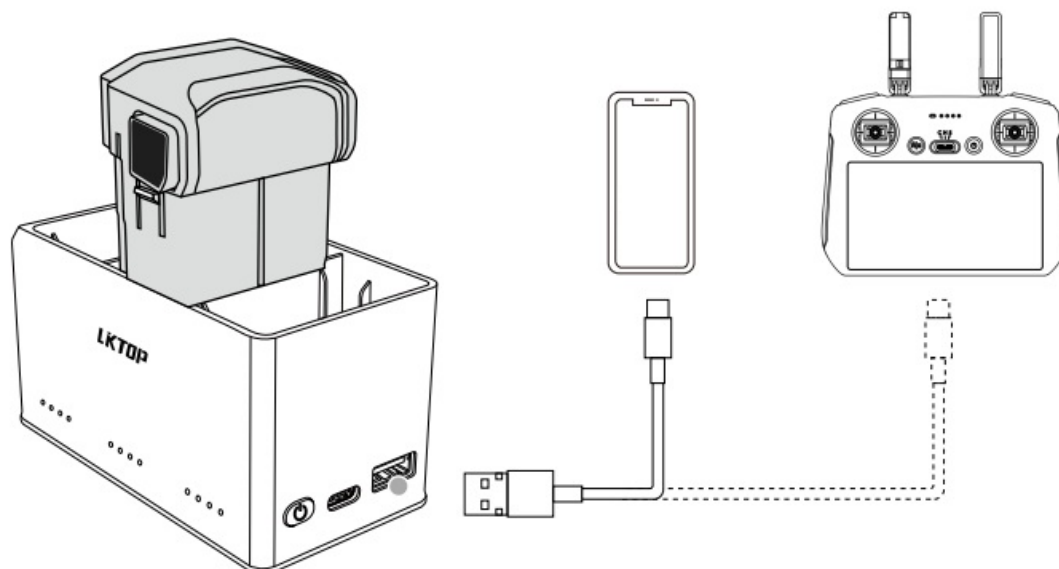

Taking LKTOP MINI3/4 SERIES TWO-WAY CHARGING HUB (MM433-37) + DJI RC 2 remote controller + mobile phone as an example

Product specification parameters

Product Name:	LKTOP MINI 3/4 SERIES TWO-WAY CHARGING HUB	LKTOP MINI 3/4 SERIES TWO-WAY CHARGING HUB
Product model:	MM433-37	MM433-100
Input (USB-C):	5V==3A, 9V==3A , 12V==3A	5V==3A, 9V==3A , 12V==3A, 20V==5A
Maximum charging power:	37W(Max)	100W(Max)
Output(USB-A):	5V==2A, 10W(Max)	5V==2A, 10W(Max)
Adapted battery:	DJI Mini 3 Series Intelligent Flight Battery, DJI Mini 4 Pro Intelligent Flight Battery, DJI Mini 4 Pro/Mini 3 Series Intelligent Flight Battery Plus	DJI Mini 3 Series Intelligent Flight Battery, DJI Mini 4 Pro Intelligent Flight Battery, DJI Mini 4 Pro/Mini 3 Series Intelligent Flight Battery Plus
Adapted charger:	Suggest using LKTOP 30W/65W charger or other 30W/65W PD protocol charger	Suggest using LKTOP 65W/100W charger or other 65W/100W PD protocol charger
Charging method:	Charge three batteries in sequence	Charge three batteries simultaneously
LED lighting function:	Support	Support
Call for help reminder function:	Support	Support
One click storage mode:	Support	Support
Battery level display:	Support	Support

Operation temperature:	5 – 40°C (41°–104° F)	5 – 40°C (41°–104° F)
Product size:	100*54*55(MM)	100*54*55(MM)
Packaging size:	110*85*60(MM)	110*85*60(MM)

- The test data were obtained under experimental conditions (at room temperature of 25 ° C) and are for reference only.
- PS: The weight/size information shown on this page is manually measured, and an error of 5g/3-5mm in soil is a normal phenomenon and is for reference only.

FCC STATEMENT

Compliance Information

FCC Compliance

This device complies with part 15 of the FCC Rules. operation is subject to the following two conditions:

1. This device may not cause harmful interference, and
2. this device must accept any interference received, including interference that may cause undesired operation.

Note:

This equipment has been tested and found to comply with the limits for a Class B digital device, pursuant to part 15 of the FCC Rules. These limits are designed to provide reasonable protection against harmful interference in a residential installation. This equipment generates, uses and can radiate radio frequency energy and, if not installed and used in accordance with the instructions, may cause harmful interference to radio communications. However, there is no guarantee that interference will not occur in a particular installation. If this equipment does cause harmful interference to radio or television reception, which can be determined by turning the equipment off and on, the user is encouraged to try to correct the interference by one or more of the following measures:

- Reorient or relocate the receiving antenna.
- Increase the separation between the equipment and the receiver.
- Connect the equipment into an outlet on a circuit different from that to which the receiver is connected.
- Consult the dealer or an experienced radio/TV technician for help.

EU Compliance

SHENZHEN LIKE FLIGHT TECHNOLOGY CO., LTD. hereby declares that this device is in compliance with Directive 2014/30/EU and 2014/35/EU.

Documents / Resources

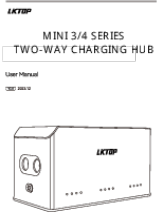
	<p>LKTOP MINI 34 Series Two Way Charging Hub [pdf] User Manual</p> <p>MINI 34 Series Two Way Charging Hub, MINI 34 Series, Two Way Charging Hub, Way Charging Hub, Charging Hub, Hub</p>
---	--

References

- [User Manual](#)

[Manuals+](#), [Privacy Policy](#)

This website is an independent publication and is neither affiliated with nor endorsed by any of the trademark owners. The "Bluetooth®" word mark and logos are registered trademarks owned by Bluetooth SIG, Inc. The "Wi-Fi®" word mark and logos are registered trademarks owned by the Wi-Fi Alliance. Any use of these marks on this website does not imply any affiliation with or endorsement.