

Contents [[hide](#)]

[1 LIVING SPACES 228212 Hercules Recliner](#)

[2 Specifications](#)

[3 ASSEMBLY INSTRUCTIONS](#)

[4 FAQs](#)

[5 Documents / Resources](#)

[5.1 References](#)



LIVING SPACES 228212 Hercules Recliner



Specifications

- **Product Name:** Hercules Manual Recliner

- **Available Types:** Sofa, Loveseat, Recliner
- **Origin:** Made in Vietnam

ASSEMBLY INSTRUCTIONS

Step 1: Parts list on the right

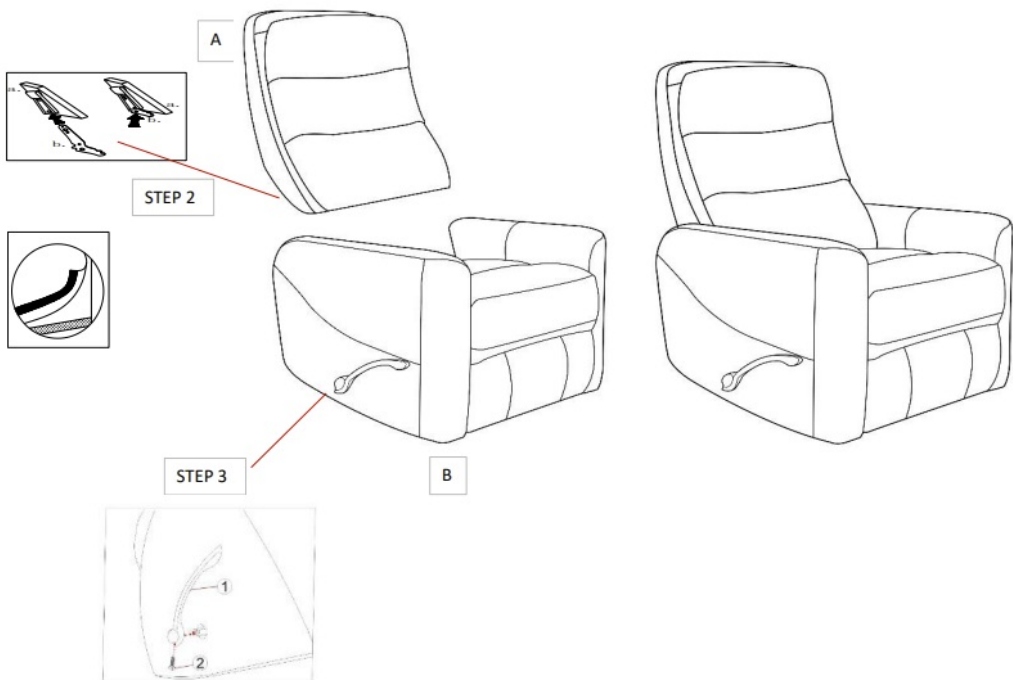

PARTS LIST:		Sofa	Loveseat	Recliner
A	BACK			1
B	SEAT			1
C	metal handle			1
C	flat head screw- skid proof			1

- **Step 2:** Attached the KD back to the base frame by aligning the brackets with the mechanism post as seen at the left. After aligning both sides, push firmly in a downward motion until you hear a clicking noise. The noise indicates the back is

locked to the base frame. Please make sure both sides are locked in position.

Attached the outside backflap to the bottom of the wooden rail by tucking the velcro.
(As shown on left).

- **Step 3:** Attach handle onto square knob, then insert flat head screw on the underside of handle and screw tight.

The picture shown for reference only.

- MADE IN VIETNAM
- Please be sure to cut zip ties to allow the swivel glider mechanism to work

FAQs

Q: Where is the product manufactured?

A: The product is made in Vietnam.

Q: How do I ensure the back is securely locked to the base frame?

A: Push the back downward until you hear a clicking noise, indicating it is locked. Make sure both sides are locked in position.

Documents / Resources

	LIVING SPACES 228212 Hercules Recliner [pdf] Instruction Manual 228212, 228212 Hercules Recliner, Hercules Recliner, Recliner
---	--

References

- [User Manual](#)

📁 LIVING
SPACES

🔍 228212, 228212 Hercules Recliner, Hercules Recliner, LIVING SPACES,
Recliner

Leave a comment

Your email address will not be published. Required fields are marked *

Comment *

Name

Email

Website

☐ Save my name, email, and website in this browser for the next time I comment.

Post Comment

Search:

e.g. whirlpool wrf535swhz

Search

[Manuals+](#) | [Upload](#) | [Deep Search](#) | [Privacy Policy](#) | [@manuals.plus](#) | [YouTube](#)

This website is an independent publication and is neither affiliated with nor endorsed by any of the trademark owners. The "Bluetooth®" word mark and logos are registered trademarks owned by Bluetooth SIG, Inc. The "Wi-Fi®" word mark and logos are registered trademarks owned by the Wi-Fi Alliance. Any use of these marks on this website does not imply any affiliation with or endorsement.