



LIVING SPACES 1539 Dev Power Recliner User Manual

[Home](#) » [LIVING SPACES](#) » LIVING SPACES 1539 Dev Power Recliner User Manual 

LIVING SPACES 1539 Dev Power Recliner



Contents

- [1 Components](#)
- [2 Quick Trouble-Shoot for Motors Malfunctioning](#)
- [3 Trouble-Shooting Guide](#)
- [4 Power Recliner PARTS](#)
- [5 Power Recliner Trouble Shooting](#)
- [6 Documents / Resources](#)
- [7 Related Posts](#)

Components

- **Switch** – mounted on the side of furniture and controls all motors and functions (reclining, power headrest, etc.) via a direct connection with motors.
- **AC wall plug**– connects the power transformer to the power outlet.
- **DC cord** – connects the power transformer to the DC socket (mounted on the rear bottom of LAF arm stump).
- **DC socket** – receives power from DC cord then transfer to motors.
- **Power Transformer** – A box-shaped unit to transfer 110V AC power to 25V DC power to supply for the

furniture.

- **Seat / Headrest/ lumbar Motor** – motors mounted on mechanism to drive movement on seat/headrest via switch control.
- **Mechanism**– the motion mechanical frame unit within the piece of furniture.

Quick Trouble-Shoot for Motors Malfunctioning

Below are some possible reasons to cause motors to stop working:

1. Loose connection or wires not securely plugged in.
2. Broken side switch
3. Broken DC socket
4. Broken power transformer (especially when ALL motors stops working on one unit)
5. Power cords damaged
6. Motors failure

NOTE: In some cases a button on the switch might be stuck after being pushed, thus continuously activating the motor. This can cause overheating or even damages on the power transformer.

Trouble-Shooting Guide

N O	The fault	diagnosis	To rule out
1	Power supply don't light up, and no output	The power supply fail	Replace a new power supply
2	Power supply light flashing	Power self-protection function start signal, parts and wires may be shorted	1. Check the surface of actuator/hand controller, whether is crushed 2. Internal shorted in the actuator/hand controller, replace the part.
3	The light of power supply is always on, press the hand controller, and the actuator can't work.	Actuator isn't powered, check whether the plug is loose.	Reconnect the plug..
		After checking the plug, the actuator still can't work, exchange the actuator is OK.	Replace a new actuator.
		After checking the plug, the actuator still can't work, exchange the controller is OK.	Replace a new hand controller.
4	The actuator cannot be retracted after it has been removed	Check whether the plug is loose.	Reconnect the plug..
		The actuator internal failure.	Replace a new actuator.
5	There is noise during actuator moving	The noise in the actuator.	Replace a new actuator
		The noise caused by the interference of mechanism.	Replace a new mechanism.

Power Recliner PARTS

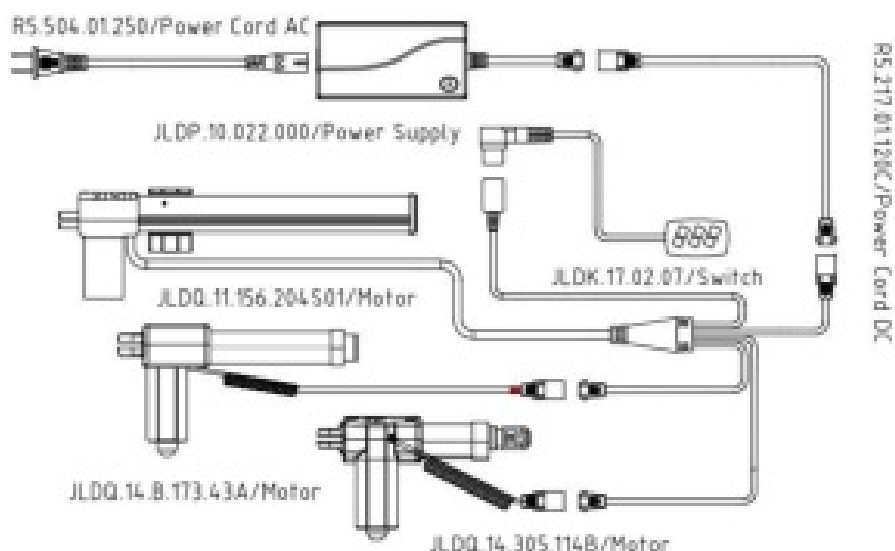

Power Recliner Trouble Shooting

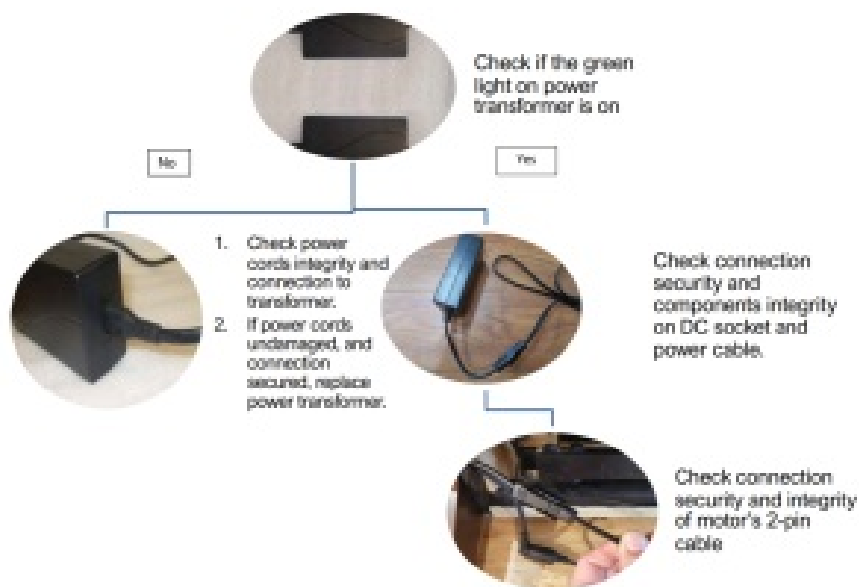

For dual-power recliners, please check connection and integrity of Y-Cable splitter.



Documents / Resources

 LIVING SPACES 1539 DEV POWER RECLINER USER MANUAL <small>Unauthorized Reproduction May Result in Legal Action</small>	LIVING SPACES 1539 Dev Power Recliner [pdf] User Manual 1539 Dev Power Recliner
---	--

[Manuals+](#)