



Litter-Robot 4 WiFi-Enabled Automatic Litter Box Instruction Manual

[Home](#) » [Litter-Robot](#) » Litter-Robot 4 WiFi-Enabled Automatic Litter Box Instruction Manual 

litter•robot® 4

by whisker

Installation guide
Ramp installation 1nstruct1ons

Contents

- 1 [Parts required:](#)
- 2 [Installing the Ramp Hinge and Ramp](#)
- 3 [Documents / Resources](#)
 - 3.1 [References](#)

Parts required:

		
Ramp	Ramp Hinge	Ramp Fence Hinge

Please note

Before starting, please note: Your Litter-Robot 4 was shipped with one of the two fences shown below. Please identify which one you have and follow the directions for that version.

1. Older Fence

If you are using the older (mini) version of the Litter-Robot 4 fence (with a plastic shield), remove it and follow the instructions for the Ramp Hinge. The Litter-Robot 4 Ramp is not compatible with the Litter-Robot 4 older fence.

2. Newer Fence



Ramp Hinge



Ramp Fence Hinge



If you are using the newer version of the Litter-Robot 4 fence (without a plastic shield), you can either
a) remove it and follow the instructions for the Ramp Hinge.
b) keep the fence on and follow the instructions for the Ramp Fence Hinge.

NOTE

There is a rib in the center of the Ramp which aligns with a groove in the middle of each Hinge to ensure the Ramp is centered correctly during installation.

		
Center of the Ramp	Center of the Ramp Hinge	Center of the Ramp Fence Hinge

Installing the Ramp Hinge and Ramp

(no fence)



How to install

1. Remove the fence by pulling up to disengage the snaps. If you do not have a fence, skip to the next step.



2. Snap the Ramp Hinge onto the bezel by pressing down at the locations shown until you hear a click. Make sure both ends of the Hinge are resting tightly against the surface of the bezel.

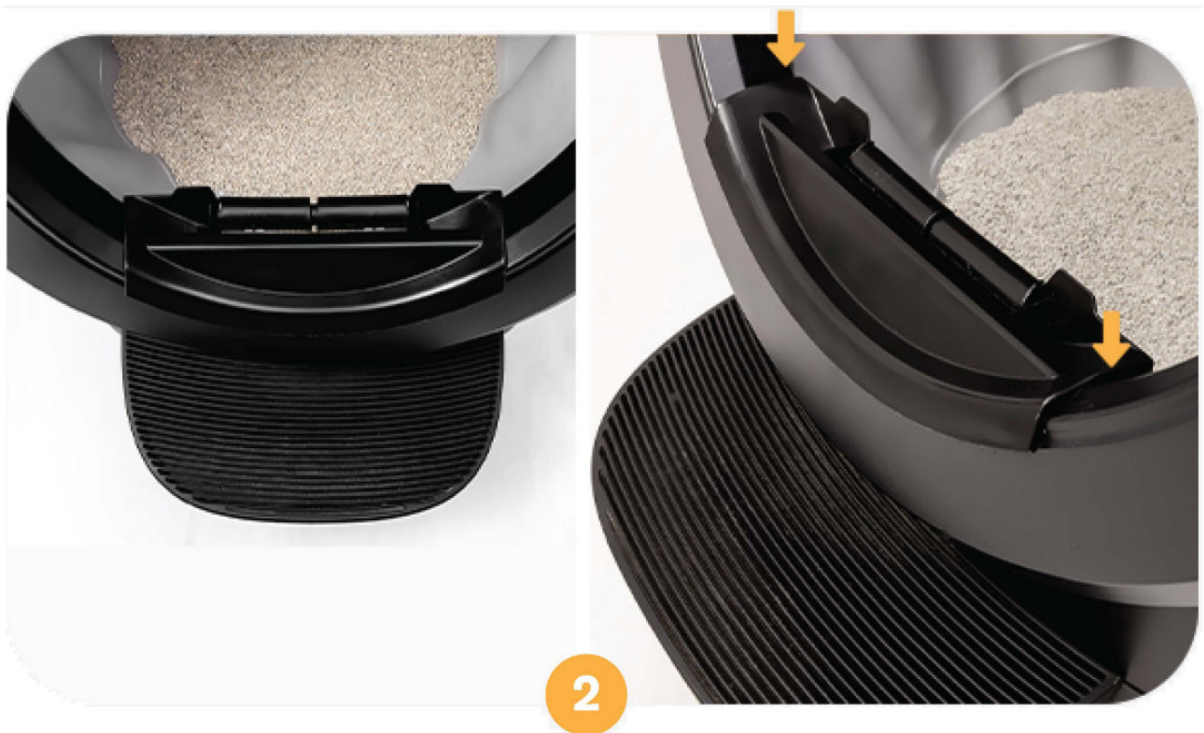

2

3. Orient the Ramp so it is parallel to the floor, then snap the Ramp onto the Hinge by pressing down.



3

4. Rotate the Ramp down to the floor. The Ramp is now ready to use!



Note

- ✓ If litter collects on the steps of the Ramp, it can be rotated upwards to dump the litter back inside the globe. (Not applicable if fence is installed.)



5. Press the Reset button  to zero the weight sensors.



Installing the Ramp Fence Hinge and Ramp

If the newer fence is not installed on your Litter-Robot 4, follow the steps below to install it. If your Litter-Robot 4

has the fence already installed, please skip the first three steps.



How to install

1. Hold the fence upright inside the globe.



2. Tilt the top of the fence toward you to align the front of the fence with the bezel.



3. Gently press down on the back of the fence to snap it onto the bezel. Make sure the fence is level.



Note

The back of the Ramp Fence Hinge has two small protrusions, one on each side. These are used to secure the Hinge to the edge of the fence.



4. Place the Ramp Fence Hinge over the top of the fence as shown. Adjust the location left-to-right until centered. Press the area behind the two small protrusions to snap it onto the edge of the fence.



5. Align the Ramp with the Hinge and press down to snap in place. Rotate the Ramp down to the floor. The Ramp is now ready to use!



6. Press the Reset button  to zero the weight sensors.



Questions? Visit whiskersupport.com

Documents / Resources

	<p>litter-robot Litter-Robot 4 WiFi-Enabled Automatic Litter Box [pdf] Instruction Manual Litter-Robot 4 WiFi-Enabled Automatic Litter Box, 4 WiFi-Enabled Automatic Litter Box, Enabled Automatic Litter Box, Automatic Litter Box, Litter Box, Box</p>
--	--

References

-  [Litter-Robot Support - Answers and Solutions](#)